

Barbie[®] Doll

happy family[™]

baby doctor

INSTRUCTIONS

CONTENTS

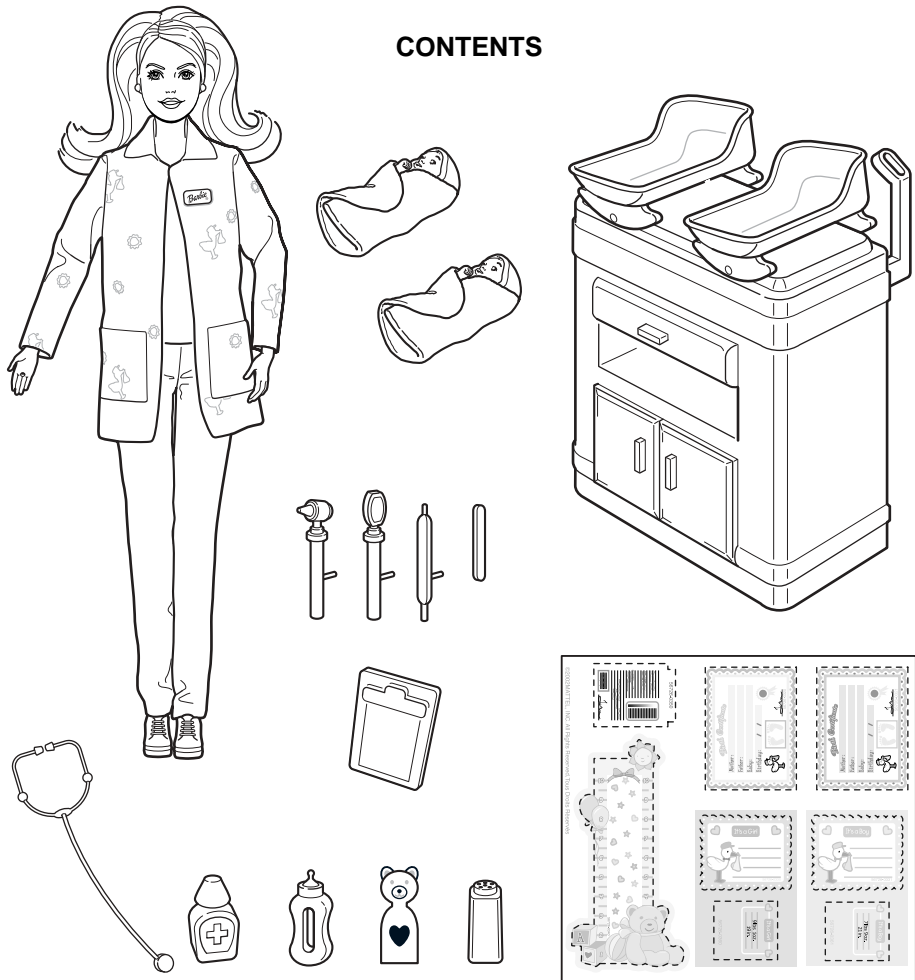

Colors and decorations may vary from those shown.

Please remove everything from the package and compare to the contents shown here.
If any items are missing, please call 1-800-524-TOYS.



56726-0920

Keep these instructions for future reference as they contain important information.

CONSUMER INFORMATION

MATTY MATTEL™ toys

YOU CAN TELL IT'S MATTEL!™ CALL us toll-free or write with any comments or questions about our products or service. Monday-Friday 8:00 a.m.-6:00 p.m. Eastern Time. Outside U.S.A., see telephone directory for Mattel listing.

Consumer Relations, Mattel, Inc.
333 Continental Blvd.
El Segundo, CA 90245 USA

1 (800) 524-TOYS

WE ARE DEDICATED TO QUALITY PRODUCTS.

WARNING:
CHOKING HAZARD - Small parts.
Not for children under 3 years.

The babies are soothingly rocked in their bassinets.

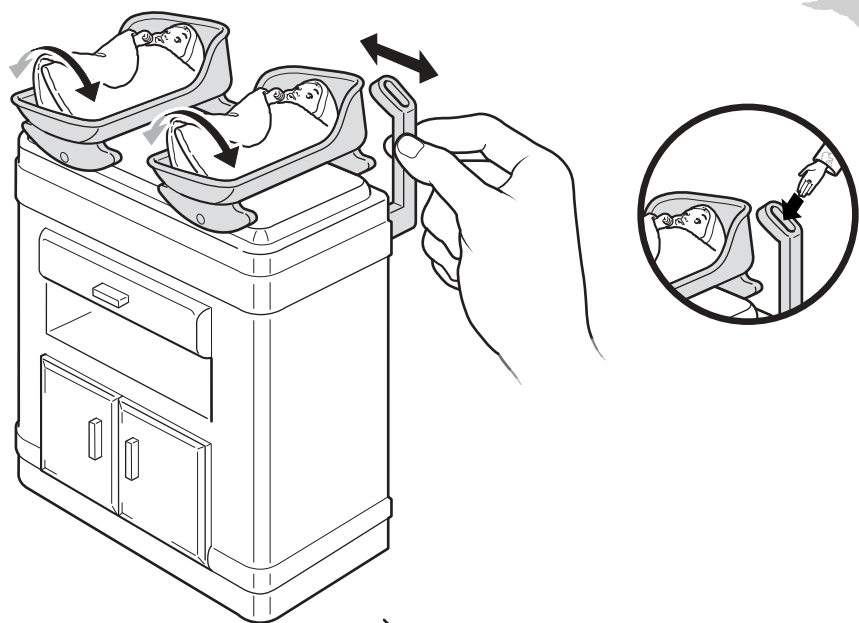

The bassinets can be removed from the base and rocked on any flat surface.

To place back on table, line up the bassinet's holes to the small posts on the table, and snap on.

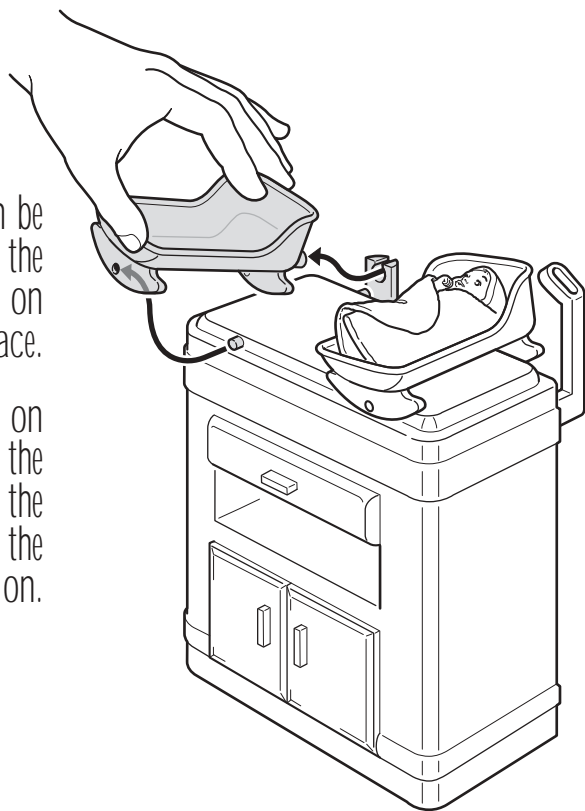

Any medical instrument with a post can be held by the doll. Simply put the post in the hole on your doll's right hand.

