

Instructions

# Big Action Garage™

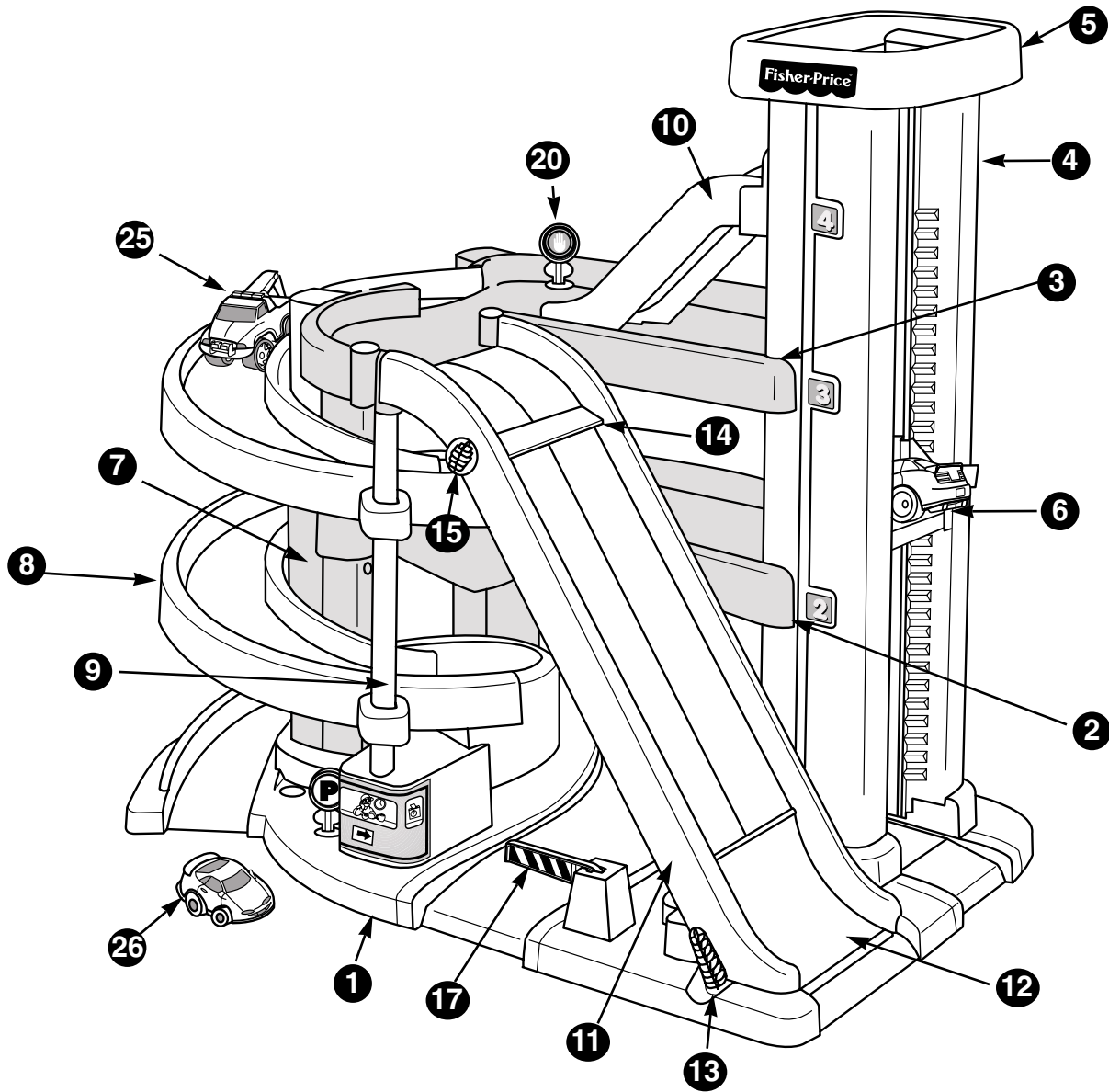

Please save these instructions for future reference.

Adult assembly is required.

Tool needed for assembly: Phillips Screwdriver.

Please read these instructions carefully and follow the assembly steps in order. The Big Action Garage will not assemble correctly out of order and you may be unable to remove or disconnect parts to correct the assembly.

CAUTION

Please keep small parts and plastic bags out of children's reach.

# Message to Parents

Thank you for purchasing the Fisher-Price Big Action Garage. With a drive-on working elevator, automatic elevator gates on each floor, and a speed ramp for racing and speed jump excitement, the Big Action Garage is full of action. There's even a gas pump to keep cars on the go! We hope your child enjoys hours of fun with the Fisher-Price Big Action Garage™.

## Parts

- |                      |   |  |
|----------------------|---|--|
| 1 Base               | 11 Speed Ramp                                     | 20 Round Bottom Sign - 3                   |
| 2 Center Floor       | 12 Speed Jump                                     | 21 Gas Pump Sign (not shown)               |
| 3 Top Floor - 1      | 13 Speed Jump Lever                               | 22 Gas Pump Hose (not shown)               |
| 4 Elevator Tower - 2 | 14 Starting Gate                                  | 23 Storage Drawer (not shown)              |
| 5 Tower Roof         | 15 Starting Gate Pin                              | 24 Drawer Guide - 2 (not shown)            |
| 6 Elevator           | 16 Elevator Gate - 3 (not shown)                  | 25 Tow Truck                               |
| 7 Side Support       | 17 Entrance Gate                                  | 26 Car - 2                                 |
| 8 Spiral Ramp - 2    | 18 Top Floor (Narrow) Switching Gate (not shown)  | 27 HOT WHEELS™ Track Connector (not shown) |
| 9 Connector Tube     | 19 Center Floor (Wide) Switching Gate (not shown) |  |
| 10 Hill Ramp         |   |  |

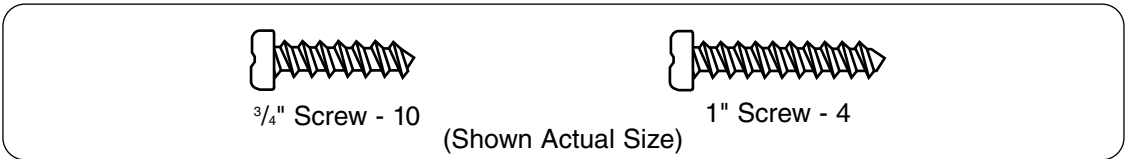

## Label Decoration

- Apply the labels as shown in the illustrations below.
- Make sure the areas where the labels will be applied are clean and dry.
- Apply the top corners of a label first and smooth downward to remove any air bubbles.
- For best adhesion, try to avoid applying a label more than once.

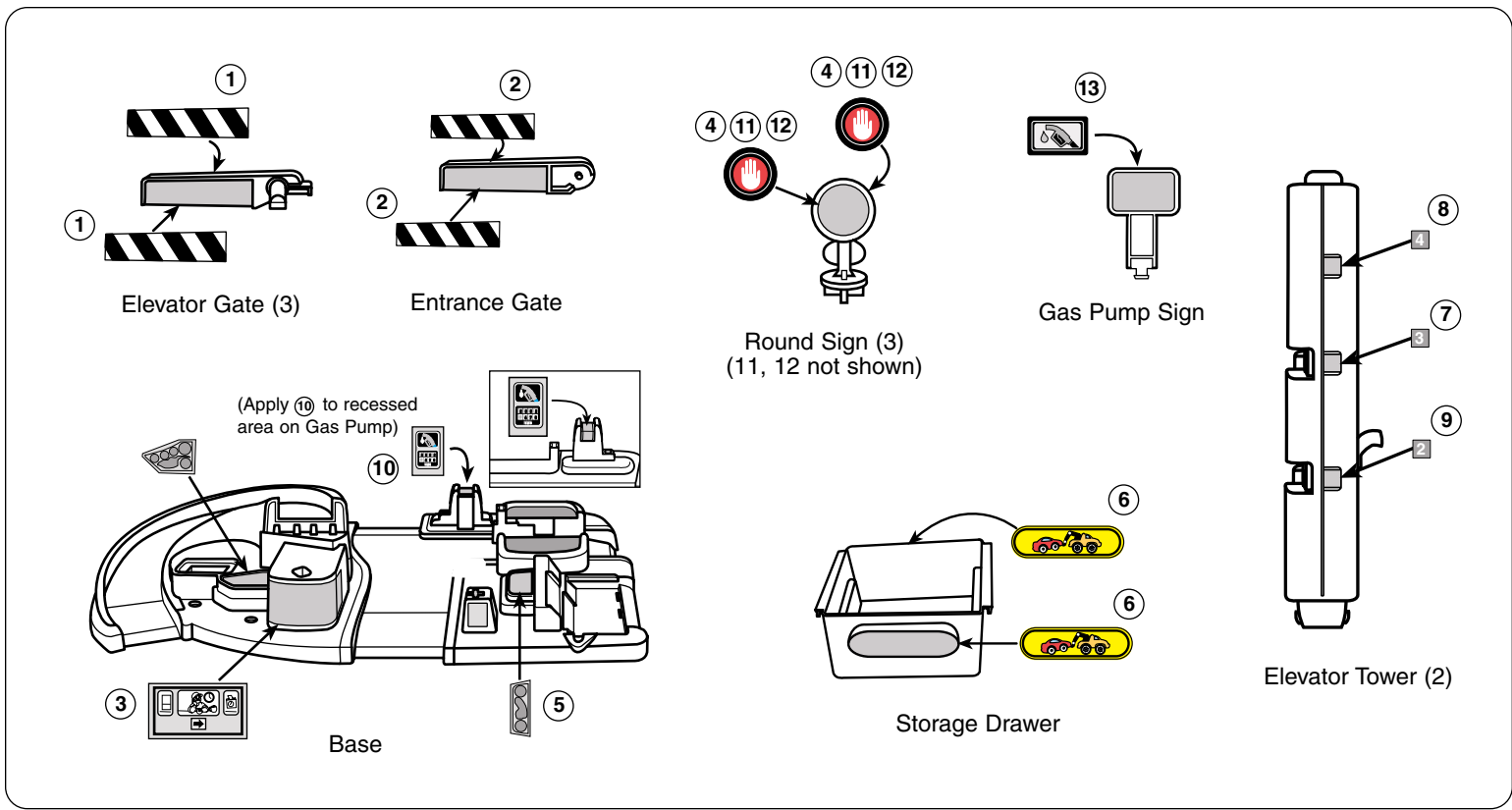

# Assembly

**IMPORTANT NOTE!** Please read these instructions carefully and follow the assembly steps in order. The Big Action Garage will not assemble correctly out of order and you may be unable to remove or disconnect parts to correct the assembly.

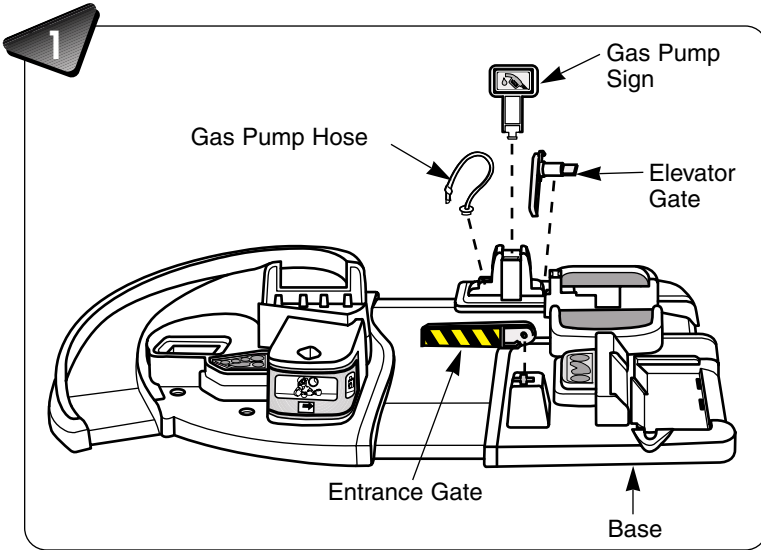

- Position the base on a flat surface.
- Firmly snap the entrance gate, an elevator gate, the gas pump sign and the gas pump hose into the base, as shown.
- Set the base aside.

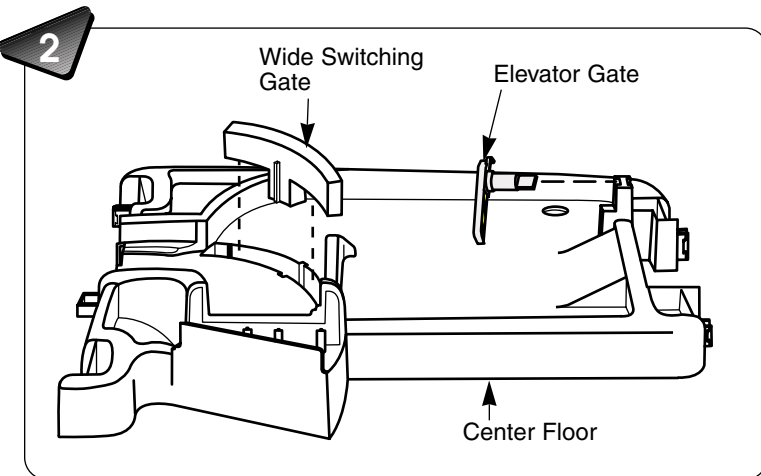

- Position the center floor on a flat surface.
- Firmly snap an elevator gate into the center floor, as shown.
- There are two switching gates. Separate the wide (center floor) switching gate from the narrow (top floor) switching gate.
- Insert the wide (center floor) switching gate into the recess in the center floor.
- Press down firmly on the wide switching gate so that it is fully inserted into the center floor.

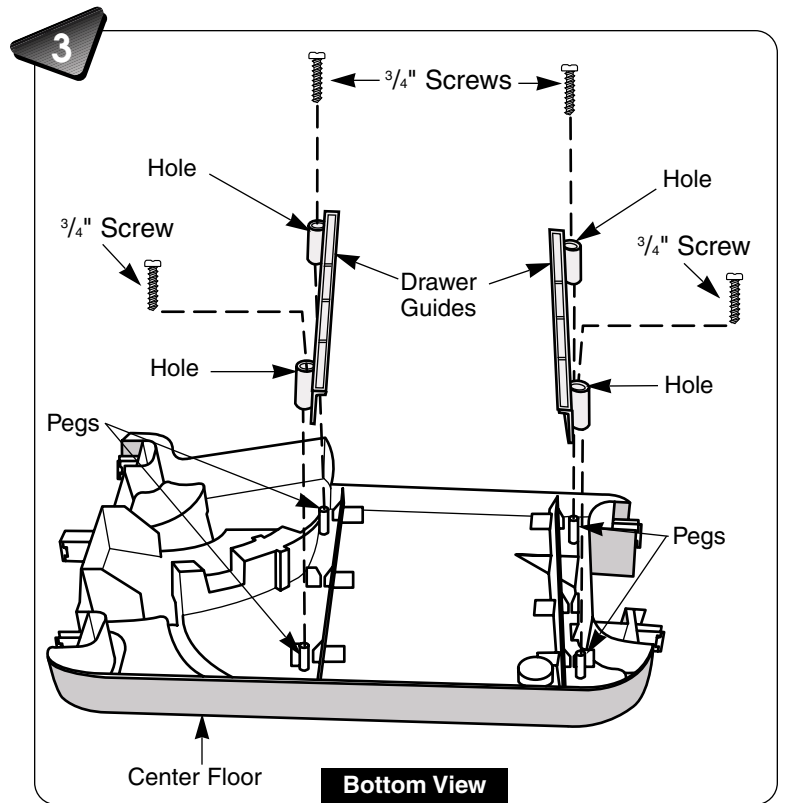

- Turn the center floor upside down.
- Fit the holes on the drawer guides onto the pegs on the bottom of the center floor. Make sure the drawer guides are pushed down fully.
- Insert a  $\frac{3}{4}$ " screw into each of the four holes in the drawer guides. Tighten the screws with a Phillips screwdriver. Do not over-tighten.
- Set the center floor aside.

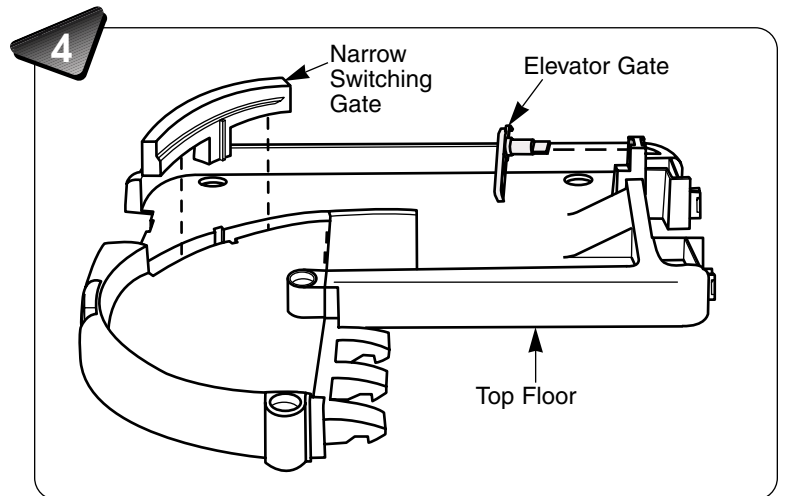

- Position the top floor on a flat surface.
- Firmly snap the elevator gate into the top floor, as shown.
- Insert the narrow (top floor) switching gate into the recess in the top floor.
- Press down firmly on the narrow switching gate so that it is fully inserted into the top floor.
- Set the top floor aside.

5

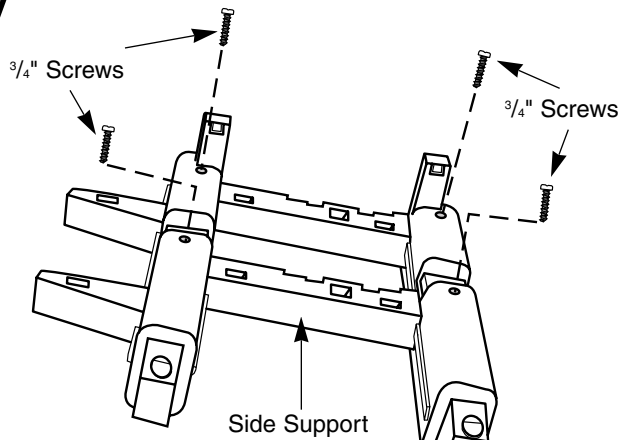

- Position the side support on a flat surface.
- Insert four  $\frac{3}{4}$ " screws into the side support. Tighten the screws with a Phillips screwdriver. Do not over-tighten.

6

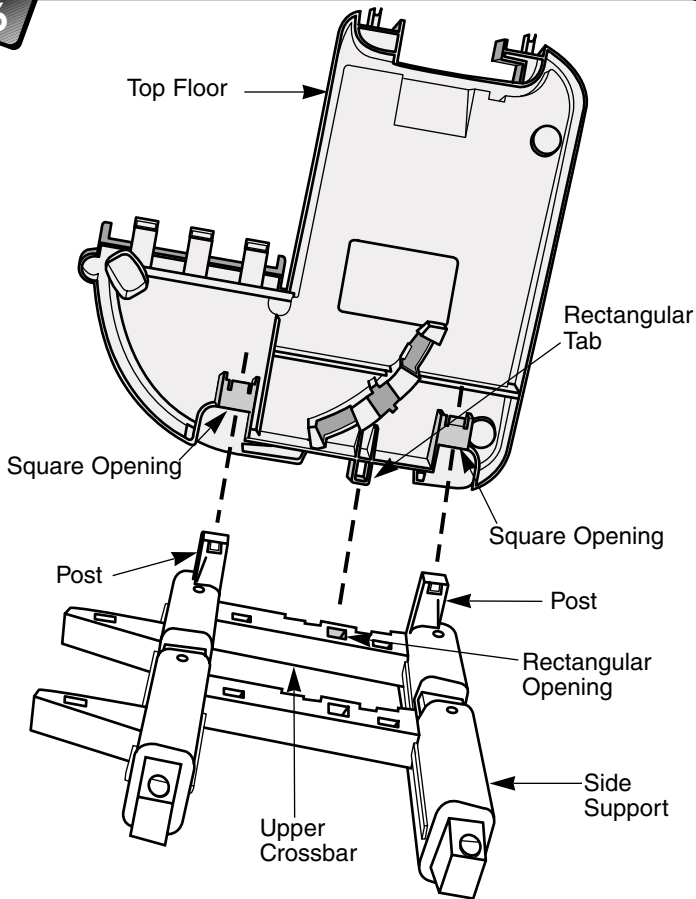

- Fit the square openings on the underside of the top floor onto the posts on the side support.
  - Make sure the rectangular tab on the top floor inserts into the rectangular opening on the side support upper crossbar.
  - Push down **firmly** on the top floor to snap it onto the side support.
- Helpful Hint:** You may need to push down near each of the posts and the tab to fully snap each one into the side support. You will hear a "click" when each post and the tab snaps into the side support.
- Pull up on the top floor to make sure it is secured to the side support.

7

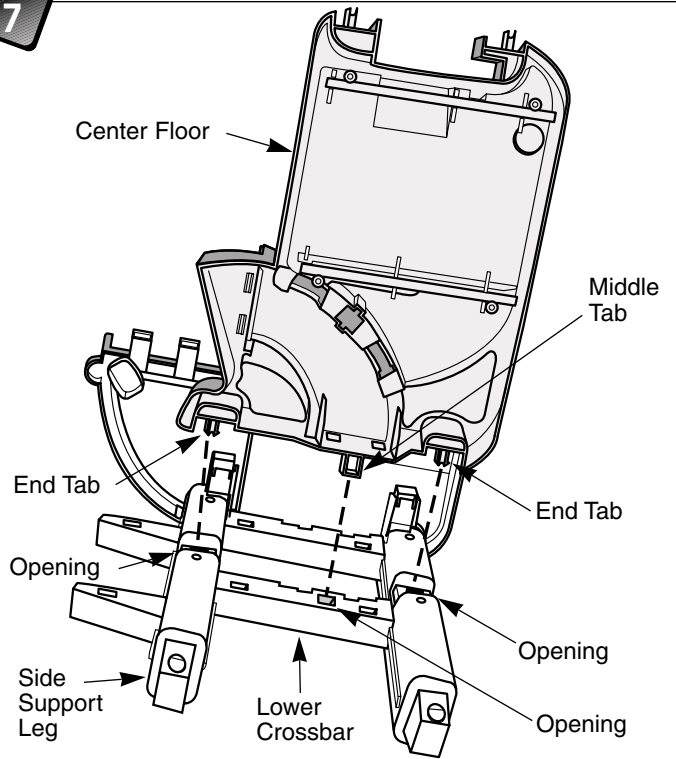

- Insert the middle tab on the center floor into the opening in the side support lower crossbar.
  - Insert the end tabs on the center floor into the openings in the side support legs.
  - Push down **firmly** on the center floor to snap it into the side support.
- Helpful Hint:** You may need to push down near each of the three tabs to snap each one into the side support. You will hear a "click" when each tab snaps into the side support.
- Pull up on the center floor to make sure it is secured to the side support.
  - Set the side support assembly aside.

8

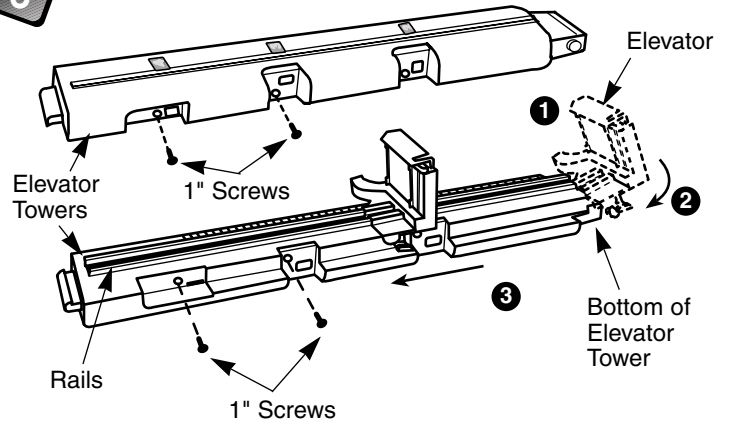

- Place the elevator tower with the rails on a flat surface, with the rails facing up.
- Place the other elevator tower on the flat surface, as shown.
- Insert two 1" screws into each elevator tower, as shown. Tighten the screws with a Phillips screwdriver. Do not over-tighten.
- With the elevator at an angle, fit the grooves in the elevator onto the rails at the bottom of the elevator tower **1**.
- Rotate the elevator down **2** to fully seat the grooves onto the elevator tower rails.
- Slide the elevator to the middle of the elevator tower **3**.

4

9

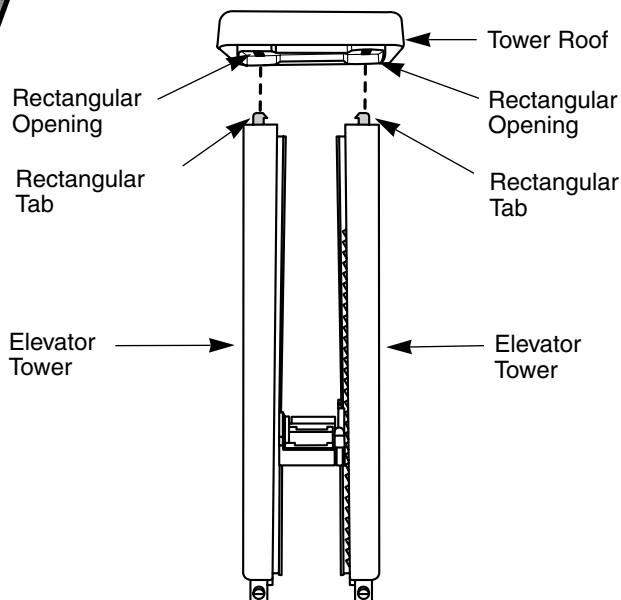

- Stand both elevator towers upright, as shown. The short, rectangular tabs are at the top of the elevator towers.
- Fit the tower roof onto the elevator towers.
- Push down firmly near each of the rectangular tabs to snap the tower roof onto the elevator towers. You will hear a “click” when each tab snaps into the tower roof.
- Pull up on the tower roof to make sure it is secured to the elevator towers.

10

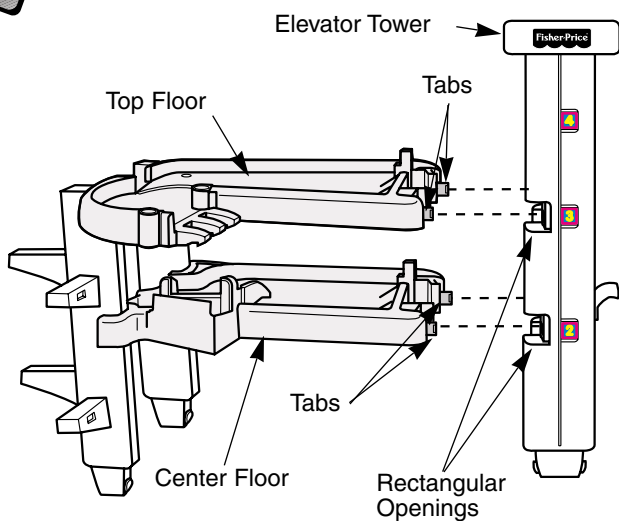

- Insert and firmly snap the tabs on the top and center floors into the rectangular openings in the sides of the elevator tower. You will hear a “click” when each tab snaps into the elevator tower.
- Pull on the elevator tower to make sure it is secured to the top and center floor.

11

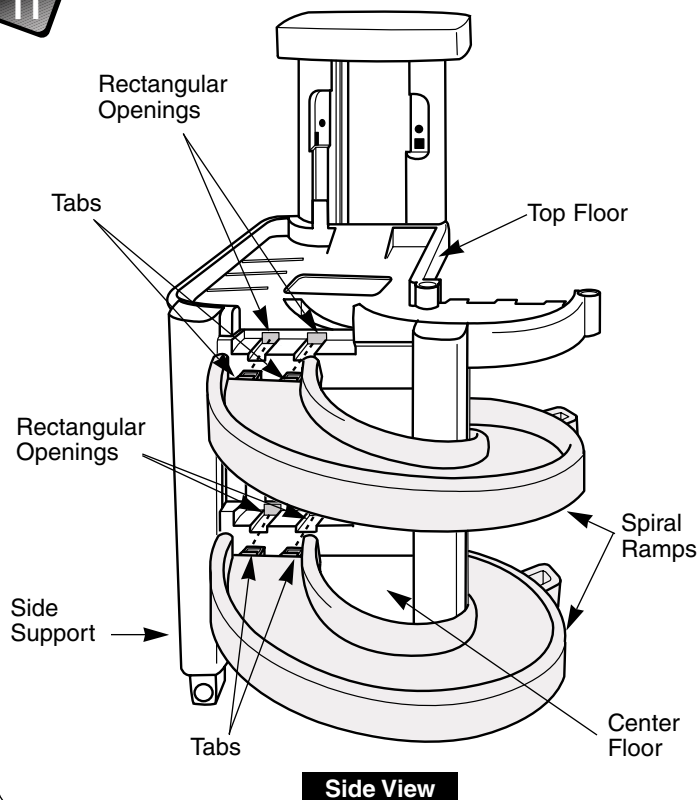

Side View

- Turn the assembly so that the side support faces you.
- Insert and firmly snap the tabs on the ends of a spiral ramp into the rectangular openings in the center floor.
- Insert and firmly snap the tabs on the ends of the other spiral ramp into the rectangular openings in the top floor.
- Pull on each spiral ramp to make sure it is secured to the top or center floor.

12

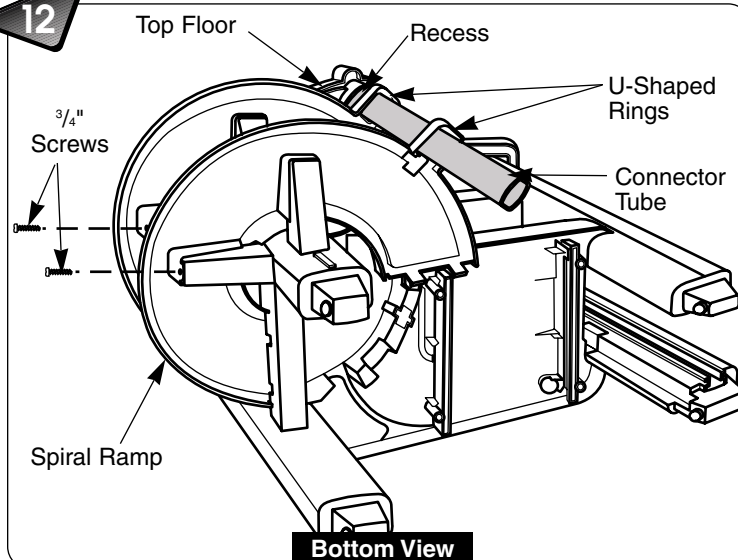

Bottom View

- Lay the assembly on its side with the bottom facing you.
- Insert the connector tube up through the U-shaped rings on the ends of the upper and lower spiral ramps.
- Insert the top of the connector tube into the recess in the top floor.
- Insert a  $\frac{3}{4}$ " screw through each spiral ramp and into the side support, as shown. Tighten the screws with a Phillips screwdriver. Do not over-tighten.
- Turn the assembly upright.

5



13

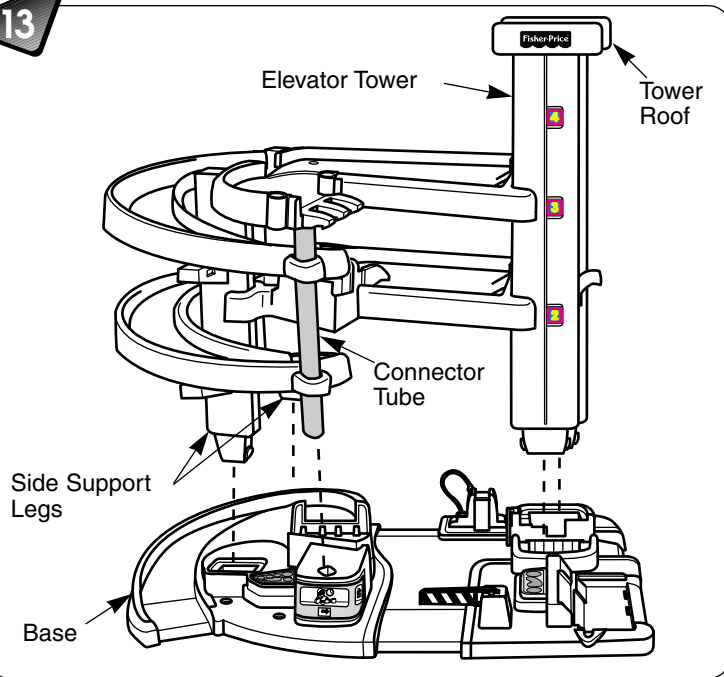

- Remove the instructional labels from the base and discard them.
- Position the ramp assembly over the base. Make sure the elevator tower, side support legs, and connector tube align with the recesses on the base, as shown.
- Push down **firmly** on the tower roof to snap the elevator tower into the base.
- Push down **firmly** on the top of each side support leg to snap the side support into the base.
- Pull up on the elevator tower and top floor to make sure the ramp assembly is secured to the base.

14

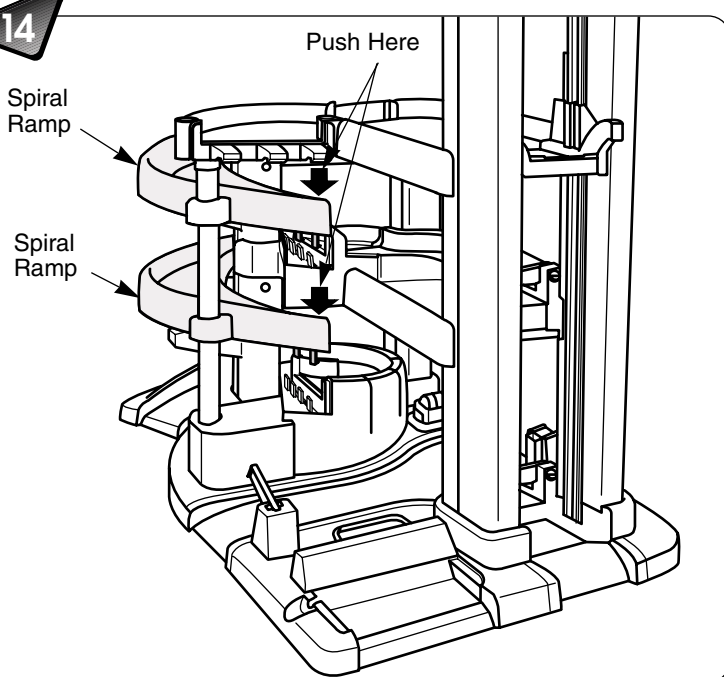

- Push down firmly at the base of the upper spiral ramp to snap it into the center floor.
- Push down firmly at the base of the lower spiral ramp to snap it into the base.

**Helpful Hint:** You will hear a “click” when each tab on the spiral ramps snaps into the center floor or base.

- Pull up on each spiral ramp to make sure it is secured to the garage floor.

15

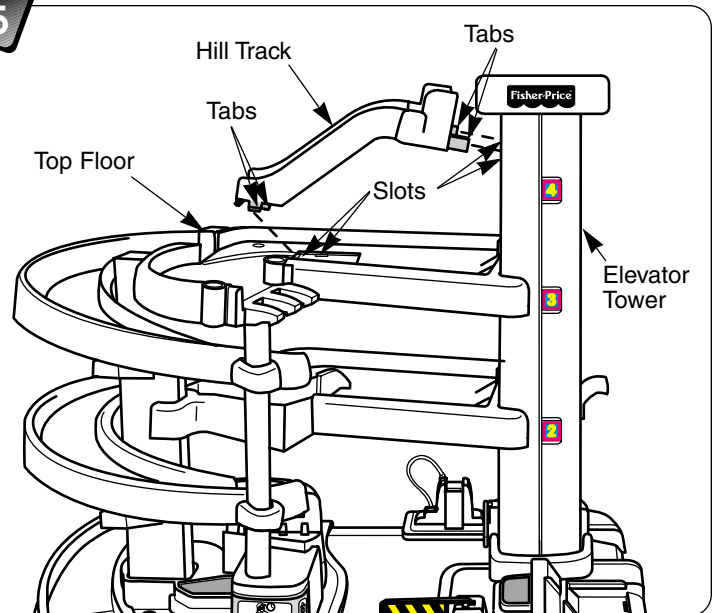

- Insert and firmly snap the tabs on the top of the hill track into the slots in the elevator tower. You will hear a “click” when each tab snaps into the elevator tower.
- Insert and firmly snap the tabs at the bottom of the hill ramp into the slots in the top floor. You will hear a “click” when each tab snaps into the top floor.
- Pull up on the hill track to make sure it is secured to the elevator tower and the top floor.

16A

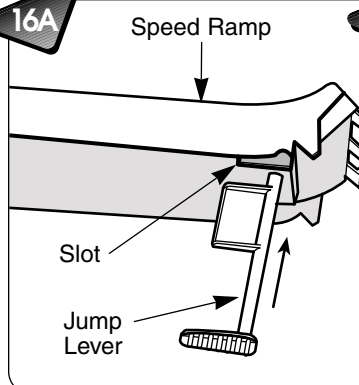

16B

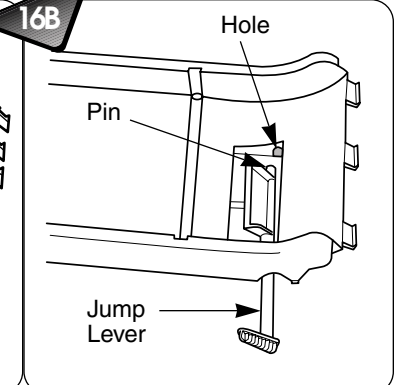

- Position the speed ramp so that the underside is facing you.
- Insert the jump lever up through the slot in the speed ramp, as shown 16A.
- Turn the speed ramp so that the top faces you.
- Insert the pin on the end of the jump lever into the hole in the speed ramp 16B.

17

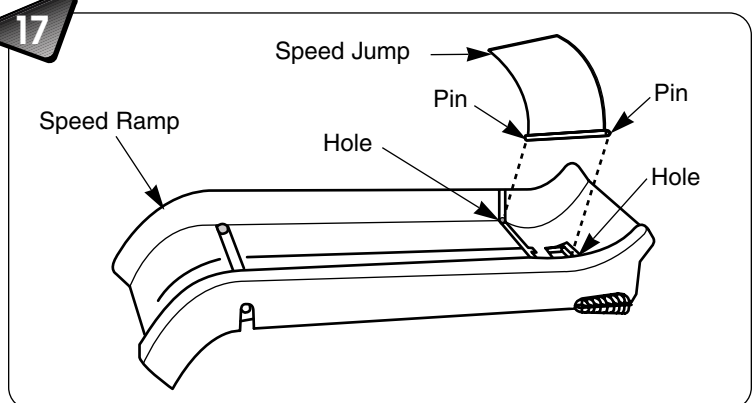

- Insert the pins on the sides of the speed jump into the holes in the sides of the speed ramp.

18

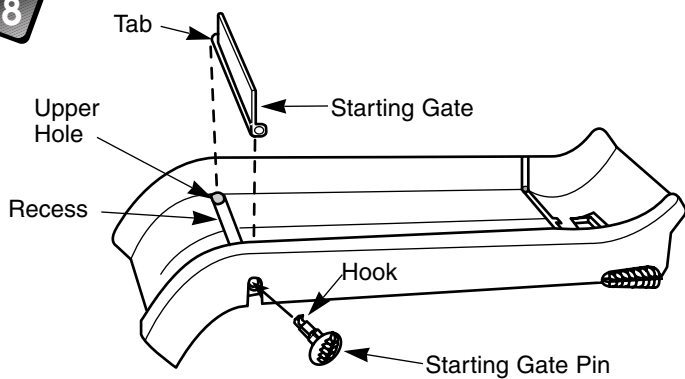

- Insert the tab on the end of the starting gate into the hole in the top of the speed ramp.
- Lower the starting gate into the recess on the speed ramp.
- Insert the starting gate pin through the side of the speed ramp and into the starting gate as shown. Make sure that the hook on the end of the starting gate pin is upward.
- Rotate the starting gate pin to lower the starting gate.

19

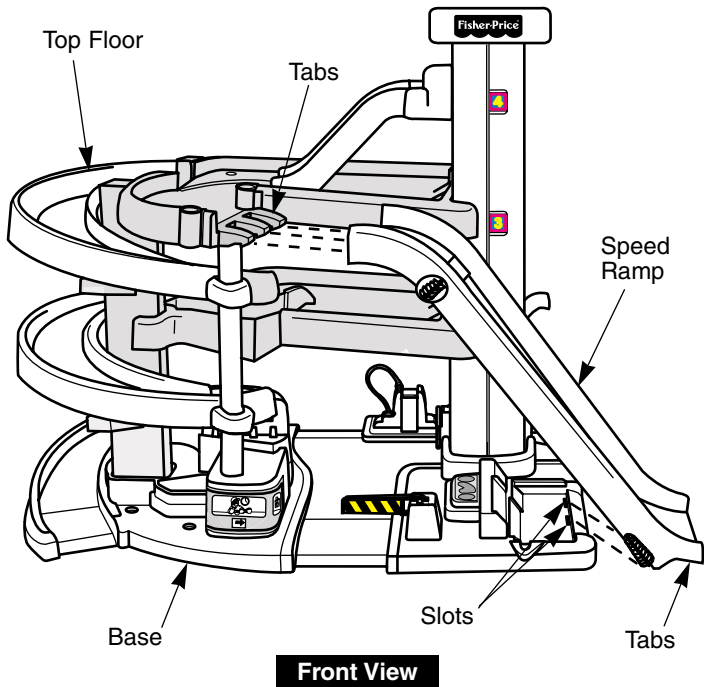

Front View

- Slide and firmly snap the speed ramp onto the tabs on the top floor.
- Insert and firmly snap the tabs on the bottom of the speed ramp into the slots on the base.
- Pull up on the speed ramp to make sure it is secured to the top floor and base.

20

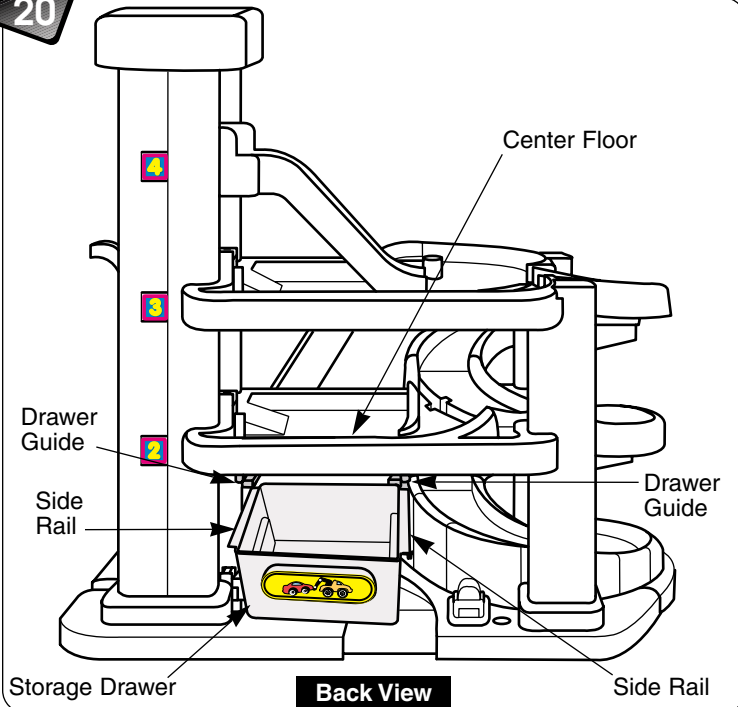

Back View

- Position the Big Action Garage so that the back of the garage faces you.
- Align the side rails on the storage drawer with the drawer guides on the underside of the center floor.
- Slide the storage drawer underneath the center floor.

## Features Elevator

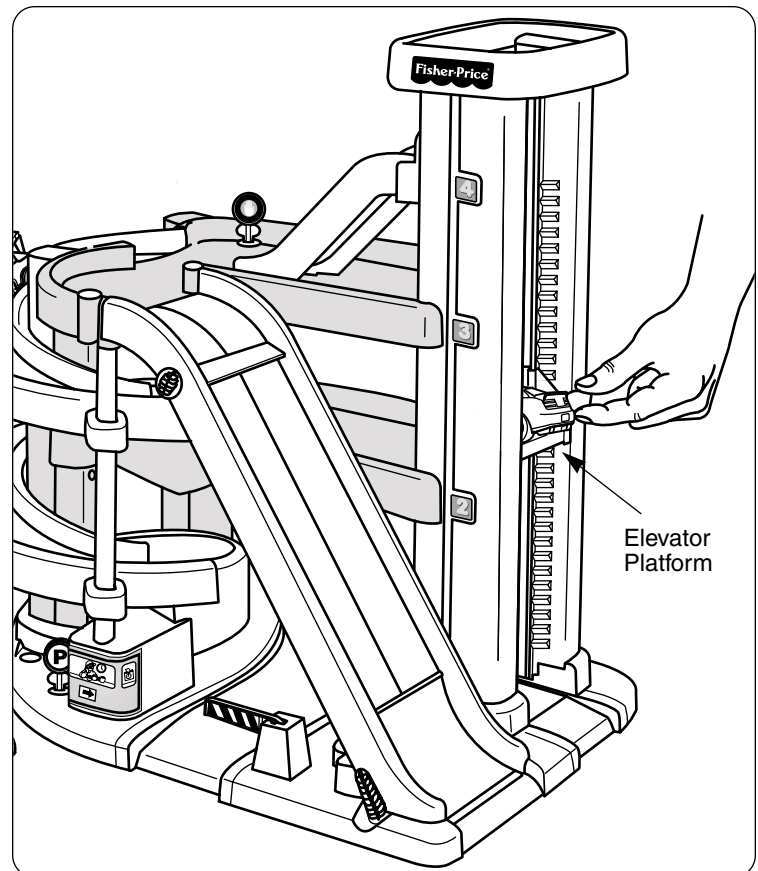

- Drive a vehicle onto the elevator platform and raise or lower the elevator to any of the four levels. The elevator gates will automatically open to let you drive through!

## Switching Gates

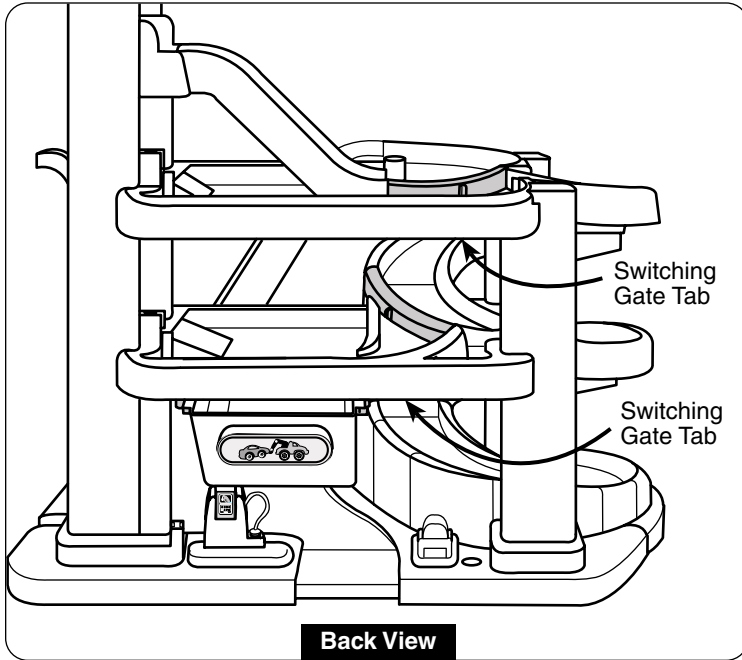

- To route traffic down the hill ramp and onto the speed ramp, raise the top floor switching gate by pushing up on the switching gate tab on the underside of the top floor.
- To detour vehicles to the center floor, keep the top and center floor switching gates lowered.
- To route traffic down both spiral ramps to the ground level, keep the top floor switching gate lowered and raise the center floor switching gate.

## Speed Ramp

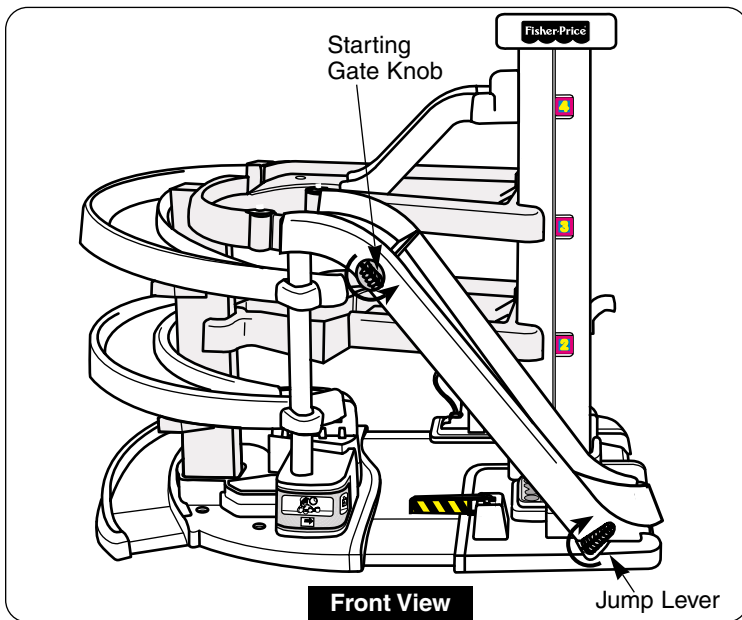

- Rotate the starting gate knob counter-clockwise to raise the speed ramp starting gate.
- Place one or two vehicles behind the starting gate and rotate the starting gate pin clockwise to lower the starting gate. Watch them race down the speed ramp!
- For added excitement, rotate the jump lever at the bottom of the speed ramp clockwise to raise the speed jump and watch the cars fly!

## Signs

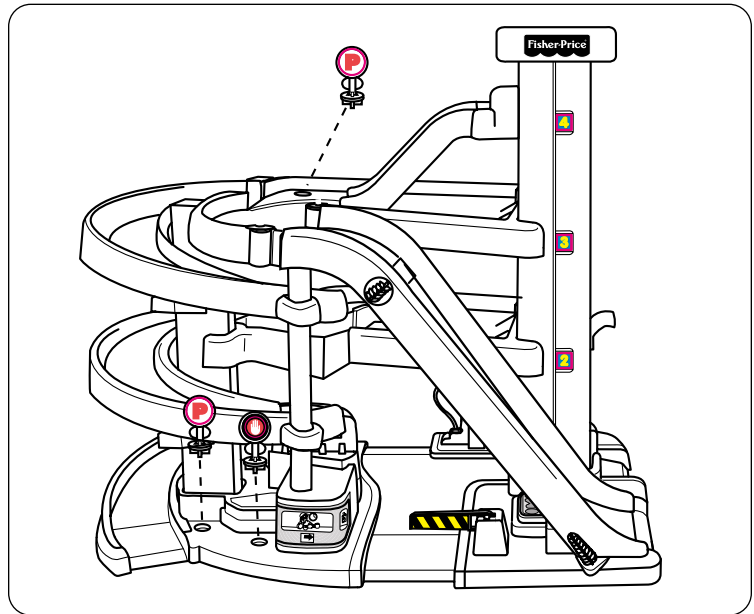

- Insert the round plugs on the bottom of the road signs into any of the round holes on the base, center or top floors.

## Connect to HOT WHEELS™ Race Track!

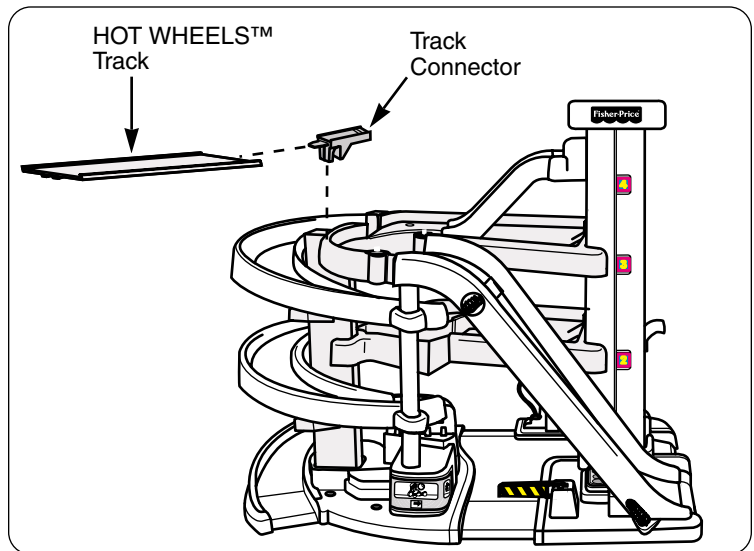

- Attach the HOT WHEELS™ Track Connector anyplace on the top or center floors to connect your own HOT WHEELS™ race track to the Big Action Garage.

HOT WHEELS™ and associated trademarks are owned and used under license from Mattel, Inc. © 1995 Mattel, Inc. All Rights Reserved.



Questions? We'd like to hear from you!

Call Fisher-Price Consumer Affairs, toll-free at **1-800-432-KIDS**, 8 AM - 6 PM EST Monday through Friday, 9 AM - 5 PM EST Saturday. Hearing-impaired consumers using TTY/TDD equipment, please call 1-800-382-7470.

Or, write to: Fisher-Price Consumer Affairs, 636 Girard Avenue, East Aurora, New York 14052.

If you have any questions about this product: **In Canada**, call **1-800-567-7724**, or write to: Mattel/Fisher-Price, 6155 Freemont Blvd., Mississauga, Ontario L5R 3W2.

**In Great Britain**, telephone 01734 770488. **In Australia**, call the Fisher-Price Australian Consumer Advisory Service toll-free at 1-800-800-812, or write to: Fisher-Price, Mattel Pty.Limited, 461 Plummer Street, Port Melbourne, Victoria 3207.