



# Consumer Information

- Please keep this instruction sheet for future reference, as it contains important information.
- Requires three "C" (LR14) **alkaline** batteries (not included).
- Adult assembly is required.
- Tool needed for assembly: Phillips screwdriver (not included).

## CONSUMER ASSISTANCE

Call toll free: 1-800-432-5437 (US & Canada only)  
M-F 9AM to 7PM / SAT 11AM to 5PM (EST)

**service.fisher-price.com**

Write to us at: Fisher-Price® Consumer Relations,  
636 Girard Avenue, East Aurora, New York 14052.

Hearing-impaired consumers using TTY/TDD equipment,  
please call 1-800-382-7470.

---

For countries outside the United States:

Canada: Mattel Canada Inc., 6155 Freemont Blvd.,  
Mississauga, Ontario L5R 3W2; [www.service.mattel.com](http://www.service.mattel.com).

Great Britain: [Mattel UK Ltd. Vanwall Business Park,  
Maidenhead SL6 4UB, Helpline: 01628 500303,  
www.service.mattel.com/uk](http://www.service.mattel.com/uk)

Australia: Mattel Australia Pty. Ltd., 658 Church Street,  
Locked Bag #870, Richmond, Victoria 3121 Australia.  
Consumer Advisory Service 1300 135 312.

New Zealand: 16-18 William Pickering Drive,  
Albany 1331, Auckland.

Asia: Mattel East Asia Ltd, Room 1106, South Tower,  
World Finance Centre, Harbour City, Tsimshatsui, HK, China.

## Fasteners

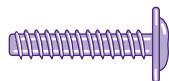

#8 x 3/4" (1.9 cm)  
Washerhead Screw – 10



#8 x 3/4" (1.9 cm) Screw – 10



#6 x 1/2" (1.3 cm) Screw – 4

All Shown Actual Size

**Note:** Tighten and loosen all screws with a Phillips screwdriver. Do not over-tighten.

## Parts



Keyboard



Desktop



2 Legs

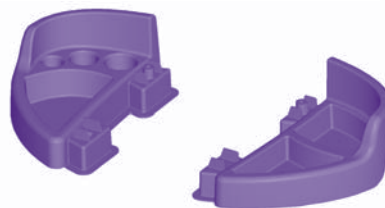

2 Storage Bins

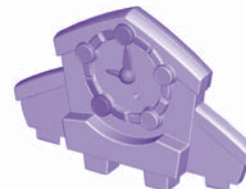

Clock



Shelf



2 Retainers



2 Feet

# Battery Installation

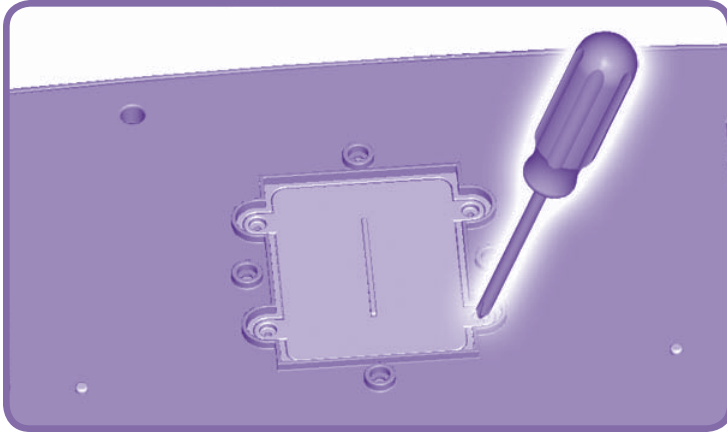

**Note:** We recommend using **alkaline** batteries for longer battery life.

- Locate the battery compartment on the underside of the keyboard.
- Loosen the screws in the battery compartment door. Remove the battery compartment door.
- Insert three "C" (LR14) **alkaline** batteries.
- Replace the battery compartment door and tighten the screws.
- When sounds or lights from this toy become faint or stop, it's time for an adult to change the batteries!



- Protect the environment by not disposing of this product with household waste (2002/96/EC). Check your local authority for recycling advice and facilities (Europe only).

# Battery Safety Information

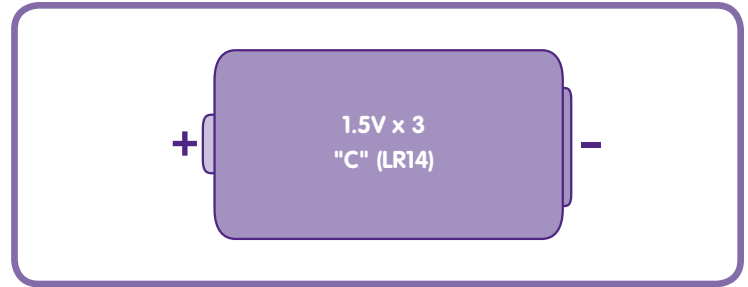

**In exceptional circumstances, batteries may leak fluids that can cause a chemical burn injury or ruin your product. To avoid battery leakage:**

- Do not mix old and new batteries or batteries of different types: alkaline, standard (carbon-zinc) or rechargeable (nickel-cadmium).
- Insert batteries as indicated inside the battery compartment.
- Remove batteries during long periods of non-use. Always remove exhausted batteries from the product. Dispose of batteries safely. Do not dispose of this product in a fire. The batteries inside may explode or leak.
- Never short-circuit the battery terminals.
- Use only batteries of the same or equivalent type, as recommended.
- Do not charge non-rechargeable batteries.
- Remove rechargeable batteries from the product before charging.
- If removable, rechargeable batteries are used, they are only to be charged under adult supervision.

# FCC Statement

## (United States Only)

This equipment has been tested and found to comply with the limits for a Class B digital device, pursuant to Part 15 of the FCC Rules. These limits are designed to provide reasonable protection against harmful interference in a residential installation. This equipment generates, uses and can radiate radio frequency energy and, if not installed and used in accordance with the instructions, may cause harmful interference to radio communications. However, there is no guarantee that interference will not occur in a particular installation. If this equipment does cause harmful interference to radio or television reception, which can be determined by turning the equipment off and on, the user is encouraged to try to correct the interference by one or more of the following measures:

- Reorient or relocate the receiving antenna.
- Increase the separation between the equipment and receiver.
- Consult the dealer or an experienced radio/TV technician for help.

Note: Changes or modifications not expressly approved by the manufacturer responsible for compliance could void the user's authority to operate the equipment.

# Care

- Wipe this toy with a clean cloth dampened with a mild soap and water solution. Do not immerse this toy.
- This toy has no consumer serviceable parts. Do not take this toy apart.

# Assembly

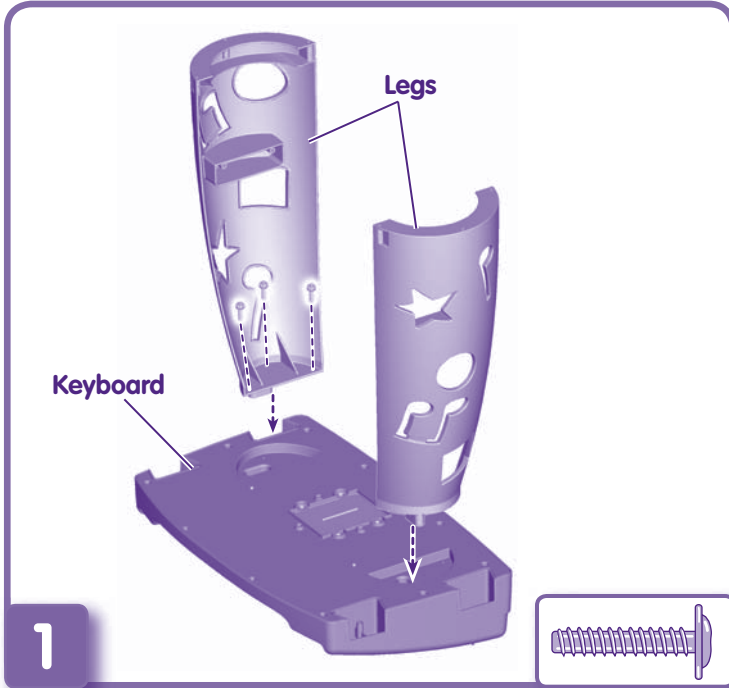

- Place the keyboard face down on a flat surface.
  - Fit the legs into the keyboard.
- Hint:** The legs are designed to fit one way.
- Insert three #8 x 3/4" (1.9 cm) washerhead screws into each leg and tighten.

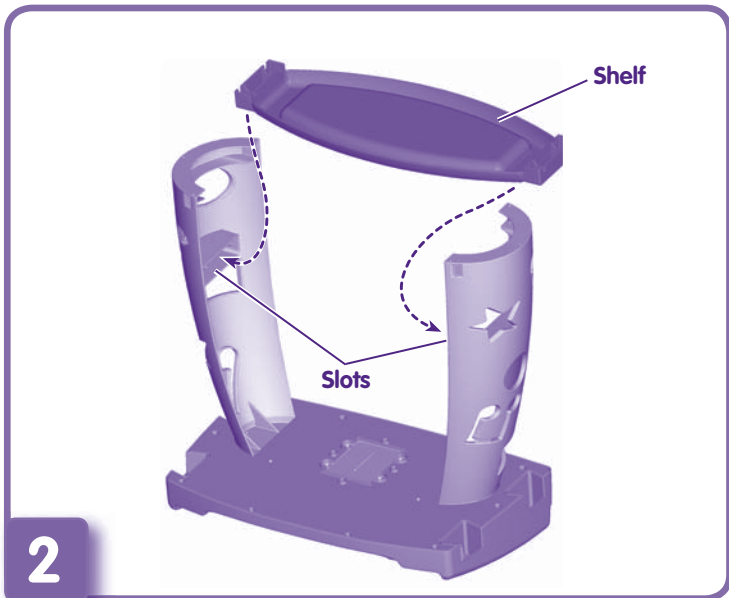

- Position the shelf.
- Fit the ends of the shelf into the slot in each leg.

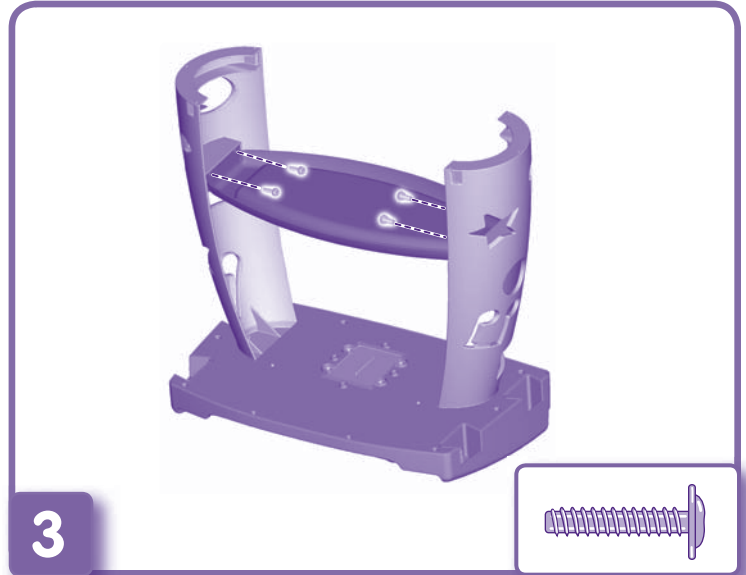

- Insert two #8 x 3/4" (1.9 cm) washerhead screws into each end of the shelf and tighten.

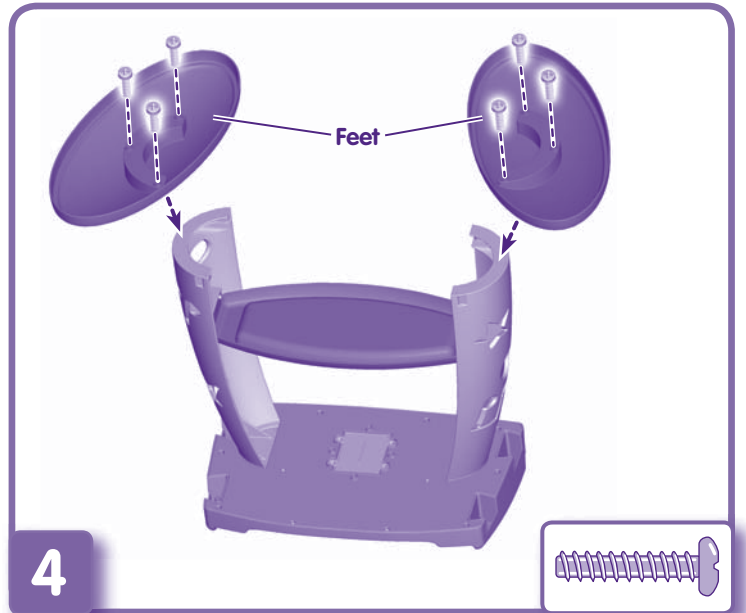

- Fit a foot onto each leg.
- Hint:** The feet are designed to fit one way.
- Insert three #8 x 3/4" (1.9 cm) screws into each foot and tighten.

# Assembly

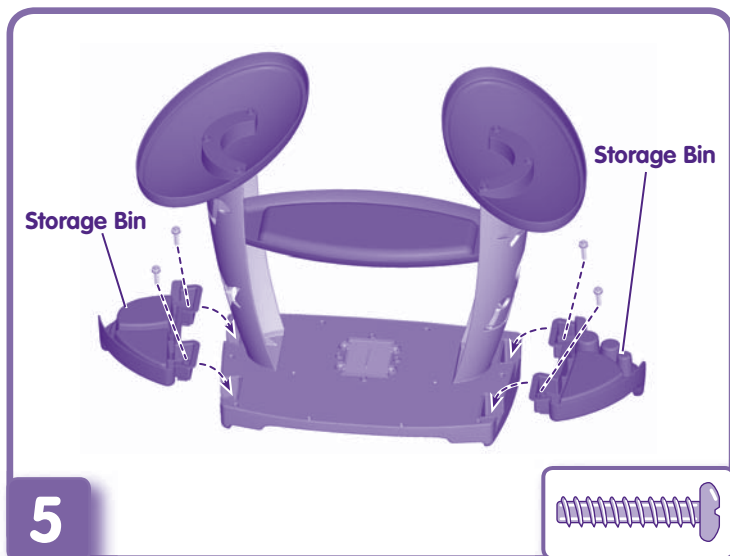

- 5**
- Fit a storage bin to the grooves on each side of the keyboard.
- Hint:** The storage bins are designed to fit one way.
- Insert two #8 x 3/4" (1.9 cm) screws into each storage bin and tighten.

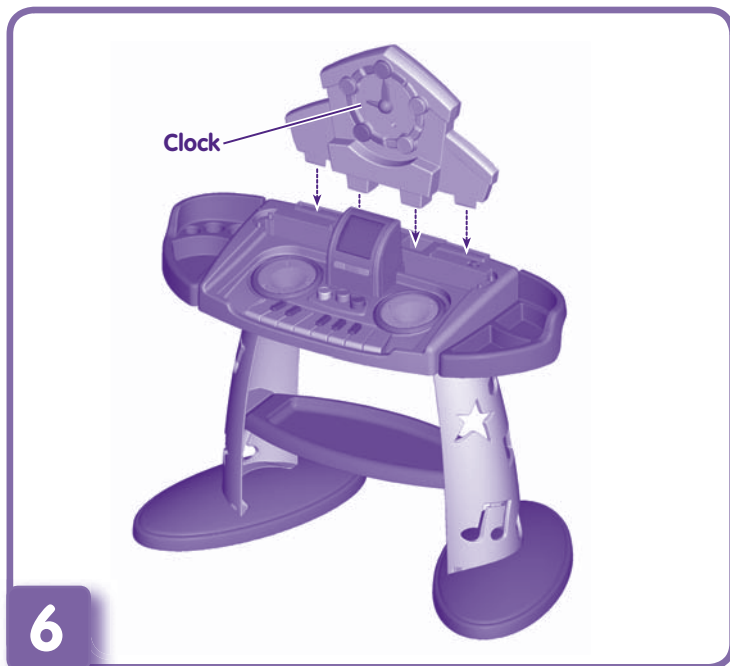

- 6**
- Turn the assembly upright.
  - **"Snap"** the clock into the slots in the top side of the assembly.

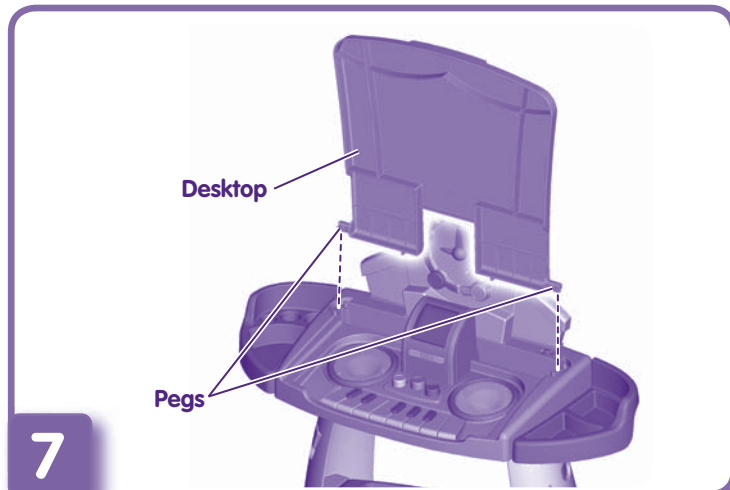

- 7**
- Fit the pegs on the desktop into the slots in the top side of the assembly.



- 8**
- Fit a retainer over each desktop peg.
  - Insert two #6 x 1/2" (1.3 cm) screws into each retainer and tighten.
  - Lift and lower the desktop.

# Decoration

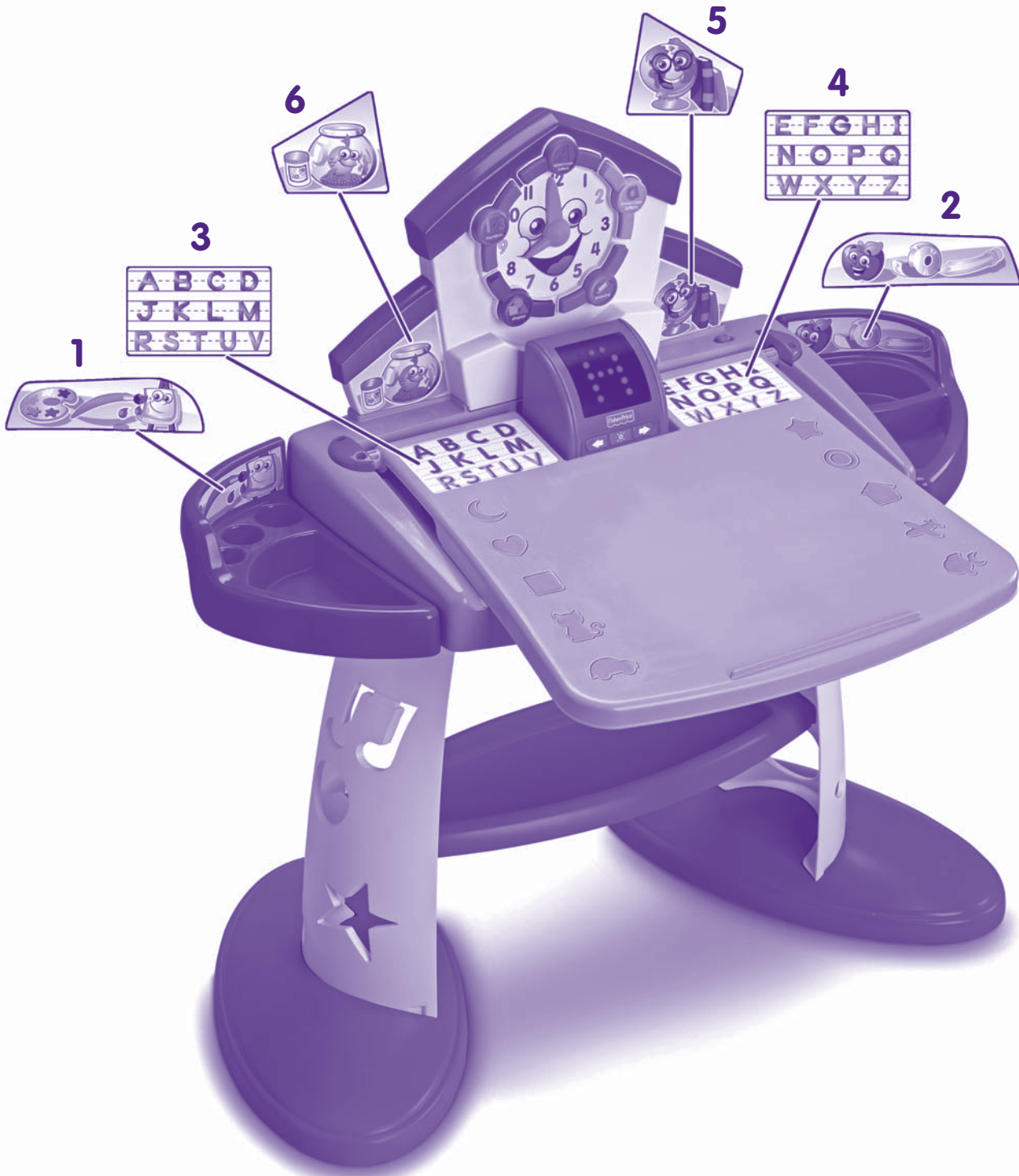





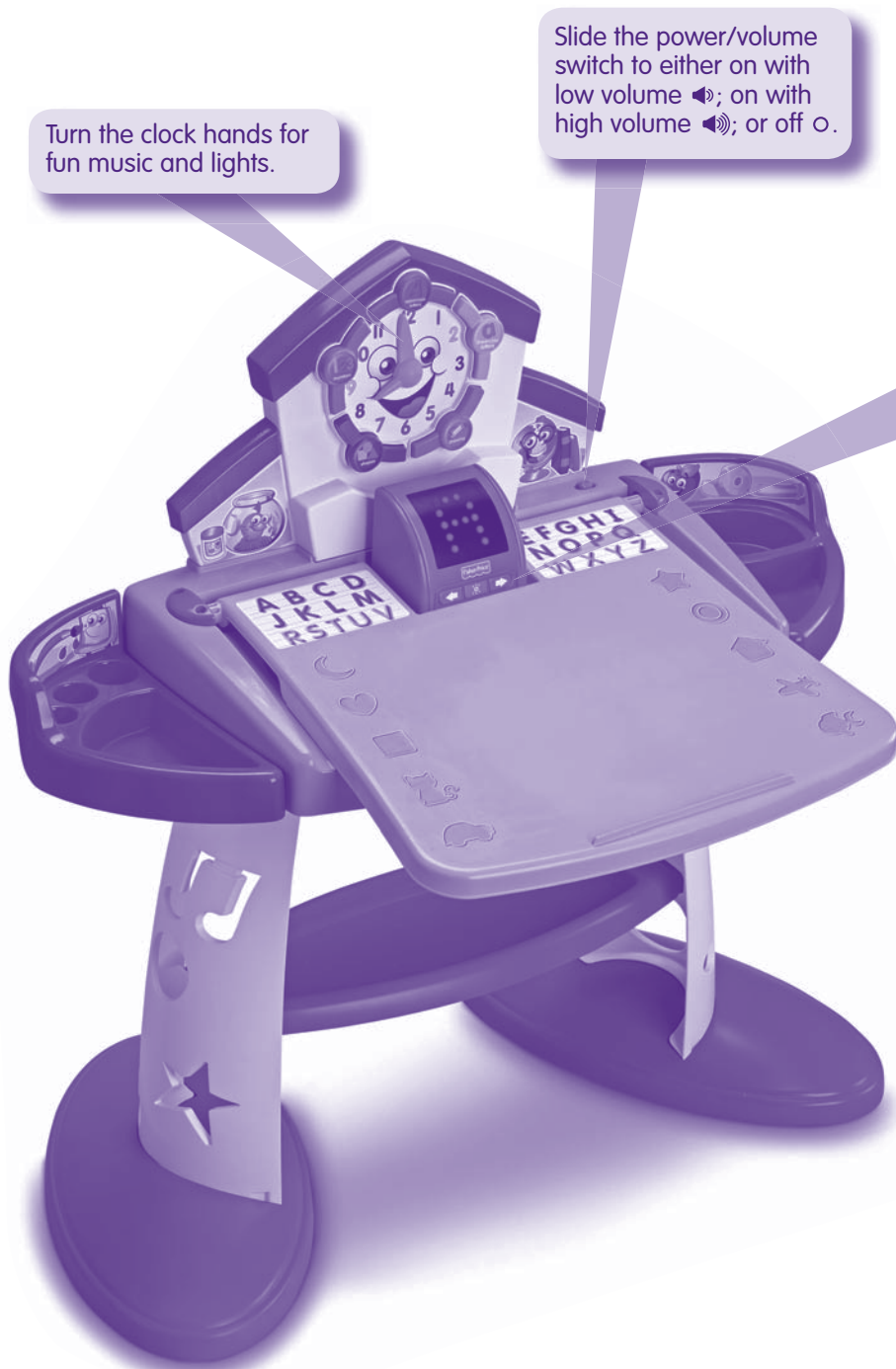

# It's Fun to Learn!

Lift and lower the desktop to learn upper and lower case letters, numbers, shapes and how to draw.



Turn the clock hands for fun music and lights.

Slide the power/volume switch to either on with low volume ; on with high volume ; or off .

Use the arrow buttons   to scroll through letters, numbers, objects and shapes. Press the select button  to choose it.



## Uppercase Letters

Press to learn words that begin with the letter chosen and how to write that letter.



## Drawing

Press to learn how to draw objects. The display screen shows how.



## Numbers

Press to learn numbers and how to write them.



## Shapes

Press to learn shapes and how to draw them.



## Lowercase Letters

Press to learn words that begin with the letter chosen and how to write that letter.

# Lets Make Some Music!

Raise the desktop for musical fun and activities.



## Songs and Dancing

Press to hear different "get-up-and-move" songs along with dancing lights! Play-along on the keyboard or the "drums."



## Instrument Select

Press to choose an instrument: piano, guitar, trumpet or flute. Press the keys on the keyboard to hear the sound of the instrument chosen. You can also choose silly sound effects or animal sounds.



## Keep the Beat

When the "drums" light up, tap them before the lights go out.