

For product sold in USA.
This device complies with Part 15 of the FCC Rules.
Operation is subject to the following two conditions: (1) This device may not cause harmful interference, and (2) this device must accept any interference received, including interference that may cause undesired operation.

- This equipment has been tested and found to comply with the limits for a Class B digital device, pursuant to part 15 of the FCC rules. These limits are designed to provide reasonable protection against harmful interference in a residential installation. This equipment generates, uses and can radiate radio frequency energy and, if not installed and used in accordance with the instructions, may cause harmful interference to radio communications. However, there is no guarantee that interference will not occur in a particular installation. If this equipment does cause harmful interference to radio or television reception, which can be determined by turning the equipment off and on, the user is encouraged to try to correct the interference by one or more of the following measures:
- Reorient or relocate the receiving antenna.
- Increase the separation between the equipment and receiver.
- Connect the equipment into an outlet on a circuit different from that to which the receiver is connected.
- Consult the dealer or an experienced radio/TV technician for help.

NOTE: Changes or modifications not expressly approved by the manufacturer responsible for compliance could void the user's authority to operate the equipment.

2010 Mattel, Inc. All Rights Reserved. MATTEL and associated trademarks and trade dress are owned by Mattel, Inc. ® and ™ designate U.S. trademarks of Mattel, Inc., except as noted. **MADE IN CHINA.** Manufactured for Mattel, Consumer Relations - Mattel, Inc., 636 Girard Avenue, East Aurora, NY 14052, U.S.A. Consumer Relations 1-800-524-8697, Mattel U.K. Ltd., Vanwall Business Park, Maidenhead SL6 4UB. Helpline 01628 500303. Mattel Australia Pty., Ltd., Richmond, Victoria. 3121. Consumer Advisory Service - 1300 135 312. Mattel East Asia Ltd., Room 1106, South Tower, World Finance Centre, Harbour City, Tsimshatsui, HK, China. Diimport & Diedarkan Oleh: Mattel SEA Ptd Ltd.(993532-P) Lot 13.5, 13th Floor, Menara Lien Hoe, Persiaran Tropicana Golf Country Resort, 47410 PJ. Tel:03-78803817, Fax:03-78803867.



PKE METER USER MANUAL

ADULT
COLLECTOR

Please keep these instructions for future reference
as they contain important information.

Back cover/Page 8

Front cover/Page 1



WARNING!
IMPROPER USE OF THIS DEVICE
COULD LEAD TO OPENING A
PORTAL TO A PARALLEL
DIMENSION OR, IN SOME CASES,
A SERIOUS RASH.

Dear Ghostbuster™-in-training,

**No. This is not a shoe polisher. It is in fact a
device used to locate and measure
Psycho-Kinetic Energy.**

**Armed with a PKE Meter, you'll never
again find yourself walking into an old
apartment building or library basement
unprepared. That and it feels so good to
hold one in your hand and say, "Back off,
man. I'm a scientist!"**

**Have fun and remember we're here to
believe you.**

Venkman, Inc.

INSTRUCTION SHEET SPECIFICATIONS	
Toy:	WWE TRIPLE H FLEXFORCE BIG TALKER
Toy No.:	R6262
Part No.:	0920
Trim Size:	5.5"x7"
Folded Size:	5.5"x3.5"
Type of Fold:	
# colors:	One
Colors:	Black
Paper Stock:	White Offset
Paper Weight:	70 lb.
EDM No.:	

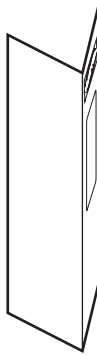

Page 2

Page 3

PKE Meter Buttons

1. Press L1 or L2 and wings will extend fully. [This indicates a ghost is right in front of you – either let it rip with your Proton Pack or run away!]
2. Press R1 or R2 and wings will extend half way. [This indicates a ghost is in the vicinity.]
3. Turn dial to left for slower lights and beeps. [Slower paced lights and beeps indicate there are low levels of Psycho-Kinetic Energy in the area.]
4. Turn dial to the right for faster lights and beeps. [Faster lights and beeps indicate psycho-kinetic activity is nearby. Proceed with caution and in no circumstances scream, "Get her!"]
5. When the Display Switch is in the left position, Display Sequence # 1 is activated.
6. When the Display Switch is in the right position, Display Sequence # 2 is activated.

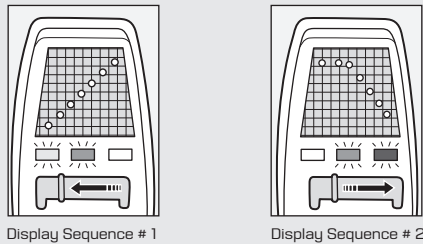

7. When the Display Switch is in the middle position, the display will turn off.
8. Press and hold L1 and R1 together for 3 seconds to mute sound. Press and hold again for another 3 seconds to reactivate sound.
9. Press and hold L2 and R2 together for 3 seconds to switch light sequence on display and wings between Ghostbusters™ I and Ghostbusters™ II modes.

[2]

10. When the PKE Meter is left idle for 75 seconds, it will automatically go into sleep mode to save energy. Press any button to reactivate the device.

**WARNING! Inappropriate scanning of the opposite sex
may result in personal injury. Proceed at your own
peril.**

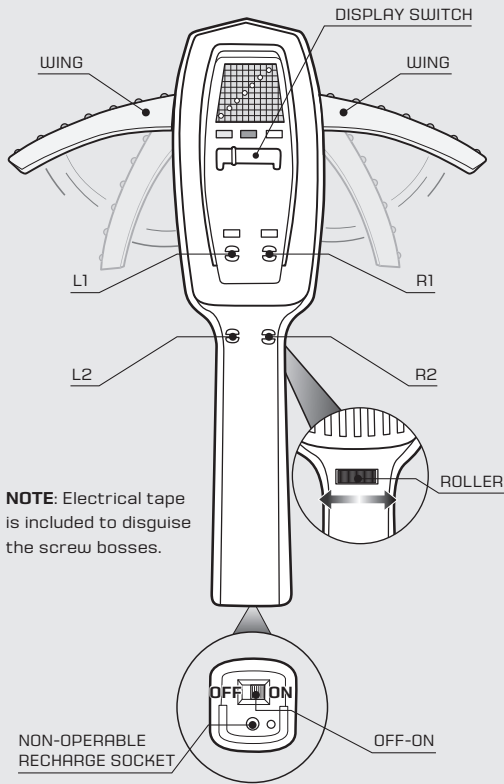

NOTE: Electrical tape
is included to disguise
the screw bosses.

[3]

Page 5

ADULTS NOTE: Batteries included are for demonstration purposes only. For longer life, use alkaline batteries.

Battery Replacement

1. Unscrew the battery cover with a Phillips head screwdriver (not included).
2. Remove batteries for demonstration purposes and dispose of them properly.
3. Install 3 new AAA alkaline batteries in the orientation (+/-) shown.
4. Replace battery cover and tighten screws.

NOTE:

- Replace batteries when sound becomes distorted or the toy does not respond.
- When exposed to an electrostatic source, the product may malfunction. To resume normal operation, remove and re-install the batteries.

Battery safety information

In exceptional circumstances batteries may leak fluids that can cause a chemical burn injury or ruin your product. To avoid battery leakage:

- Non-rechargeable batteries are not to be recharged.
- Rechargeable batteries are to be removed from the product before being charged (if designed to be removable).
- Rechargeable batteries are only to be charged under adult supervision (if designed to be removable).
- Do not mix alkaline, standard (carbon-zinc), or rechargeable (nickel-cadmium) batteries.
- Do not mix old and new batteries.
- Only batteries of the same or equivalent type as recommended are to be used.
- Batteries are to be inserted with the correct polarity.
- Exhausted batteries are to be removed from the product.

[4]

Page 6

- The supply terminals are not to be short-circuited.
- Dispose of battery(ies) safely.
- Do not dispose of this product in a fire. The batteries inside may explode or leak.

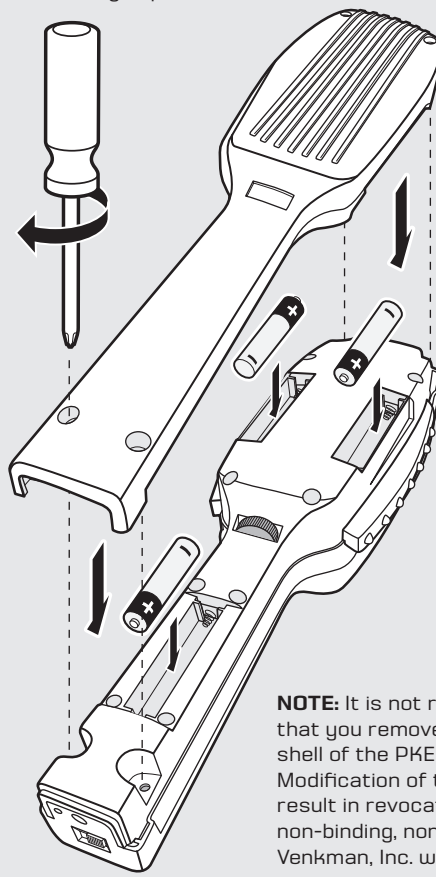

NOTE: It is not recommended
that you remove the inner
shell of the PKE Meter.
Modification of the device will
result in revocation of your
non-binding, non-existent
Venkman, Inc. warranty.

[5]

Page 7