

Barbie Grand Hotel™

INSTRUCTIONS



Please remove everything from the package and compare to the contents shown here.
If any items are missing, please call 1-800-524-TOYS.

Requires 3 "AA" alkaline batteries, not included.

Colors and decorations may vary.

Keep these instructions for future reference as they contain important information.

29248-0920-G1

© 2000 Mattel, Inc., El Segundo, CA 90245 U.S.A. All Rights Reserved.
Mattel U.K. Ltd., Vanwall Business Park, Maidenhead SL6 4UB. Helpline 01628500303.

Mattel Australia Pty Ltd., Richmond, Victoria. 3121.

Consumer Advisory Service 1 800 800 812 (valid only in Australia).



Unfold the Barbie Grand Hotel™

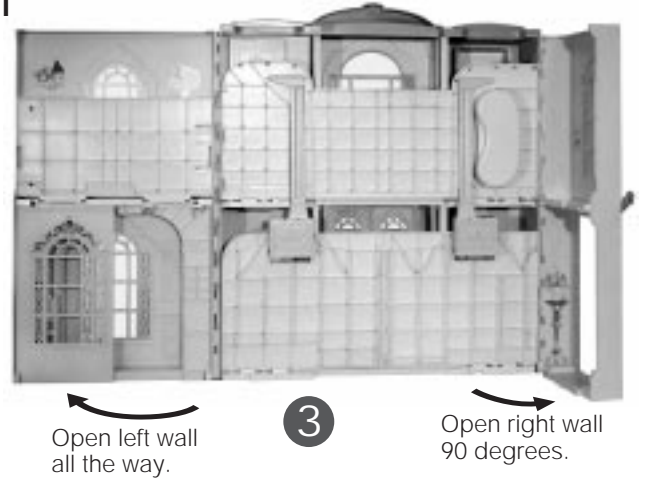
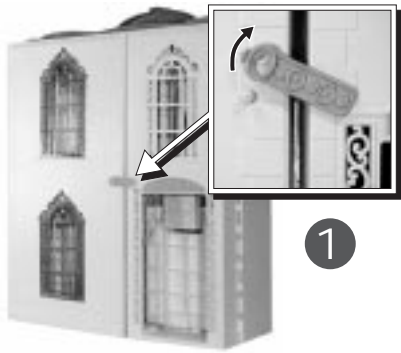

Open left wall all the way.

Open right wall 90 degrees.

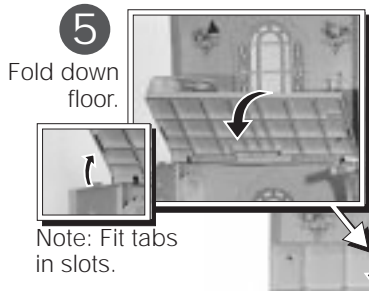

Fold down floor.



Note: Fit tabs in slots.



6

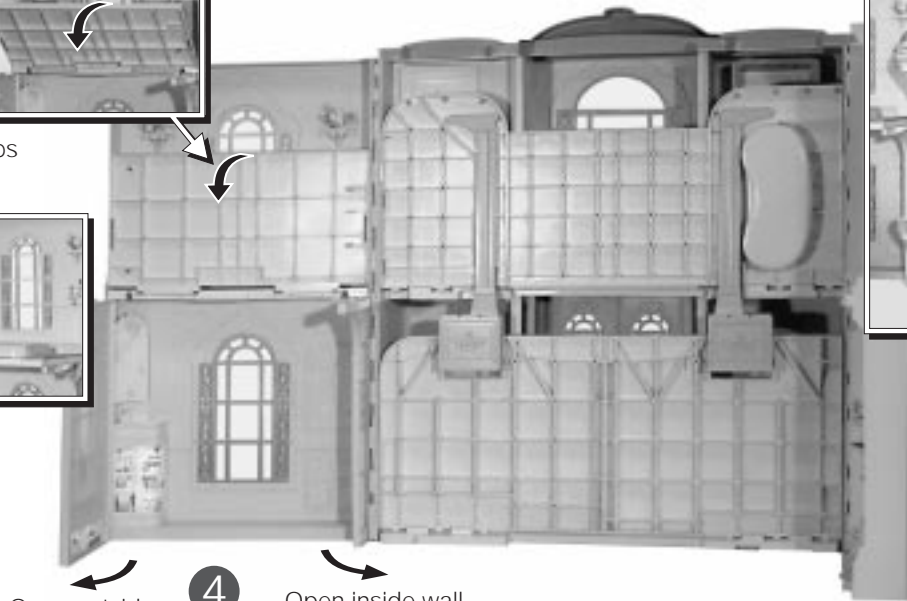

4

Open outside left wall.

Open inside wall 90 degrees.

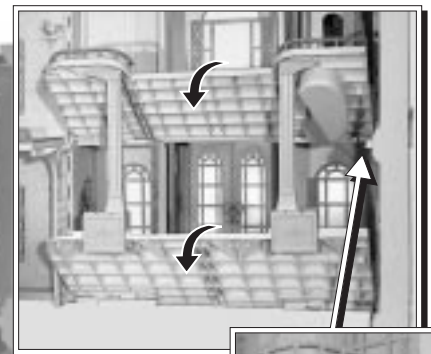

7

Fold down floors



8

Slide floor panel over floor space.

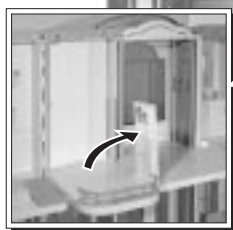

9

Lift up TV/bookcase.

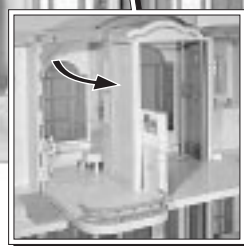

10

Open wall.

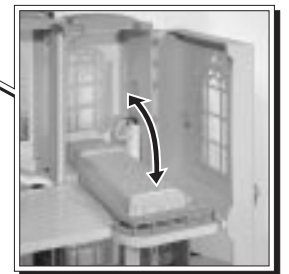

11

Pull down bed for a good night's sleep. Raise it in the morning.

Apply Labels

Place labels as shown by number ①.

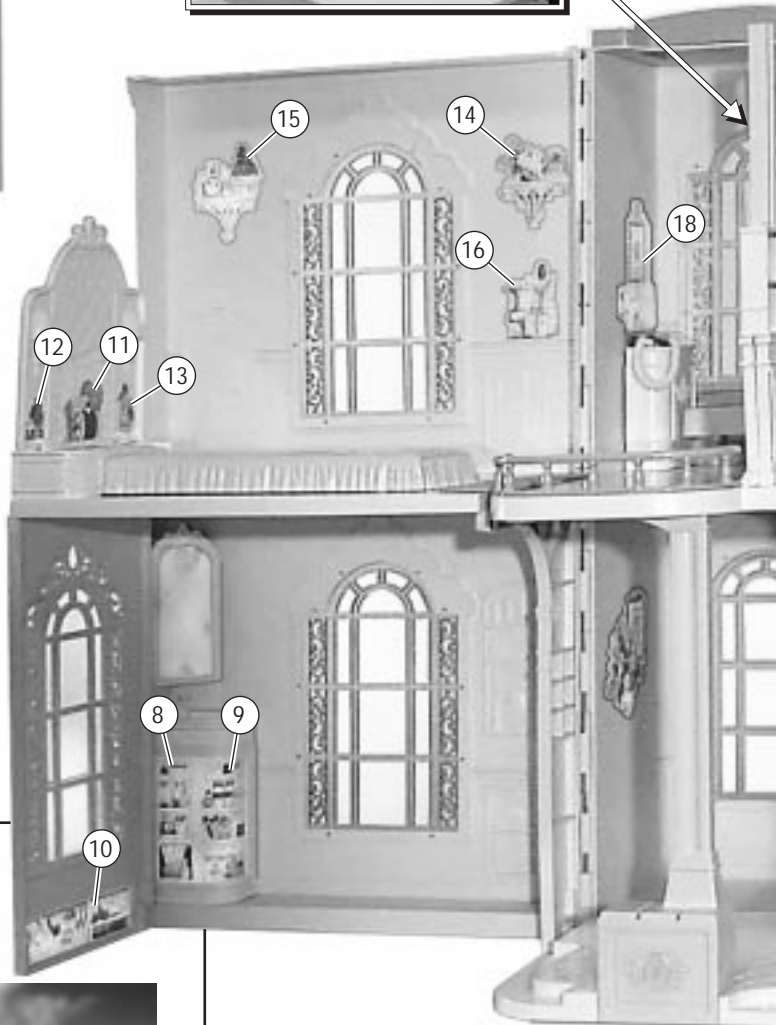
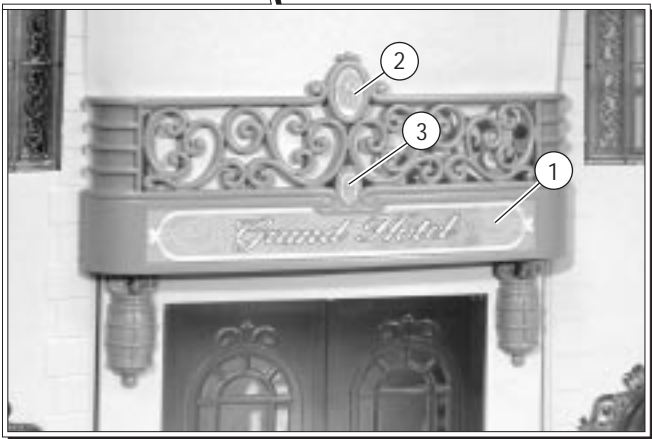
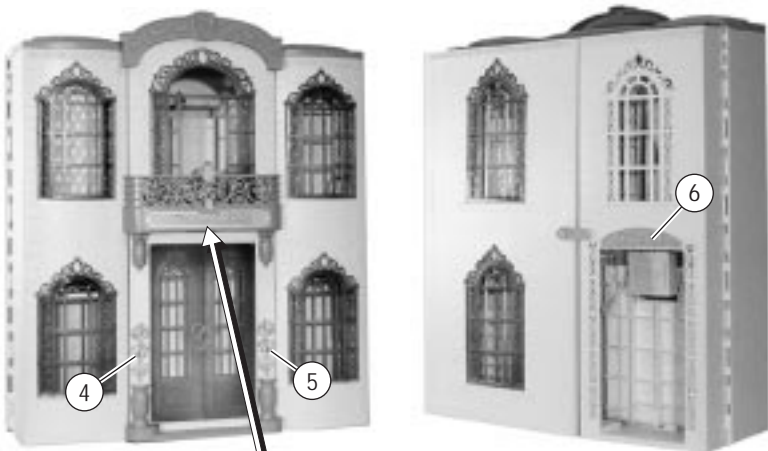

Playtime!

Set up the Barbie® Grand Hotel and all its amenities. Call for room service, have lunch, enjoy the Grand Salon.



Dolls not included.



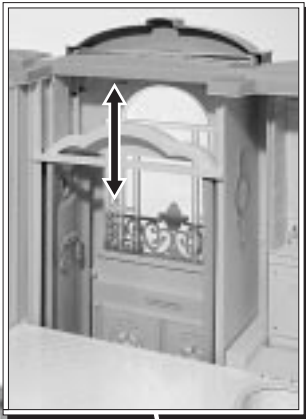

Elevator slides up and down, bell rings.

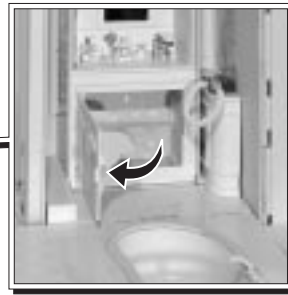
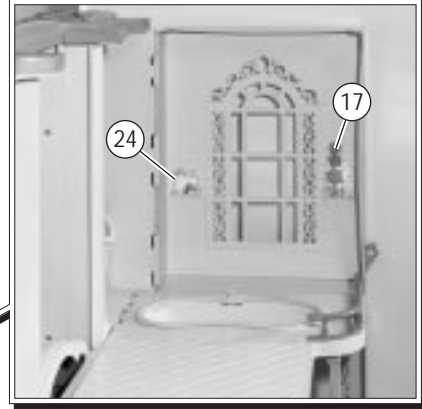
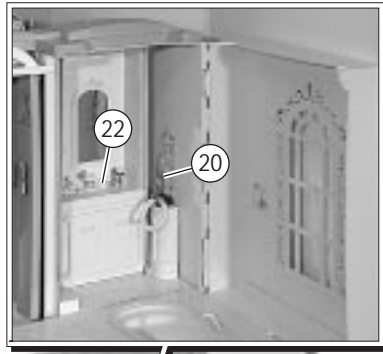

Vanity door opens.



Install Registration Desk

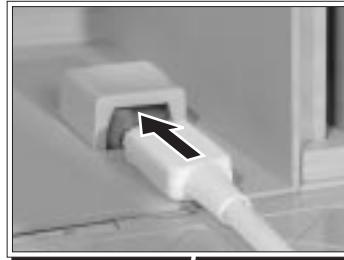

Plug in cable as shown and turn on switch in back of desk. All phones are now ready for action.

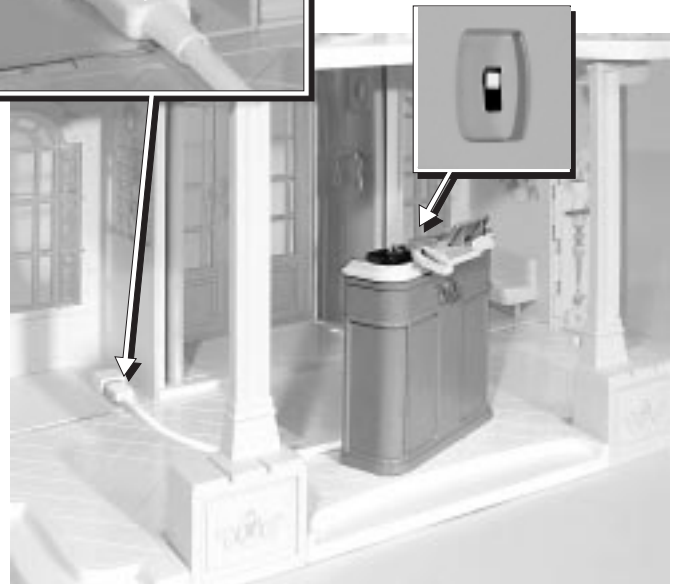

NOTE: If front desk sounds malfunction, reset by activating ON/OFF switch.

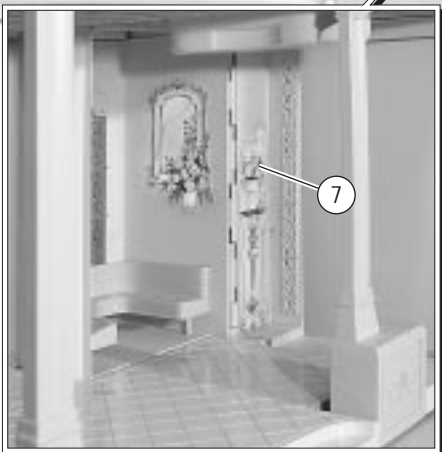

Install Balcony & etc.

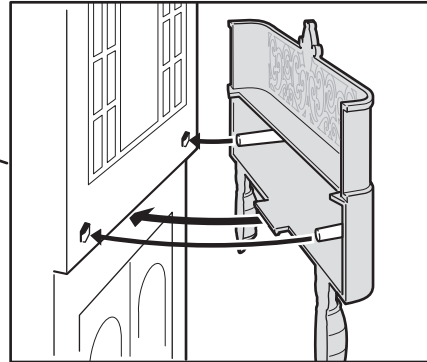
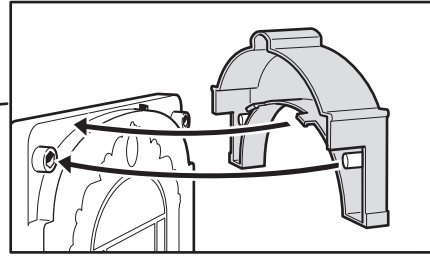

Press units into building. Once placed they are not removable.

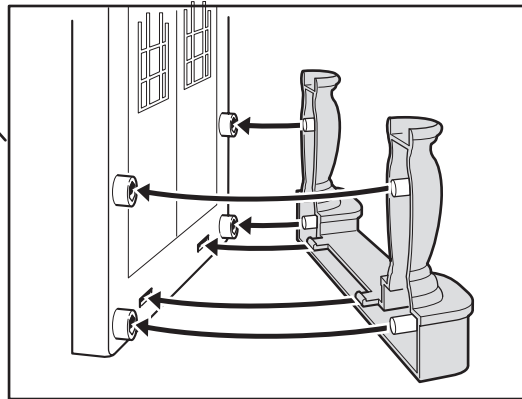

Phones

**3 interactive phones that actually talk to Barbie!
Over 100 phrase combinations.**

"Grand Salon. Would you like an appointment?"

"Room service. Please press the green button after you hear the food you'd like."

Use the front desk buttons for interactive play. "Call" between rooms on the interactive phones too.

You have many choices when you press the phone buttons: Greetings, Room Service for food, or the Grand Salon.

The choices are yours!

Here are some basic instructions for the phone buttons:

Reception Desk phone:

- Pressing the red button rings Deluxe Suite phone
- Green button rings the Penthouse Suite phone
- White button activates hotel greetings

Penthouse phone:

- Red button rings the reception desk phone
- Green button rings the Deluxe Suite phone

Deluxe Suite phone:

- Red button rings the reception desk phone
- Green button rings the Penthouse Suite phone

Part of the interactive phone play includes the suite phones randomly ringing with a call or indicating a message with a blinking light. When a suite phone rings or has a blinking light, press the red button to answer the call or retrieve the message. Simply follow the voice prompts given. It is not necessary to lift up the phone's handset.

FRONT DESK



ROOM PHONES



Install Batteries

Using Phillips head screwdriver (not included), unscrew battery compartment door and lift off. Insert 3 "AA" alkaline batteries as shown. Replace door.

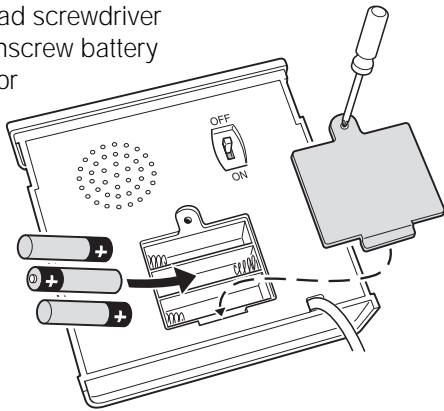

BATTERY SAFETY INFORMATION:

1. Non-rechargeable batteries are not to be recharged.
2. Rechargeable batteries are to be removed from the toy before being charged.
3. Rechargeable batteries are only to be charged under adult supervision.
4. Do not mix alkaline, standard (carbon-zinc), or rechargeable (nickel-cadmium) batteries.
5. Do not mix old and new batteries
6. Only batteries of the same or equivalent type as recommended are to be used.
7. Batteries are to be inserted with the correct polarity.
8. Exhausted batteries are to be removed from the toy.
9. The supply terminals are not to be short-circuited.
10. Dispose of batteries safely.

Storage

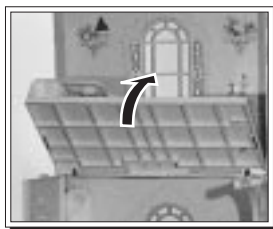
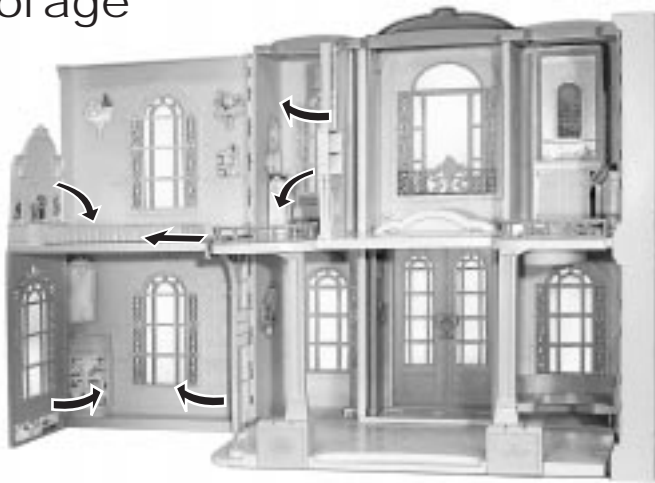

1. Fold back all walls and foldable parts. Lift up the floors.

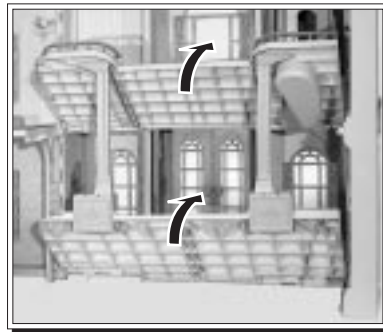

2. Store all small parts and accessories inside of hotel. Fold large walls and close latch.



2-YEAR LIMITED WARRANTY

Mattel, Inc. warrants to the original consumer purchaser that this product will be free of defects in material or workmanship for two years (unless specified in alternate warranties) from the date of purchase. If defective, return the product along with proof of the date of purchase, postage prepaid, to Consumer Relations, 636 Girard Avenue, East Aurora, New York 14052 for replacement or refund at our option. This warranty does not cover damage resulting from unauthorized modification, accident, misuse or abuse. In no event shall we be responsible for incidental, consequential, or contingent damages (except in those states that do not allow this exclusion or limitation). **Valid only in U.S.A.** This warranty gives you specific legal rights and you may also have other rights which vary from state to state. Some states do not allow the exclusion of incidental or consequential damages, so the above exclusions or limitations may not apply to you. Send only the product to the address above.

Send all correspondence to Consumer Relations, Mattel, Inc., 333 Continental Blvd., El Segundo, California 90245-5012 U.S.A. Or you may phone us toll-free at 1-800-524-TOYS, Monday-Friday, 8:00 a.m.-6:00 p.m. Eastern Time. Outside U.S.A., see telephone directory for Mattel listing.

CONSUMER INFORMATION

MATTY MATTEL™ toys



YOU CAN TELL IT'S MATTEL!™ CALL us toll-free or write with any comments or questions about our products or service. Monday-Friday 8:00 a.m.-6:00 p.m. Eastern Time. Outside U.S.A., see telephone directory for Mattel listing.

Consumer Relations, Mattel, Inc.
333 Continental Blvd.
El Segundo, CA 90245 USA

1(800)524-TOYS

WE ARE DEDICATED TO QUALITY PRODUCTS.



WARNING:

CHOKING HAZARD – Small parts.
Not for children under 3 years.