

## II. TRIANGLE CONNECTORS

Triangle connectors let you build higher by attaching vehicle bodies (or other pieces) on top of each other.

To connect, simply line up the triangles and push pieces together as shown. To remove, just pull apart.

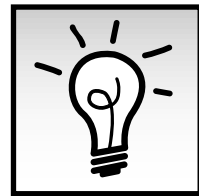
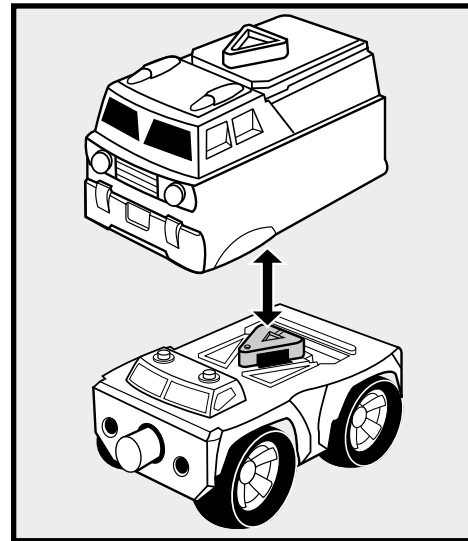
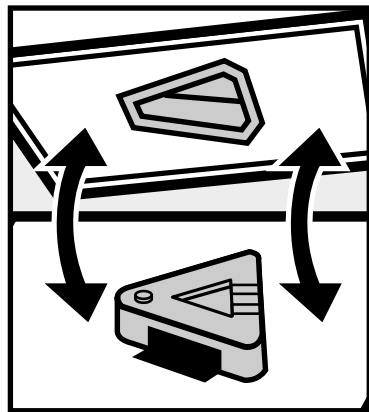

Components vary by set.

## III. WHEEL CONNECTORS

Wheel connectors let you build wider by attaching vehicles side-by-side.

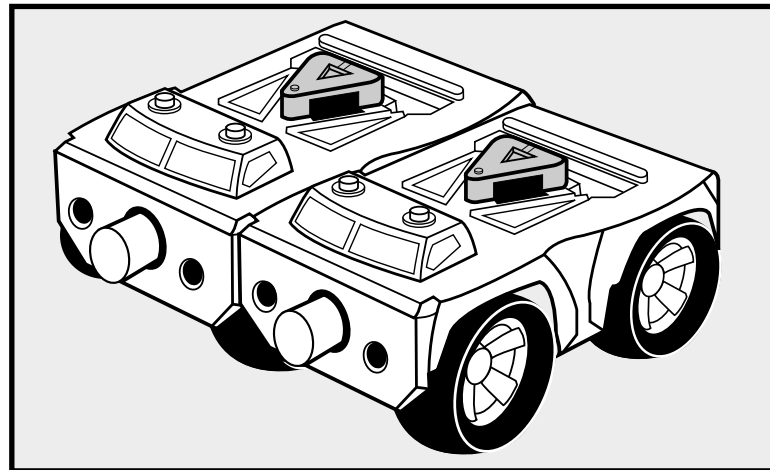
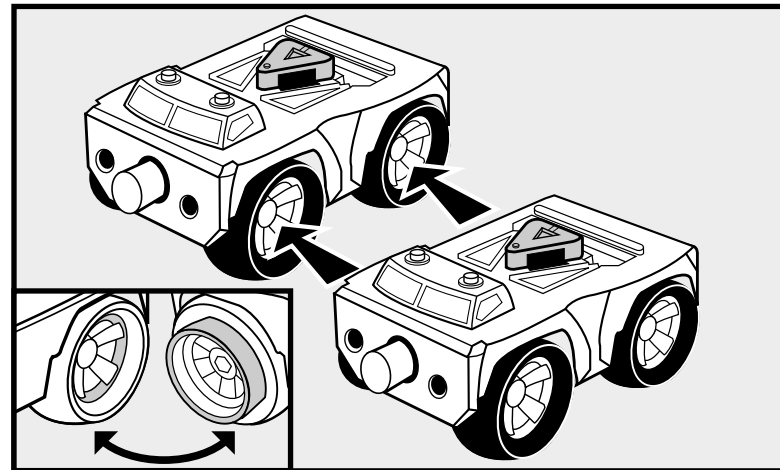

To connect, line up wheels and push them together as shown. Make sure triangles are pointing in the same direction. To remove, just pull apart.

### BATTERY REPLACEMENT

If light & sounds play slowly or distort replace batteries.

1. To replace button-cell batteries, unscrew and remove battery door.
2. Remove old batteries. Install 3 button-cell (AG13, LR44) batteries with polarity (+/-) as shown.
3. Replace battery door and tighten screw.

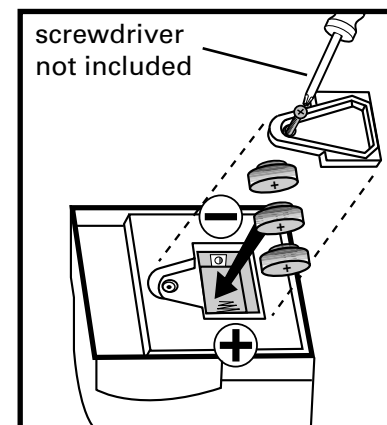

### Battery Safety Information

Batteries may leak fluids that can cause a chemical burn injury or ruin your toy (product). To avoid battery leakage:

- Non-rechargeable batteries are not to be recharged.
- Rechargeable batteries are to be removed from the toy before being charged.
- Rechargeable batteries are only to be charged under adult supervision.
- Do not mix alkaline, standard (carbon-zinc), or rechargeable (nickel-cadmium) batteries.
- Do not mix old and new batteries.
- Only batteries of the same or equivalent type as recommended are to be used.
- Batteries are to be inserted with the correct polarity.
- Exhausted batteries are to be removed from the toy.
- The supply terminals are not to be short-circuited.
- Dispose of batteries safely. Do not dispose of in a fire as batteries may explode or leak.
- Products with non-replaceable batteries are not to be disposed of in a fire as the batteries inside may explode or leak.

©2003 Mattel, Inc., Mt. Laurel, NJ 08054 U.S.A. PRINTED IN CHINA. All Rights Reserved. ® and ™ designate U.S. trademarks of Mattel, Inc.

Retain this address for future reference: Mattel U.K. Ltd., Vanwall Business Park, Maidenhead SL6 4UB. Helpline: 01628 500303. Mattel Australia Pty Ltd., Richmond, Victoria 3121 - Consumer Advisory Service: 1300 135 315 (valid only in Australia). Mattel East Asia Ltd, Room 1106, South Tower, World Finance Centre, Harbour City, Tsimshatsui, HK, China. Diimport & Diedarkan Oleh: Mattel SEA Ptd Ltd. (993532-P) Lot 13.5, Menara Lien Hoe, Persiaran Tropicana Golf Country Resort, 47410 PJ. Tel: 03-78803817, Fax: 03-78803867.

# MAGNA WHEELS

Keep these instructions for future reference as they contain important information.

The Magna Wheels easy-connection system lets you build longer, higher and wider.

There are 3 kinds of connectors:

**WARNING:**  
CHOKING HAZARD - Small parts.  
Not for children under 3 years.

### Magnetic Connectors

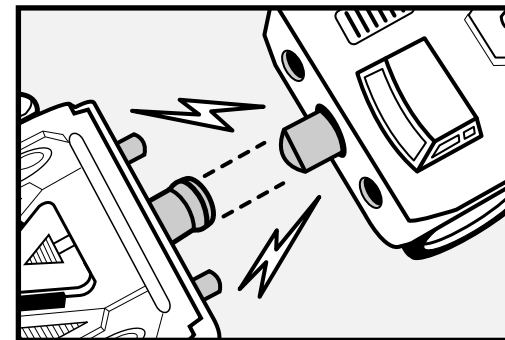

### Triangle Connectors

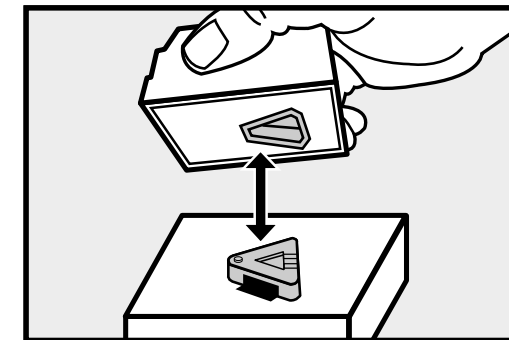

### Wheel Connectors

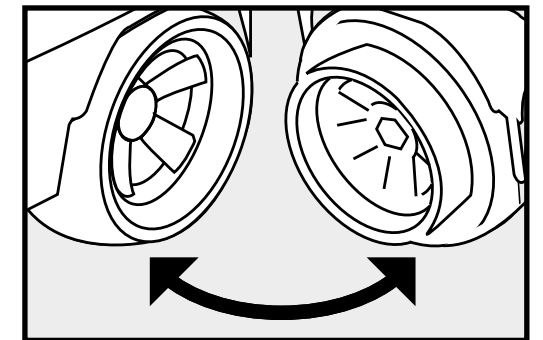

## I. MAGNETIC CONNECTORS

Magnetic connectors let you build longer by linking vehicles together. There are two types of magnetic connectors: type A and type B. Type A connectors are stationary. Type B connectors are spring-loaded (they can be pushed in). Magnetic connectors work 2 ways: with magnetic connections and with push-click connections.

For magnetic connections, simply click Type A and Type B connectors together as shown.

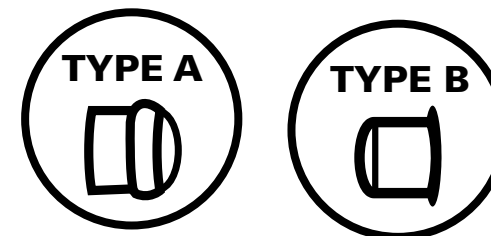

For push-click connections, line up Type A and Type B connectors and push together. The vehicles will lock together with a click.

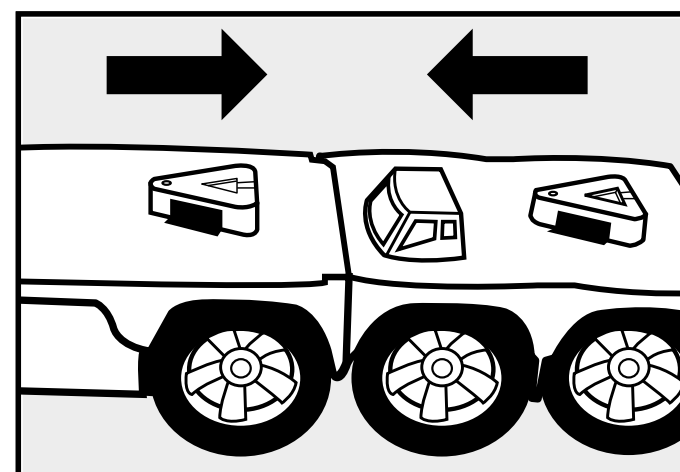

This product contains a magnet. Do not use around items that are sensitive to or affected by magnetic fields.

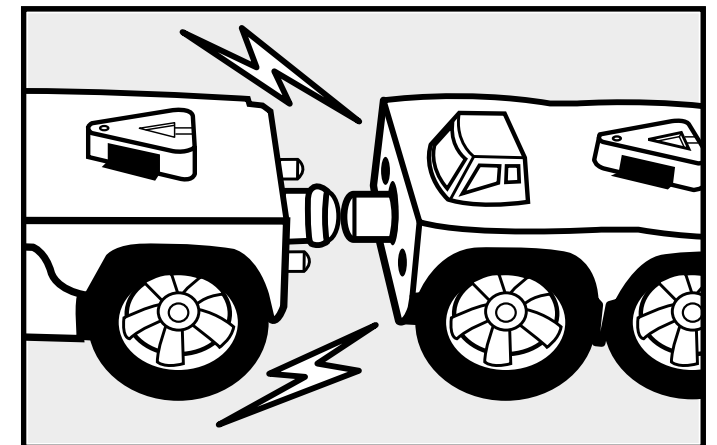

To remove, just pull apart.

