

Fisher-Price®

Push'n Pedal Trike

Model Number: 72666

Instructions



Please keep these instructions for future reference.

Adult assembly is required.

Age: 1½ years - 5 years

Weight Limit: 50 lbs.

Tools needed for assembly: Hammer, Phillips Screwdriver, Scrap Block of Wood

WARNING

- Adult supervision is required.
- Never use near steps, sloped driveways, hills, ditches, roadways, alleys, swimming pool areas or other bodies of water.
- Always wear shoes or sneakers.
- Never allow more than one rider.
- Observe child weight limit: maximum 50 lbs.

CAUTION

Please keep small parts, hardware and plastic bags out of children's reach. Dispose of plastic bags properly.

Message to Parents

Thank you for purchasing the Fisher-Price® Push 'n Pedal Trike for your child. The Push 'n Pedal Trike is a grow-with-me trike with a flip-up footrest and a parent-assist handle for riders who have not yet learned to pedal on their own. When your child learns to pedal, you can convert the Push 'n Pedal Trike to a pedal trike.

The Push 'n Pedal Trike requires adult assembly. Please set aside at least 30 minutes for assembly. Please read these instructions carefully and identify all parts before assembly. Refer to the parts illustration and parts list for identification.



Questions? We'd like to hear from you!

Call Fisher-Price® Consumer Affairs, toll-free at **1-800-432-KIDS**, 8 AM - 6 PM EST Monday through Friday. Hearing-impaired consumers using TTY/TDD equipment, please call 1-800-382-7470. Or, write to: Fisher-Price Consumer Affairs, 636 Girard Avenue, East Aurora, New York 14052.

Occasionally a consumer may experience a problem with one of our products. If this should happen, please call us, toll-free, rather than return this product to the store. Usually we can solve the problem on the telephone or by sending you replacement parts. Please call Fisher-Price Consumer Affairs, toll-free at **1-800-432-KIDS**, 8 AM - 6 PM EST Monday through Friday. Hearing-impaired consumers using TTY/TDD equipment, please call 1-800-382-7470. Or, write to: Fisher-Price Consumer Affairs, 636 Girard Avenue, East Aurora, New York 14052.

If you have any questions about this product: **In Canada**, call **1-800-567-7724**, or write to: Mattel/Fisher-Price, 6155 Freemont Blvd., Mississauga, Ontario L5R 3W2. **In Great Britain**, telephone 01734 770488. **In Australia**, call the Fisher-Price Australian Consumer Advisory Service toll-free at 1-800-800-812, or write to: Fisher-Price, Mattel Pty. Limited, 461 Plummer Street, Port Melbourne, Victoria 3207.

Three (3) Year Limited Warranty

Fisher-Price, Inc., 636 Girard Avenue, East Aurora, New York 14052, warrants to the original owner that the Push 'n Pedal Trike is free from all defects in material and workmanship when used under normal conditions for a period of three (3) years from the date of purchase. This warranty does not cover color fading of the product or product parts, or damage from excessive abuse or acts of God.

Should the product fail to perform properly, we will repair or replace it at our option, free of charge. Purchaser is responsible for shipping the product to Fisher-Price® Consumer Affairs at the address indicated above and for all associated freight and insurance cost. Fisher-Price, Inc. will bear the cost of shipping the repaired or replaced item to you. This warranty is void if the owner repairs or modifies the product. This warranty excludes any liability other than that expressly stated above including but not limited to any incidental or consequential damages.

SOME STATES DO NOT ALLOW THE EXCLUSION OR LIMITATION OF INCIDENTAL OR CONSEQUENTIAL DAMAGES, SO THE ABOVE LIMITATION OR EXCLUSION MAY NOT APPLY TO YOU.

THIS WARRANTY GIVES YOU SPECIFIC LEGAL RIGHTS, AND YOU MAY ALSO HAVE OTHER RIGHTS WHICH MAY VARY FROM STATE TO STATE.

Parts

- Please save all packaging material until assembly is complete to ensure that no parts are discarded.
- Please wipe each part with a clean dry cloth before assembly the Push 'n Pedal Trike.

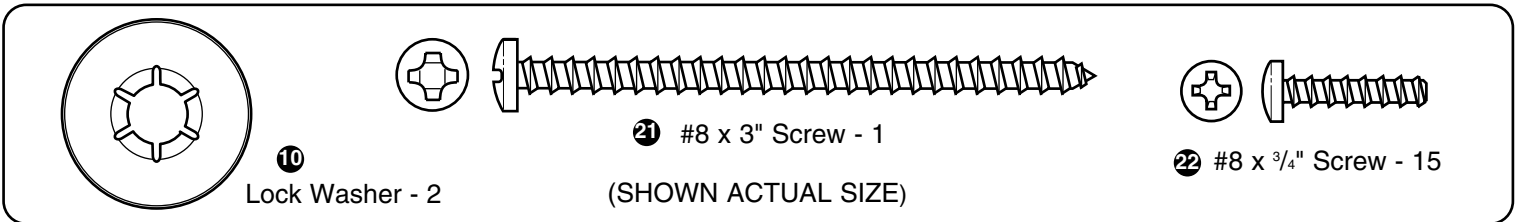
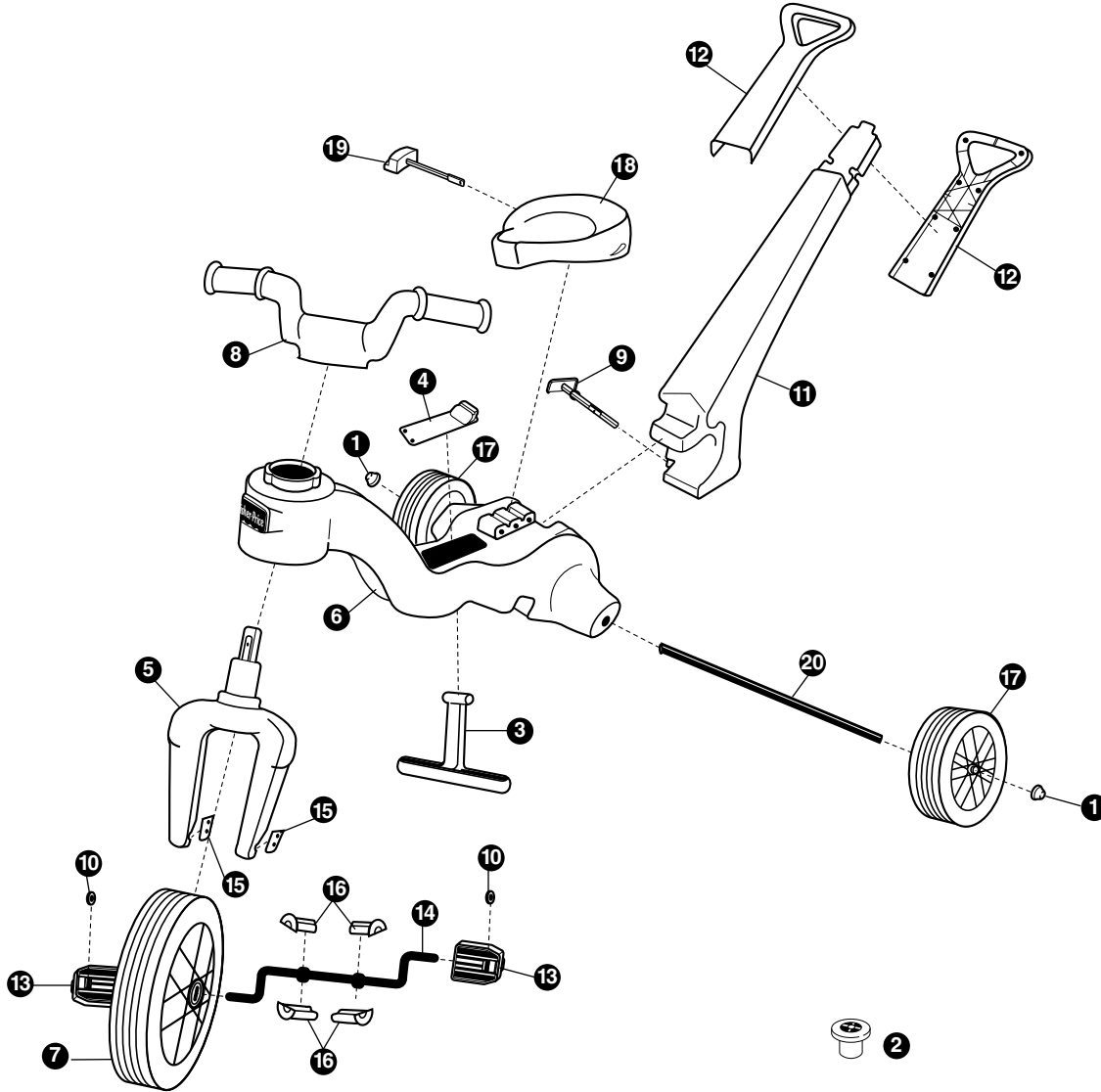
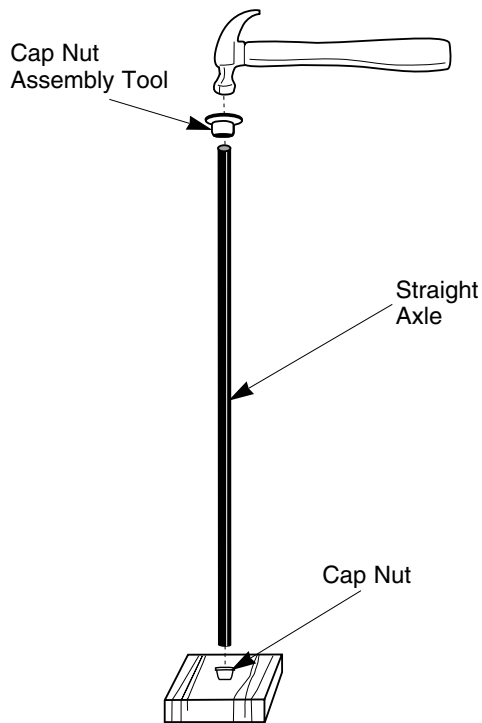

Illustration Number	Part Description	Quantity	Illustration Number	Part Description	Quantity
1	Cap Nut	2	12	Parent-Assist Handle Grip (half)	2
2	Cap Nut Assembly Tool	2	13	Pedal	2
3	Footrest	1	14	Pedal Axle	1
4	Footrest Cover	1	15	Pedal Axle Cover	2
5	Fork	1	16	Pedal Hub	4
6	Frame	1	17	Rear Wheel	2
7	Front Wheel	1	18	Seat	1
8	Handlebar	1	19	Seat Adjustment Pin	1
9	Handle Retainer Pin	1	20	Straight Axle	1
10	Lock Washer	2	21	#8 x 3" Screw	1
11	Parent-Assist Handle Base	1	22	#8 x 3/4" Screw	15

Assembly

Rear Wheel Assembly

1



- Place a cap nut on a scrap block of wood.
- Place one end of the straight axle into the cap nut.
- Place a cap nut assembly tool on the end of the straight axle and tap the center with a hammer. **Make sure the cap nut is securely attached to the straight axle.**
- Remove the cap nut assembly tool from the straight axle.

2

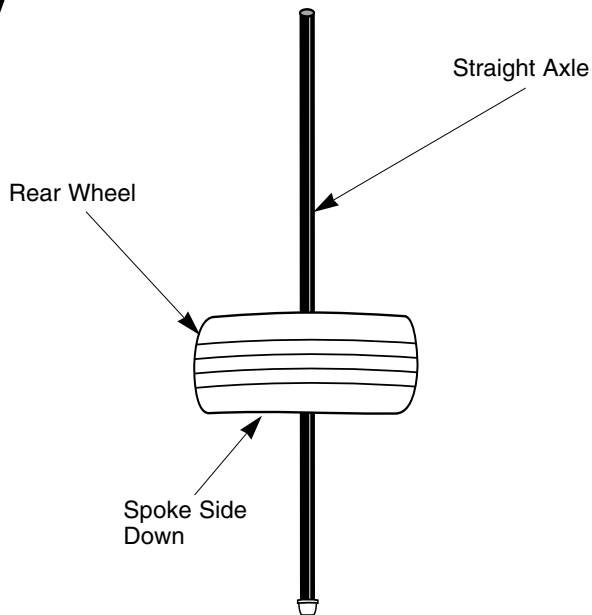

- Slide a rear wheel (spoke side down) onto the straight axle.

3

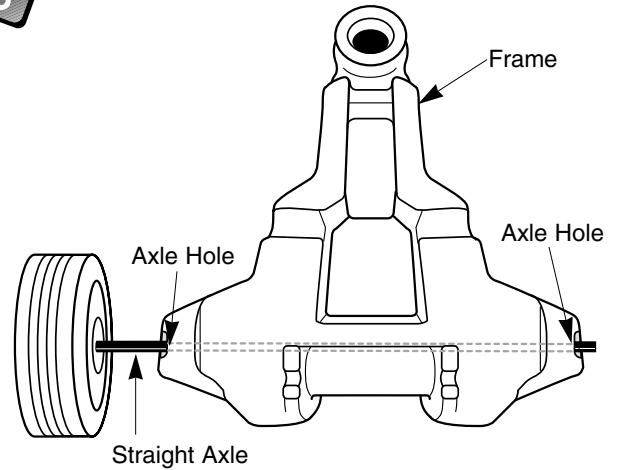

- Turn the frame upside down.
- Insert the straight axle through the axle holes in the rear of the frame.

4

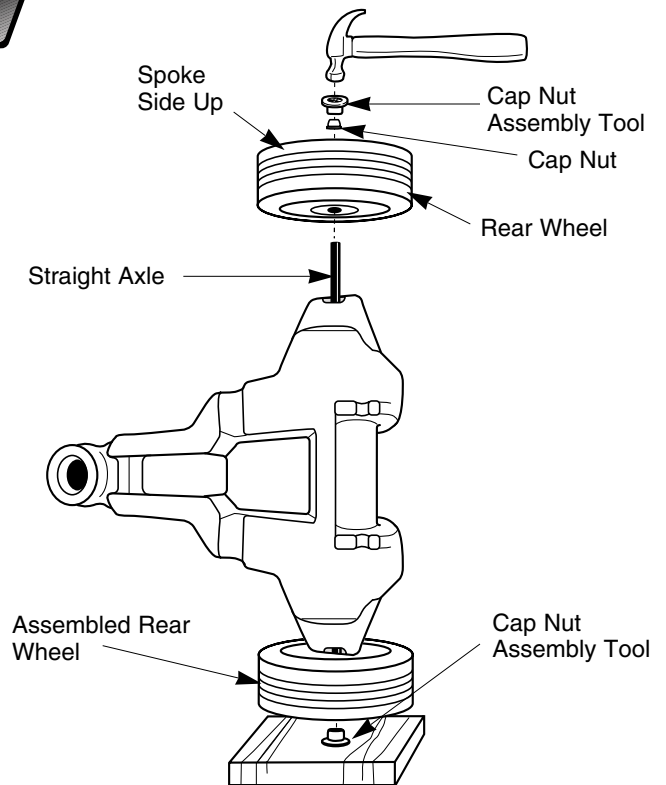

- Place a cap nut assembly tool on a scrap block of wood.
- Turn the frame on its side with the exposed end of the straight axle up.
- Place the assembled rear wheel on the scrap block of wood, with the cap nut inside the cap nut assembly tool.
- Slide a rear wheel (spoke side up) onto the end of the straight axle.
- Place a cap nut on the end of the straight axle.
- Place a cap nut assembly tool over the cap nut and tap the center with a hammer. **Make sure the cap nut is securely attached to the straight axle.**

4

- Set the frame aside.

Pedal Axle and Front Wheel Assembly

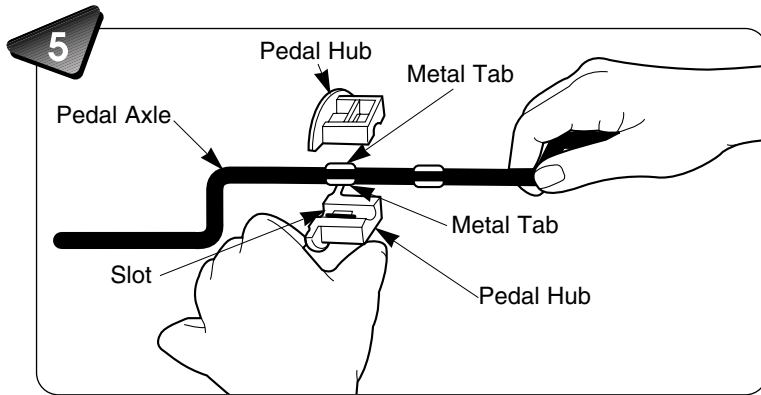

- Place two pedal hubs on the pedal axle so that the metal tabs on the pedal axle fit into the slots inside each pedal hub.

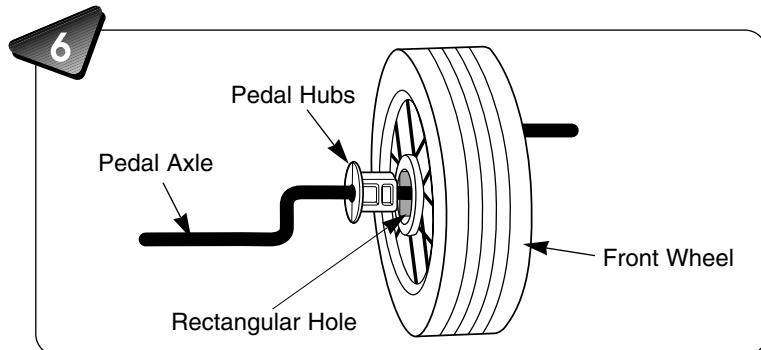

- While holding the pedal hubs on the pedal axle, insert the assembly into the rectangular hole in the front wheel.

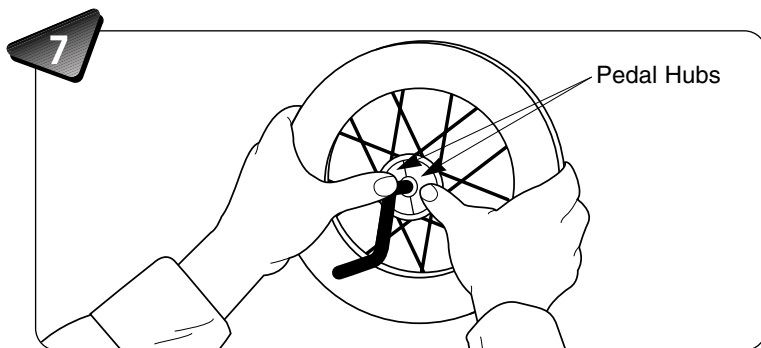

- Push the pedal hubs in until they are flush with the surface of the front wheel.

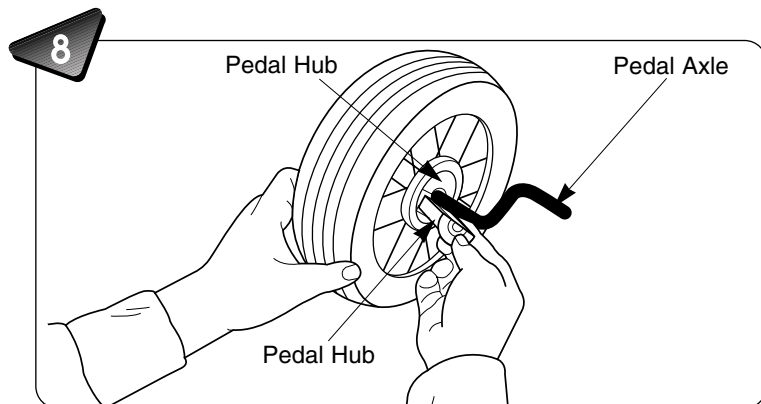

- Turn the front wheel assembly over.
- Insert a pedal hub on top of the pedal axle and into the rectangular hole in the front wheel.
- Insert the remaining pedal hub below the pedal axle and into the rectangular hole in the front wheel.

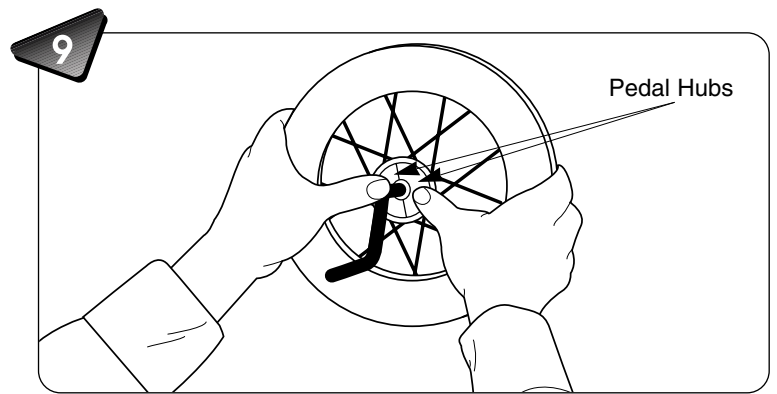

- Push the pedal hubs in until they are flush with the surface of the front wheel.

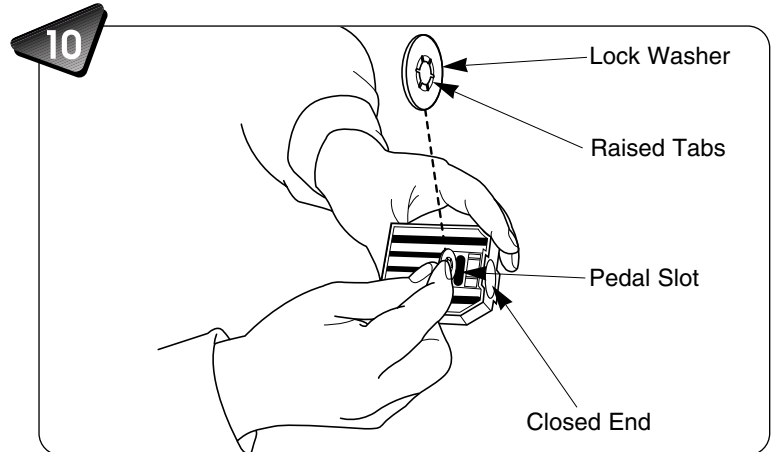

- Insert a lock washer into the pedal slot. Make sure the raised tabs on the lock washer are facing the closed, or outside, end of the pedal.
- Insert the other lock washer into the other pedal.

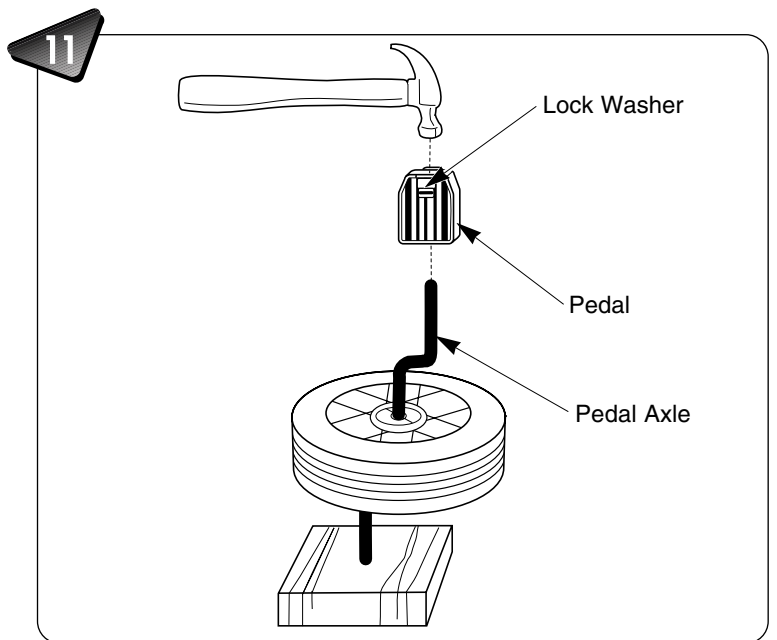

- Place a scrap block of wood under the front wheel assembly.
- Place a pedal on the pedal axle.
- With the pedal lock washer centered over the pedal axle end, tap the pedal with a hammer until it is secure.
- Repeat this procedure to attach the other pedal to the other end of the pedal axle.

Front Wheel to Fork Assembly

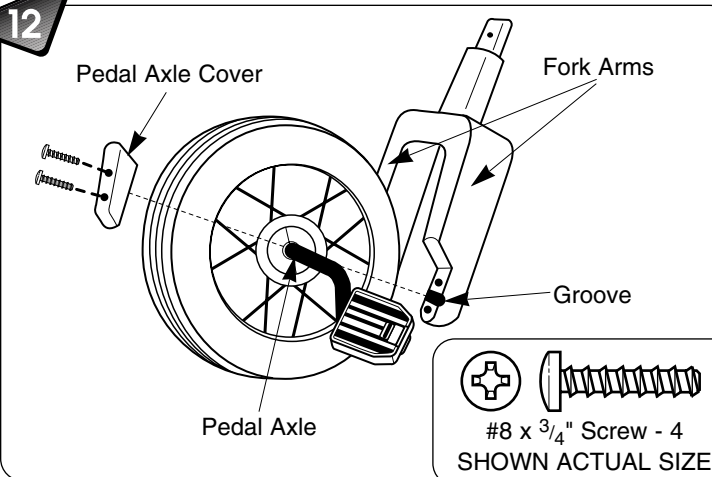

- Place the front wheel assembly between the fork arms so that the pedal axle fits into the groove at the bottom of each fork arm.
- Place a pedal axle cover over the pedal axle on one fork arm.
- Insert two #8 x $\frac{3}{4}$ " screws into the pedal axle cover and tighten with a Phillips screwdriver. Do not over-tighten.
- Repeat this procedure to attach the other pedal axle cover to the other fork arm.

Handlebar to Fork Assembly

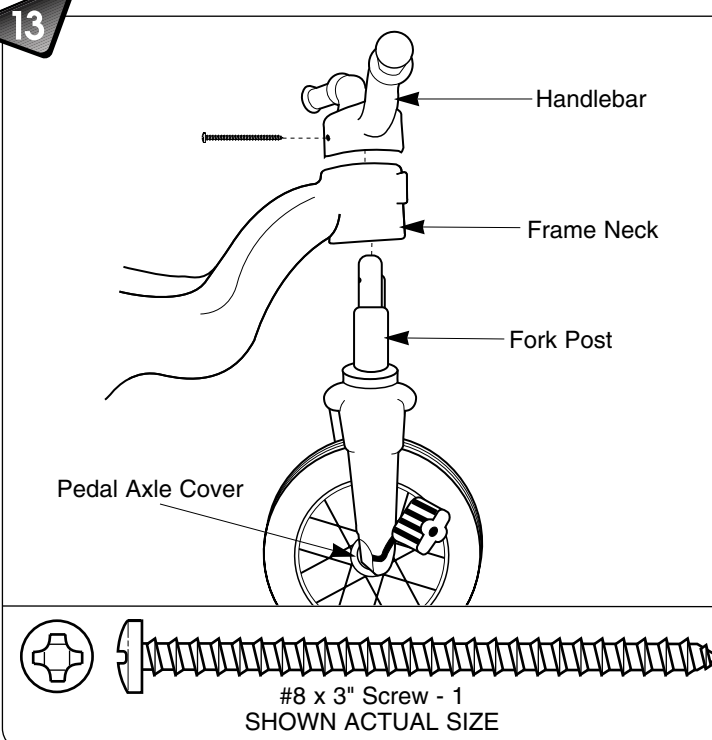

- Turn the frame upright.
- Insert the fork post up through the hole in the neck of the frame. Make sure the fork is positioned so that the pedal axle covers face the rear wheels.
- Place the handlebar over the fork post and push it down onto the frame. Make sure the handlebar is positioned so that the screw hole faces the rear wheels and aligns with the screw hole in the fork.
- Insert the #8 x 3" screw into the hole and tighten with a Phillips screwdriver. Do not over-tighten.

Footrest Assembly

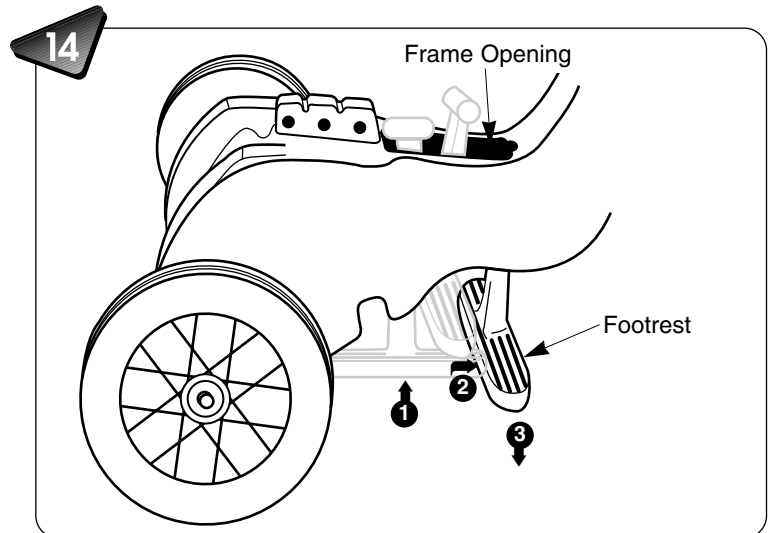

- Insert the top of the footrest up through the opening in the underside center of the frame **1**.
- Rotate the footrest $\frac{1}{4}$ turn **2**.
- Slide the footrest toward the handlebar as far as it will go until the top of the footrest is positioned over the opening's rectangular cut-out.
- Lower the top of the footrest into the rectangular cut-out in the frame **3**.

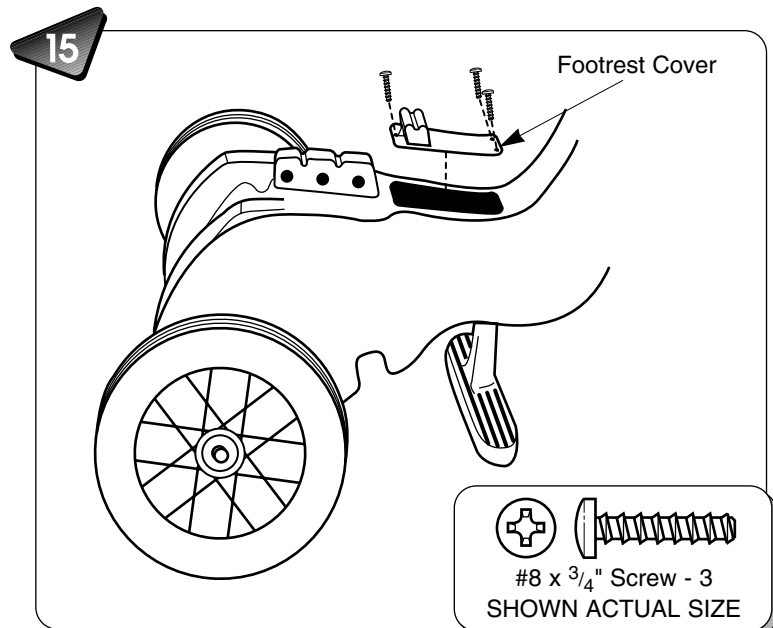

- Place the footrest cover over the frame opening. Make sure that the holes in the footrest cover align with the holes on the frame.
- Insert three #8 x $\frac{3}{4}$ " screws into the footrest cover and tighten with a Phillips screwdriver. Do not over-tighten.

Parent-Assist Handle Assembly

16

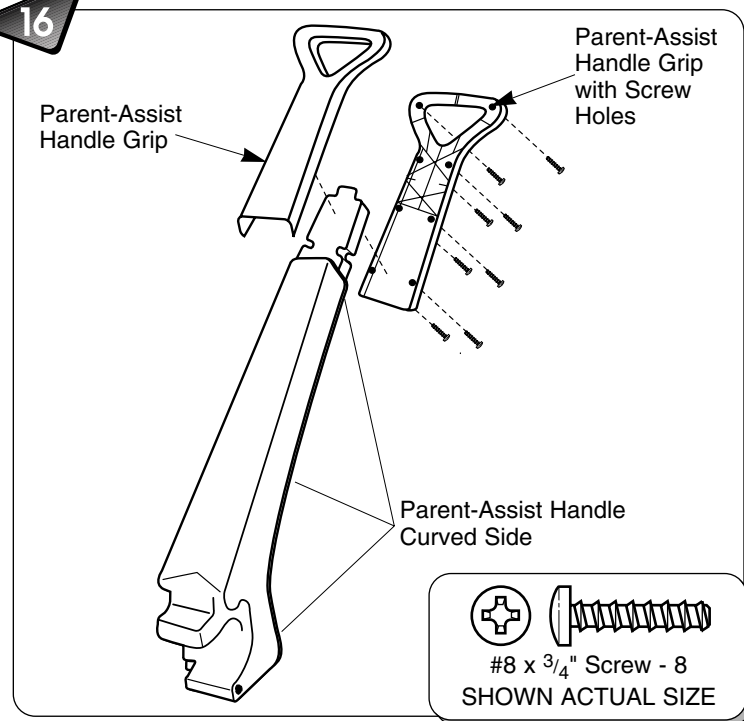

- Find the curved side (back) of the parent-assist handle.
- Find the half of the parent-assist handle grip which has screw holes. Fit this half of the handle grip on the back side of the handle.
- Fit the other half of the handle grip to the handle grip on the parent-assist handle.
- Insert eight #8 x $\frac{3}{4}$ " screws into the handle grip and tighten with a Phillips screwdriver. Do not over-tighten.

17

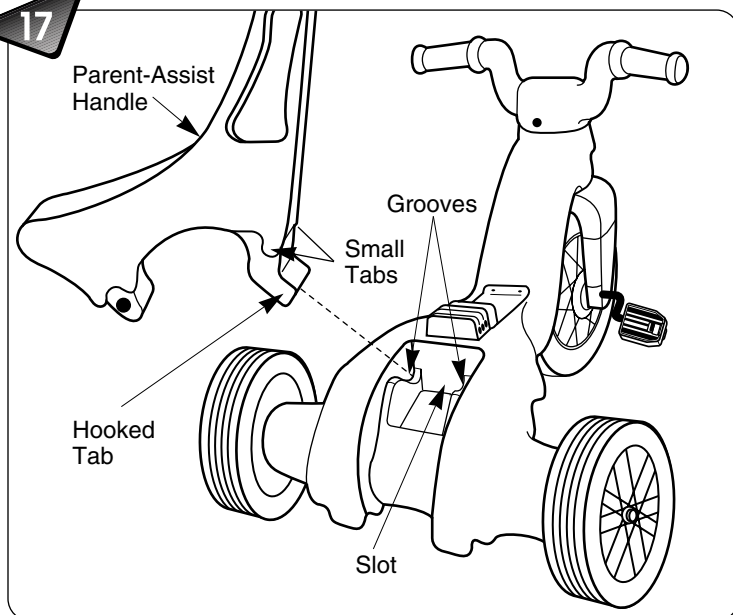

- At an angle, insert the hooked tab on the front of the parent-assist handle base into the slot in the back of the frame.
- Rotate the parent-assist handle down so that the small tabs on the handle fit into the grooves in the back of the frame.

18

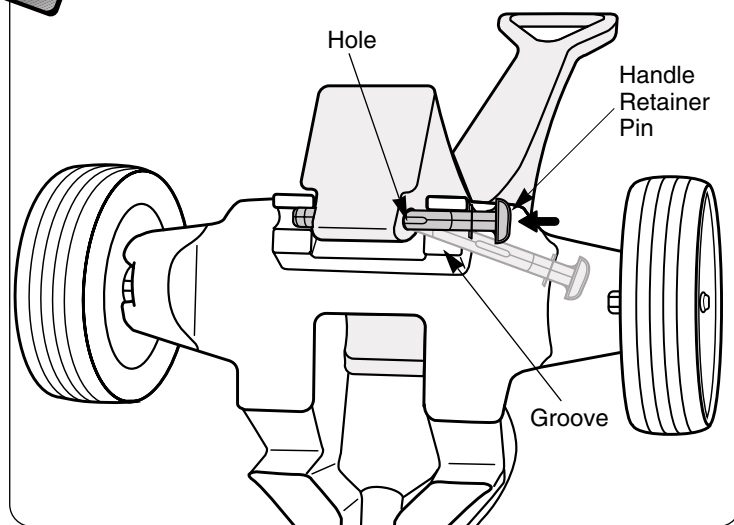

- Turn the frame upside down so that the parent-assist handle rests on the floor.
- Fit the handle retainer pin into the groove in the bottom of the frame and then into the hole in the bottom of the parent-assist handle base.

Helpful Hint: To align the groove in the bottom of the frame and the hole in the bottom of the parent-assist handle, you may need to push down on the base of the parent-assist handle while inserting the handle retainer pin.

- Push the handle retainer pin through the parent-assist handle base to secure the handle to the Push 'n Pedal Trike frame.

Seat Assembly

19

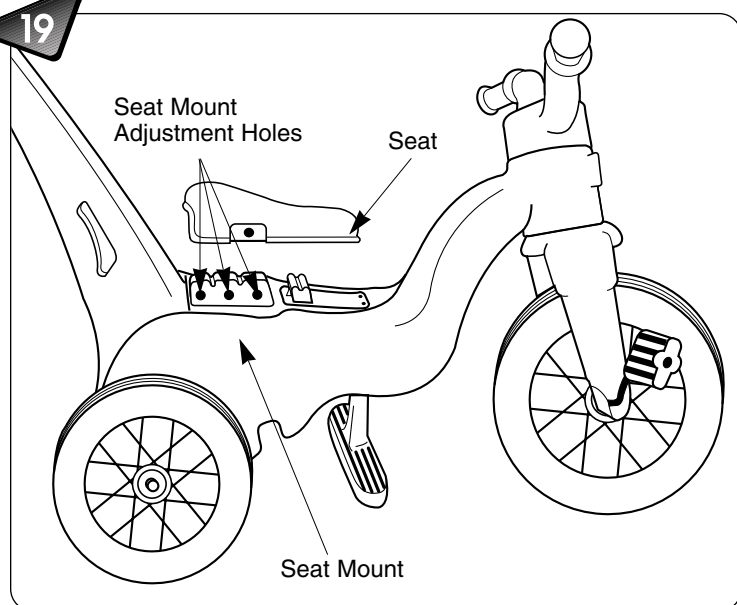

- Place the seat on the seat mount.
- Adjust the seat for your child's comfort by lining up the hole in the seat with one of the seat mount adjustment holes.

Please Note: When the parent-assist handle is attached to the Push n' Pedal Trike, the seat can only be secured in the front or middle seat mount adjustment hole. When the parent-assist handle is removed from the Push 'n Pedal Trike, the seat can be secured in the front, middle or rear seat mount adjustment hole.

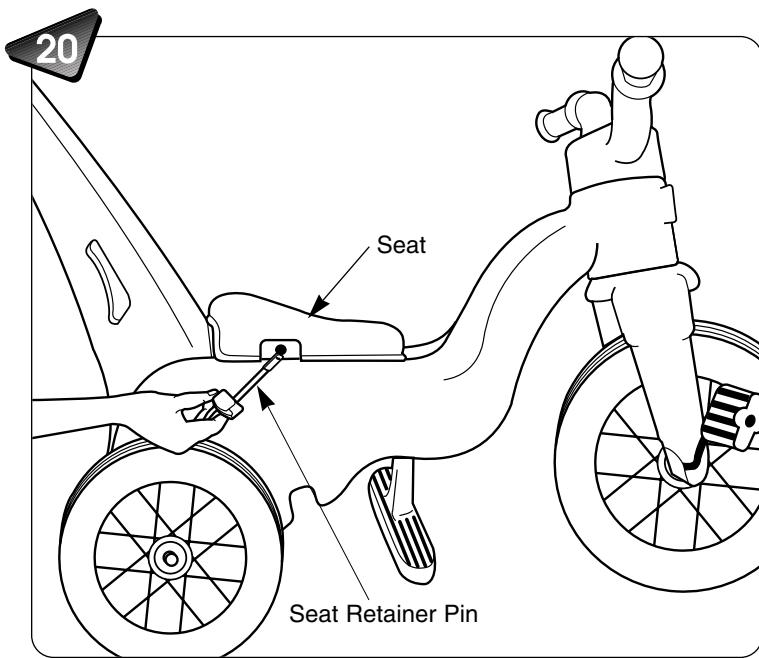

- While pushing down on the seat, insert the seat retainer pin through the hole in the seat and into a seat mount adjustment hole.

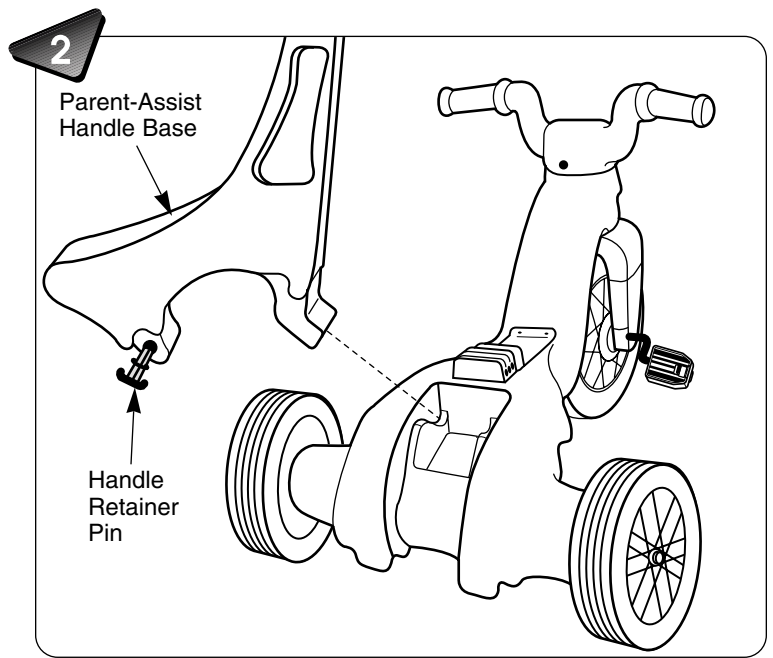

- Remove the parent-assist handle from the frame.
- Insert the handle retainer pin back into the parent assist handle. Store the parent-assist handle and the handle retainer pin in a safe place for future use.

To Convert From Parent-Assist To Pedal Trike

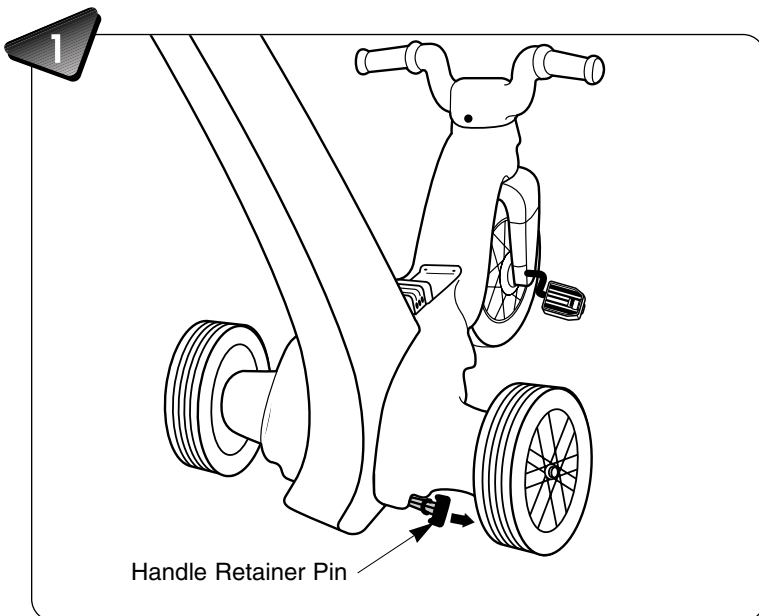

- Pull the handle retainer pin out of the parent-assist handle base.

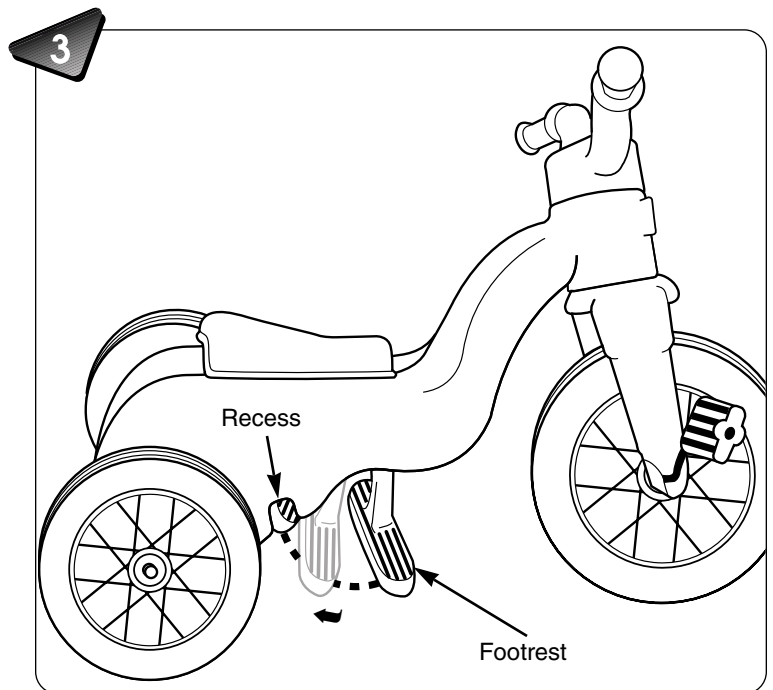

- Push the footrest up towards the rear wheels and snap it into the recess in the underside of the frame.

Maintenance

- Push the footrest up towards the rear wheels and snap it into the recess in the underside of the frame.
- Periodically inspect the Push 'n Pedal Trike for wear and damage and tighten fasteners if necessary.
- To clean the Push 'n Pedal Trike, use a mild soap and water solution and a clean cloth. Rinse clean with water to remove soap residue.