

Barbie™

Grow-With-Me Trike

Instructions

Model Number: 72668



Keep these instructions for future reference, as they contain important information.

Adult assembly is required.

Tools needed for assembly: Hammer, Phillips Screwdriver, Scrap Block of Wood (not included).

If you have any questions about this product, or are missing a part, please call us toll-free at 1-800-432-KIDS, rather than return this product to the store.

Age: 2 - 6 years.

Weight Limit: 60 lbs.

Fisher-Price®

Consumer Information

Thank you for purchasing the BARBIE™ Grow-With-Me Trike for your child. The BARBIE™ Grow-With-Me Trike starts off as a regular tricycle for the youngest riders and then converts to a low rider as your child grows.

The BARBIE™ Grow-With-Me Trike requires adult assembly. Please set aside at least 30 minutes for assembly. Please read these instructions carefully and identify all parts before assembly. Refer to the parts illustration for identification.

Questions? We'd like to hear from you!

Call Consumer Relations, toll-free at **1-800-432-KIDS**, 8 AM - 6 PM EST Monday through Friday. Hearing-impaired consumers using TTY/TDD equipment, please call 1-800-382-7470. Or, write to: Consumer Relations, 636 Girard Avenue, East Aurora, New York 14052.

WARNING

Adult supervision is required.
Never use near steps, sloped driveways, hills, ditches, roadways, alleys
swimming pool areas or other bodies of water.
Always wear shoes or sneakers.
Never allow more than one rider.

CAUTION

This product contains small parts in its unassembled state.
Adult assembly is required.

Fasteners

ALL SHOWN ACTUAL SIZE

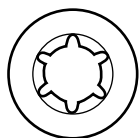

Lock Washer – 2



Cap Nut – 2



#8 x 3" Screw – 1



#8 x 3/4" Screw – 4

Parts

IMPORTANT!

- Please save all packaging material until assembly is complete to ensure that no parts are discarded.
- If you are missing a part, please call toll-free **1-800-432-KIDS**, rather than return this product to the store.
- Please wipe each part with a clean, dry cloth before assembly.

NOTE: Some parts shown are assembled to both sides of the Trike.

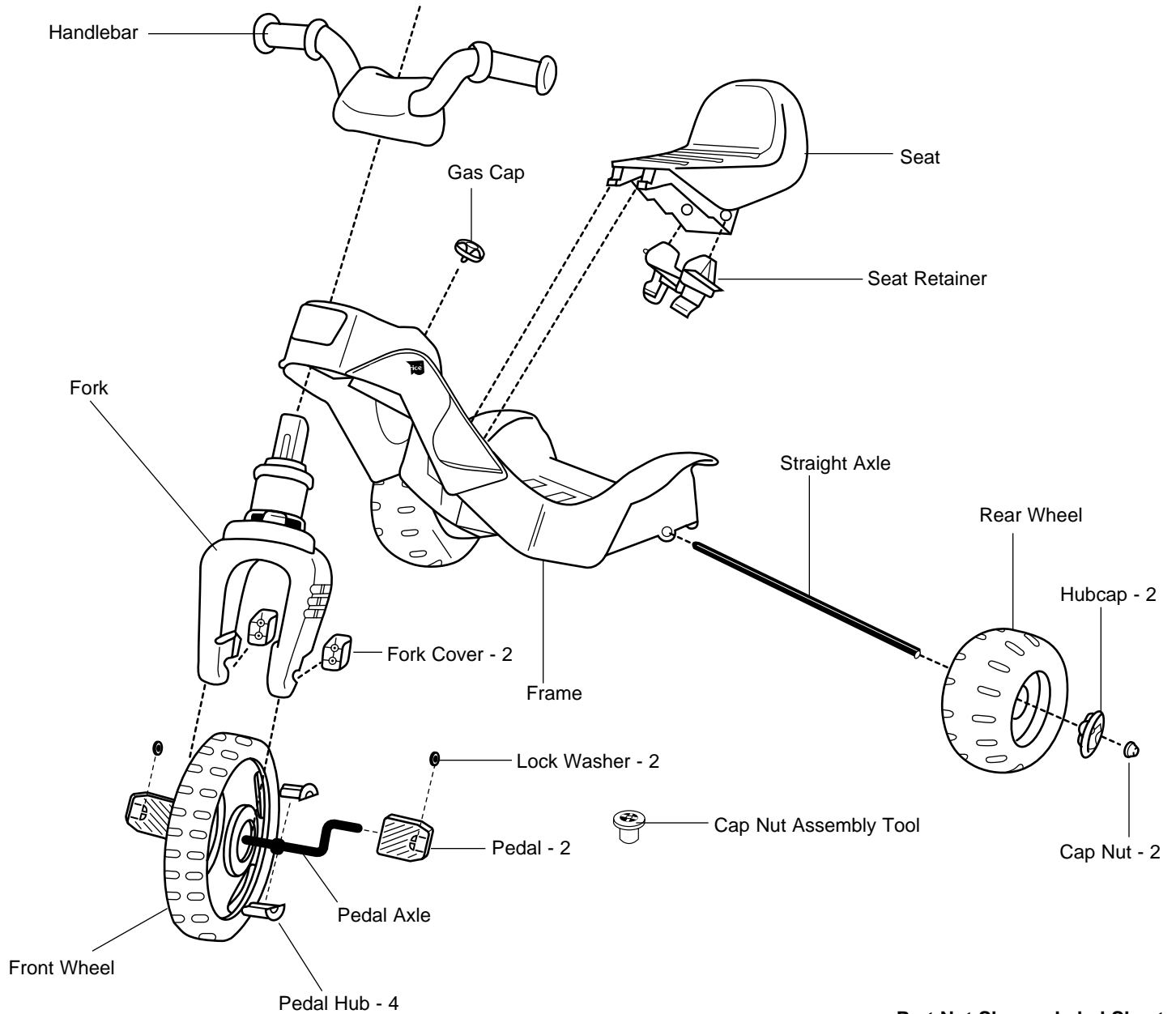

Assembly

1

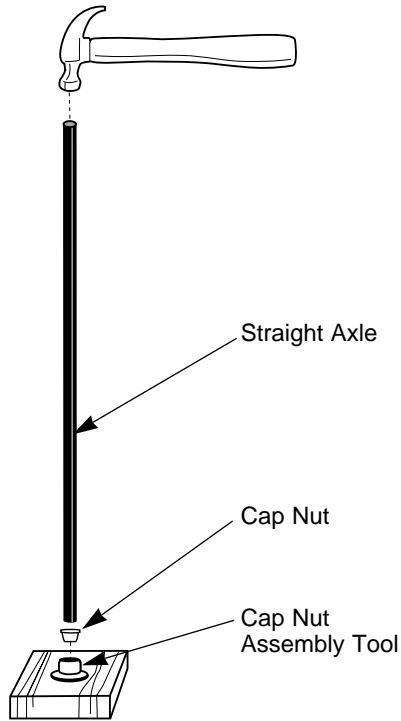

- Place a scrap block of wood on a flat surface.
- Fit a cap nut into the cap nut assembly tool.
- Place one end of the straight axle into the cap nut.
- Tap the end of the straight axle with a hammer. **Make sure the cap nut is securely attached to the straight axle.**
- Remove the cap nut assembly tool from the cap nut.

2

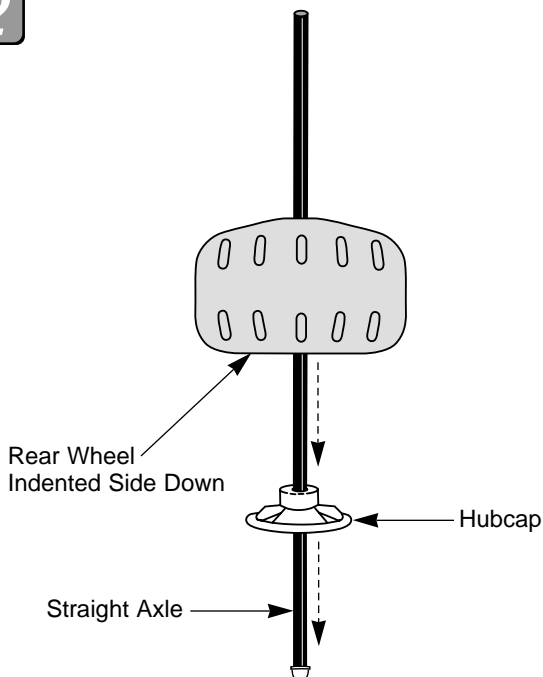

- Slide a hubcap (peg side up) onto the straight axle.
- Slide a rear wheel (indented side down) onto the straight axle.

3

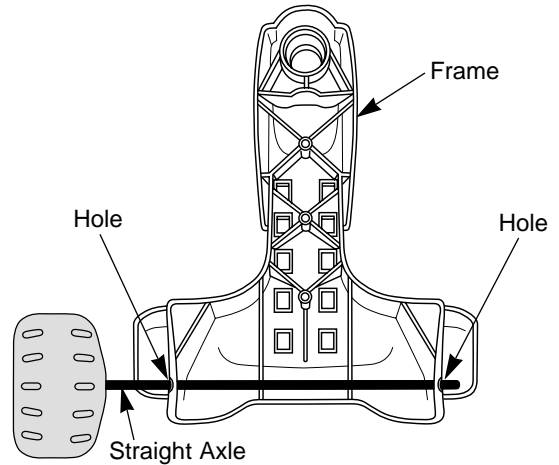

Bottom View

- Turn the frame upside down.
- Insert the straight axle through the holes in the rear of the frame.

4

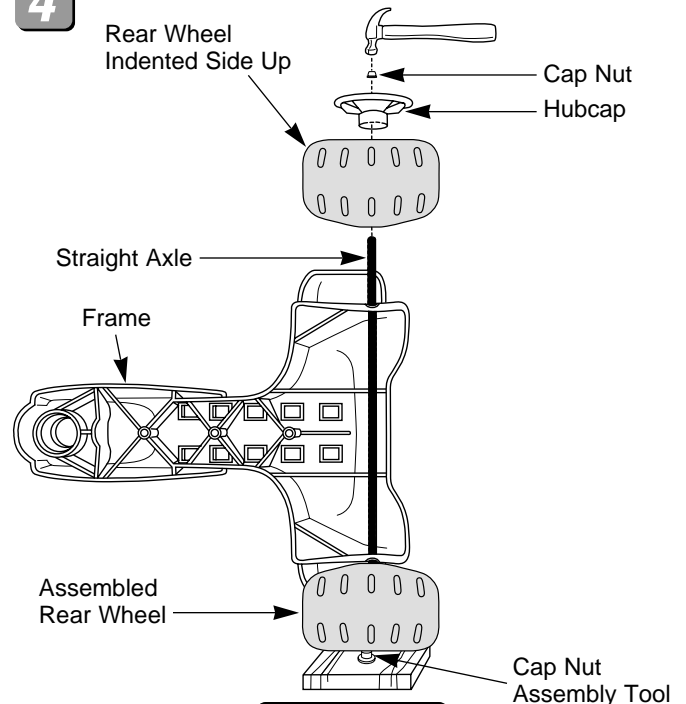

Bottom View

- Place a scrap block of wood on a flat surface.
 - Turn the frame on its side with the exposed end of the straight axle up.
 - Place the cap nut assembly tool under the assembled rear wheel and onto the cap nut.
 - Slide a rear wheel (indented side up) onto the end of the straight axle.
 - Slide a hubcap (peg side down) onto the straight axle.
 - Place a cap nut on the end of the straight axle.
 - Tap the cap nut with a hammer. **Gently pull the rear wheel up to be sure the cap nut is securely attached to the straight axle.**
 - Dispose of the cap nut assembly tool properly.
- 4 • Set the frame assembly aside.

Assembly

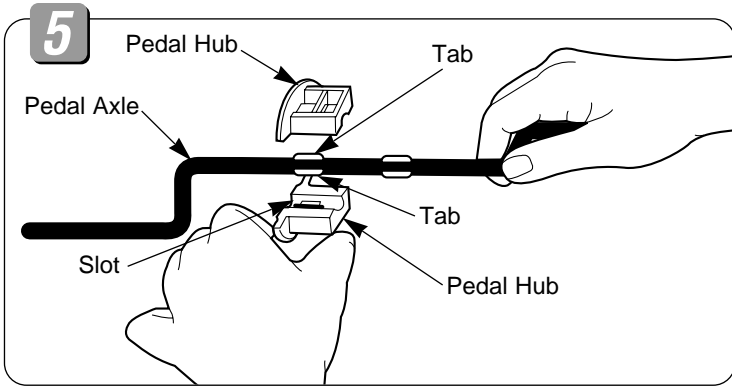

- Fit two pedal hubs onto the pedal axle tabs. Make sure the tabs fit into the slot in each pedal hub.

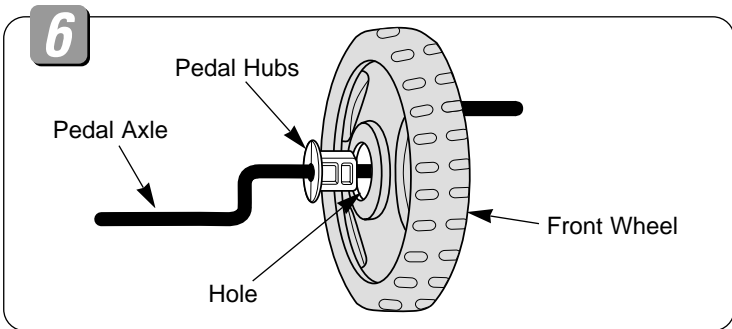

- While holding the pedal hubs on the pedal axle, insert the pedal axle through the hole in the center of the front wheel.

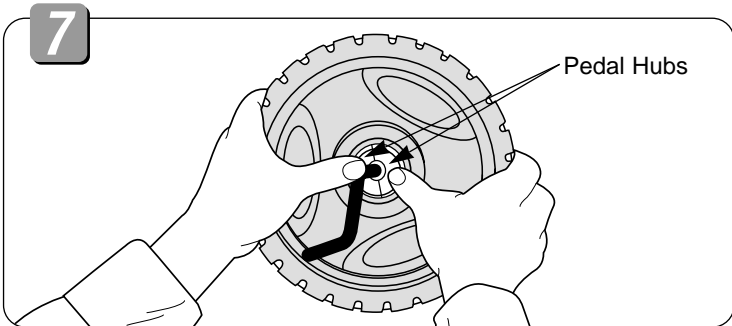

- Push the pedal hubs into the center of the front wheel until they are flush with the surface of the front wheel.

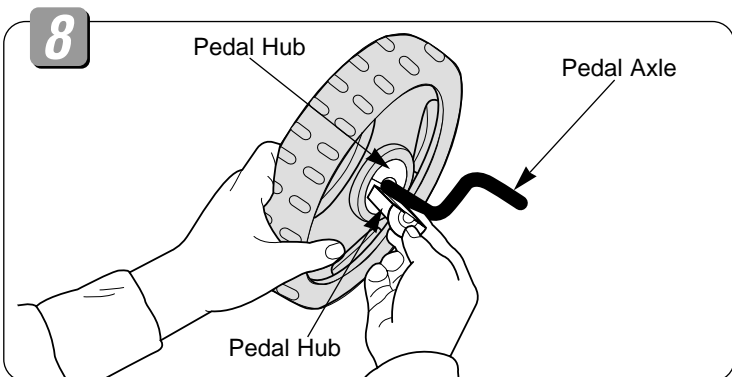

- Turn the front wheel assembly over.
- Insert a pedal hub onto the top of the pedal axle and into the hole in the center of the front wheel.
- Insert the remaining pedal hub below the pedal axle and into the hole in the center of the front wheel.

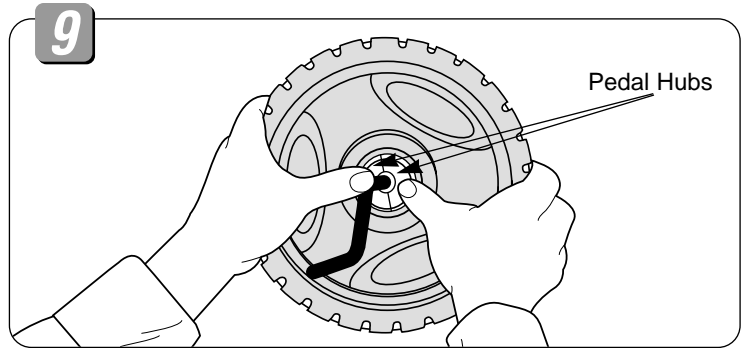

- Push the pedal hubs into the center of the front wheel until they are flush with the surface of the front wheel.

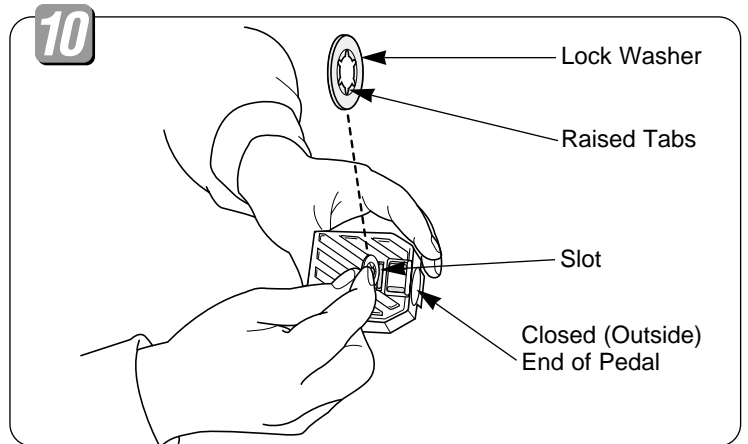

- Insert a lock washer into the slot in the pedal. Make sure the raised tabs on the lock washer are facing the "closed" or outside end of the pedal.
- Insert the other lock washer into the other pedal.

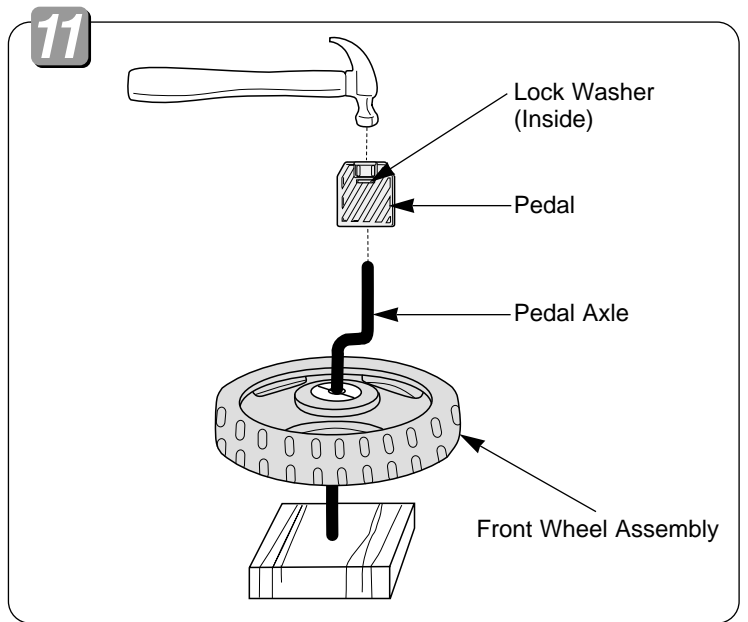

- Place a scrap block of wood under the front wheel assembly.
- Fit a pedal on the pedal axle.
- With the lock washer centered over the pedal axle end, tap the pedal with a hammer until it is secure.
- Repeat this procedure to attach the other pedal to the other end of the pedal axle.

Assembly

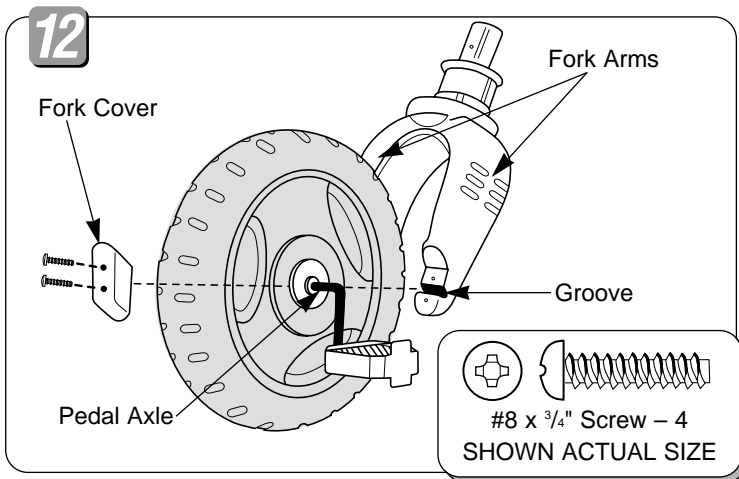

- Place the front wheel assembly between the fork arms. Make sure the pedal axle fits into the groove at the bottom of each fork arm.
- Place a fork cover over the pedal axle on one fork arm.
- Insert two #8 x 3/4" screws through the fork cover and into the fork arm. Tighten the screws with a Phillips screwdriver. Do not over-tighten.
- Repeat this procedure to attach the other fork cover to the other fork arm.

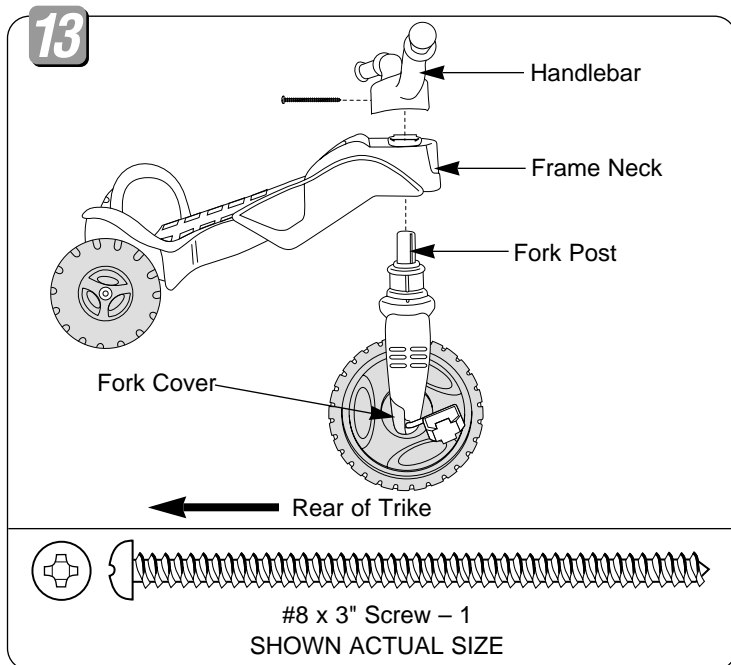

- Turn the frame upright.
- Insert the fork post up through the hole in the neck of the frame. **Make sure the fork is positioned so that the fork covers face the rear wheels.**
- Place the handlebar over the fork post and push it down onto the frame. Make sure the handlebar is positioned so that the screw hole faces the rear wheels and aligns with the screw hole in the fork post.

Hint: You may need to rotate the handlebar to align the holes.

- Insert the #8 x 3" screw through the hole in the handlebar and into the fork post. Tighten the screw with a Phillips screwdriver. Do not over-tighten.

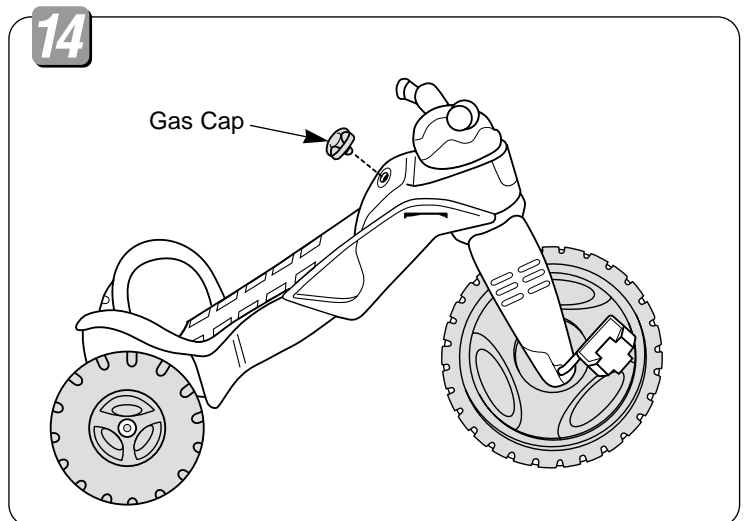

- Insert and **"snap"** the gas cap into the hole in the frame.

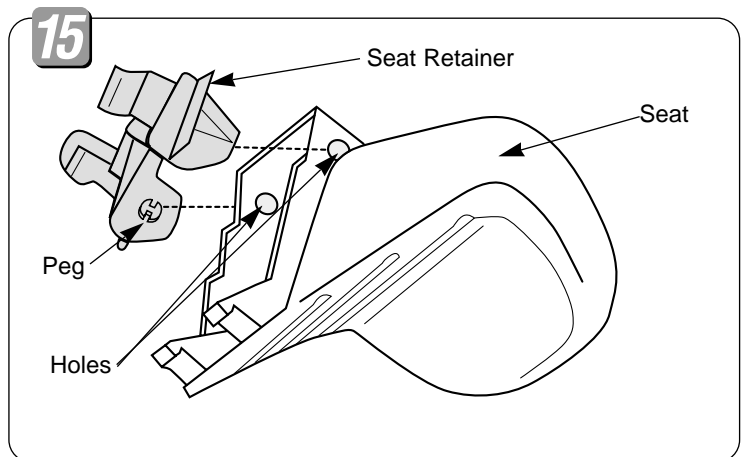

- Position the seat upside down.
- Fit the small pegs on the seat retainer into the holes in the seat.

One-time assembly is now complete.

Label Decoration

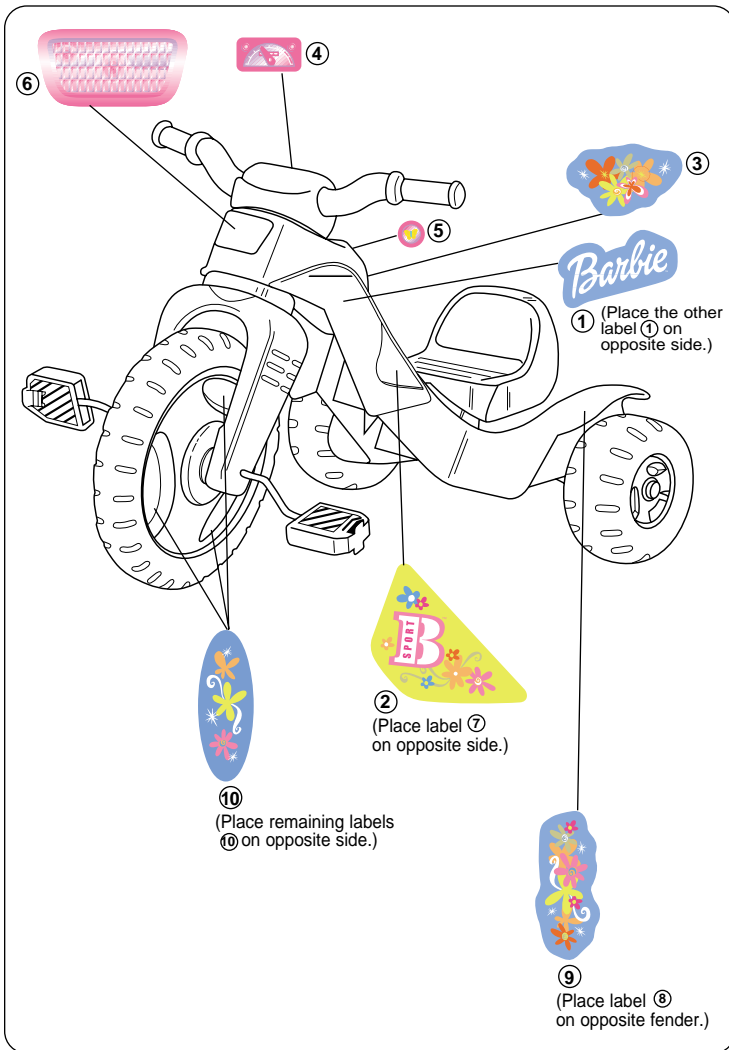

Proper label application will help to keep the labels looking their best!

- Wash your hands before applying the labels.
- Make sure the areas where the labels will be applied are clean and dry. Wipe your vehicle with a clean, soft, dry cloth to remove any dust or oils.
- For best results, avoid applying a label more than once.
- Apply the labels as shown in the illustration above.
- After applying a label, rub the label firmly with a cloth to make sure the label is adhered to your vehicle.

Attaching the Seat

Hint: The seat can be attached to the frame in any of three positions, depending on the size of your child. Check your child's fit on the BARBIE™ Grow-With-Me Trike by observing the seat to pedal distance, as it is being ridden. If the pedals seem too far away or too close for your child, move the seat up or down.

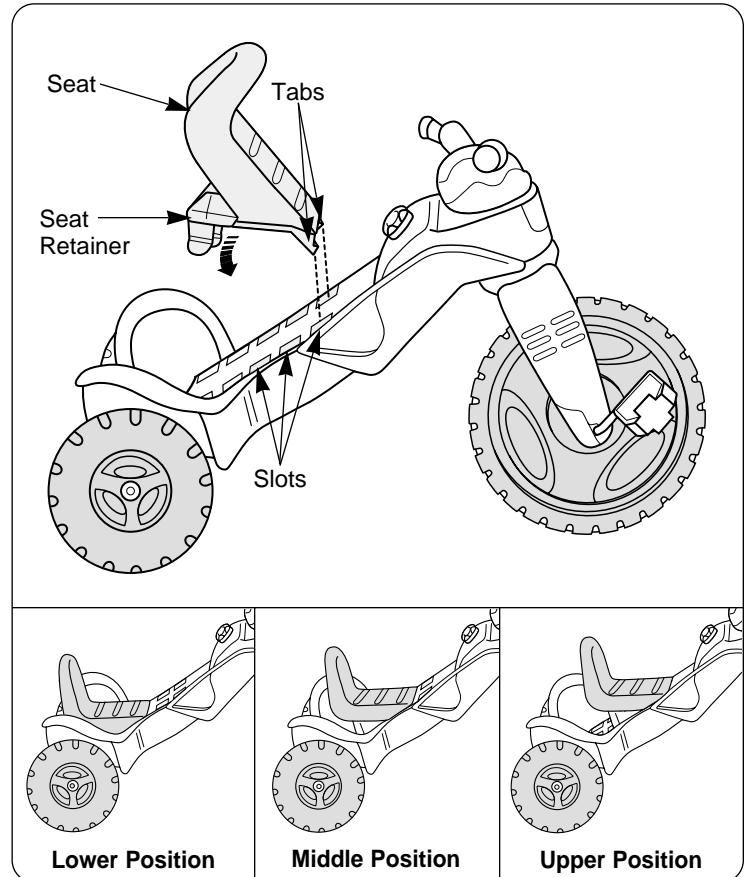

- At an angle, insert the tabs on the seat into any of the top three sets of slots for the lower, middle or upper position.
- Lower the seat so that the seat retainer inserts and snaps into the slots in the frame.
- Pull up on the seat to be sure it is secure.

Removing the Seat

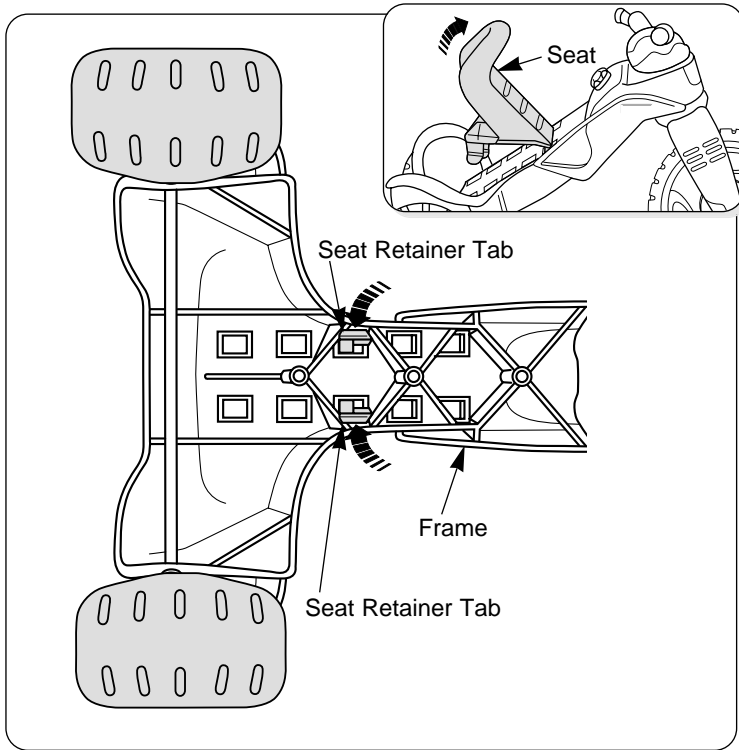

- Turn the frame on its side.
- Squeeze the seat retainer tabs toward one another and lift the seat from the frame.

Maintenance

- Check the plastic parts regularly and if broken or cracked, dispose of them properly.
- Check all fasteners regularly to be sure they are tight. If the fasteners are not tight, tighten them as necessary.
- To clean the BARBIE™ Grow-With-Me Trike, use a mild soap and water solution and a clean cloth. Rinse clean with water to remove soap residue.

Three (3) Year Limited Warranty

Mattel, Inc., (636 Girard Avenue, East Aurora, New York 14052), warrants to the original owner that the BARBIE™ Grow-With-Me Trike is free from all defects in material and workmanship when used under normal conditions for a period of three (3) years from the date of purchase. This warranty does not cover color fading of the product or product parts, or damage from excessive abuse or acts of God.

Should the product fail to perform properly, we will repair or replace it at our option, free of charge. Purchaser is responsible for shipping the product to Fisher-Price Consumer Relations at the address indicated above and for all associated freight and insurance cost. Fisher-Price, Inc. will bear the cost of shipping the repaired or replaced item to you. This warranty is void if the owner repairs or modifies the product. This warranty excludes any liability other than that expressly stated above including but not limited to any incidental or consequential damages.

SOME STATES DO NOT ALLOW THE EXCLUSION OR LIMITATION OF INCIDENTAL OR CONSEQUENTIAL DAMAGES, SO THE ABOVE LIMITATION OR EXCLUSION MAY NOT APPLY TO YOU.

THIS WARRANTY GIVES YOU SPECIFIC LEGAL RIGHTS, AND YOU MAY ALSO HAVE OTHER RIGHTS WHICH MAY VARY FROM STATE TO STATE.

Consumer Information

Questions? We'd like to hear from you!

Call Fisher-Price® Consumer Relations, toll-free at **1-800-432-KIDS**, 8 AM - 6 PM EST Monday through Friday. Hearing-impaired consumers using TTY/TDD equipment, please call 1-800-382-7470. Or, write to: Fisher-Price® Consumer Relations, 636 Girard Avenue, East Aurora, New York 14052.

For other countries, outside the United States:

Canada: call **1-800-567-7724**, or write to: Mattel Canada Inc, 6155 Freemont Blvd., Mississauga, Ontario L5R 3W2.

Great Britain: telephone 01628 500303.

Australia: Mattel Australia Pty. Ltd., 658 Church Street, Locked Bag #870, Richmond, Victoria 3121 Australia. Consumer Advisory Service 1300 135 312.

New Zealand: 16-18 William Pickering Drive, Albany 1331, Auckland.

www.fisher-price.com