

**Fisher-Price®**

Model Number 72766

# **Little People®**

## **Home Sweet Home™**

**Please save these instructions for future reference.**

**Adult assembly is required to install batteries.**

**Tools needed to install batteries: Phillips Screwdriver.**

**This product requires three, size "AAA" (LR03) alkaline batteries (not included).**



[www.fisher-price.com](http://www.fisher-price.com)

Fisher-Price, Inc., a subsidiary of Mattel, Inc., East Aurora, NY 14052 U.S.A.

©1999 Mattel, Inc. All Rights Reserved. ® and ™ designate U.S. trademarks of Mattel, Inc.

## Let's Open the House!

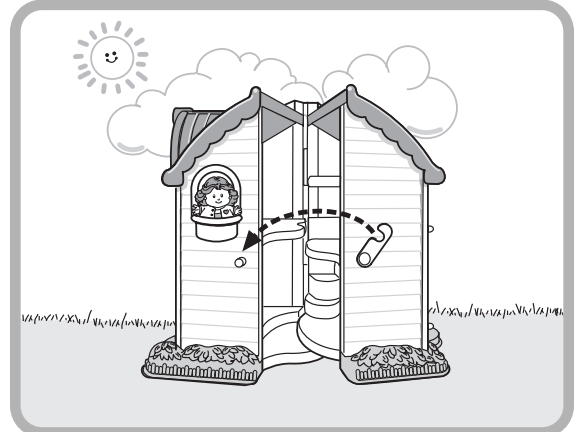
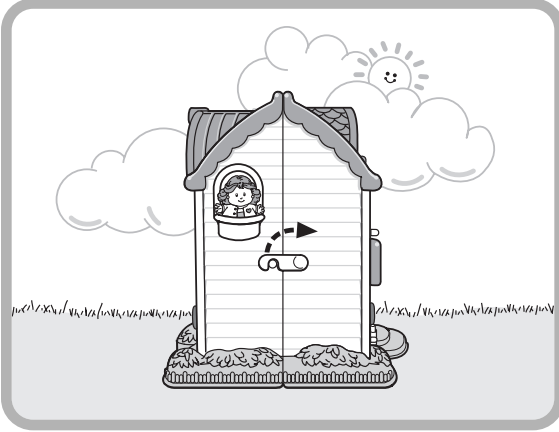

- When it's time to play, lift the latch to open the house.
- When playtime's over, place all of the accessory pieces inside the house. Close the house and lower the latch.

## Let's Decorate the House!

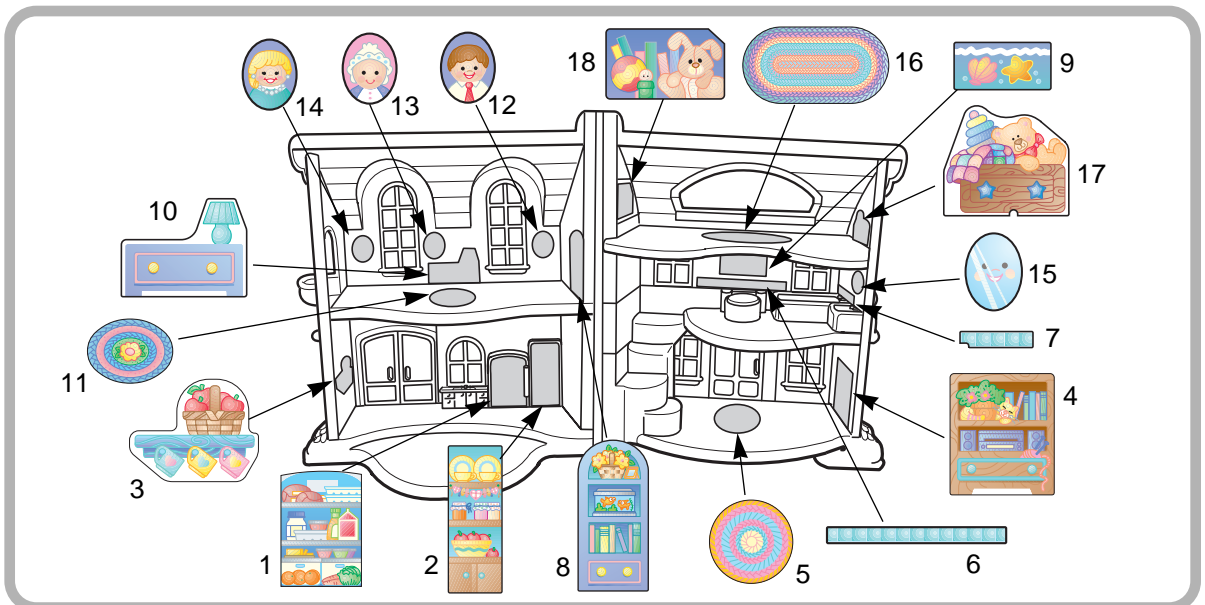

**Proper label application will help to keep the labels looking their best!**

- Make sure the areas where the labels will be applied are clean and dry. Wipe this product with a clean, soft, dry cloth to remove any dust or oils.
- For best results, do not attempt to apply a label more than once.
- Apply the labels as shown in the illustration above.

## Battery Installation

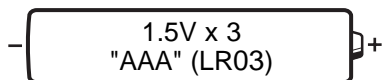

**SHOWN ACTUAL SIZE**

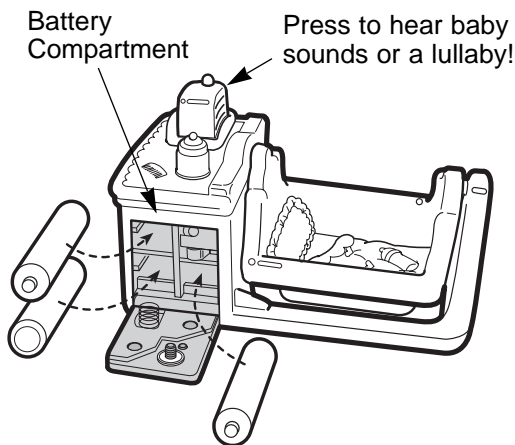

- Loosen the screw in the nursery battery compartment door with a Phillips screwdriver.
- Lift to open the battery compartment door.
- Insert three, size "AAA" (LR03) alkaline batteries as indicated inside the battery compartment.
- Replace the battery compartment door and tighten the screw with a Phillips screwdriver. Do not over-tighten.

### Battery Tips

- Do not mix old and new batteries.
- Do not mix different types of batteries: alkaline, standard (carbon-zinc) or rechargeable (nickel-cadmium).
- Remove the batteries during long periods of non-use. Always remove exhausted batteries from the toy. Battery leakage and corrosion can damage the toy.
- Never short circuit the battery terminals.

- Non-rechargeable batteries are not to be recharged.
- Only batteries of the same or equivalent type as recommended in the "Battery Installation" instructions are to be used.
- If removable rechargeable batteries are used, they are only to be charged under adult supervision.
- Rechargeable batteries are to be removed from the toy before they are charged.
- If you use a battery charger, it should be examined regularly for damage to the cord, plug enclosure and other parts. Do not use a damaged battery charger until it has been properly repaired.

### CAUTION

Please keep small parts, and plastic bags out of children's reach.  
Dispose of plastic bags properly.

## Re-Attaching the Toilet Seat

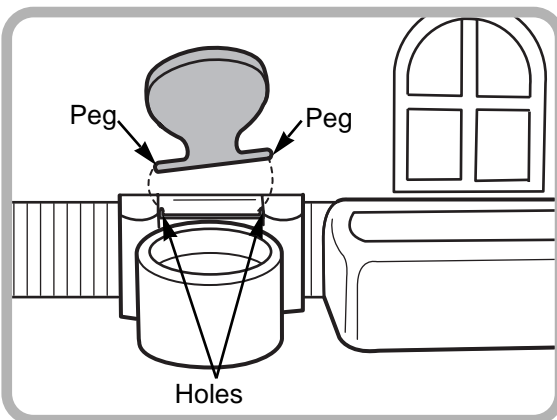

If the toilet seat comes off the toilet, simply re-attach it.

- Insert the peg on one side of the toilet seat into the hole at the back of the toilet.
- Insert the other peg on the toilet seat into the other hole in the back of the toilet.

## Re-attaching the Front and Back Doors

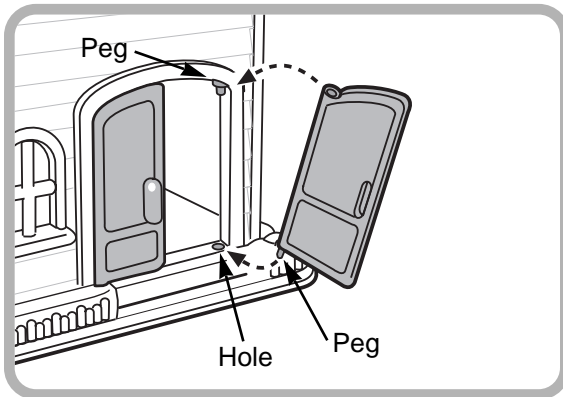
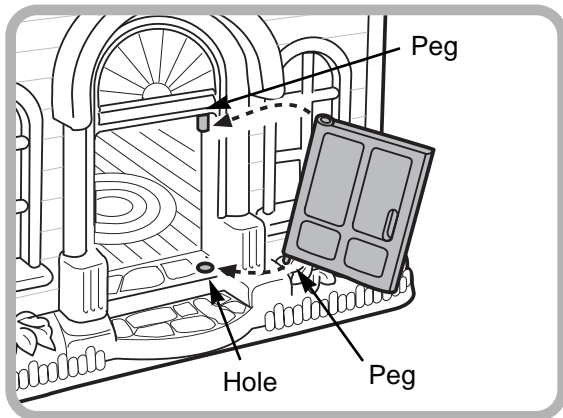

If the front or back doors come off, simply re-attach them.

- Insert the peg on the bottom of the door into the hole in the bottom of the doorway.
- Press down on the door as you snap the peg on the top of the doorway into the hole in the hole of the door.

## Re-attaching the Refrigerator Door

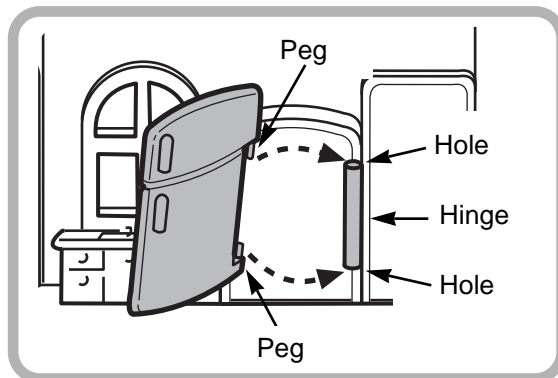

If the refrigerator door comes off, simply re-attach it.

- Insert the peg near the top of the refrigerator door into the top hole in the refrigerator door hinge.
- Snap the peg near the bottom of the refrigerator door into the bottom hole in the refrigerator door hinge.

## FCC Note (United States Only)

**Note:** This equipment has been tested and found to comply with the limits for a Class B digital device, pursuant to Part 15 of the FCC Rules. These limits are designed to provide reasonable protection against harmful interference in a residential installation. This equipment generates, uses and can radiate radio frequency energy and, if not installed and used in accordance with the instructions, may cause harmful interference to radio communications. However, there is no guarantee that interference will not occur in a particular installation. If this equipment does cause harmful interference to radio or television reception, which can be determined by turning the equipment off and on, the user is encouraged to try to correct the interference by one or more of the following measures:

- Reorient or relocate the receiving antenna.
- Increase the separation between the equipment and receiver.
- Consult the dealer or an experienced radio/TV technician for help.