



Aquatic Rescue Command Center™

Product Number 78157

We've Made a Change!

This product now has a power switch.

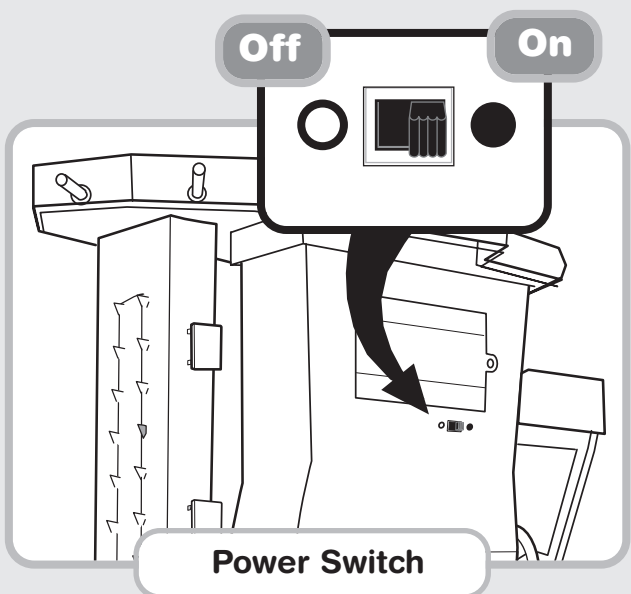

- Locate the power switch on the back of the message center.
- Slide the switch to the ● position to turn the toy on. When you're finished, slide the switch to the off ○ position.

NOTE: Static electricity may temporarily stop the electronic function of this toy. For example, walking across the rug and touching this toy or sliding Voice Tech™ Video Cards in and out of the message center. To reset the toy, slide the power switch to the off position ○ and then back on ● again.



Fisher-Price, Inc., a subsidiary of Mattel, Inc., East Aurora, NY 14052 U.S.A.
© 2001 Mattel, Inc. All Rights Reserved. ® and ™ designate U.S. trademarks of Mattel, Inc.

Printed in Mexico
78157pr-0921