

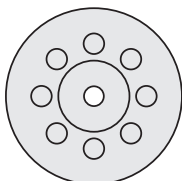

Removing and Replacing the Rear Wheel

Speed Control Wheels

These wheels should be installed for beginners. These wheels are designed to slow the skates down, giving beginners extra control.



Note: The speed control wheel is designed with “built-in” resistance that may “squeak” when your beginner skates.

High-Performance Wheels

These wheels can be installed for more experienced skaters.

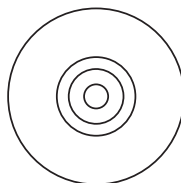

1

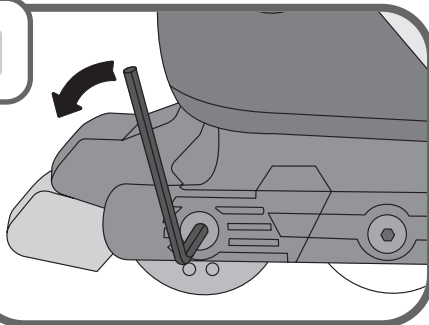

- Loosen the screw on the rear wheel of a skate with an Allen wrench (included). Remove the screw.

2

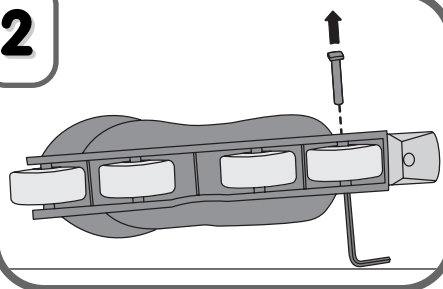

- Insert the end of an Allen wrench into the hole.
- Place the skate on its side on a hard surface as shown. Be sure the Allen wrench is facing down.

IMPORTANT! Do not place the skate on a surface that might be damaged by the Allen wrench. Place a cloth on the surface for additional protection.

- Push down on the skate so that the Allen wrench pushes out the barrel nut (axle) from skate.

Removing and Replacing the Rear Wheel

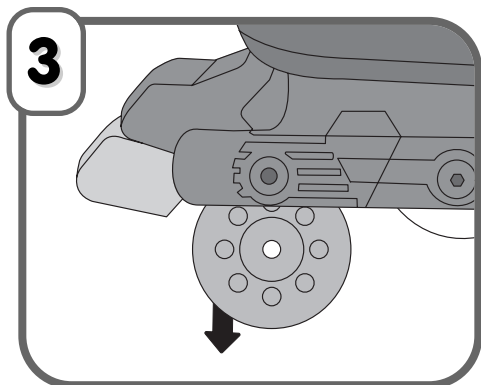

- Pull to remove the wheel.
- Fit the desired wheel back into the skate.

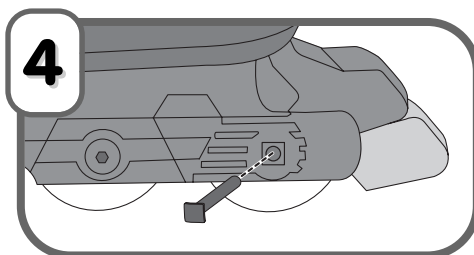

- Turn the skate so that the square recessed area is facing you.
- Insert the barrel nut (axle) into the hole. Press the barrel nut (axle) fully into the square recessed area. Be sure that the square head is flush with the side of the skate.

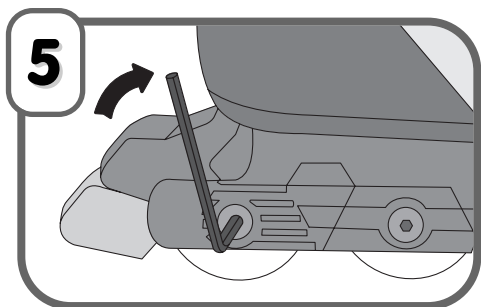

- Turn the skate over and insert the screw into the opposite hole. Tighten the screw with an Allen wrench. Do not over-tighten.