



Please keep these instructions for future reference as they contain important information.

CONTENTS



TO ASSEMBLE

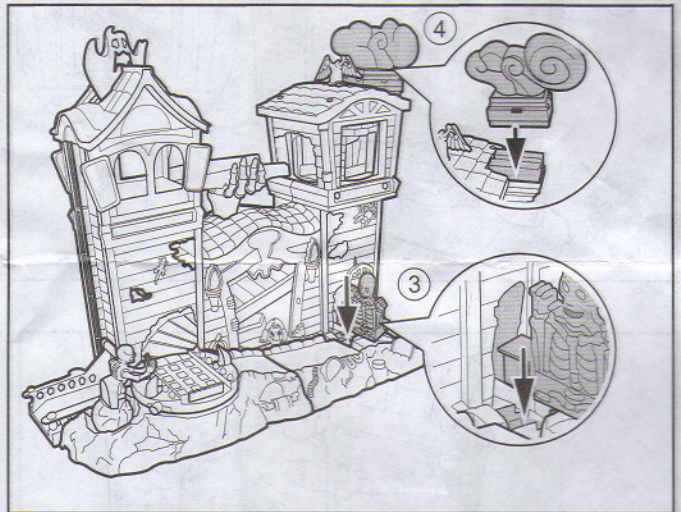
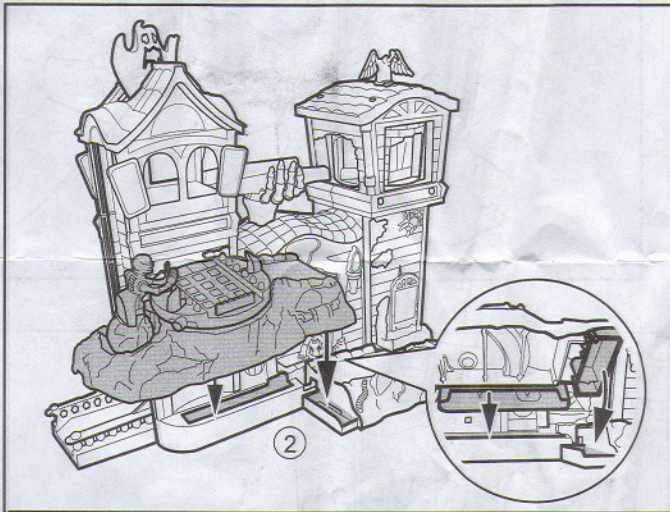
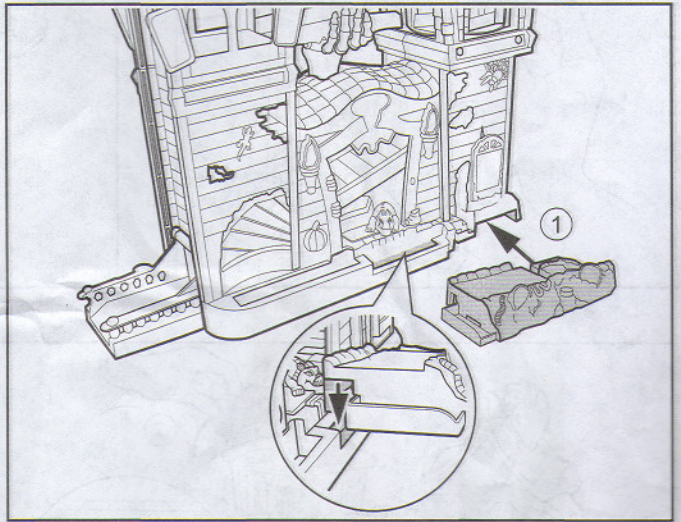

HOW TO PLAY

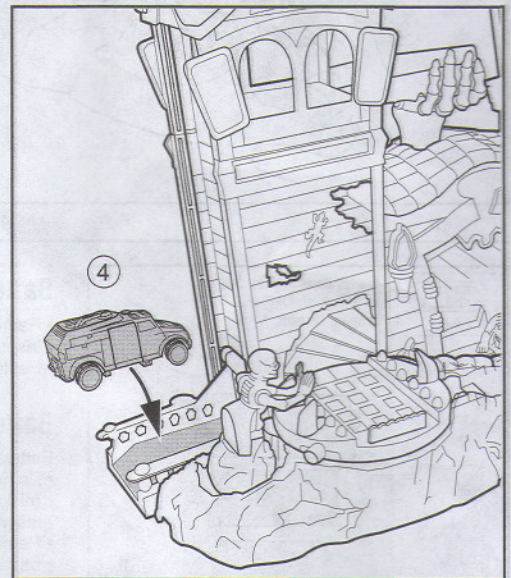
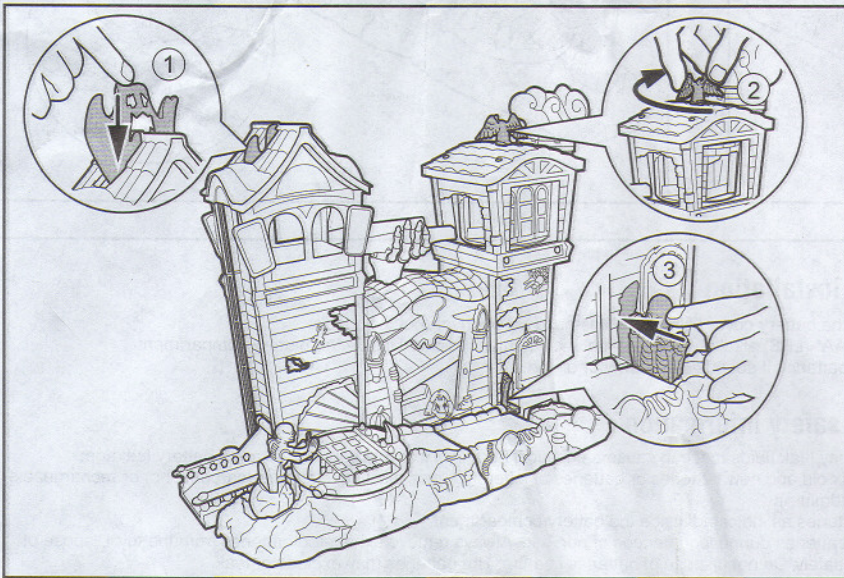

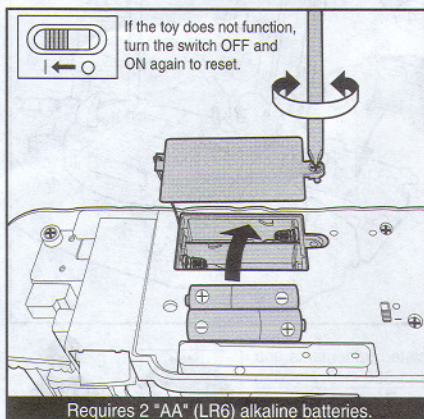
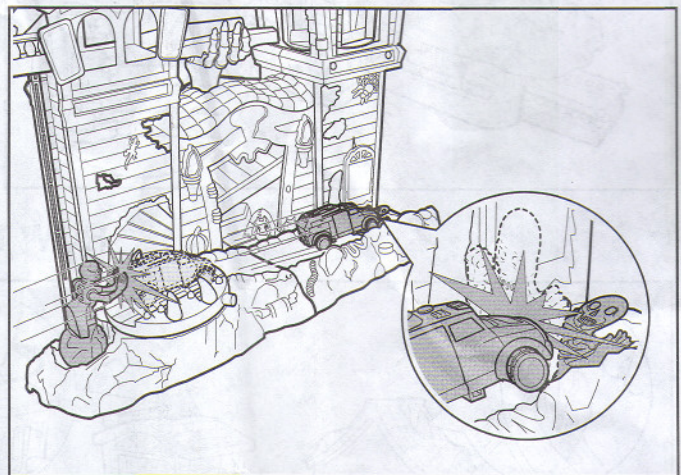
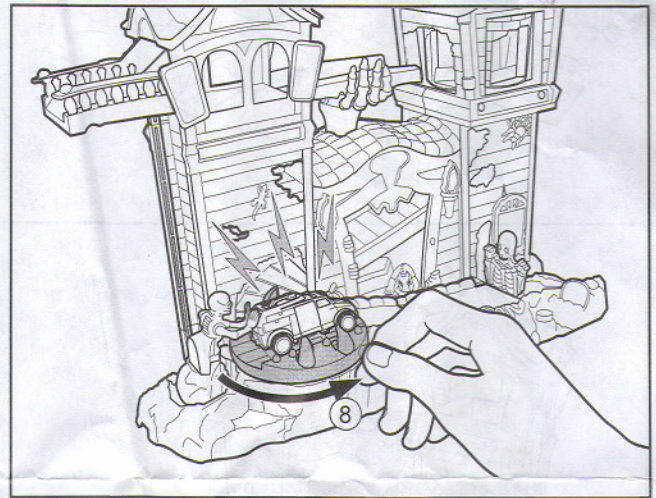
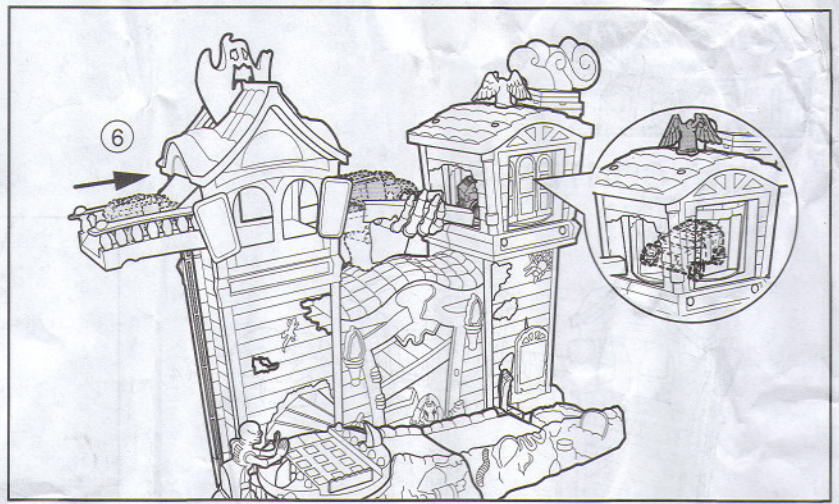
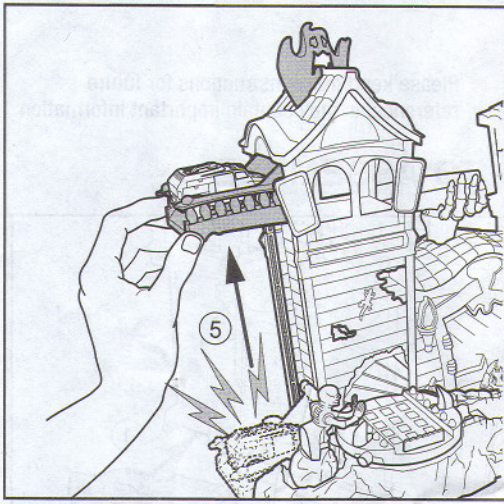

Battery installation

- Remove the battery cover using a Phillips-head screwdriver (not included).
- Insert 2 "AA" (LR6) alkaline batteries (not included) as indicated inside the battery compartment.
- Replace batteries if sounds play slowly or distort.

Battery safety information

- Batteries may leak fluids that can cause a chemical burn injury or ruin your toy. To avoid battery leakage:
- Do not mix old and new batteries or batteries of different types: alkaline, standard (carbon-zinc) or rechargeable (nickel-cadmium).
 - Insert batteries as indicated inside the battery compartment.
 - Remove batteries during long periods of non-use. Always remove exhausted batteries from the toy. Dispose of batteries safely. Do not dispose of batteries in a fire. The batteries may explode or leak.
 - Never short-circuit the battery terminals.
 - Use only batteries of the same or equivalent type, as recommended.
 - Do not charge non-rechargeable batteries.
 - Remove rechargeable batteries from the toy before charging.
 - If removable, rechargeable batteries are used, they are only to be charged under adult supervision.