

## Battery Replacement

Toy requires 3 replaceable AG13 (LR44) alkaline button cell batteries. Replace batteries when sound becomes distorted and/or lights become dim. To replace batteries, use a Phillips head screwdriver (not included) to open battery door. Remove and set aside. Insert 3 AG13 (LR44) alkaline button cell batteries as shown. Use either AG13 (LR44) alkaline button cell batteries or equivalent. Replace battery cover and screw closed.

**ATTENTION:** Non-alkaline batteries may not power this toy. Replace with alkaline batteries for longest life and best performance.

This equipment has been tested and found to comply with the limits for a Class B digital device, pursuant to part 15 of the FCC rules. These limits are designed to provide reasonable protection against harmful interference in a residential installation. This equipment generates, uses and can radiate radio frequency energy and, if not installed and used in accordance with the instructions, may cause harmful interference to radio communications. However, there is no guarantee that interference will not occur in a particular installation. If this equipment does cause harmful interference to radio or television reception, which can be determined by turning the equipment off and on, the

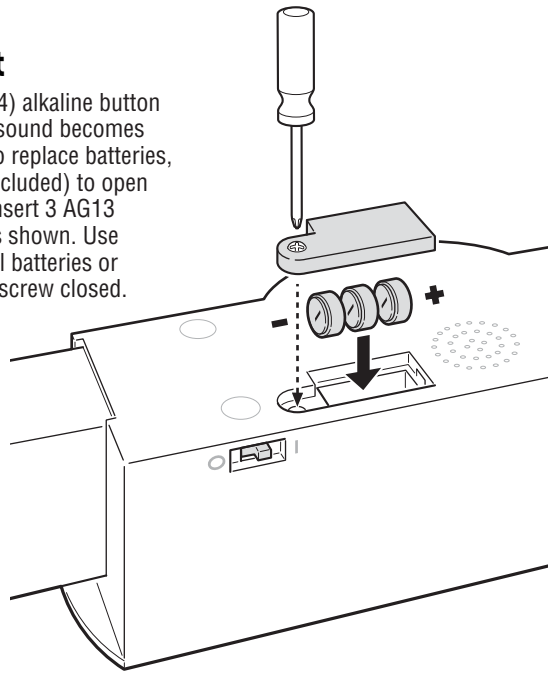

user is encouraged to try to correct the interference. Consult the dealer or an experienced radio/TV technician for help.

Mattel Inc.  
333 Continental Blvd.  
El Segundo, CA  
(310) 252-2000

### BATTERY SAFETY INFORMATION

- Do not mix old and new batteries or batteries of different types: alkaline, standard (carbon-zinc) or rechargeable (nickel-cadmium).
- Insert batteries as indicated inside the battery compartment.
- Remove batteries during long periods of non-use. Always remove exhausted batteries from the toy (product). Dispose of batteries safely.
- Never short-circuit the battery terminals.

- Use only batteries of the same or equivalent type, as recommended.
- Do not charge non-rechargeable batteries.
- Remove rechargeable batteries from the toy (product) before charging.
- If removable, rechargeable batteries are used, they are only to be charged under adult supervision.
- Never short-circuit the battery terminals.
- Do not dispose of this toy in a fire. The batteries inside may explode or leak.

When fashions become dry, use baby powder for lubrication.

### CONSUMER INFORMATION

**YOU CAN TELL IT'S MATTEL!**™ CALL us toll-free or write with any comments or questions about our products or service. Monday-Friday 8:00 a.m.-6:00 p.m. Eastern Time. Outside U.S.A., see telephone directory for Mattel listing.

Consumer Relations, Mattel, Inc.  
333 Continental Blvd.  
El Segundo, CA 90245 USA

**1 (800) 524-TOYS**

**WE ARE DEDICATED TO QUALITY PRODUCTS.**

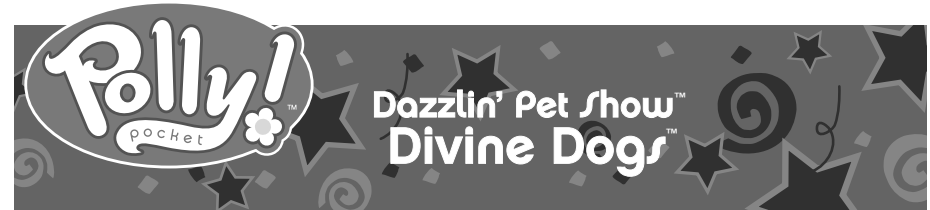

## INSTRUCTIONS

### CONTENTS

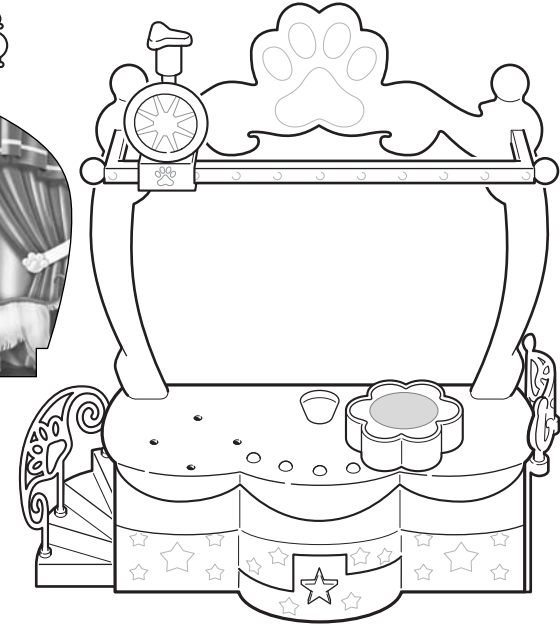
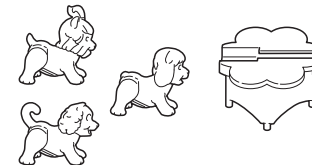

This product contains a magnet.  
Do not use around items that are sensitive to or affected by magnetic fields.

**WARNING:**  
**CHOKING HAZARD - Small parts.**  
Not for children under 3 years.

Colors and decorations may vary from those shown.

Please remove everything from the package and compare to the contents shown here.  
If any items are missing, please call 1-800-524-TOYS.



B7078-0920

Keep these instructions for future reference as they contain important information.

# Playing with Polly™ and the Dazzlin' Dog Show!

- 1.** Stage opens up. Left side includes a closet for clothes, right side is for grooming the dogs before a show, and center opens out for the winner's podium.

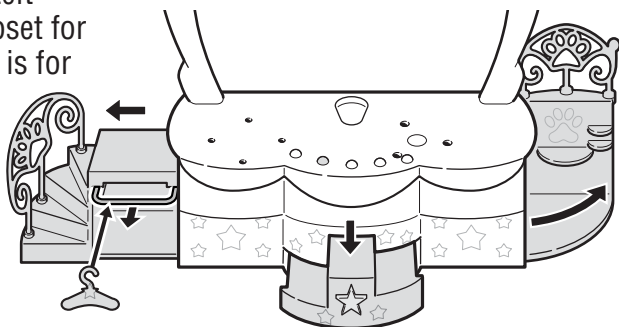

- 2.** Place the launching pad and doll stand on the stage, as shown.

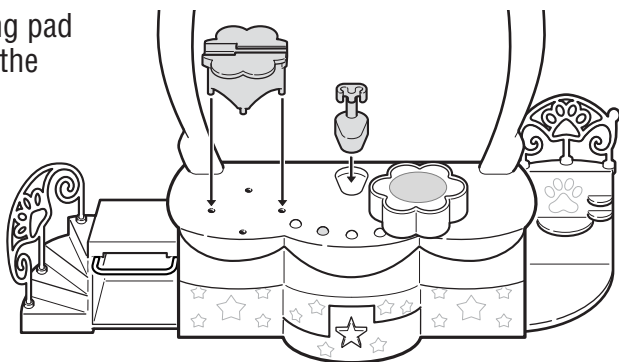

- 3.** Slide dog onto launching pad, as shown. Push the dog forward with your finger until the dog launches into the air, performing a flip. The dog lands on the landing pad, and a sound is heard.

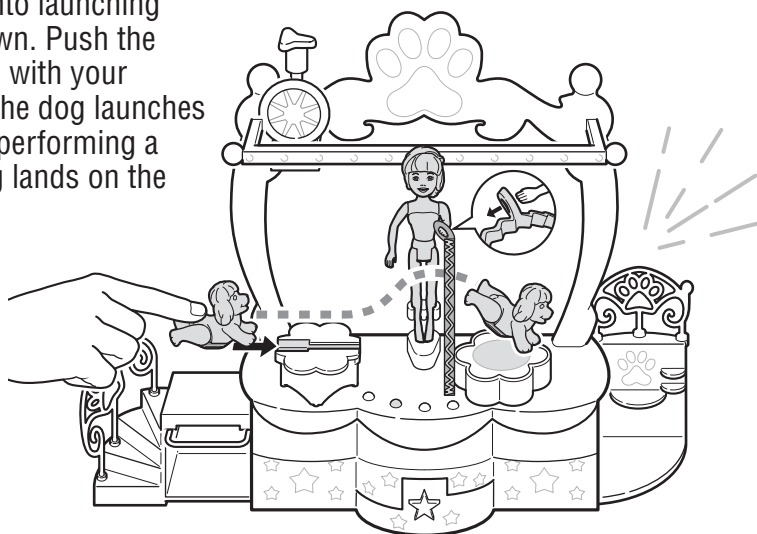

The doll holds a hoop for the dog to jump through.

## UNICYCLE

- Place a dog on the unicycle seat, and push across bar with finger.

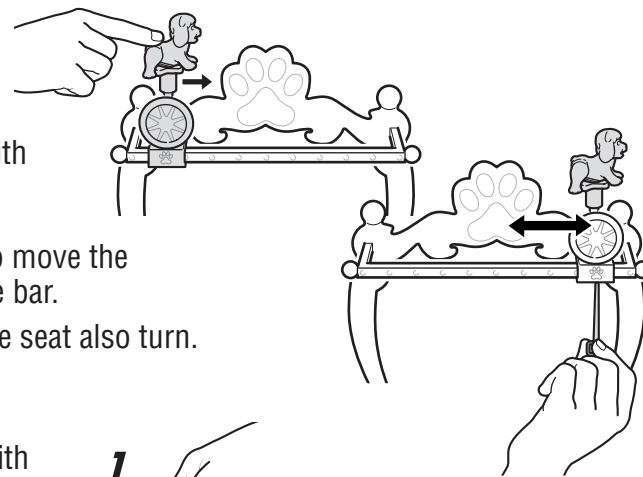

or

- Use magic wand to move the unicycle across the bar.

The dog and unicycle seat also turn.

## DOG BONE

- Place dog bone with tab into the dog's mouth. As you turn the dog bone over, the dog will flip over.
- Place the dog bone with tab near the dog's nose and raise the bone slightly to make the dog stand up.
- Place the dog bone end without the tab near the dog's nose. By moving the dog bone in a circle around the dog, the dog will spin in circles. Make sure the dog's hind legs are not touching the play surface so it can spin freely.

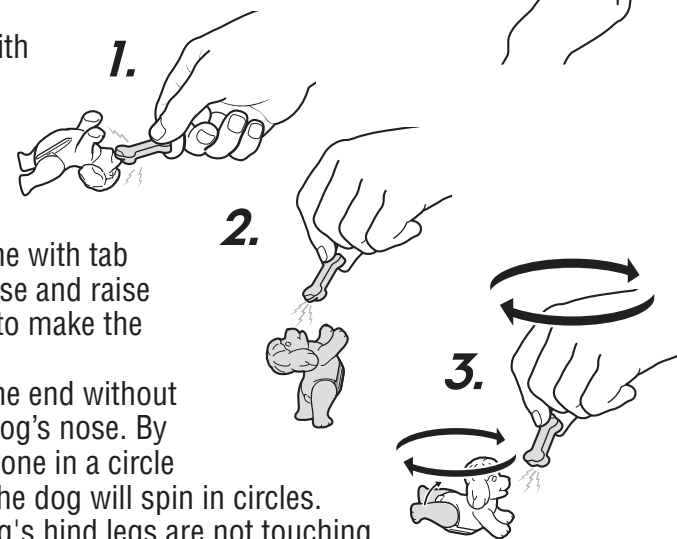

## WINNER'S PODIUM

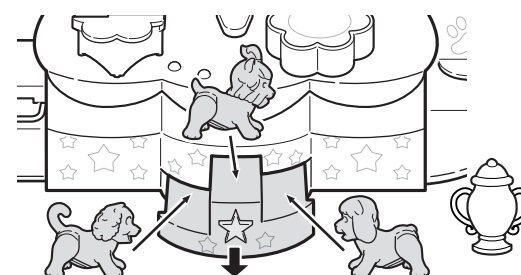

## CLOTHES FOR DOGS

