



Please keep this instruction sheet for future reference,
as it contains important information.

Maximum weight: 43 lbs. (19.5 kgs).

Ages: 12 months and up.

Requires three “AA” (LR6) **alkaline** batteries (not included) for operation.

Adult assembly is required for assembly.

Tool required for battery replacement: Phillips screwdriver (not included).

Adult supervision is required.



www.fisher-price.com

Musical Rocking Pony

Parts

CAUTION

This product contains small parts in its unassembled state.
Adult assembly is required.

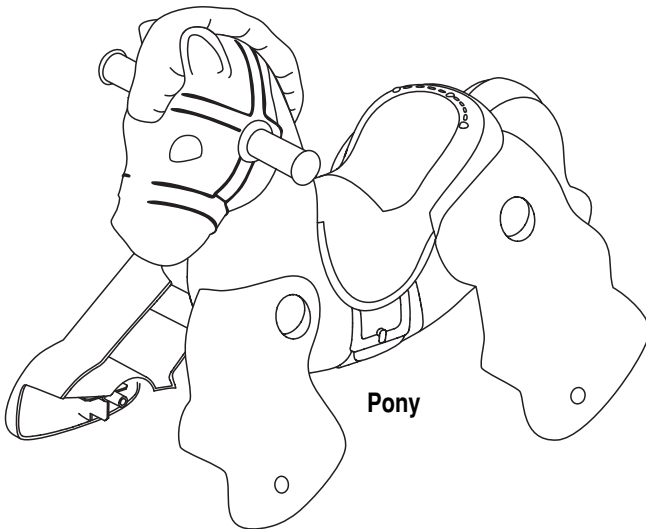

#8 x 1" Screw – 2



#8 x 2" Screw – 4

Fasteners Shown Actual Size

Note: Tighten or loosen all screws with a Phillips screwdriver. Do not over-tighten the screws.

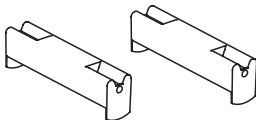

2 Rail Supports

Not Shown:
Label Sheet

4 Numbered Rail Halves

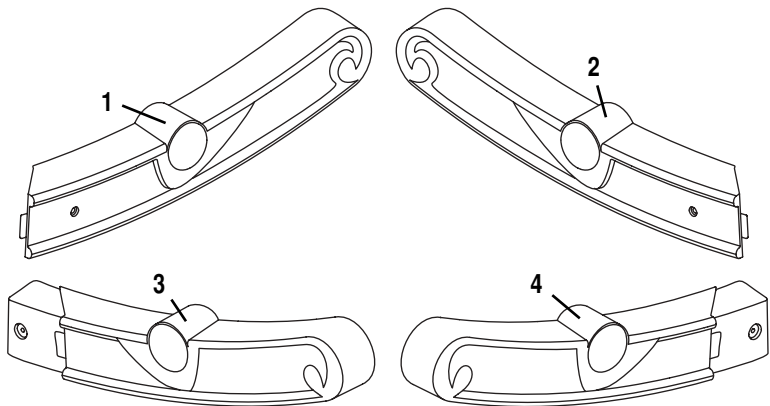

Assembly

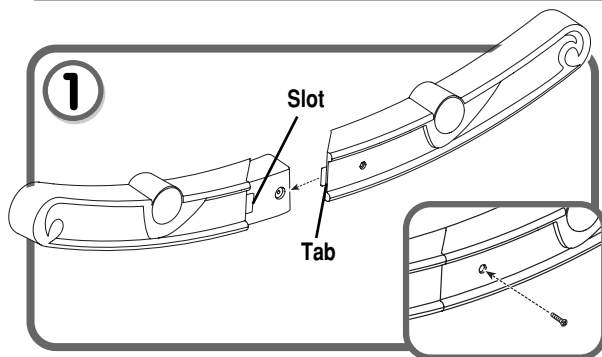

- Fit the tab on one rail half into the slot in the other.
- Insert a #8 x 1" screw into the rail assembly and tighten.
- Repeat this procedure to assemble the other rail.

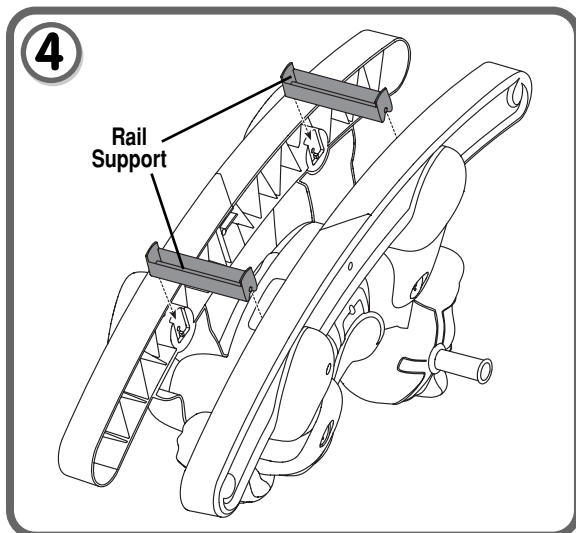

- While holding both rails in place, position the pony upside down.
- Slide the rail supports into the matching slots in each rail assembly as shown.

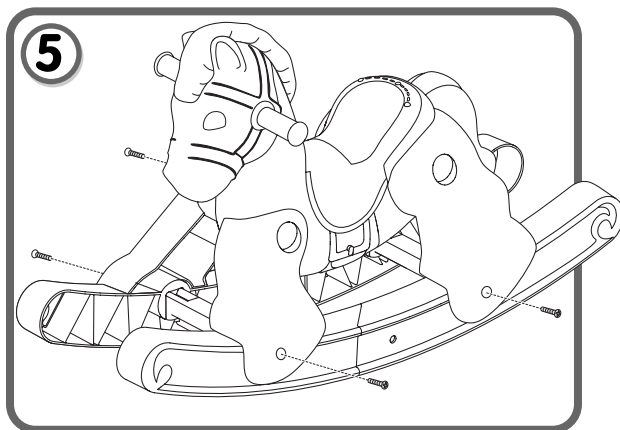

- Insert a #8 x 2" screw into each of the pony's feet and tighten the screws.
- Turn the pony upright.

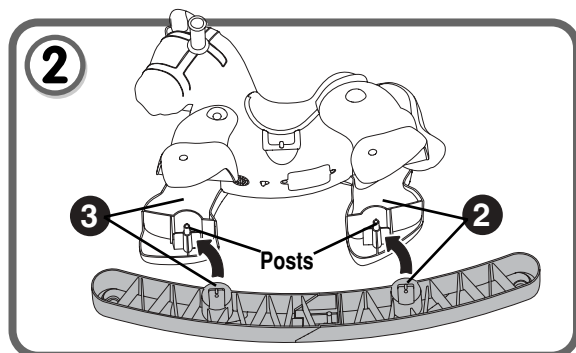

- Lay the pony on it's side so that it's head is facing to the left. Locate the numbers 2 and 3 inside the pony's feet.
- Locate the rail with matching numbers 2 and 3.
- Fit this rail onto the posts inside the pony's feet.

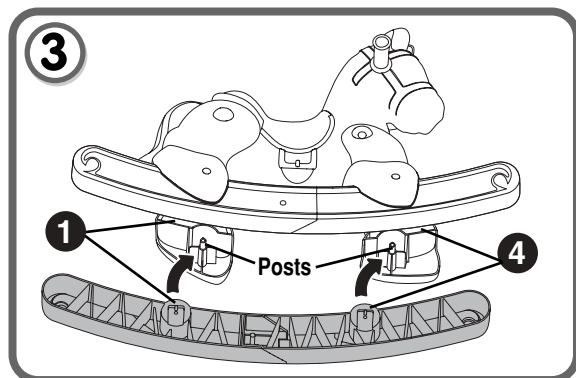

- While holding the rail in place, turn the pony over and fit the other rail in place with the numbers 1 and 4 to the posts with matching numbers 1 and 4.

Label Decoration

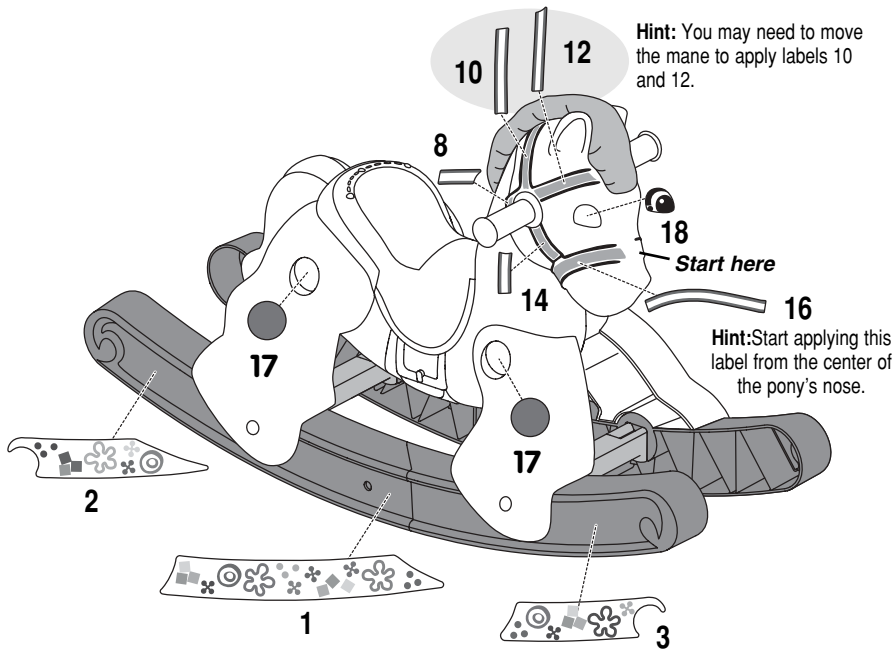
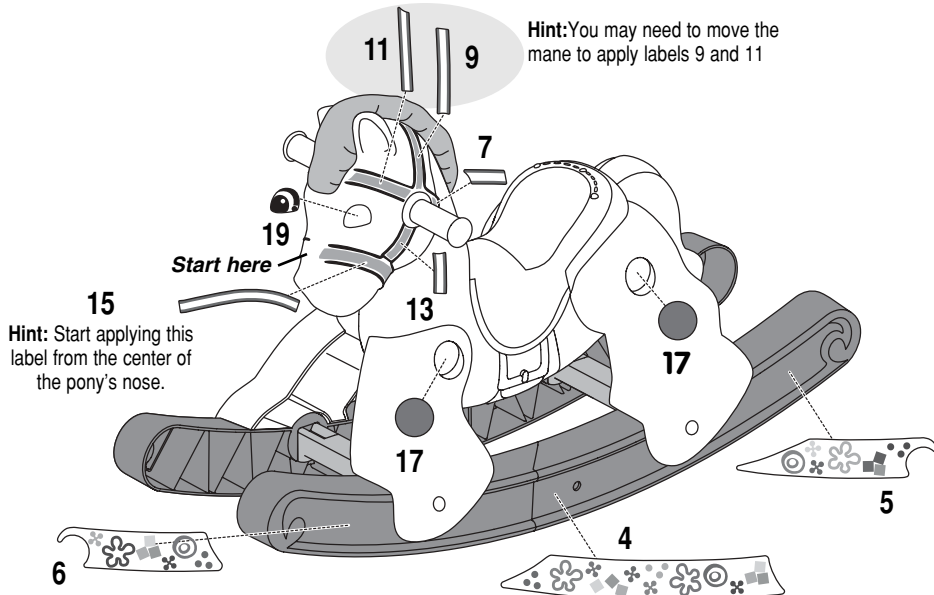

- Apply the labels as shown in the illustration.
- For best results, wash your hands before applying the labels and make sure the areas to which the labels will be applied are clean and dry. Avoid repositioning a label once it has been applied.

Battery Installation

Battery
Compartment
Door

Bottom View

- Locate the battery compartment on the outside of the pony.
- Loosen the screws in the battery compartment door. Remove the battery compartment door.
- Insert three “AA” (LR6) **alkaline** batteries.

Hint: We recommend using **alkaline** batteries for longer life.

- Replace the battery compartment door and tighten the screws with a Phillips screwdriver. Do not over-tighten.
- When sounds from this toy become faint or stop, it's time for an adult to change the batteries.

Battery Safety Information



1.5V x 3
“AA” (LR6)

Shown Actual Size

Batteries may leak fluids that can cause a chemical burn injury or ruin your toy. To avoid battery leakage:

- Do not mix old and new batteries or batteries of different types: alkaline, standard (carbon-zinc) or rechargeable (nickel-cadmium).
- Insert batteries as indicated on the battery compartment door.
- Remove batteries during long periods of non-use. Always remove exhausted batteries from the toy. Dispose of batteries safely. Do not dispose of batteries in a fire. The batteries may explode or leak.
- Never short-circuit the battery terminals.
- Use only batteries of the same or equivalent type, as recommended.
- Do not charge non-rechargeable batteries.
- Remove rechargeable batteries from the toy before charging.
- If removable, rechargeable batteries are used, they are only to be charged under adult supervision.

Rocking Fun!

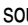
- Locate the power/volume switch on the underside of the pony.
- Slide the switch to the desired position: Off ; on with low volume ; or on with high volume .
- Rock the pony to hear riding tunes and pony sounds.

Power/Volume Switch



Consumer Information

Questions? We'd like to hear from you!

Call Fisher-Price® Consumer Relations, toll-free at **1-800-432-5437**, 8 AM - 6 PM EST Monday through Friday. Hearing-impaired consumers using TTY/TDD equipment, please call 1-800-382-7470.

Or, write to:

Fisher-Price® Consumer Relations
636 Girard Avenue
East Aurora, New York 14052, U.S.A.

For countries outside the United States:

CANADA

Questions? 1-800-567-7724, Mattel Canada Inc., 6155 Freemont Blvd., Mississauga, Ontario L5R 3W2.

GREAT BRITAIN

Mattel UK Ltd, Vanwall Business Park, Maidenhead SL6 4UB.
Helpline: 01628 500302.

AUSTRALIA

Mattel Australia Pty. Ltd., 658 Church Street, Locked Bag #870, Richmond, Victoria 3121 Australia. Consumer Advisory Service 1300 135 312.

NEW ZEALAND

16-18 William Pickering Drive, Albany 1331, Auckland.

ASIA

Mattel East Asia Ltd, Room 1106, South Tower, World Finance Centre, Harbour City, Tsimshatsui, HK, China.

Care

- Wipe the toy with a clean cloth dampened with a mild soap and water solution.
- Periodically, check the plastic parts and if broken or cracked, dispose of them properly.
- Periodically, check all fasteners regularly to be sure they are tight. If the fasteners are not tight, tighten them as necessary.

FCC Statement (United States Only)

Note: This equipment has been tested and found to comply with the limits for a Class B digital device, pursuant to Part 15 of the FCC Rules. These limits are designed to provide reasonable protection against harmful interference in a residential installation. This equipment generates, uses and can radiate radio frequency energy and, if not installed and used in accordance with the instructions, may cause harmful interference to radio communications. However, there is no guarantee that interference will not occur in a particular installation. If this equipment does cause harmful interference to radio or television reception, which can be determined by turning the equipment off and on, the user is encouraged to try to correct the interference by one or more of the following measures:

- Reorient or relocate the receiving antenna.
- Increase the separation between the equipment and receiver.
- Consult the dealer or an experienced radio/TV technician for help.

Note: Changes or modifications not expressly approved by the manufacturer responsible for compliance could void the user's authority to operate the equipment.