



4+



BCC95-0920

# ACTION ARENA

## INSTRUCTIONS

Keep these instructions for future reference as they contain important information.

### CONTENTS

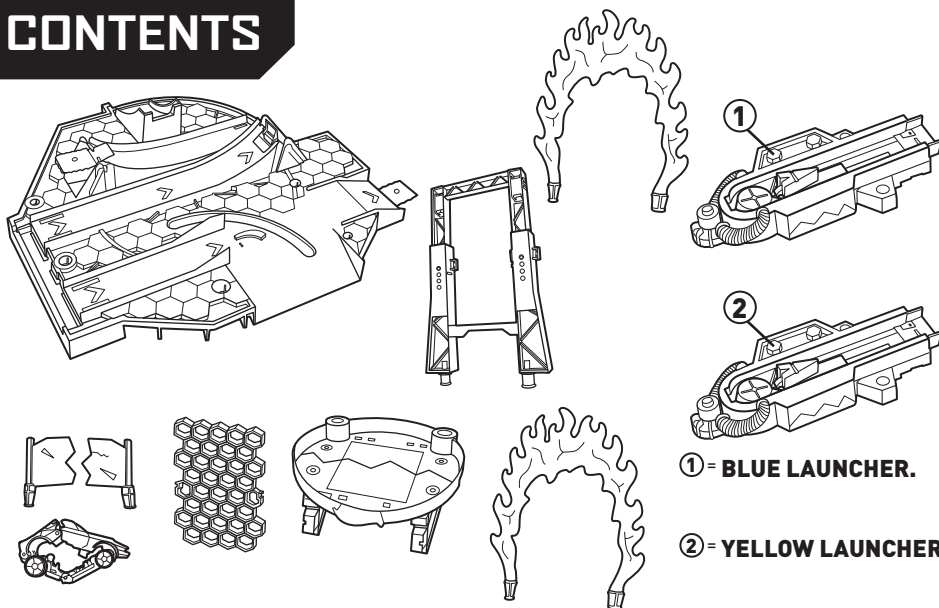

① = BLUE LAUNCHER.

② = YELLOW LAUNCHER.

For best results store vehicle in the open position.

©2012 Mattel. All Rights Reserved. Mattel, Inc., 636 Girard Avenue, East Aurora, NY 14052, U.S.A. Consumer Relations 1-800-524-8697. Mattel U.K. Ltd., Vanwall Business Park, Maidenhead SL6 4UB. Helpline 01628 500303. Mattel Australia Pty., Ltd., Richmond, Victoria. 3121. Consumer Advisory Service - 1300 135 312. Mattel East Asia Ltd., Room 1106, South Tower, World Finance Centre, Harbour City, Tsimshatsui, HK, China. Diimport & Diedarkan Oleh: Mattel SEA Ptd Ltd. (993532-P) Lot 13.5, 13th Floor, Menara Lien Hoe, Persiaran Tropicana Golf Country Resort, 47410 PJ. Tel:03-78803817, Fax:03-78803867. service.mattel.com

### ASSEMBLY

1.

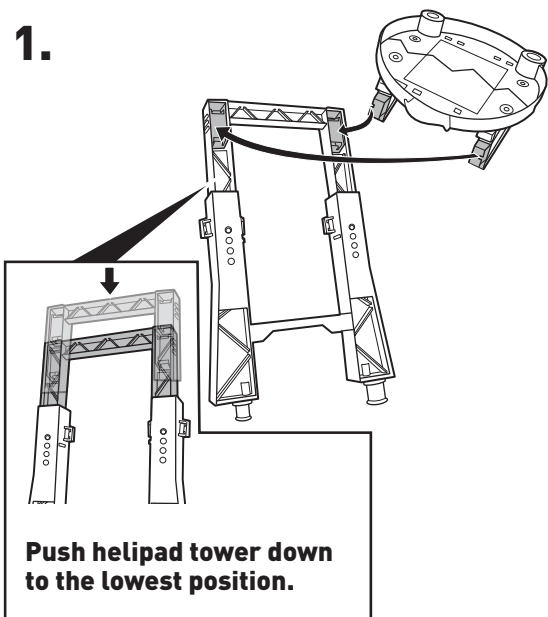

Push helpad tower down to the lowest position.

2.

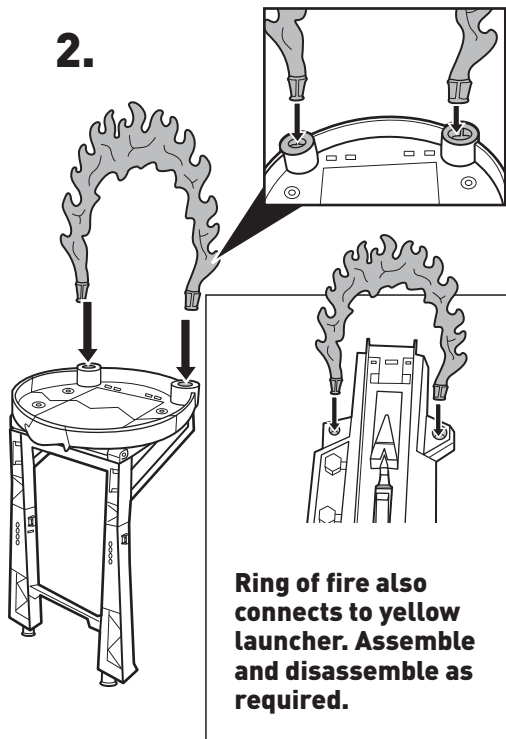

Ring of fire also connects to yellow launcher. Assemble and disassemble as required.

3.

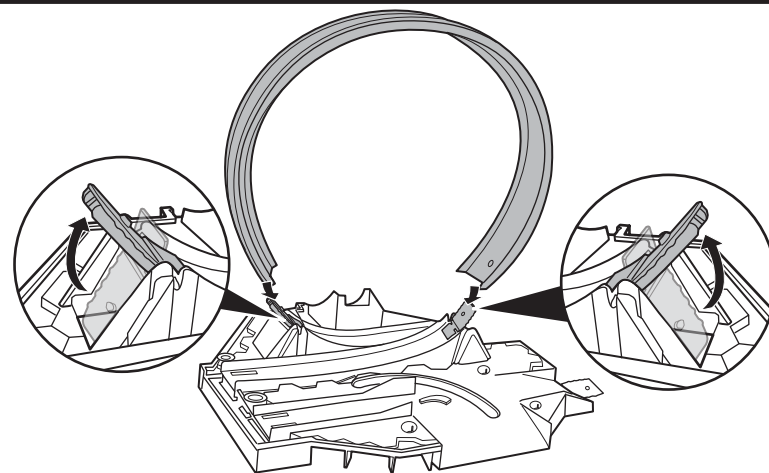

4.

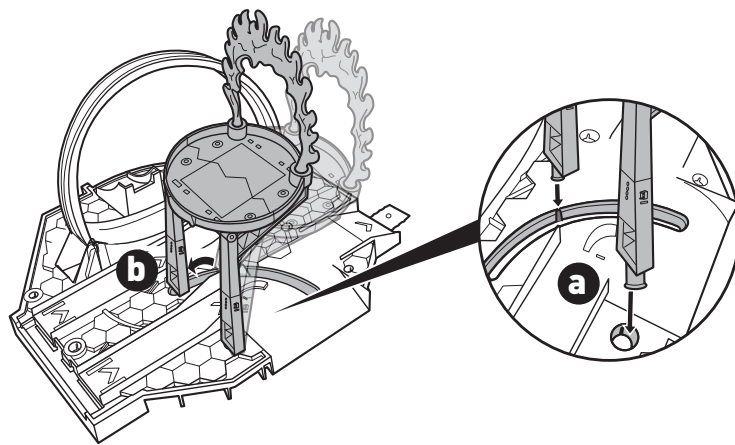

5. Connect Blue Launcher and Yellow Launcher in the locations shown.

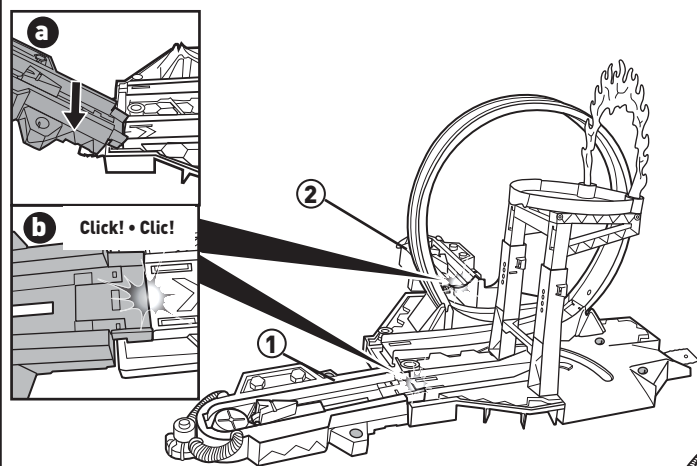

① = BLUE LAUNCHER. ② = YELLOW LAUNCHER.

6.

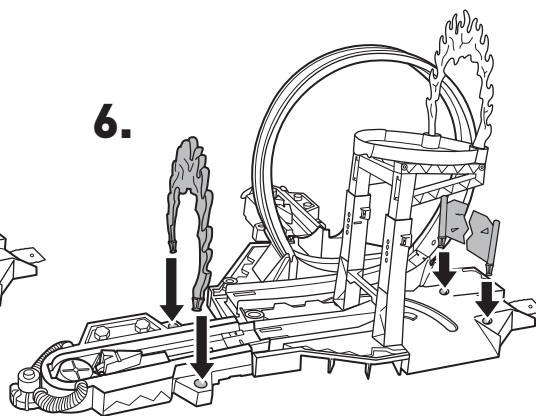

7.

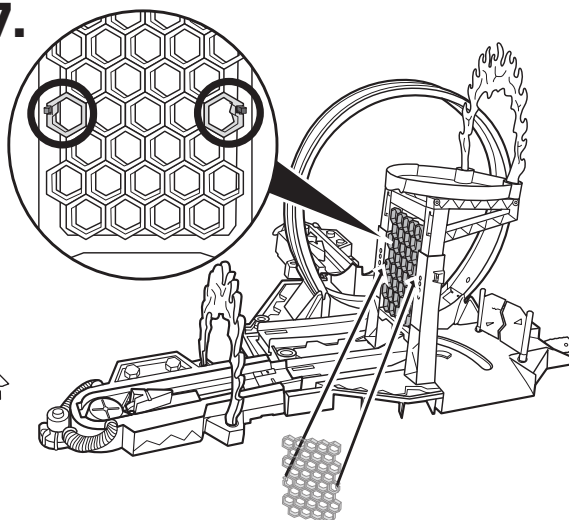

Final View

### REPLACE RUBBER BAND

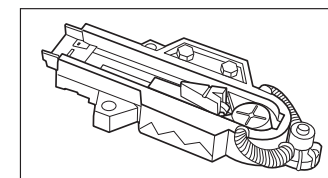
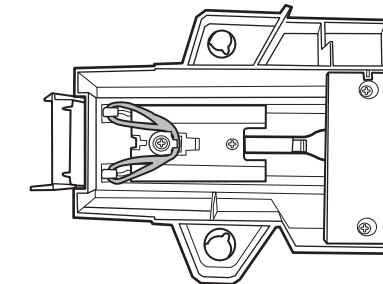
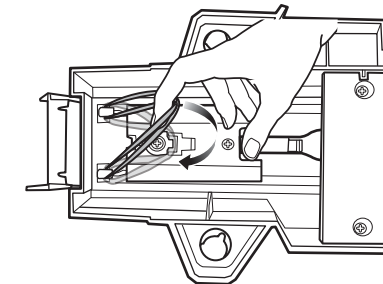

### CONNECT

Connects with Hot Wheels® tracks and track sets (not included).

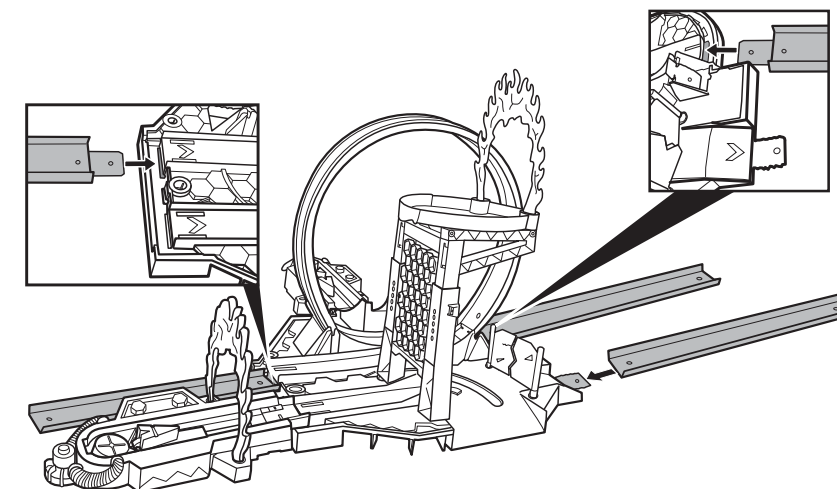

# LAUNCHER SETTINGS

Launchers are designed with 2 speed settings.

**1 = FAST SETTING**

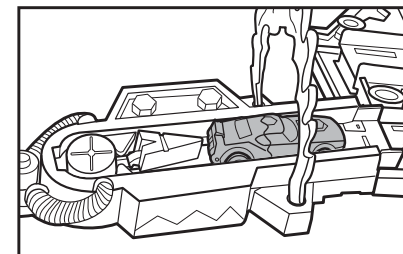
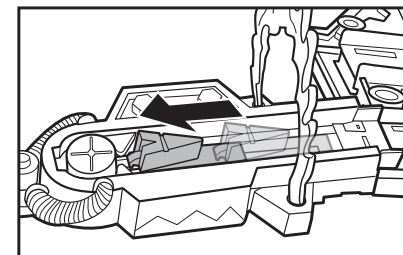

**2 = SLOW SETTING**

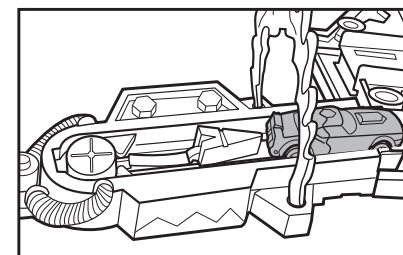
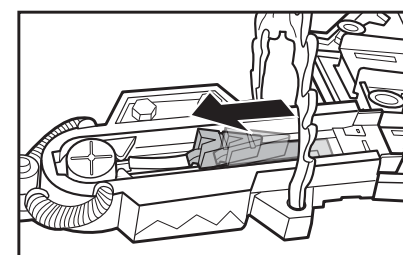

For best results store the launcher with rubber band in slack position.

# TO PLAY

**1. Press together as shown to set up or reset the vehicle before play.**

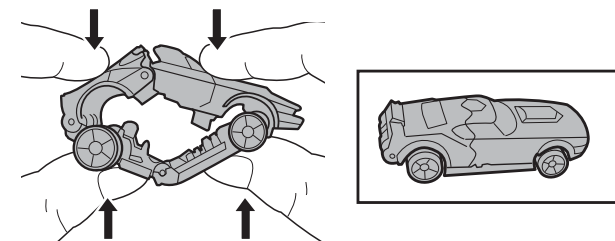

**2. Hit the helipad.**

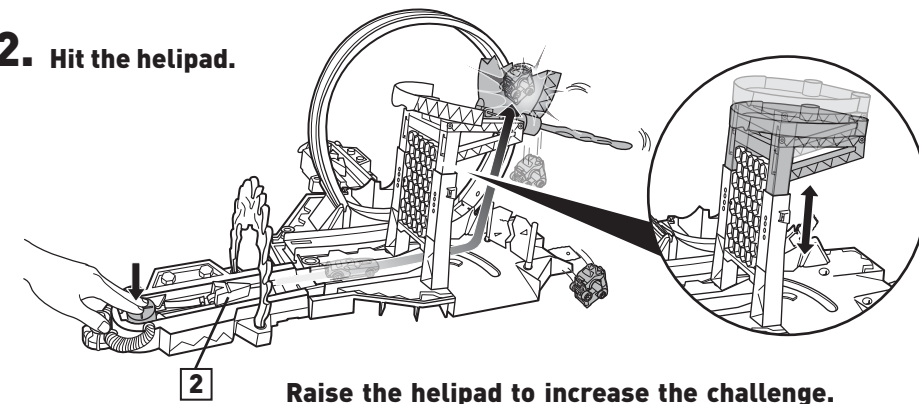

**2** Raise the helipad to increase the challenge. Or lower it to make it easier.

**3. Jump the super stunt ramp.**

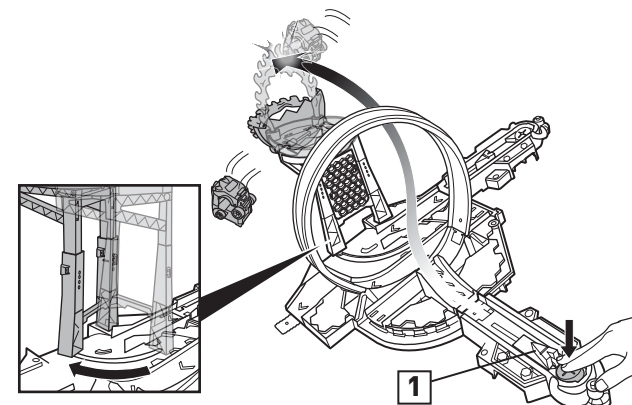

**4. Slide blue launcher over for 360° loop action.**

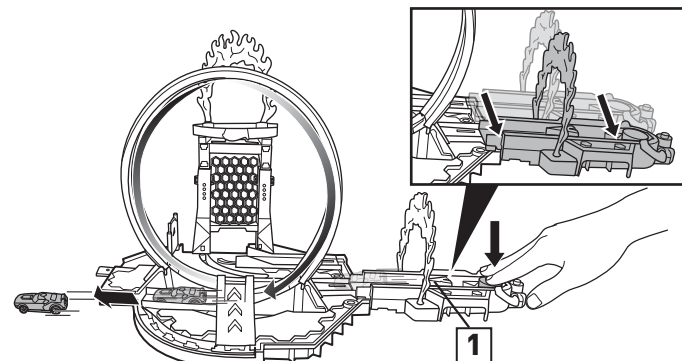

**5. For head-to-head action, connect ring of fire to the yellow launcher.**

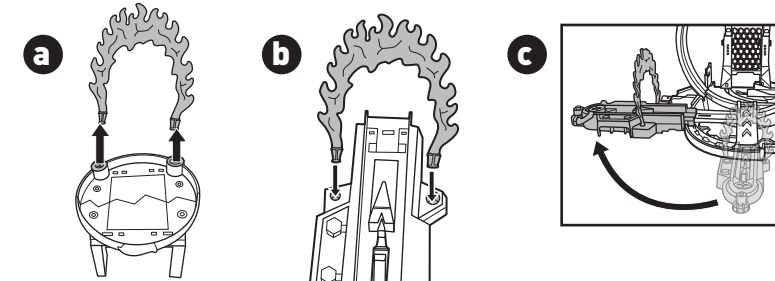

**a** Remove ring of fire from helipad.

**b** Connect it to the yellow launcher.

**c** Slide yellow launcher clockwise to go head-to-head.

**6. Face-off head-to-head.**

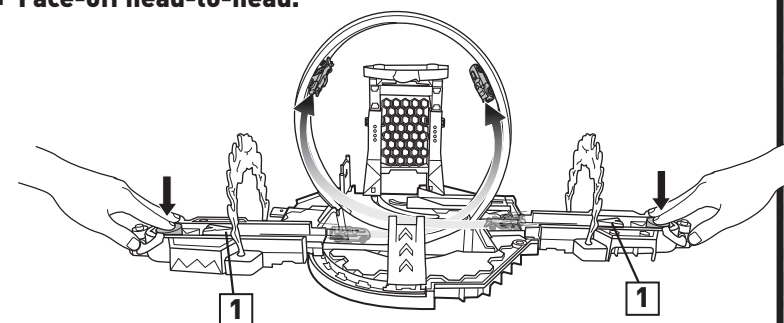

**7. Hit wall for awesome crash.**

Works best on flat, level, hard surfaces.

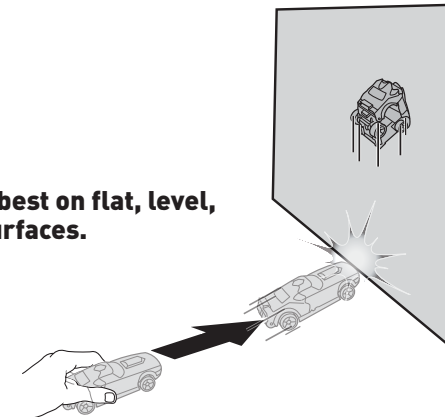

# MORE WAYS TO PLAY

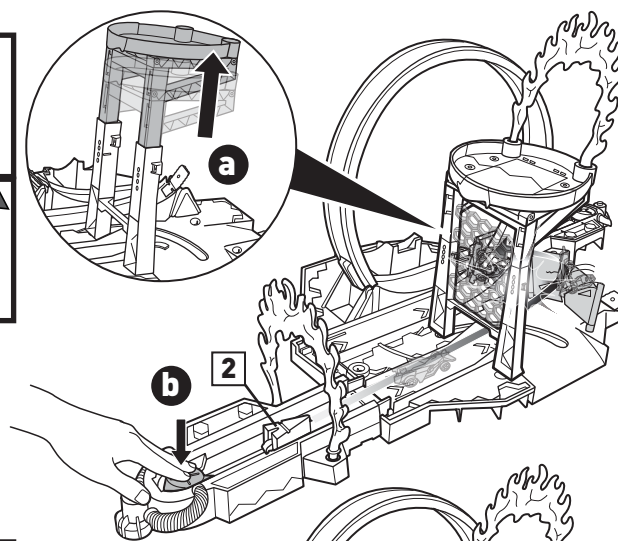
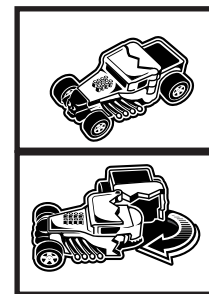
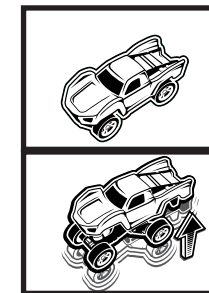

Play with other Stunt Devils vehicles (not included).

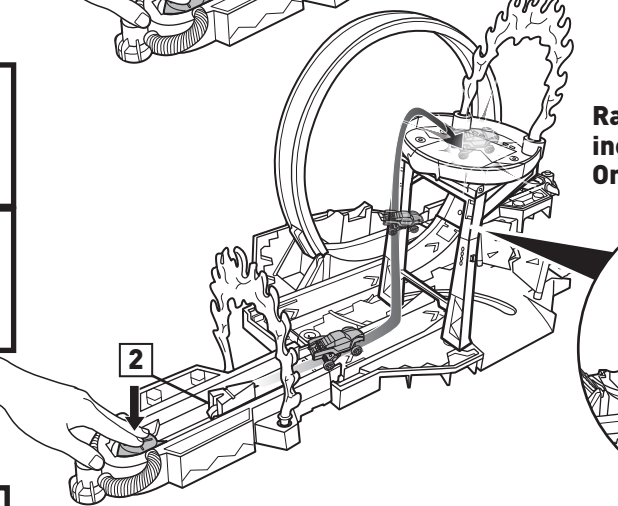

Raise the helipad to increase the challenge. Or lower it to make it easier.

