

Spills & Thrills on Sodor

INSTRUCTIONS

Keep these instructions for future reference as they contain important information.

ASSEMBLY

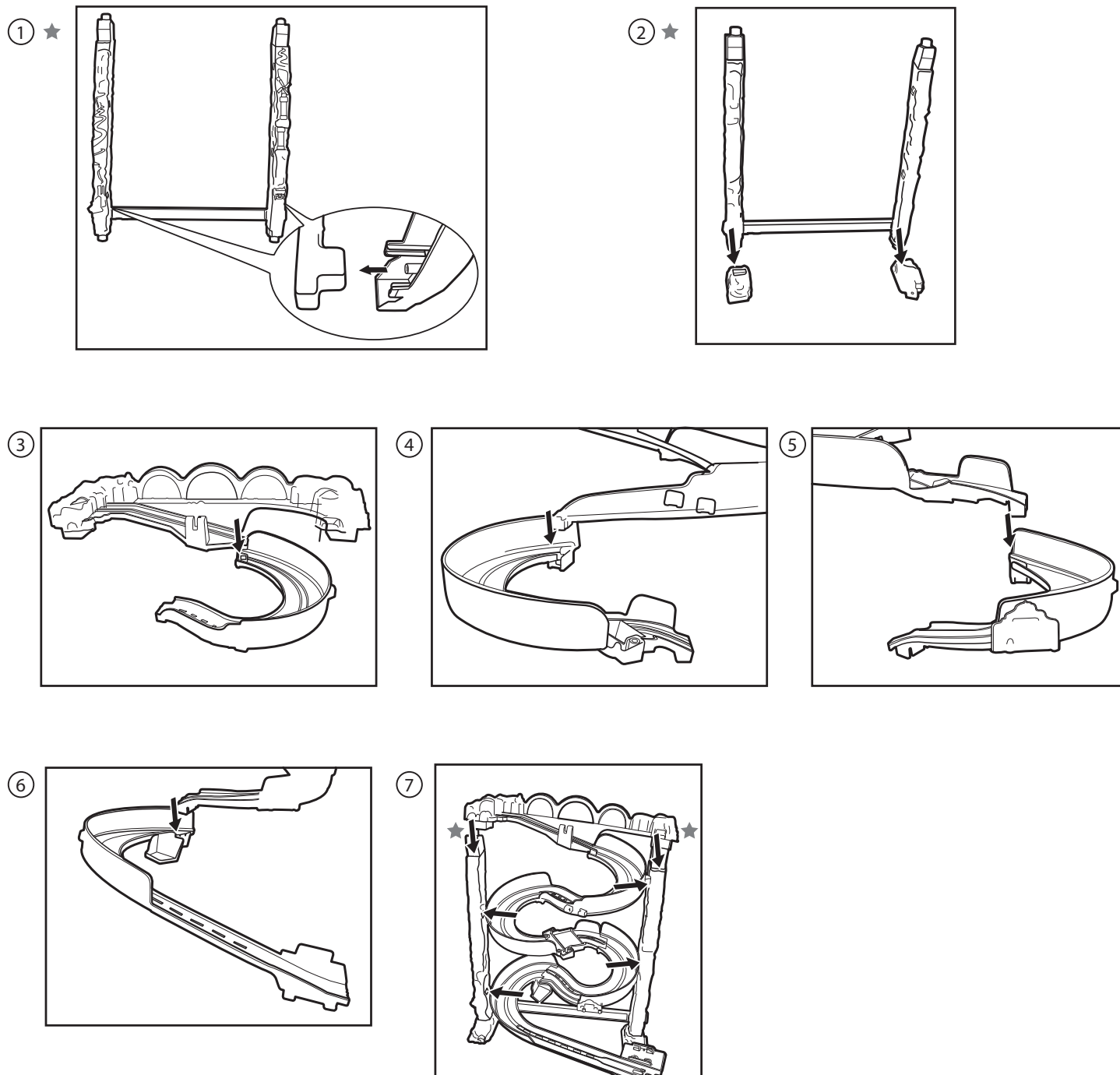

NOTE: May not work with all engines.

★ **NOTE:** This part is a "one-time snap" - once it is put together, it cannot be taken apart.

8

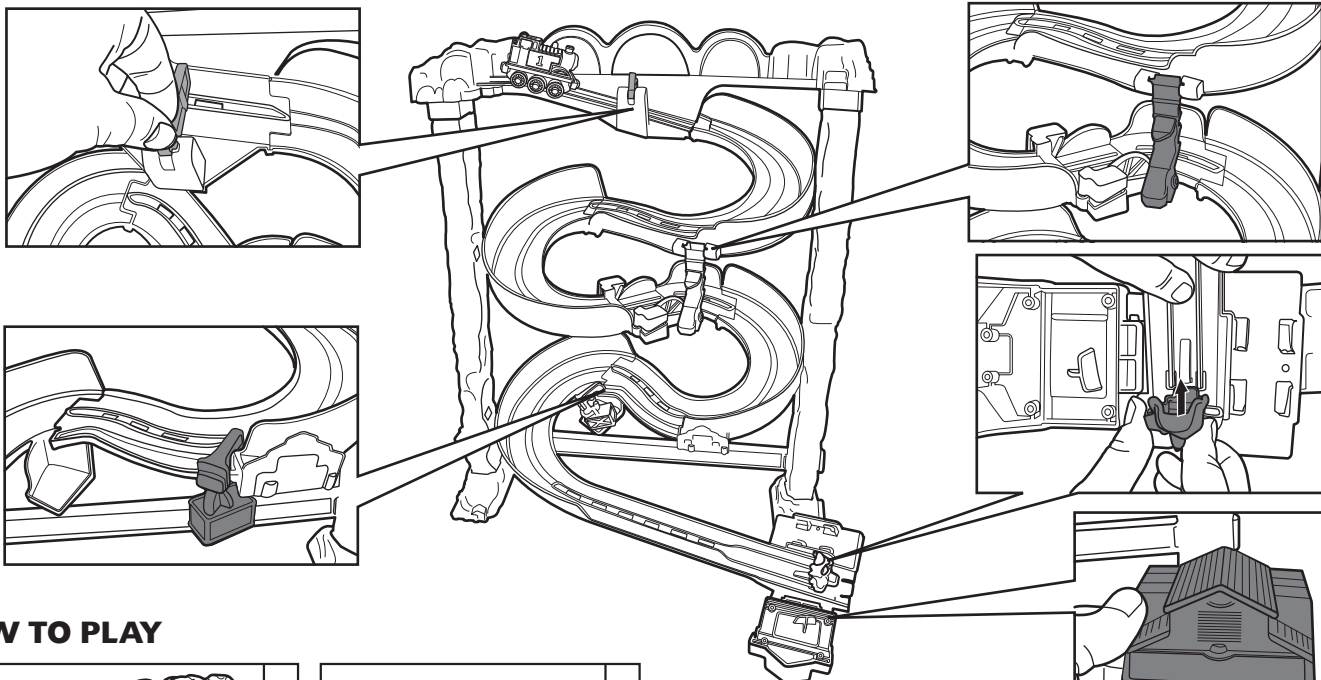

HOW TO PLAY

1

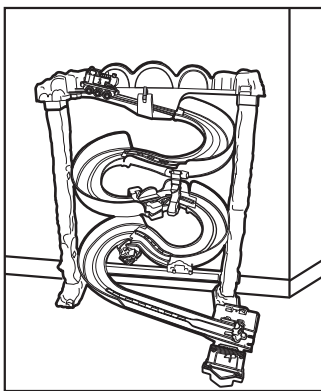
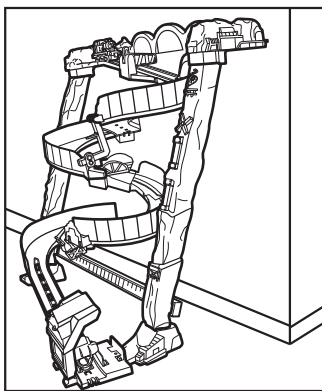

NOTE: Once assembly is complete, lean the track set up against a wall at an angle. The track set is not intended to stand on its own – it must be leaning against a wall for support.

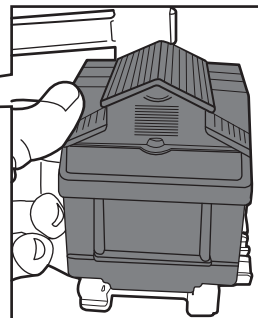

2

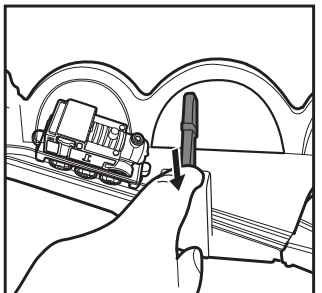

3

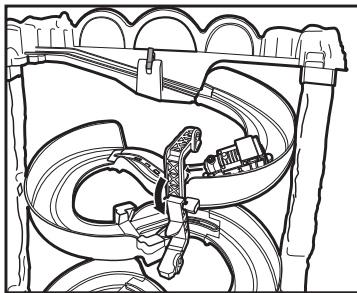

4

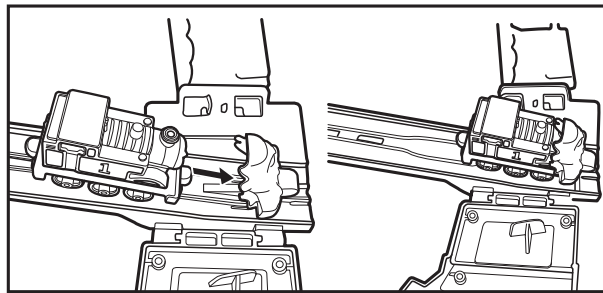

CONSUMER ASSISTANCE

1-800-432-5437 (US & Canada)
1300 135 312 (Australia)

service.fisher-price.com

Fisher-Price, Inc., 636 Girard Avenue, East Aurora, NY 14052.
Hearing-impaired consumers: 1-800-382-7470.

Outside the United States:

Canada: Mattel Canada Inc., 6155 Freemont Blvd.,
Mississauga, Ontario L5R 3W2; www.service.mattel.com.

Great Britain: Mattel UK Ltd, Vanwall Business Park,
Maidenhead SL6 4UB. Helpline: 01628 500303.
www.service.mattel.com/uk

Mattel Europa B.V., Gondel 1, 1186 MJ Amstelveen, Nederland.

Australia: Mattel Australia Pty. Ltd., 658 Church Street,
Locked Bag #870, Richmond, Victoria 3121 Australia.

New Zealand: 16-18 William Pickering Drive,
Albany 1331, Auckland.

Thomas the Tank Engine & Friends™



CREATED BY BRIT ALLCROFT

Based on the Railway Series by The Reverend W Awdry.
©2013 Gullane (Thomas) Limited.

Thomas the Tank Engine & Friends and Thomas & Friends
are trademarks of Gullane (Thomas) Limited.

©2013 HIT Entertainment Limited. HIT and the HIT logo
are trademarks of HIT Entertainment Limited.

©2013 Mattel. All Rights Reserved.

® and ™ designate U.S. trademarks of Mattel, except as noted.

PRINTED IN CHINA.

Mattel East Asia Ltd., Room 503-09, North Tower,
World Finance Centre, Harbour City, Tsimshatsui, HK, China.

BCX21



Fisher-Price®