

INSTRUCTIONS

CONTENTS

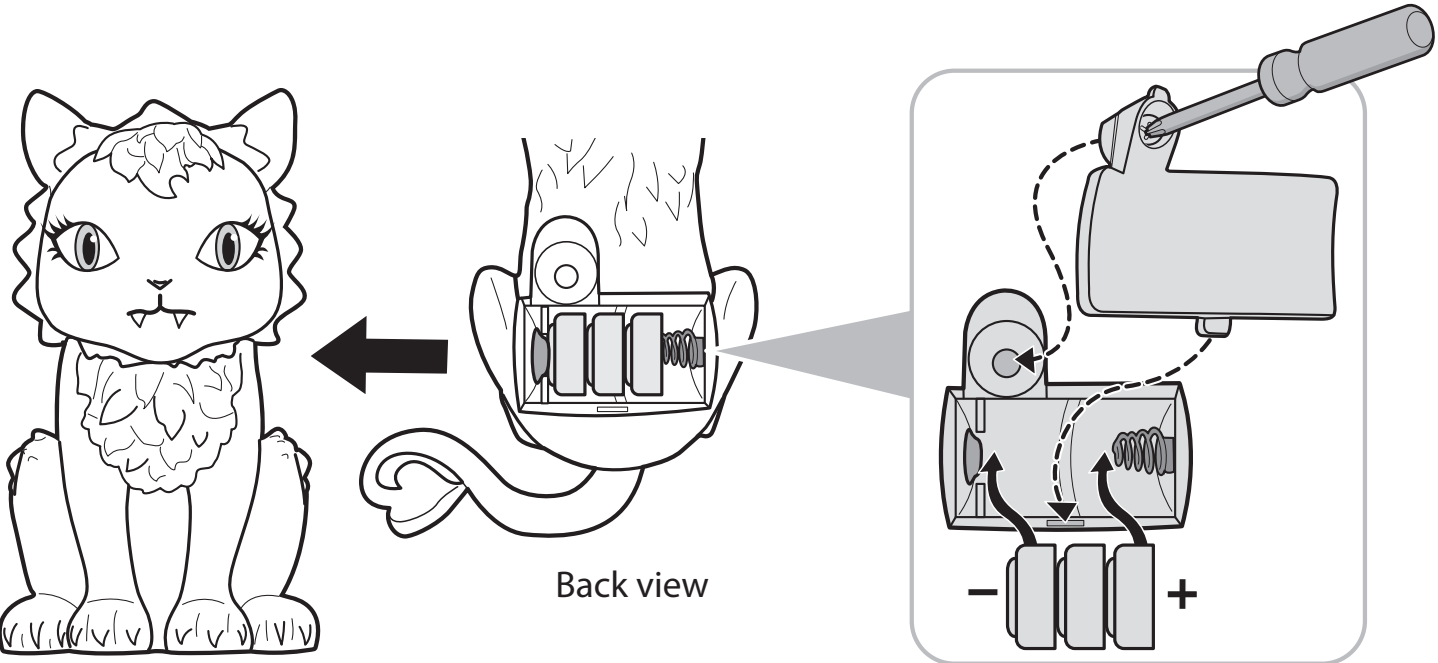

Battery Replacement

Replace batteries when sound becomes distorted. To replace batteries, use a Phillips head screwdriver (not included) to open battery cover. Insert 3 new AG13 (LR44) button cell batteries as shown. Use either AG13 (LR44) button cell batteries or equivalent. Replace battery cover and tighten screw. When exposed to an electrostatic source, the product may malfunction. If this problem occurs, reset the product by reinstalling the batteries.

**CONSUMER INFORMATION**  
Need Assistance? Visit [service.mattel.com](http://service.mattel.com) or call 1-800-524-8697 (US and Canada only).  
[SERVICE.MATTTEL.COM](http://SERVICE.MATTTEL.COM)

Mattel, Inc., 636 Girard Avenue, East Aurora, NY 14052, U.S.A. Consumer Relations 1-800-524-8697. Mattel U.K. Ltd., Vanwall Business Park, Maidenhead SL6 4UB. Helpline 01628 500303. Mattel Australia Pty., Ltd., Richmond, Victoria. 3121. Consumer Advisory Service - 1300 135 312.  
Mattel East Asia Ltd., Room 503-09, North Tower, World Finance Centre, Harbour City, Tsimshatsui, HK, China. Diimport & Diedarkan Oleh: Mattel SEA Ptd Ltd. (993532-P) Lot 13.5, 13th Floor, Menara Lien Hoe, Persiaran Tropicana Golf Country Resort, 47410 PJ. Malaysia. Tel: 03-78803817, Fax: 03-78803867.

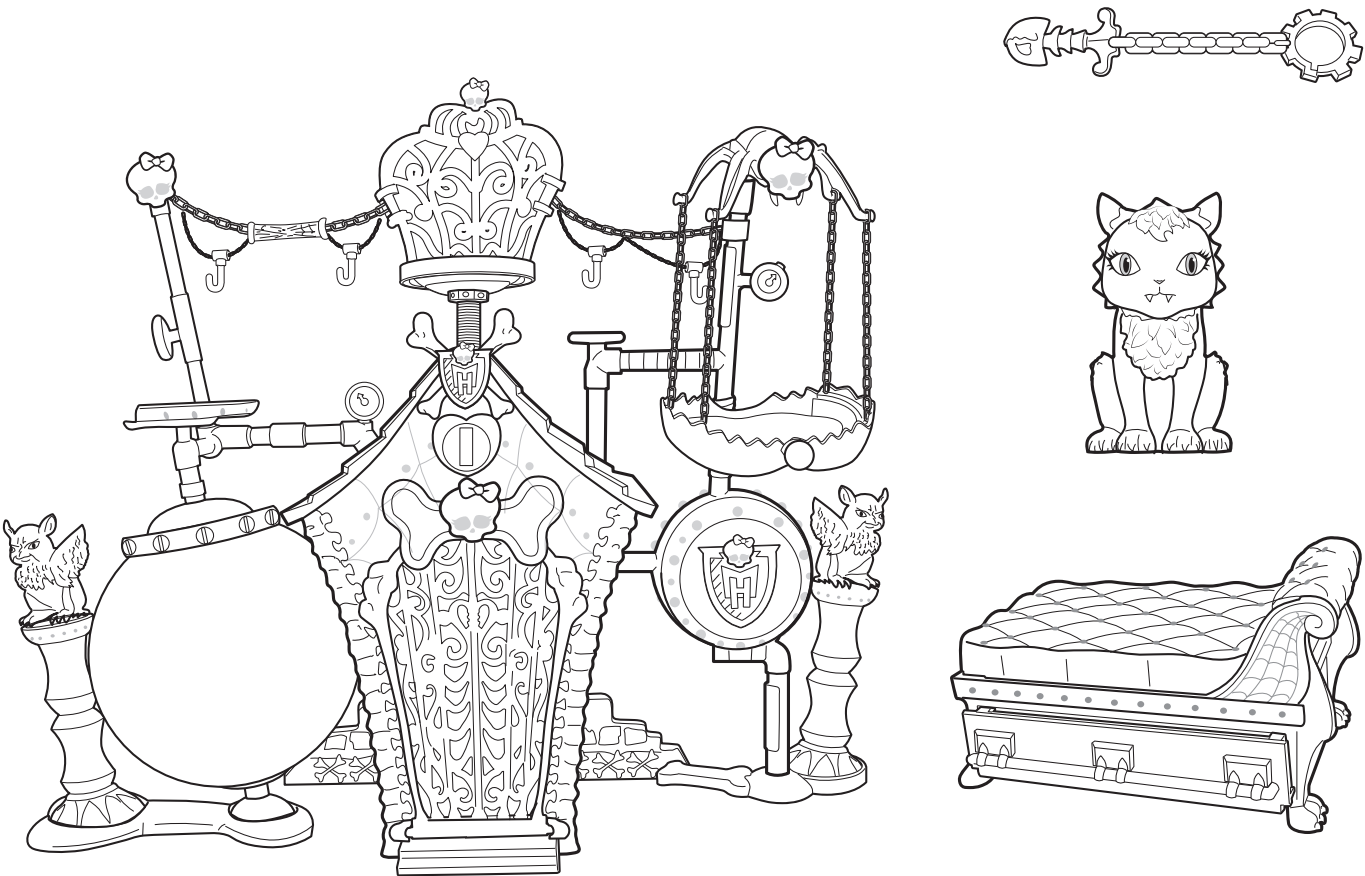

Includes 3 AG13 (LR44) button cell batteries. Batteries included are for demonstration purposes only. Dispose of batteries safely.

Please remove everything from the package and compare to the contents shown here. If any items are missing, please contact your local Mattel office. Keep these instructions for future reference as they contain important information.

**WARNING:**  
CHOKING HAZARD - Small parts.  
Not for children under 3 years.

# Let's Play!

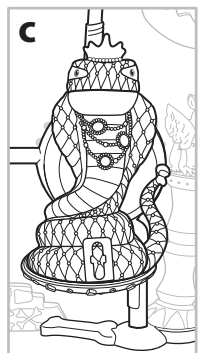
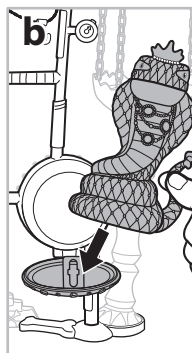
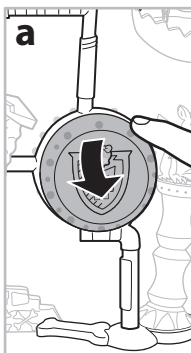
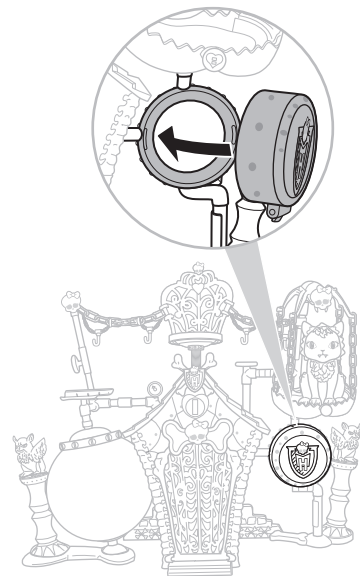
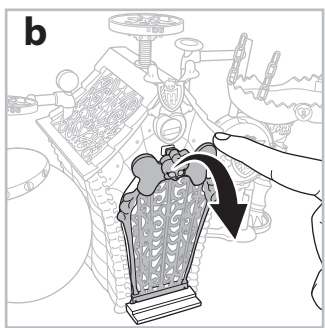
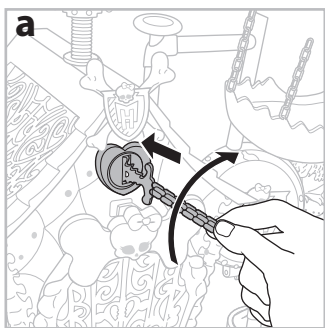
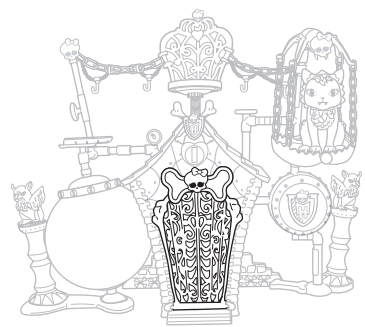

Pet not included.

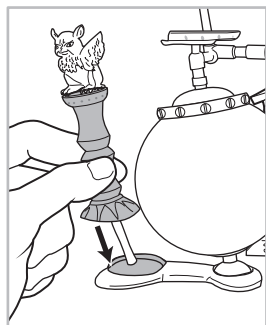
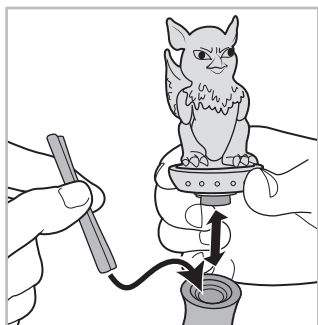
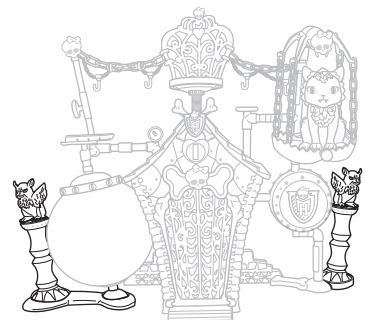
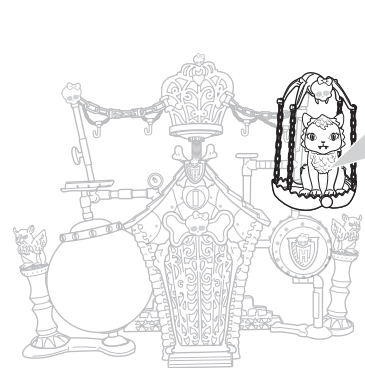
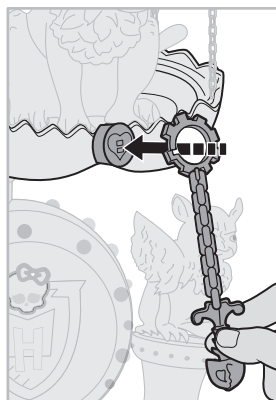
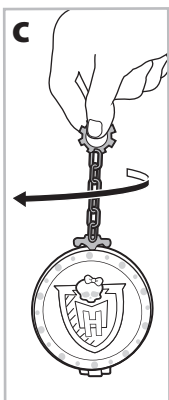
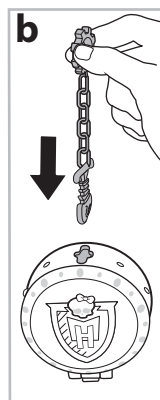
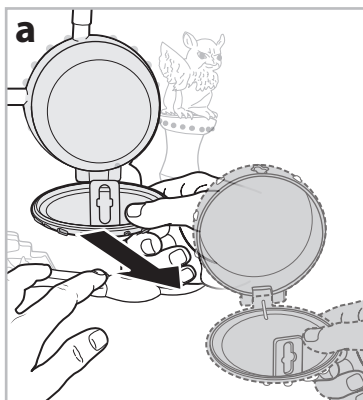

Paper roll not included.

## Magic drawer

Make sure the initial position of switch is as shown before each play.

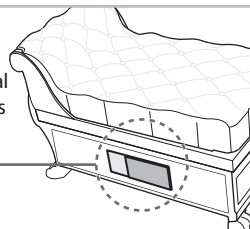

1

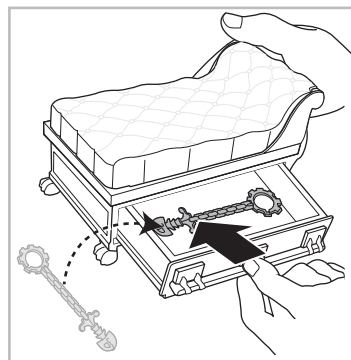

2

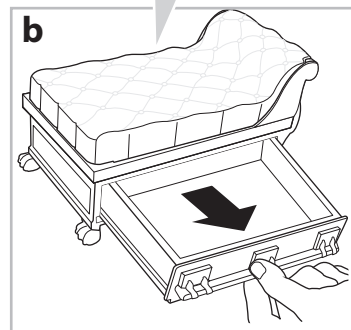
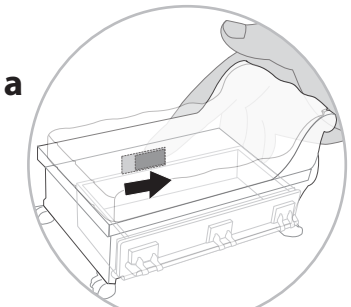

3

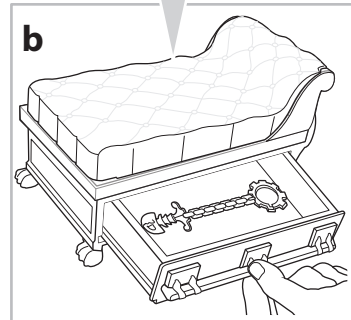
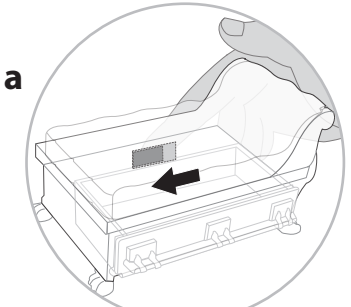

The figure has a sensor in her chest. This sensor detects motion best within 5 feet.

**A** Press button to activate sensor. Press again to turn off.

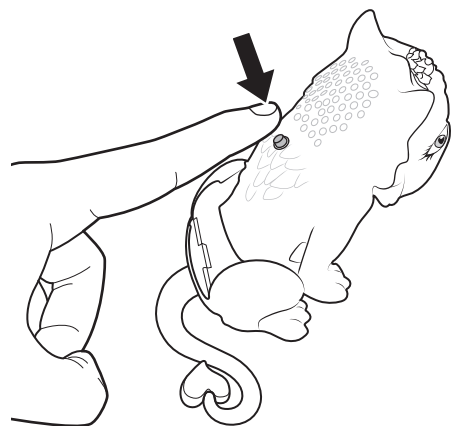

**B** Figure growls when movements are recognized.

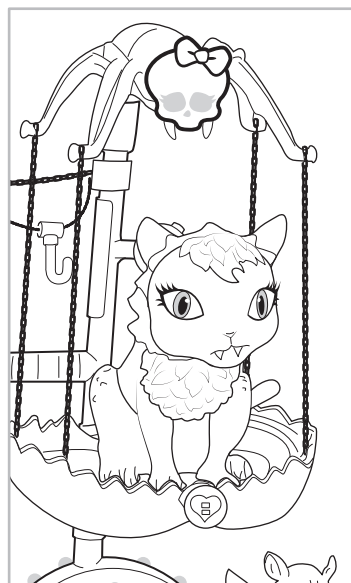

**Note:** The product is equipped with an automatic shut-off feature that helps preserve battery life.

**IMPORTANT:** The sensor may not work in all lights, such as in direct sunlight, or in light that is either too bright or too dim.

When exposed to an electrostatic source, this product may malfunction. Turn the switch off and then on again for normal function.