



OFF-ROAD MAXIMUM DESTRUCTION® BATTLE

INSTRUCTIONS

Please keep these instructions for future reference as they contain important information.

CONTENTS



LABEL SHEET

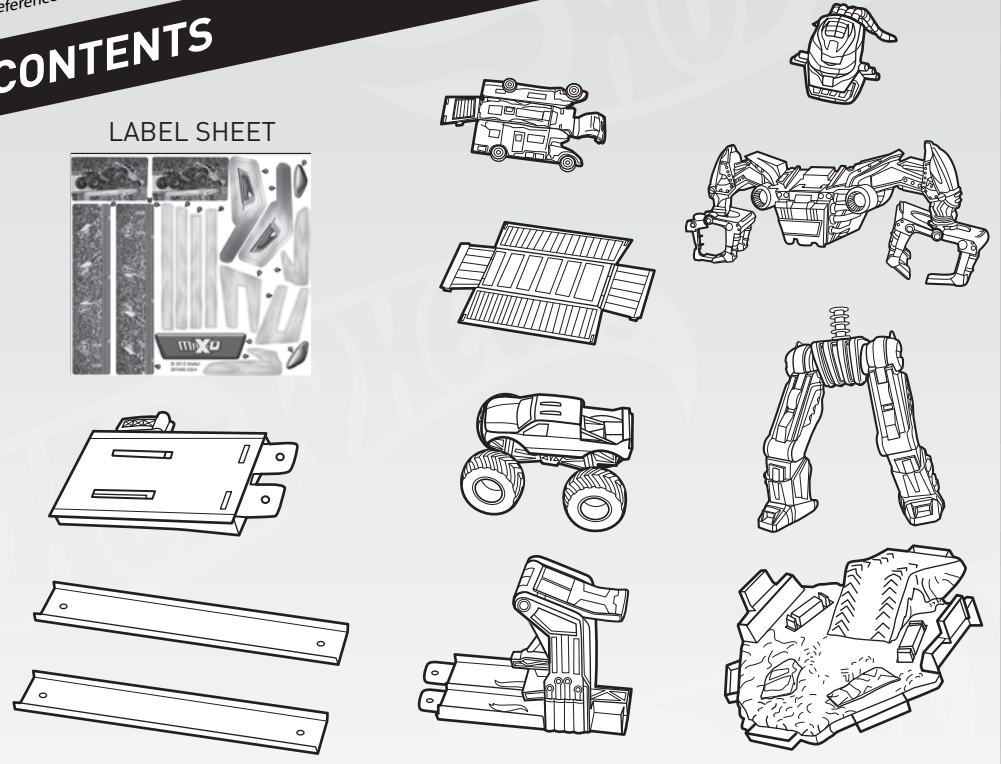

© 2014 Feld Motor Sports, Inc.
MONSTER JAM®, UNITED STATES HOT ROD ASSOCIATION®, USHRA®, AFTERBURNER®, BACKWARDS BOB®, BLACKSMITH®, BLUE THUNDER®, BULLDOZER®, CAPTAIN'S CURSE®, DRAGON'S BREATH®, EL DIABLO™, EL TORO LOCO®, GRAVE DIGGER®, GRAVE DIGGER THE LEGEND®, GRINDER™, CRUSADER™, MAX-D™, MAXIMUM DESTRUCTION®, MOHAWK WARRIOR®, MONSTER MUTT®, NORTHERN NIGHTMARE™, SON-UVA DIGGER®, and ZOMBIE™ are trademarks of and used under license by FMS. All rights reserved.

©2013 Mattel. All Rights Reserved. Mattel, Inc., 636 Girard Avenue, East Aurora, NY 14052, U.S.A. Consumer Relations 1-800-524-8697. Mattel U.K. Ltd., Vanwall Business Park, Maidenhead SL6 4UB. Helpline 01628 500303. Mattel Australia Pty., Ltd., Richmond, Victoria. 3121. Consumer Advisory Service - 1300 135 312. Mattel East Asia Ltd., Room 503-09, North Tower, World Finance Centre, Harbour City, Tsimshatsui, HK, China. Diimport & Diedarkan Oleh: Mattel SEA Ptd Ltd. (993532-P) Lot 13.5, 13th Floor, Menara Lien Hoe, Persiaran Tropicana Golf Country Resort, 47410 P.J. Malaysia. Tel:03-78803817, Fax:03-78803867.

1 APPLY LABELS

Helpful Hint: Apply labels before assembly by number as indicated.

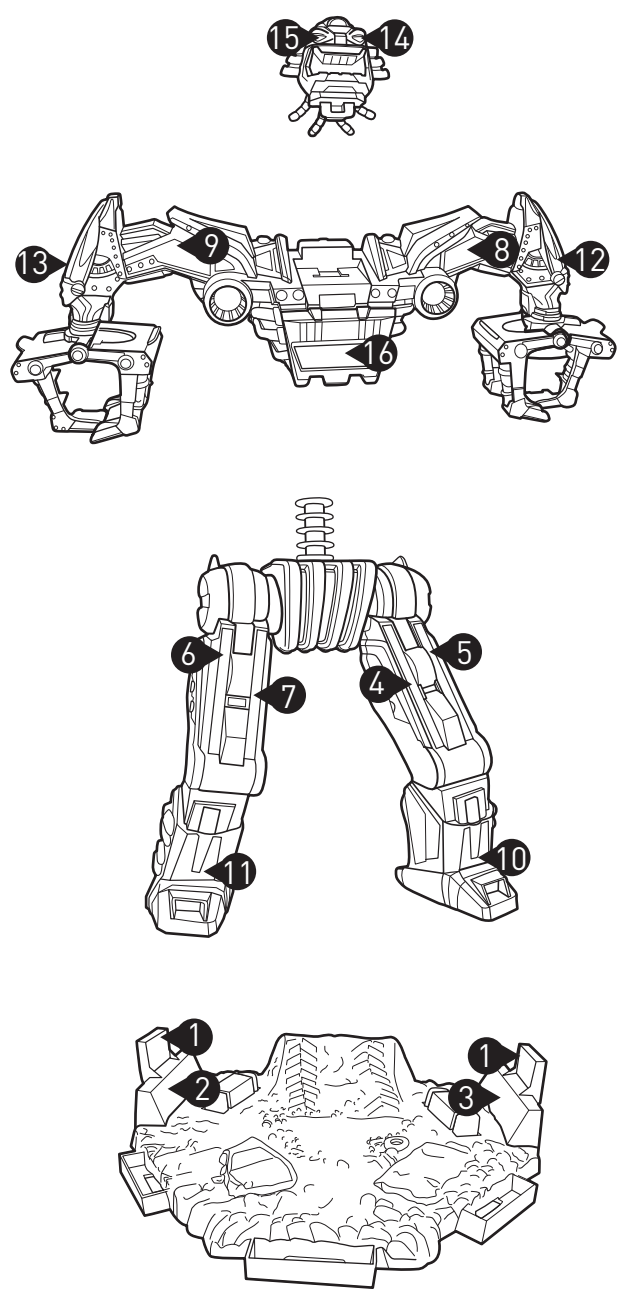

2 ASSEMBLY

Assemble the figure.

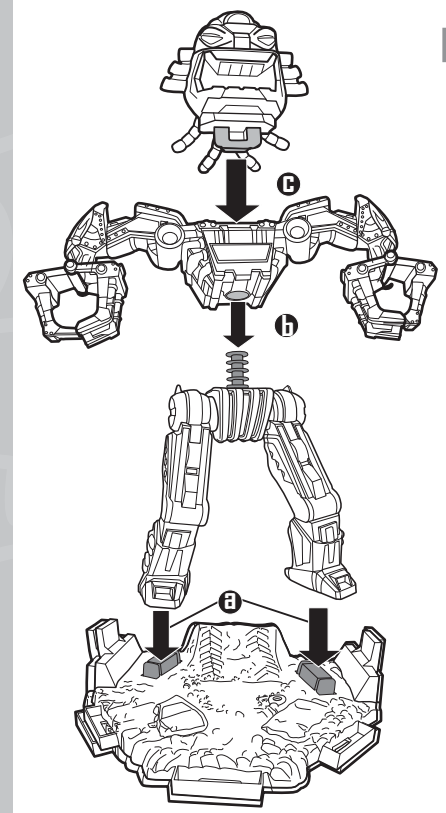

Assemble crushable vehicle.

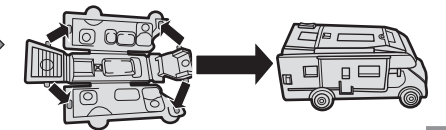

Assemble collapsible carton.

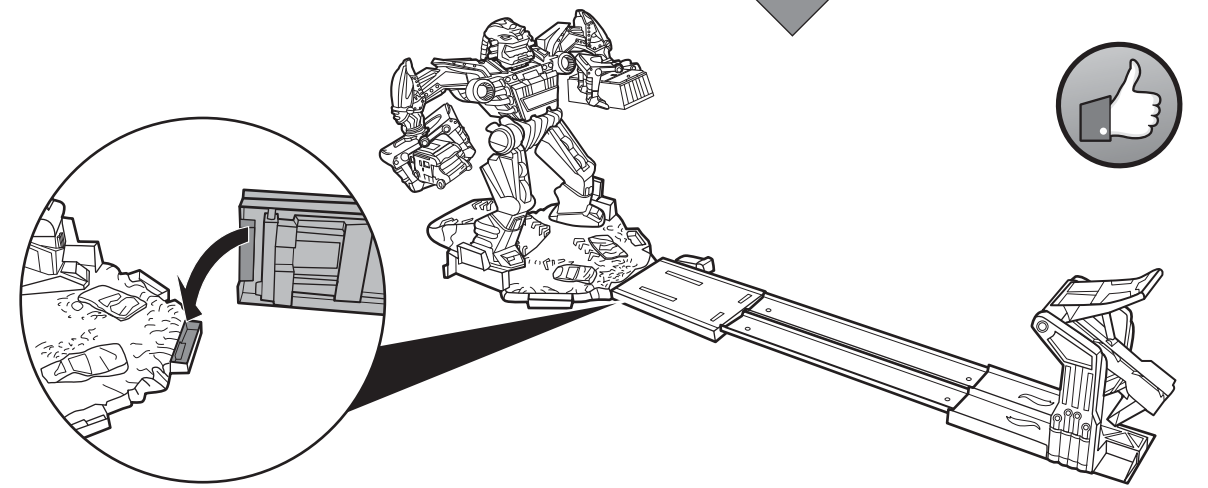
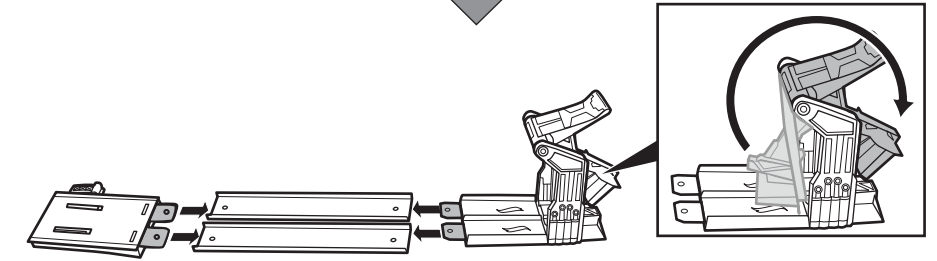
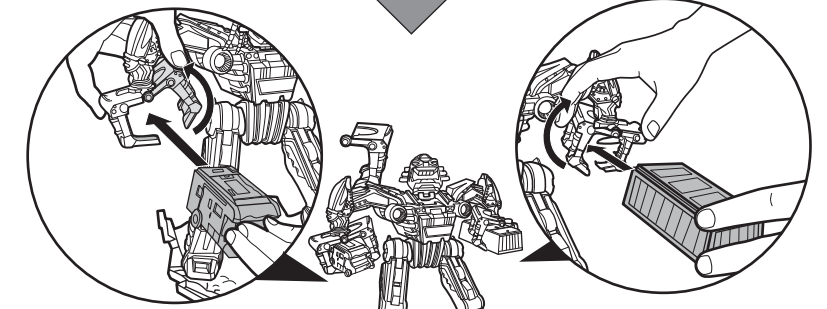
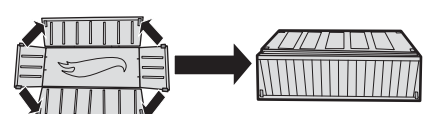

3 TO PLAY

1. Pound to launch truck past the figure.

2. Figure spins!

3.

Hit the figure's chest to make it explode!
WARNING: DO NOT AIM AT EYES OR FACE.
ONLY USE PROJECTILES SUPPLIED WITH THIS TOY. DO NOT FIRE AT POINT-BLANK RANGE.

4 MORE WAYS TO PLAY

1.

CONNECT ADDITIONAL SETS (SOLD SEPARATELY) TO LAUNCH FROM MULTIPLE DIRECTIONS.

2.

WORKS WITH MOST HOT WHEELS® VEHICLES (NOT INCLUDED).

TROUBLESHOOTING

Q: My car keeps slowing down by itself on the tracks.

A: Lint may collect around your car's axles. This may cause the car to run slowly. Use tweezers or a toothpick to remove lint.

Q: The figure's head and torso keep popping off when I try to connect them to the legs. How can I fix that?

A: Connecting the head, torso and legs is a two step process. The torso and legs **MUST** be connected together before you connect the head to the torso.

Q: Why can't I connect the figure's torso to the legs?

A: Do not press the figure's chest button. Try holding the figure's left and right arm when connecting to its legs.