

Rock 'n Playhouse Box

INSTRUCTIONS

Keep these instructions for future reference as they contain important information.

HOW TO PLAY

There are three floors of fun with music & sounds on every floor! The elevator triggers sound effects on each floor, while Julius phrases prompt play, encouraging children to use their Julius Jr. character figures to skate on the ramp, enter the invention dimension, look through the telescope and more.

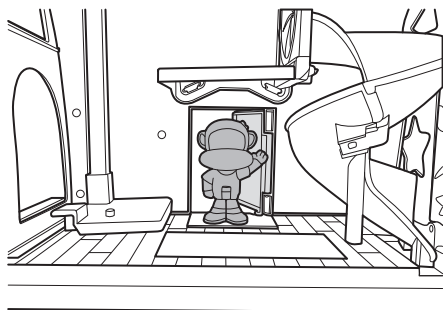

Open the door to enter the Playhouse and trigger a special entry sequence.

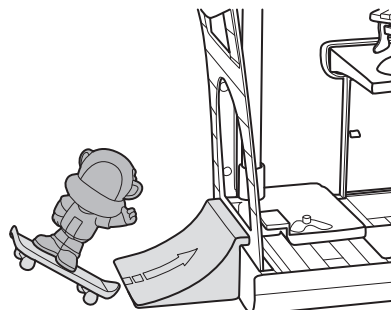

Skate on the skateboard ramp.

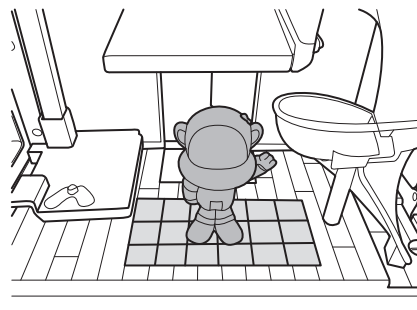

Dance on the light-up floor on the ground level.

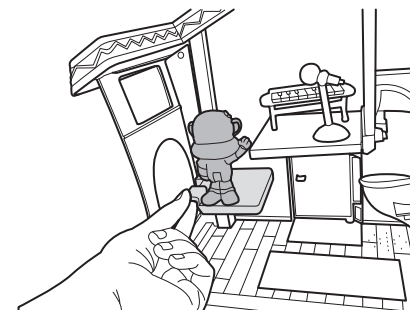

Take the "Lift-o-Tron" magic elevator to the 2nd floor and rock out with the band.

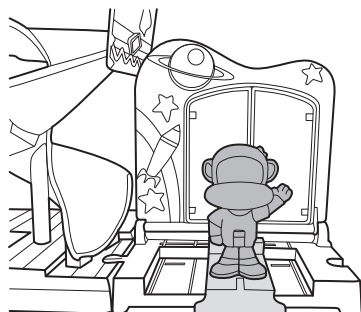

Go for a rocket ride in outer space.

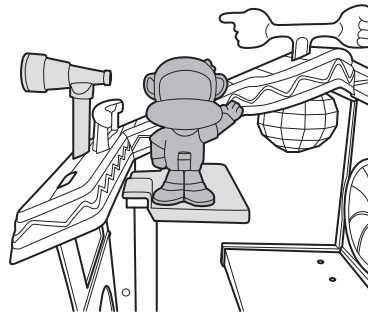

Go onto the roof and peer out into the 'real world.'

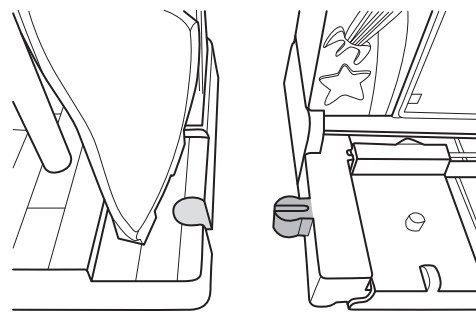

Universal fit sliding conveyor belt can be attached to other conveyor belts and smaller sets for extended play.

™ & © 2014 Paul Frank Industries LLC. All Rights Reserved.

©2014 Mattel. All Rights Reserved.

* and ™ designate U.S. trademarks of Mattel, except as noted. **PRINTED IN CHINA.**

Mattel East Asia Ltd., Room 503-09, North Tower, World Finance Centre, Harbour City, Tsimshatsui, HK, China.

ID. BJG14-0920

BJG14

Fisher-Price

CONSUMER ASSISTANCE
1-800-432-5437 (US & Canada)
1300 135 312 (Australia)
service.fisher-price.com

Fisher-Price, Inc., 636 Girard Avenue, East Aurora, NY 14052.
Hearing-impaired consumers: 1-800-382-7470.

Outside the United States:

Canada: Mattel Canada Inc., 6155 Freemont Blvd.,
Mississauga, Ontario L5R 3W2; www.service.mattel.com.

Great Britain: Mattel UK Ltd, Vanwall Business Park,
Maidenhead SL6 4UB. Helpline: 01628 500303.
www.service.mattel.com/uk

Mattel Europa B.V., Gondel 1, 1186 MJ Amstelveen, Nederland.

Australia: Mattel Australia Pty. Ltd., 658 Church Street,
Locked Bag #870, Richmond, Victoria 3121 Australia.

New Zealand: 16-18 William Pickering Drive,
Albany 1331, Auckland.