



MINNIE

Jump 'n Style Pony Stable

INSTRUCTIONS

Keep these instructions for future reference as they contain important information.

ASSEMBLY PARTS

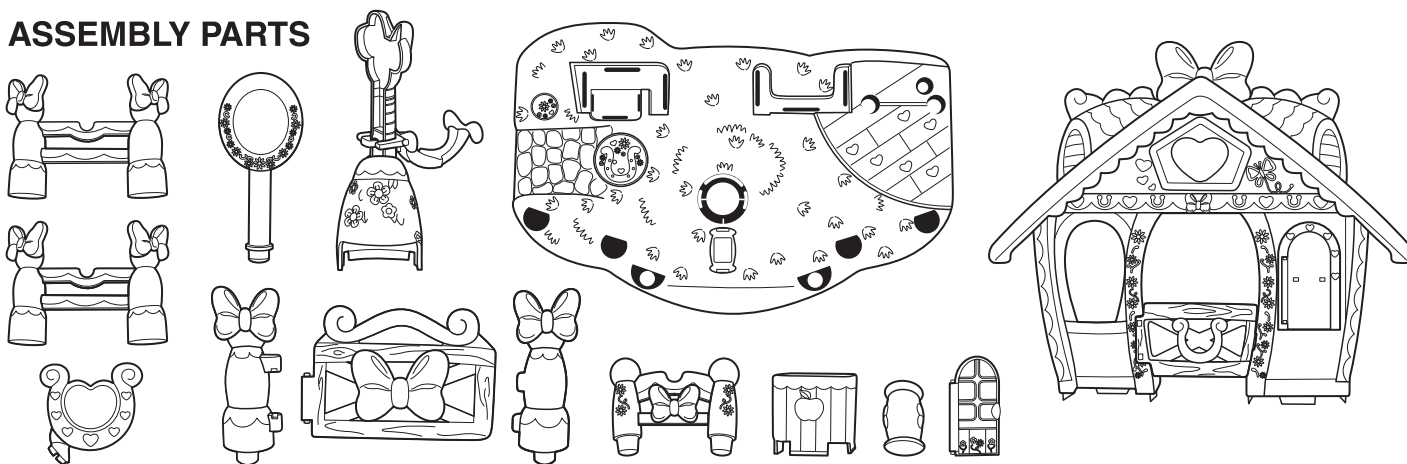

HOW TO PLAY

1. You can remove these two fence posts and set them up separately so your pony can practice jumping.
2. Feed your pony by placing her foot on the peg and pressing the yellow button.
3. Make your pony leap by mounting her to the bracket on the harness and turning the post.
4. You can also hang Minnie's dress on the back wall of the stable.

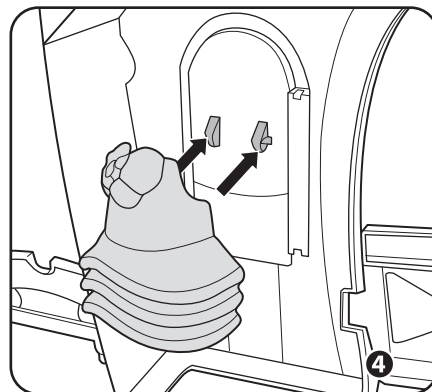
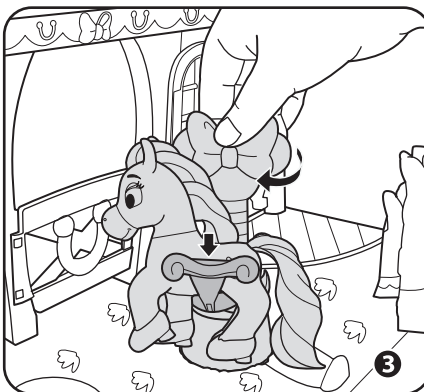
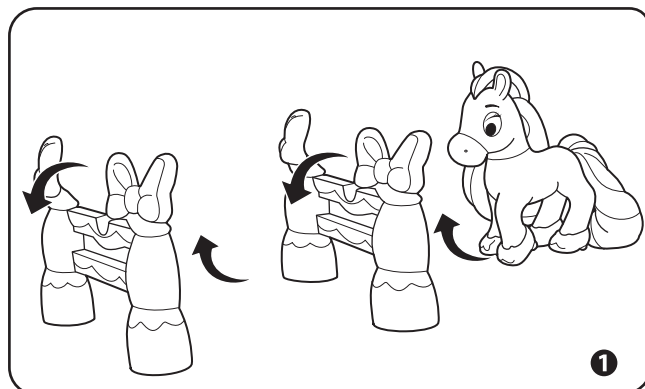

CONSUMER ASSISTANCE

1-800-432-5437 (US & Canada)
1300 135 312 (Australia)

service.fisher-price.com

Fisher-Price, Inc., 636 Girard Avenue, East Aurora, NY 14052.
Hearing-impaired consumers: 1-800-382-7470.

Outside the United States:

Canada: Mattel Canada Inc., 6155 Freemont Blvd.,
Mississauga, Ontario L5R 3W2: www.service.mattel.com.

Great Britain: Mattel UK Ltd, Vanwall Business Park,
Maidenhead SL6 4UB. Helpline: 01628 500303.
www.service.mattel.com/uk

Mattel Europa B.V., Gondel 1, 1186 MJ Amstelveen, Nederland.

Australia: Mattel Australia Pty. Ltd., 658 Church Street,
Locked Bag #870, Richmond, Victoria 3121 Australia.

New Zealand: 16-18 William Pickering Drive,
Albany 1331, Auckland.

© Disney

Visit DisneyJunior.com

©2014 Mattel. All Rights Reserved.

® and ™ designate U.S. trademarks of Mattel, except as noted.

PRINTED IN CHINA.

Mattel East Asia Ltd., Room 503-09, North Tower, World Finance Centre,
Harbour City, Tsimshatsui, HK, China.

ID. BJP02-0920G2

BJP02

Fisher-Price

ASSEMBLY

✳ **NOTE:** These assemblies are "one-time snaps".
Once these pieces are snapped together,
they cannot be taken apart.

