

Battery Installation

Use a Phillips head screwdriver (not included) to open battery cover. Insert 3 new AA alkaline batteries as shown. Replace battery cover and tighten screw. For longer life use alkaline batteries only. Replace batteries when motor starts to slow down or lights dim. When exposed to an electrostatic source, the product may malfunction. If this problem occurs, reset the product by reinstalling the batteries.

Note: The recharge station is equipped with an automatic shut-off feature that helps preserve battery life.

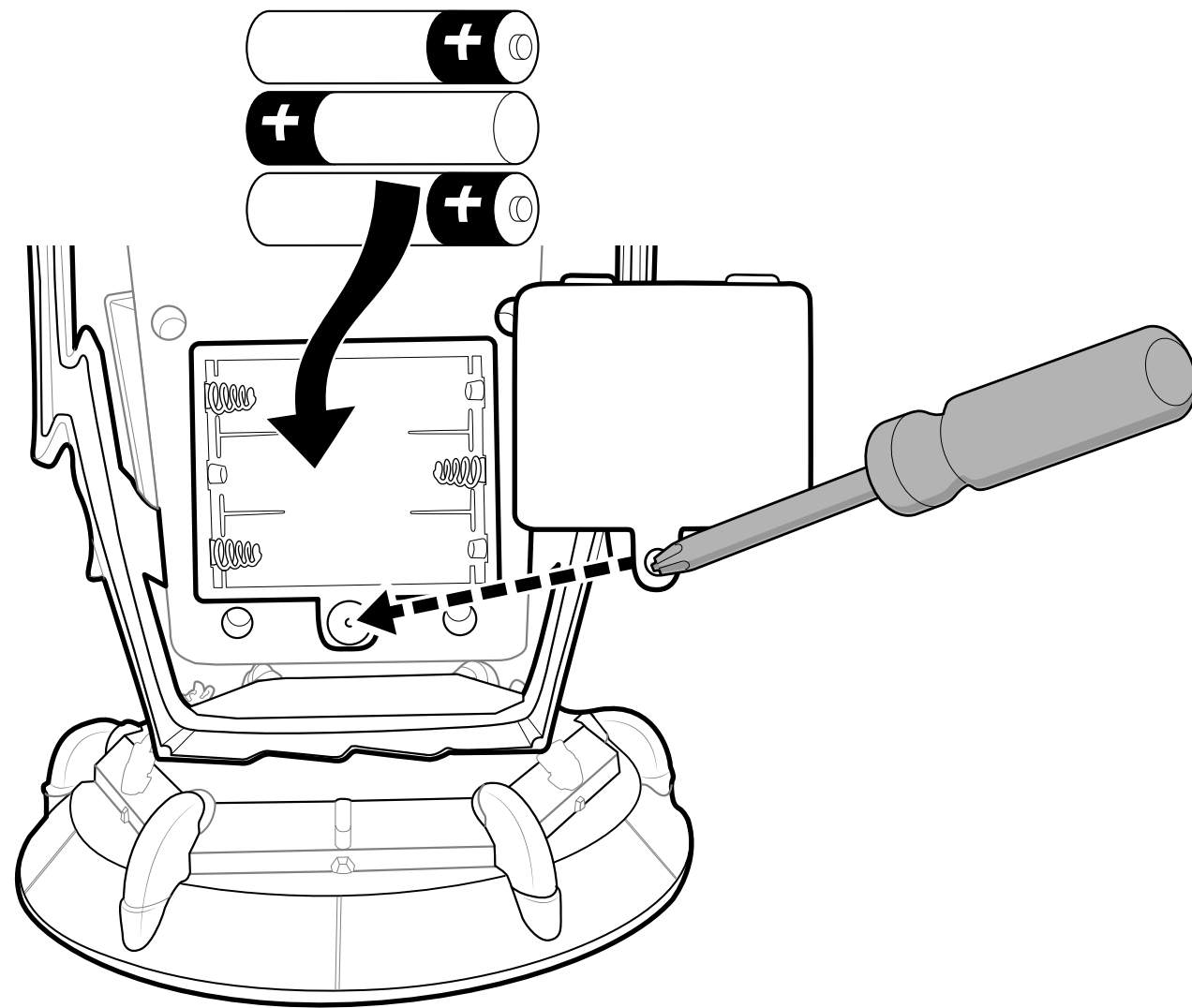

Back view

CONSUMER INFORMATION

Need Assistance? Visit service.mattel.com or call 1-800-524-8697 (US and Canada only).

SERVICE.MATTEL.COM

Mattel, Inc., 636 Girard Avenue, East Aurora, NY 14052, U.S.A. Consumer Services 1-800-524-8697. Mattel U.K. Ltd., Vanwall Business Park, Maidenhead SL6 4UB. Helpline 01628 500303. Mattel Australia Pty., Ltd., Richmond, Victoria. 3121. Consumer Advisory Service - 1300 135 312.

Mattel East Asia Ltd., Room 503-09, North Tower, World Finance Centre, Harbour City, Tsimshatsui, HK, China. Diimport & Diedarkan Oleh: Mattel SEA Ptd Ltd. (993532-P) Lot 13.5, 13th Floor, Menara Lien Hoe, Persiaran Tropicana Golf Country Resort, 47410 PJ. Malaysia. Tel: 03-78803817, Fax: 03-78803867.

MONSTER HIGH

6+
MATTTEL
BJR46-0920G2

INSTRUCTIONS

CONTENTS

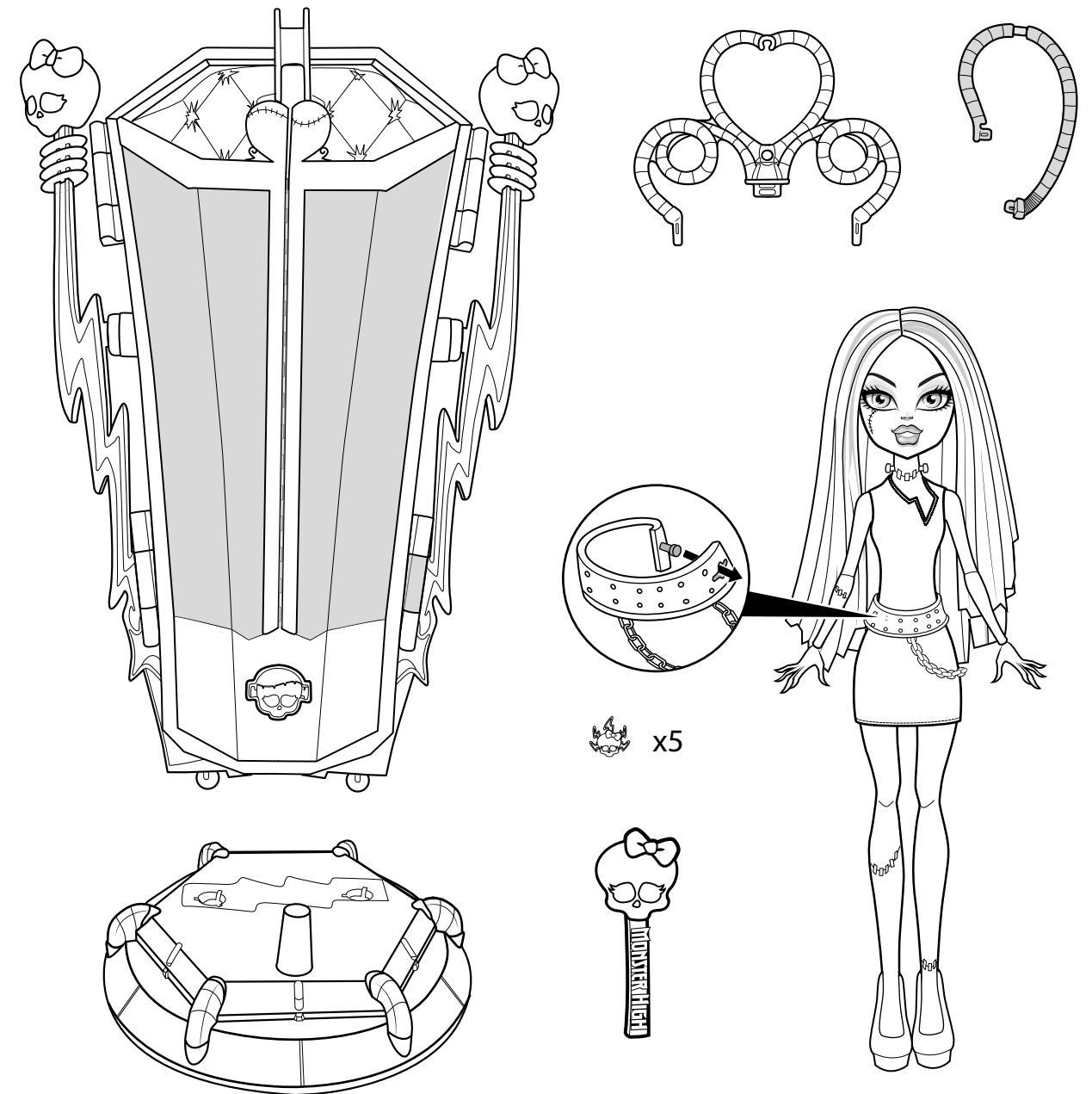

Intended for use with the doll included. High humidity may affect performance. This product emits flashing lights at 8 - 60 cycles per second for the flashing lights. Requires 3 "AA" Alkaline batteries, not included. Dispose of batteries safely.

WARNING:
CHOKING HAZARD - Small parts.
Not for children under 3 years.

Please remove everything from the package and compare to the contents shown here. If any items are missing, please contact your local Mattel office. Keep these instructions for future reference as they contain important information.

Assembly

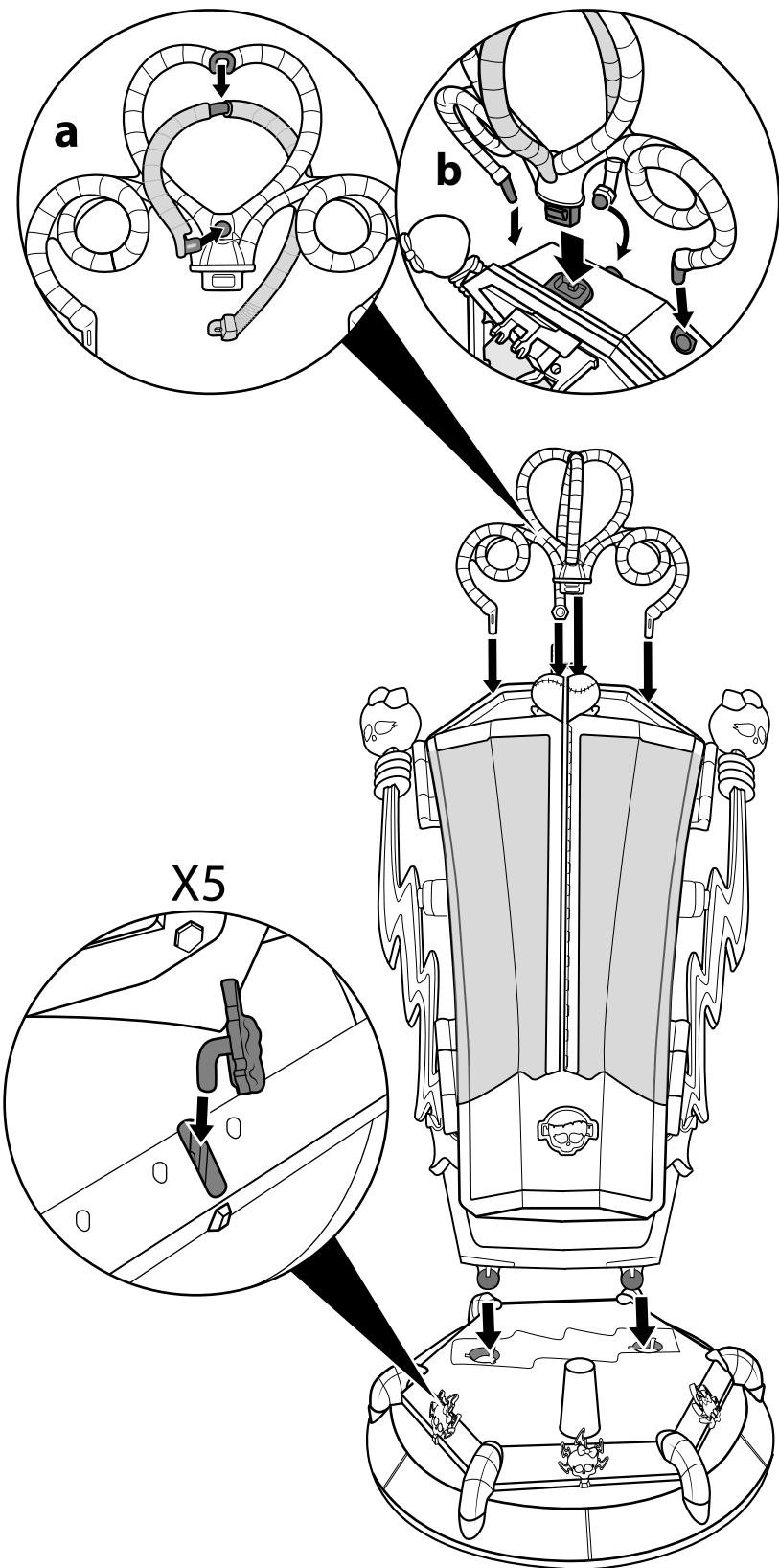

1 Brush doll's hair before each play.

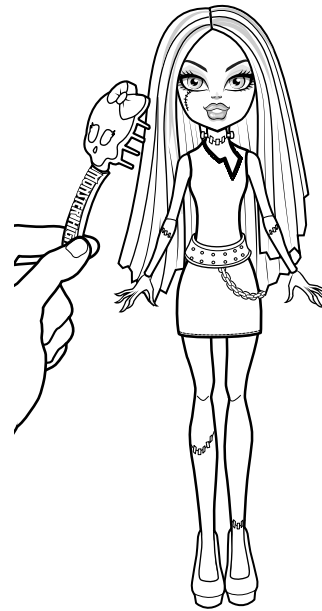

Let's Play!

2 Place doll inside and attach to doll clips.

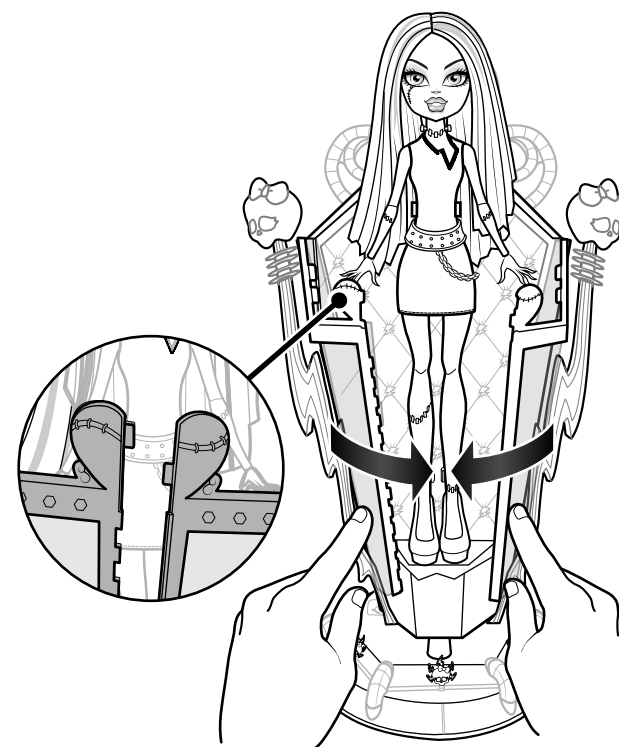
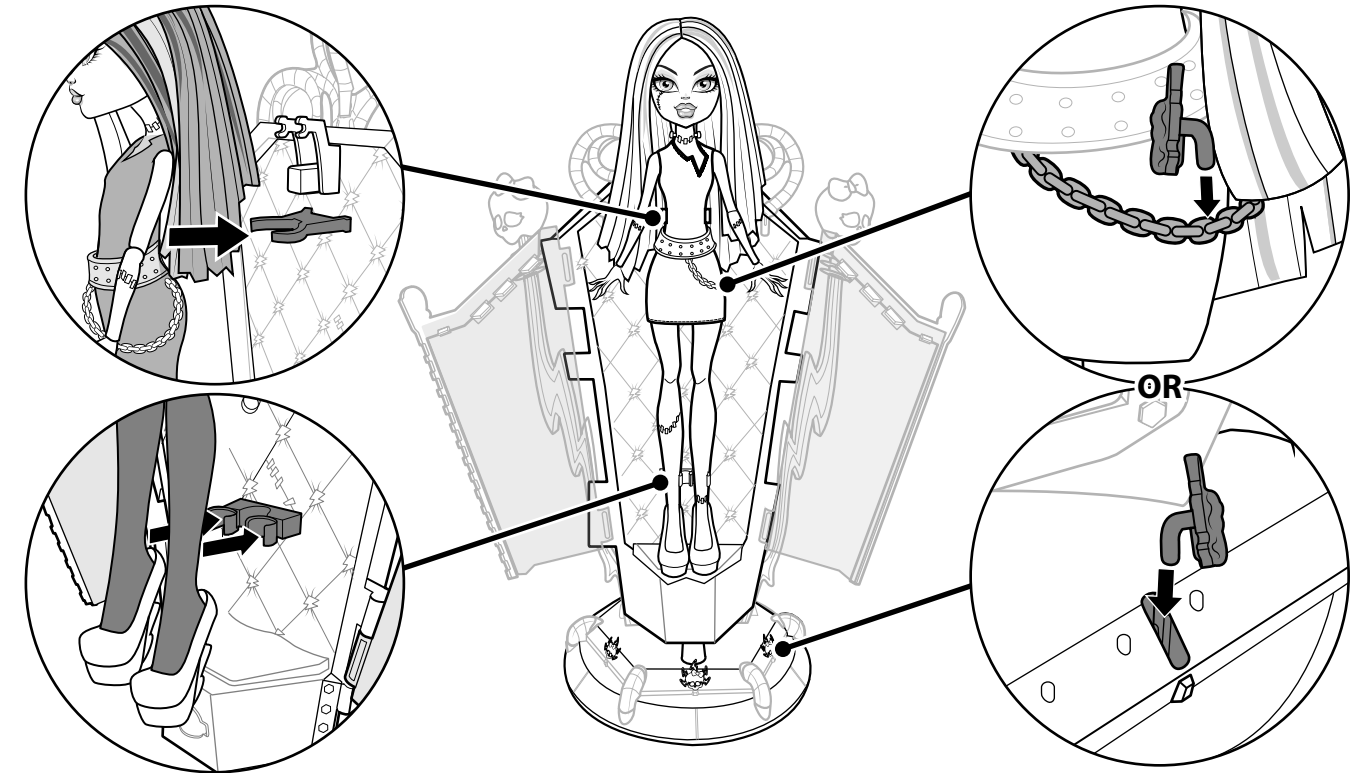

3 Always close doors before activating.

Tip: This scary-cool product uses Static Electricity! To learn more about how static electricity works, visit monsterhigh.com

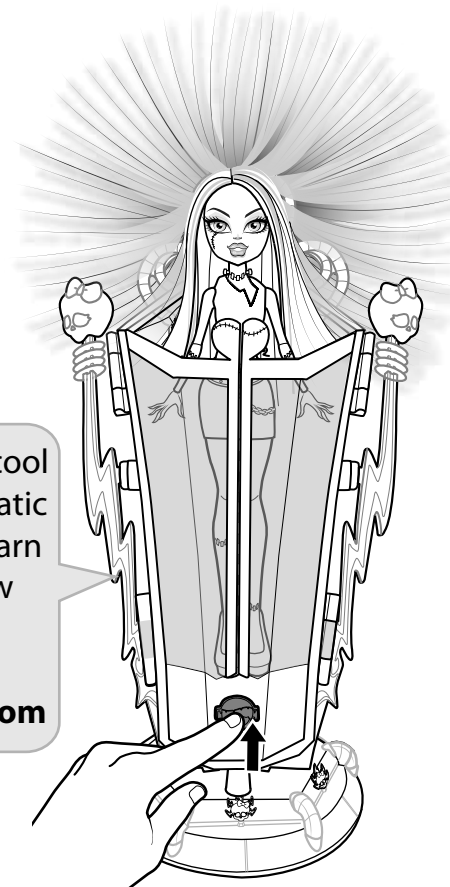

4 Press and hold button to make doll's hair stand on end. Release to stop. The static-effect function will stop after 15 seconds, even if you continue to hold down the button.

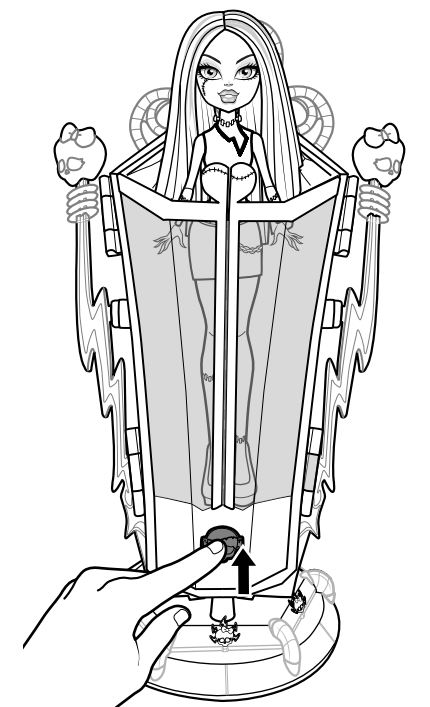

5 Press for lights! Each press of the button will cause the light to change in this order: red, green, blue, white, off.

6 The light stays on once activated, and automatically turns off after approximately 5 minutes OR after you cycle through the colors. To re-activate, press button again.