



WARNING: Do not aim at eyes or face. Only use projectiles supplied with this toy. Do not fire at point blank range. Always wear appropriate eye-wear, sold separately.

WHIPBLAST™ BLASTER

6+

Please keep these instructions for future reference as they contain important information.

1 CONTENTS

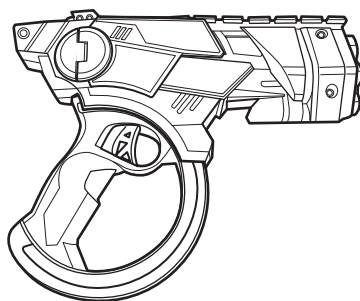

x 4

⚠ CAUTION: Do not aim at eyes or face.
TO AVOID INJURY: Use only darts designed for this product.
Do not modify darts or dart blaster.

2 TO PLAY 1: WHIPBLAST™ MODE

A. Activate shields.

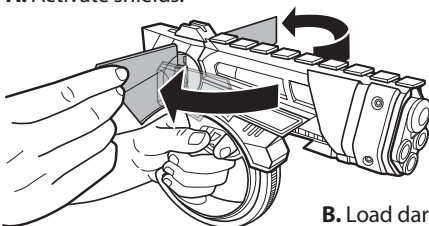

C. Hold button and push barrel all the way down until "CLICK!"

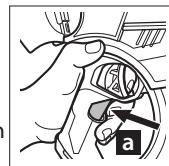

B. Load darts into barrel and storage.

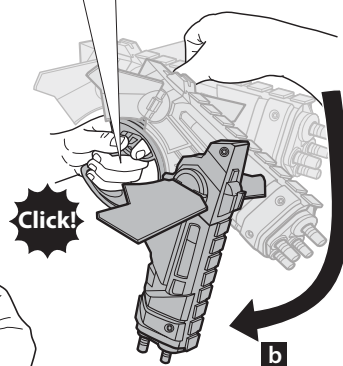
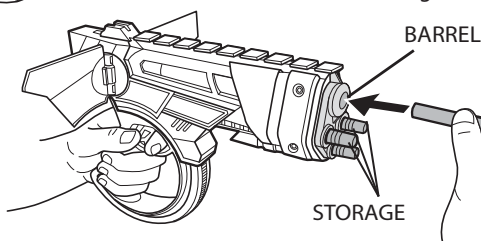

2 TO PLAY 1: WHIPBLAST™ MODE (CONTD.)

D. 2 Hands Charge: Hold button and push barrel all the way back up to charge blaster.

1 Hand Charge: Try whipping the barrel all the way back up to charge blaster!

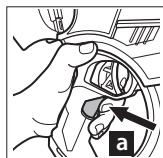
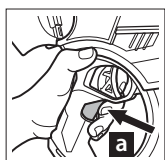

E. Pull trigger to fire. Load dart from storage into barrel. Charge blaster to fire again!

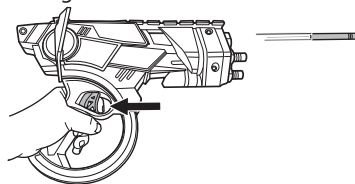

NOTE: Unload darts when not in use.

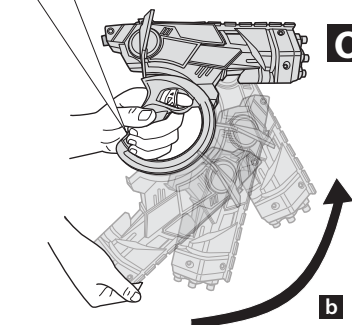

OR

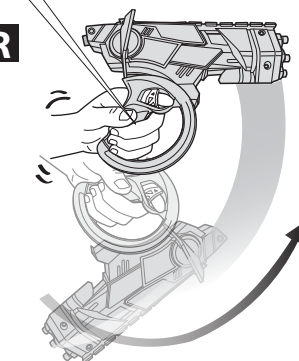

b

IMPORTANT: Handle with care. Do not whip barrel when shields or other accessories are attached to blaster rail.

3 TO PLAY 2: ADVANCED WHIPBLAST™ MODE

Master your skills! Charge blaster by whipping the barrel down and back up with only one hand!

A. Hold button and whip barrel all the way down until "CLICK!"

B. Hold button and whip barrel all the way up.

C. Pull trigger to fire.

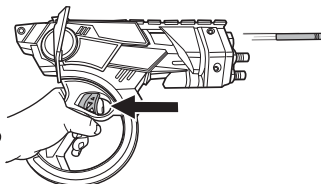

Click!

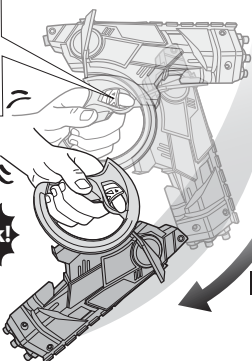

b

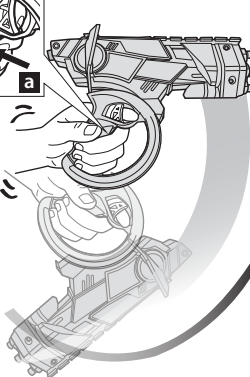

b

IMPORTANT: Be sure barrel has been whipped all the way down before whipping it back up.

4 TO PLAY 3: DEFENSE MODE

A. Adjust shields.

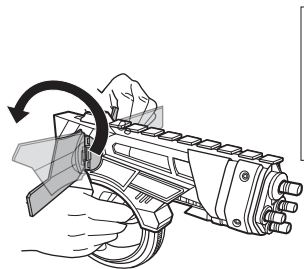

B. Push barrel down until "CLICK!"

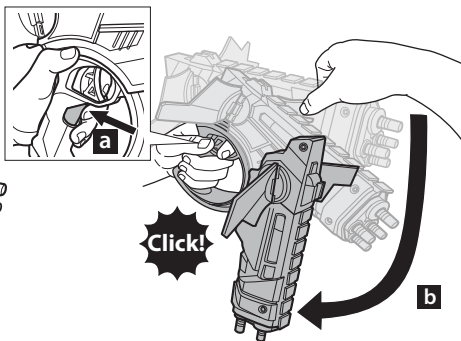

C. Capture your friends' darts.

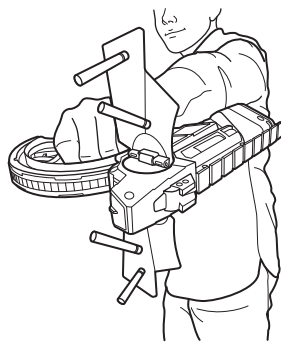

5 PERFORMANCE TIPS

A. For best charging ease, keep finger off trigger and firmly press the middle blue button inward while charging.

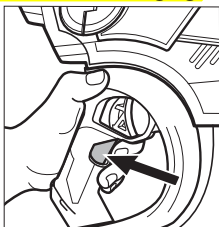

B. Be sure to fully charge, push or whip the barrel all the way down until "CLICK!" and the blue indicator is visible.

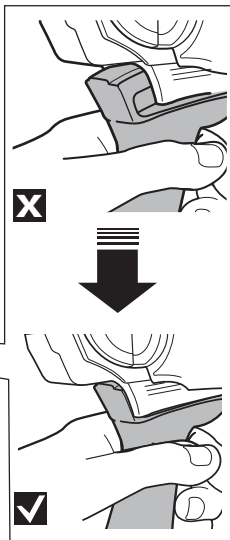

C. Blaster will not fire if barrel is not pushed all the way back up after charge. Push barrel all the way back if necessary.

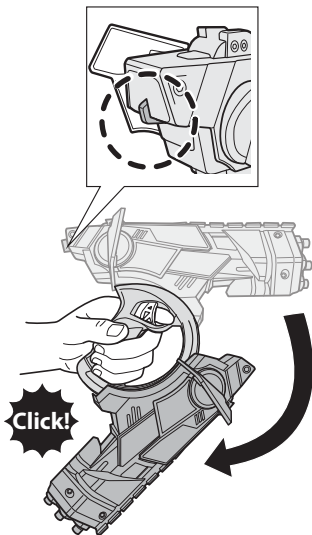
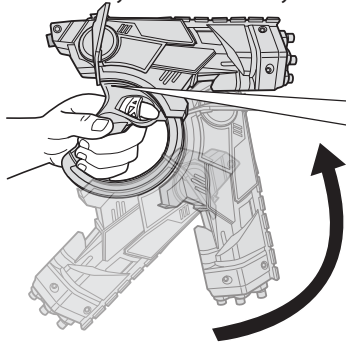

NOTE: Do not push barrel down when blaster is already charged.

6 ATTACHING TARGETS

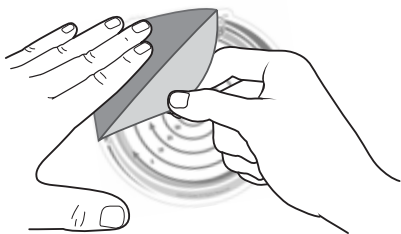

Peel backing off target before sticking it to surface.

- ✗ Do not stick target to walls or furniture as it may cause damage to the surface.

8 CLEANING DARTS

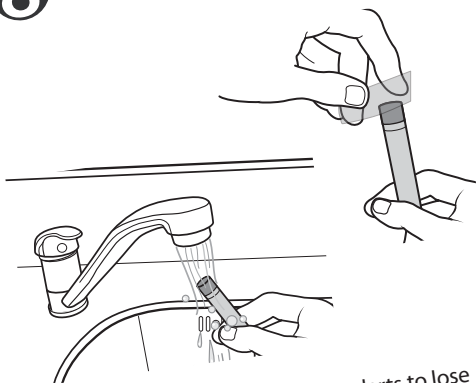

Dust, dirt, and other debris can cause darts to lose their adhesiveness.

To clean darts, rinse darts' tips with tap water or use tape to remove excess debris.

NOTE: Dry darts before using again.

7 REMOVING DARTS

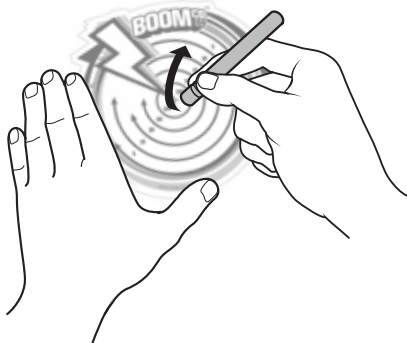

IMPORTANT:

Always remove darts from target after play. Keep one hand pressed on target, hold dart by the tip and gently peel dart off.

9 REPLACING TARGETS & SHIELDS



Y8620/BBY17

Replace time-worn targets and shields with **Y8620/BBY17 printable refills**.

Each sold separately, subject to availability.