

Hot Wheels WALL TRACKS
ROTO-ARM REVOLUTION™ 5+
HANGING TEMPLATE



Keep these instructions for future reference as they contain important information.

YOU WILL NEED:

- Low-adhesive tape such as painter's tape or masking tape
- Approximately 4 feet by 2 feet of open wall space
- 20 minutes

CONTENTS:

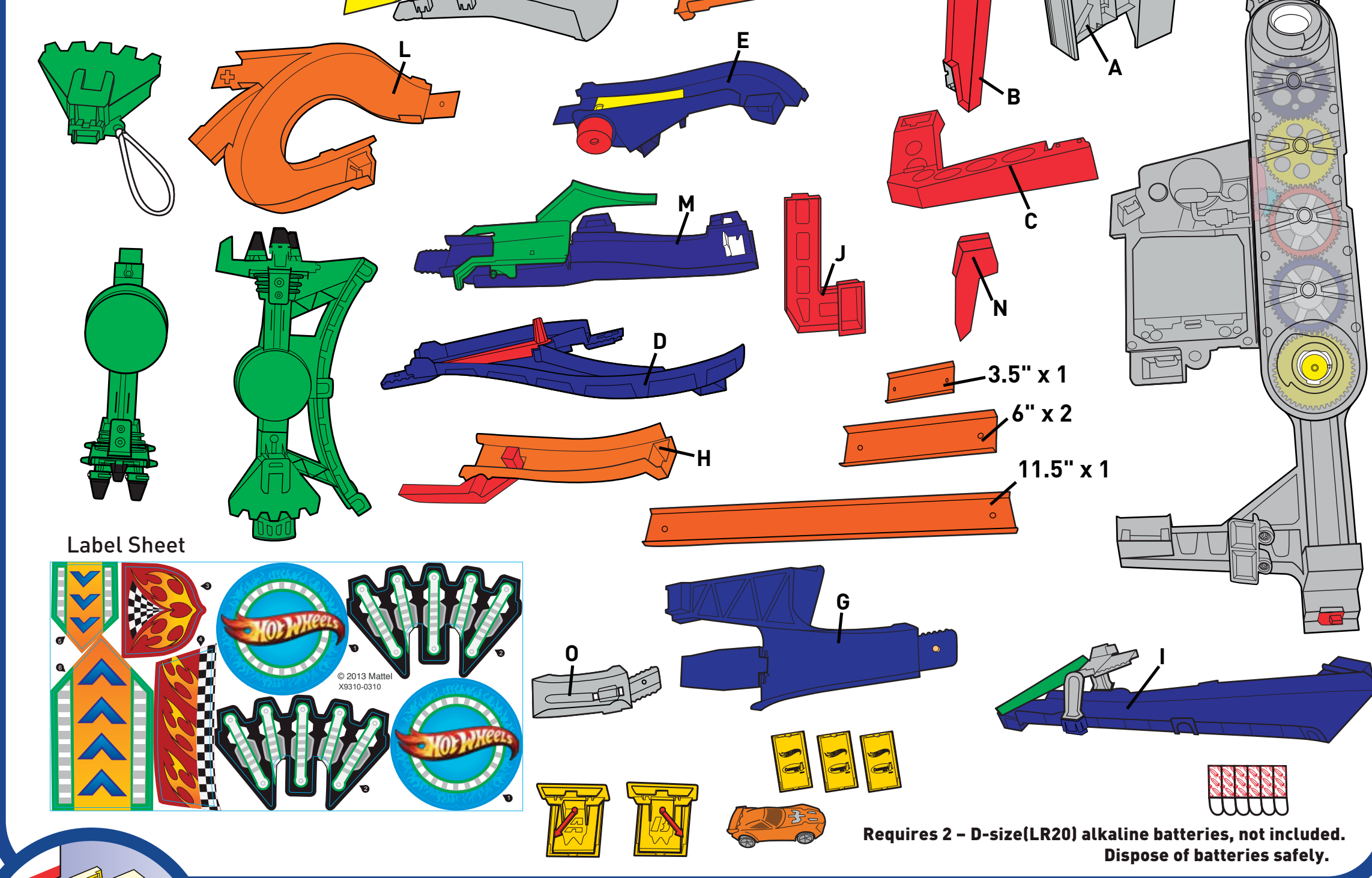

APPLY LABELS
 Helpful Hint: Apply labels before assembly by number as indicated.

Brackets should NOT overlap template.
 PRESS FIRMLY FOR 30 SECONDS

START HERE:

Please read all instructions before beginning assembly and set-up.

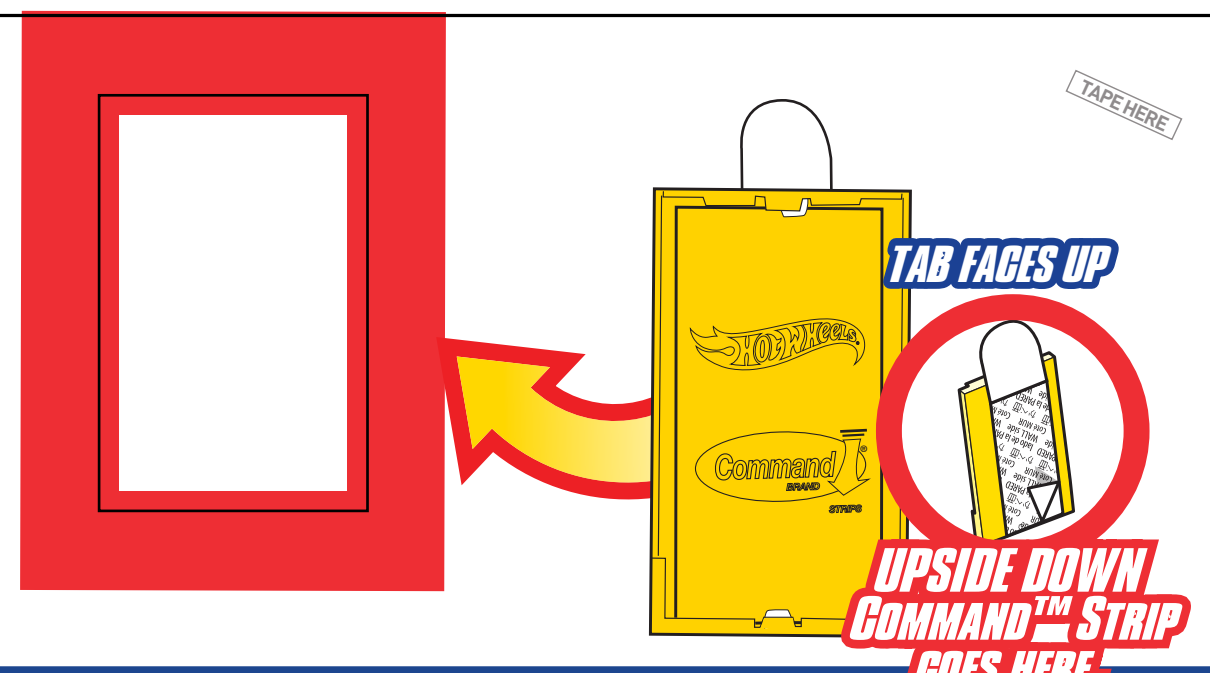

1 HANG TEMPLATE

Lie template flat and level against wall and tape as shown. Top of template should align with the height of the child.

NOTE TO PARENTS: Before applying Command® Strips make sure the wall surface is clean and dry. If cleaning is necessary 3M recommends using isopropyl rubbing alcohol. Do not use household cleaners.

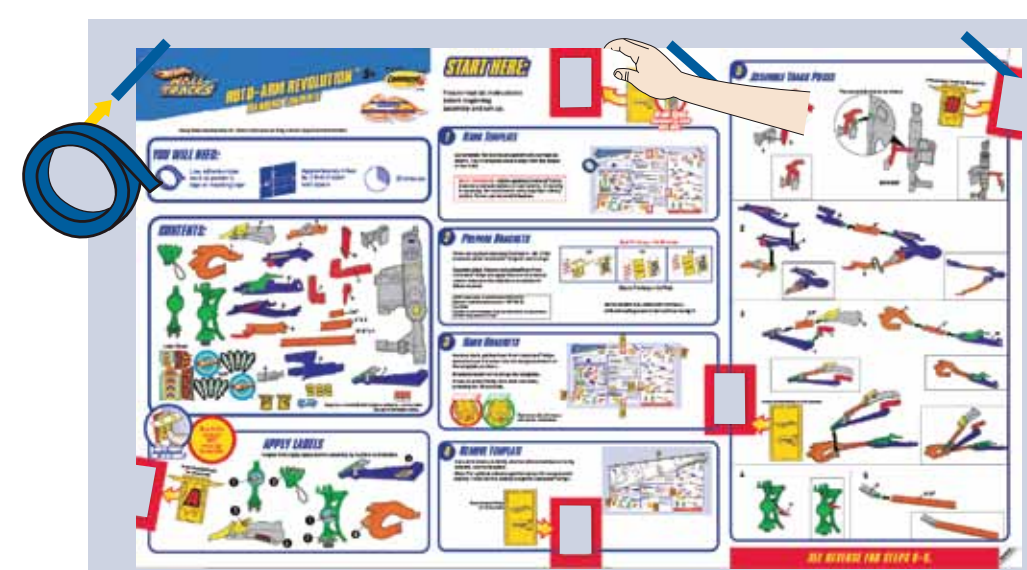

2 PREPARE BRACKETS

There are 2 yellow brackets (Marked A - B), 3 flat brackets and 6 Command® Strips (1 extra strip). Separate strips. Remove red-printed liner from Command® Strips and apply to back of brackets as shown. Make sure the strip tab is accessible for future removal.

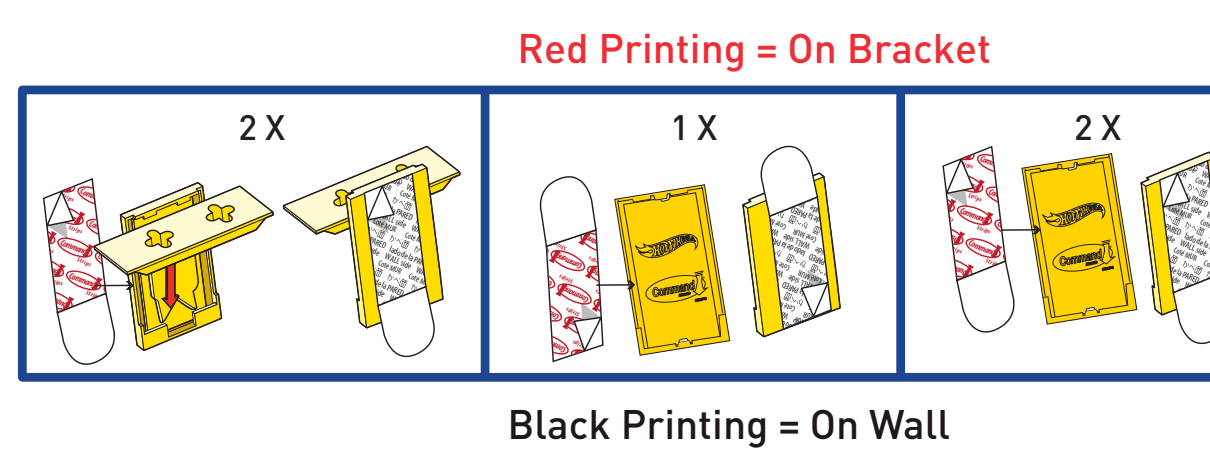

NOTE: Apply strips to surfaces above 50°F (10°C). Adhesive could lose adhesion above 100°F (40°C).
CAUTION: DO NOT use with wallpaper. May not adhere well to vinyl surfaces. DO NOT hang items over beds.

NOTE: DO NOT PULL BRACKET OFF WALL without reading removal instructions in step 9.

3 HANG BRACKETS

Remove black-printed liner from Command® Strips and attach each bracket into the designated notch of the template as shown. Bracket should not overlap the template. Press bracket firmly onto wall and hold, pressing for 30 seconds.

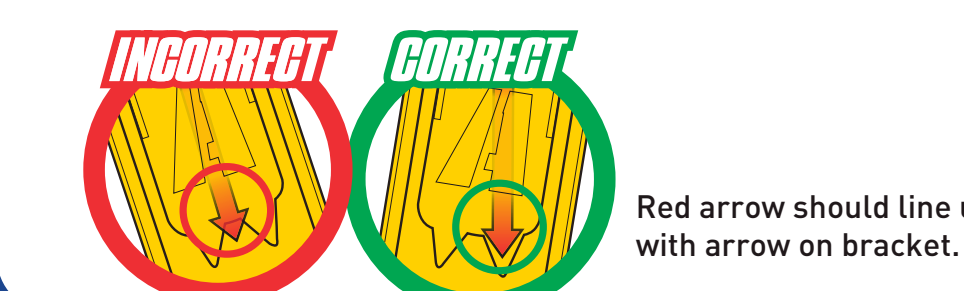

4 REMOVE TEMPLATE

Once all brackets are firmly attached with red arrows correctly oriented, remove template. Note: For optimal adhesion performance 3M recommends waiting 1 hour before adding weight to Command® Strips.

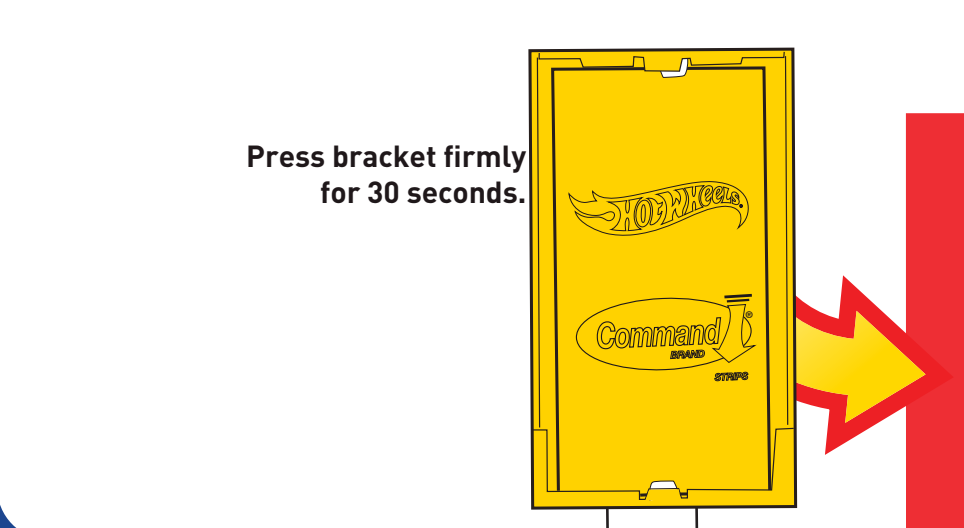

5 ASSEMBLE TRACK PIECES

Pre-assemble pieces as shown.

1. Assemble pieces A, B, C, D, E, F, G, H, I, J, K, L, M, N, O, P, Q, R, S.

2. Assemble pieces D, E, F, G, H, I, J, K, L, M, N, O, P, Q, R, S.

3. Assemble pieces D, E, F, G, H, I, J, K, L, M, N, O, P, Q, R, S.

4. Assemble pieces D, E, F, G, H, I, J, K, L, M, N, O, P, Q, R, S.

5. Assemble pieces D, E, F, G, H, I, J, K, L, M, N, O, P, Q, R, S.

SEE REVERSE FOR STEPS 6-9.

SEE OTHER SIDE FOR STEPS 1-5

6 BATTERY INSTALLATION

- Unscrew the battery cover with a Phillips head screwdriver (not included).
- Install 2 "D" size (LR20) alkaline batteries (not included) in the orientation (+/-) shown.
- Replace battery cover and tighten screw.
- For longer life use alkaline batteries.
- Replace batteries when vehicles can no longer reach the top of the track set.
- When exposed to an electrostatic source, the product may malfunction. To resume normal operation, remove and re-install the batteries.

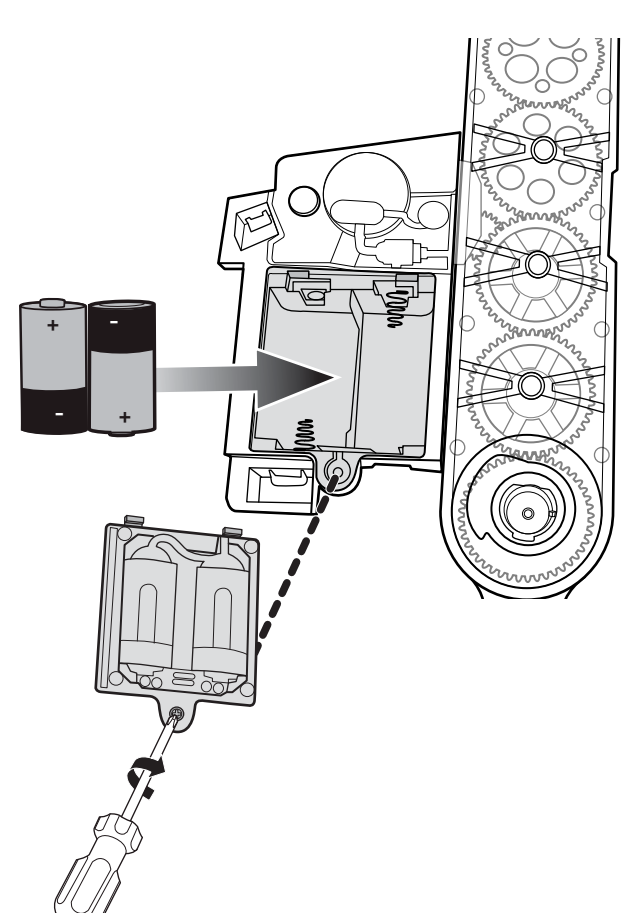

BATTERY SAFETY INFORMATION

- In exceptional circumstances batteries may leak fluids that can cause a chemical burn injury or ruin your product. To avoid battery leakage:
- Non-rechargeable batteries are not to be recharged.
 - Rechargeable batteries are to be removed from the product before being charged.
 - Rechargeable batteries are only to be charged under adult supervision.
 - Do not mix alkaline, standard (carbon-zinc), or rechargeable (nickel-cadmium) batteries.
 - Do not mix old and new batteries.
 - Only batteries of the same or equivalent type as recommended are to be used.
 - Batteries are to be inserted with the correct polarity.
 - Exhausted batteries are to be removed from the product.
 - The supply terminals are not to be short-circuited.
 - Dispose of battery(ies) safely.
 - Do not dispose of this product in a fire. The batteries inside may explode or leak.

Protect the environment by not disposing of this product with household waste [2002/96/EC]. Check your local authority for recycling advice and facilities.

NOTE: Changes or modifications not expressly approved by the manufacturer responsible for compliance could void the user's authority to operate the equipment.

7 HANG TRACK ON WALL

Once brackets are mounted and TEMPLATE IS REMOVED FROM WALL, attach track pieces as shown.

1. Attach track pieces to brackets.

2. Attach track pieces to brackets.

3. Attach track pieces to brackets.

4. Attach track pieces to brackets.

5. Attach track pieces to brackets.

8 LET'S PLAY!

Send your cars in different directions!

Load car and launch!

Switch ON

Test your skills. Time your launch to destroy the claw!

Warning: Do not aim at eyes or face. Only use projectile supplied with this toy. Do not fire at point blank range.

9 REATTACHING & REMOVAL

Mounting brackets are designed to break away from the set without causing surface damage. If mounting plate separates from bracket, snap bracket back into place.

Remove track pieces from wall prior to removing brackets.

To remove brackets from the wall entirely:

- NEVER pull strip towards you.
- Hold bracket gently to prevent it from snapping fingers. DO NOT press against wall.
- Grab tab on Command® Strip and SLOWLY STRETCH STRAIGHT DOWN ALONG WALL AT LEAST 12 INCHES until bracket and strip release.

Purchase medium Command® Refill Strips to reapply to your wall.

CONNECT Create your own set-ups with other Wall Tracks™ sets.