



WRECKING BRAWL™ INSTRUCTIONS

6+

Please keep these instructions for future reference as they contain important information.

CONTENTS

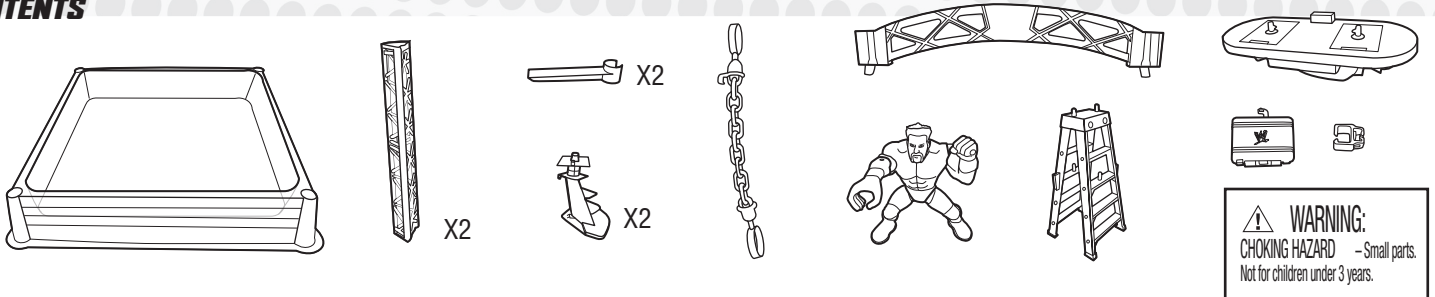

ASSEMBLY

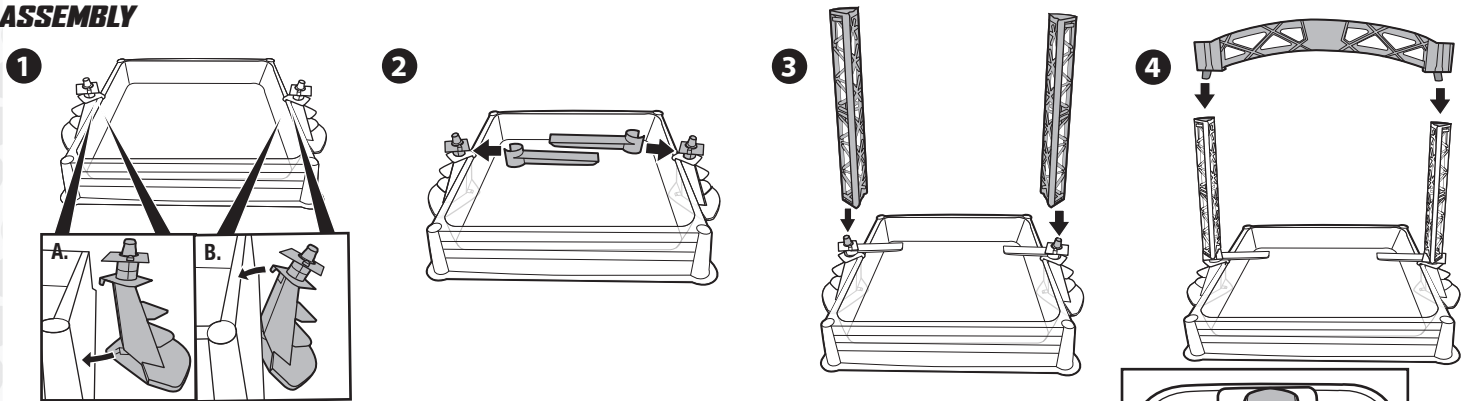

SET UP NOTE: REPEAT SET UP BEFORE EACH "TO PLAY".

A. CRANK CLOCKWISE



B. RESET HANDLE

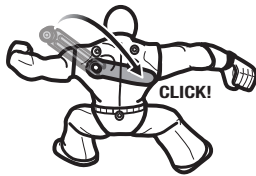

TO PLAY 1

1

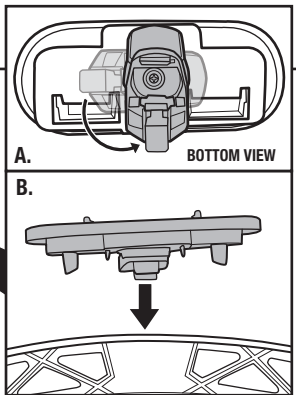
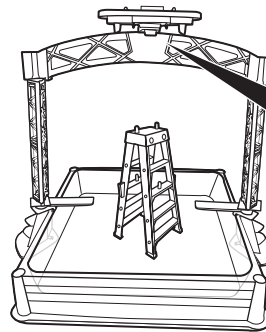

2

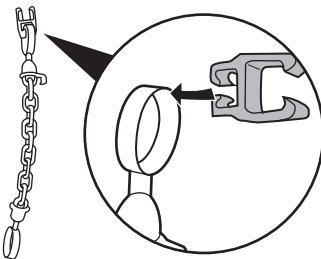

3

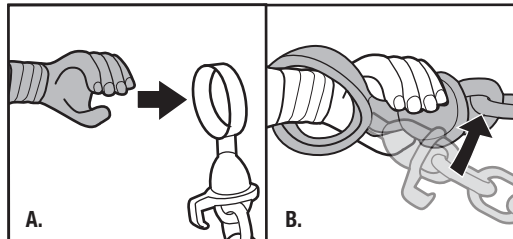

4

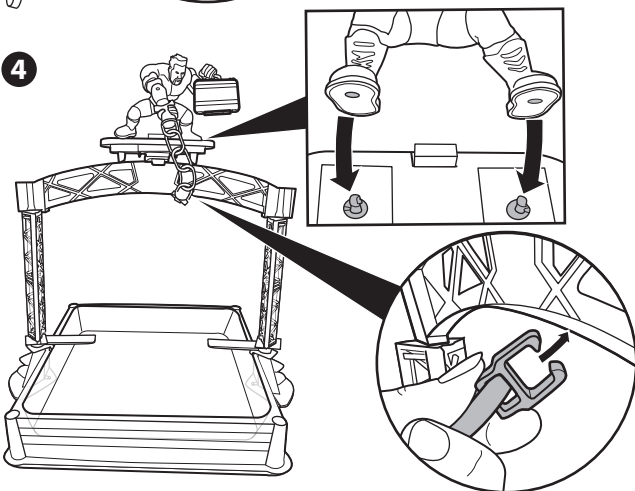

5 PRESS HEAD FORWARD, CLICK HEAD AND RELEASE.

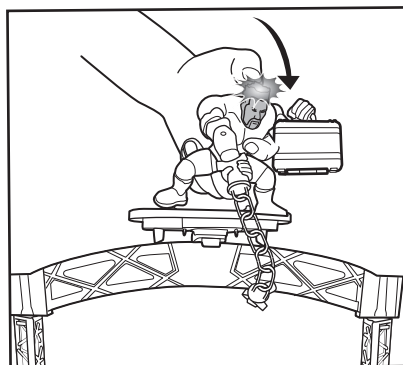

6 PRESS BUTTON TO LAUNCH FIGURE.

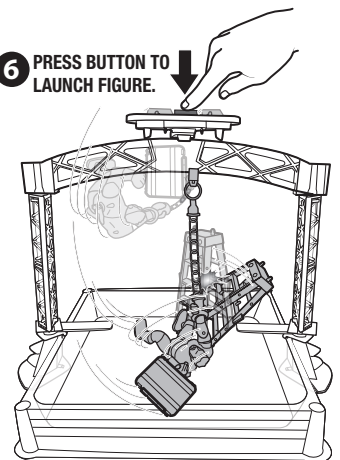

TO PLAY 2

Sheamus™ figure included. Additional figures sold separately, subject to availability.

1 SNAP HANDS AROUND OPPONENT'S WRIST

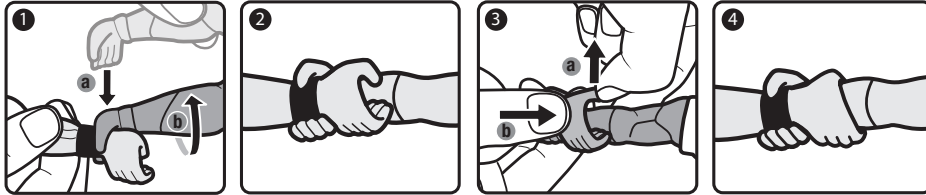

2

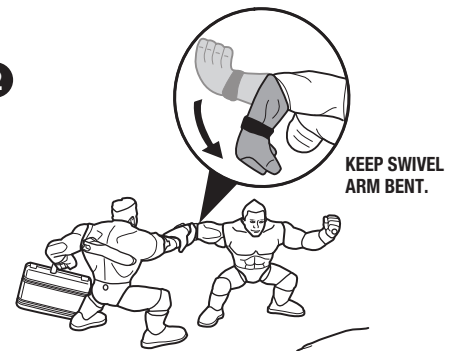

3

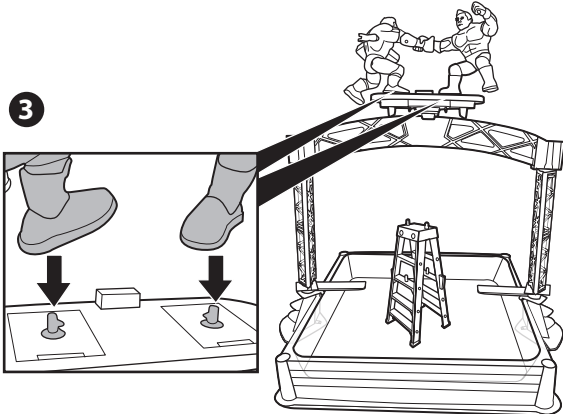

4

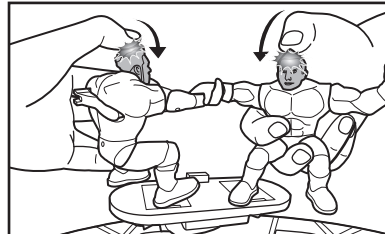

PRESS HEADS FORWARD, CLICK HEADS AND RELEASE.

5

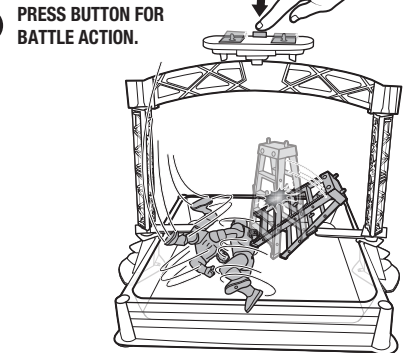

PRESS BUTTON FOR BATTLE ACTION.

TO PLAY 3

1 PRESS AND HOLD BUTTON TO DETACH PLATFORM.

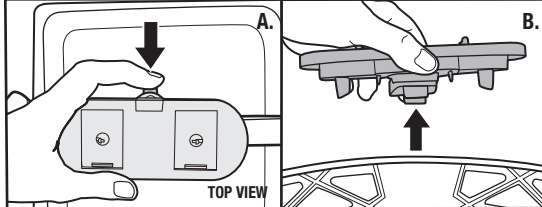

2

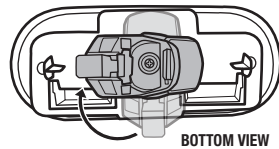

BOTTOM VIEW

3

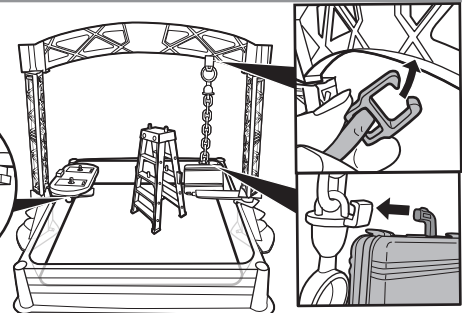
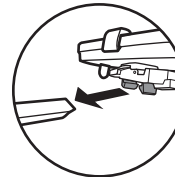

4

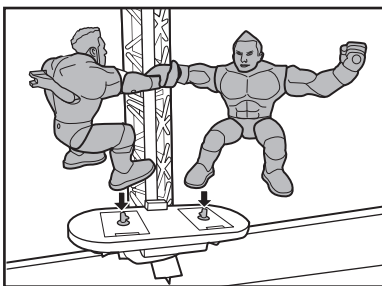

5

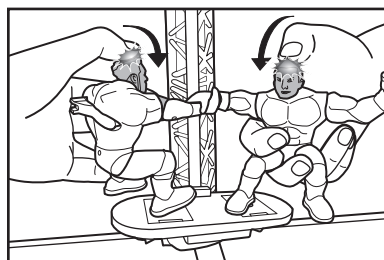

PRESS HEADS FORWARD, CLICK HEADS AND RELEASE.

6

PRESS BUTTON FOR BATTLE ACTION.

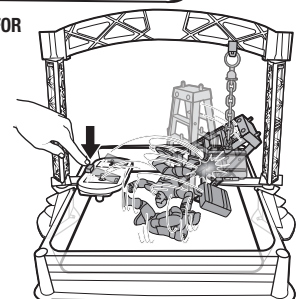

TO PLAY 4

CONNECT RIGHT ARMS TO CHAIN.

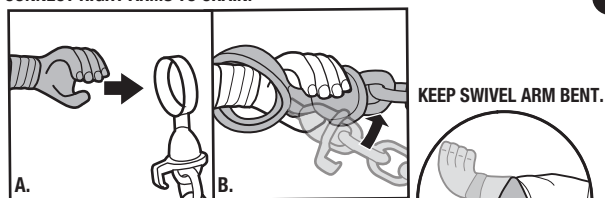

2

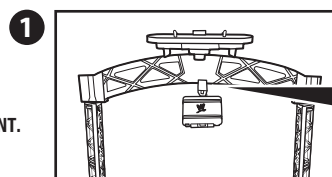

3

PRESS HEADS FORWARD, WHEN HEADS CLICK, RELEASE FOR BATTLE ACTION.

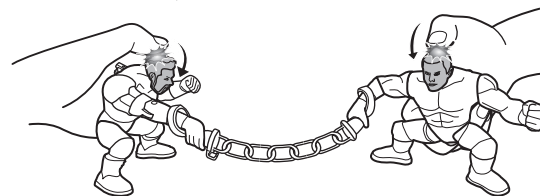

4

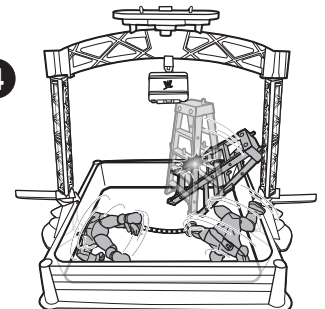

All WWE programming, talent names, images, likenesses, slogans, wrestling moves, trademarks, logos and copyrights are the exclusive property of WWE and its subsidiaries. All other trademarks, logos and copyrights are the property of their respective owners. © 2013 WWE. All Rights Reserved.

©2013 Mattel. All Rights Reserved.

Mattel, Inc. 636 Girard Avenue, East Aurora, NY 14052, U.S.A. Consumer Relations 1-800-524-8697. Mattel Canada Inc., Mississauga, Ontario L5R 3W2. You may call us free at 1-800-524-8697. Mattel U.K. Ltd., Vanwall Business Park, Maidenhead SL6 4UB. Helpline 01628 500303. Mattel Australia Pty., Ltd., Richmond, Victoria. 3121. Consumer Advisory Service - 1300 135 312 Mattel East Asia Ltd., Room 1106, South Tower, World Finance Centre, Harbour City, Tsimshatsui, HK, China. Diimport & Diedarkan Oleh: Mattel SEA Ptd Ltd.(993532-P) Lot 13.5, 13th Floor, Menara Lien Hoe, Persiaran Tropicana Golf Country Resort, 47410 PJ. Tel:03-78803817, Fax:03-78803867.

service.mattel.com

Y0009-0920

