



ESCAPE FROM FRANK TRACK SET INSTRUCTIONS

4+

CONTENTS

WARNING:
CHOKING HAZARD - Small parts.
Not for children under 3 years.

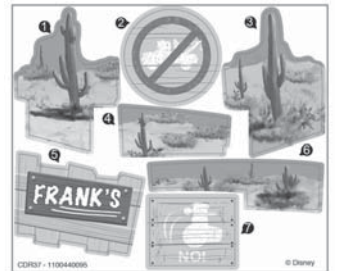
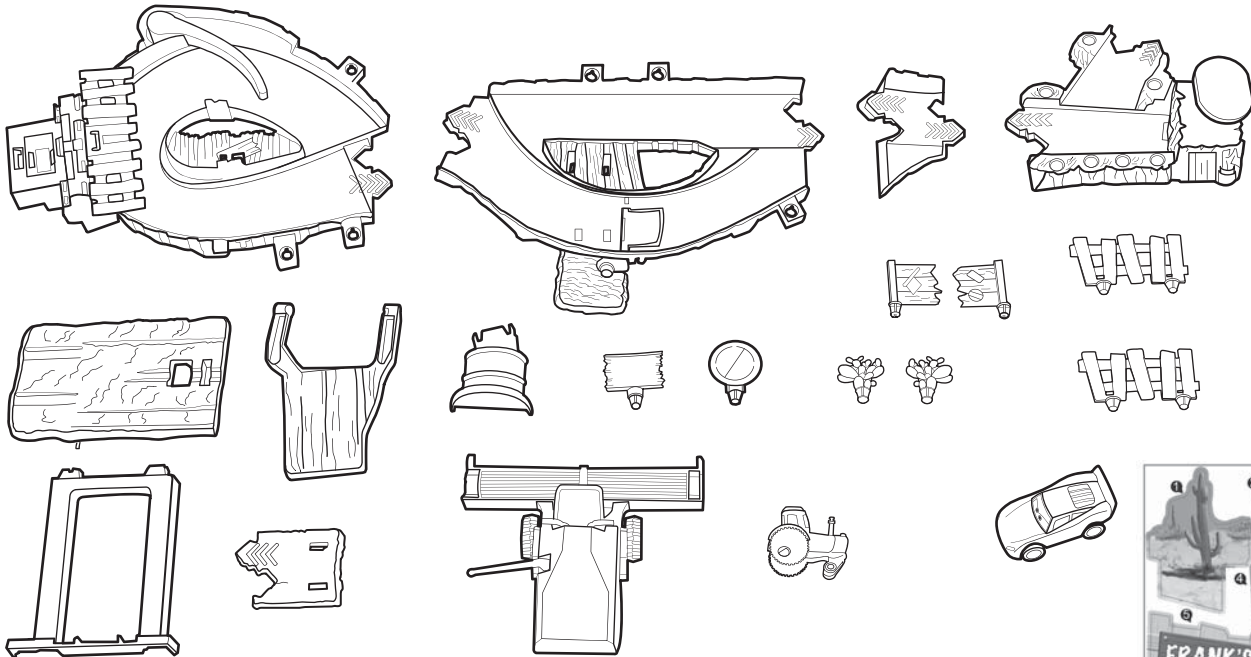

Label Sheet

1 / APPLY LABELS

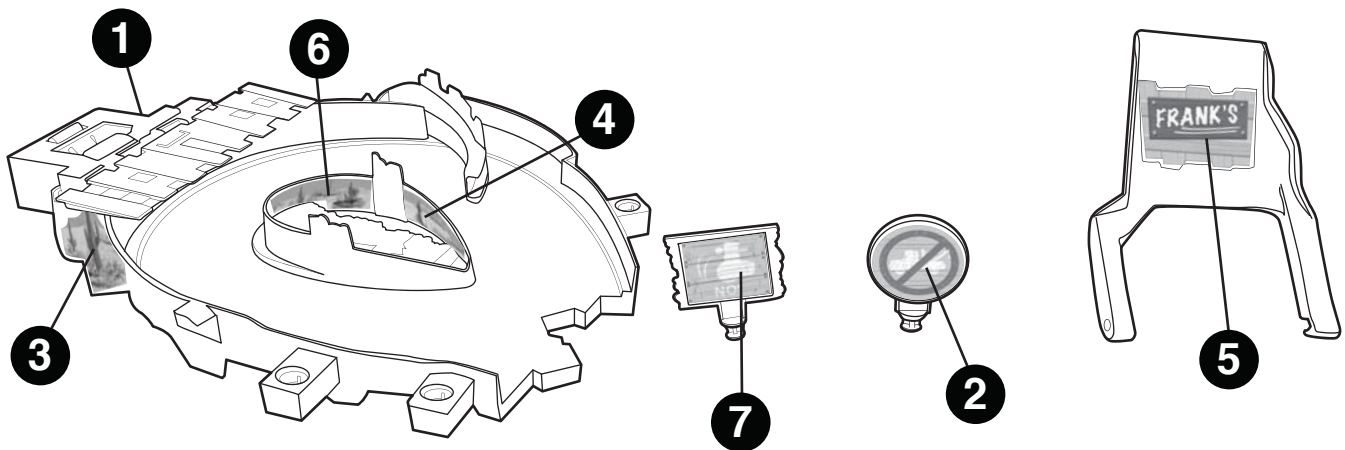

©2014 Mattel. All Rights Reserved. ® and ™ designate U.S. trademarks of Mattel, except as noted.
Mattel, Inc., 636 Girard Avenue, East Aurora, NY 14052, U.S.A. Consumer Relations 1-800-524-8697. Mattel U.K. Ltd., Vanwall Business Park, Maidenhead SL6 4UB. Helpline 01628 500303. Mattel Australia Pty., Ltd., Richmond, Victoria. 3121. Consumer Advisory Service - 1300 135 312. Mattel East Asia Ltd., Room 503-09, North Tower, World Finance Centre, Harbour City, Tsimshatsui, HK, China. Diimport & Diedarkan Oleh: Mattel Southeast Asia Pte. Ltd., No 19-1, Tower 3 Avenue 7, Bangsar South City, No 8, Jalan Kerinchi, 59200 Kuala Lumpur, Malaysia. Tel: 03-78803817, Fax: 03-78803867.



2 / ASSEMBLY

1

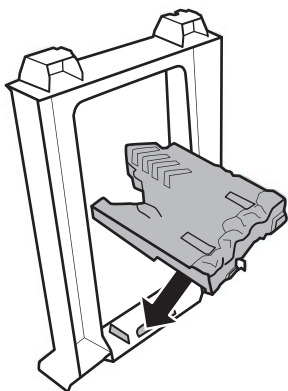

2

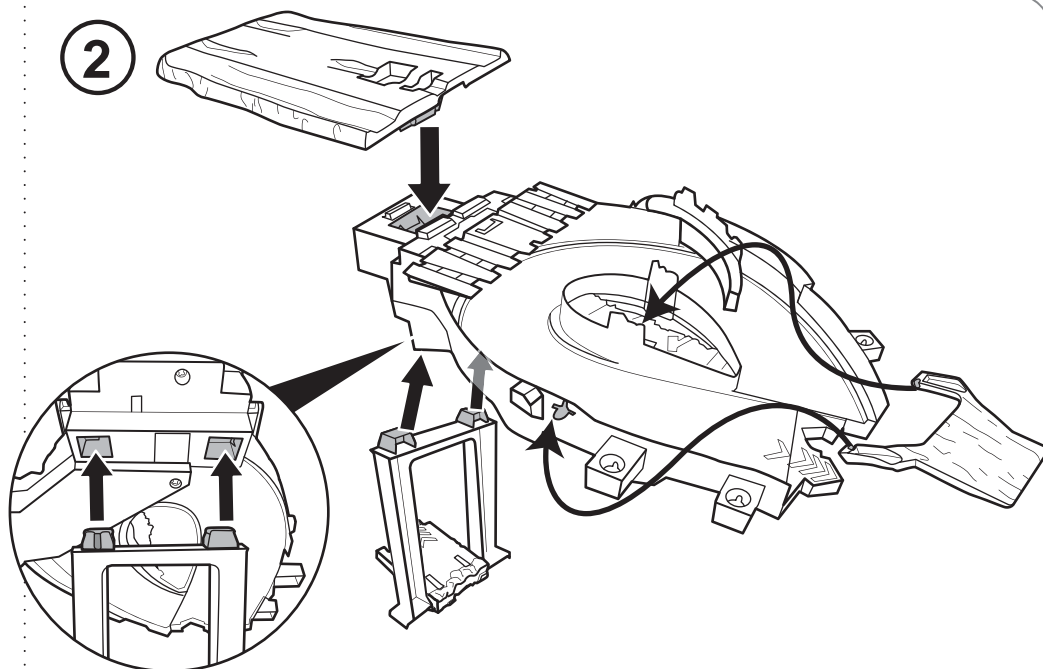

3

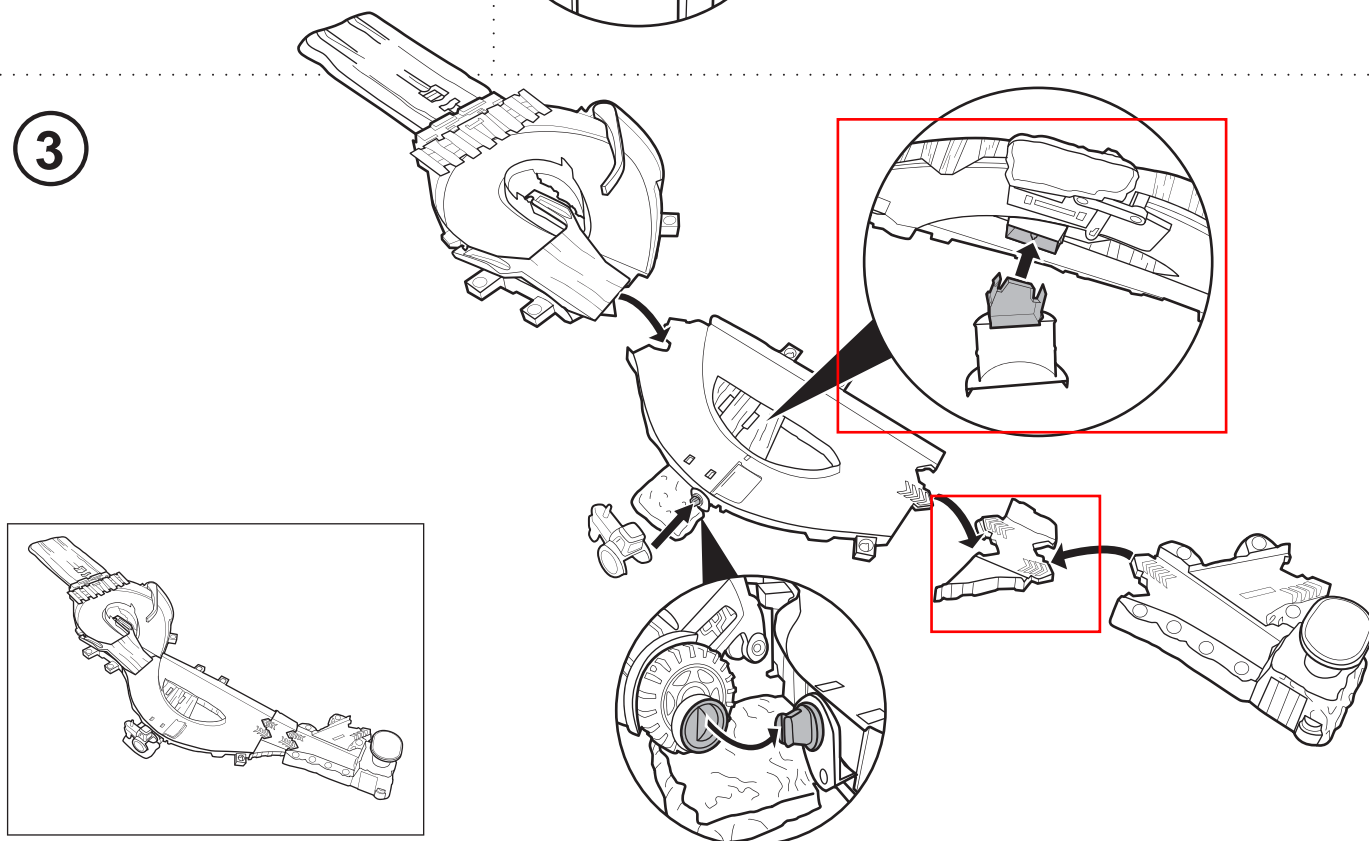

4

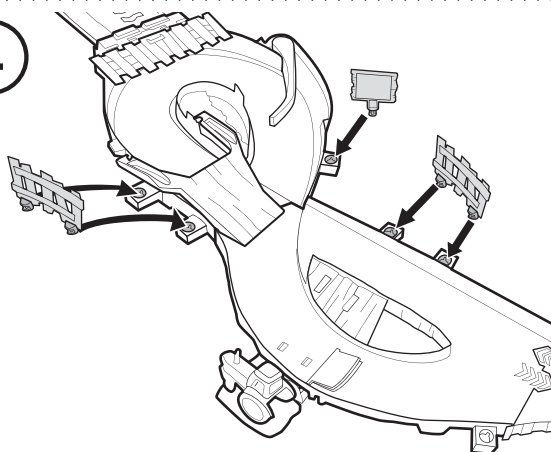

5

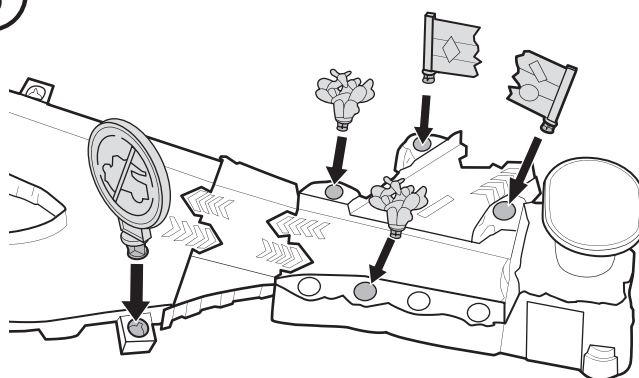

ACCESSORIES ARE INTERCHANGEABLE. MOVE THEM AROUND AS DESIRED.

3 / LET'S PLAY

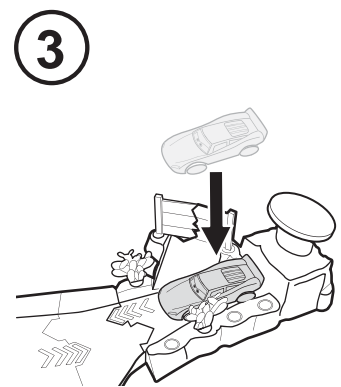
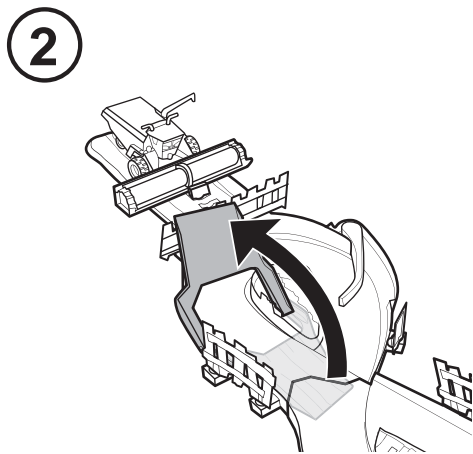
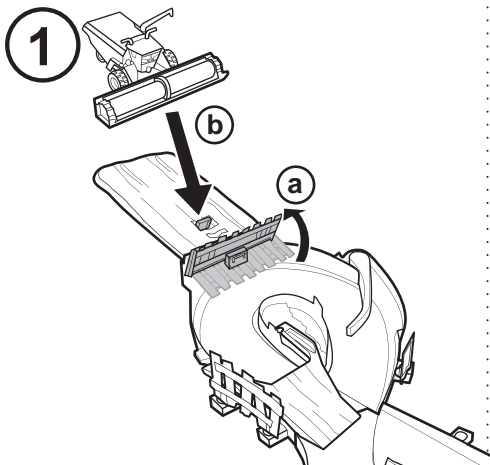

- ④ POUND LAUNCHER REPEATEDLY TO RACE LAPS AROUND THE TRACK. TRY HITTING HARDER OR SOFTER TO FIND THE BEST PERFORMANCE.

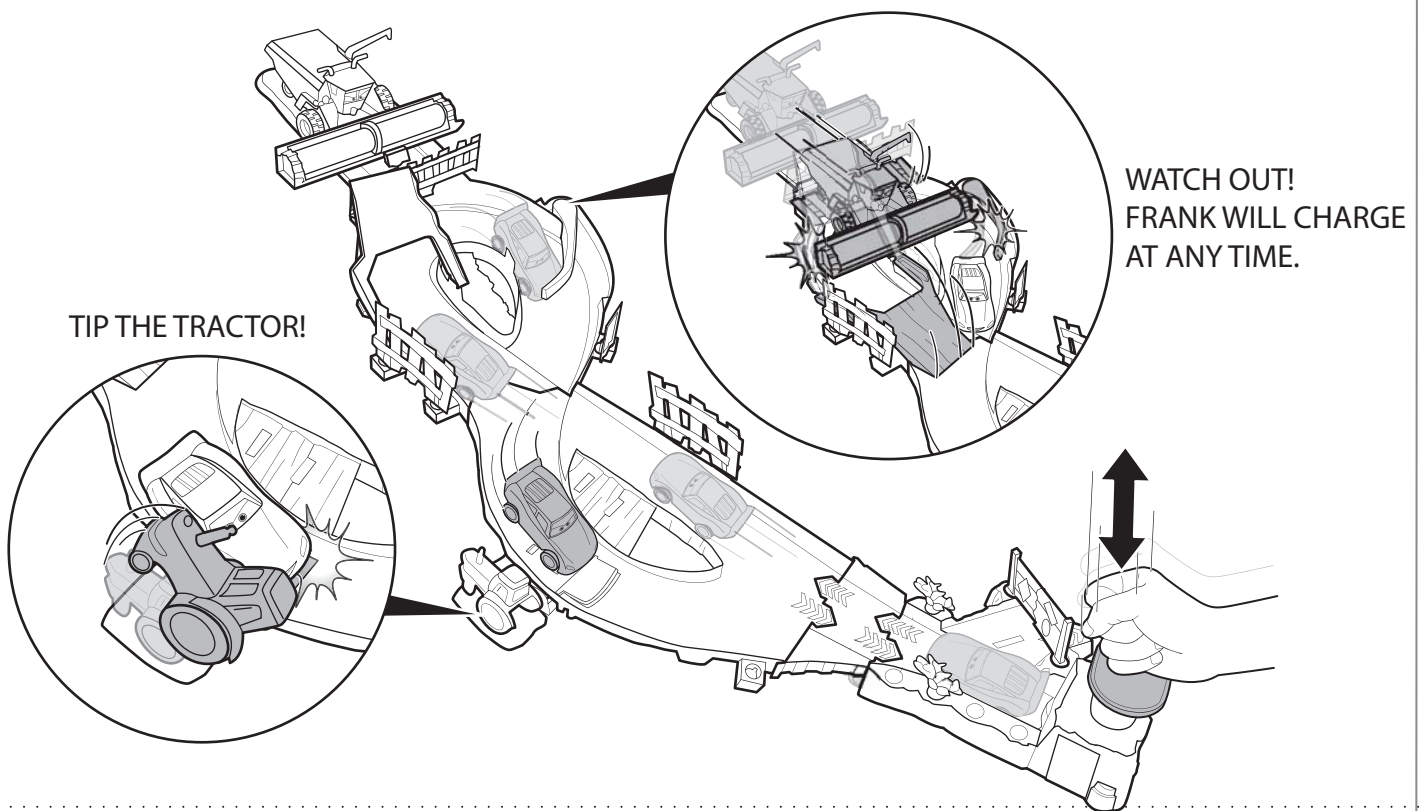

- ⑤ JUMP OVER FRANK TO ESCAPE!

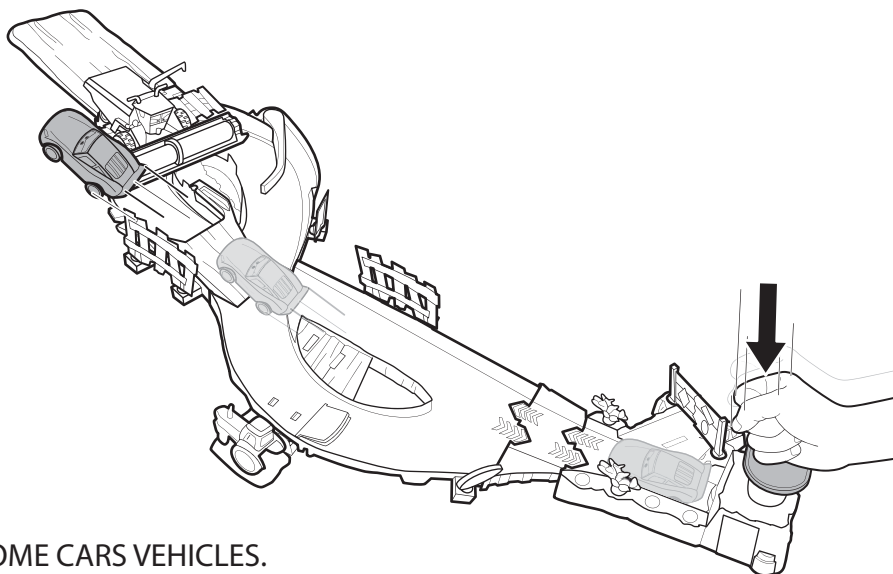

NOT FOR USE WITH SOME CARS VEHICLES.

4 / MORE WAYS TO PLAY

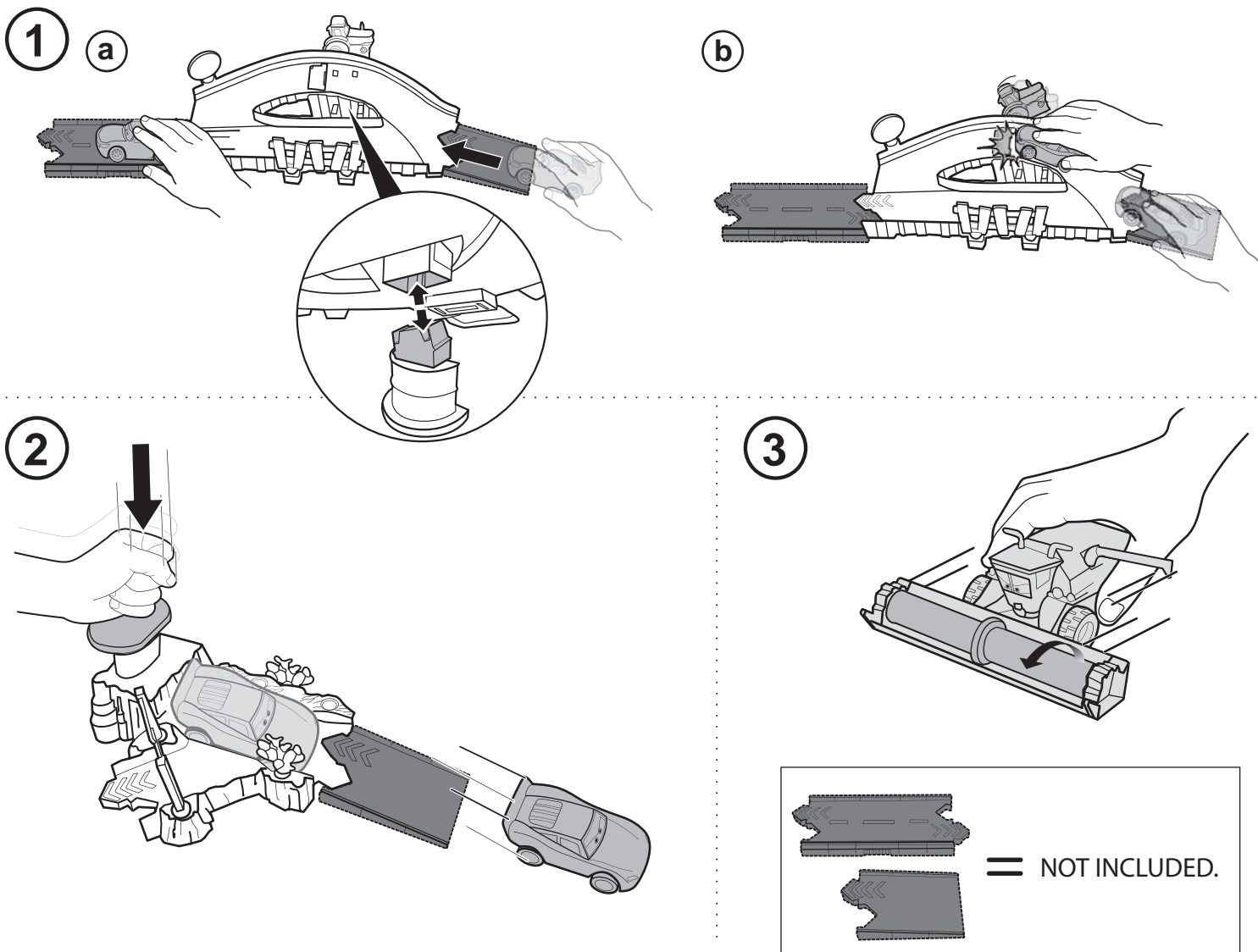

5 / COLLECT & CONNECT STORY SETS

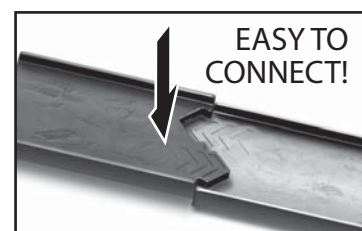
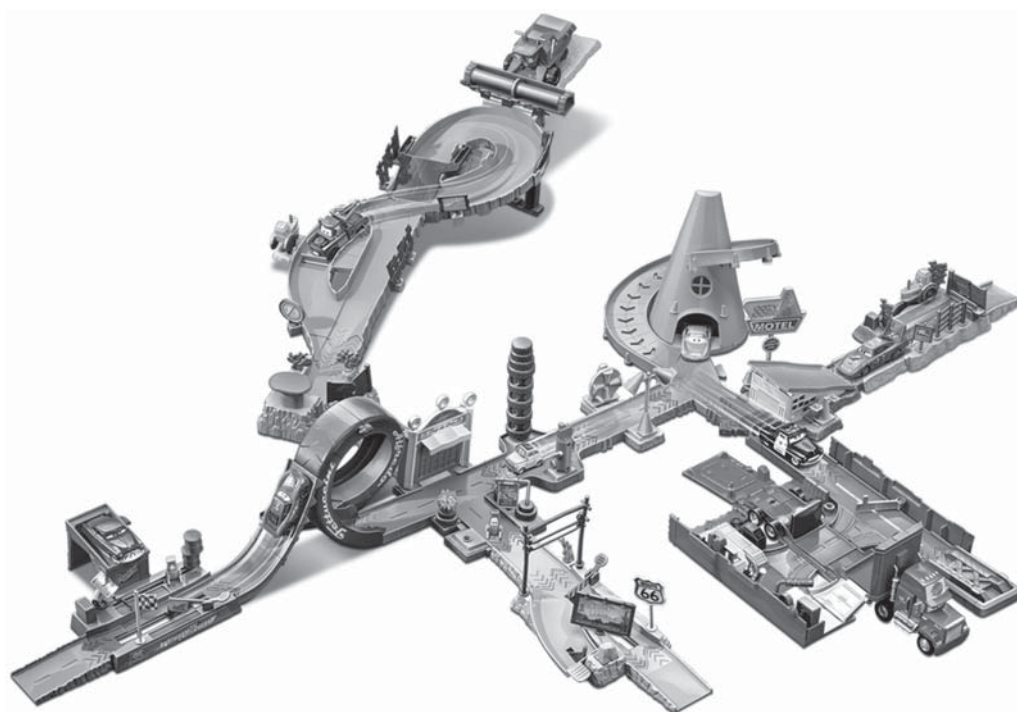

PLAYSETS WITH VEHICLES EACH SOLD SEPARATELY, SUBJECT TO AVAILABILITY.