

# Puppy Palace Adventure

Keep these instructions for future reference as they contain important information.

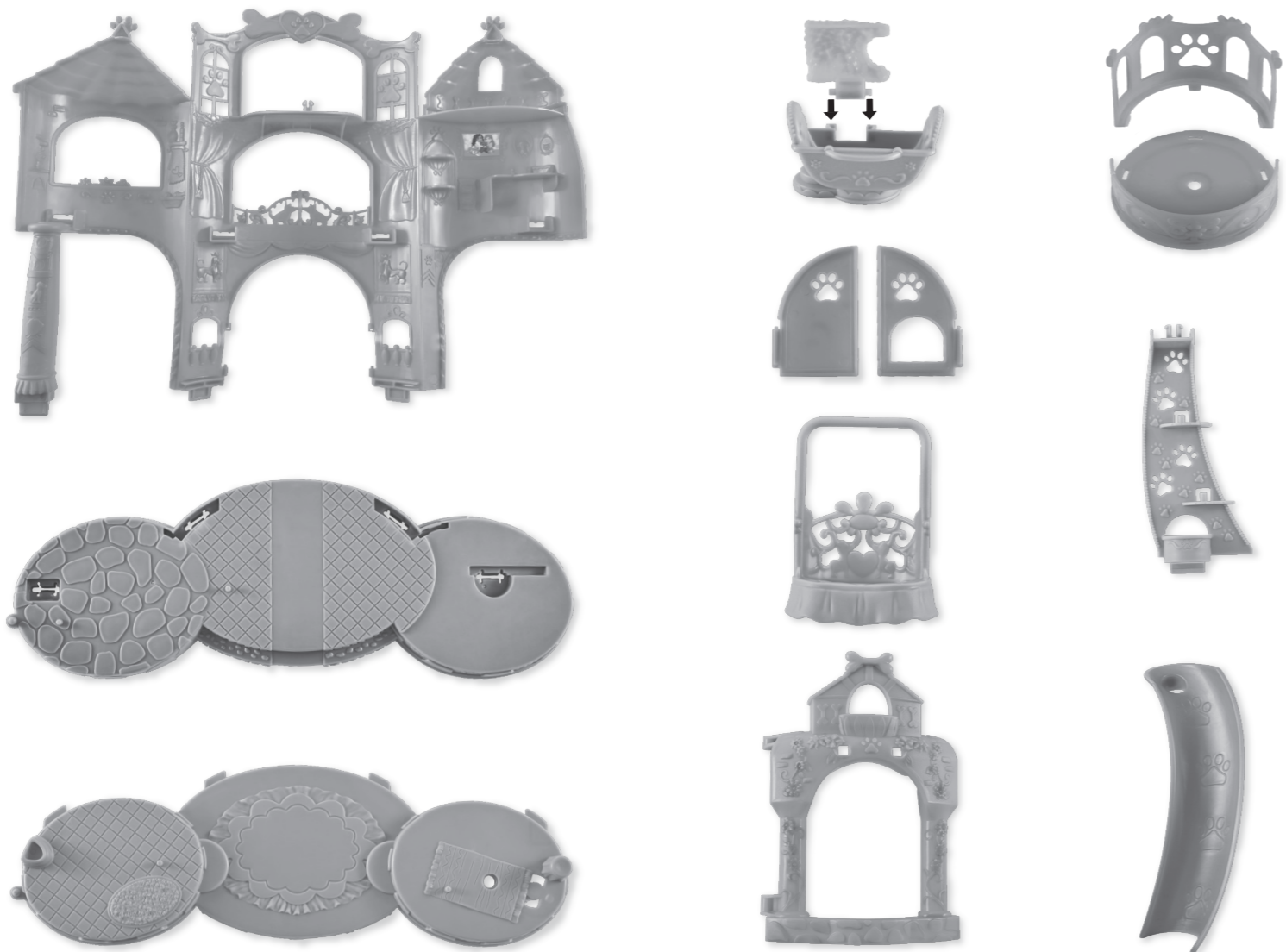

## ASSEMBLY PARTS



## ASSEMBLY

\* NOTE: These assemblies are "one-time snaps". Once these pieces are snapped together, they cannot be taken apart.

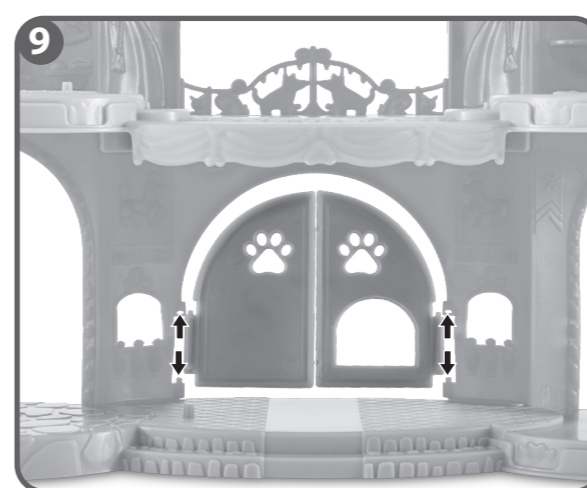
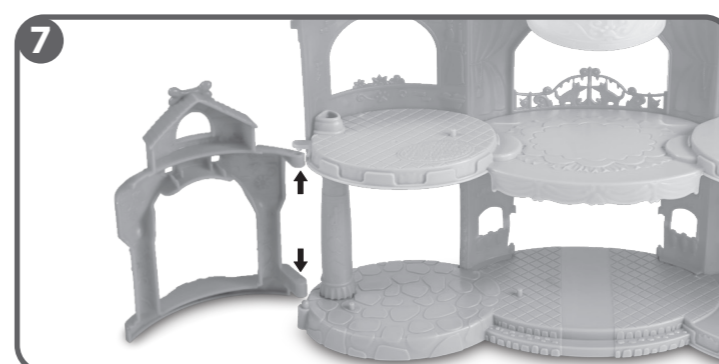
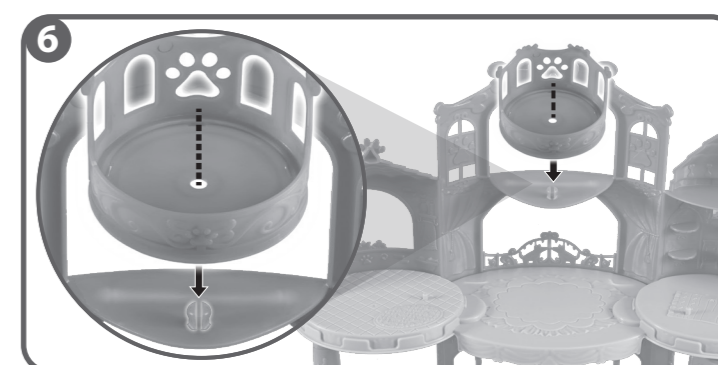
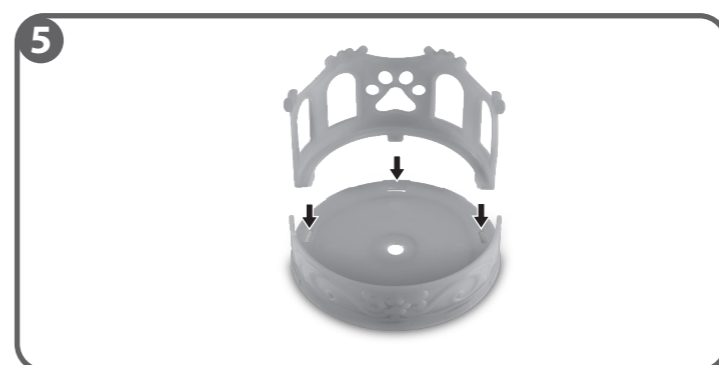
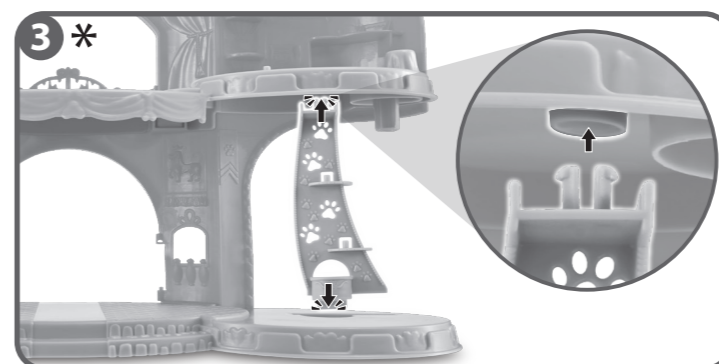
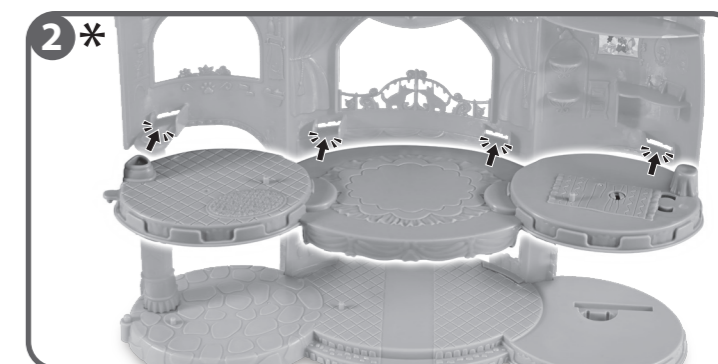
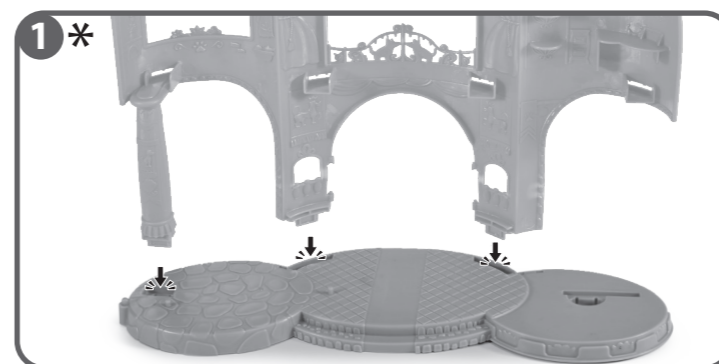

**CONSUMER ASSISTANCE**  
 1-800-432-5437 (US & Canada)  
 1300 135 312 (Australia)  
[www.service.fisher-price.com](http://www.service.fisher-price.com)

**Fisher-Price, Inc.**, 636 Girard Avenue, East Aurora, NY 14052.  
 Hearing-impaired consumers: 1-800-382-7470.

**Outside the United States:**  
 Canada: Mattel Canada Inc., 6155 Freemont Blvd., Mississauga, Ontario L5R 3W2; [www.service.mattel.com](http://www.service.mattel.com).  
 Great Britain: Mattel UK Ltd, Vanwall Business Park, Maidenhead SL6 4UB. Helpline: 01628 500303. [www.service.mattel.com/uk](http://www.service.mattel.com/uk)  
 Mattel Europa B.V., Gondel 1, 1186 MJ Amstelveen, Nederland.  
 Australia: Mattel Australia Pty. Ltd., 658 Church Street, Locked Bag #870, Richmond, Victoria 3121 Australia.  
 New Zealand: 16-18 William Pickering Drive, Albany 1331, Auckland.

**WARNING:** CHOKING HAZARD - Small parts. Not for children under 3 years.

**ADULT ASSEMBLY REQUIRED.**  
 No tools needed.

© 2015 Viacom International Inc. All Rights Reserved. Nickelodeon, Dora, Dora and Friends, and all related titles, logos and characters are trademarks of Viacom International Inc.

©2015 Mattel. All Rights Reserved. ® and ™ designate U.S. trademarks of Mattel, except as noted. **PRINTED IN CHINA.**  
 Mattel East Asia Ltd., Room 503-09, North Tower, World Finance Centre, Harbour City, Tsimshatsui, HK, China.

CGT79-0970  
 1100708970-DOM  
**Fisher-Price®**