



1



2



3

Please keep this instruction sheet for future reference,
as it contains important information.

Requires three AA (LR6) **alkaline** batteries (not included) for operation.

Adult assembly is required.

Tool required for battery installation: Phillips screwdriver (not included).

Use as a mobile from birth until 5 months.

A mobile is intended for visual stimulation and not to be grasped by a child.

Wipe this toy with a clean, damp cloth. Do not immerse this toy.

Assembled Parts



WARNING

Prevent Entanglement Injury

Crib Mobile Use

- Keep out of baby's reach.
- Remove mobile from crib or playpen when baby begins to push up on hands and knees.
- This product may not attach to all crib designs. Do not add additional strings or straps to attach to a crib or playpen.

Stroller Toy Use

- Do not attach link directly to crib or playpen.



Mobile Clip

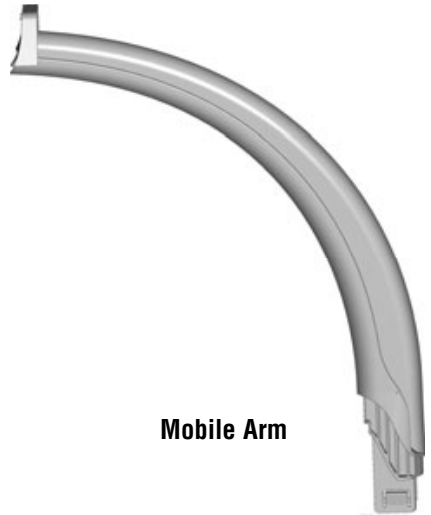

Mobile Arm

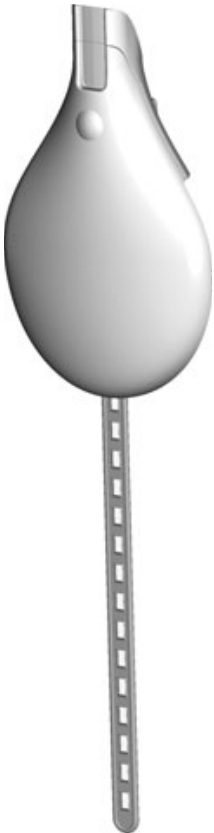

Mobile Base

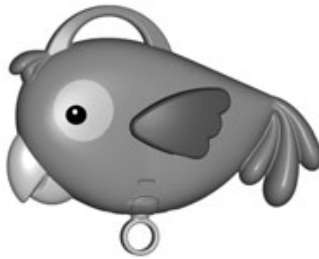

Bird



Link Toy

Crib Mobile Assembly

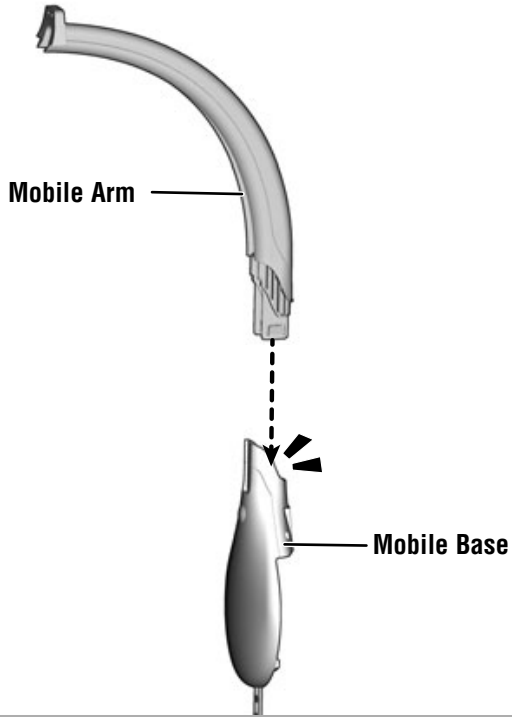

1

- Fit the mobile arm into the socket in the top of the base. Push to “snap” in place.

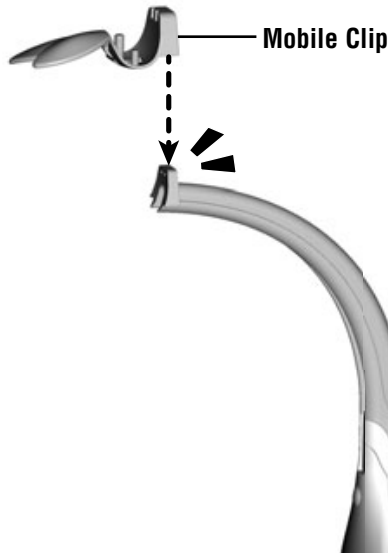

2

- Fit the mobile clip onto the free end of the mobile arm.
- Push to “snap” in place.

Crib Mobile Assembly

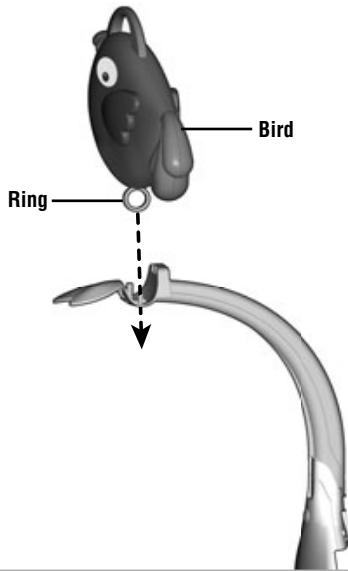

3

- Fit the bird onto the mobile clip.

Hint: You may need to turn the ring on the bottom of the bird to fit through the slot in the mobile clip.

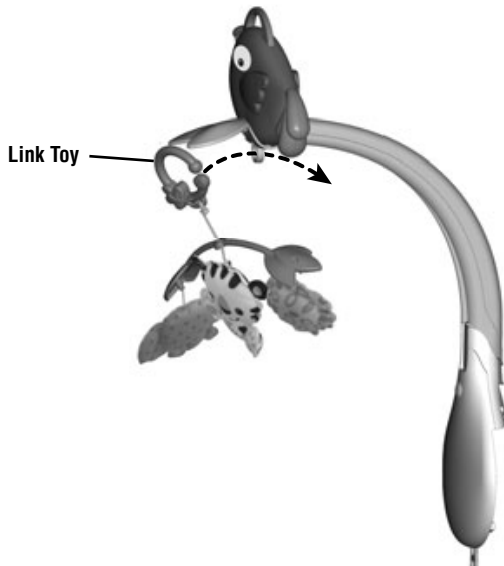

4

- Fit the open end of the link toy onto the ring on the bird.

Bird Battery Installation

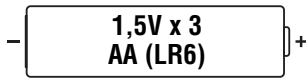

For longer life, use **alkaline** batteries.

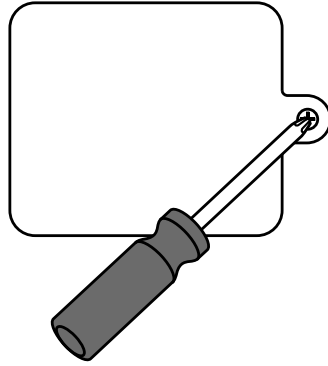

-
- Loosen the screw in the battery compartment door and remove the door.
 - Insert three AA (LR6) **alkaline** batteries.
 - Replace the battery compartment door and tighten the screw. Do not over-tighten.
 - If this toy begins to operate erratically, you may need to reset the electronics. Slide the power/volume switch off and back on.
 - When sounds/motion become faint or stop, it's time for an adult to change the batteries.
 - Protect the environment by not disposing of this product with household waste (2002/96/EC). Check your local authority for recycling advice and facilities.



Battery Safety Information

In exceptional circumstances, batteries may leak fluids that can cause a chemical burn injury or ruin your product. To avoid battery leakage:

- Do not mix old and new batteries or batteries of different types: alkaline, standard (carbon-zinc) or rechargeable (nickel-cadmium).
- Insert batteries as indicated inside the battery compartment.
- Remove batteries during long periods of non-use. Always remove exhausted batteries from the product. Dispose of batteries safely. Do not dispose of this product in a fire. The batteries inside may explode or leak.
- Never short-circuit the battery terminals.
- Use only batteries of the same or equivalent type, as recommended.
- Do not charge non-rechargeable batteries.
- Remove rechargeable batteries from the product before charging.
- If removable, rechargeable batteries are used, they are only to be charged under adult supervision.

Consumer Information



CONSUMER ASSISTANCE

1-800-432-5437 (US & Canada)
1300 135 312 (Australia)

service.fisher-price.com

Fisher-Price, Inc., 636 Girard Avenue, East Aurora, NY 14052.
Hearing-impaired consumers: 1-800-382-7470.

Outside the United States:

Canada: Mattel Canada Inc., 6155 Fremont Blvd.,
Mississauga, Ontario L5R 3W2; www.service.mattel.com.

Great Britain: Mattel UK Ltd, Vanwall Business Park,
Maidenhead SL6 4UB. Helpline: 01628 500303.
www.service.mattel.com/uk

Mattel Europa B.V., Gondel 1, 1186 MJ Amstelveen, Nederland.

Australia: Mattel Australia Pty. Ltd., 658 Church Street,
Locked Bag #870, Richmond, Victoria 3121 Australia.

New Zealand: 16-18 William Pickering Drive,
Albany 1331, Auckland.

CAN ICES-3 (B)/NMB-3 (B)

Operation is subject to the following two conditions: (1) this device may not cause interference, and (2) this device must accept any interference, including interference that may cause undesired operation of the device.

L'utilisation de ce dispositif est autorisée seulement aux conditions suivantes : (1) il ne doit pas produire de brouillage et (2) l'utilisateur du dispositif doit être prêt à accepter tout brouillage radioélectrique reçu, même si ce brouillage est susceptible de compromettre le fonctionnement du dispositif.

FCC STATEMENT (UNITED STATES ONLY)

This equipment has been tested and found to comply with the limits for a Class B digital device, pursuant to Part 15 of the FCC rules. These limits are designed to provide reasonable protection against harmful interference in a residential installation. This equipment generates uses and can radiate radio frequency energy and, if not installed and used in accordance with the instructions, may cause harmful interference to radio communications. However, there is no guarantee that interference will not occur in a particular installation. If this equipment does cause harmful interference to radio or television reception, which can be determined by turning the equipment off and on, the user is encouraged to try to correct the interference by one or more of the following measures:

- Reorient or relocate the receiving antenna.
- Increase the separation between the equipment and receiver.
- Consult the dealer or an experienced radio/TV technician for help.

NOTE: Changes or modifications not expressly approved by the manufacturer responsible for compliance could void the user's authority to operate the equipment. This device complies with Part 15 of the FCC Rules. Operation is subject to the following two conditions: (1) This device may not cause harmful interference, and (2) this device must accept any interference received, including interference that may cause undesired operation.

Crib Mobile Attachment

IMPORTANT! Always attach all provided fasteners (strings, straps, clamps, etc.) tightly to a crib or playpen according to the instructions. Do not add additional strings or straps to attach to a crib. Check frequently.

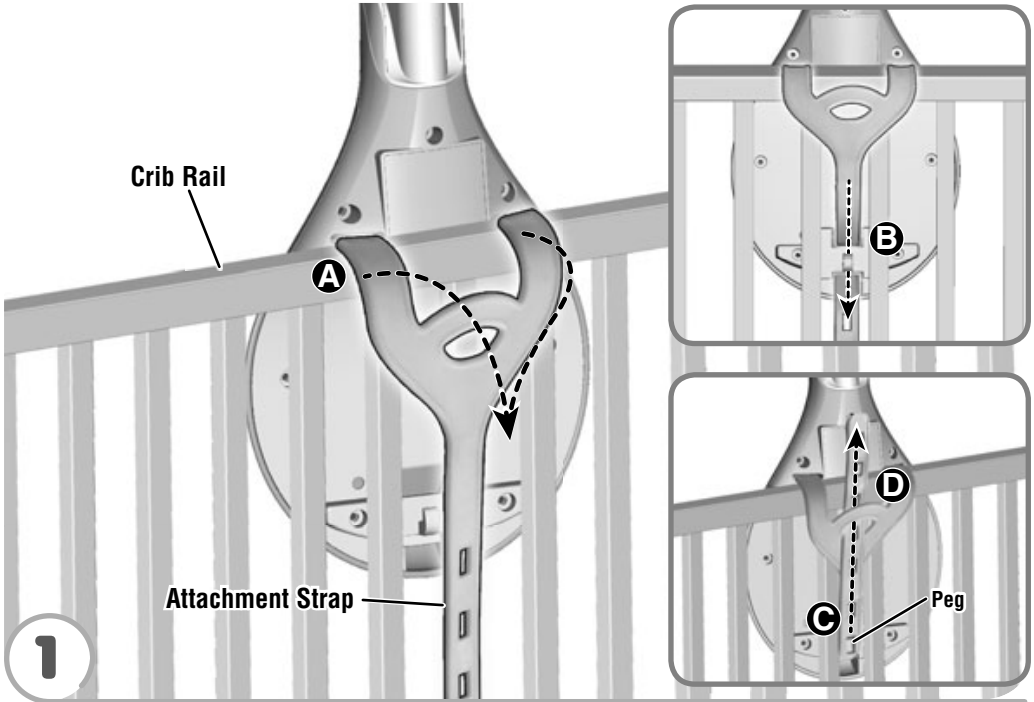

- Position the toy inside the crib. Make sure the attachment strap is on the outside of the crib **A**.
- Slide the end of the attachment strap down through the slot on the back of the toy **B**.
- Pull the end of the attachment strap up and fasten to the peg on the back of the toy **C**.

Note: This toy should be snug against the crib rail and spindles. Use the strap slot that provides the tightest fit.

- If you have excess strap, slide the free end of the attachment strap up through the opening near the top of the attachment strap **D**.

Crib Mobile Attachment

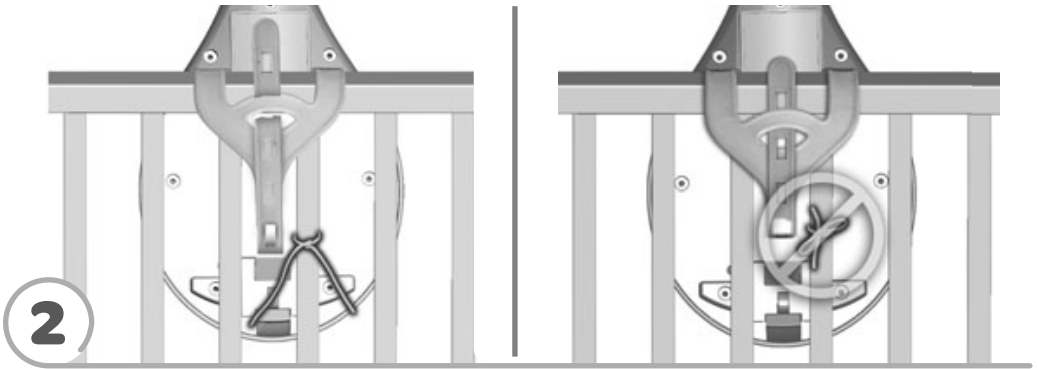

- Tie the toy's strings to a crib spindle.

Note: It is better to tie the strings in a knot than a bow, since a bow may be easily untied.

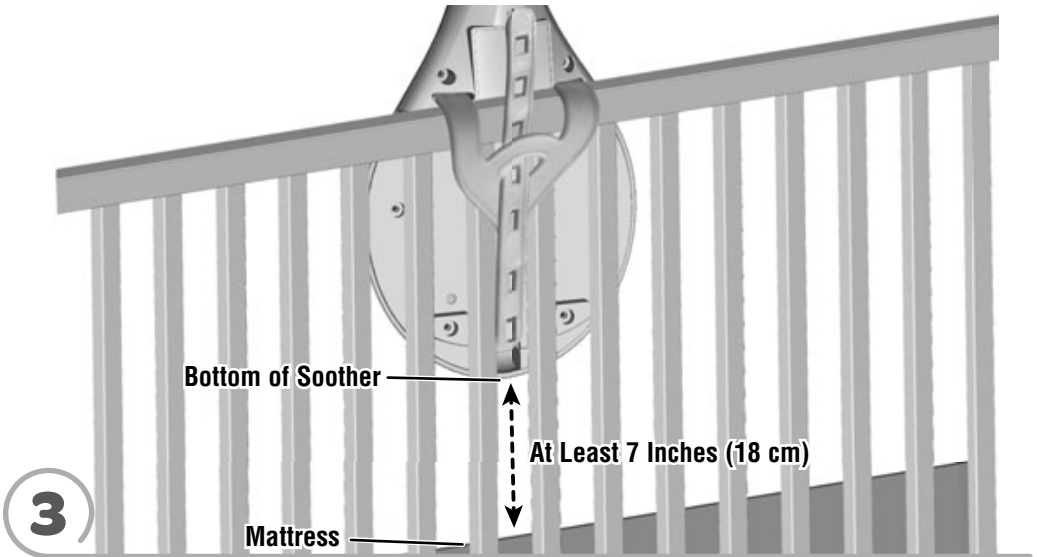

- Make sure the distance between the bottom of the mobile base and the crib mattress is **at least 7 inches (18 cm)**.
- If the distance is less than 7 inches (18 cm): readjust the attachment straps to lift the toy; or lower the crib mattress.

Crib Mobile Use



- Slide the power/volume switch to ON with low volume ◀), ON with high volume ◀)) or OFF ○.
- Press the button on the front of the bird to start the mobile and sounds.

Hints:

- The sounds will play for approximately 20 minutes.
- The mobile will turn off after approximately 12 minutes.
- Press the button on the bird to restart sounds/mobile.

Stroller Fun

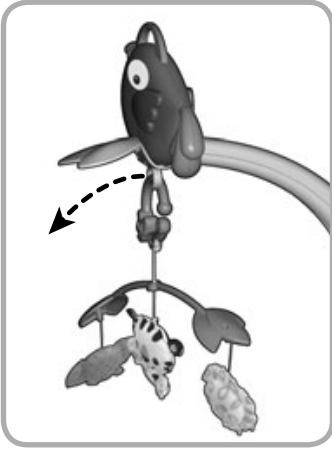

- Pull the link toy off the ring on the bird.
- Fit the open end of the link toy onto a stroller canopy.

Take Along Music

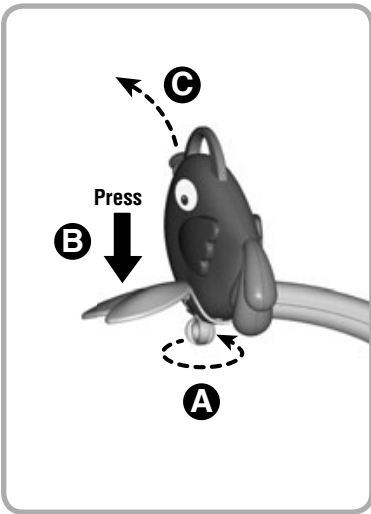

- Remove the mobile from the crib.
- Pull the link toy off the ring on the bird.
- Turn the ring on the bottom of the bird **A**. Then, press the front of the mobile clip **B** and lift to remove the bird **C**.

Hint: When used in take along mode, the bird will play short tunes and sound effects.