

TRACK LAYOUT

**NOTE:** Be sure the track curves to the RIGHT and not to the LEFT in order for the shark feature to work correctly.



**NOTE:** DO NOT ATTEMPT TO PULL MOUNTING BASE OFF OF WALL WITHOUT READING THE FOLLOWING REMOVAL INSTRUCTIONS!

**To remove WALL PLATE from wall:**

**NOTE:** You can remove the WALL PLATE from the MOUNTING BASE in between play sessions, but do not remove the MOUNTING BASE from the wall.

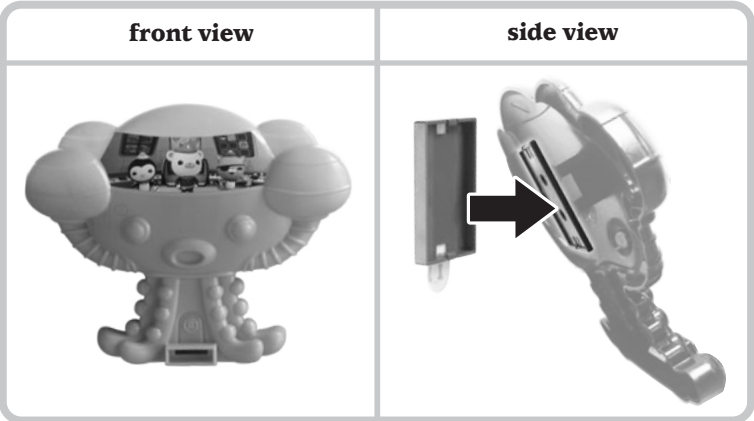

Pull the WALL PLATE gently from the bottom to unsnap the MOUNTING BASE from the WALL PLATE.

**To remove MOUNTING BASE permanently from wall:**



**IMPORTANT NOTE:**  
Do not remove the MOUNTING BASE from the wall in between play sessions.  
Remove only the WALL PLATE from the MOUNTING BASE in between play sessions.  
Once the MOUNTING BASE is removed from the wall, it cannot be re-attached using the same Command® Strip.



NEVER pull the Command® strip towards you (as shown).

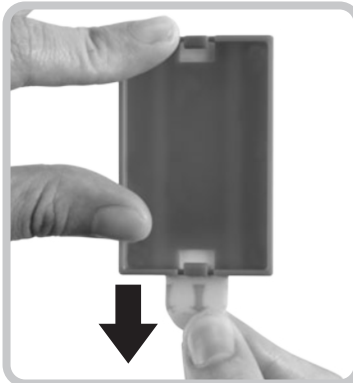

Hold the MOUNTING BASE gently to prevent the base from snapping your fingers.

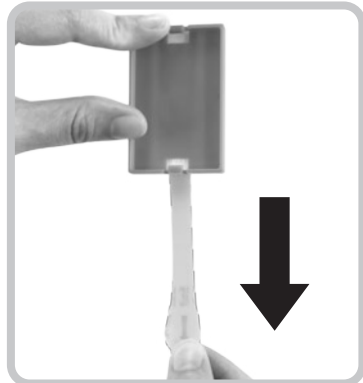

Stretch straight down along wall at least 12 inches (30 cm) until MOUNTING BASE and the strip release.

Silver  
G A T E  
Based on the books by  
meomi

?

CONSUMER ASSISTANCE

1-800-432-5437 (US & Canada)  
1300 135 312 (Australia)

service.fisher-price.com

Fisher-Price, Inc., 636 Girard Avenue, East Aurora, NY 14052.  
Hearing-impaired consumers: 1-800-382-7470.

Outside the United States:

Canada: Mattel Canada Inc., 6155 Freemont Blvd., Mississauga, Ontario L5R 3W2; [www.service.mattel.com](http://www.service.mattel.com).  
Great Britain: Mattel UK Ltd, Vanwall Business Park, Maidenhead SL6 4UB. Helpline: 01628 500303. [www.service.mattel.com/uk](http://www.service.mattel.com/uk)  
Mattel Europa B.V., Gondel 1, 1186 MJ Amstelveen, Nederland.  
Australia: Mattel Australia Pty. Ltd., 658 Church Street, Locked Bag #870, Richmond, Victoria 3121 Australia.  
New Zealand: 16-18 William Pickering Drive, Albany 1331, Auckland.

OCTONAUTS™ OCTOPOD™ Meomi Design Inc.  
OCTONAUTS Copyright © 2015 Vampire Squid Productions Ltd, a member of the Silvergate Media group of companies. All rights reserved.  
©2015 Mattel. All Rights Reserved.  
\* and ™ designate U.S. trademarks of Mattel, except as noted.  
**PRINTED IN CHINA.** Mattel East Asia Ltd., Room 503-09, North Tower, World Finance Centre, Harbour City, Tsimshatsui, HK, China.  
3M and Command are trademarks of 3M. © 3M 2015. All Rights Reserved.

CJJ12  
1100383434\_DOM  
Fisher-Price®

Gup Speeders  
Speedway

INSTRUCTIONS

Keep these instructions for future reference as they contain important information.

WHAT'S INCLUDED

ADULT ASSEMBLY REQUIRED. No tools required for assembly.

**IMPORTANT:** Failure to follow instructions carefully may cause damage to your wall!  
**SAVE INSTRUCTIONS** for damage-free removal or visit [command.com](http://command.com)

**NOTE:**  
Only apply Command® Strip to surfaces above 50°F (10°C).  
Adhesive could lose adhesion above 105°F (40°C).

**CAUTION:**  
DO NOT use with wallpaper. May not adhere well to vinyl surfaces.  
DO NOT use for antiques, heirlooms, or other valuable or irreplaceable items.  
DO NOT hang items over beds.



WALL PLATE ASSEMBLY

Attach the WALL PLATE to your wall using the enclosed Command® Strip.

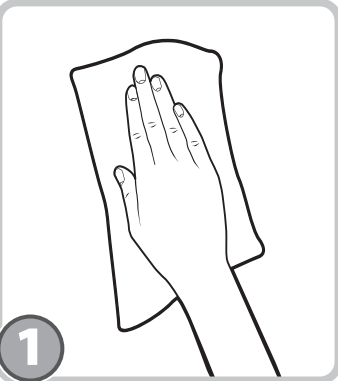

Clean surface of wall with isopropyl rubbing alcohol, wipe gently, let dry. Do not use household cleaners.



Separate strips.



Remove RED-printed liner from Command® Strip.

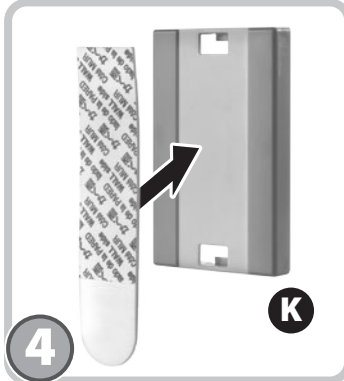

Press adhesive side of Command® Strip to back of MOUNTING BASE.



Make sure the strip tab is accessible for future removal.

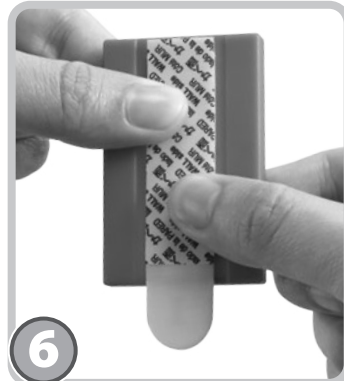

Press Command® Strip to MOUNTING BASE firmly for 30 seconds.

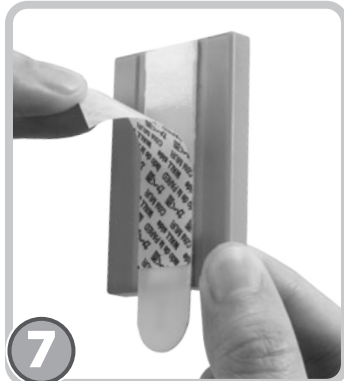

Remove BLACK-printed liner from the other side of the Command® Strip.

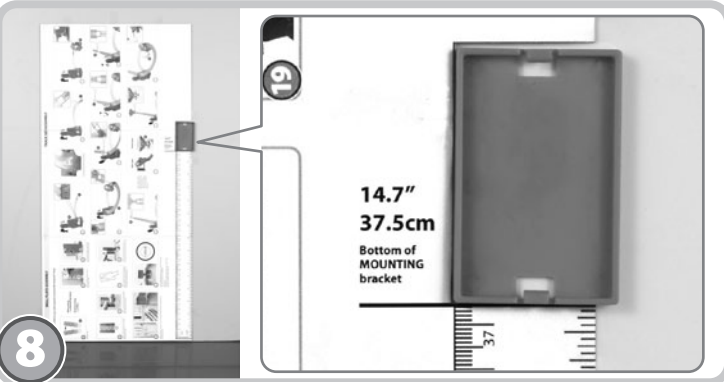

Measure off 14.7 inches / 37.5 cm using the ruler found on the side of the instruction sheet.

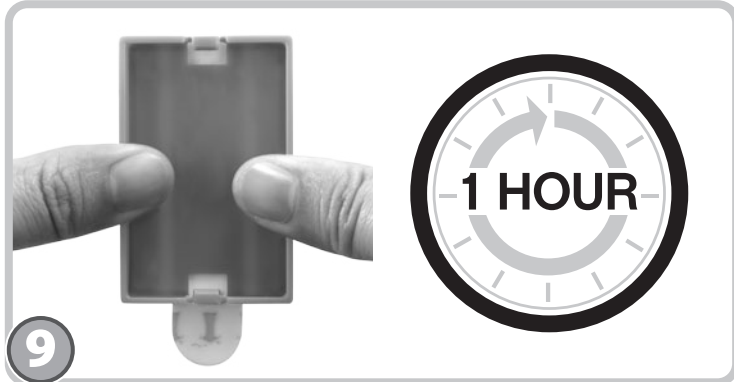

Press **MOUNTING BASE** firmly to wall for 30 seconds. Proceed to **TRACK SET ASSEMBLY**.  
**IMPORTANT:**  
For maximum holding strength wait 1 hour before attaching the **WALL PLATE** (Step 18).

TRACK SET ASSEMBLY

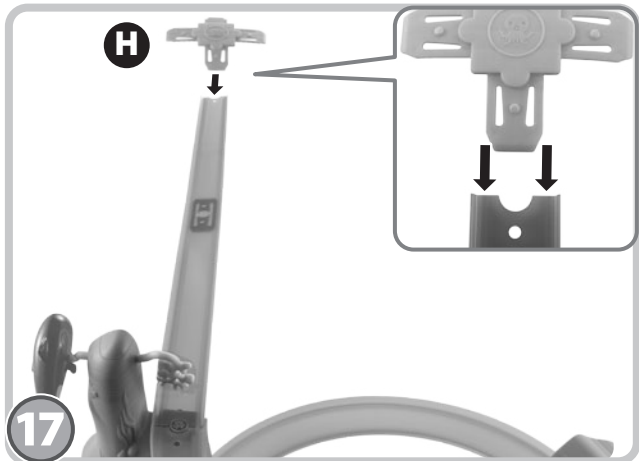
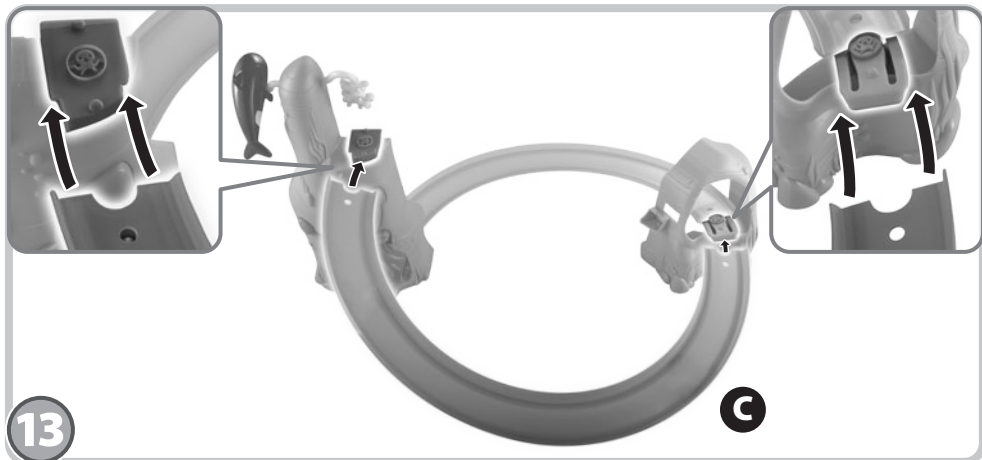
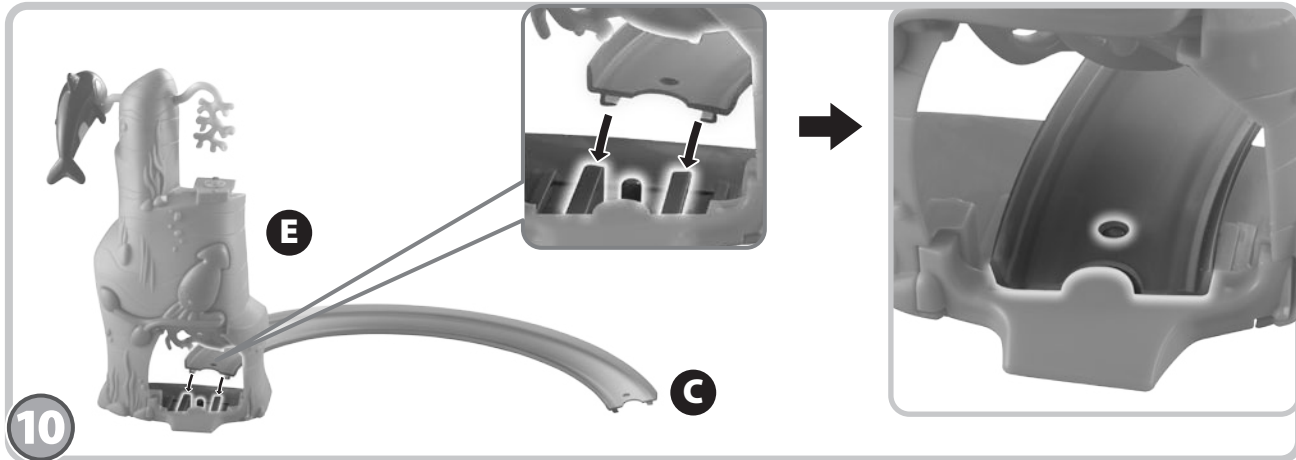

After 1 hour, snap the WALL PLATE onto the MOUNTING BASE and continue with the TRACK SET ASSEMBLY of your GUP Speeders Raceway.

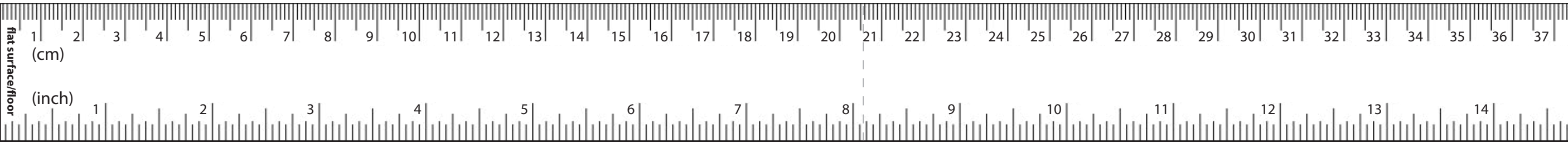
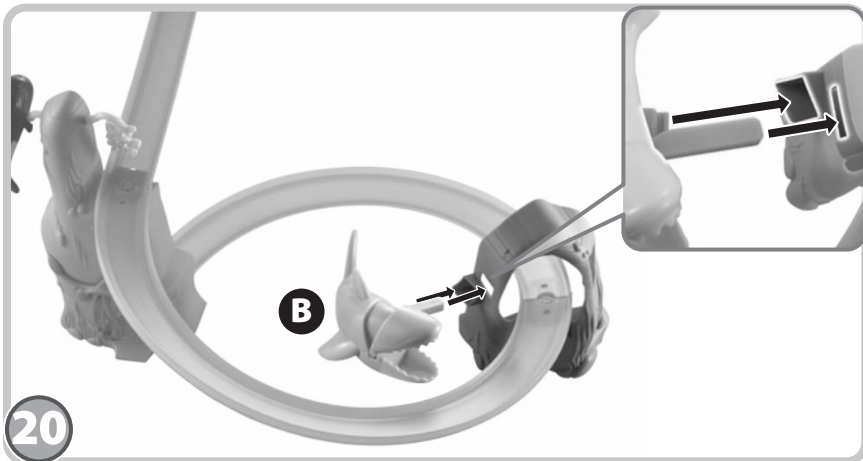
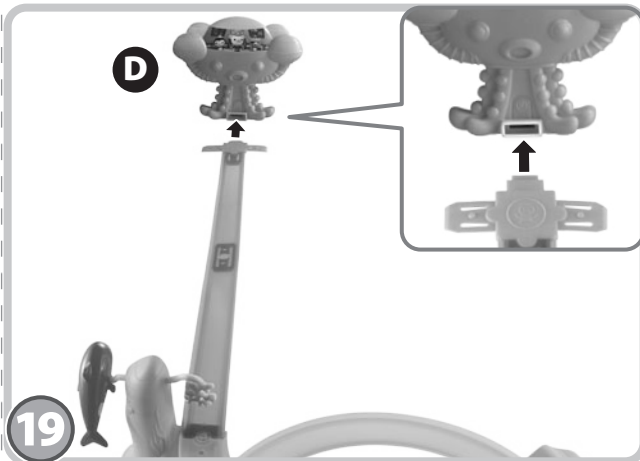
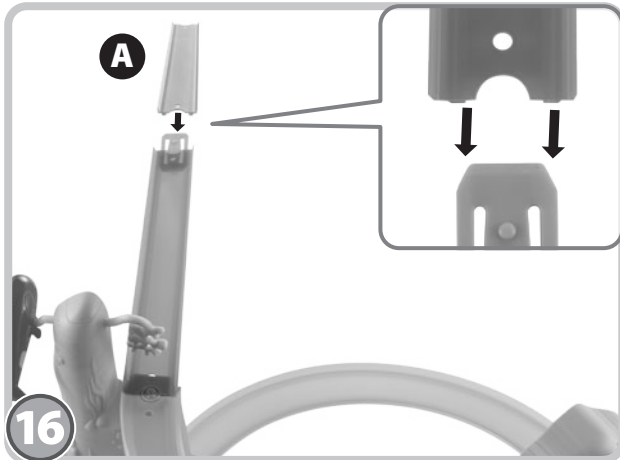
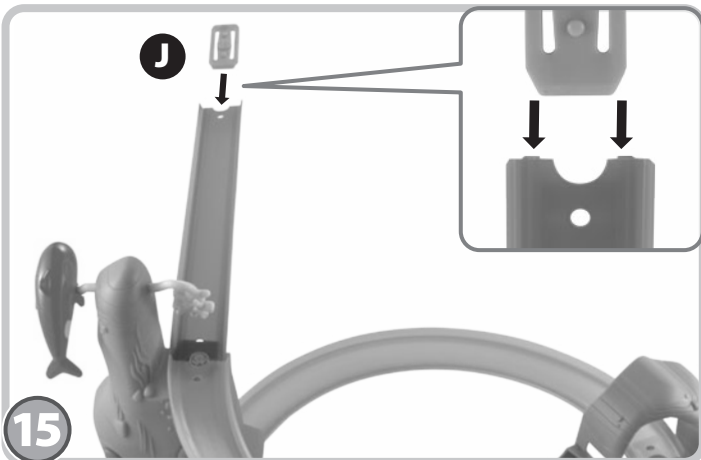
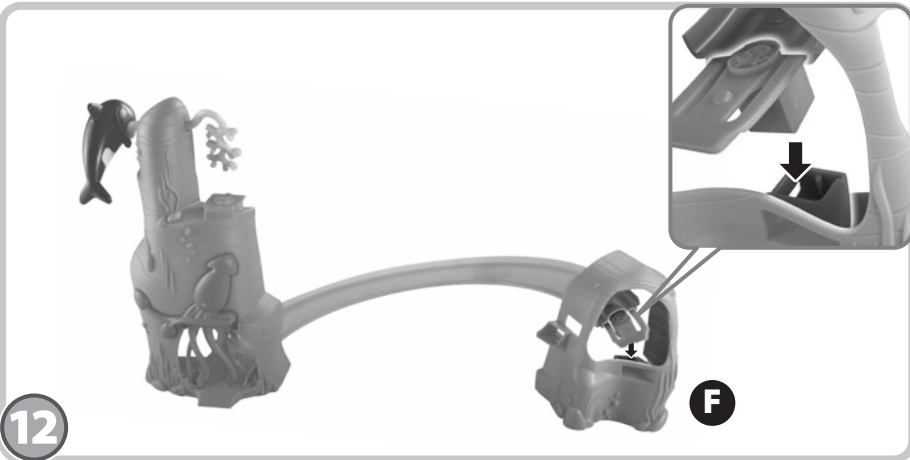
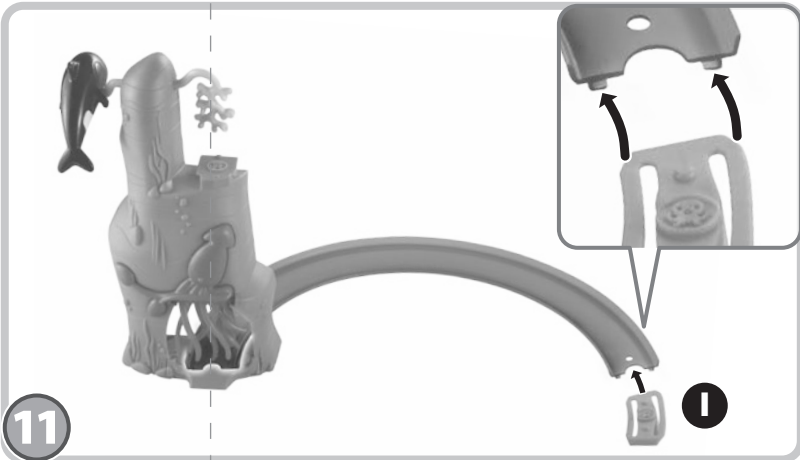
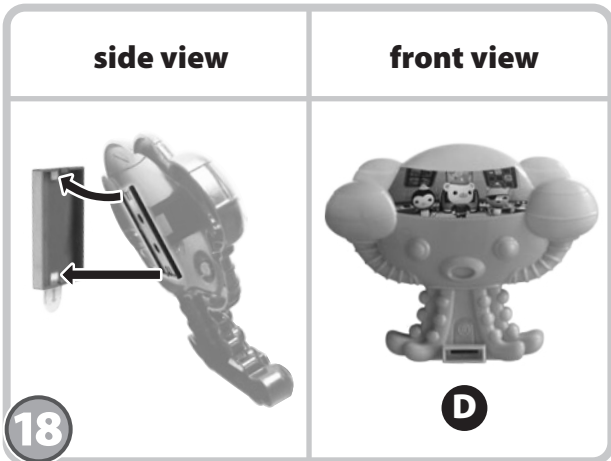

14.7"  
37.5cm  
Bottom of  
MOUNTING  
bracket