



# RAMONE'S COLOR CHANGE PLAYSET INSTRUCTIONS

4+

## CONTENTS



REFER TO LETTERS MOLDED ON TOY PARTS AND THROUGHOUT THE INSTRUCTIONS TO HELP WITH ASSEMBLY.

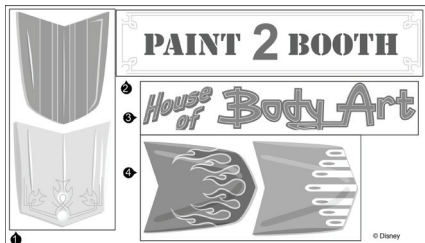
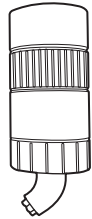
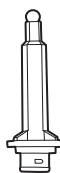
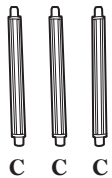
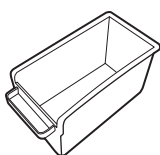
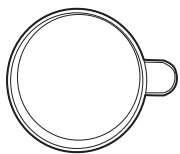
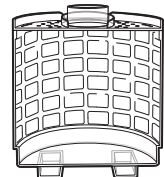
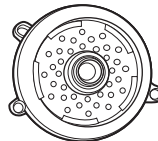
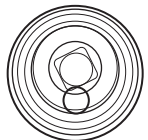
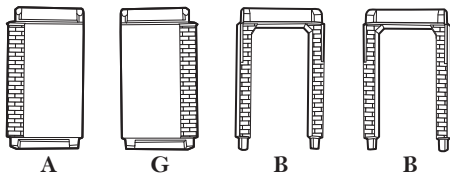
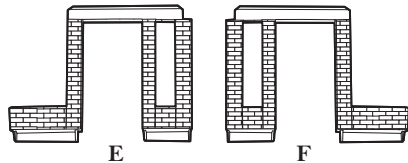
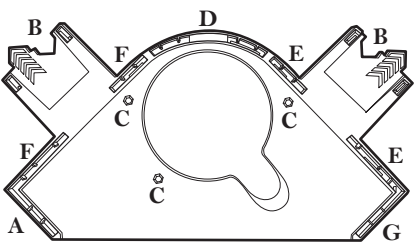
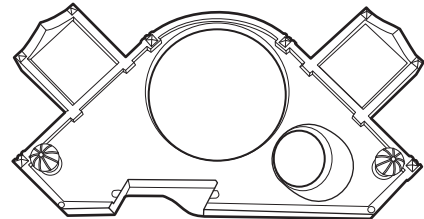

Label Sheet

## 1 / APPLY LABELS

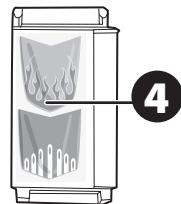
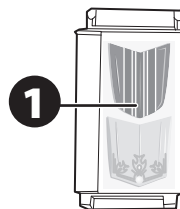
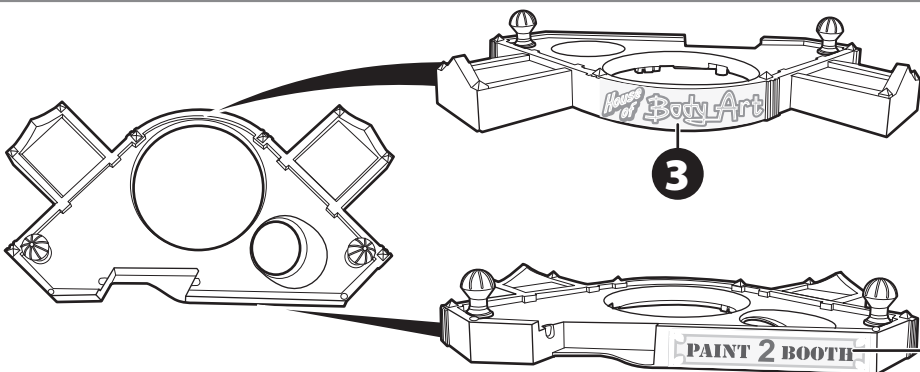

©2015 Mattel. All Rights Reserved. ® and ™ designate U.S. trademarks of Mattel, except as noted.  
 Mattel, Inc., 636 Girard Avenue, East Aurora, NY 14052, U.S.A. Consumer Services 1-800-524-8697. Mattel U.K. Ltd., Vanwall Business Park, Maidenhead SL6 4UB. Helpline 01628 500303. Mattel Australia Pty., Ltd., Richmond, Victoria. 3121. Consumer Advisory Service - 1300 135 312.  
 Mattel East Asia Ltd., Room 503-09, North Tower, World Finance Centre, Harbour City, Tsimshatsui, HK, China. Tel.: (852) 3185-6500. Diimport & Diedarkan Oleh: Mattel Southeast Asia Pte. Ltd., No 19-1, Tower 3 Avenue 7, Bangsar South City, No 8, Jalan Kerinchi, 59200 Kuala Lumpur, Malaysia. Tel: 03-78803817, Fax: 03-78803867.

Chevrolet™

© Disney/Pixar

[www.disney.com/cars](http://www.disney.com/cars)

[service.mattel.com](http://service.mattel.com)

CKD12 - 1100545083G1\_DOM



# 2 / ASSEMBLY

①

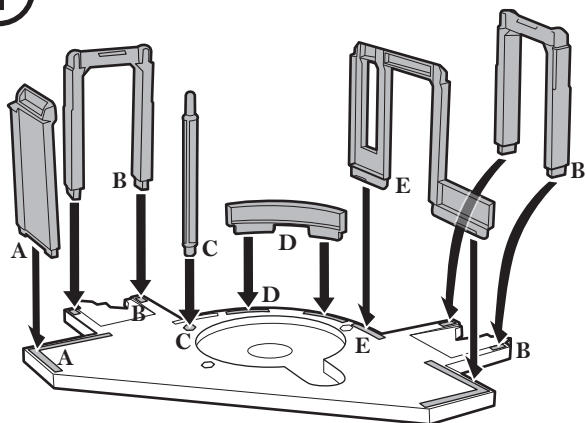

②

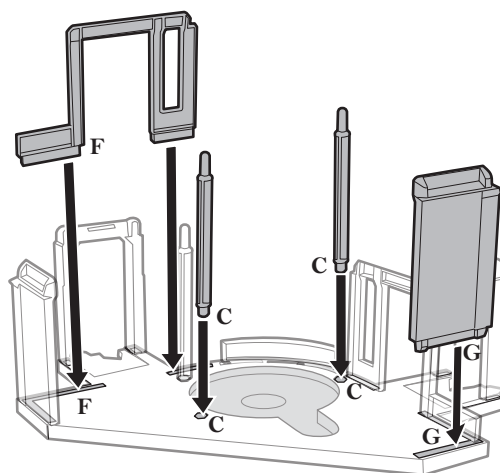

③

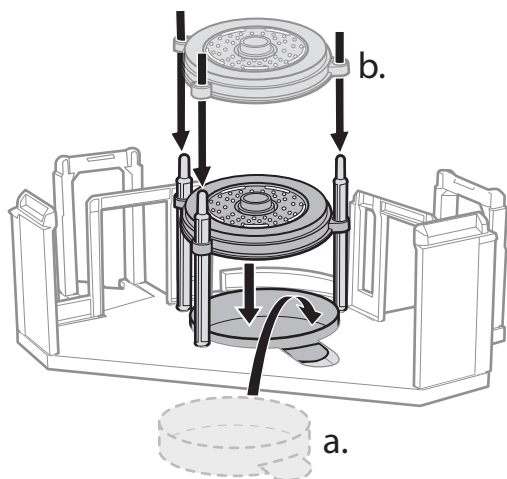

④

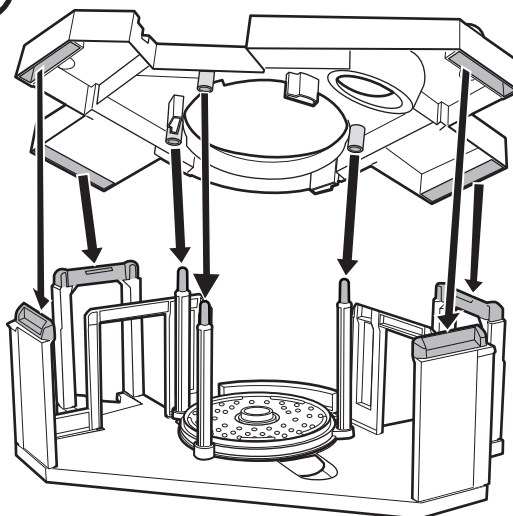

⑤

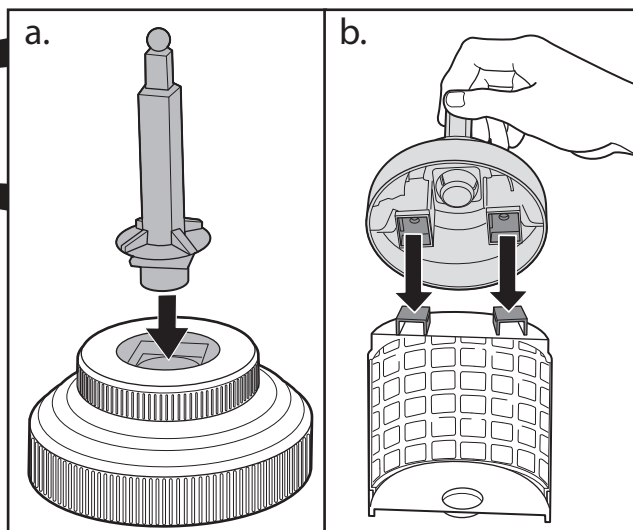
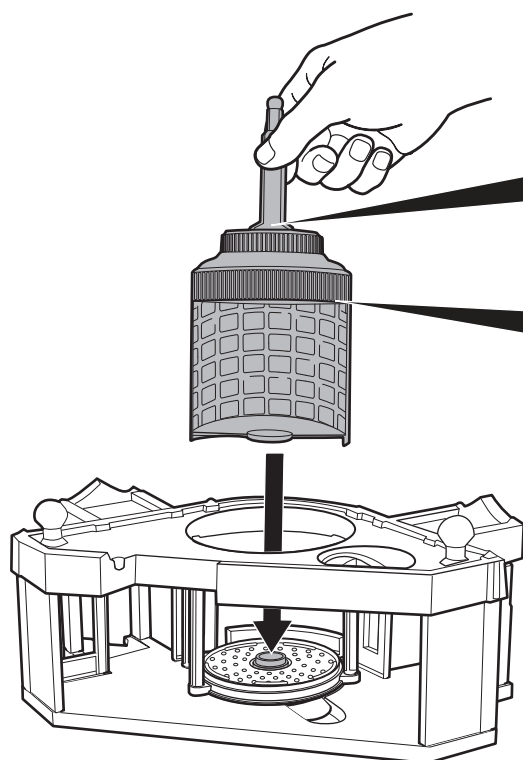

⑥

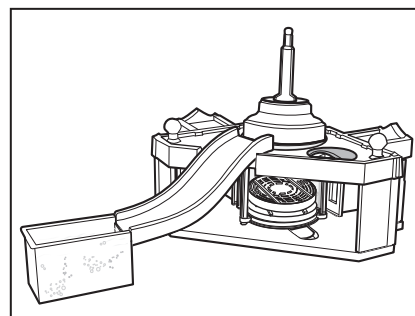
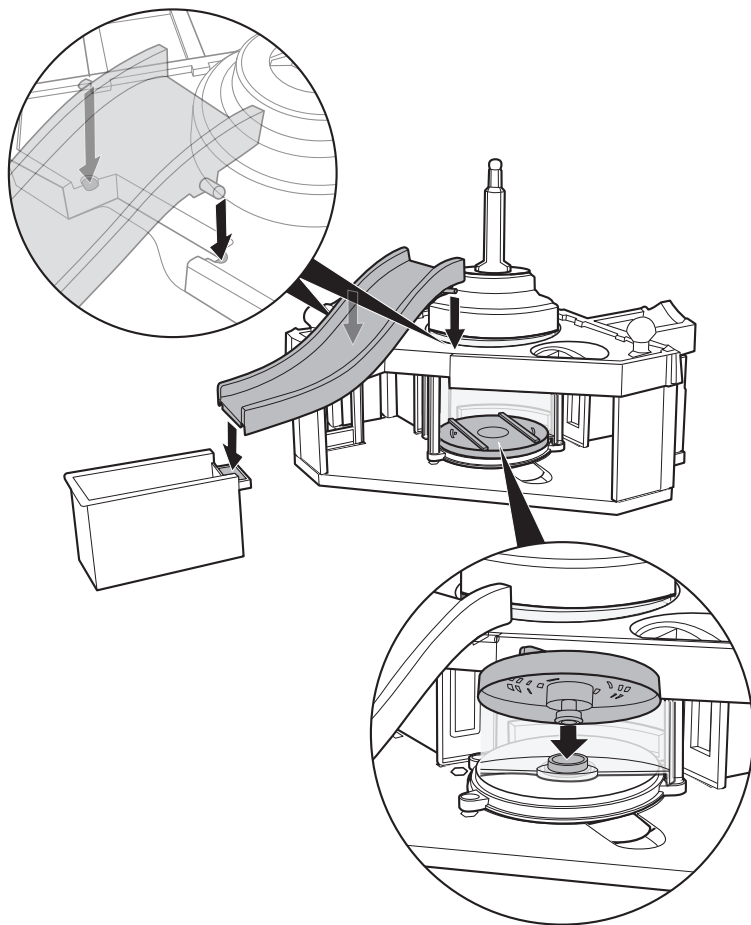

## 3 / TO PLAY

①

WARM WATER  
95°F/35°C to 107°F/42°C

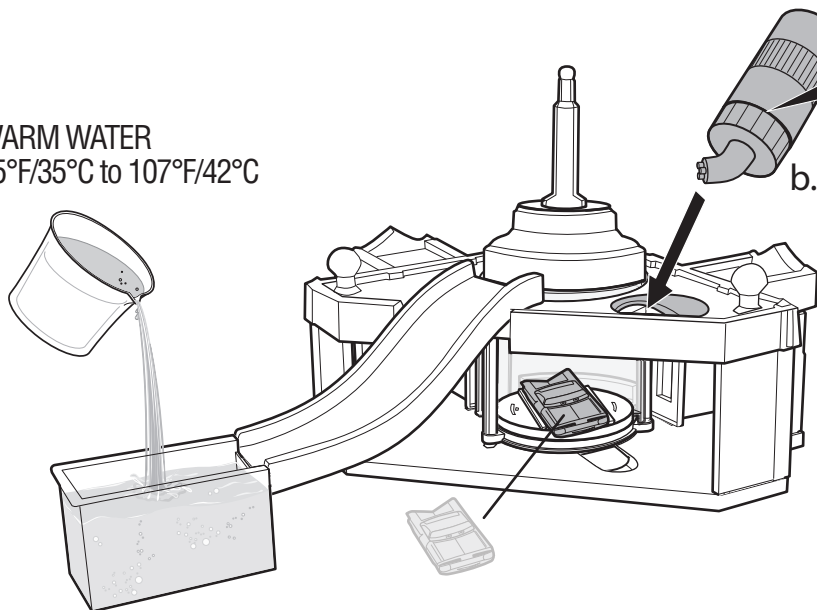

Insert the nozzle into the icy water. Squeeze repeatedly to fill up the bottle.

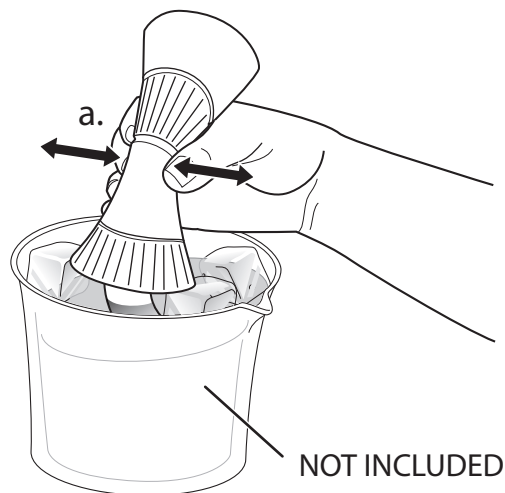

ICY WATER  
For best performance of color change feature,  
please use icy water under 50°F/10°C.

To avoid burns, do not use water that is too hot, above 120°F/49°C.

2

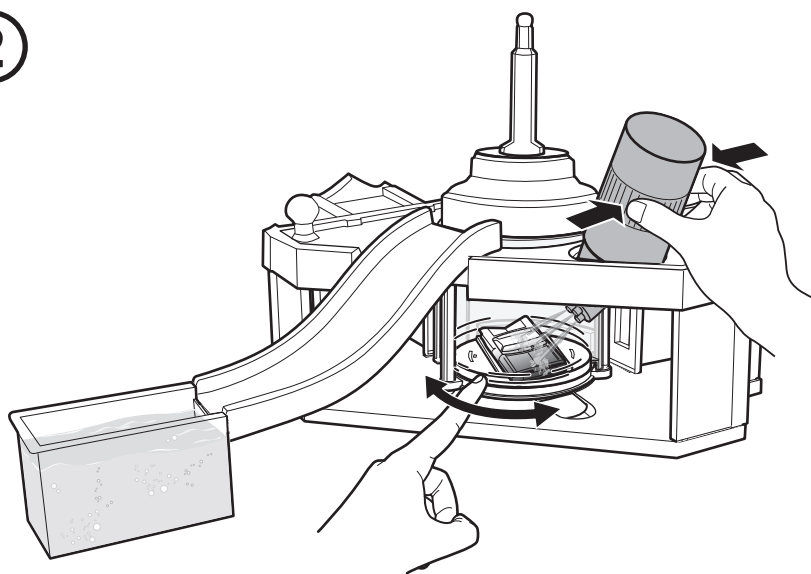

Car transforms to icy water color.

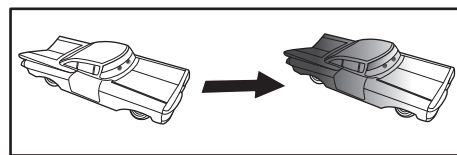

3

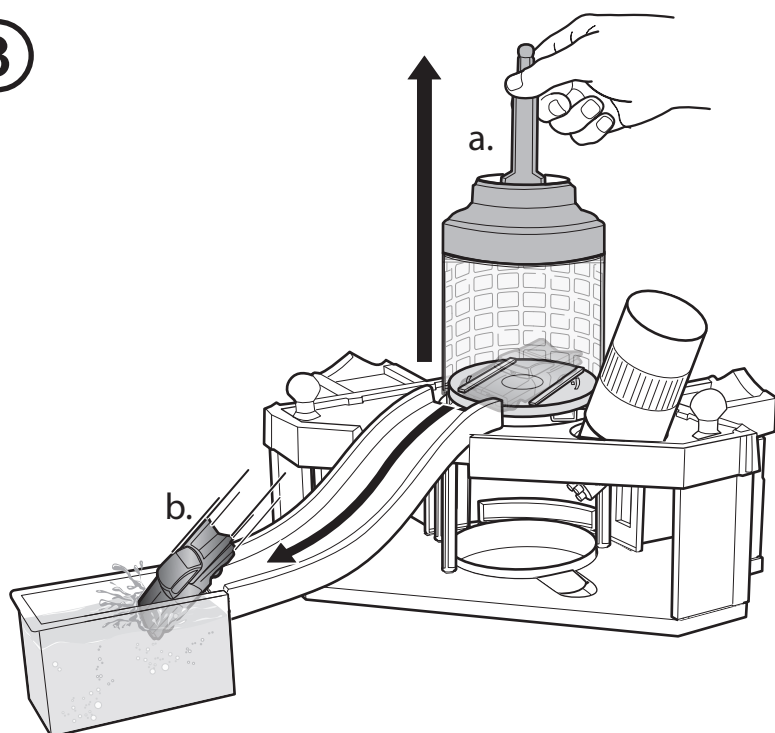

Car transforms to warm water color.

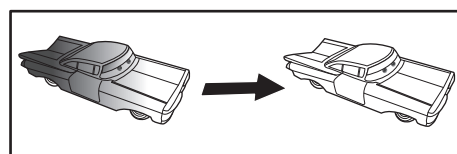

4

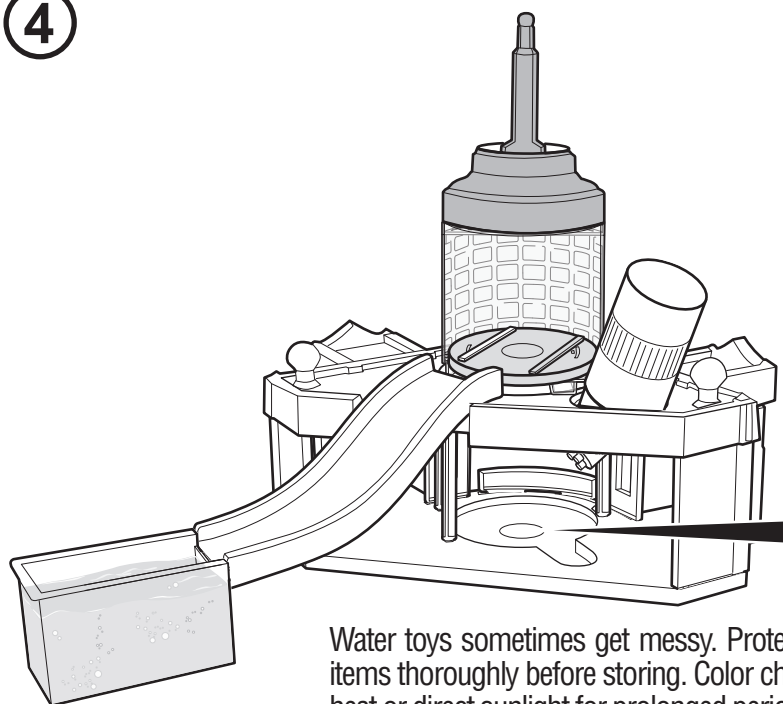

Empty water into drain after play.



Squeeze & shake bottle repeatedly to drain water before storage.

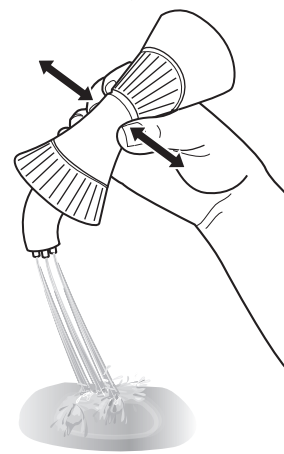

Water toys sometimes get messy. Protect play surfaces before use. Drain, rinse, clean and dry all items thoroughly before storing. Color change will last longer if you do not expose this toy to intense heat or direct sunlight for prolonged periods of time.