

# JONATHAN ADLER

CRAFTED BY

**Fisher-Price®**



## DFP71

Keep this instruction sheet for future reference,  
as it contains important information.

Requires seven AA (LR6) **alkaline** batteries (not included) for operation.

Tool needed for battery installation: Phillips screwdriver.

Adult assembly is required. No tool needed for assembly.

**fisher-price.com**



## CONSUMER ASSISTANCE

1-800-432-5437 (US & Canada)  
1300 135 312 (Australia)



[service.fisher-price.com](http://service.fisher-price.com)

Fisher-Price, Inc., 636 Girard Avenue, East Aurora, NY 14052.  
Hearing-impaired consumers: 1-800-382-7470.

### Outside the United States:

Canada: Mattel Canada Inc., 6155 Freemont Blvd.,  
Mississauga, Ontario L5R 3W2; [www.service.mattel.com](http://www.service.mattel.com).

Great Britain: Mattel UK Ltd, Vanwall Business Park,  
Maidenhead SL6 4UB. Helpline: 01628 500303.  
[www.service.mattel.com/uk](http://www.service.mattel.com/uk)

Mattel Europa B.V., Gondel 1, 1186 MJ Amstelveen, Nederland.

Australia: Mattel Australia Pty. Ltd., 658 Church Street,  
Locked Bag #870, Richmond, Victoria 3121 Australia.

New Zealand: 16-18 William Pickering Drive,  
Albany 1331, Auckland.

Jonathan Adler is a registered trademark of Jonathan  
Adler Enterprises, LLC and is being used pursuant to license.  
© 2016 Jonathan Adler, Inc. All rights reserved.

©2016 Mattel. All Rights Reserved. \* and ™ designate U.S. trademarks of Mattel, except as noted.

PRINTED IN CHINA

DFP71-0970-G1  
1101059534-DOM

# PARTS



**Mobile**



**Hub**



**Tummy Wedge**



**Giraffe Toy**



**Elephant Toy**



**Mirror Toy**



**Lion Toy**



**Koala Toy**

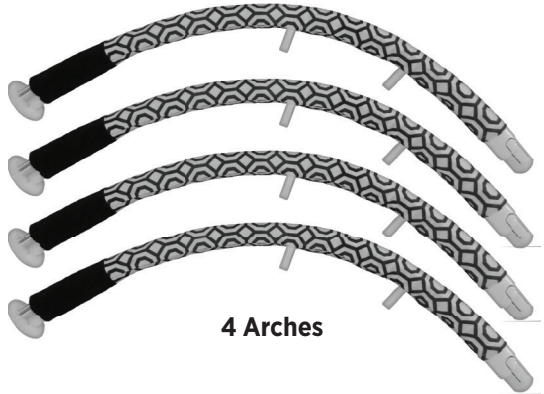

**4 Arches**



**2 Monkey Toys**



**2 Links**



**2 Square Toys**



**Mat**

# ASSEMBLY AND SETUP

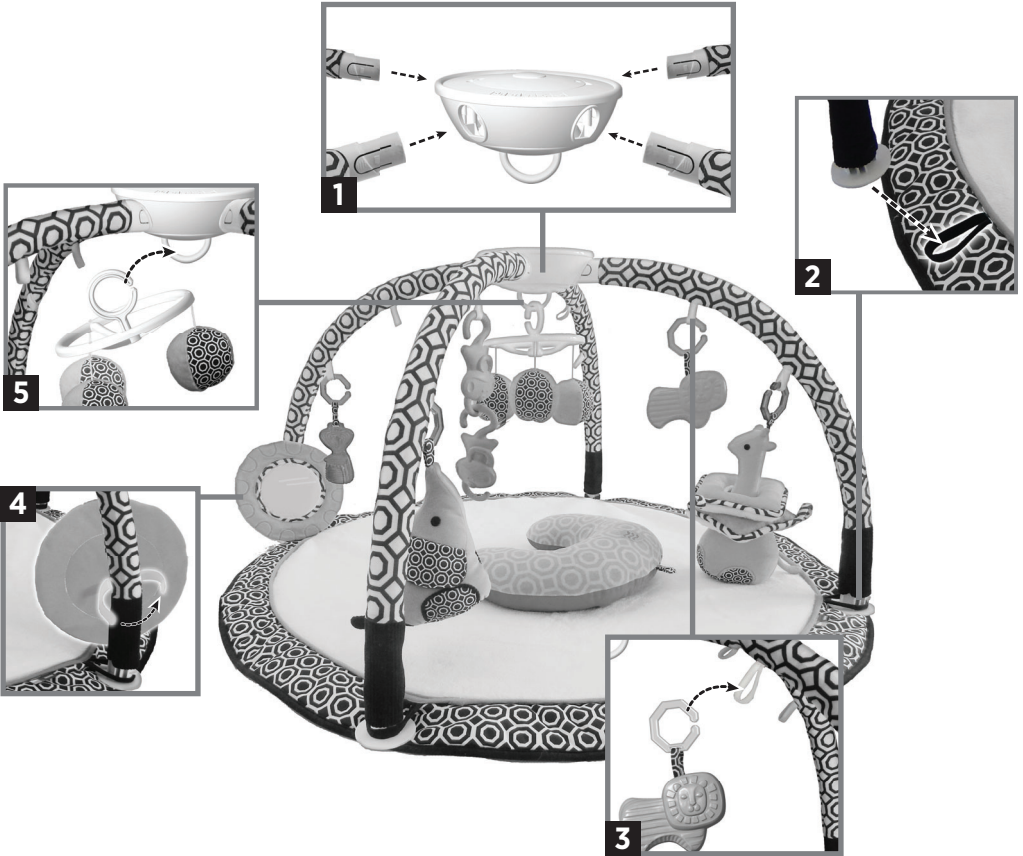

**1** Insert and “snap” the arches into the hub sockets. Pull on each arch to be sure it’s secure to the hub.

**2** Lay the mat on a flat surface, plush side up. Insert the foot at the end of each arch into the loops on the mat.

**3** Attach the toys to any of the loops around the gym or the wedge.

**4** Fasten the straps on the back of the mirror toy to any of the arches.

**5** Attach the mobile to the hub.

**Hint:** Attach the extra links to the loops on the plush toys.

# BATTERY INSTALLATION

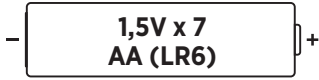

For longer life, use **alkaline** batteries.

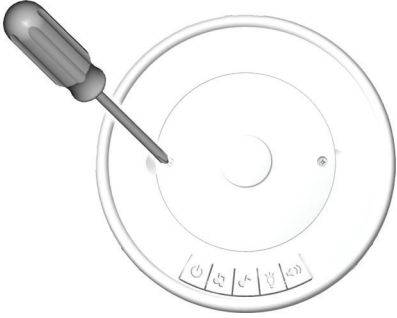

- Loosen the screw in the battery compartment door and remove the door.
- Insert three, new AA (LR6) **alkaline** batteries.
- Replace the battery compartment door and tighten the screw.

- Locate the battery compartment door on the top side of the hub.
- Loosen the screws in the battery compartment door and remove the door.
- Insert four, new AA (LR6) **alkaline** batteries.
- Replace the battery compartment door and tighten the screws.
- If the hub begins to operate erratically, you may need to reset the electronics. Remove the batteries and reinstall them.
- When the sounds/lights become faint or stop, it's time for an adult to change the batteries.

**Power Button**



**Push Button**



- Insert the electronic unit back inside the tummy wedge. Make sure the power button faces you and the push button is toward the front of the tummy wedge.
- If the electronic unit begins to operate erratically, you may need to reset the electronics. Slide the power switch off and back on.
- When vibrations become faint or stop, it's time for an adult to change the batteries.

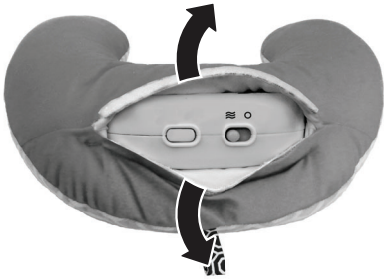

- Open the fasteners on the tummy wedge. Remove the electronic unit.

# DANCING LIGHTS MUSIC & CALMING VIBRATIONS



## WARNING



### Gym

- To prevent entanglement injury, never place the gym in a crib or playpen. Never add strings, ties or other products to the gym.

### Tummy Wedge

- To prevent serious injury or death from suffocation: Never use in crib. Never use with sleeping child. Never leave child unattended.



- Press the power button  to turn the hub ON. Now, make sounds and light selections:
  - 🎵 **Long Play Music** – Music plays for up to 20 minutes. Press again and again to change songs; press and hold to turn music off.
  - 🎵 **Short Play Music** – Listen to one song. When baby bats at the mobile, baby starts another song! To turn off, press and hold to turn off music.
  - 💡 **Lights** – Baby enjoys a twinkling light show.
- Choose a comfortable volume level for baby. Press the volume button  to cycle through choices, including turning volume off.
- Press the button  on the tummy wedge for about 10 minutes of soothing vibrations.

## ON-THE-GO FUN



- For fun on-the-go, remove the mobile from the hub and attach to baby's stroller.

## STORAGE AND CARE

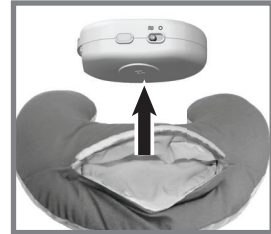

- Remove the foot on each arch from the loops on the mat.
- Squeeze tabs on both sides of an arch and pull to remove from the hub. Repeat to remove the other arches from the hub.
- The tummy wedge cover and the mat are machine washable. **First, remove the electronic unit from the wedge.** Machine wash cold, on the gentle cycle. Do not use bleach. Tumble dry low heat.
- Wipe the arches, hub, links and all of the toys with a clean cloth dampened with mild soap and water solution. Do not use bleach. Do not immerse the electronic unit.

# CONSUMER INFORMATION

## Battery Safety Information

In exceptional circumstances, batteries may leak fluids that can cause a chemical burn injury or ruin your product. To avoid battery leakage:

- Do not mix old and new batteries or batteries of different types: alkaline, standard (carbon-zinc) or rechargeable (nickel-cadmium).
- Insert batteries as indicated inside the battery compartment.
- Remove batteries during long periods of non-use. Always remove exhausted batteries from the product. Dispose of batteries safely. Do not dispose of this product in a fire. The batteries inside may explode or leak.
- Never short-circuit the battery terminals.
- Use only batteries of the same or equivalent type, as recommended.
- Do not charge non-rechargeable batteries.
- Remove rechargeable batteries from the product before charging.
- If removable, rechargeable batteries are used, they are only to be charged under adult supervision.

## CAN ICES-3 (B)/NMB-3 (B)

Operation is subject to the following two conditions: (1) this device may not cause interference, and (2) this device must accept any interference, including interference that may cause undesired operation of the device.

L'utilisation de ce dispositif est autorisée seulement aux conditions suivantes :

- (1) il ne doit pas produire de brouillage et
- (2) il doit pouvoir tolérer tout brouillage radioélectrique reçu, même si ce brouillage est susceptible de compromettre son fonctionnement.

## FCC STATEMENT (UNITED STATES ONLY)

This equipment has been tested and found to comply with the limits for a Class B digital device, pursuant to Part 15 of the FCC rules. These limits are designed to provide reasonable protection against harmful interference in a residential installation.

This equipment generates uses and can radiate radio frequency energy and, if not installed and used in accordance with the instructions, may cause harmful interference to radio communications. However, there is no guarantee that interference will not occur in a particular installation. If this equipment does cause harmful interference to radio or television reception, which can be determined by turning the equipment off and on, the user is encouraged to try to correct the interference by one or more of the following measures:

- Reorient or relocate the receiving antenna.
- Increase the separation between the equipment and receiver.
- Consult the dealer or an experienced radio/TV technician for help.

NOTE: Changes or modifications not expressly approved by the manufacturer responsible for compliance could void the user's authority to operate the equipment.

This device complies with Part 15 of the FCC Rules. Operation is subject to the following two conditions: (1) This device may not cause harmful interference, and (2) this device must accept any interference received, including interference that may cause undesired operation.



- Protect the environment by not disposing of this product with household waste (2012/19/EU). Check your local authority for recycling advice and facilities.