



BUILDER'S GUIDE

NAIL THE JUMP!

EXPERIMENT
WITH SPEED

 **WARNING:**
CHOKING HAZARD - Small parts.
Not for children under 3 years.



HANG ON TO THIS GUIDE, IT HAS KEY
INFORMATION TO BUILD RAD STUNTS!

4+

service.mattel.com

HOTWHEELS.COM



DGD29-0970

1100764545-DOMG2

STARTER KIT

CONGRATULATIONS. You just gained access to the unlimited world of Track Builder and now YOU are in the driving seat. Create your own outrageous stunts, experiment with speed and keep challenging yourself. Are you ready to get your wheels turning? Grab your car and go.....MAKE IT EPIC!



PARENTS: FOR EPIC TRACK IDEAS, HOW-TO VIDEOS AND AWESOME ENTERTAINMENT, CHECK OUT THE HOT WHEELS YOUTUBE CHANNEL!

WWW.YOUTUBE.COM/HOTWHEELS.



THE BUILDER'S GUIDE BREAKDOWN

HERE'S WHAT YOU GET!	3
HERE'S HOW YOU START!	3
CHOOSE YOUR BUILD!	5
BUILD 1	6
BUILD 2	8
BUILD 3	10
BUILD 4	12
HERE'S WHAT'S COOL!	14
WHAT IF.....?	15
HERE'S WHAT ELSE YOU CAN GET:	16

HERE'S WHAT YOU GET!

PARTS IN THIS SET ARE LABELED **TB8**

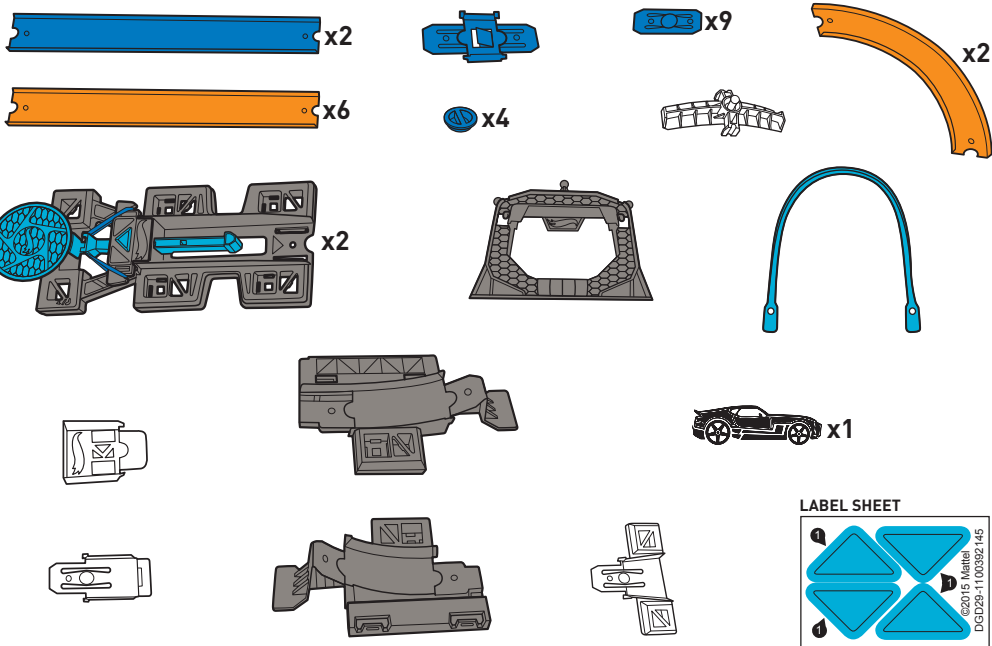

**NOT FOR USE WITH SOME HOT WHEELS® VEHICLES.
INCLUDES ONE VEHICLE. OTHER VEHICLES SHOWN SOLD SEPARATELY.**

HERE'S HOW YOU START!

APPLY LABELS

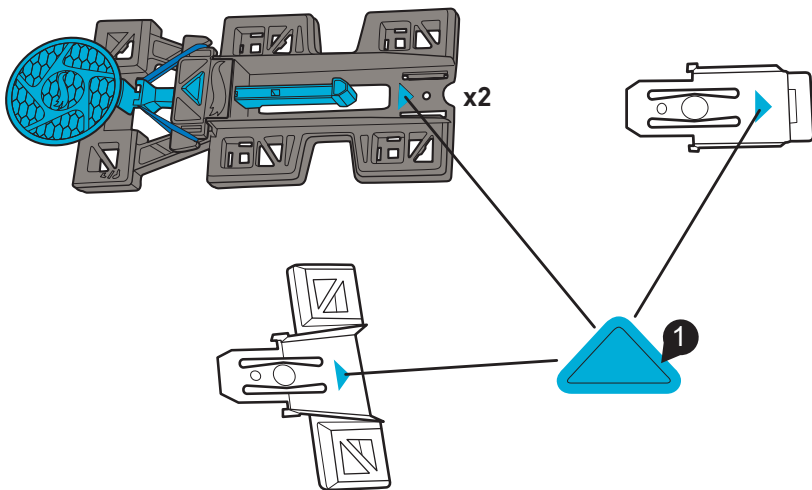

HERE'S HOW YOU START!

BUILD THE STUNT HANDLE

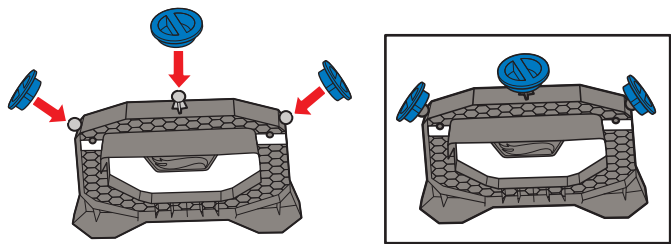

BUILD THE LOOP BASE

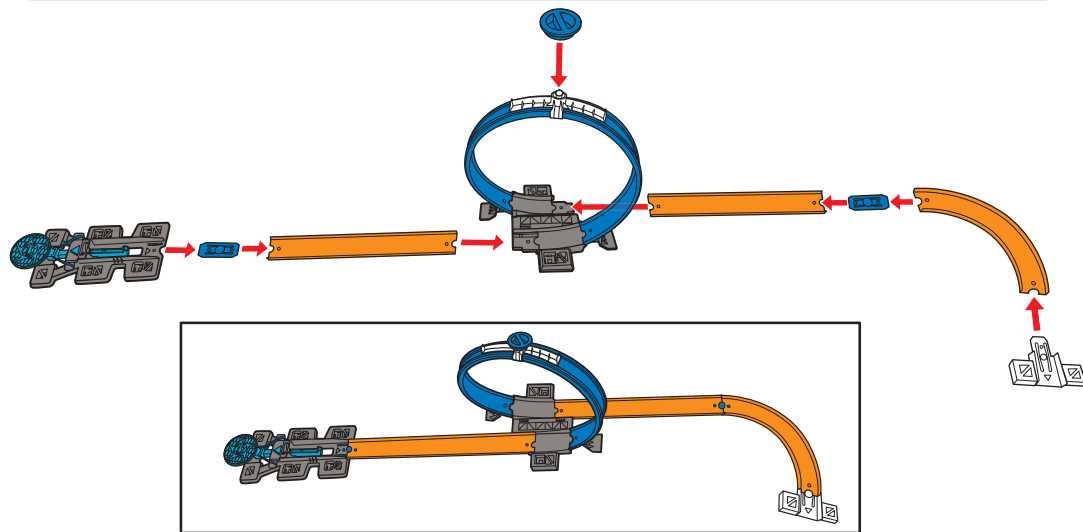
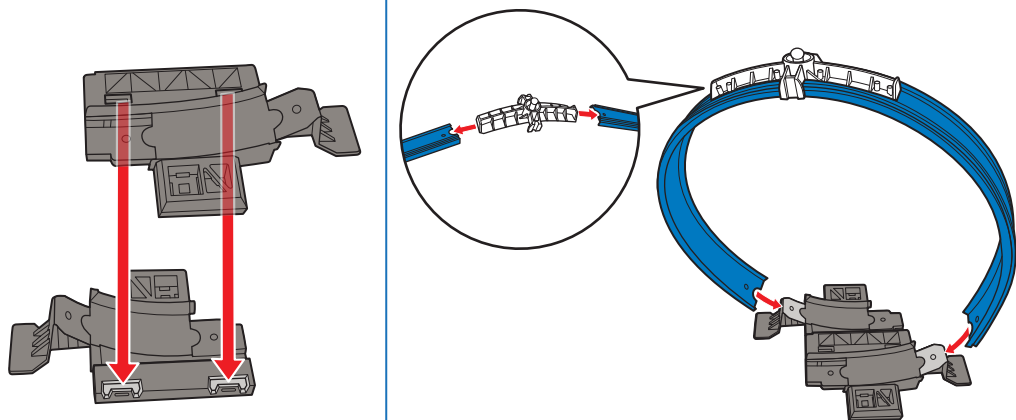

CHOOSE YOUR BUILD!

BUILD 1

INSTRUCTIONS ON PAGE 6

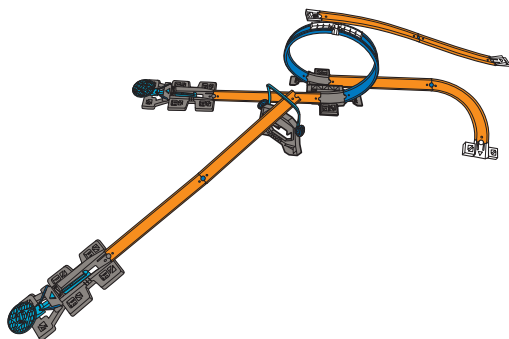

BUILD 2

INSTRUCTIONS ON PAGE 8

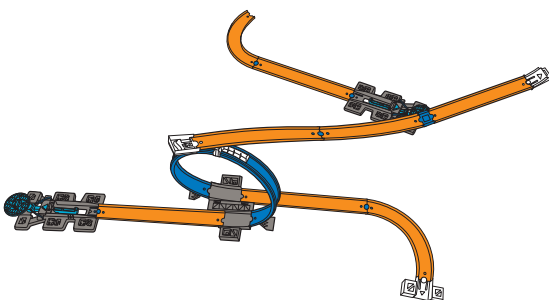

BUILD 3

INSTRUCTIONS ON PAGE 10

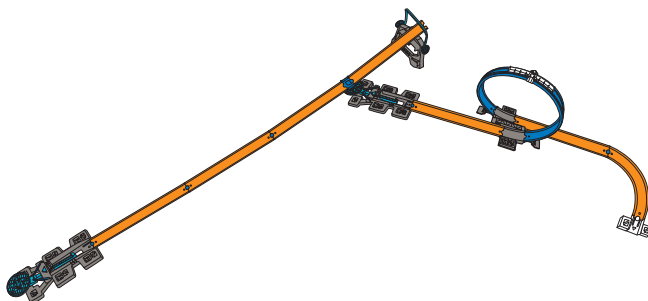

BUILD 4

INSTRUCTIONS ON PAGE 12

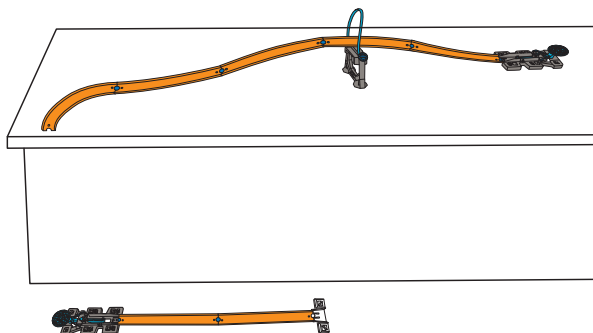

COLORS AND DECORATIONS MAY VARY.

BUILD 1

HERES WHAT YOU NEED:

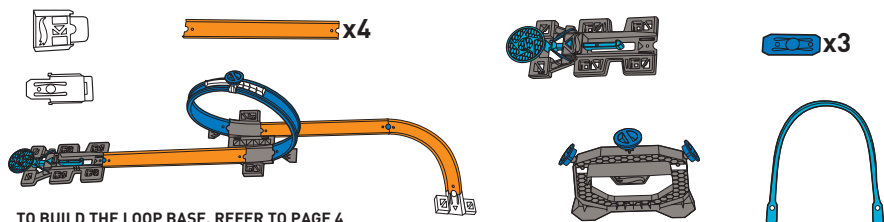

BUILDER'S TIP

SLIDE THE TRACK OVER THE PIVOT POINT

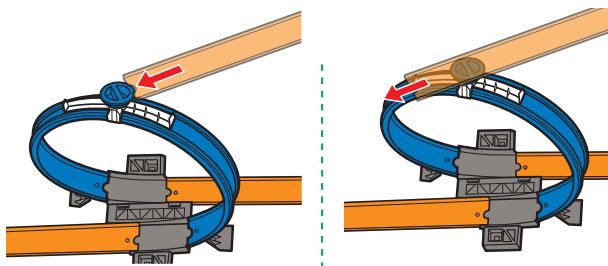

1. CONNECT THE TRACK TO THE PIVOT POINT ON THE LOOP AS SHOWN.

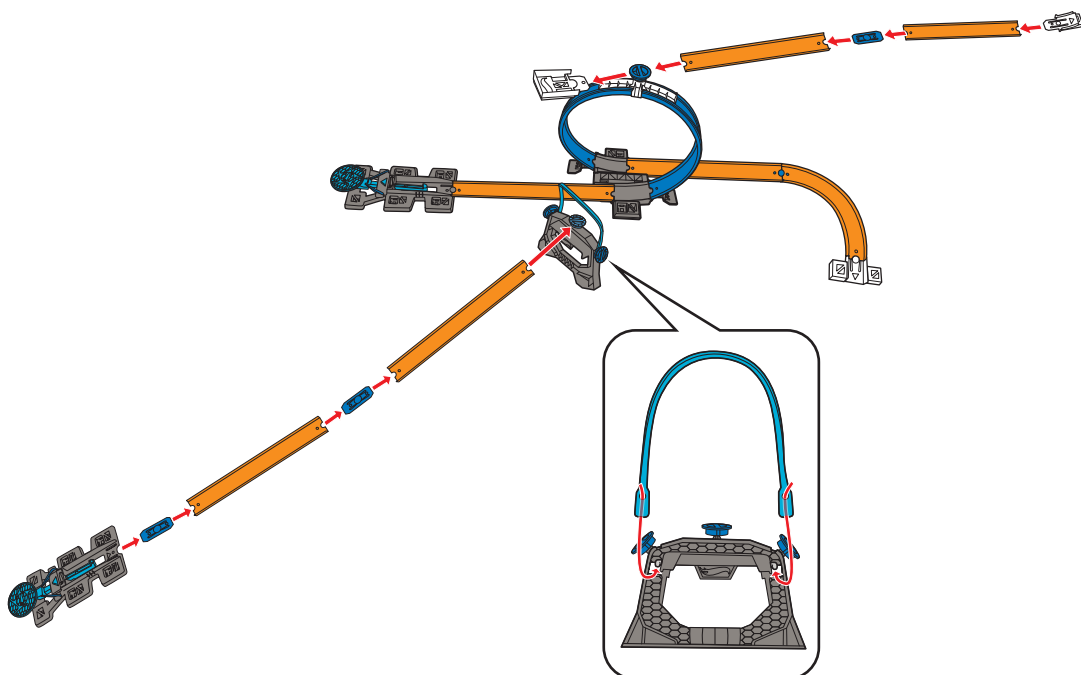

NOW GRAB YOUR CAR AND GO!



BUILDER'S TIP: HOW TO USE THE LAUNCHERS

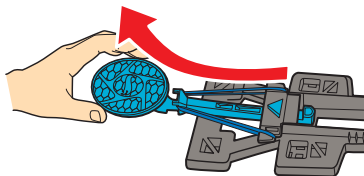

**PULL THE LAUNCHER
ACROSS AND UP AS SHOWN**

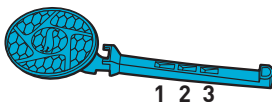

**PULL BACK AND LOCK INTO THE
GROOVE TO SELECT YOUR SPEED**

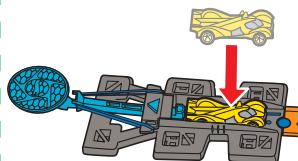

NOW LOAD YOUR CAR



EXPERIMENT WITH BALANCE:

Will the force of the loop cause the car to go?

**RACE THROUGH THE LOOP TO
LAUNCH CAR ON TOP!**

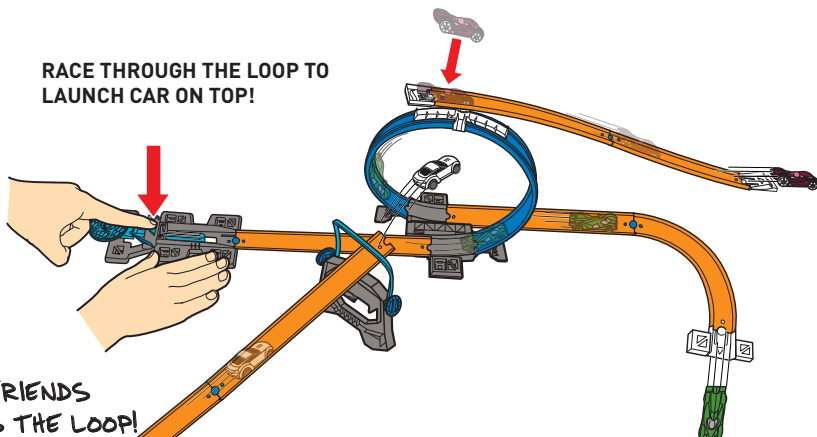

**CHALLENGE YOUR FRIENDS
TO SEE WHO MAKES THE LOOP!**

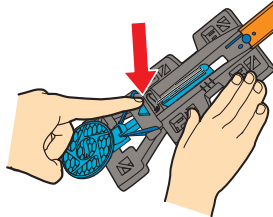

**NOTE: FOR BEST PERFORMANCE, PLAY
ON A HARD SMOOTH SURFACE.**

BUILD 2

HERES WHAT YOU NEED:

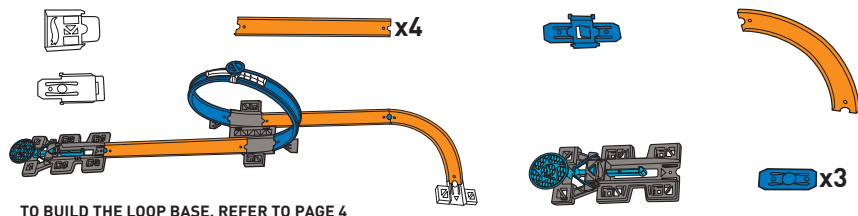

1.

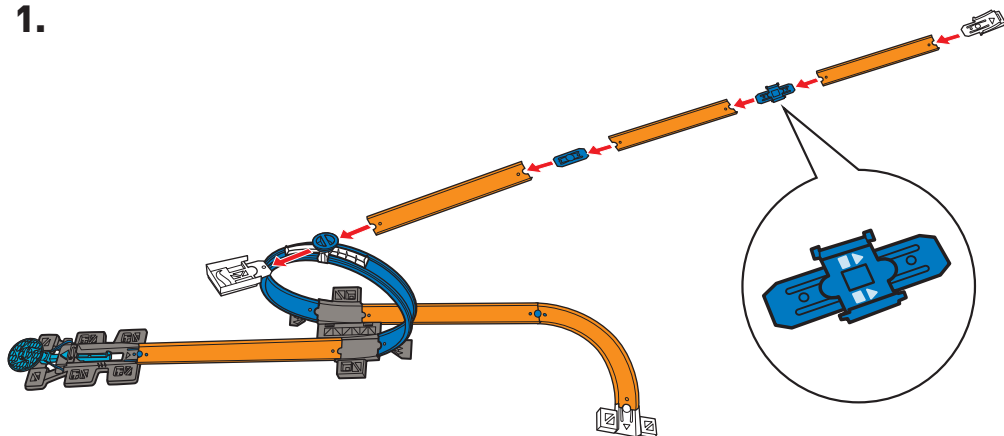

2.

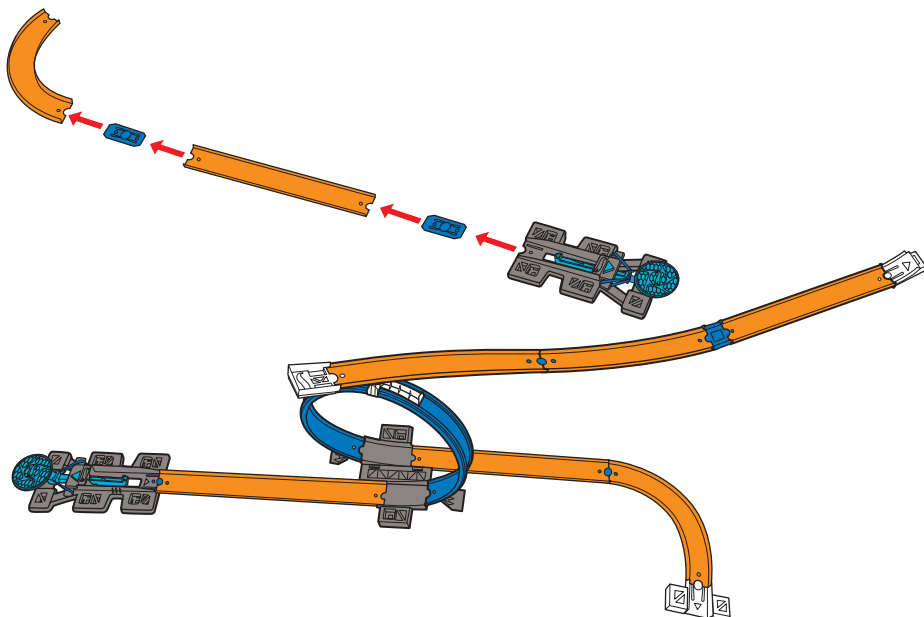

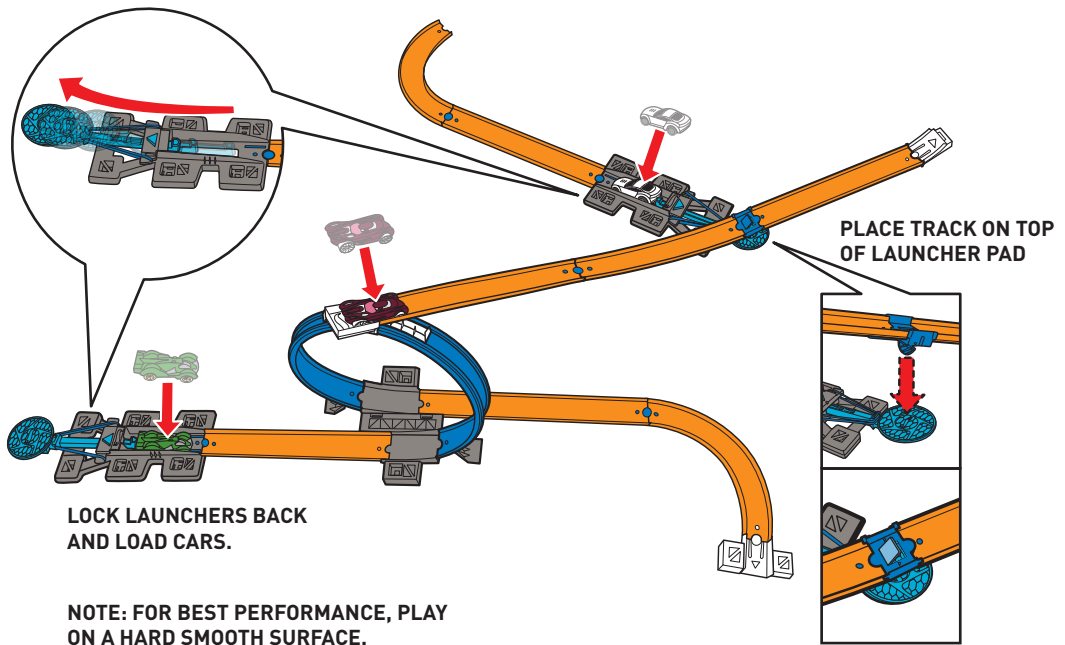

CAN YOU NAIL THE CHAIN REACTION?

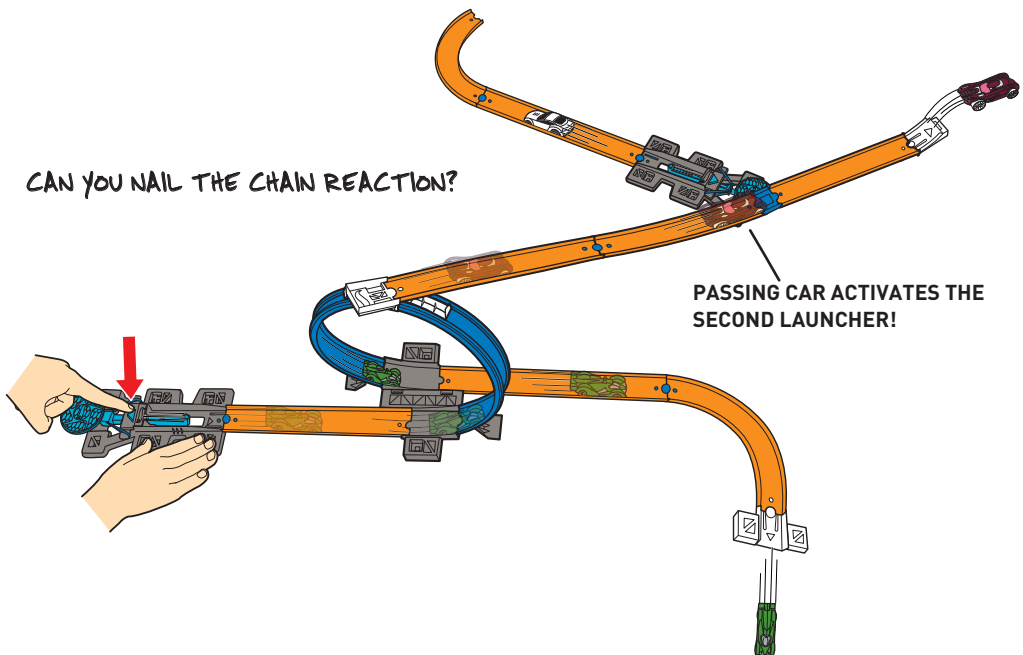

BUILD 3

HERES WHAT YOU NEED:

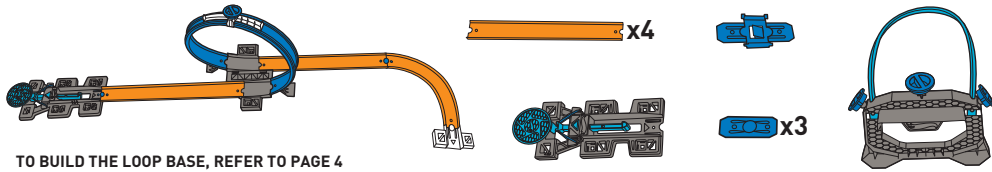

1.

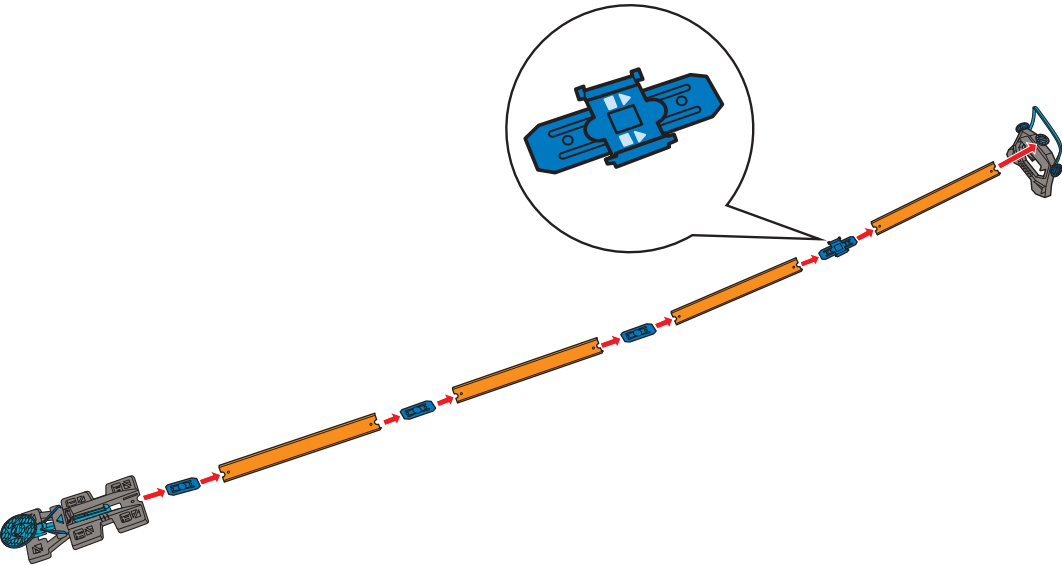

2.

ALIGN LAUNCHER PAD WITH ORANGE TRACK.

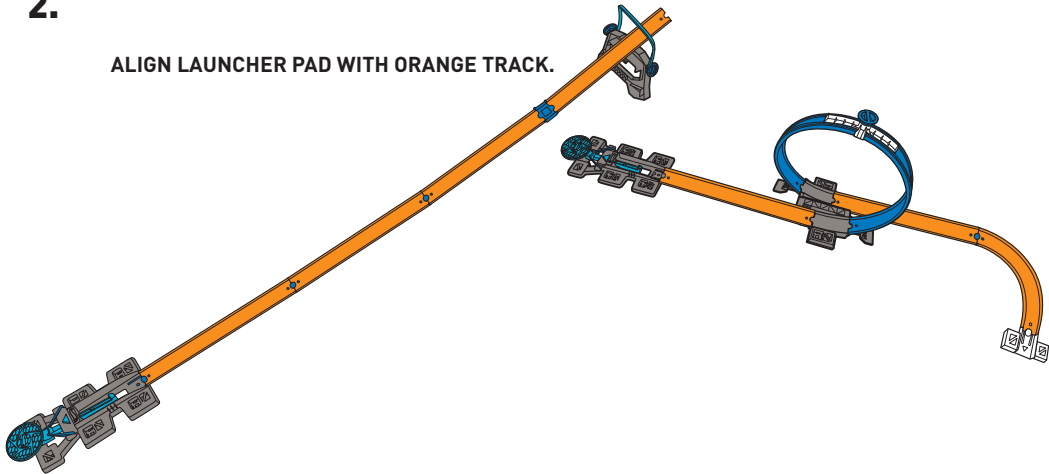

NOW GRAB YOUR CAR AND GO!

LOCK LAUNCHERS BACK
AND LOAD CARS.

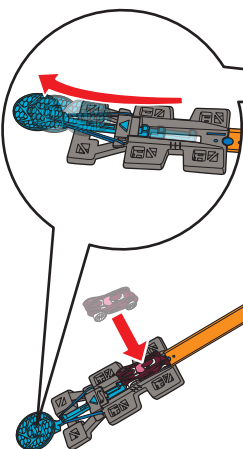

PLACE TRACK ON TOP
OF LAUNCHER PAD

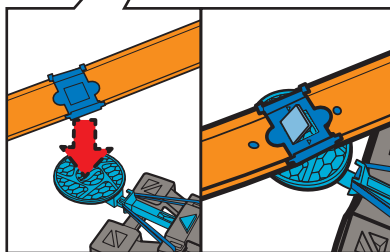

EXPERIMENT WITH SPEED
-DO DIFFERENT HOT WHEELS® CARS GO FASTER?

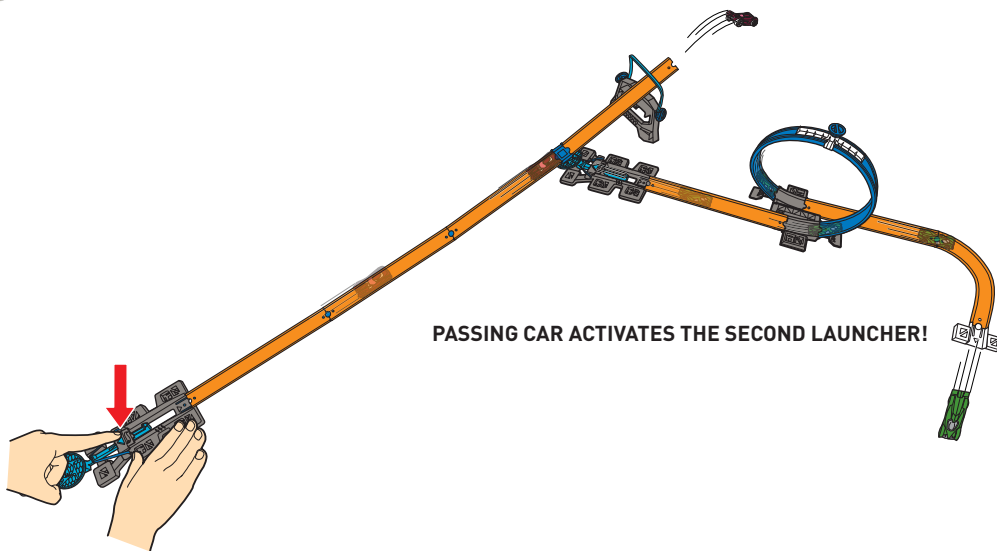

PASSING CAR ACTIVATES THE SECOND LAUNCHER!

BUILD 4

HERES WHAT YOU NEED:

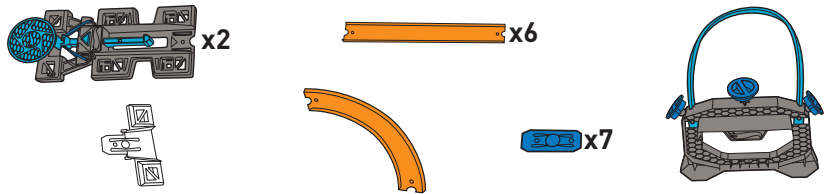

BUILDER'S TIP

SLIDE THE TRACK OVER THE PIVOT POINT

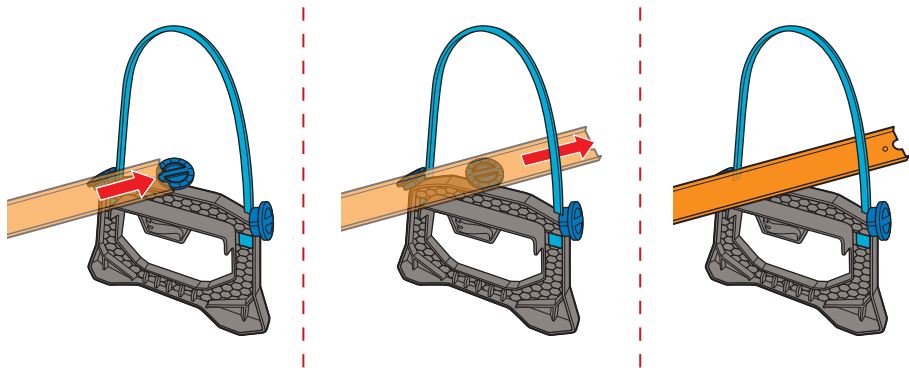

1. BUILD AS SHOWN ON A RAISED SURFACE.

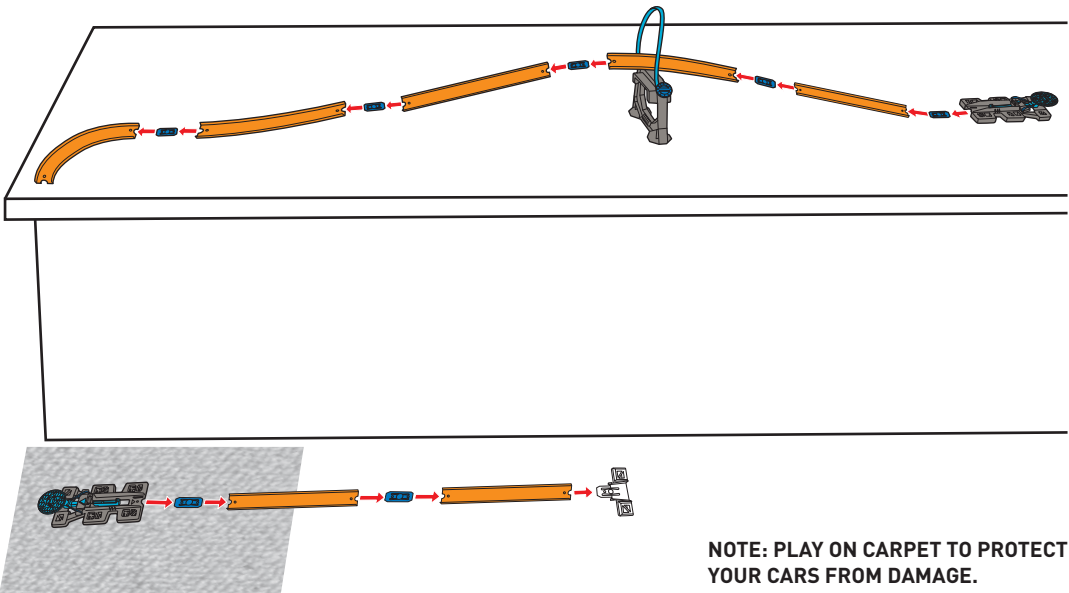

NOTE: PLAY ON CARPET TO PROTECT YOUR CARS FROM DAMAGE.

NOW GRAB YOUR CAR AND GO!

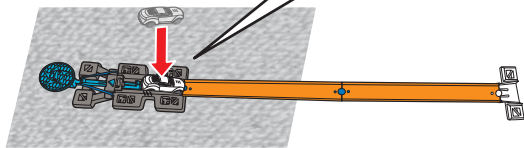
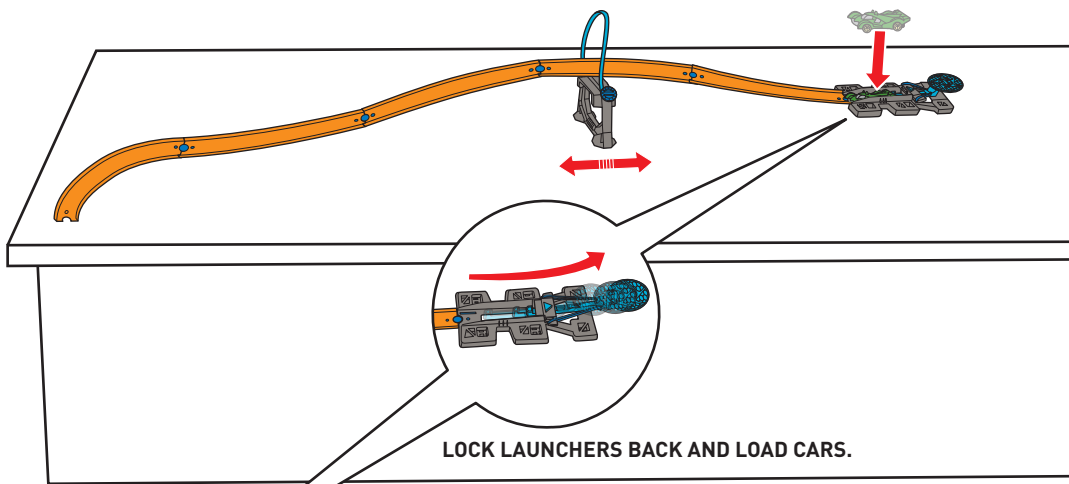

💡 EXPERIMENT WITH HEIGHT
- CAN YOU NAIL IT WITH A LOWER TABLE?

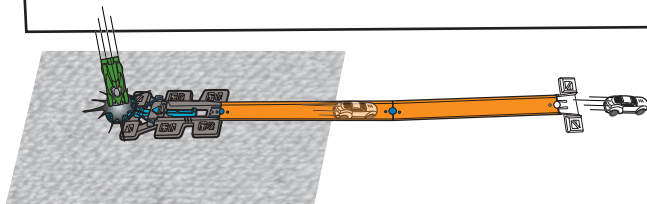
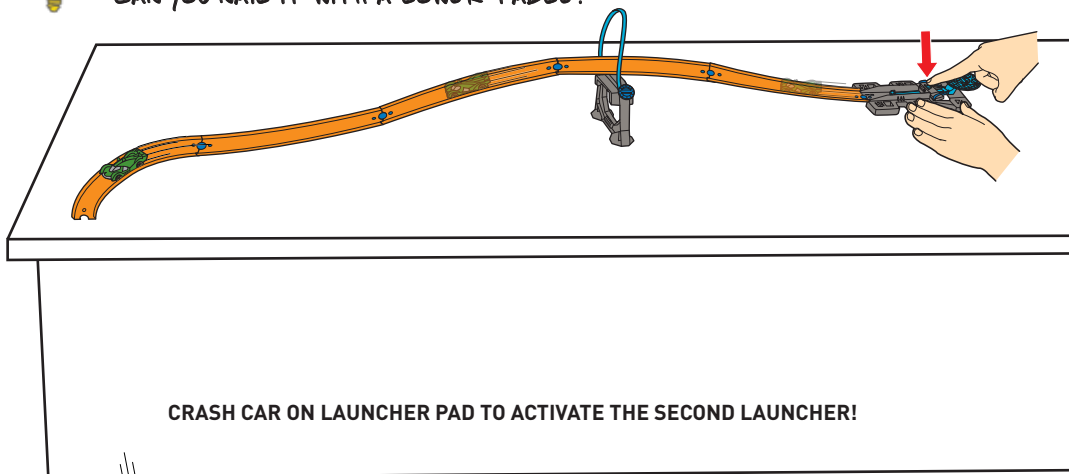

HERE'S WHAT'S COOL!

PIVOT POINTS

NOW YOU CAN
ROTATE TRACK 360!

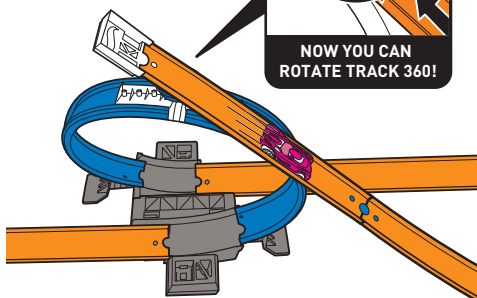

CREATE A GRAVITY DROP

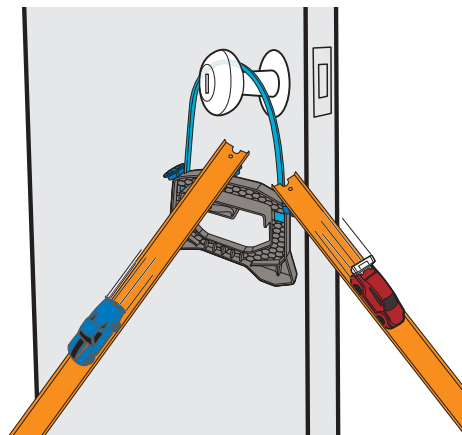

TURN THE LOOP BASE INTO A JUMP FOR YOUR LAUNCHES!

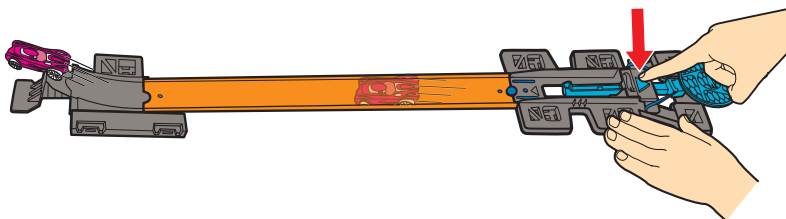

STORE YOUR ACCESSORIES!

a

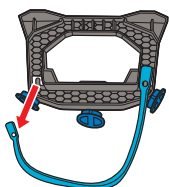

b

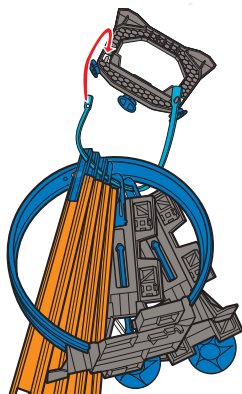

c

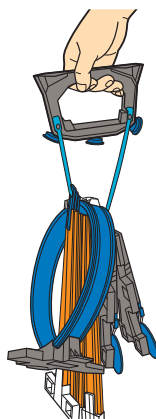

TAKE IT ANYWHERE!

d

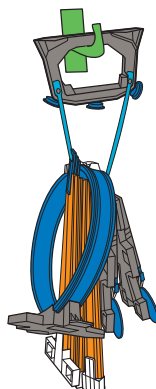

HANG IT IN YOUR ROOM!

WHAT IF.....?

THE KEY TO A RAD STUNT IS IN YOUR HOME ALREADY:

CREATE A CHAIN REACTION LAUNCH!

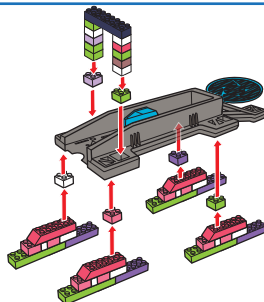
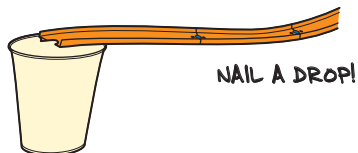
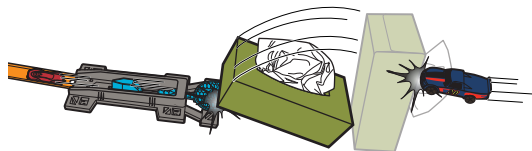

IMAGINE WHAT YOU COULD DO WITH
THE TRACK BUILDER SYSTEM!



FOR MORE EPIC TRACK IDEAS VISIT
WWW.HOTWHEELS.COM/TRACKBUILDER

HERE'S WHAT ELSE YOU CAN GET:

ADVERTISEMENT

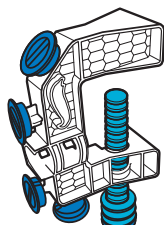

**DLF03
CLAMP IT!**

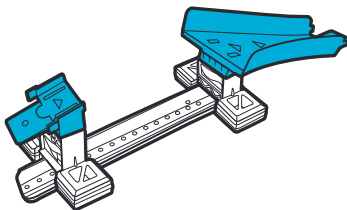

**DLF05
JUMP IT!**

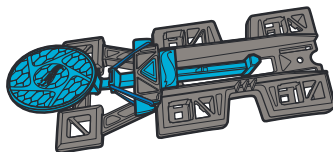

**DLF06
LAUNCH IT!**



**DLF02
HANG IT!**

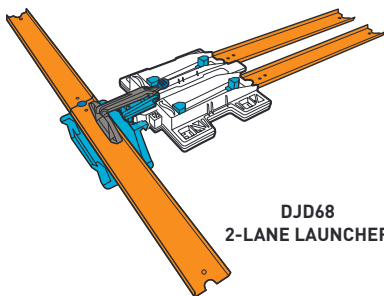

**DJD68
2-LANE LAUNCHER**

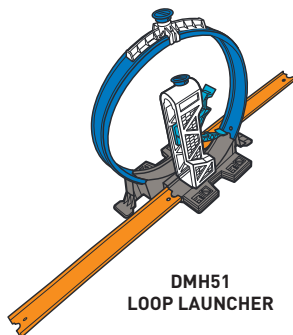

**DMH51
LOOP LAUNCHER**

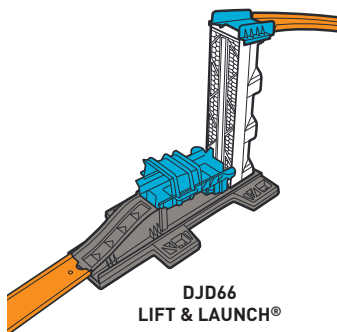

**DJD66
LIFT & LAUNCH®**

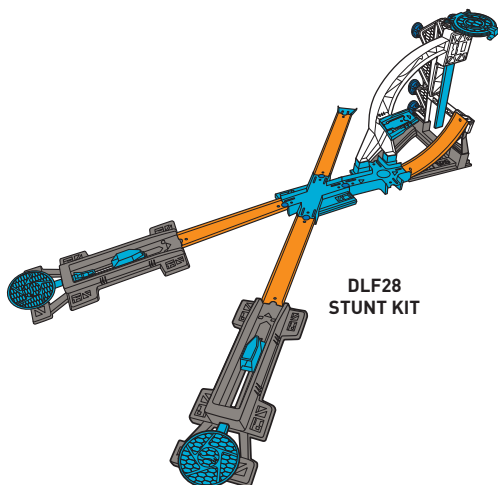

**DLF28
STUNT KIT**

**COLORS AND DECORATIONS MAY VARY.
EACH SOLD SEPARATELY, SUBJECT TO AVAILABILITY.**

©2015 Mattel. All Rights Reserved. Mattel, Inc., 636 Girard Avenue, East Aurora, NY 14052, U.S.A. Consumer Services 1-800-524-8697. Mattel U.K. Ltd., Vanwall Business Park, Maidenhead SL6 4UB. Helpline 01628 500303. Mattel Australia Pty., Ltd., Richmond, Victoria. 3121. Consumer Advisory Service - 1300 135 312. Mattel East Asia Ltd., Room 503-09, North Tower, World Finance Centre, Harbour City, Tsimshatsui, HK, China. Tel.: (852) 3185-6500. Diimport & Diedarkan Oleh: Mattel Southeast Asia Pte. Ltd., No 19-1, Tower 3 Avenue 7, Bangsar South City, No 8, Jalan Kerinchi, 59200 Kuala Lumpur, Malaysia. Tel: 03-78803817, Fax: 03-78803867.