

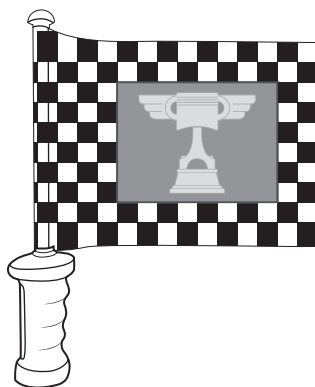

FLAG FINISH LIGHTNING McQUEEN INSTRUCTIONS

3+

CONTENTS

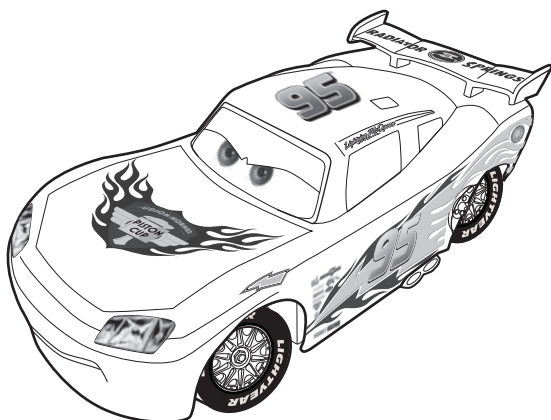

⚠ CAUTION: To prevent entanglement, keep all hair away from the wheels.

Keep these instructions for future reference as they contain important information.
IMPORTANT: Please read all instructions before operating your vehicle.

FEATURES

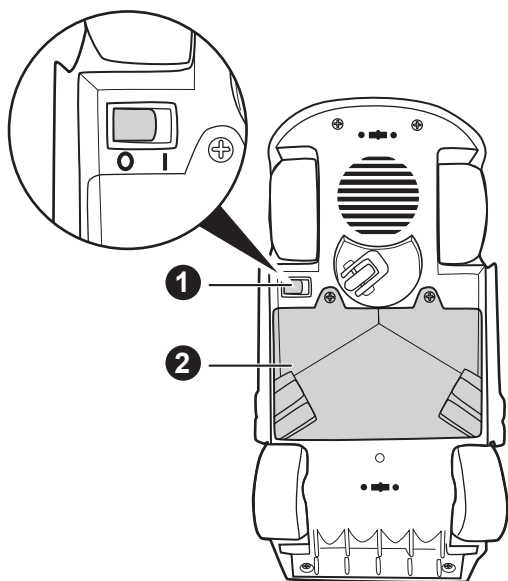

VEHICLE

- ① POWER SWITCH
 - = OFF
 - I = ON
- ② BATTERY COVER

FLAG TRANSMITTER

- ③ MODE SWITCH
 - = OFF
 - ↶ = DRAG & DRIFT
 - ↷ = RACE LAPS
 - 🏆 = VICTORY DANCE
- ④ BATTERY COVER

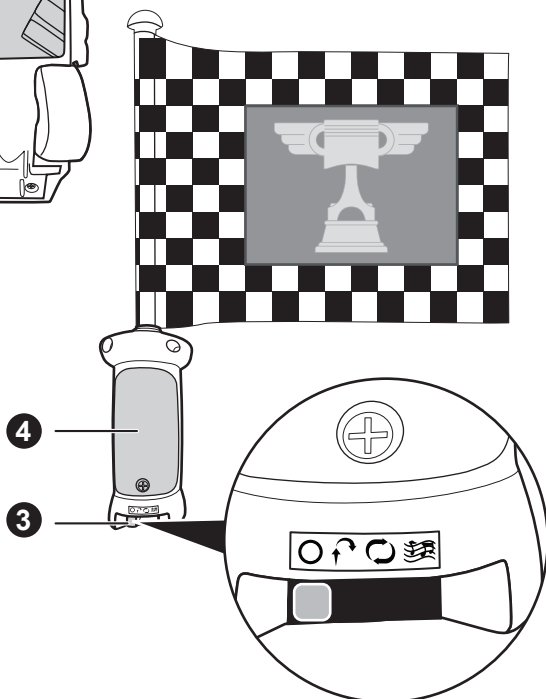

1 / BATTERY INSTALLATION

VEHICLE & FLAG TRANSMITTER

Vehicle requires 6 AA (LR06) alkaline batteries, not included.
Transmitter requires 2 AAA (LR03) alkaline batteries, not included.
For longer life, use alkaline batteries. Dispose of batteries safely.

VEHICLE

1. Unscrew the battery cover with a Phillips head screwdriver (not included).
2. Install 6 AA (LR06) alkaline batteries, with polarity (+/-) as shown inside the battery compartment.
3. Replace battery cover and tighten screws.

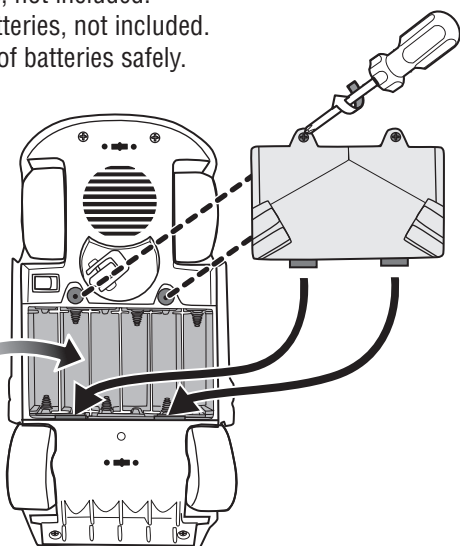
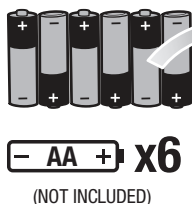

FLAG TRANSMITTER

1. Unscrew the battery cover with a Phillips head screwdriver (not included).
2. Install 2 AAA (LR03) alkaline batteries, with polarity (+/-) as shown inside the battery compartment.
3. Replace battery cover and tighten screw.

NOTE: When exposed to an electrostatic source, the toy may malfunction. To resume normal operation, remove and re-install the batteries. This should reset the toy and let you resume normal operation.

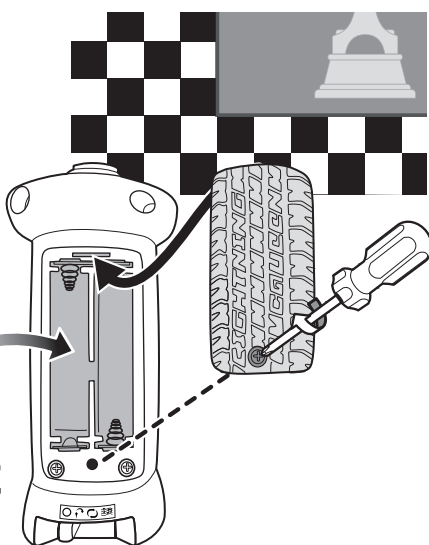
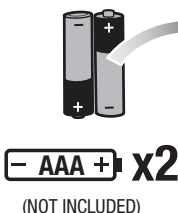

BATTERY SAFETY INFORMATION

In exceptional circumstances batteries may leak fluids that can cause a chemical burn injury or ruin your product. To avoid battery leakage:

- Non-rechargeable batteries are not to be recharged.
- Rechargeable batteries are to be removed from the product before being charged.
- Rechargeable batteries are only to be charged under adult supervision.
- Do not mix alkaline, standard (carbon-zinc), or rechargeable (nickel-cadmium) batteries.
- Do not mix old and new batteries.
- Only batteries of the same or equivalent type as recommended are to be used.
- Batteries are to be inserted with the correct polarity.
- Exhausted batteries are to be removed from the product.
- The supply terminals are not to be short-circuited.
- Dispose of battery(ies) safely.
- Do not dispose of this product in a fire. The batteries inside may explode or leak.



Protect the environment by not disposing of this product with household waste (2012/19/EU). Check your local authority for recycling advice and facilities.

2 / LET'S PLAY!

You can use the flag transmitter to play with Lightning McQueen in the following modes:

- ① DRAG & DRIFT
- ② RACE LAPS
- ③ VICTORY DANCE

IMPORTANT:

- Always start with the vehicle and transmitter powered OFF, and within 6 inches from each other.
- Always turn ON the vehicle and put it on the floor before turning ON the transmitter.
- Always turn OFF the transmitter before the vehicle.

NOTE:

- This product is not recommended for use on loose dirt or wet surfaces.
- To conserve battery life, Lightning McQueen goes to sleep when left idle. To wake him up, switch the vehicle and transmitter OFF and then ON again.

① DRAG & DRIFT

Turn ON the vehicle and slide the MODE SWITCH on the flag to . When you hear "Time for a drag race! Drop the flag!" wave the flag downward, then hold it still, to see Lightning McQueen race forward. When you want Lightning McQueen to stop, wave the flag downward again and he drifts to a halt.

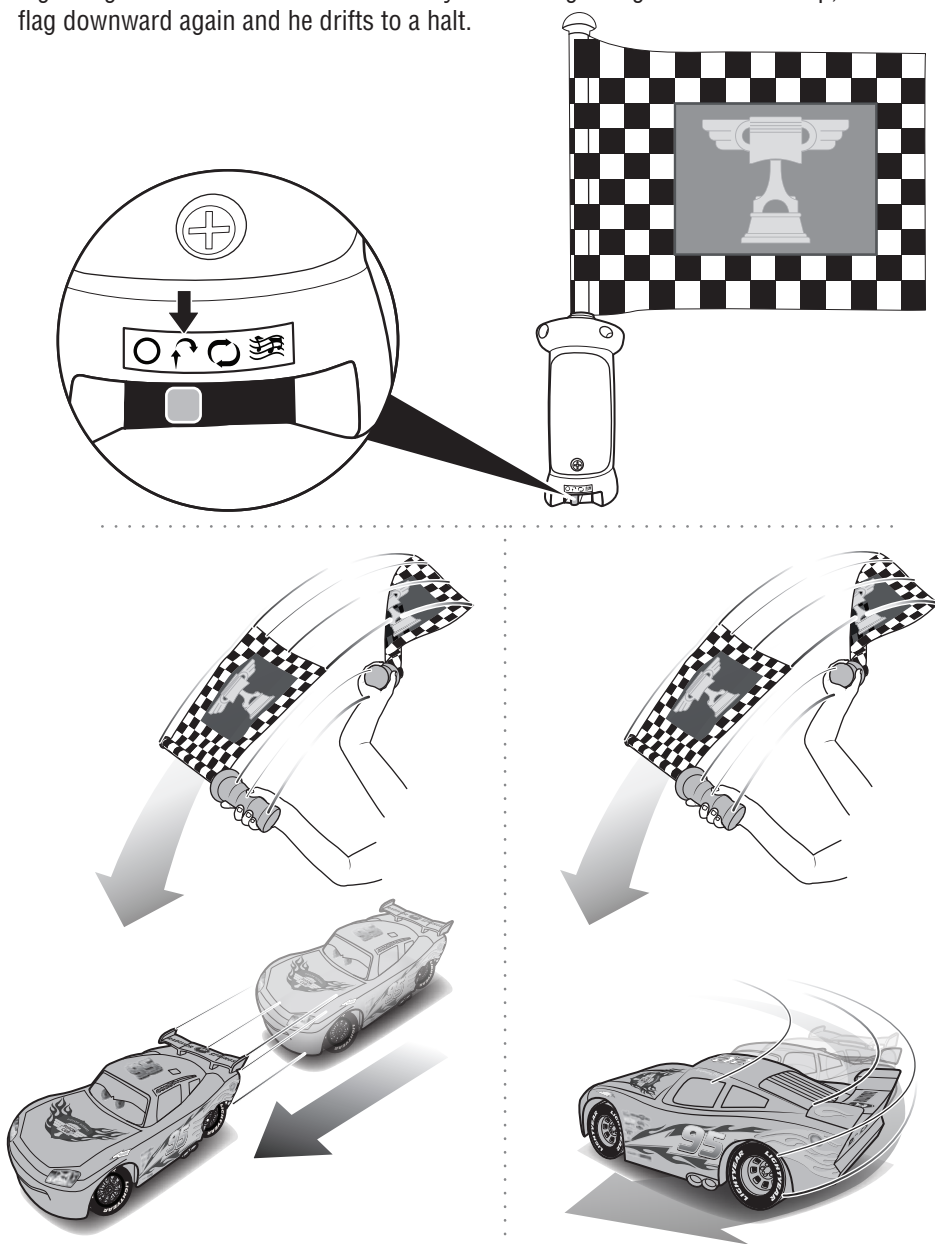

2 RACE LAPS

Turn ON the vehicle and slide the MODE SWITCH on the flag to . When you hear "The Piston Cup! Wave that flag!" wave the flag continuously left and right to see Lightning McQueen drift around in a circle. Stop waving the flag and Lightning McQueen stops.

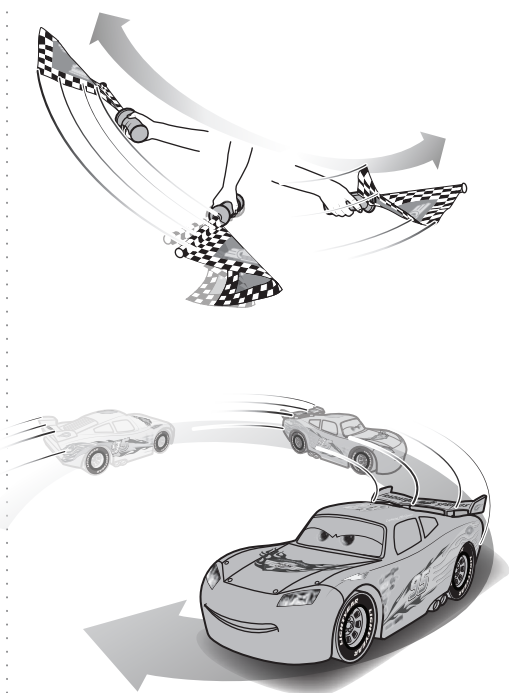
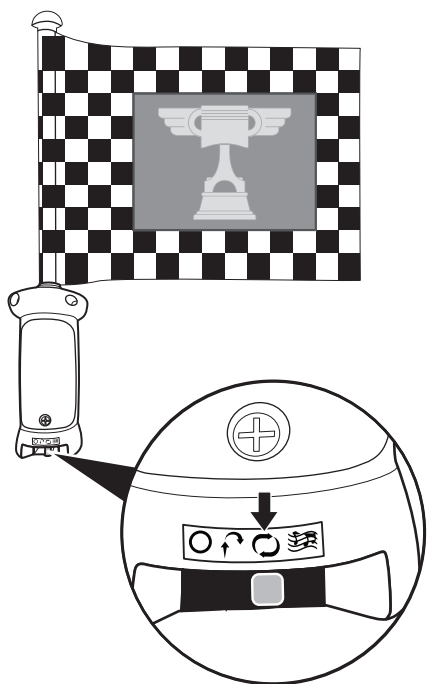

3 VICTORY DANCE

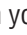
Turn ON the vehicle and slide the MODE SWITCH on the flag to . When you hear "Victory dance! Shake that flag!" wave the flag continuously up and down to see Lightning McQueen break out his dance moves. Stop waving and Lightning McQueen stops too.

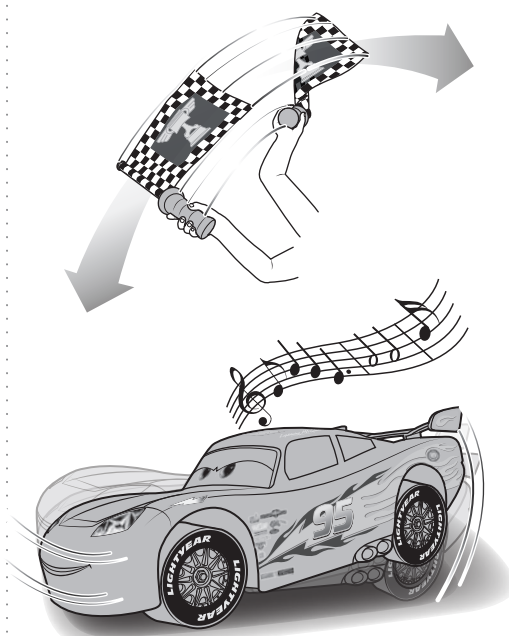
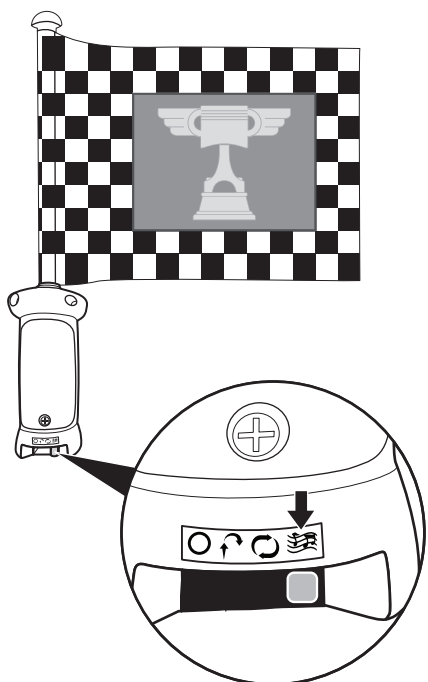

3 / MORE WAYS TO PLAY

MULTIPLAYER

You can race your Flag Finish Lightning McQueen against a friend's (maximum 4 vehicles). Start with all vehicles and transmitters powered OFF (switches set to 0). Turn ON one set of vehicle and transmitter together to pair them up. Wait for Lightning McQueen to respond before turning ON the next vehicle and transmitter. Repeat until each set is paired up. If Lightning McQueen goes out of range, or any of the vehicles or transmitters are turned OFF during play, turn OFF the corresponding vehicle/transmitter, and repeat the above steps to continue play.

4 / QUICK TIPS

- 1 When your vehicle starts to lose power, it may lose functionality or performance. It's time for fresh batteries. Your vehicle's running time may change depending on your driving style and driving environment.
- 2 Radio interference can affect your vehicle's performance. Interference can be caused by other R/C vehicles running on the same frequency, electrical wires, large buildings or CB radios. Try to stay away from these!
- 3 Point your transmitter up - not down toward your vehicle. If your vehicle gets too far away, it won't work properly.
- 4 Don't drive your vehicle in sand or through water or snow. Do not immerse in water. If your vehicle does get wet, wipe it with a towel and allow to dry completely overnight.
- 5 Don't store your vehicle near heat or in direct sunlight. Always turn switches OFF and remove all batteries for storage.

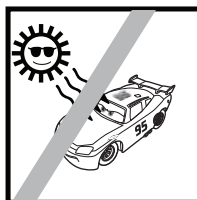
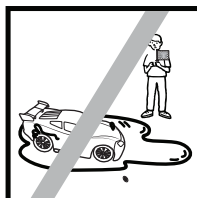
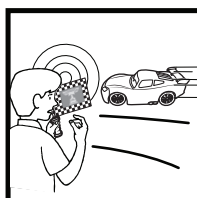
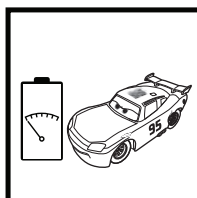

5 / CONSUMER INFORMATION

Note to Adults: To ensure that the child's play is both safe and fun, please review all operating instructions and safety rules with your child.

- NEVER drive your vehicle on streets! Streets are for real cars!
- DO NOT pick up the vehicle while it is in motion.
- Keep fingers, hair and loose clothing away from the wheels while the vehicle is switched ON.
- Adult supervision is recommended while this toy is being operated.
- When not in use, turn off the vehicle. To avoid accidental operation, remove all batteries.
- This product is not recommended for use on loose dirt or wet surfaces.

FOR PRODUCT SOLD IN USA

This device complies with Part 15 of the FCC Rules.

Operation is subject to the following two conditions:

(1) This device may not cause harmful interference, and (2) this device must accept any interference received, including interference that may cause undesired operation.

- This equipment has been tested and found to comply with the limits for a Class B digital device, pursuant to part 15 of the FCC rules. These limits are designed to provide reasonable protection against harmful interference in a residential installation. This equipment generates, uses and can radiate radio frequency energy and, if not installed and used in accordance with the instructions, may cause harmful interference to radio communications. However, there is no guarantee that interference will not occur in a particular installation. If this equipment does cause harmful interference to radio or television reception, which can be determined by turning the equipment off and on, the user is encouraged to try to correct the interference by one or more of the following measures:
- Reorient or relocate the receiving antenna.
- Increase the separation between the equipment and receiver.
- Connect the equipment into an outlet on a circuit different from that to which the receiver is connected.
- Consult the dealer or an experienced radio/TV technician for help.

NOTE: Changes or modifications not expressly approved by the manufacturer responsible for compliance could void the user's authority to operate the equipment.

©2016 Mattel. All Rights Reserved. ® and ™ designate U.S. trademarks of Mattel, except as noted.
Mattel, Inc., 636 Girard Avenue, East Aurora, NY 14052, U.S.A. Consumer Services 1-800-524-8697. Mattel U.K. Ltd., Vanwall Business Park, Maidenhead SL6 4UB. Helpline 01628 500303. Mattel Australia Pty., Ltd., Richmond, Victoria. 3121.Consumer Advisory Service - 1300 135 312. Mattel East Asia Ltd., Room 503-09, North Tower, World Finance Centre, Harbour City, Tsimshatsui, HK, China. Tel.: (852) 3185-6500. Diimport & Diedarkan Oleh: Mattel Southeast Asia Pte. Ltd., No 19-1, Tower 3 Avenue 7, Bangsar South City, No 8, Jalan Kerinchai, 59200 Kuala Lumpur, Malaysia. Tel: 03-78803817, Fax: 03-78803867.

