

# HOT WHEELS TRACK BUILDER SYSTEM™

## BUILDER'S GUIDE

CRASH FASTER

GO HIGHER!

JUMP FURTHER!



HANG ON TO THIS GUIDE,  
IT HAS KEY INFORMATION  
TO BUILD RAD STUNTS!

**WARNING:**  
CHOKING HAZARD - Small parts.  
Not for children under 3 years.

4+

service.mattel.com  
**HOTWHEELS.COM**



DLF28-0970  
1100858562-DOMG2

# STUNT KIT

CONGRATULATIONS. You just gained access to the unlimited world of Track Builder and now YOU are in the driving seat. Create your own outrageous stunts, experiment with speed and Keep challenging yourself. Are you ready to get your wheels turning? Grab your car and go.....MAKE IT EPIC!



PARENTS: FOR EPIC TRACK IDEAS, HOW-TO VIDEOS AND AWESOME ENTERTAINMENT, CHECK OUT THE HOT WHEELS YOUTUBE CHANNEL!  
[WWW.YOUTUBE.COM/HOTWHEELS](http://WWW.YOUTUBE.COM/HOTWHEELS).



## THE BUILDER'S GUIDE BREAKDOWN

HERE'S WHAT YOU GET!

3

HERE'S HOW YOU START!

3

CHOOSE YOUR BUILD!

5

HIGH JUMP STUNT

6

CRISS CROSS STUNT

8

LONG JUMP STUNT

10

THE DROP STUNT

12

HERE'S WHAT'S COOL!

14

WHAT IF.....?

15

HERE'S WHAT ELSE YOU CAN GET:

16



# HERE'S HOW YOU START!

REFER TO LETTER ON TOY PARTS AND CONTENTS PAGE TO HELP WITH ASSEMBLY.

## BUILD THE STUNT BASE

1.

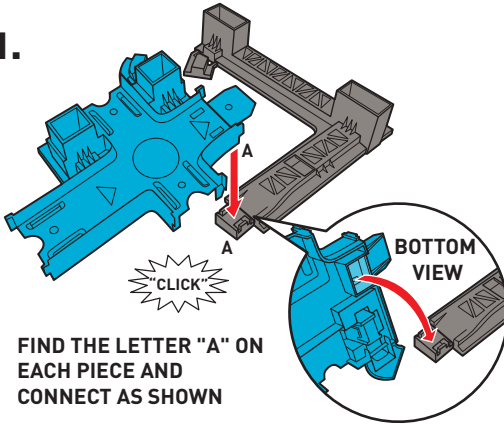

FIND THE LETTER "A" ON EACH PIECE AND CONNECT AS SHOWN

2.

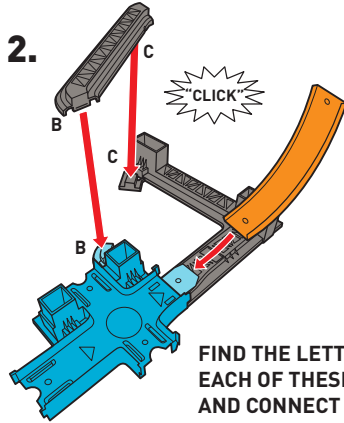

FIND THE LETTERS ON EACH OF THESE PIECES AND CONNECT AS SHOWN

3.

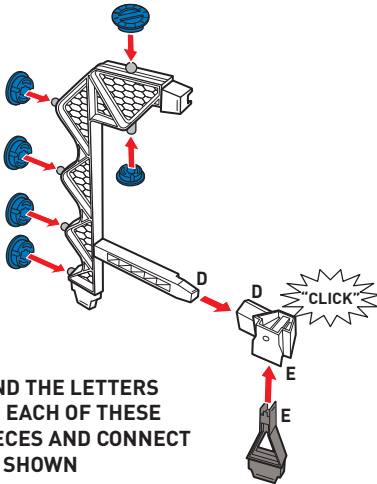

FIND THE LETTERS ON EACH OF THESE PIECES AND CONNECT AS SHOWN

4.

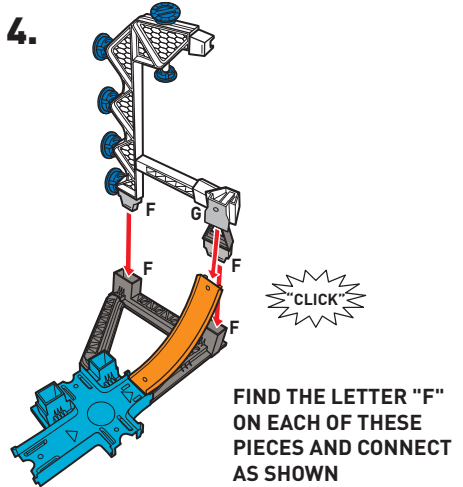

FIND THE LETTER "F" ON EACH OF THESE PIECES AND CONNECT AS SHOWN

5.

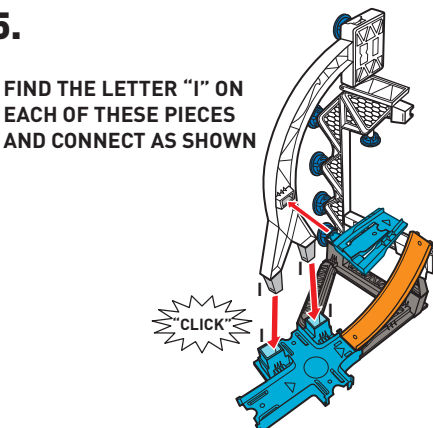

FIND THE LETTER "I" ON EACH OF THESE PIECES AND CONNECT AS SHOWN

6.

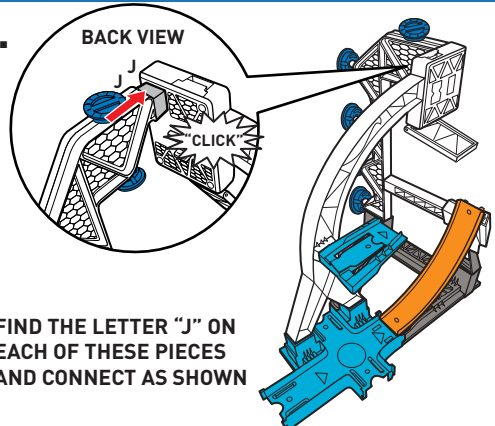

FIND THE LETTER "J" ON EACH OF THESE PIECES AND CONNECT AS SHOWN

# CHOOSE YOUR BUILD!

**BUILD THESE 4 STUNTS!**  
**THEY ARE COLOR CODED AND RATED LEVEL 1-4.**

## HIGH JUMP STUNT LEVEL 1

INSTRUCTIONS ON PAGE 6

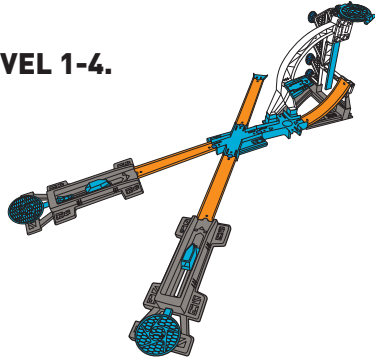

## CRISS CROSS STUNT LEVEL 2

INSTRUCTIONS ON PAGE 8

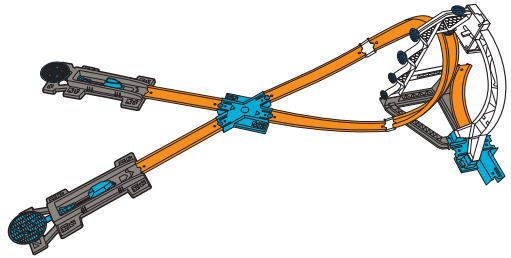

## LONG JUMP STUNT LEVEL 3

INSTRUCTIONS ON PAGE 10

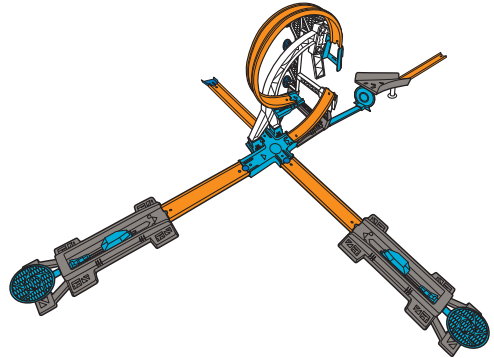

## THE DROP STUNT LEVEL 4

INSTRUCTIONS ON PAGE 12

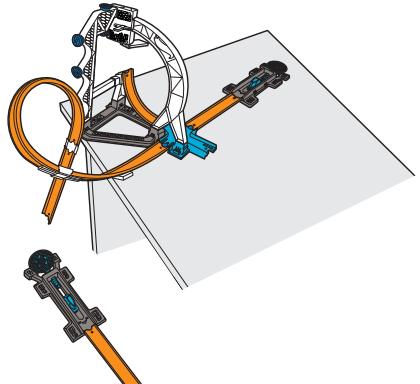

COLORS AND DECORATIONS MAY VARY.

# HIGH JUMP STUNT LEVEL 1

## HERE'S WHAT YOU NEED FOR THIS STUNT



x2

x4

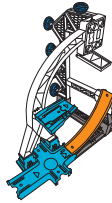

TO BUILD THE STUNT BASE, REFER TO PAGE 4

x2

x1



1.

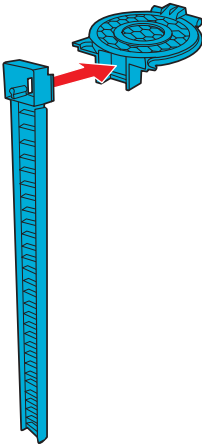

2. ATTACH THE JUMPBOARD. PUSH IT DOWN UNTIL IT'S FLUSH AS SHOWN ON THE RIGHT.

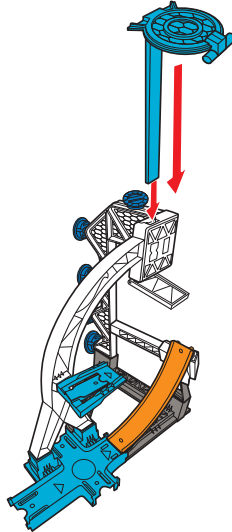

3.

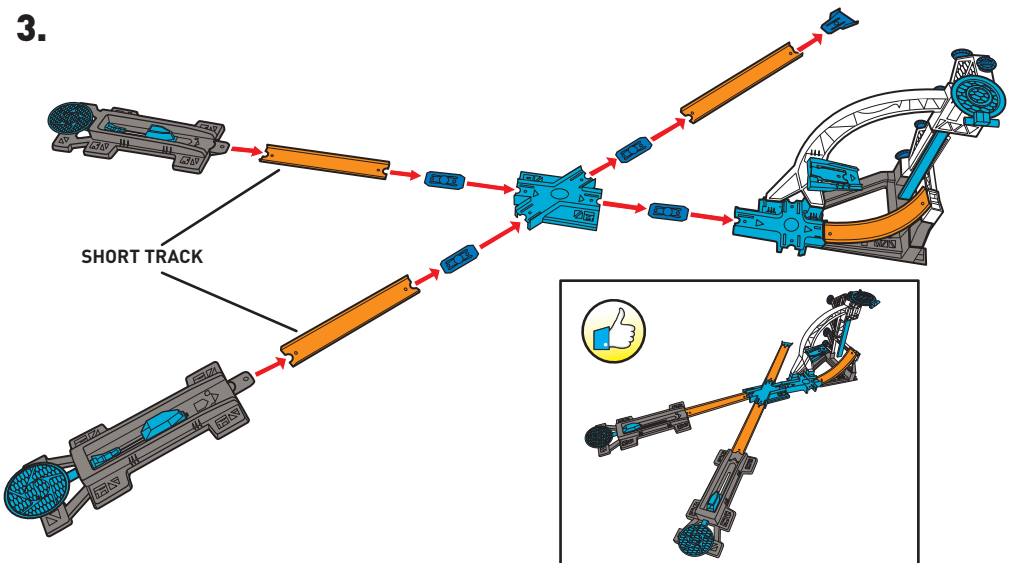

SHORT TRACK

# NOW GRAB YOUR CAR AND GO!

EXPERIMENT WITH SPEED!

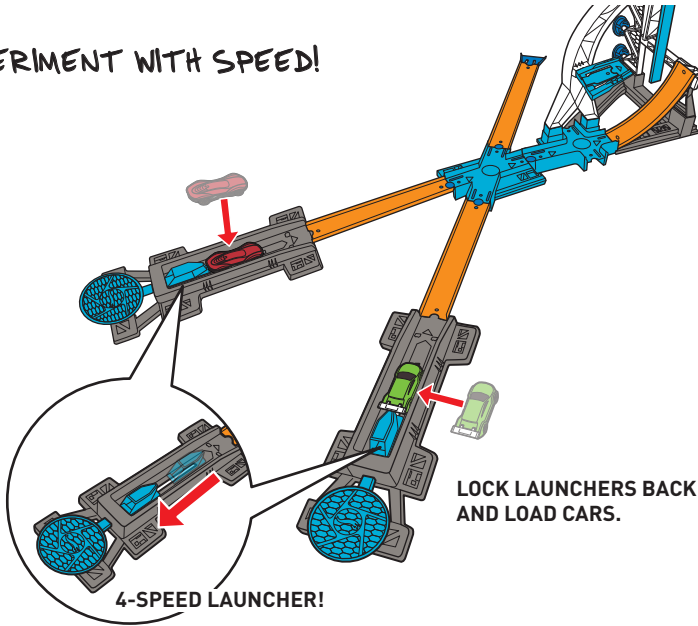

LOCK LAUNCHERS BACK  
AND LOAD CARS.

LAUNCH, CRASH THEN MEASURE  
YOUR DISTANCE!



EXPERIMENT WITH YOUR HOT WHEELS  
- DO DIFFERNT CARS GO HIGHER?

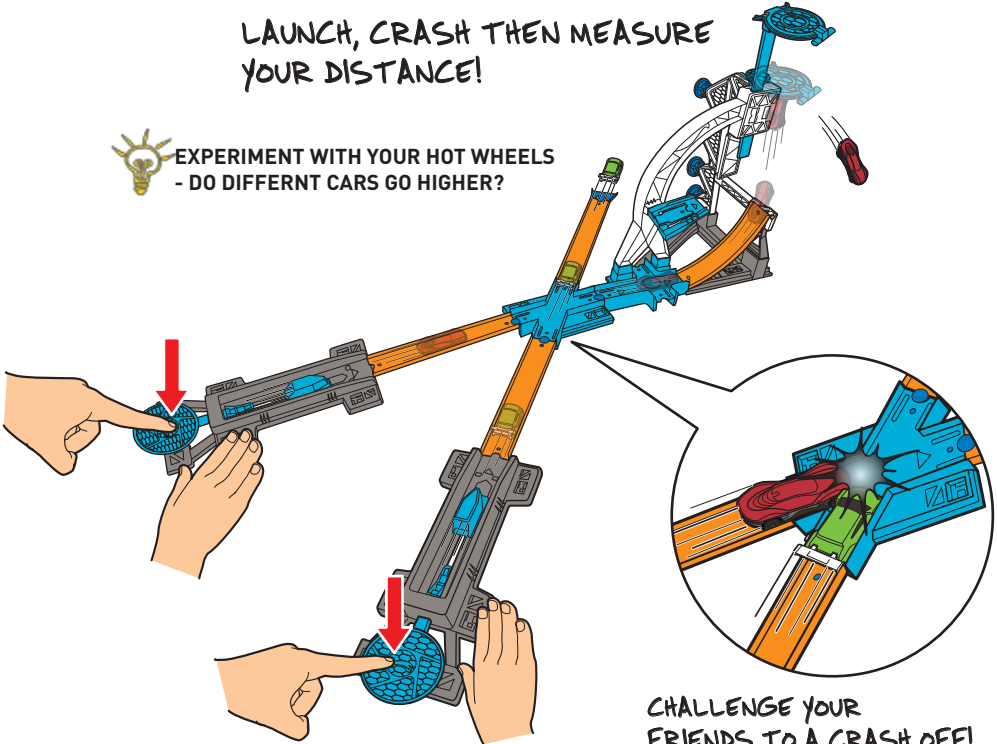

CHALLENGE YOUR  
FRIENDS TO A CRASH OFF!

# CRISS CROSS STUNT LEVEL 2

## HERE'S WHAT YOU NEED FOR THIS STUNT

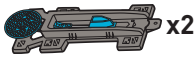

x4

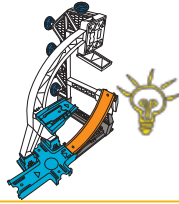
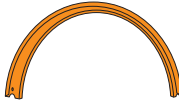

TO BUILD THE STUNT BASE, REFER TO PAGE 4

### 1. DETACH THE PIVOT POINT.

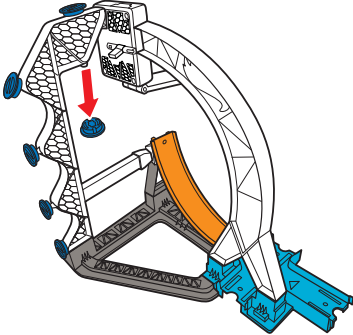

### 2. SLIDE PIVOT POINT TO THE MIDDLE OF THE TRACK.

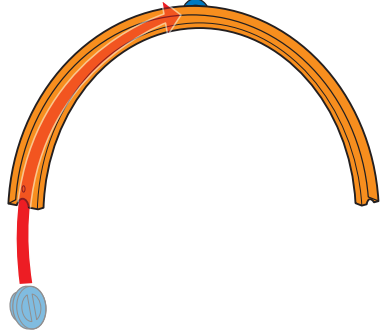

### 3. REATTACH THE PIVOT POINT TO SET.

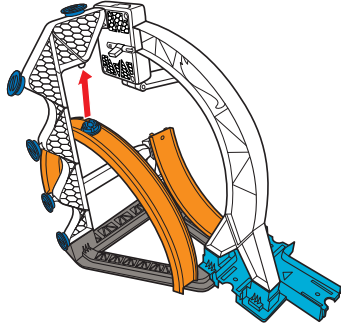

### 4.

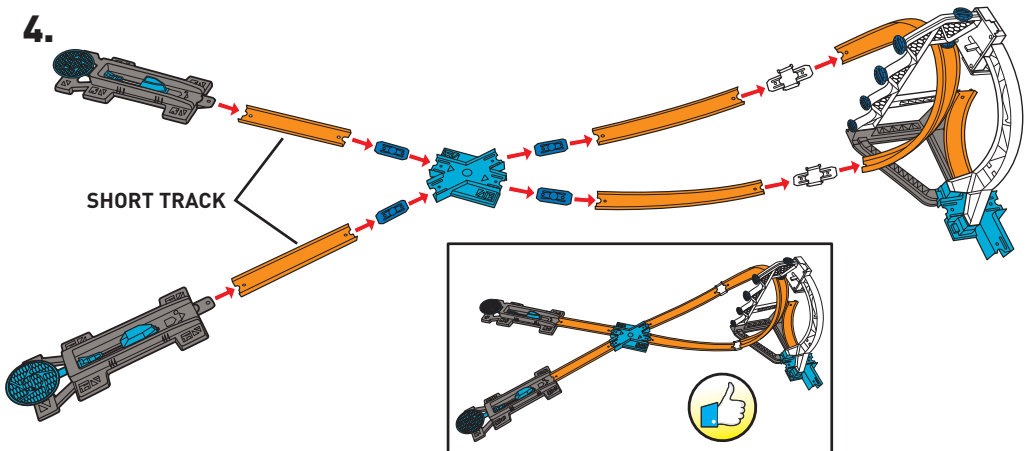



# NOW GRAB YOUR CAR AND GO!

LOCK LAUNCHERS BACK AND LOAD CARS.

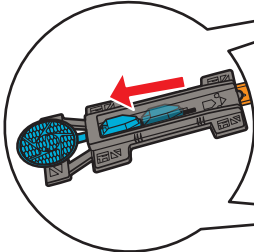

4-SPEED LAUNCHER!

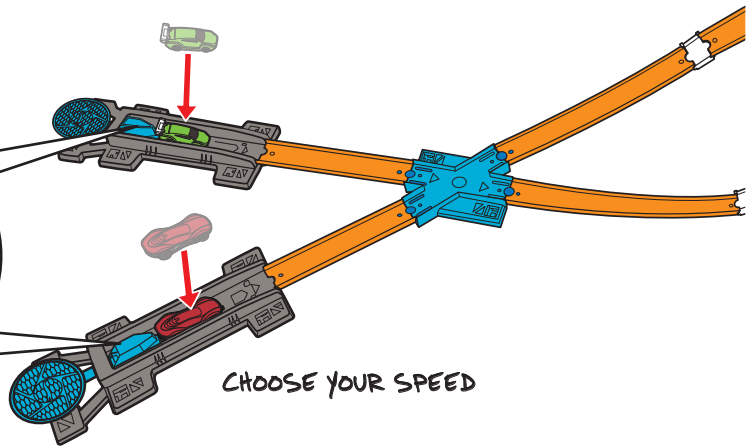

CHOOSE YOUR SPEED



EXPERIMENT WITH SPEED  
-DO DIFFERENT CARS GO FASTER?

PRESS TO LAUNCH

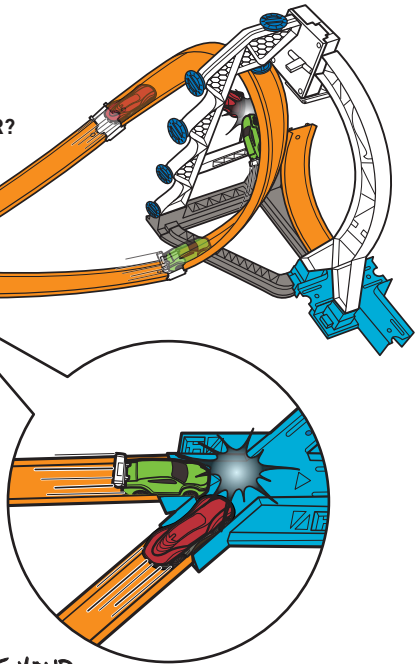
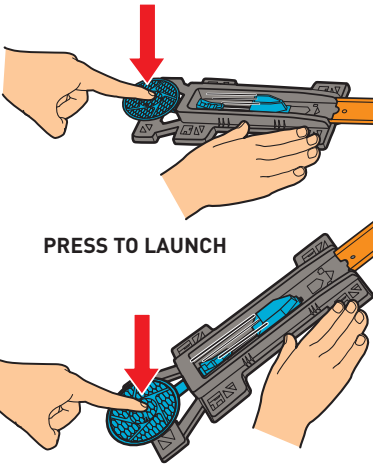

CHALLENGE YOUR FRIENDS TO A CRASH OFF!

# LONG JUMP STUNT LEVEL 3

## HERE'S WHAT YOU NEED FOR THIS STUNT

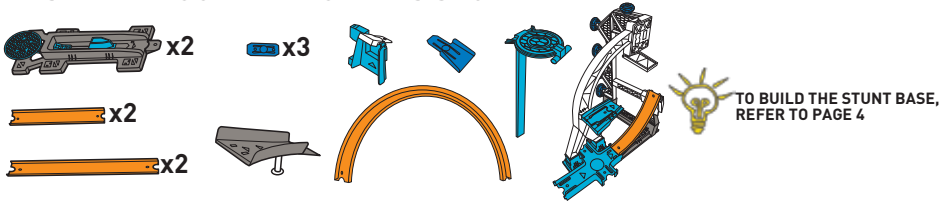

**1. ATTACH LOOP TRACK CONNECTOR (DETACH WHEN NOT REQUIRED).**

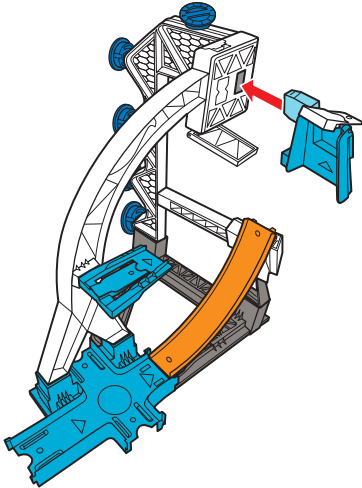

**2.**

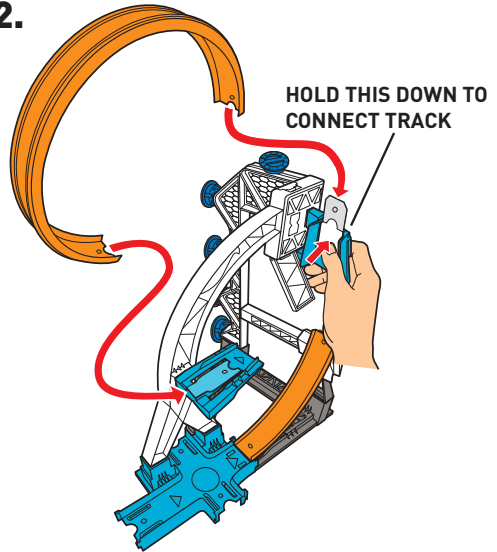

**3.**

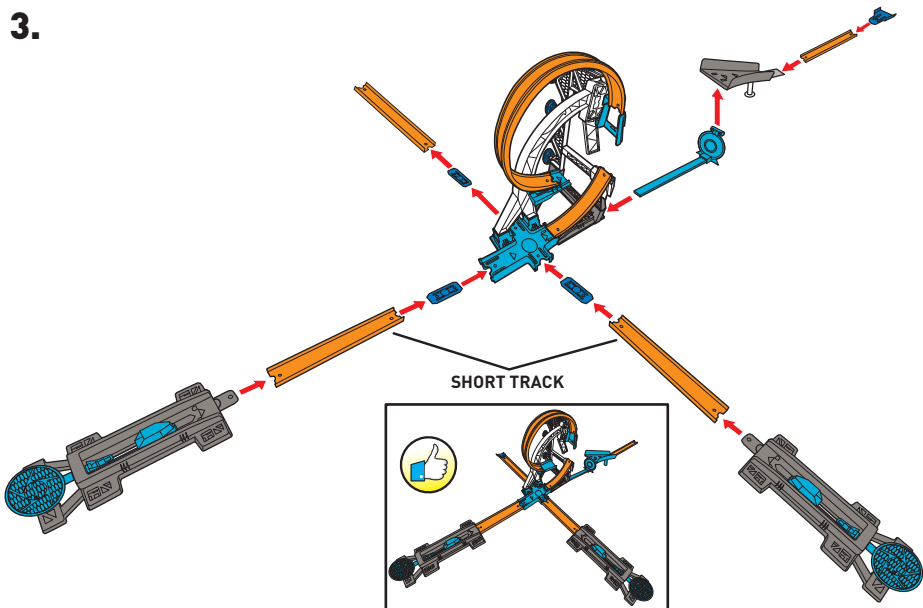

# NOW GRAB YOUR CAR AND GO!

CHALLENGE YOUR FRIENDS TO A CRASH OFF!

CAN YOU NAIL THE LANDING?

ADJUST THE DISTANCE TO VARY THE CHALLENGE.

CHOOSE YOUR SPEED!

4-SPEED LAUNCHER!

LOCK LAUNCHERS BACK AND LOAD CARS.

SET THE RECORD THEN BREAK IT!

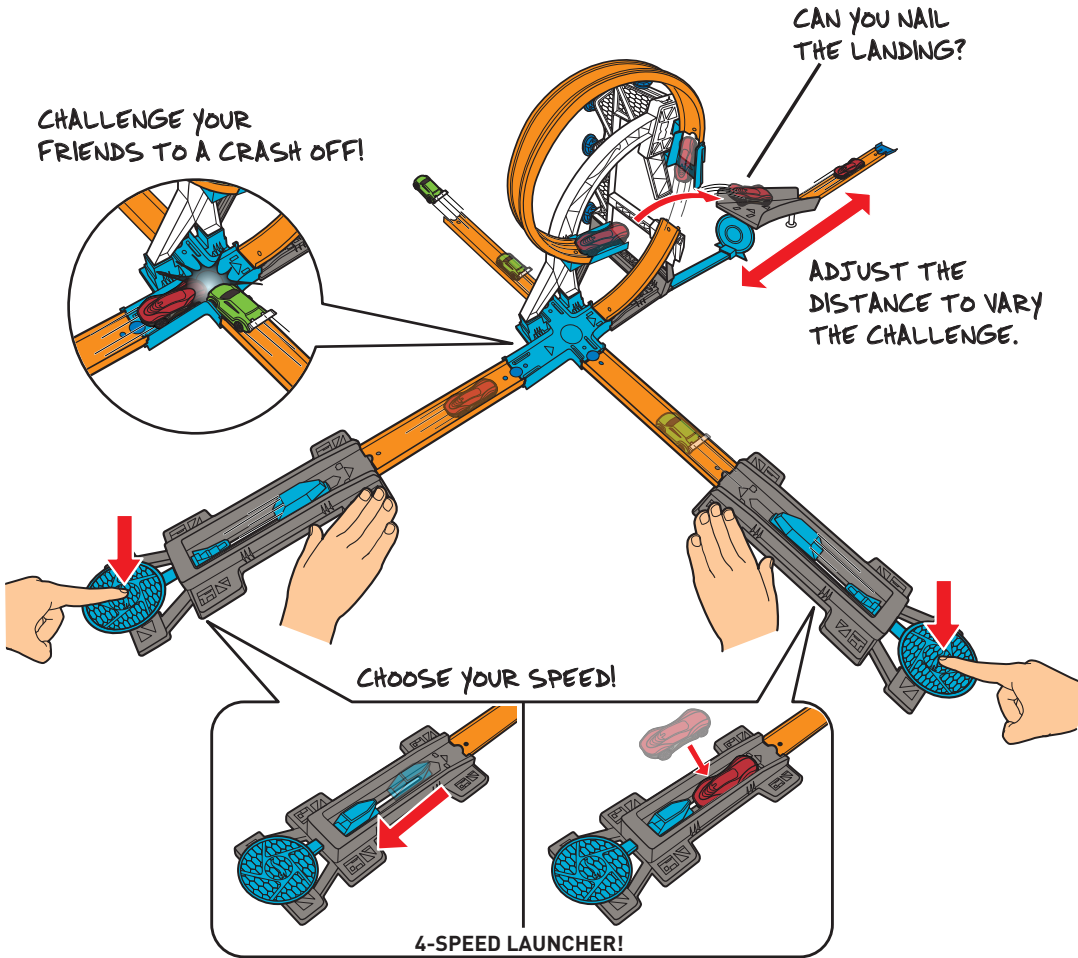

# THE DROP STUNT LEVEL 4

## HERE'S WHAT YOU NEED FOR THIS STUNT

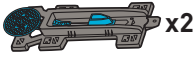

TO BUILD THE STUNT BASE, REFER TO PAGE 4

1.

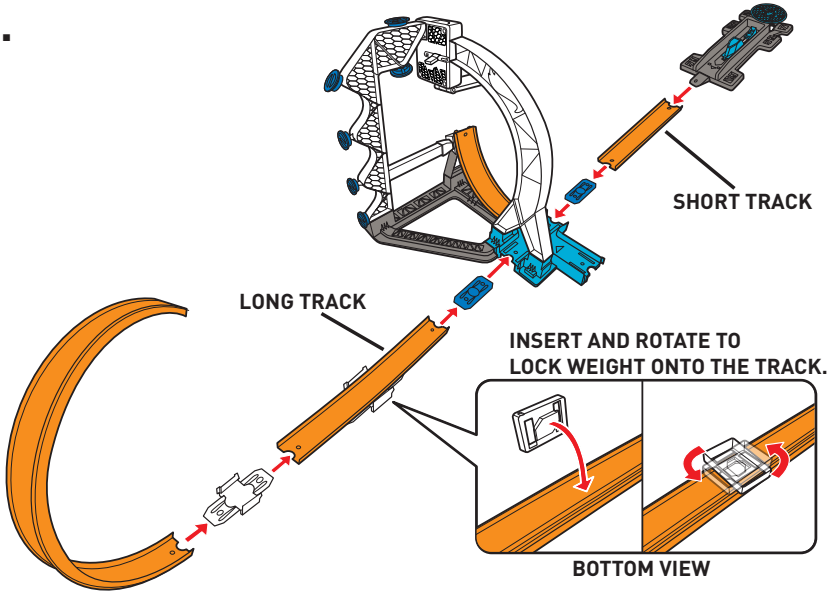

2. SLIDE TRACK THROUGH TWO PIVOT POINTS.

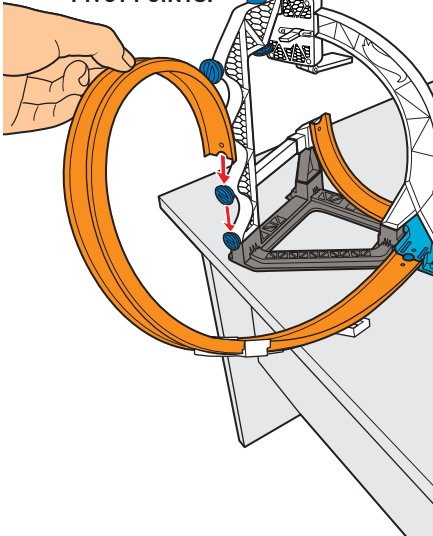

3.

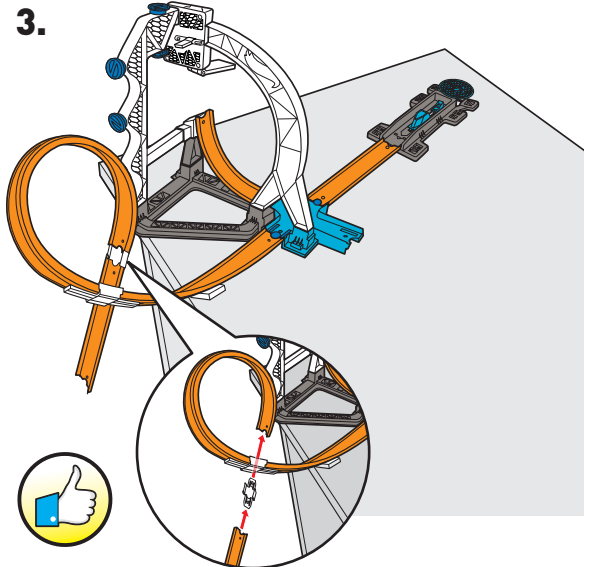

# NOW GRAB YOUR CAR AND GO!

 EXPERIMENT WITH HEIGHT  
- HOW MUCH OF DROP DO  
YOU NEED?

SHORT TRACK

PUT LAUNCHER ON THE FLOOR  
AND ALIGN IT WITH THE TRACK.

4-SPEED LAUNCHER!

LOCK LAUNCHERS BACK AND LOAD CARS.

NOTE: PLAY ON CARPET TO PROTECT  
YOUR CARS FROM DAMAGE.

CAN YOU NAIL  
THE LANDING?

LAUNCH ANOTHER  
CAR INTO ACTION!

KEEP TRYING TILL YOU MAKE IT!

# HERE'S WHAT'S COOL!

PIVOT POINTS allow you to connect your track in any direction!

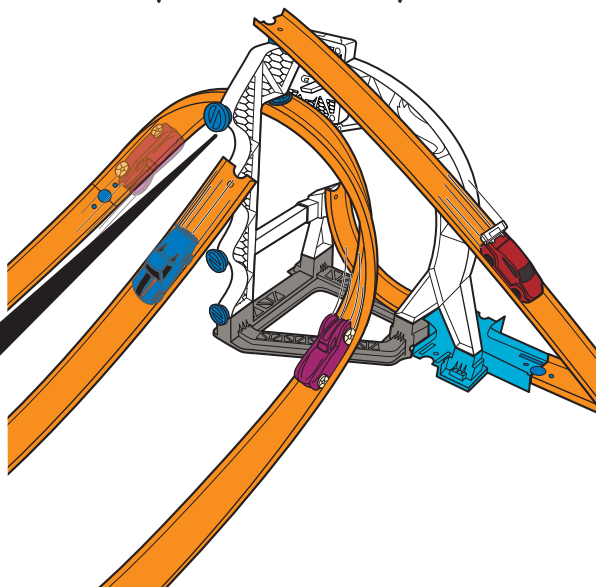

DID YOU SEE INSIDE THE BOX?

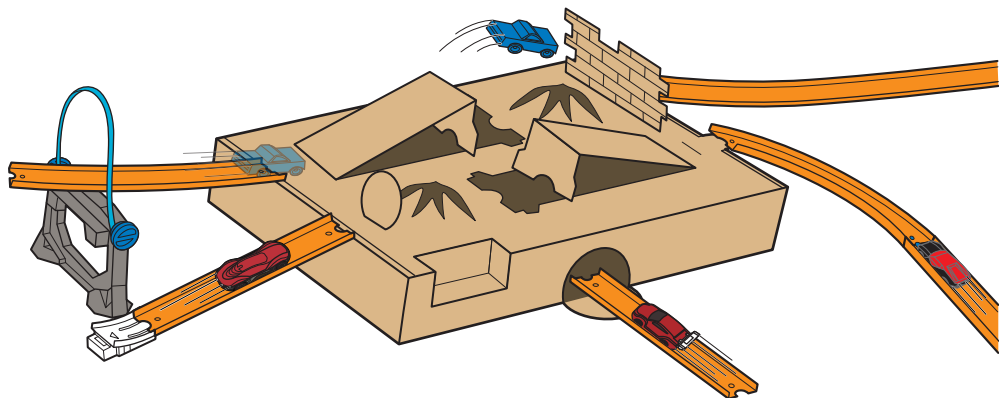

NOW THAT'S WHAT I CALL A HOT WHEELS HACK!



FOR MORE COOL HOT WHEELS HACKS, VISIT  
[WWW.HOTWHEELS.COM/TRACKBUILDER](http://WWW.HOTWHEELS.COM/TRACKBUILDER)

# WHAT IF.....?

THE KEY TO A RAD STUNT IS IN YOUR HOME ALREADY:

CREATE A CHAIN REACTION LAUNCH!

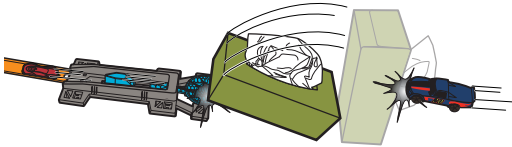

NAIL A DROP!

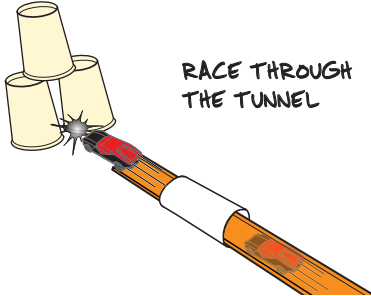

RACE THROUGH THE TUNNEL

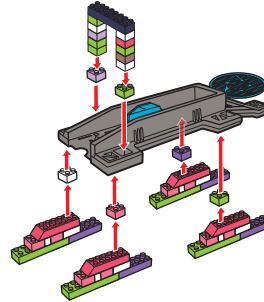

USE YOUR BRICKS FOR AWESOME TRICKS!

IMAGINE WHAT YOU COULD DO WITH THE TRACK BUILDER SYSTEM!



FOR MORE EPIC TRACK IDEAS VISIT  
[WWW.HOTWHEELS.COM/TRACKBUILDER](http://WWW.HOTWHEELS.COM/TRACKBUILDER)

# HERE'S WHAT ELSE YOU CAN GET:

## ADVERTISEMENT

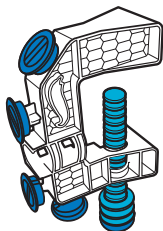

**DLF03**  
**CLAMP IT!**

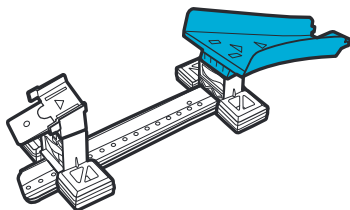

**DLF05**  
**JUMP IT!**

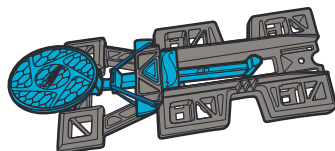

**DLF06**  
**LAUNCH IT!**



**DLF02**  
**HANG IT!**

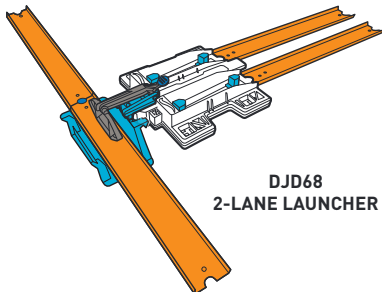

**DJD68**  
**2-LANE LAUNCHER**

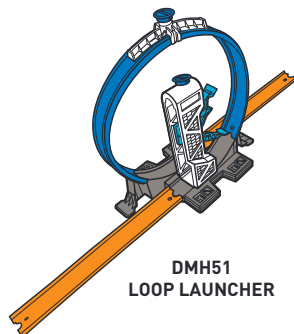

**DMH51**  
**LOOP LAUNCHER**

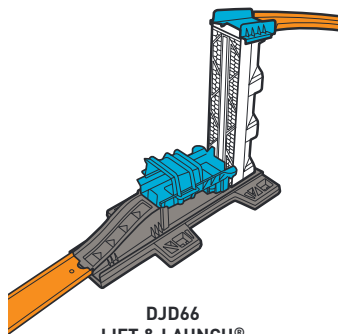

**DJD66**  
**LIFT & LAUNCH®**

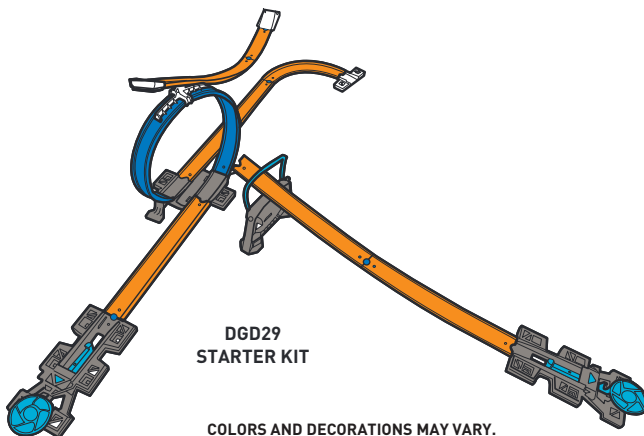

**DGD29**  
**STARTER KIT**

COLORS AND DECORATIONS MAY VARY.  
EACH SOLD SEPARATELY, SUBJECT TO AVAILABILITY.