

Battery Replacement

Replace batteries when sound becomes distorted or lights become faint, and any play mode does not work properly. To replace batteries, use a Phillips head screwdriver (not included) to open battery covers. Insert 3 new AG13 (LR44) button cell batteries as shown. Use either AG13 (LR44) button cell batteries or equivalent. Replace battery covers and tighten screws. When exposed to an electrostatic source, the product may malfunction. If this problem occurs, reset the product by reinstalling the batteries.

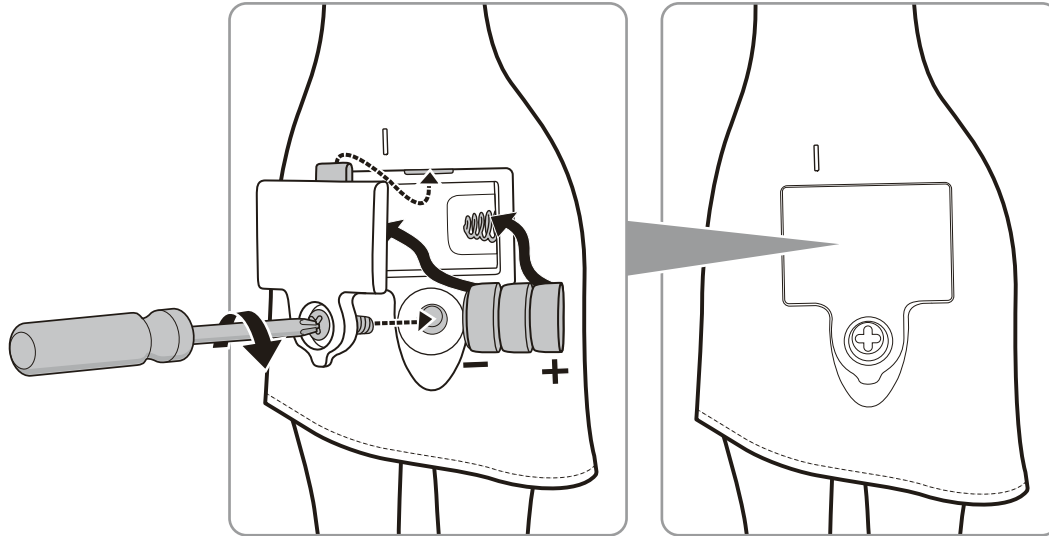

Batteries included are for demonstration purposes only.

For longer life use alkaline batteries.

Note: The product is equipped with an automatic shut-off feature that helps preserve battery life.

CONSUMER INFORMATION

Need Assistance? Visit service.mattel.com or call 1-800-524-8697 (US and Canada only).

SERVICE.MATTEL.COM

Mattel East Asia Ltd., Room 503-09, North Tower, World Finance Centre, Harbour City, Tsimshatsui, HK, China. Tel.: (852) 3185-6500.
Diimport & Diedarkan Oleh: Mattel Southeast Asia Pte. Ltd., No 19-1, Tower 3 Avenue 7, Bangsar South City, No 8, Jalan Kerinchi, 59200 Kuala Lumpur, Malaysia. Tel: 03-78803817, Fax: 03-78803867.

MONSTER HIGH

6+



INSTRUCTIONS

CONTENTS

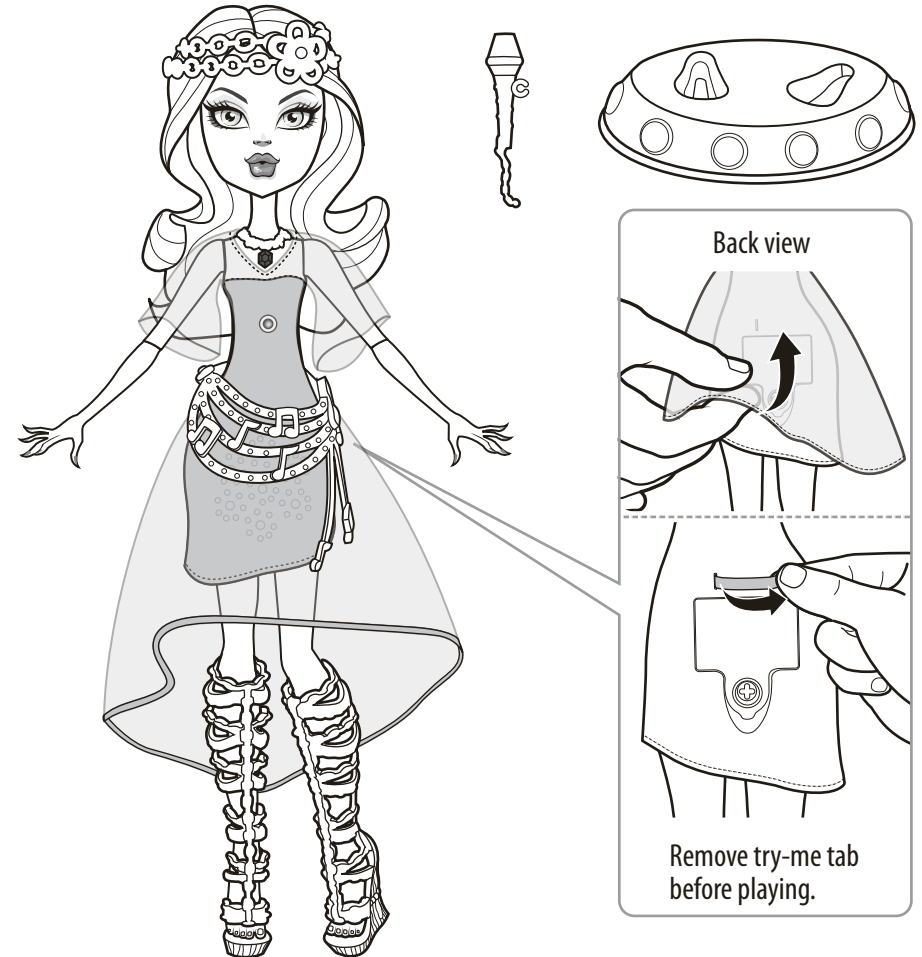

WARNING:
CHOKING HAZARD – Small parts.
Not for children under 3 years.

Please remove everything from the package and compare to the contents shown here. If any items are missing, please contact your local Mattel office. Keep these instructions for future reference as they contain important information.

ASSEMBLY

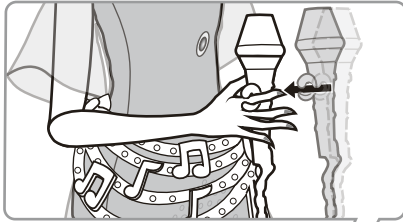

Sensor

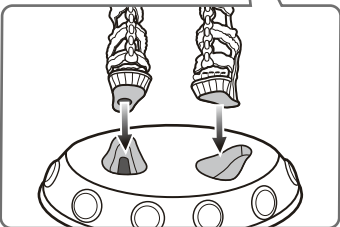
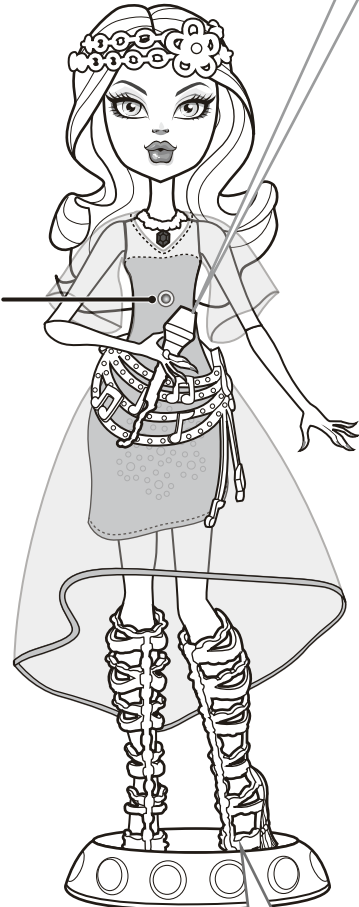

As you press the diamond, the 4 modes begin in sequential order.

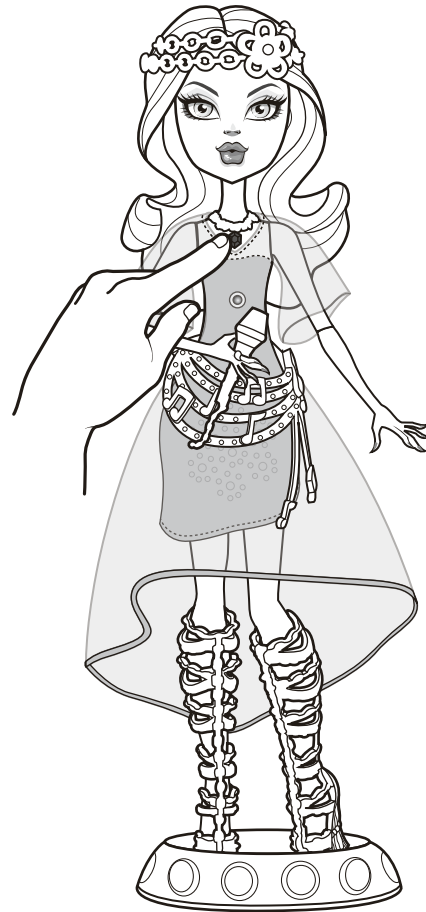

LET'S PLAY!

1. First press: performance mode with lights!
2. Second press: light-effects only mode!

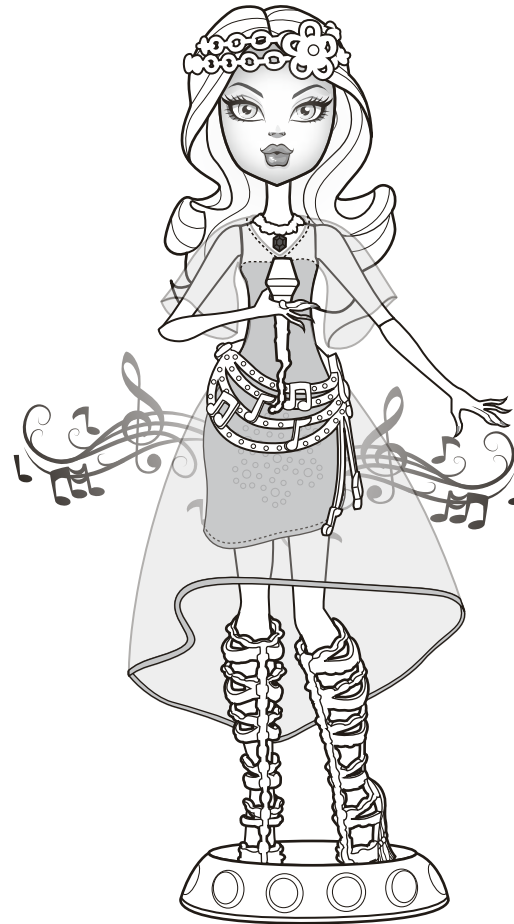

Note:No interactivity in these two modes.

3. Third press: warm-up mode with lights!
4. Fourth press: rehearsal mode with lights!

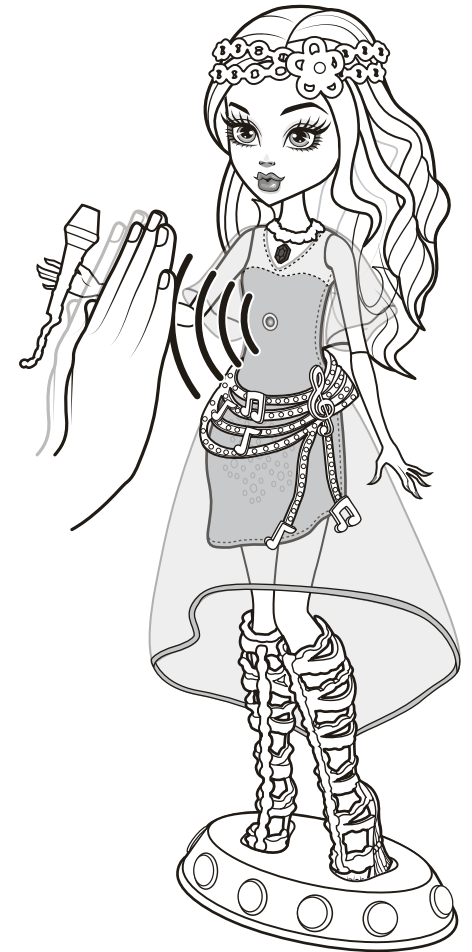

Note:Voice gets louder & lights get brighter as your hand gets closer to the sensor.