



COLOSSAL BLITZ™

8+

INSTRUCTIONS!
BOOM-CO.COM

Please keep these instructions for future reference as they contain important information. Colors and decorations may vary.

1 CONTENTS

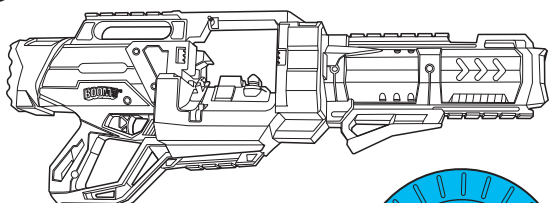

x72

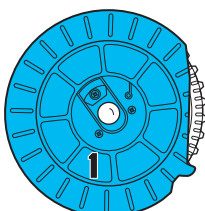

1

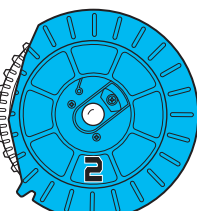

2



x6 C (LR14)

ALKALINE BATTERIES REQUIRED

NOT INCLUDED

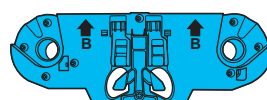

B

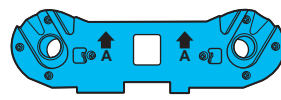

A

WARNING: Do not aim at eyes or face. Only use projectiles supplied with this toy. Do not fire at point blank range.

TO AVOID INJURY: Do not modify rounds, darts, or dart blaster. Always wear appropriate eye-wear, sold separately.

2 ASSEMBLY

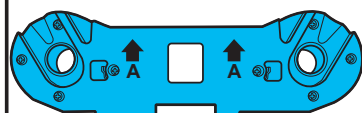

A

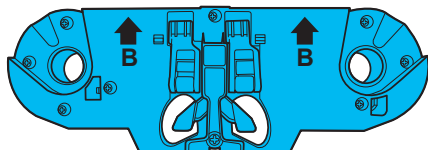
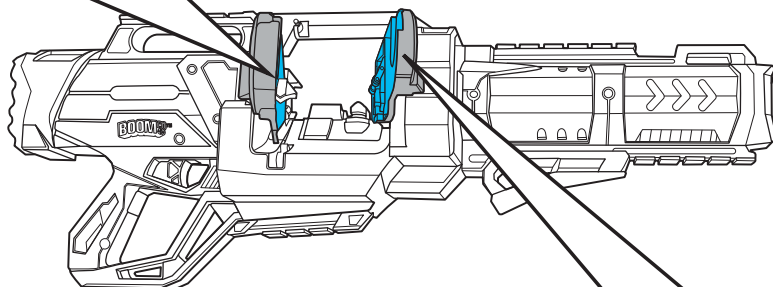
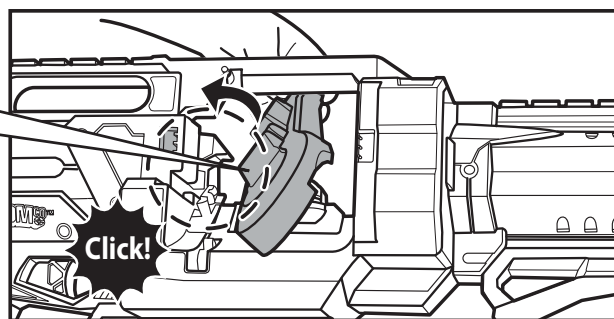
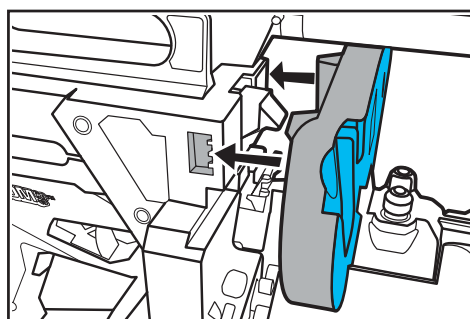

B

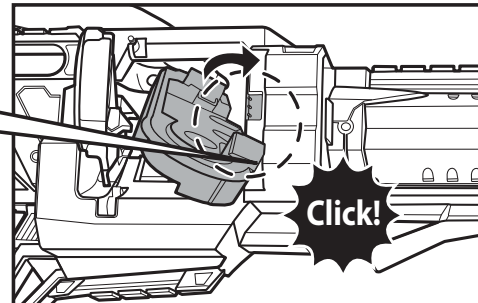
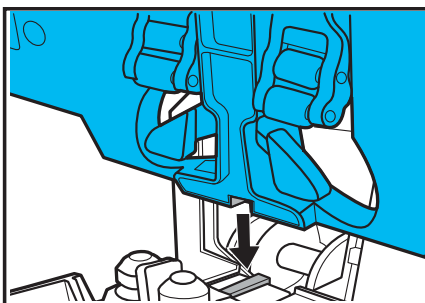

3 BATTERY INSTALLATION

- Requires 6 C (LR14) alkaline batteries (not included).
- Unscrew the battery cover with a Phillips head screwdriver (not included).
- Install 6 new C (LR14) alkaline batteries in the orientation (+/-) shown.
- Replace battery cover and tighten screws.
- Replace batteries if motor slows down.
- For best performance, use alkaline batteries.

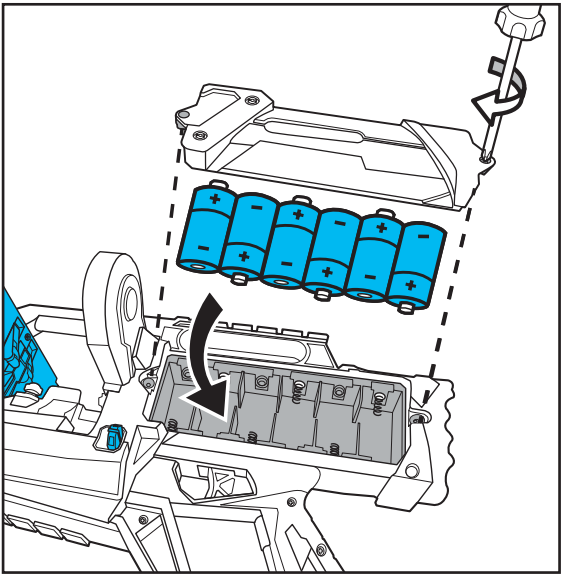

4 LOADING DRUMS

Fully load both drums with darts.

IMPORTANT:
Push darts all the way down.

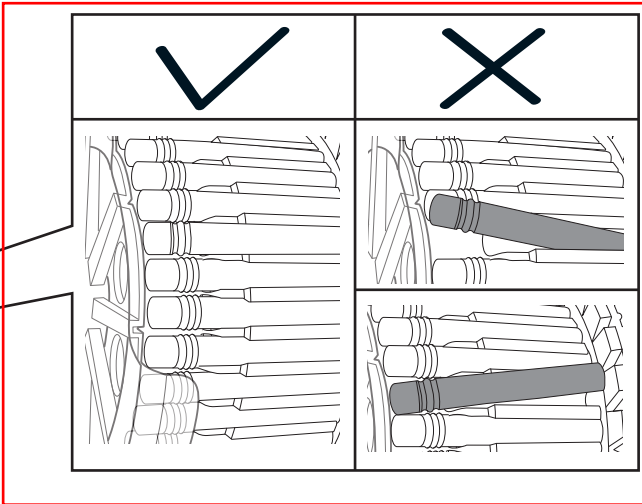
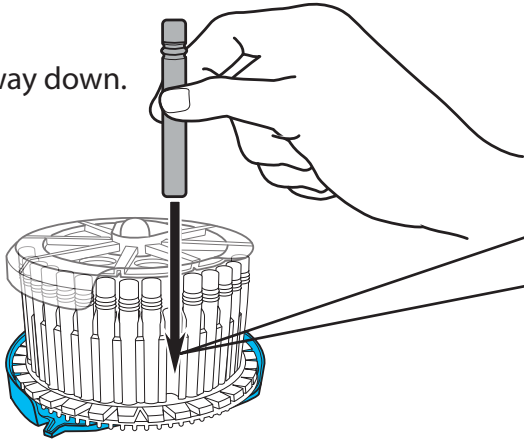

5 ATTACHING DRUMS TO BLASTER

Align the arrows on the drums and blaster. Push drums in to attach.

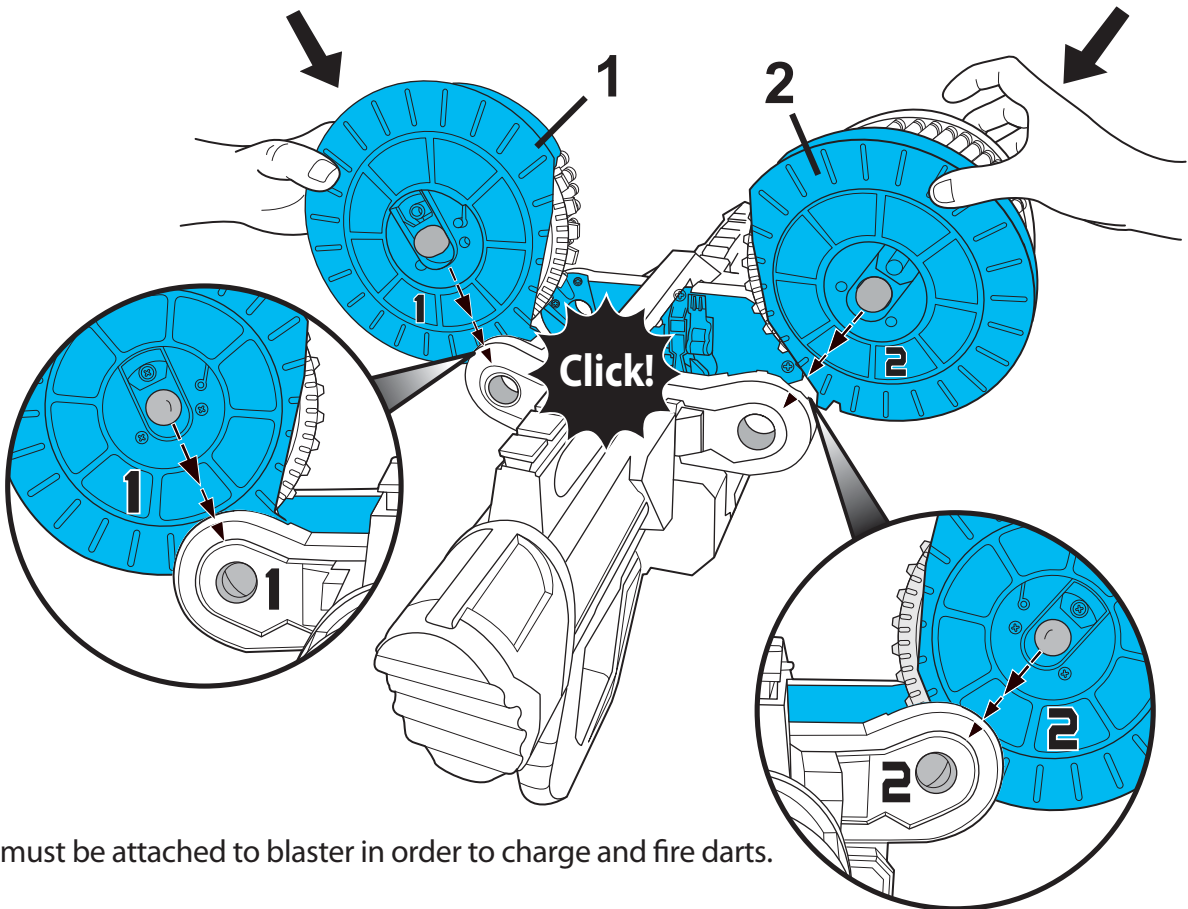

NOTE: Drums must be attached to blaster in order to charge and fire darts.

6 SINGLE-FIRE

A. Flip switch to single-fire position (□□□).

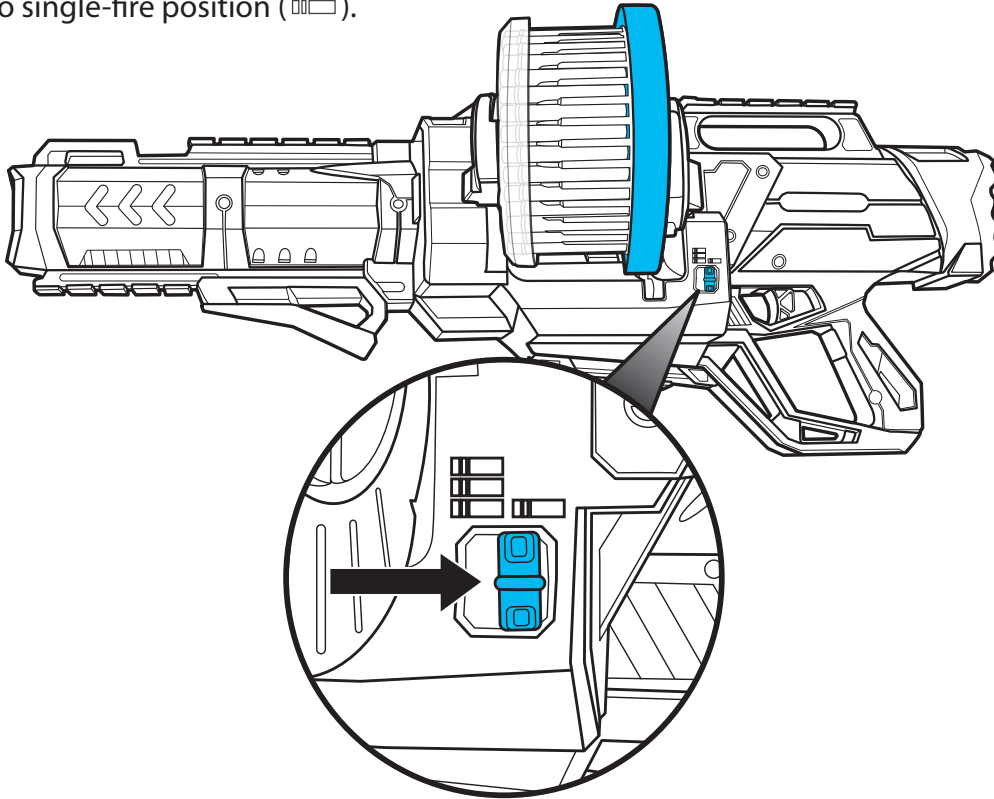

B. Hold button to charge motor. **Pull and release trigger** for single-fire.

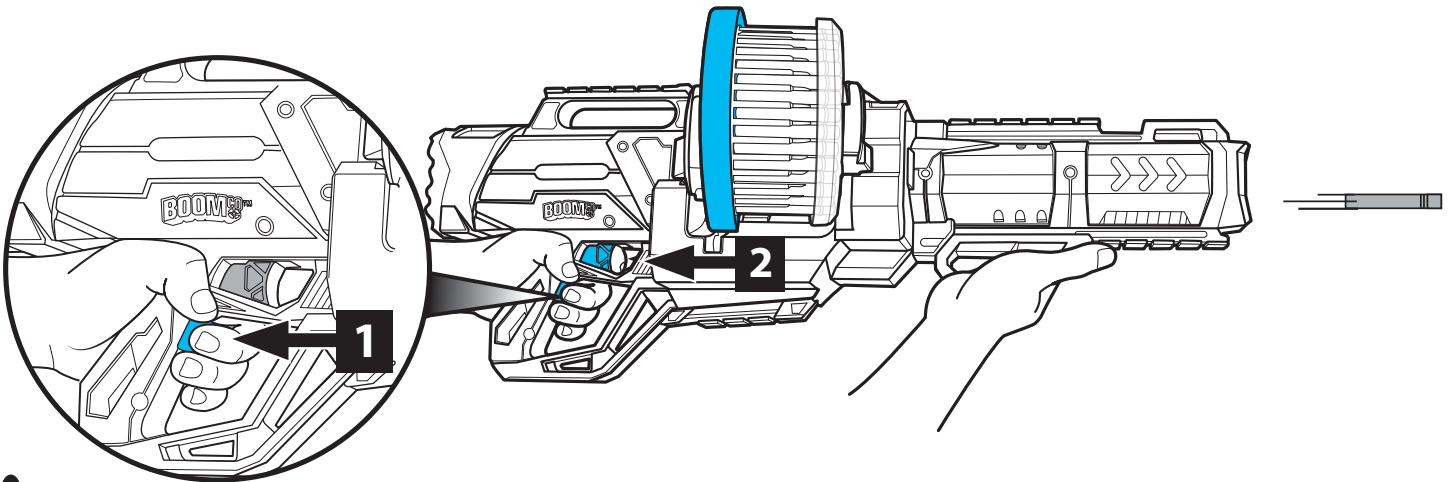

NOTE: Darts can also be loaded when drums are on the blaster during **SINGLE-FIRE MODE** (□□□).

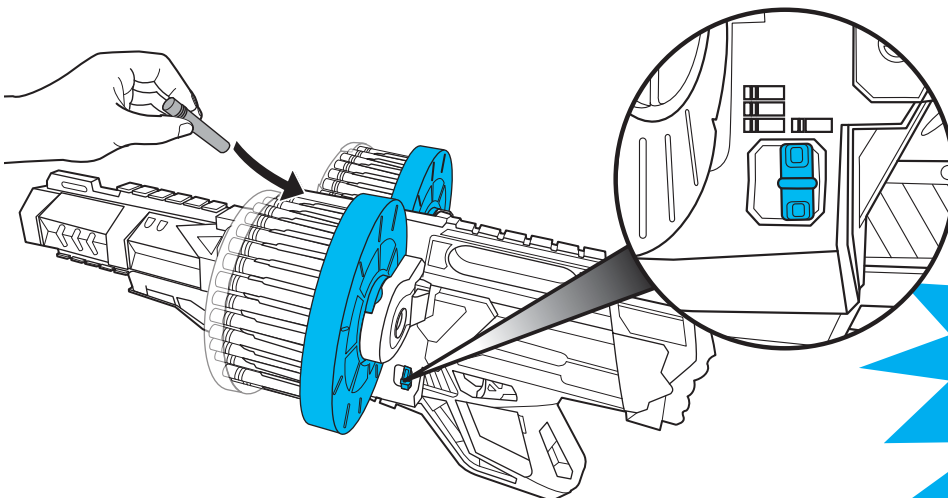

**ONLY LOAD DARTS
WHEN BLASTER IS IN
SINGLE-FIRE MODE!**

7 RAPID-FIRE

A. Flip switch to rapid-fire position ().

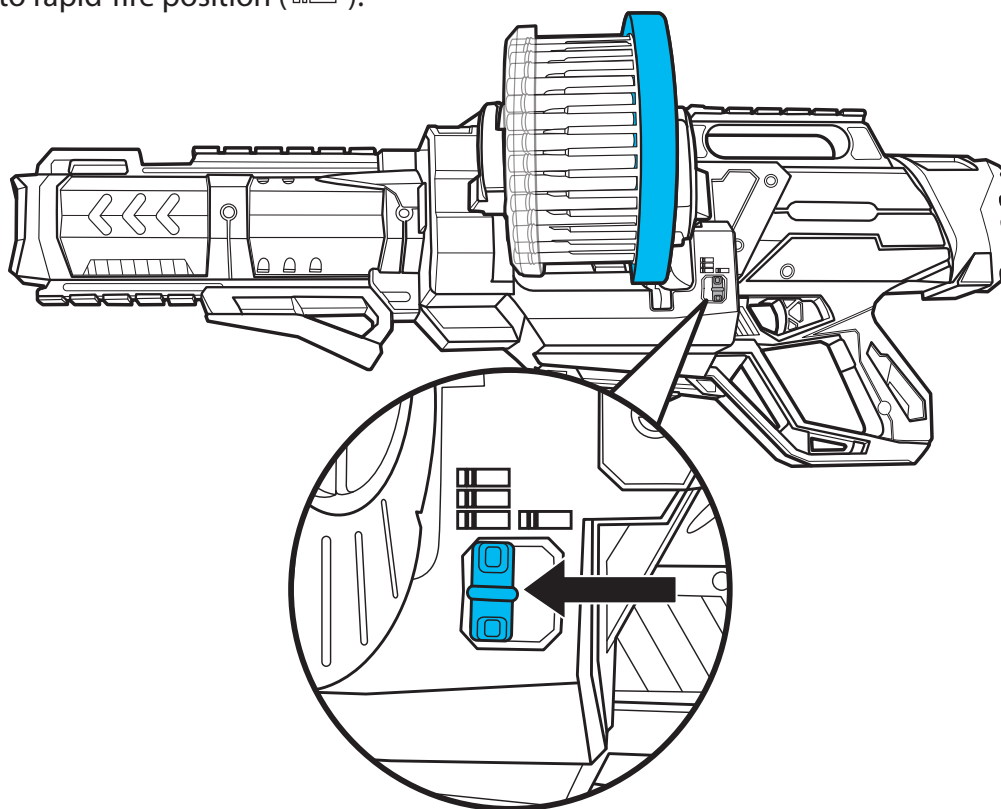

B. Charge blaster. **Pull and hold trigger** for rapid-fire.

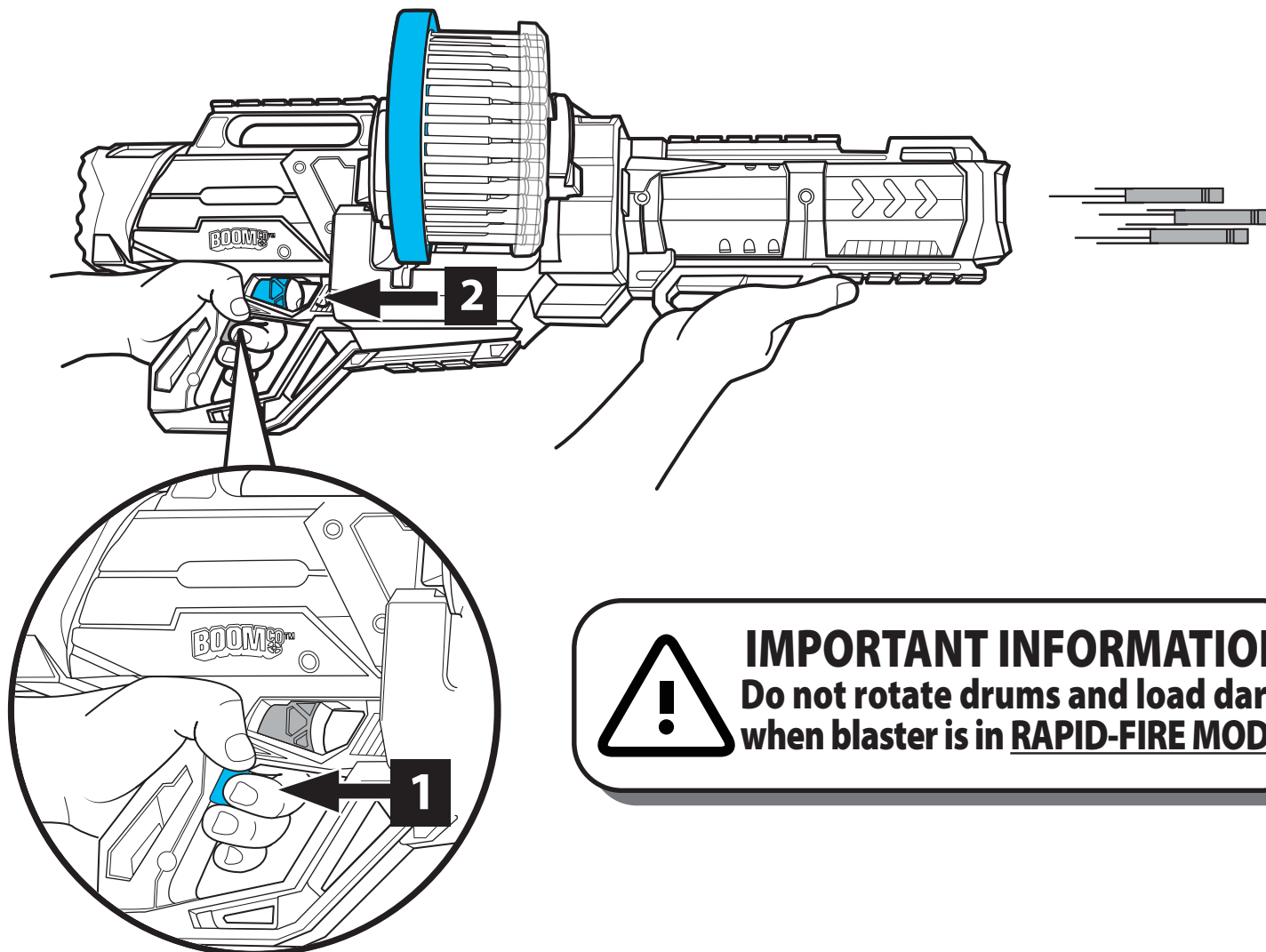

IMPORTANT INFORMATION
Do not rotate drums and load darts
when blaster is in RAPID-FIRE MODE.

PERFORMANCE TIPS

A. Blaster may be jammed if it is loaded but will not fire. To clear a jam:

Press buttons and pull drums out...

... then remove the jammed dart.

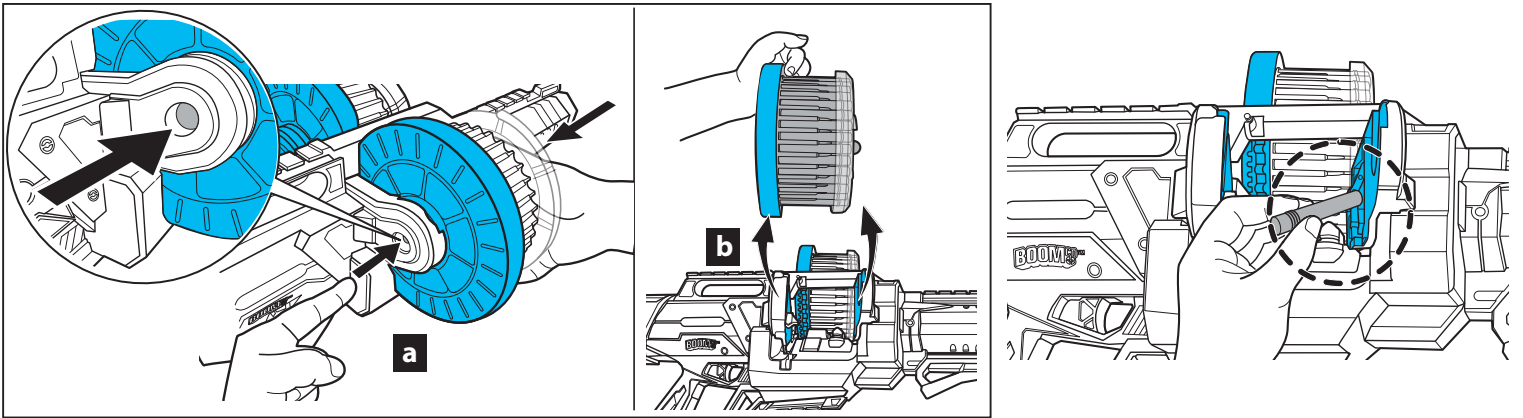

B. For best performance, periodically use tape (not included) to clean and remove dust and other debris from dart rollers.

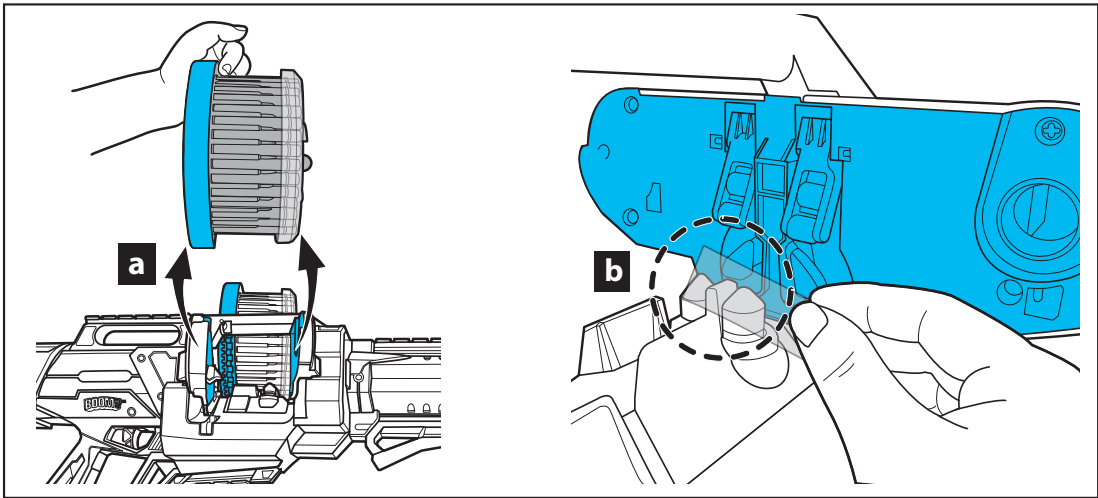

C. When reloading while the drums are on the blaster, the blaster **MUST** be in **SINGLE-FIRE MODE** (□□□).

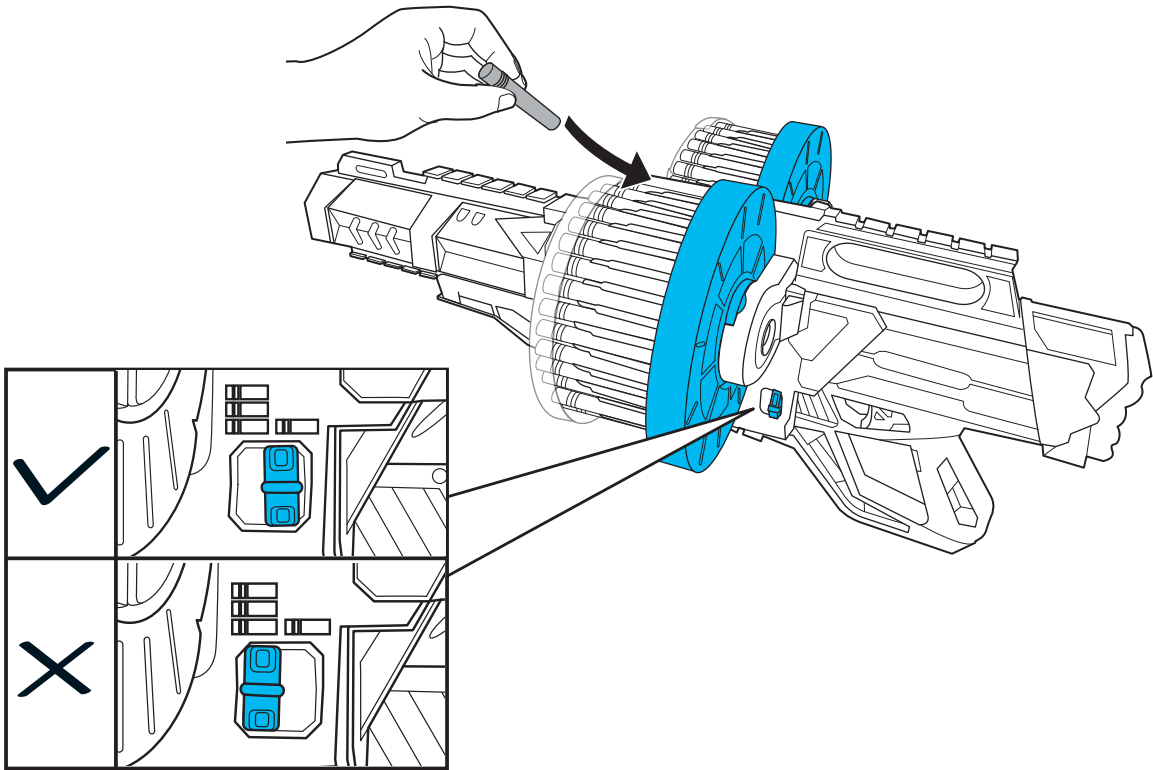

ATTACHING TARGETS

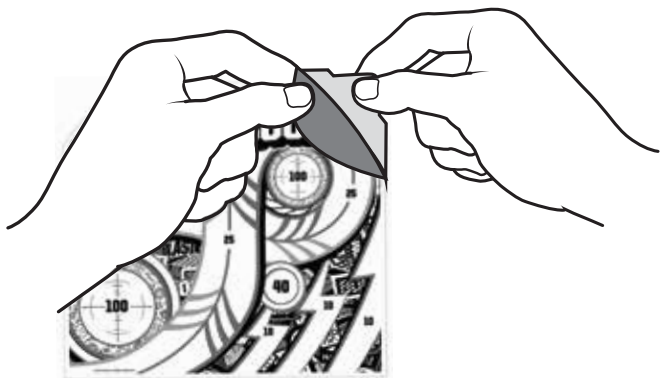

Peel backing off target before sticking it to surface.

✗ **Do not stick target to walls or furniture as it may cause damage to the surface.**

CLEANING DARTS

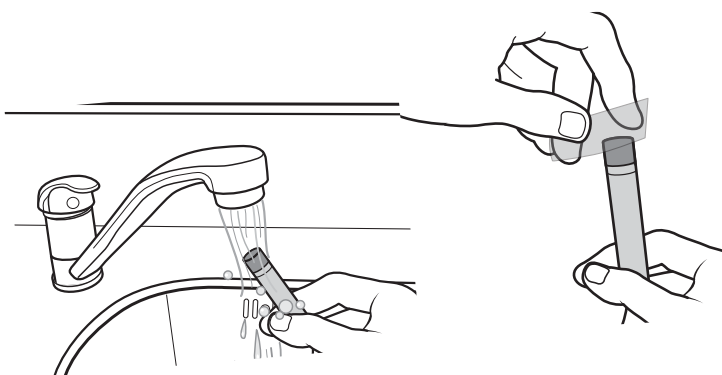

REMOVING DARTS

Keep one hand pressed on target, hold dart by the tip and gently peel dart off.

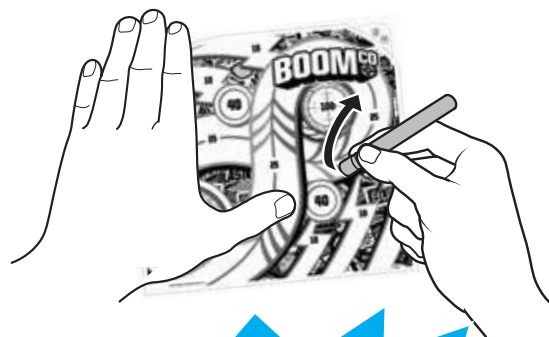

REMOVE DARTS IMMEDIATELY TO MAINTAIN SMART STICK™ TECHNOLOGY !

Dust, dirt, and other debris can cause darts to lose their adhesiveness.

To clean darts, rinse darts' tips with tap water or use tape to remove excess debris.

NOTE: Dry darts before using again.

BATTERY SAFETY INFORMATION

In exceptional circumstances batteries may leak fluids that can cause a chemical burn injury or ruin your product.

To avoid battery leakage:

- Non-rechargeable batteries are not to be recharged.
- Rechargeable batteries are to be removed from the product before being charged.
- Rechargeable batteries are only to be charged under adult supervision.
- Do not mix alkaline, standard (carbon-zinc), or rechargeable (nickel-cadmium) batteries.
- Do not mix old and new batteries.
- Only batteries of the same or equivalent type as recommended are to be used.
- Batteries are to be inserted with the correct polarity.
- Exhausted batteries are to be removed from the product.
- The supply terminals are not to be short-circuited.
- Dispose of battery(ies) safely.
- Do not dispose of this product in a fire. The batteries inside may explode or leak.



Protect the environment by not disposing of this product with household waste (2002/96/EC). Check your local authority for recycling advice and facilities.

©2015 Mattel. All Rights Reserved. Mattel, Inc., 636 Girard Avenue, East Aurora, NY 14052, U.S.A. Consumer Relations 1-800-524-8697. Mattel U.K. Ltd., Vanwall Business Park, Maidenhead SL6 4UB. Helpline 01628 500303. Mattel Australia Pty., Ltd., Richmond, Victoria. 3121. Consumer Advisory Service - 1300 135 312. Mattel East Asia Ltd., Room 503-09, North Tower, World Finance Centre, Harbour City, Tsimshatsui, HK, China. Diimport & Diedarkan Oleh: Mattel SEA Ptd Ltd.(993532-P) Lot 13.5, 13th Floor, Menara Lien Hoe, Persiaran Tropicana Golf Country Resort, 47410 PJ. Malaysia. Tel:03-78803817, Fax:03-78803867.



CFM91-0970G1
DPN15-0970G1
1100348308-DOM