

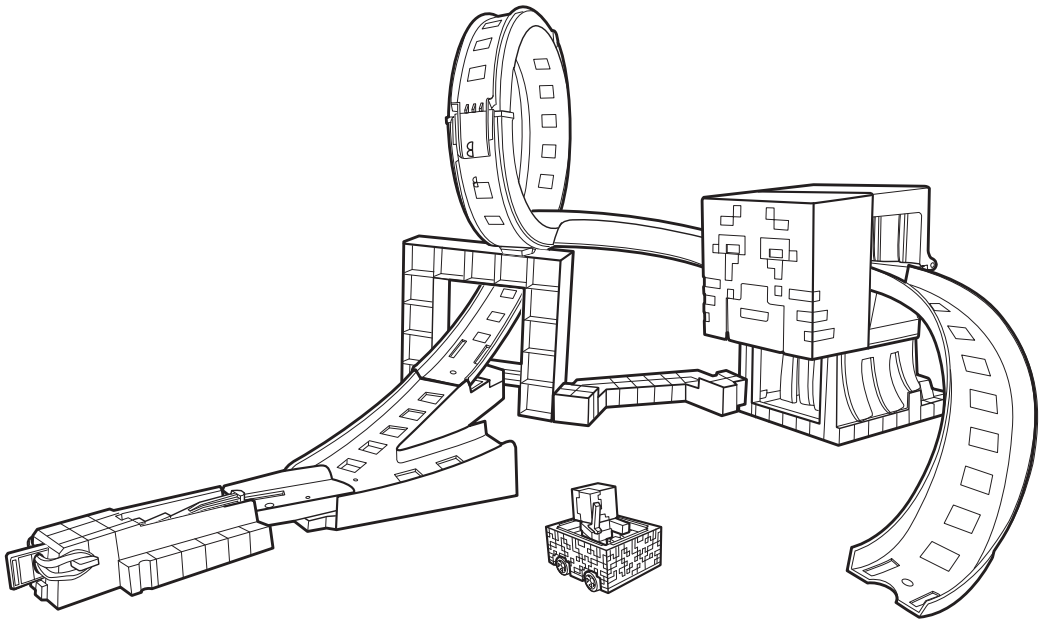

MINECRAFT

GHAST ATTACK TRACK®



4+  **MOJANG**

© & TM Notch Development AB and Mojang AB. All Rights Reserved.

service.mattel.com

HOTWHEELS.COM



WARNING:
CHOKING HAZARD - Small parts.
Not for children under 3 years.



DPW28-0970G1
1100923809-DOM

PLEASE KEEP THESE INSTRUCTIONS FOR FUTURE
REFERENCE AS THEY CONTAIN IMPORTANT INFORMATION.

CONTENTS

GHAST

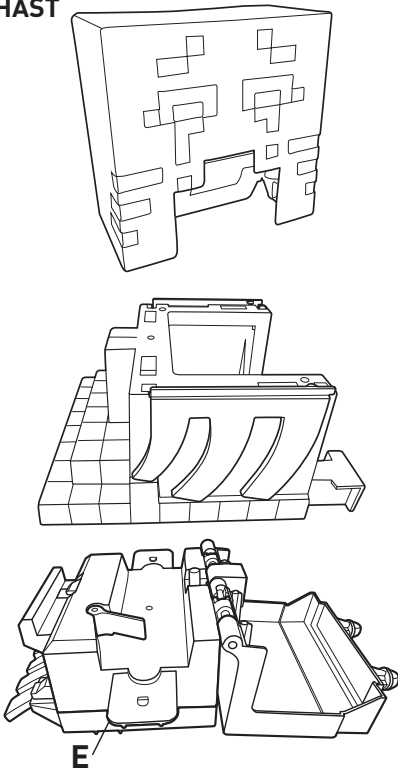

MINECART RAILS

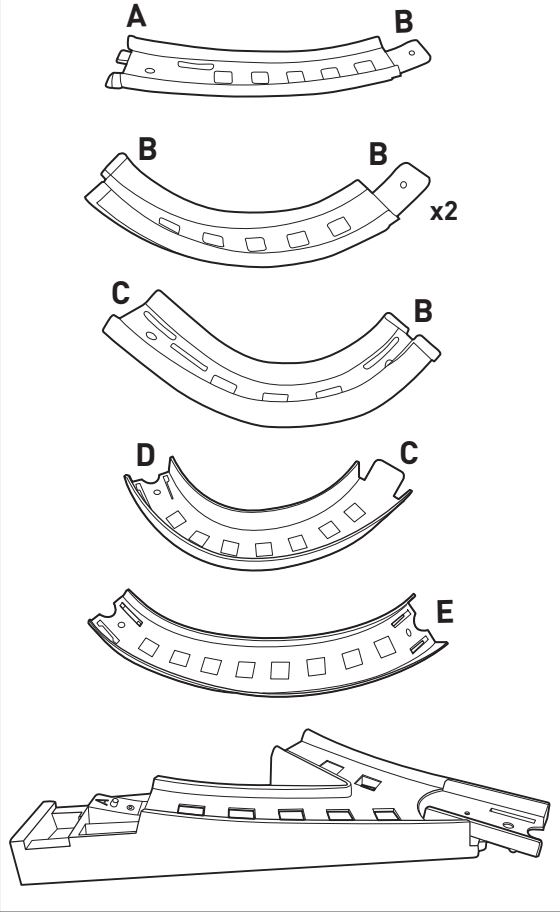

RAIL LOOP STAGE

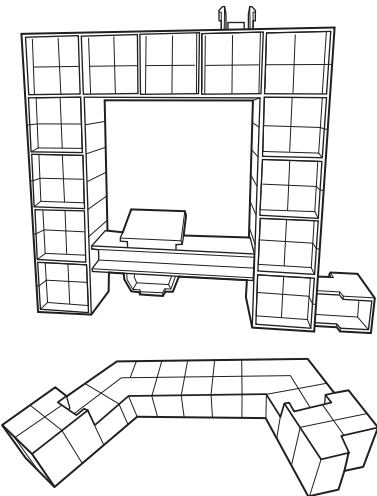

MINECART & FIGURE

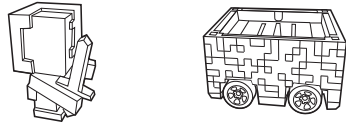

LAUNCHER

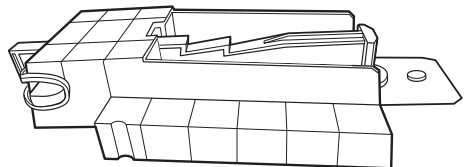

ASSEMBLY



Refer to letter on toy parts and contents page to help with assembly.

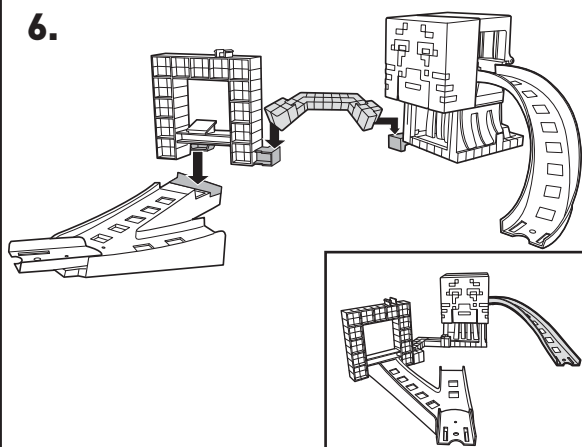
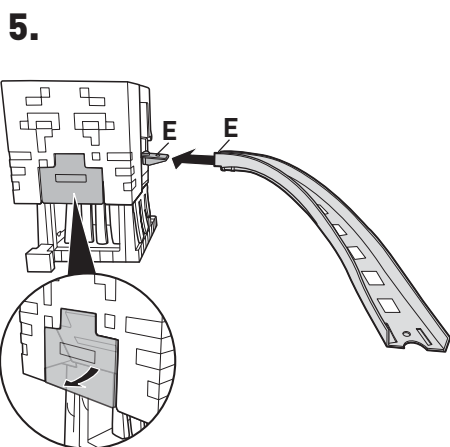
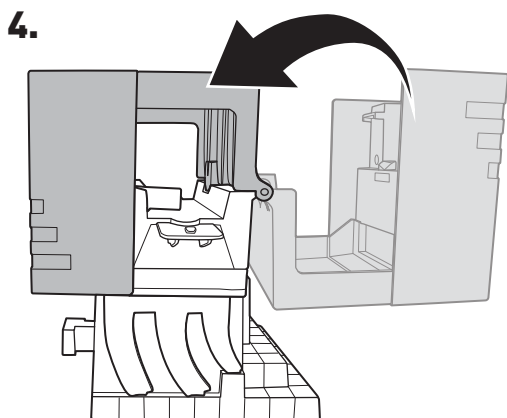
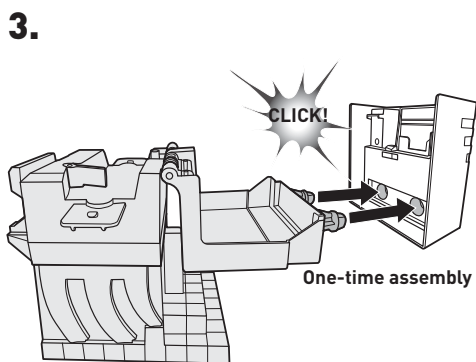
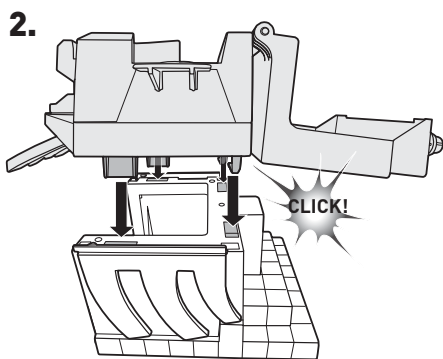
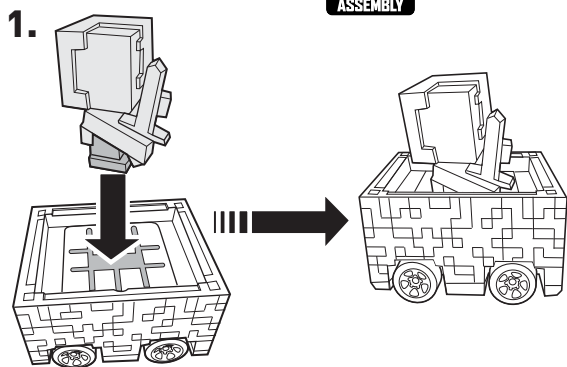

7.

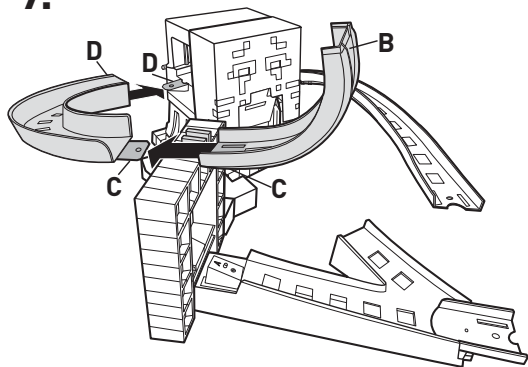

8.

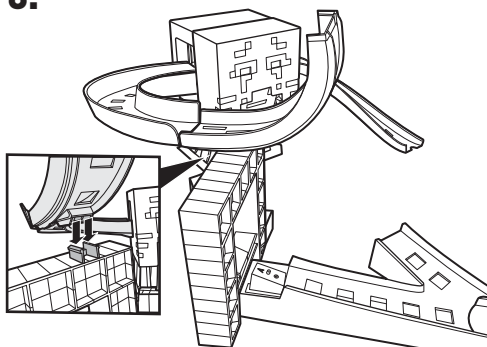

9.

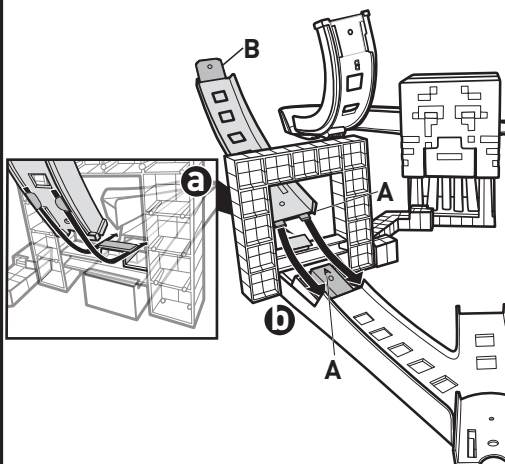

10.

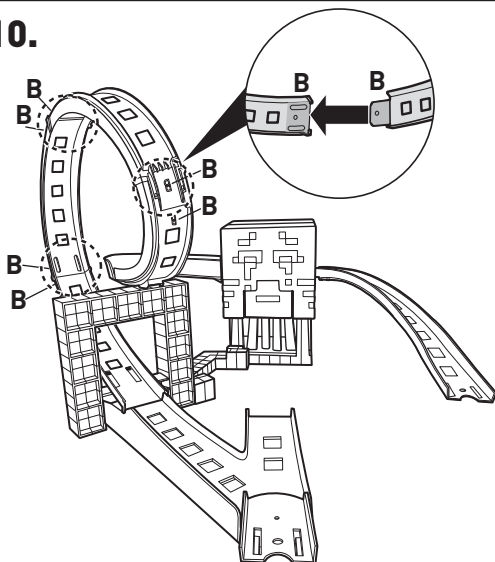

11.

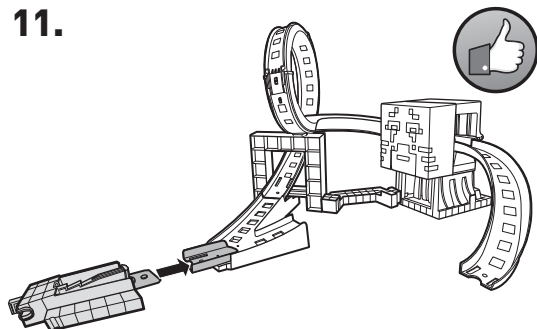

12. Connect to other HOT WHEELS® sets (sold separately).

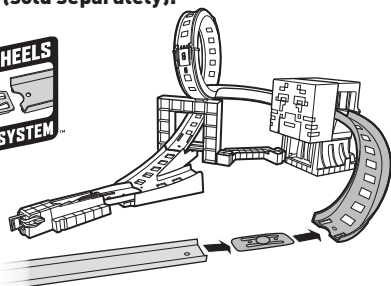

TO PLAY

- 1. MOVE LAUNCHER SO IT POINTS TO THE LEFT MINECART RAIL, LOAD MINECART AND PULL LAUNCHING ROD BACK TO LOCK IN PLACE.**

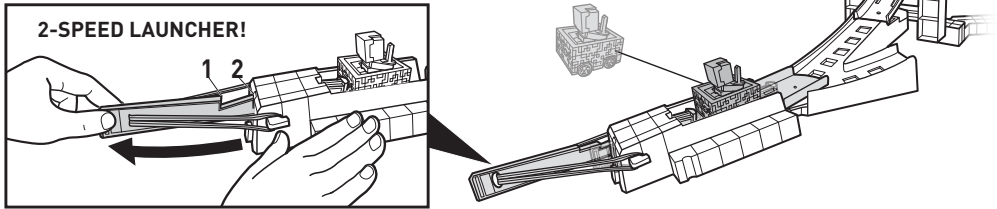

- 2. LAUNCH THROUGH THE LOOP AND GHAST TO WAKE IT UP!**

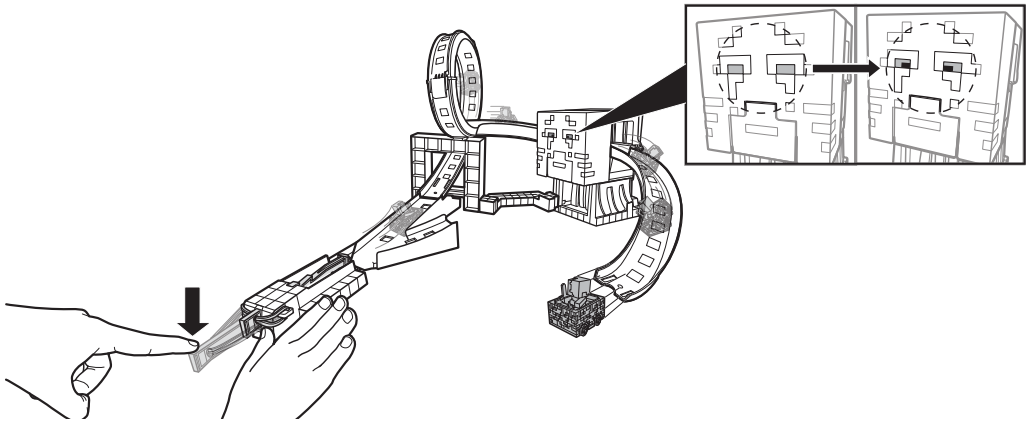

- 3. LAUNCH THROUGH THE LOOP AND GHAST AGAIN TO OPEN ITS MOUTH!**

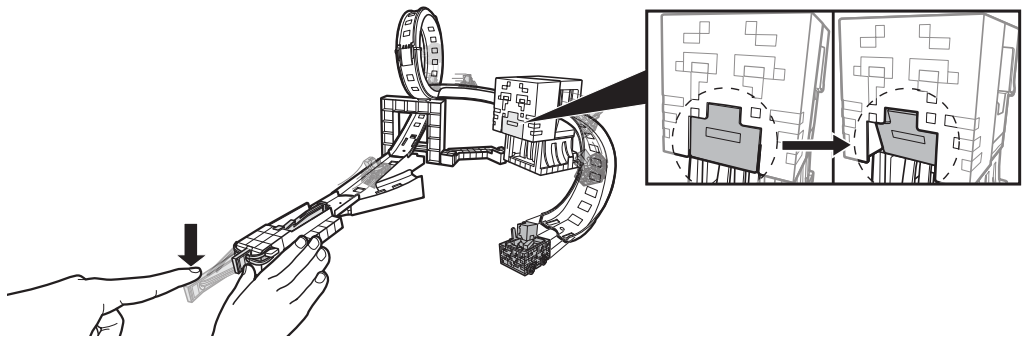

4. MOVE LAUNCHER SO IT POINTS TO THE RIGHT MINECART RAIL.

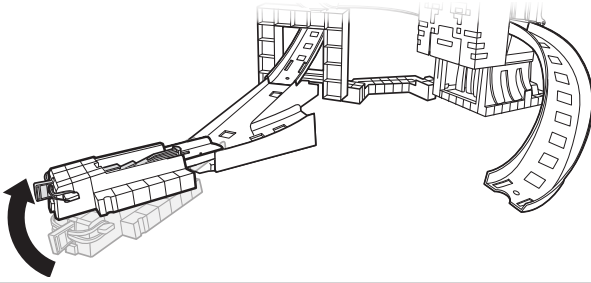

5. LAUNCH AND HIT THE OPEN MOUTH TO BLAST THE GHAST!

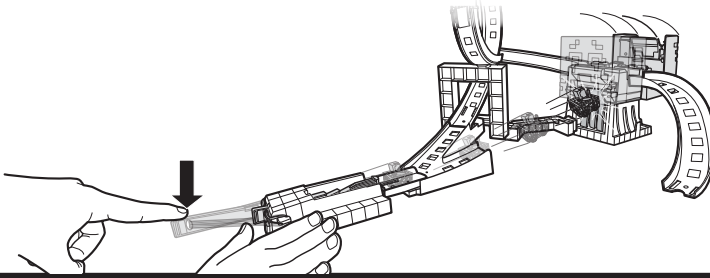

RESET

1.

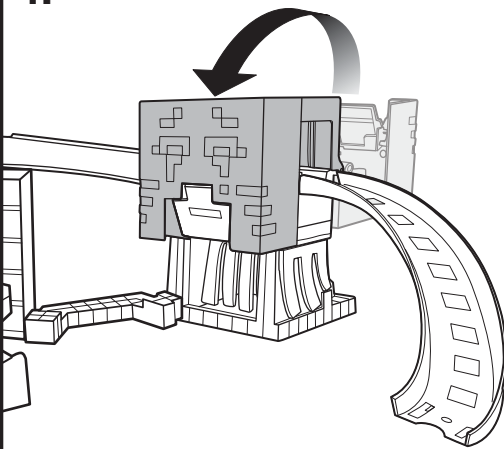

2.

