

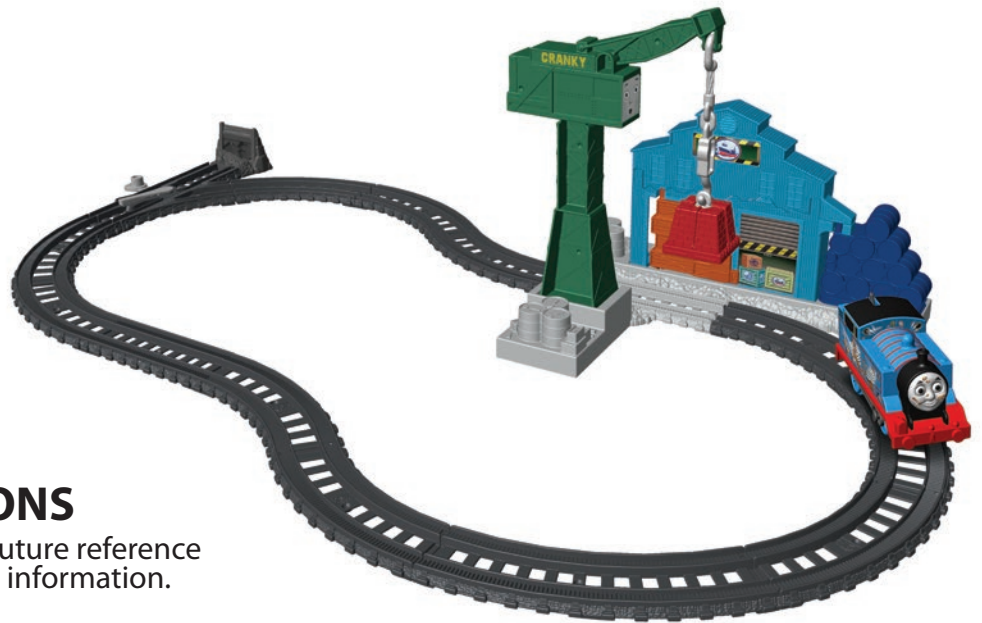

DEMOLITION AT THE DOCKS



INSTRUCTIONS

Keep these instructions for future reference as they contain important information.

WHAT'S INCLUDED

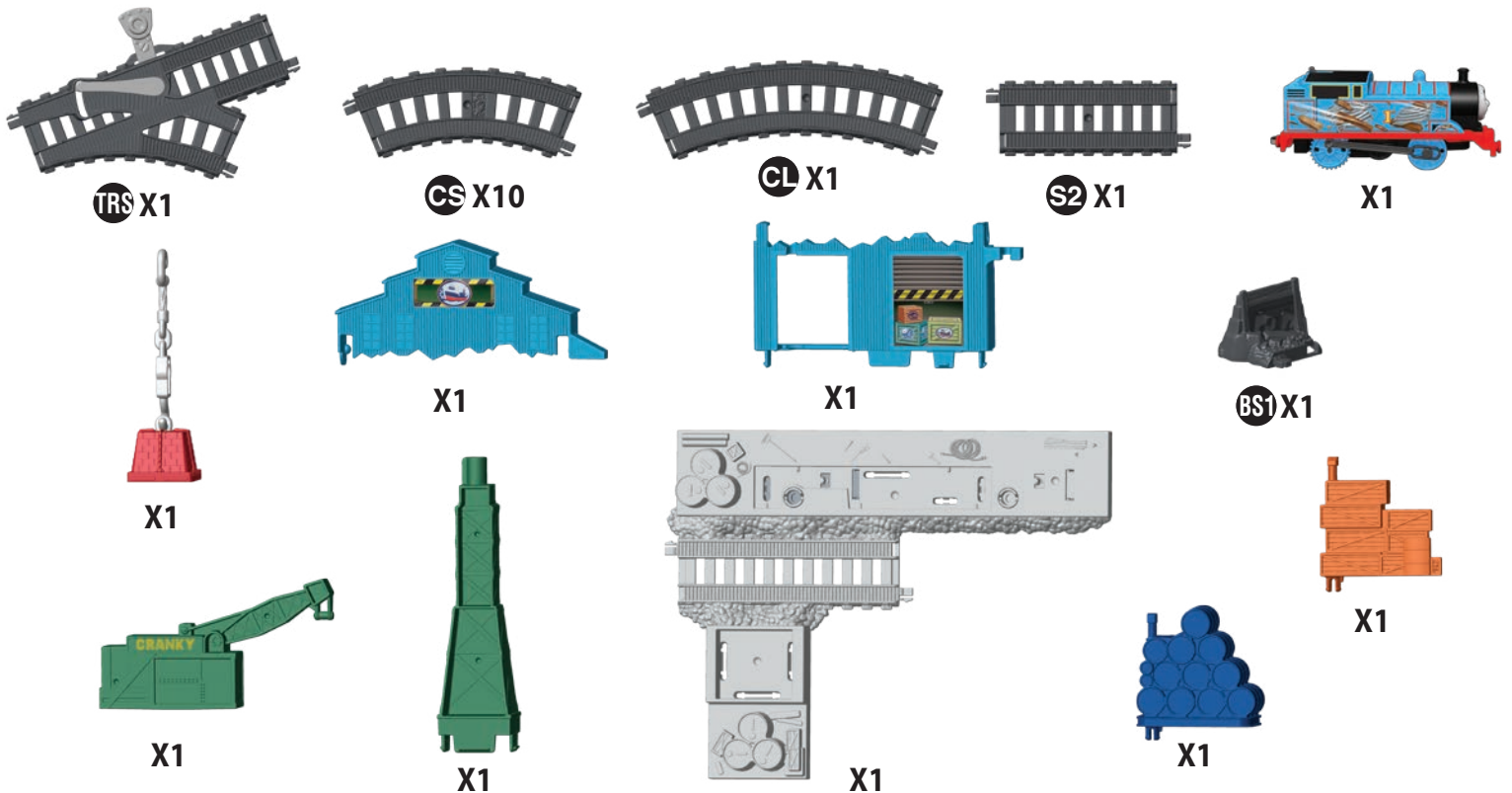

HELPFUL HINTS

★ ONE-TIME SNAPS: Assembly steps that are marked with a star are "one-time snaps". Once these parts are put together, they cannot be taken apart.



Track marking codes are found on the bottom of tracks.

ADULT ASSEMBLY REQUIRED. No tools needed.

Note: Some engines may not work on this track set.

ASSEMBLY

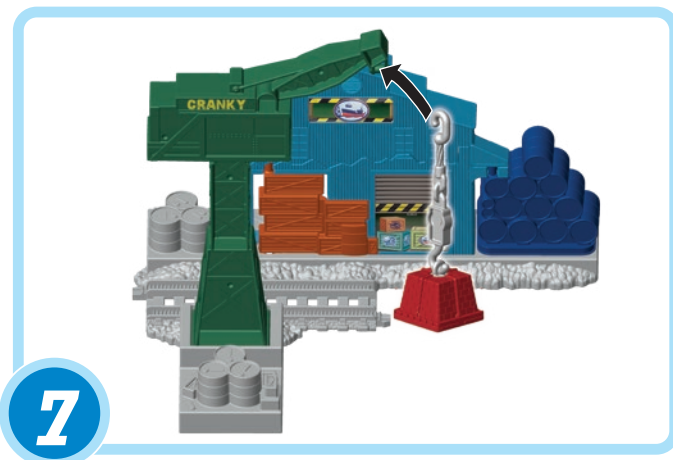
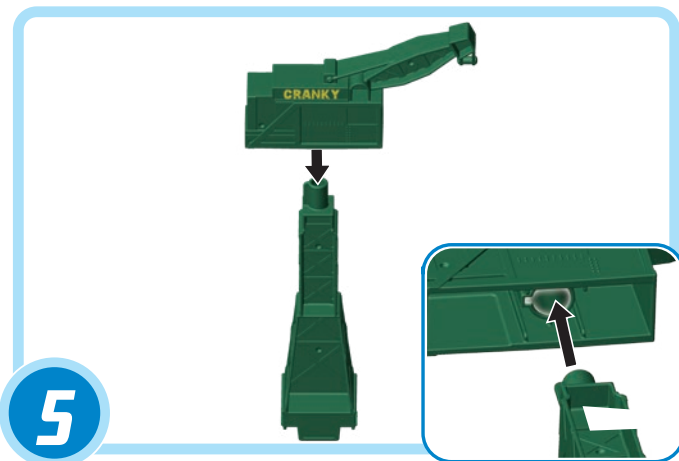
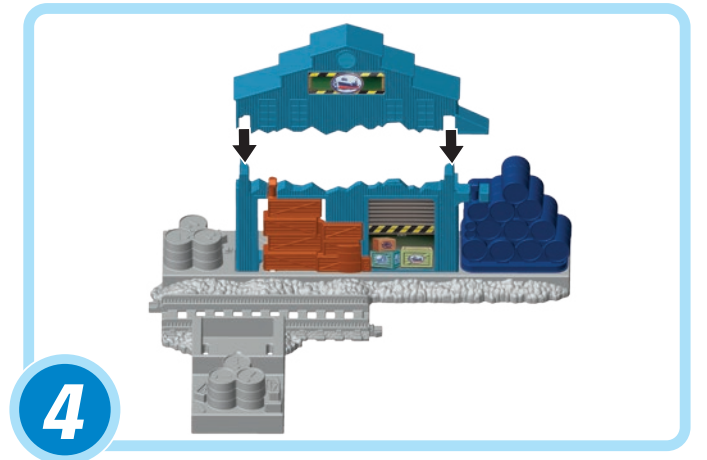
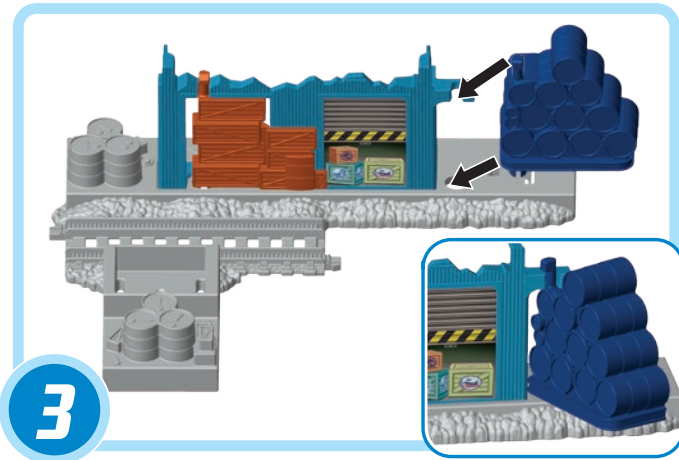
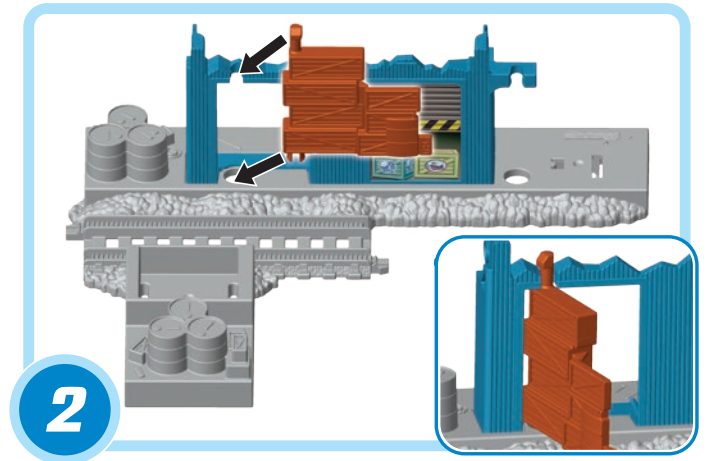
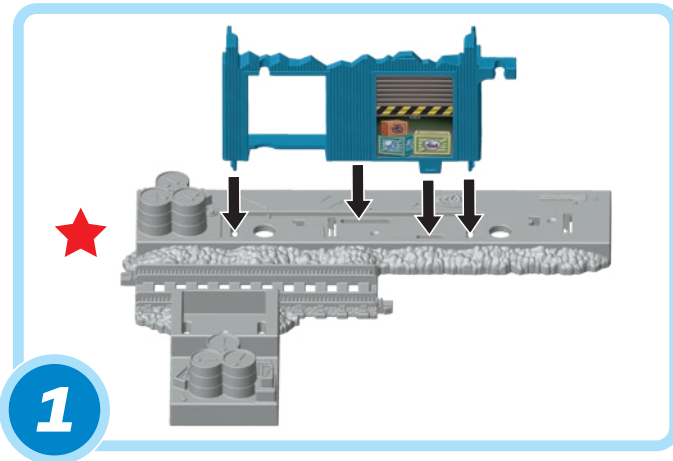

TRACK LAYOUT

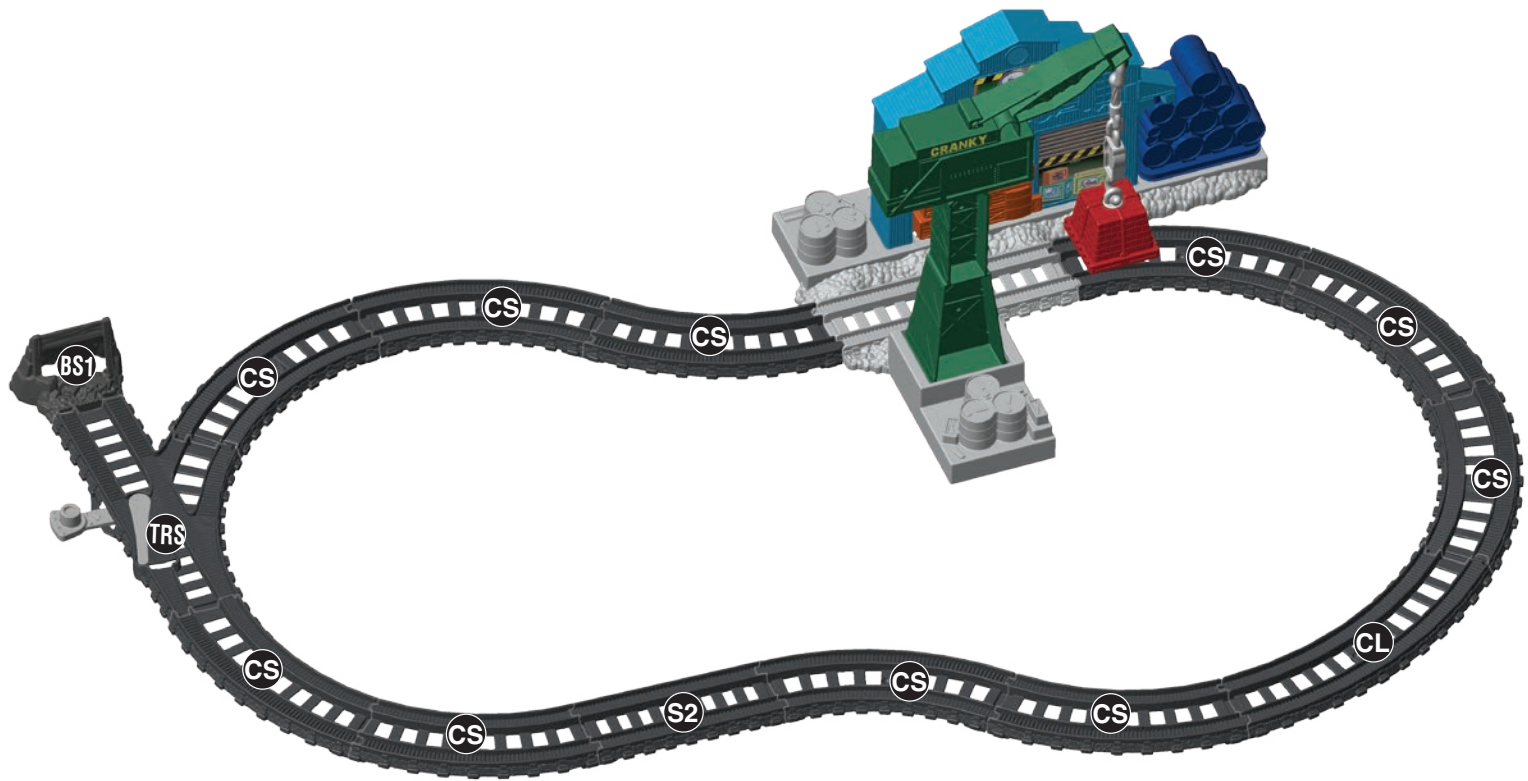

HOW TO PLAY

To set the warehouse, raise the roof, then move the gate into place, followed by the barrels, as shown.



Release the cargo and let it swing into the warehouse. As it bursts apart, Thomas can race through the wreckage.

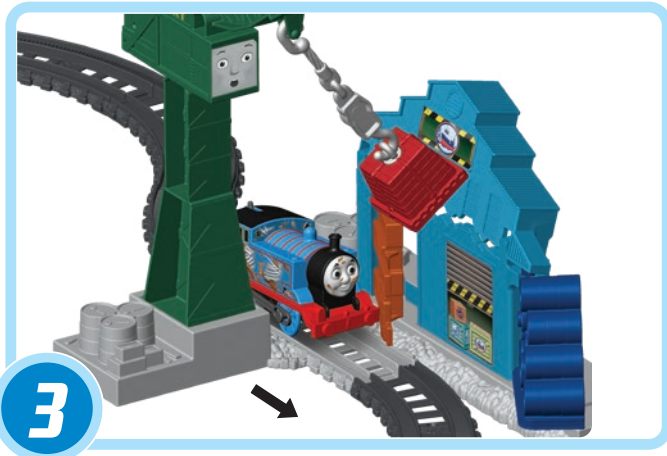

To knock down the warehouse, lift the cargo on Cranky's hook away from the building, as shown.



Note: Thomas can only race through the wreckage traveling around the set clockwise, in the direction of the arrow.

BATTERY INFORMATION

BATTERY INSTALLATION

Access the battery compartment by unscrewing and separating the top half of the engine from the bottom half of the engine. Install the batteries as indicated inside the battery compartment. Re-assemble the two halves of the engine, re-insert the screw and tighten. If the product begins to malfunction, check the battery installation. You may need to reset the electronics by removing the batteries and reinstalling them. If the product continues to malfunction or no longer operates, remove the batteries from the toy and replace them with fresh batteries. Requires 2 "AAA" (LR03) batteries.



Required tool: Phillips screwdriver (not included)

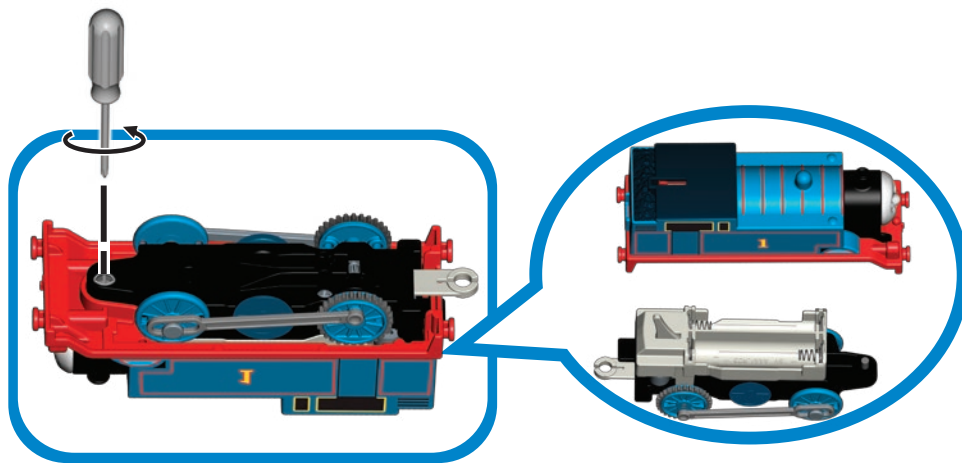

BATTERY SAFETY INFORMATION

In exceptional circumstances batteries may leak fluids that can cause a chemical burn injury or ruin your product. To avoid battery leakage:

- Non-rechargeable batteries are not to be recharged.
- Rechargeable batteries are to be removed from the product before being charged.
- Rechargeable batteries are only to be charged under adult supervision.
- Do not mix alkaline, standard (carbon-zinc), or rechargeable (nickel-cadmium) batteries.
- Do not mix old and new batteries.
- Only batteries of the same or equivalent type as recommended are to be used.
- Batteries are to be inserted with the correct polarity.
- Exhausted batteries are to be removed from the product.
- The supply terminals are not to be short-circuited.
- Dispose of battery(ies) safely.
- Do not dispose of this product in a fire. The batteries inside may explode or leak.



Protect the environment by not disposing of this product with household waste (2012/19/EU). Check your local authority for recycling advice and facilities.



CAUTION:

To prevent entanglement, keep hair away from wheels.



CONSUMER ASSISTANCE

1-800-432-5437 (US & Canada)
1300 135 312 (Australia)

service.fisher-price.com

Fisher-Price, Inc., 636 Girard Avenue, East Aurora, NY 14052.
Hearing-impaired consumers: 1-800-382-7470.

Outside the United States:

Canada: Mattel Canada Inc., 6155 Freemont Blvd.,
Mississauga, Ontario L5R 3W2; www.service.mattel.com.

Great Britain: Mattel UK Ltd, Vanwall Business Park,
Maidenhead SL6 4UB. Helpline: 01628 500303.
www.service.mattel.com/uk

Mattel Europa B.V., Gondel 1, 1186 MJ Amstelveen, Nederland.

Australia: Mattel Australia Pty. Ltd., 658 Church Street,
Locked Bag #870, Richmond, Victoria 3121 Australia.

New Zealand: 16-18 William Pickering Drive,
Albany 1331, Auckland.

Thomas the Tank Engine & Friends™



CREATED BY BRITT ALLCROFT

Based on the Railway Series by The Reverend W Awdry.

©2016 Gullane (Thomas) Limited. Thomas the Tank Engine & Friends and Thomas & Friends are trademarks of Gullane (Thomas) Limited.

©2016 HIT Entertainment Limited. HIT and the HIT logo are trademarks of HIT Entertainment Limited.

©2016 Mattel. All Rights Reserved. ® and ™ designate U.S. trademarks of Mattel, except as noted. **PRINTED IN CHINA.** Mattel East Asia Ltd., Room 503-09, North Tower, World Finance Centre, Harbour City, Tsimshatsui, HK, China. Tel.: (852) 3185-6500.

DVF73-0970
1101101183-DOM



**DVF73
CFF94 Asst.**

Fisher-Price®