

ROCK SLIDE REVENGE™



3+

INSTRUCTIONS

Please keep these instructions for future reference as they contain important information.

CONTENTS

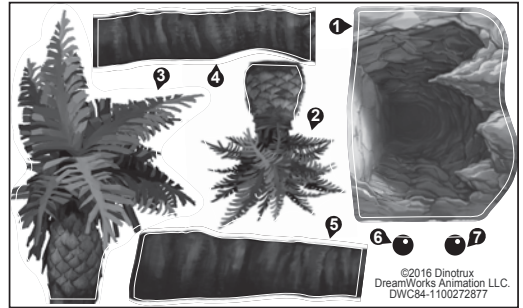
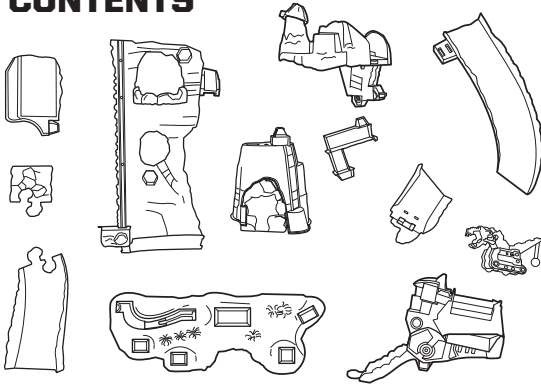

1 APPLY LABELS

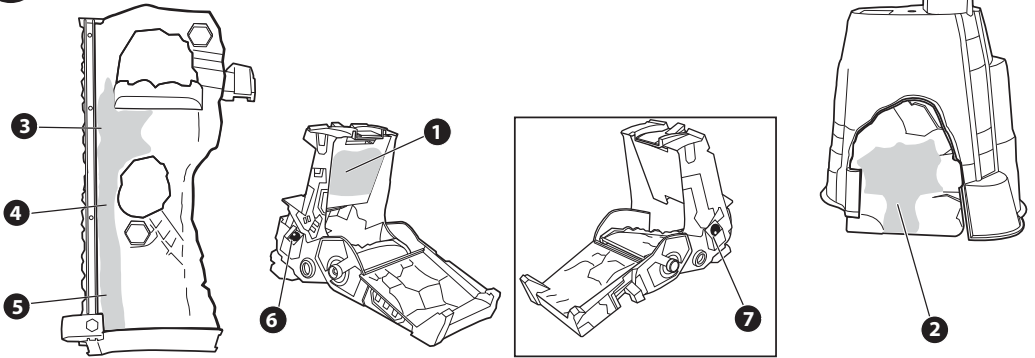

©2016 Mattel. All Rights Reserved. ® and ™ designate U.S. trademarks of Mattel, except as noted. Mattel, Inc., 636 Girard Avenue, East Aurora, NY 14052, U.S.A. Consumer Services 1-800-524-8697. Mattel U.K. Ltd., Vanwall Business Park, Maidenhead SL6 4UB. Helpline 01628 500303. Mattel Australia Pty., Ltd., Richmond, Victoria. 3121. Consumer Advisory Service - 1300 135 312. Mattel East Asia Ltd., Room 503-09, North Tower, World Finance Centre, Harbour City, Tsimshatsui, HK, China. Tel.: (852) 3185-6500. Diimport & Diedarkan Oleh: Mattel Southeast Asia Pte. Ltd., No 19-1, Tower 3 Avenue 7, Bangsar South City, No 8, Jalan Kerinchi, 59200 Kuala Lumpur, Malaysia. Tel: 03-78803817, Fax: 03-78803867.

DWC84_0970
1101199864_DOM



2 ASSEMBLY

A.

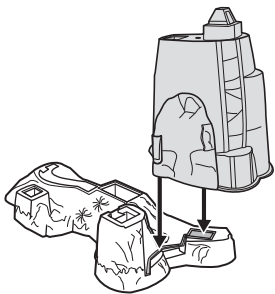

B.

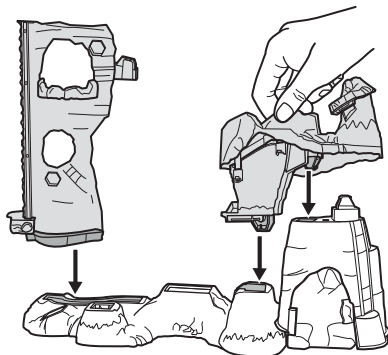

C.

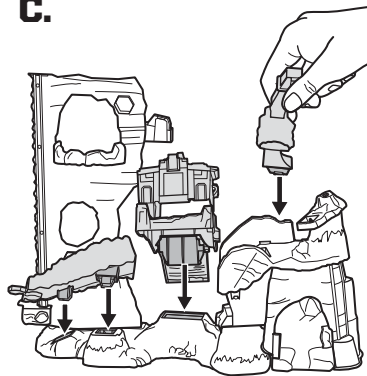

D.

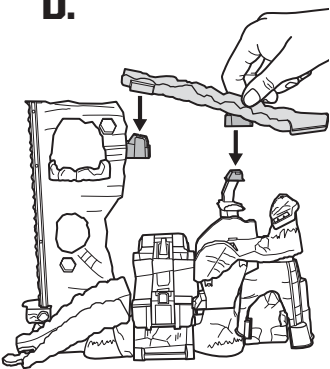

E.

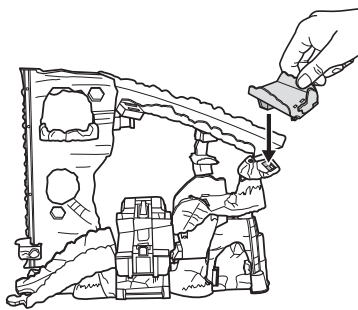

F.

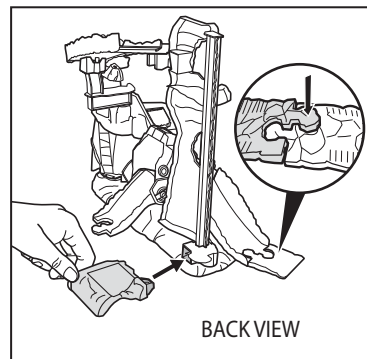

3 TO PLAY: ROCK SLIDE!

A. Set up D-Structs.

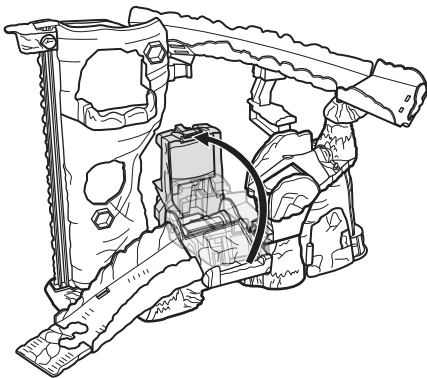

B. Move Revvit up on lift elevator.

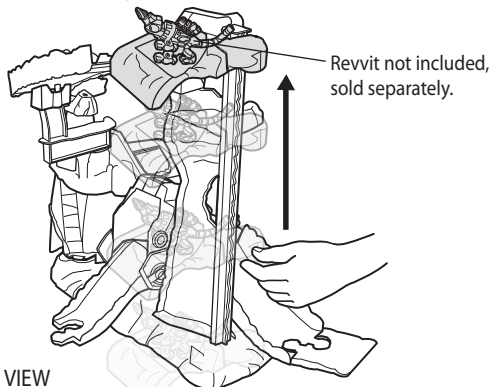

C. Push Revvit down the rock slide.

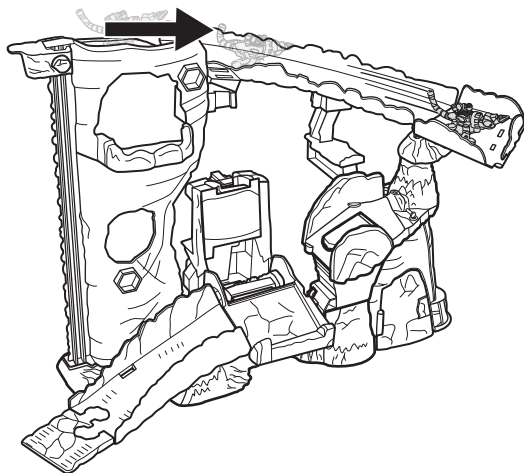

D1. Revvit either passes through safely...

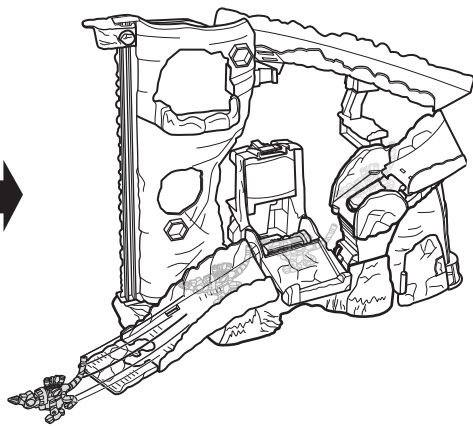
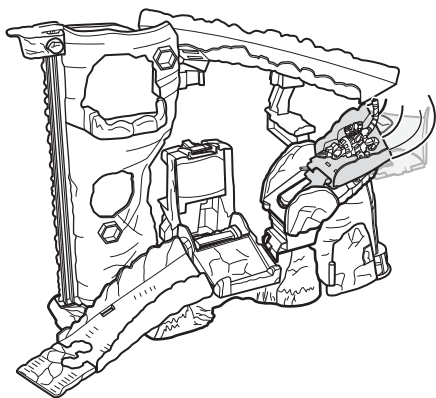

D2. ...or gets captured by D-Structs.

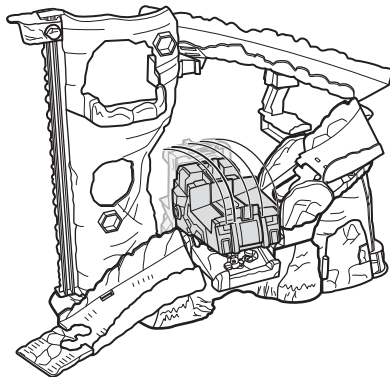
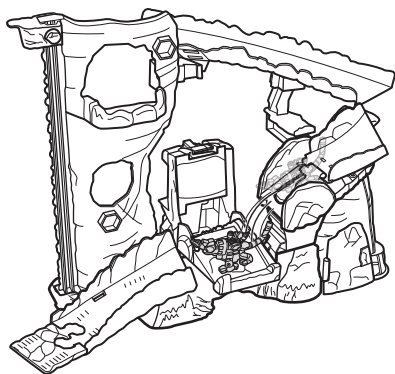

D-Structs' trap works best with Reptools and Scaptors vehicles (sold separately).

4 TO PLAY: TO THE RESCUE!

A. Push Ty Rux down the rock slide...

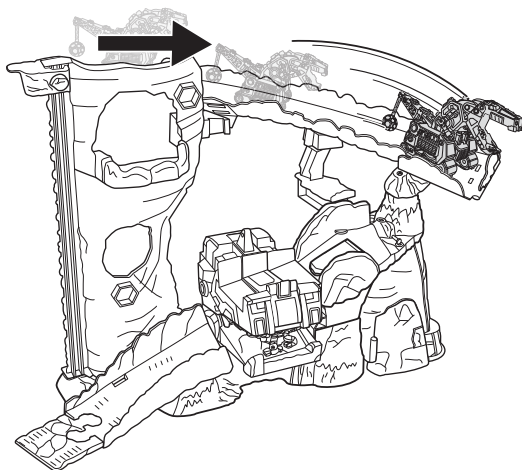

B. ...to rescue Revvit!

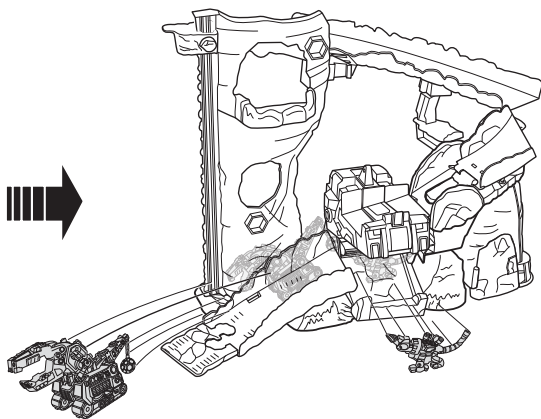
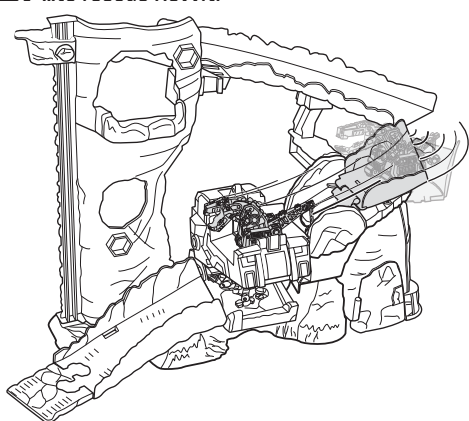

5 MORE WAYS TO PLAY

A. Attach Reptools and Scryptors (not included) to the rock. **B.** Connect with other Dinotrux playsets!

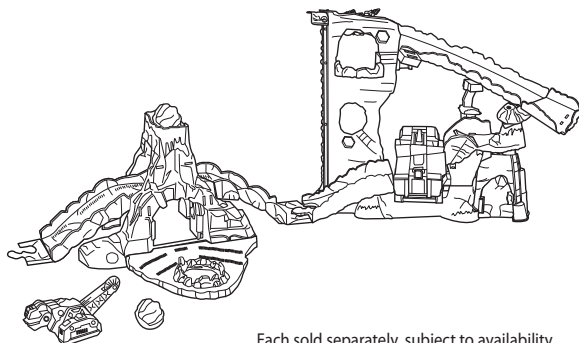
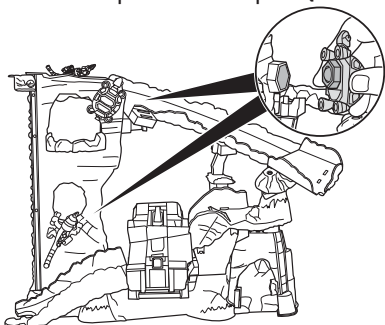

Works only with Reptools and Scryptors vehicles (sold separately).

Each sold separately, subject to availability.