

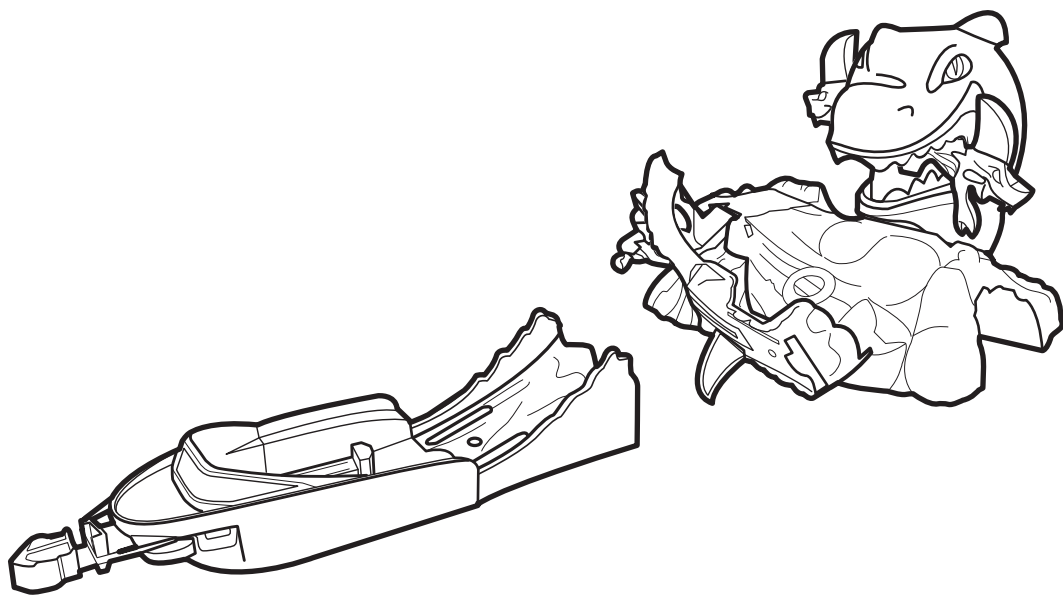

SHARKBAIT



4+

service.mattel.com

HOTWHEELS.COM

 **WARNING:**
CHOKING HAZARD - Small parts.
Not for children under 3 years.



ASST.DWK94
DWK98-0970
1101102547-DOM
ASST.DYL99
DYM03-0970
1101296164-DOM

PLEASE KEEP THESE INSTRUCTIONS FOR FUTURE REFERENCE AS THEY CONTAIN IMPORTANT INFORMATION.

CONTENTS

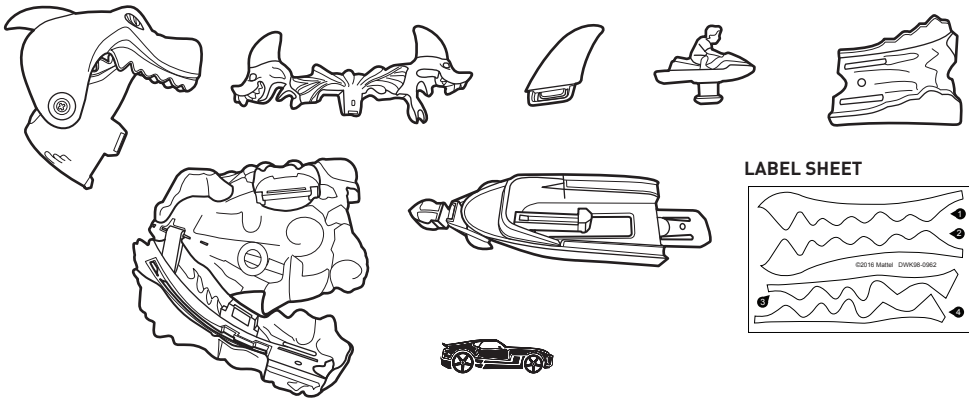

APPLY LABELS

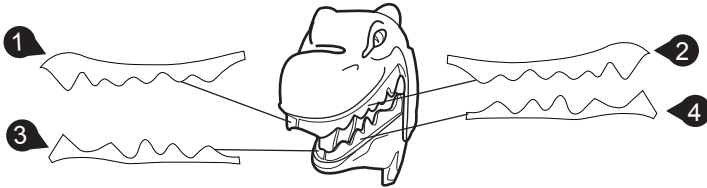

ASSEMBLY

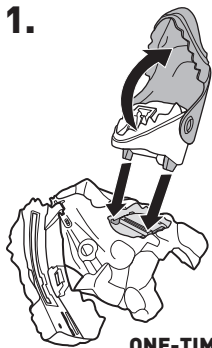

ONE-TIME ASSEMBLY

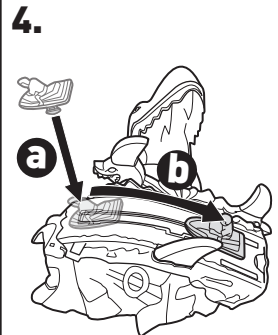
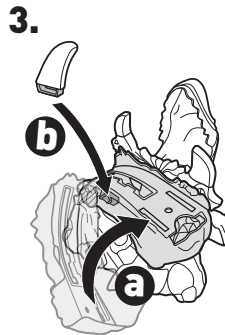
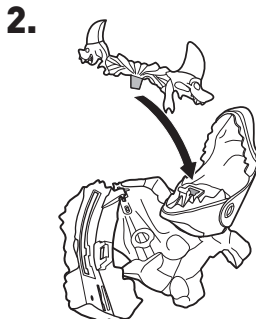

5.

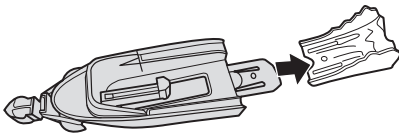

TO PLAY

1. PULL BACK AND LOCK LAUNCHER. LOAD VEHICLE.

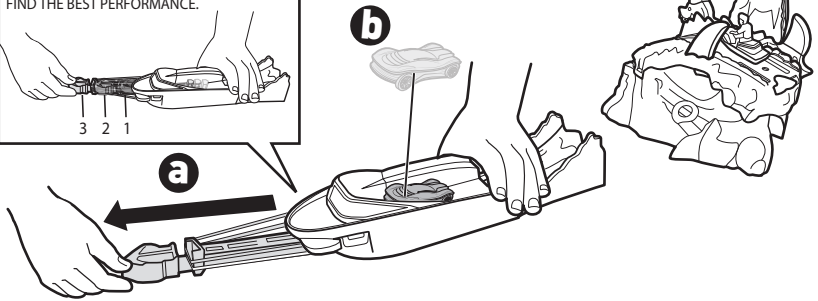
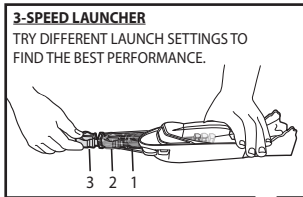

2. PRESS TO LAUNCH. HIT THE FRONT FIN AND YOUR CAR CRASHES!

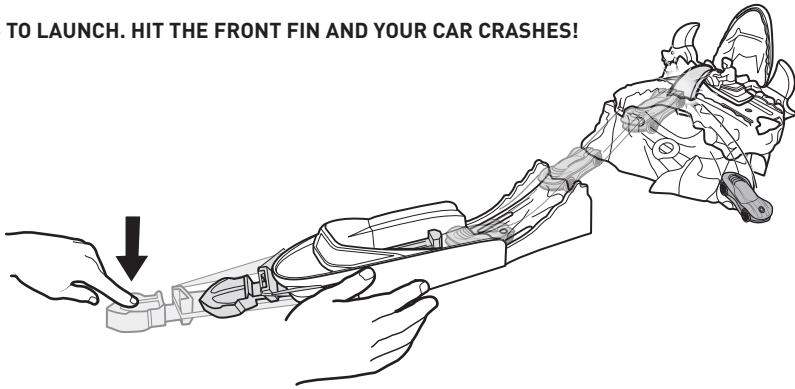

3. HIT ONE OF THE BACK FINS AND THE SHARK ATTACKS!

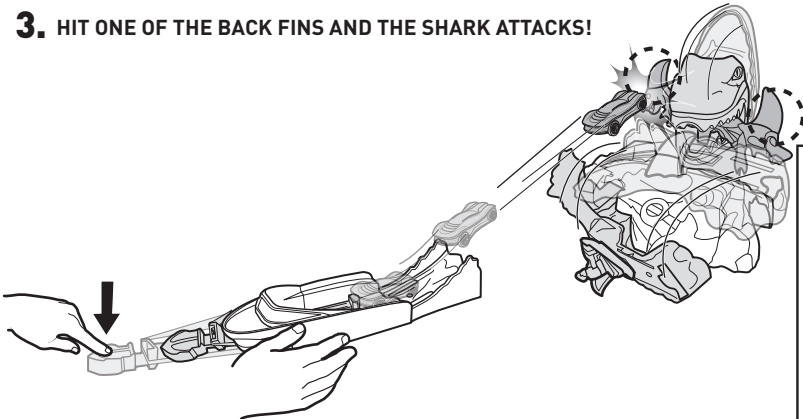

TO RESET.

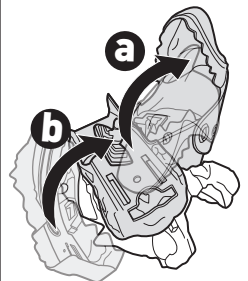

NOT FOR USE WITH SOME HOT WHEELS® VEHICLES.

TO PLAY (CONTD.)

4. MOVE THE LAUNCHER AND LAUNCH AGAIN. HIT THE JET SKI AND IT RIDES TO SAFETY.

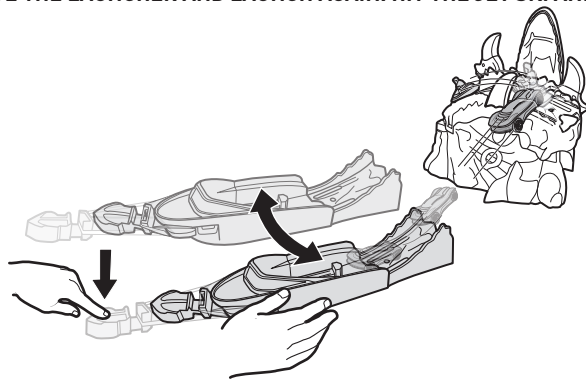

TO RESET.



STORAGE

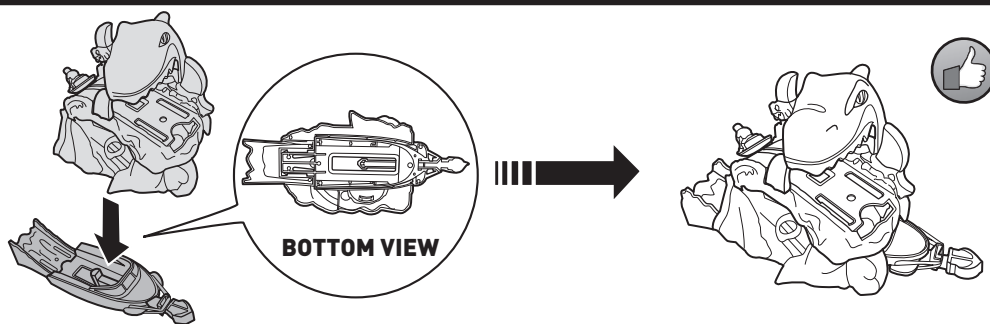

MORE WAYS TO PLAY

CONNECTS TO OTHER HOT WHEELS® SETS (SOLD SEPARATELY).

