

# PISTON CUP MOTORIZED GARAGE INSTRUCTIONS

4+

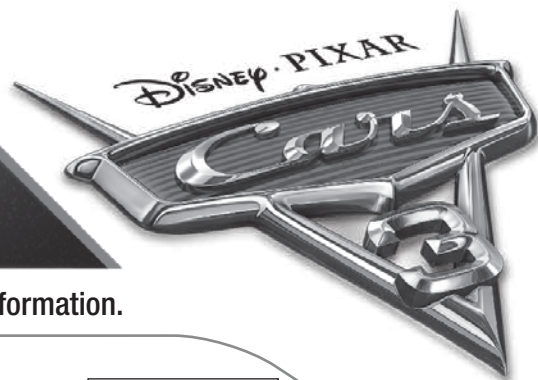

Please keep these instructions for future reference as they contain important information.

## CONTENTS

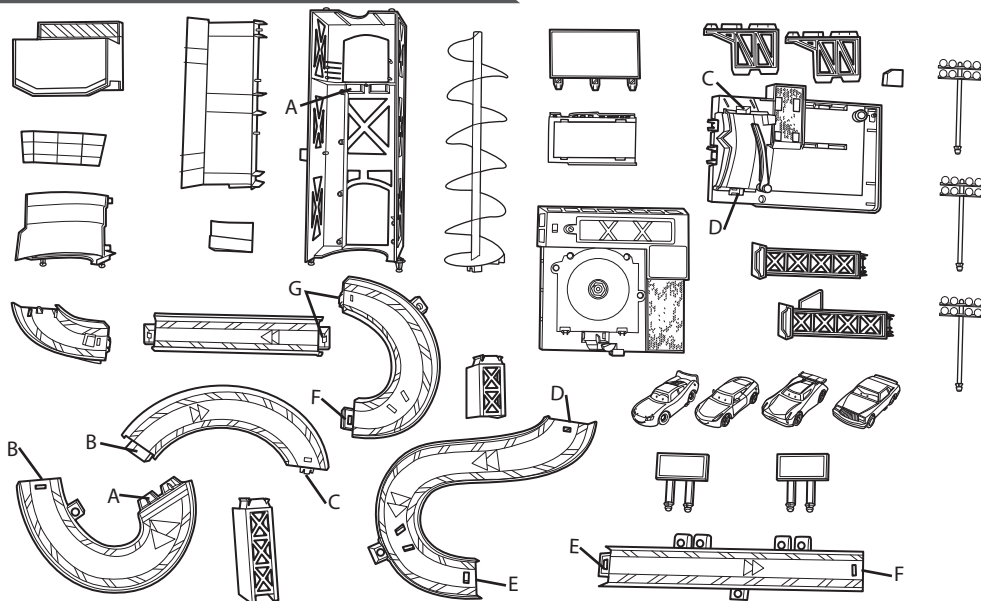

**WARNING:**  
CHOKING HAZARD – Small parts.  
Not for children under 3 years.

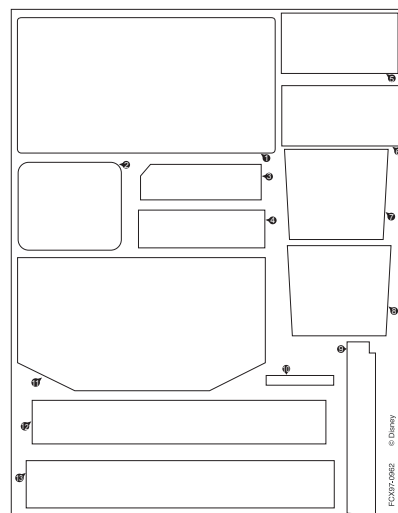

## 1 APPLY LABELS

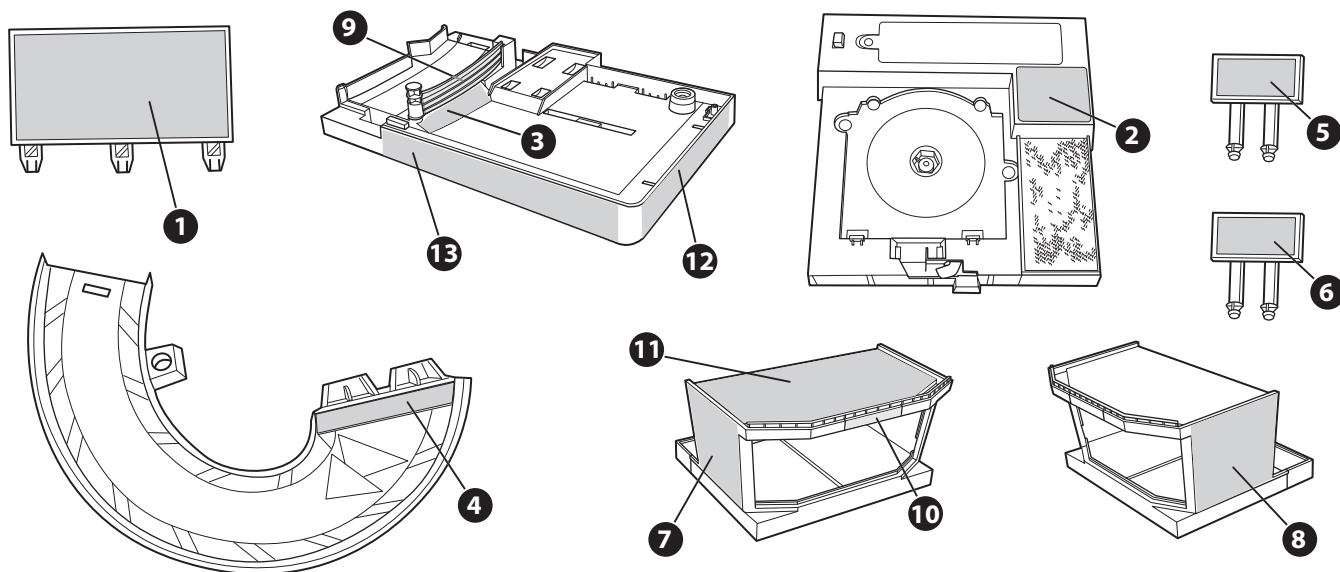

©2017 Mattel. All Rights Reserved. ® and ™ designate U.S. trademarks of Mattel, except as noted.

Mattel, Inc., 636 Girard Avenue, East Aurora, NY 14052, U.S.A. Consumer Relations 1-800-524-8697. Mattel U.K. Ltd., Vanwall Business Park, Maidenhead SL6 4UB. Helpline 01628 500303. Mattel Australia Pty., Ltd., Richmond, Victoria. 3121. Consumer Advisory Service - 1300 135 312. Mattel East Asia Ltd., Room 503-09, North Tower, World Finance Centre, Harbour City, Tsimshatsui, HK, China. Diimport & Diedarkan Oleh: Mattel Southeast Asia Pte. Ltd., No 19-1, Tower 3 Avenue 7, Bangsar South City, No 8, Jalan Kerinchi, 59200 Kuala Lumpur, Malaysia. Tel: 03-78803817, Fax: 03-78803867.



## 2 ASSEMBLY

Refer to letters molded to help with assembly.

A.

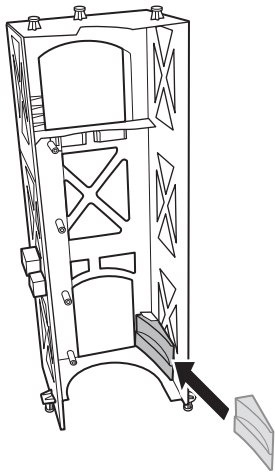

B.

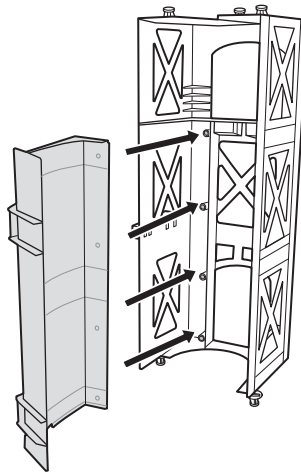

C.

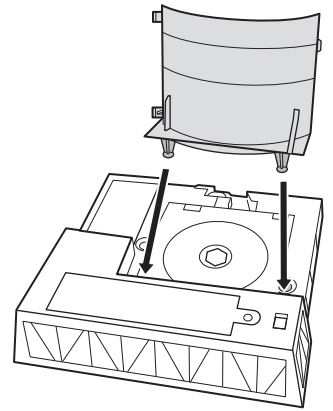

D.

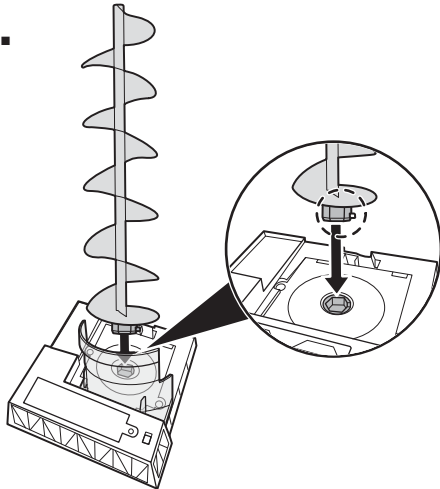

E.

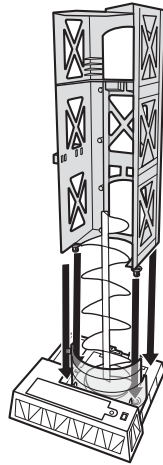

F.

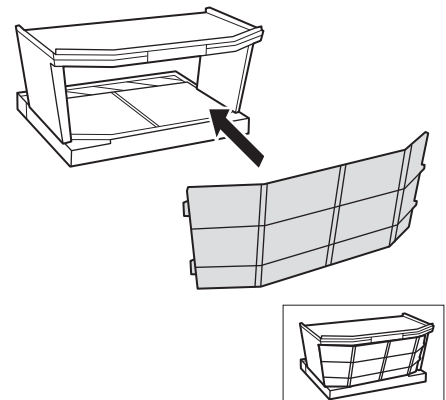

G.

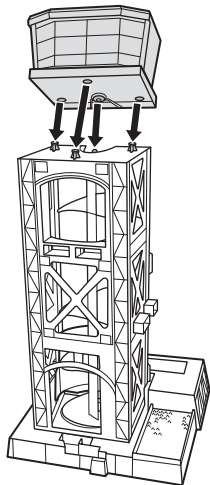

H.

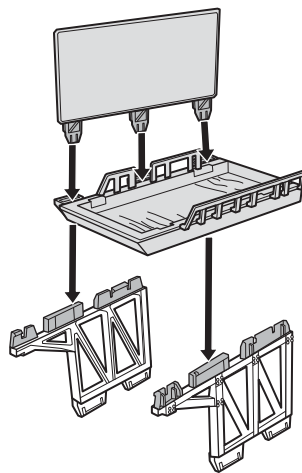

I.

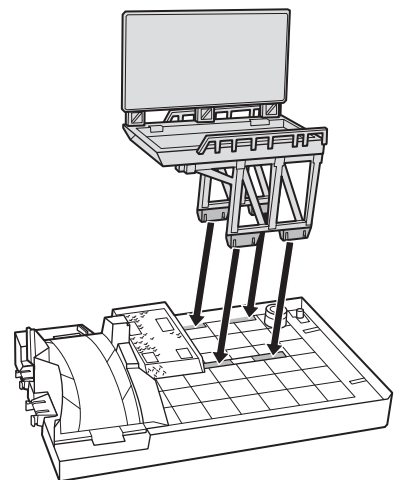

J.

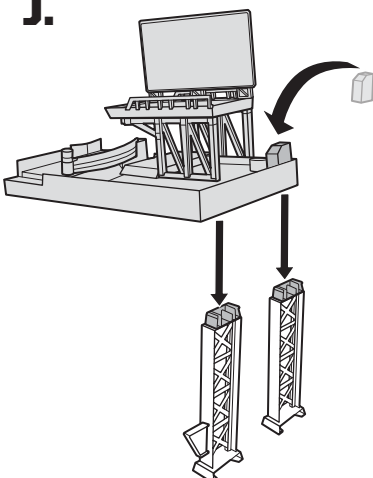

K.

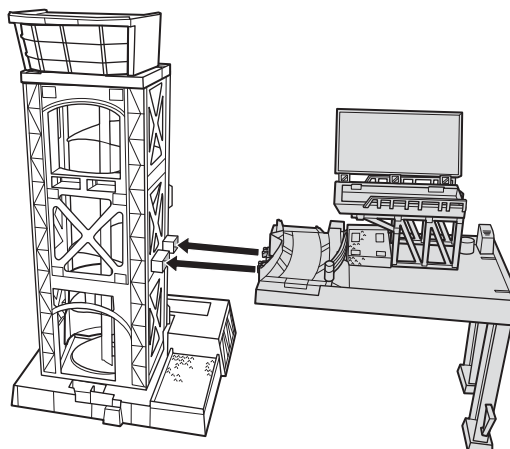

L.

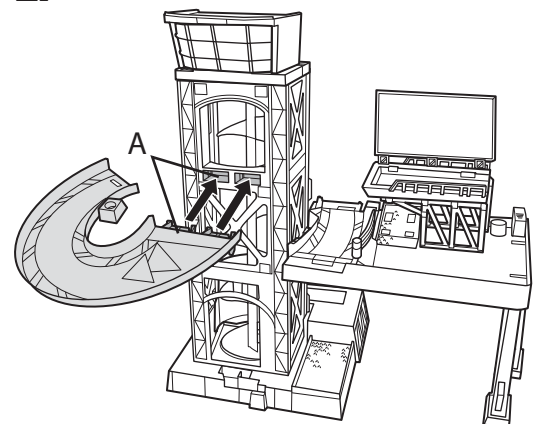

# M. BACK VIEW

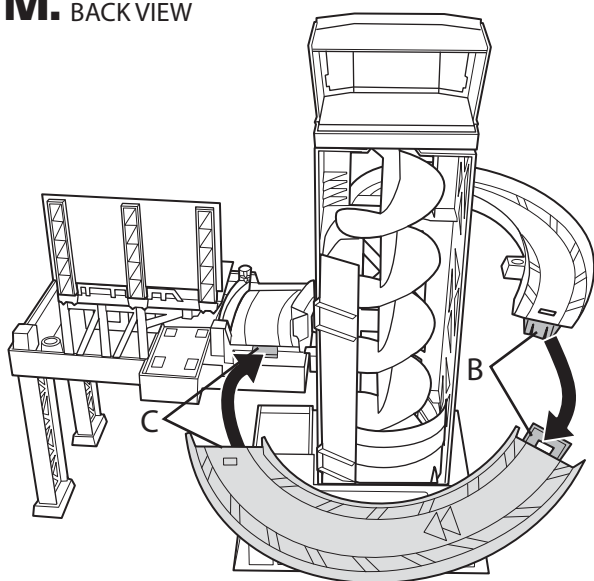

# N.

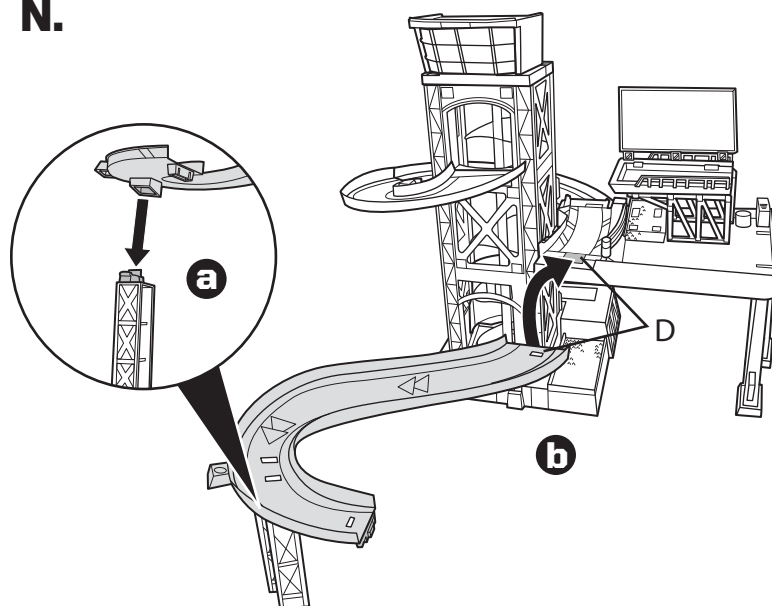

# O.

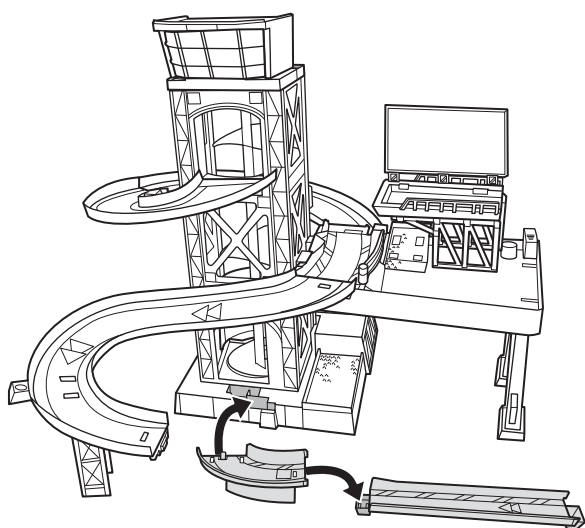

# P.

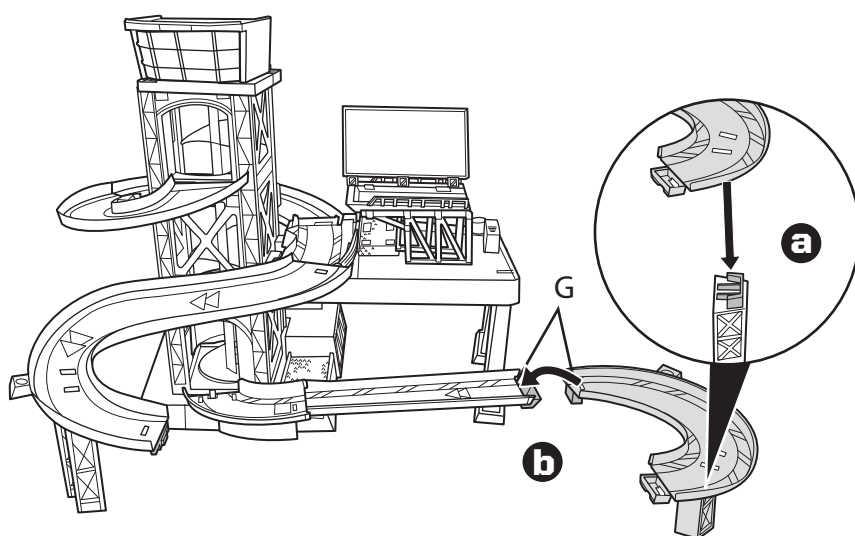

# Q.

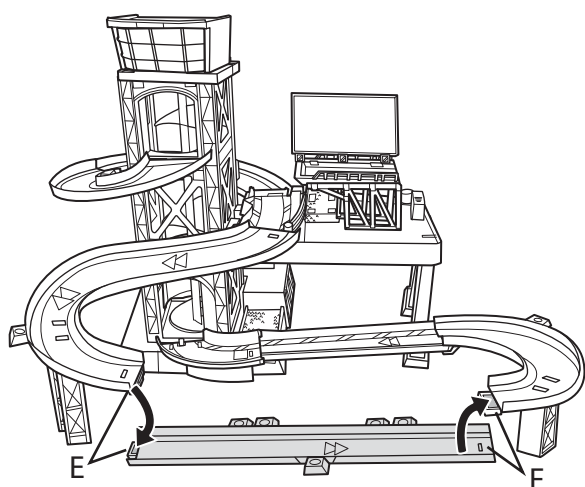

# R.

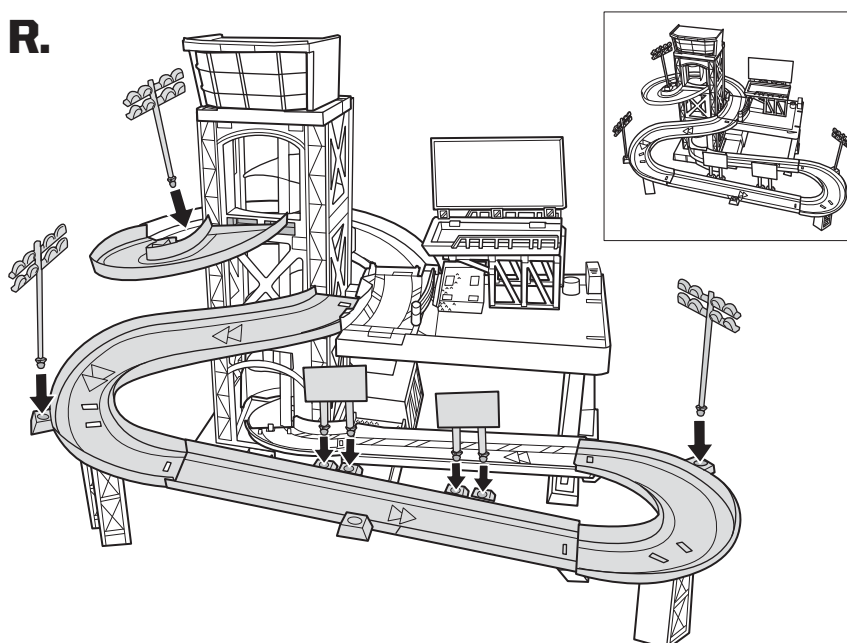

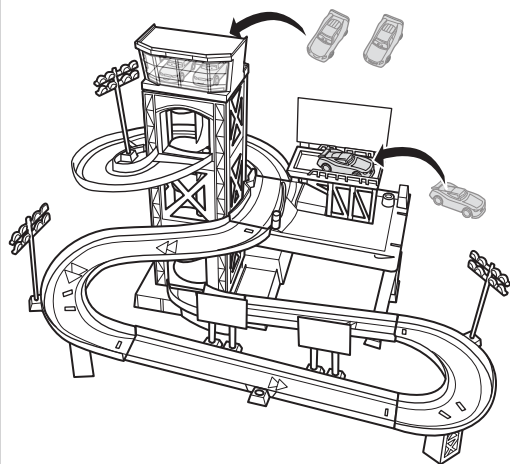
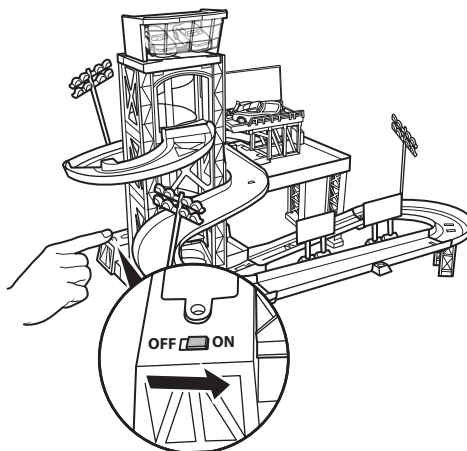
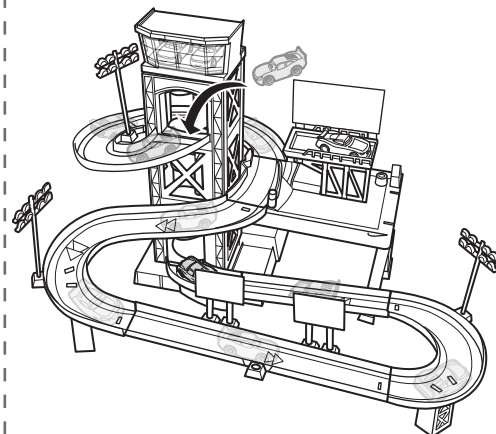

**A.** Load vehicles supporting the race.**B.** Switch ON the elevator.**C.** Load vehicle on track for non-stop racing!

Not for use with some Cars vehicles.

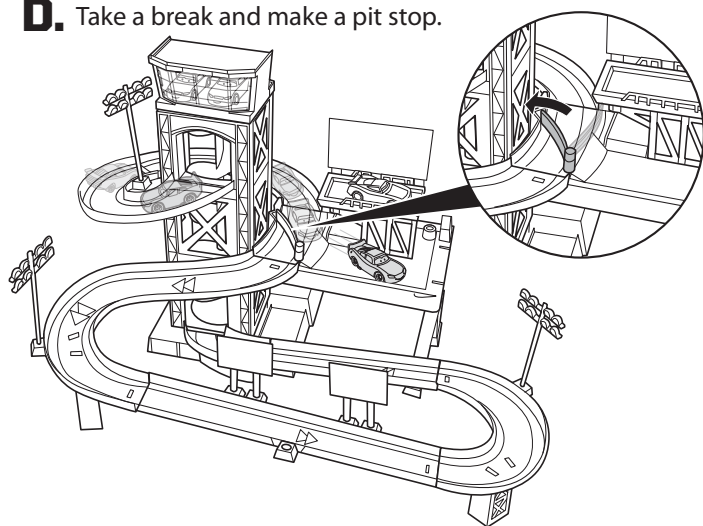
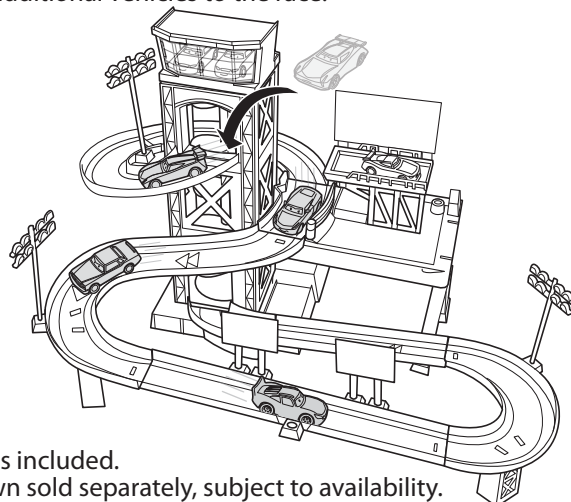
**D.** Take a break and make a pit stop.**E.** Load additional vehicles to the race!

Four vehicles included.  
Others shown sold separately, subject to availability.

**TIP:** If cars are jammed in the elevator, switch it OFF and disassemble the main tower. Take out the cars and reassemble the main tower again to resume the race.

## 4 BATTERY INSTALLATION

- Requires 2 "D" size (LR20) alkaline batteries (not included).
  - Unscrew the battery cover with a Phillips head screwdriver (not included).
  - Install 2 "D" size (LR20) alkaline batteries (not included) in the orientation (+/-) shown.
  - Replace battery cover and tighten screws.
  - Replace the batteries if elevator can no longer transport vehicles up.
  - Dispose of batteries safely.
  - For longer life use alkaline batteries.
  - When exposed to an electrostatic source, the product may malfunction.
- To resume normal operation, remove and re-install the batteries.

**BATTERY SAFETY INFORMATION**

In exceptional circumstances batteries may leak fluids that can cause a chemical burn injury or ruin your product. To avoid battery leakage:

- Non-rechargeable batteries are not to be recharged.
- Rechargeable batteries are to be removed from the product before being charged.
- Rechargeable batteries are only to be charged under adult supervision.
- Do not mix alkaline, standard (carbon-zinc), or rechargeable batteries.
- Do not mix old and new batteries.
- Only batteries of the same or equivalent type as recommended are to be used.
- Batteries are to be inserted with the correct polarity.
- Exhausted batteries are to be removed from the product.
- The supply terminals are not to be short-circuited.
- Dispose of battery(ies) safely.
- Do not dispose of this product in a fire. The batteries inside may explode or leak.

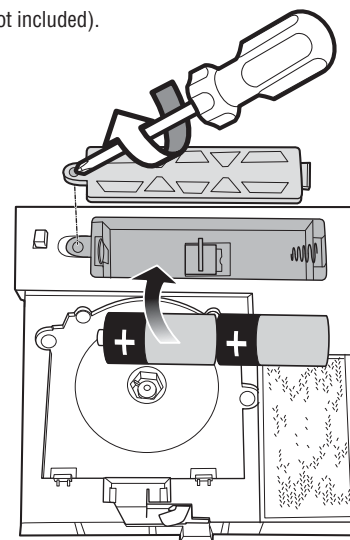

Protect the environment by not disposing of this product or any batteries with household waste. This symbol indicates that this product shall not be treated as household waste. Check your local authority for recycling advice and facilities.