

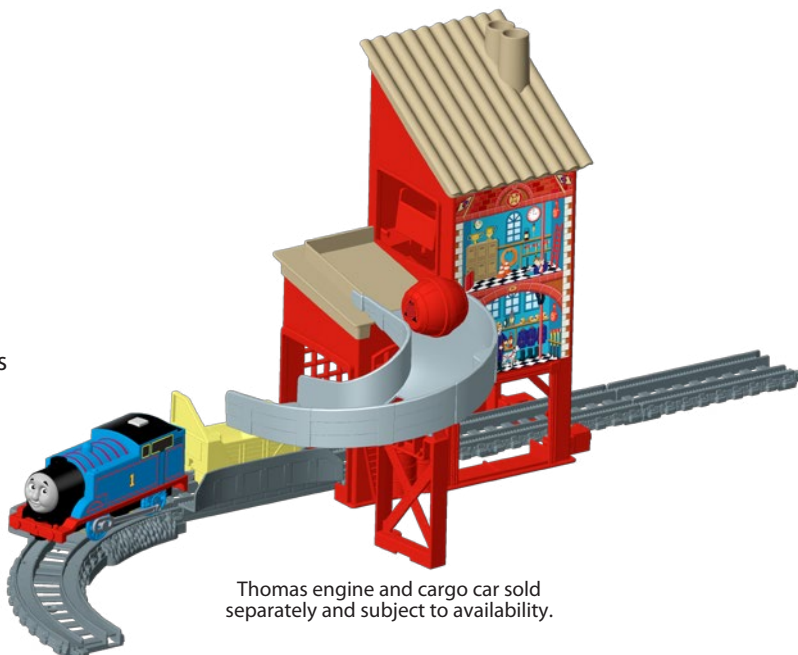

FILL-UP FIREHOUSE

INSTRUCTIONS

Keep these instructions for future reference as they contain important information.



Thomas engine and cargo car sold separately and subject to availability.

WHAT'S INCLUDED

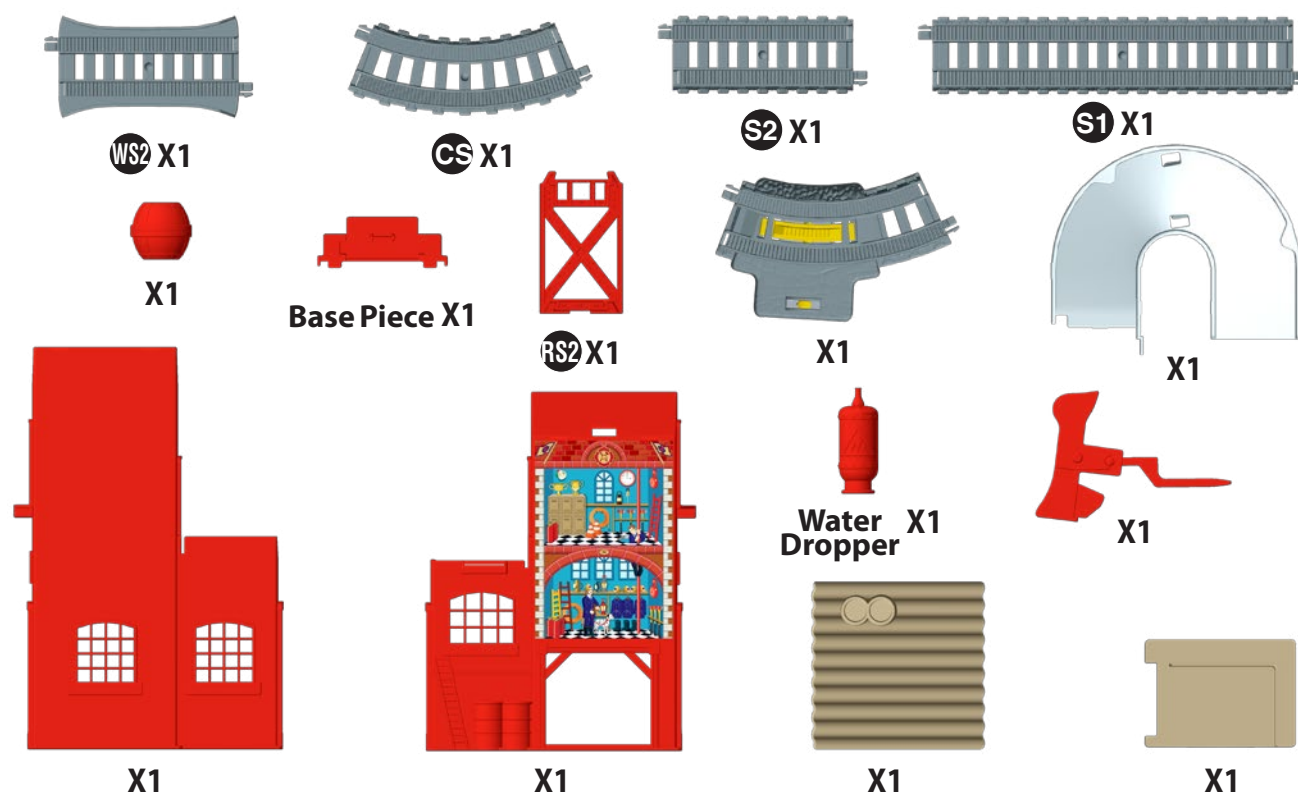

HELPFUL HINTS



Track marking codes are found on the bottom of tracks.

Note: Some engines may not work on this track set.

Water toys sometimes get messy. Protect play surfaces before use.

Drain, rinse, clean and dry all items thoroughly before storing.

ADULT ASSEMBLY REQUIRED. No tools needed.

Note: The fire extinguisher water dropper can be used to fill TrackMaster™ Real Steam Engines (sold separately and subject to availability)

LABEL PLACEMENT

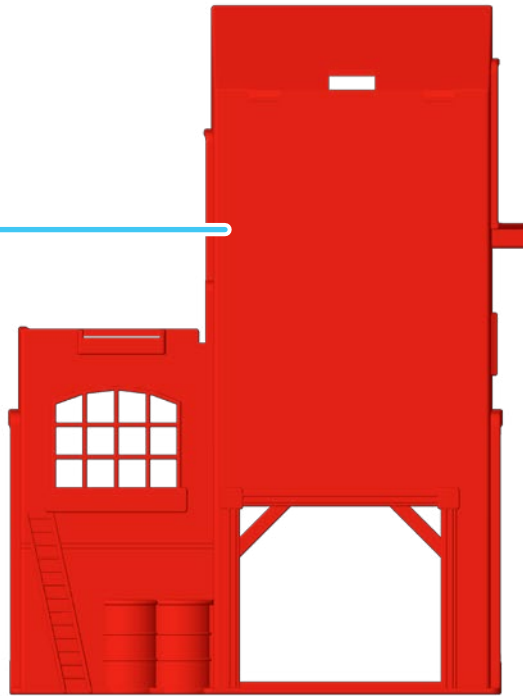

ASSEMBLY

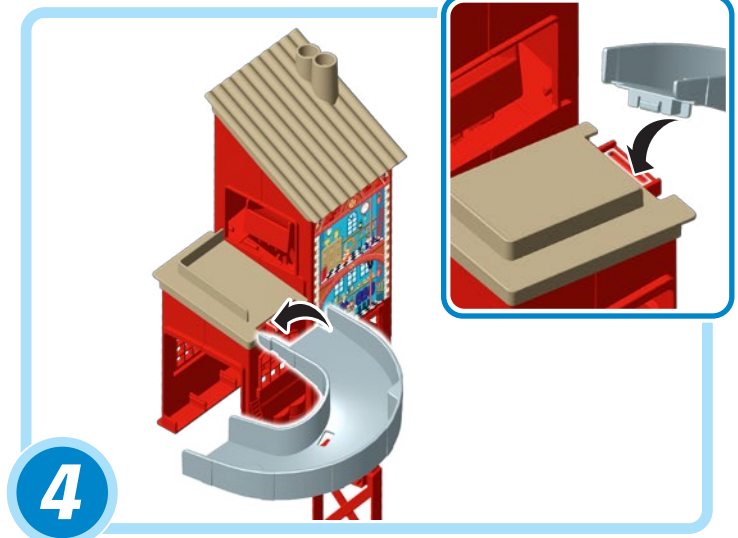
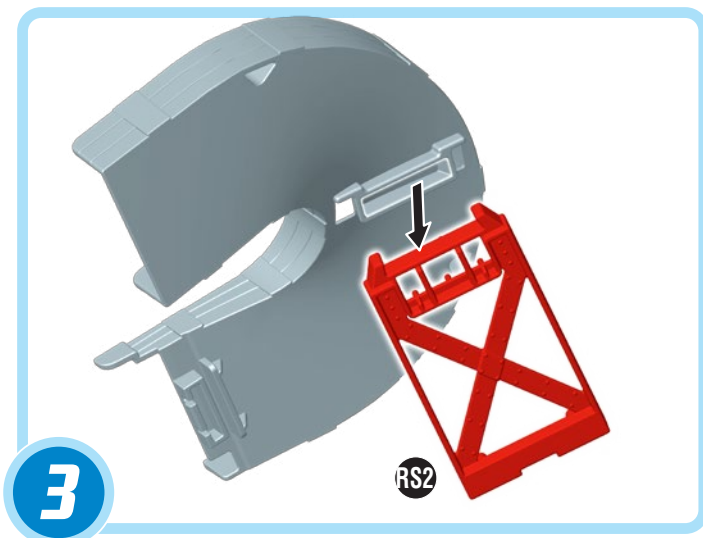
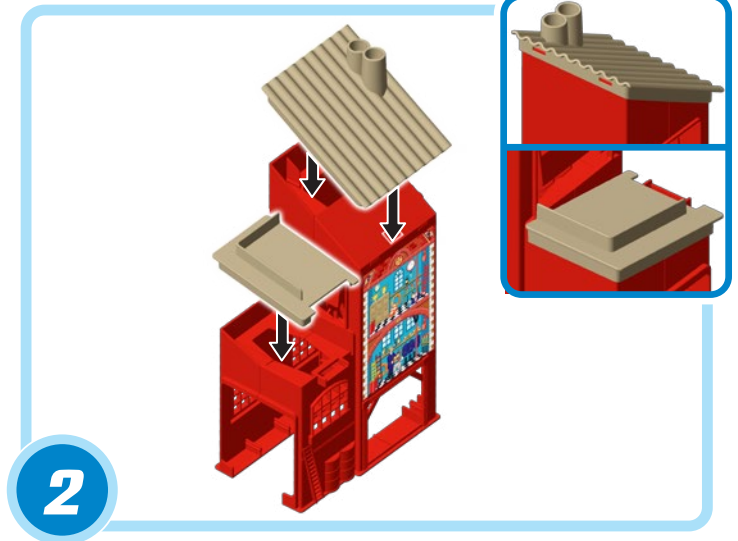
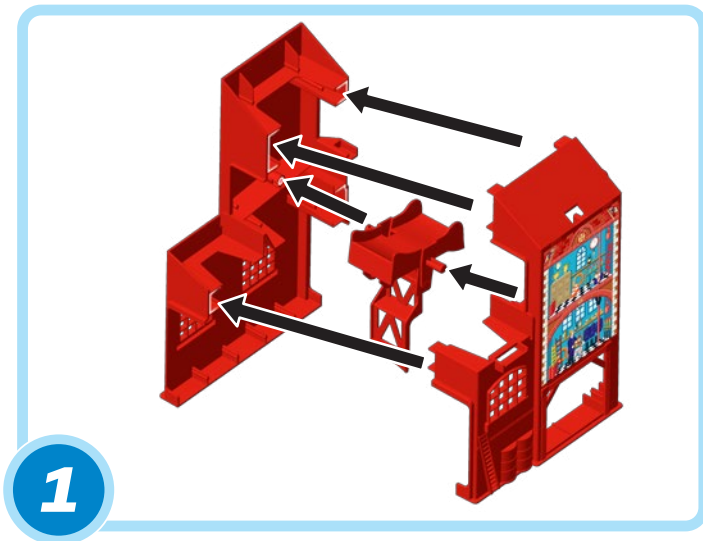

TRACK LAYOUT

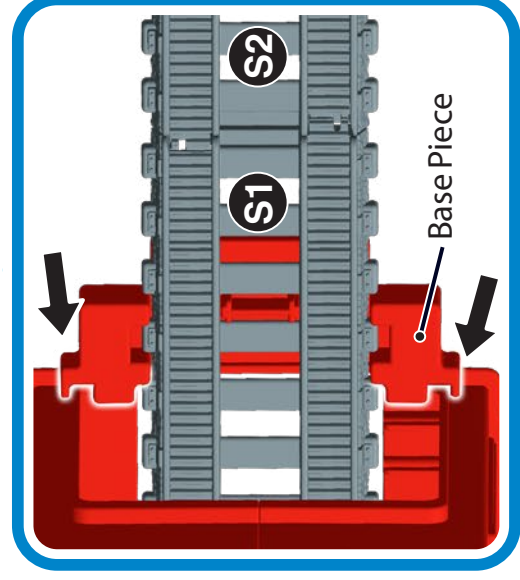
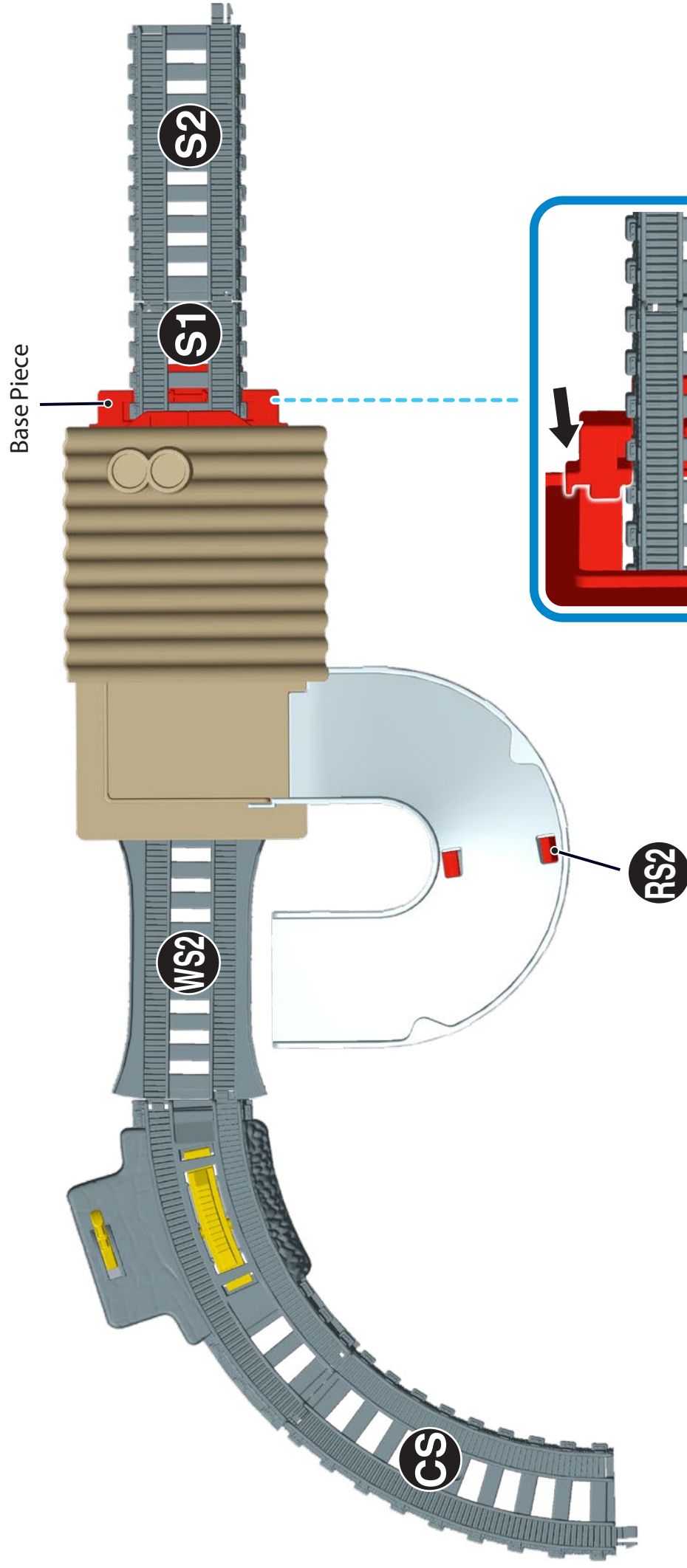

Note: Adjust the track forward or backward to ensure the cargo car aligns with the ramp so the barrel can roll into the cargo car.

Ensure the ribs of the house fit into the slots of the Base Piece beneath the track.

BEFORE YOU PLAY

Set the stop-track to "stop".

Place the barrel on the platform of the Firehouse.

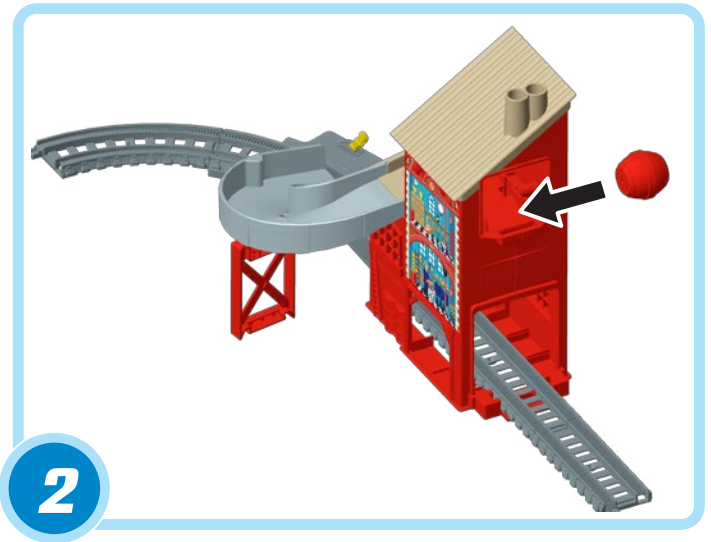
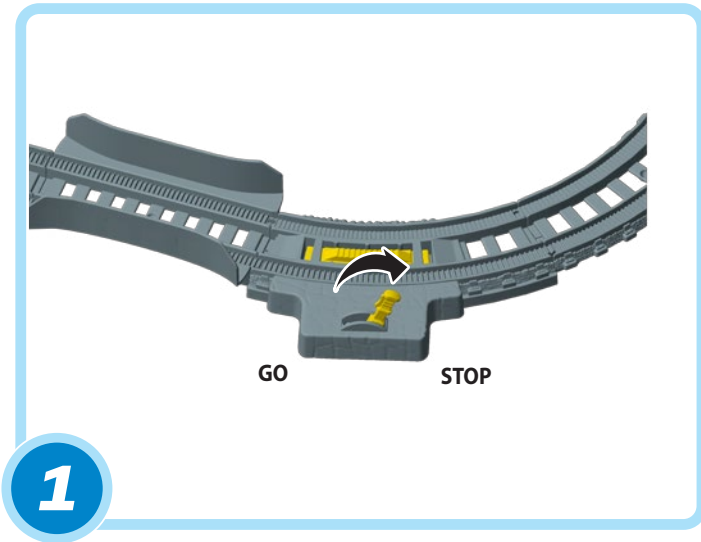

HOW TO PLAY

As the engine passes through the Firehouse, the barrel will roll down the ramp and into the cargo car. Flip the switch to send the engine forward.

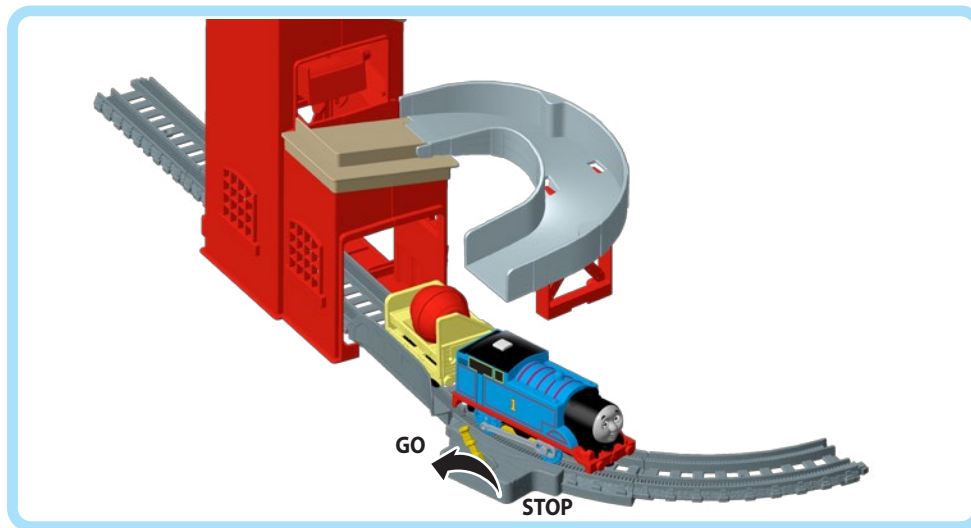

Thomas engine and cargo car sold separately and subject to availability.

CONSUMER ASSISTANCE
1-800-432-5437 (US & Canada)
1300 135 312 (Australia)
service.fisher-price.com

Fisher-Price, Inc., 636 Girard Avenue, East Aurora, NY 14052.
Hearing-impaired consumers: 1-800-382-7470.

Outside the United States:

Canada: Mattel Canada Inc., 6155 Freemont Blvd.,
Mississauga, Ontario L5R 3W2; www.service.mattel.com.

Great Britain: Mattel UK Ltd, Vanwall Business Park,
Maidenhead SL6 4UB. Helpline: 01628 500303.
www.service.mattel.com/uk

Mattel Europa B.V., Godel 1, 1186 MJ Amstelveen, Nederland.

Australia: Mattel Australia Pty. Ltd., 658 Church Street,
Locked Bag #870, Richmond, Victoria 3121 Australia.

New Zealand: 16-18 William Pickering Drive,
Albany 1331, Auckland.

Thomas the Tank Engine & Friends™



CREATED BY BRITT ALLCROFT

Based on the Railway Series by The Reverend W Awdry.
©2017 Gullane (Thomas) Limited. Thomas the Tank Engine & Friends
and Thomas & Friends are trademarks of Gullane (Thomas) Limited.
©2017 HIT Entertainment Limited. HIT and the HIT logo are trademarks
of HIT Entertainment Limited.

©2017 Mattel. All Rights Reserved. ® and ™ designate U.S. trademarks of
Mattel, except as noted. **PRINTED IN CHINA.** Mattel East Asia Ltd., Room
503-09, North Tower, World Finance Centre, Harbour City, Tsimshatsui,
HK, China. Tel.: (852) 3185-6500. Mattel South Africa (PTY) LTD,
Office 102 I3, 30 Melrose Boulevard, Johannesburg 2196.

FBK48-0970
1101290717-DOM

WARNING:
CHOKING HAZARD - Small parts.
Not for children under 3 years.



Fisher-Price®

FBK48