

CARD GAME

2 GAMES IN 1

From the Makers of **UNO**

AGES **6+**
PLAYERS **2**



MINI FIGURE



2 TOKENS

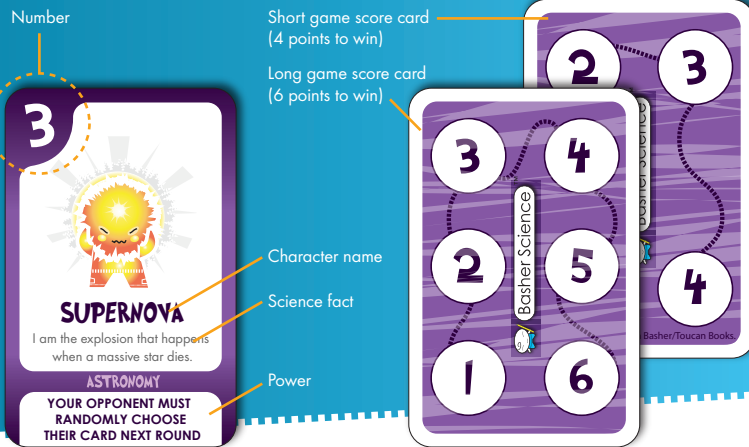

BATTLE GAME

Battle for power in a game of strategy and reason, where your decisions can lead to victory.

SET UP

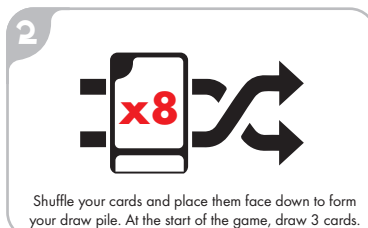

HOW TO PLAY

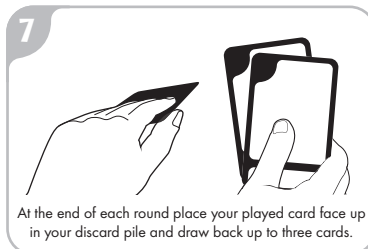
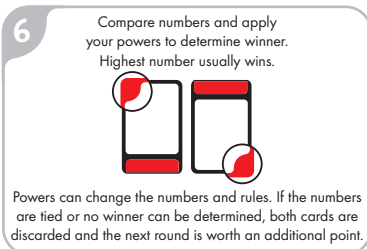
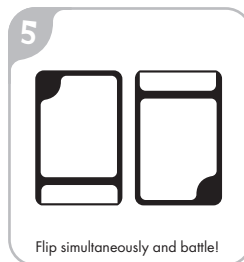

SCORING & RULES

Use a token or the figure included to keep score.

When you win a round, move your token/figure along the score card. When you reach either number 4 (short game) or number 6 (long game), you are the winner!

Keep playing rounds until a player has reached the end of their score track or both players are out of cards. If nobody has reached the end of the score track, the player who is farther along is the winner. In the event of a tie, **BOTH PLAYERS WIN!**

If any card contradicts a game rule, follow the text on the card.

Some cards may call for you to flip a coin.

You can use the tokens for this.

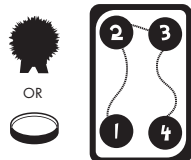

MATCH GAME

Apply your science knowledge and memory skills in a game of match to overcome your opponent.

SET UP

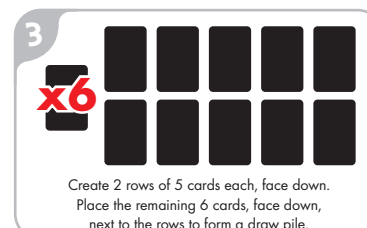
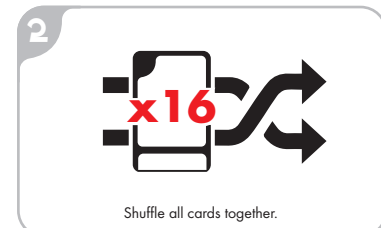
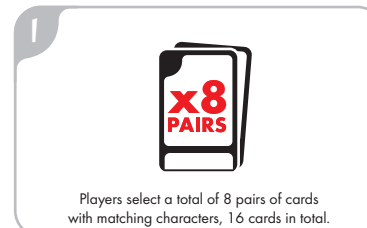

HOW TO PLAY

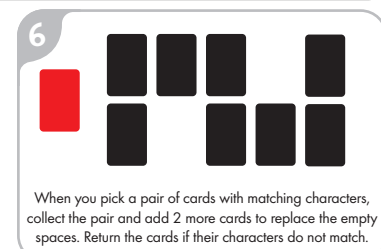
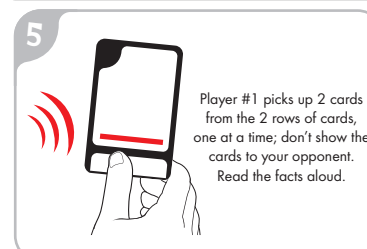

STRATEGY & SCORING

Before you start playing, learn the facts for each card. This will give you the advantage of knowing what the face down cards are.

While the names and pictures for each character pair will match, the facts on each card will be different. Learn all the facts about every character to have the best advantage!

When you get a pair, put it in the discard pile, and move your token/figure up on the score track.

Keep playing until a player has reached the end of their score track or there are no more cards. If nobody has reached the end of the score track, the player who is farther along is the winner. In the event of a tie, **BOTH PLAYERS WIN!**

PLEASE KEEP THESE INSTRUCTIONS FOR FUTURE REFERENCE AS THEY CONTAIN IMPORTANT INFORMATION.
©2016 Mattel. All Rights Reserved. ® and ™ designate U.S. trademarks of Mattel, except as noted. Mattel, Inc., 636 Girard Avenue, East Aurora, NY 14052, U.S.A. Consumer Services 1-800-524-8697. Mattel U.K. Ltd., Vanwall Business Park, Maidenhead SL6 4UB. Helpline 01628 500303. Mattel Australia Pty., Ltd., Richmond, Victoria, 3121. Consumer Advisory Service - 1300 135 312. Mattel East Asia Ltd., Room 503-09, North Tower, World Finance Centre, Harbour City, Tsimshatsui, HK, China. Tel: (852) 3185-6500. Diimport & Diedarkan Oleh: Mattel Southeast Asia Pte. Ltd., No 19-1, Tower 3 Avenue 7, Bangsar South City, No 8, Jalan Kerinchi, 59200 Kuala Lumpur, Malaysia. Tel: 03-78803817, Fax: 03-78803867.

BASHER SCIENCE and all related characters and elements ™ & © 2007–2010 Simon Basher and Toucan Books. All rights reserved. Licensed from Macmillan Publishers International Ltd.

BUILD YOUR DECK

For advanced play, increase your powers and science skills with additional cards included in our mini figure sets and other science card packs.



COLLECTOR GUIDE

CHEMISTRY

SERIES 1



ION*



GAS*

EXCLUSIVE FIGURES!



ATOM



MOLECULE



THERMOMETER



BASE



SOLID



LIQUID



TEST TUBE



ACID

BIOLOGY

SERIES 1



SKELETON*



DNA*

EXCLUSIVE FIGURES!



EYE



HEART



BACTERIA



VIRUS

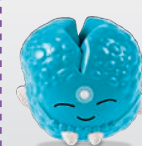

CELL



MITOCHONDRIA



FUNGUS



POLLEN

ROCKS AND MINERALS

SERIES 1



EVAPORITE*



OBSIDIAN*

EXCLUSIVE FIGURES!



CLAY



SANDSTONE



GOLD



DIAMOND



GRANITE



BASALT



MAGNETITE



PYRITE

ASTRONOMY

SERIES 2



RED DWARF*



NEUTRON STAR*

EXCLUSIVE FIGURES!



STAR BIRTH NEBULA



BROWN DWARF



SUPERNOVA



BLACK HOLE



VOYAGERS



INTERNATIONAL SPACE STATION



SIRIUS



BETELGEUSE

* Only available in 3 packs.

Each sold separately, subject to availability. Colors and decorations may vary.

