

TUNDRA TOWER EXPANSION PLAYSET

INSTRUCTIONS

CONTENTS



Apply these stickers
anywhere you like!

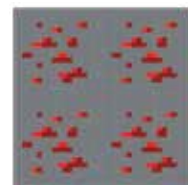

NOTE: The labels are for
one-time use only and
cannot be repositioned.

Check out service.mattel.com for more information.
Please remove everything from the package and compare to the contents shown here.
If any items are missing, please contact your local Mattel office.
Keep these instructions for future reference as they contain important information.



©2017 Mattel. All Rights Reserved. ® and ™ designate U.S. trademarks of Mattel, except as noted. Mattel, Inc., 636 Girard Avenue, East Aurora, NY 14052, U.S.A. Consumer Services 1-800-524-8697. Mattel U.K. Ltd., Vanwall Business Park, Maidenhead SL6 4UB. Helpline 01628 500303. Mattel Australia Pty., Ltd., Richmond, Victoria. 3121. Consumer Advisory Service - 1300 135 312. Mattel East Asia Ltd., Room 503-09, North Tower, World Finance Centre, Harbour City, Tsimshatsui, HK, China. Tel.: (852) 3185-6500. Diimport & Diedarkan Oleh: Mattel Southeast Asia Pte. Ltd., No 19-1, Tower 3 Avenue 7, Bangsar South City, No 8, Jalan Kerinchi, 59200 Kuala Lumpur, Malaysia. Tel: 03-78803817, Fax: 03-78803867.

Colors and decorations may vary.



FDC43-0970-G2
1101411386-DOM

? service.mattel.com

BEFORE YOU START

SET UP
1. Snap these parts on **BEFORE** crafting.

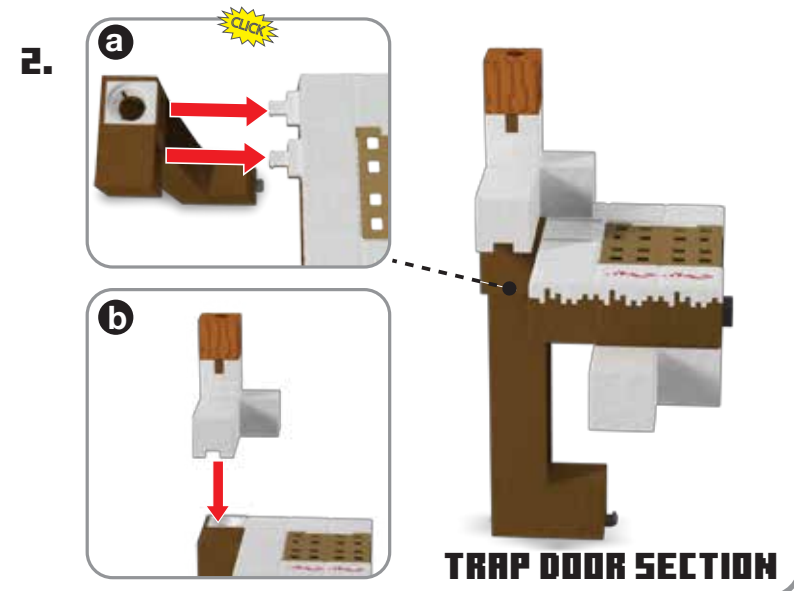
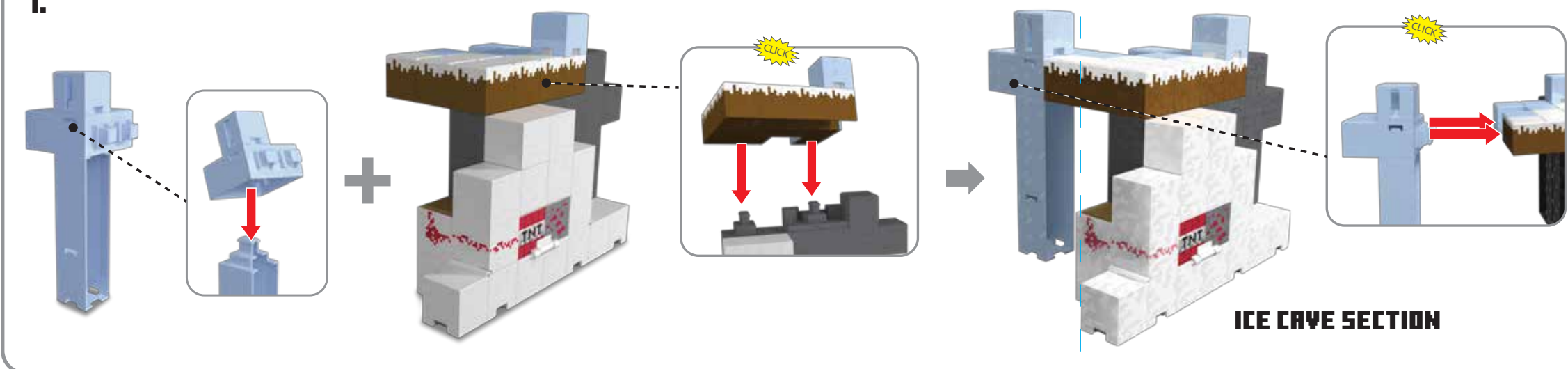

CRAFT THIS COMBINATION!

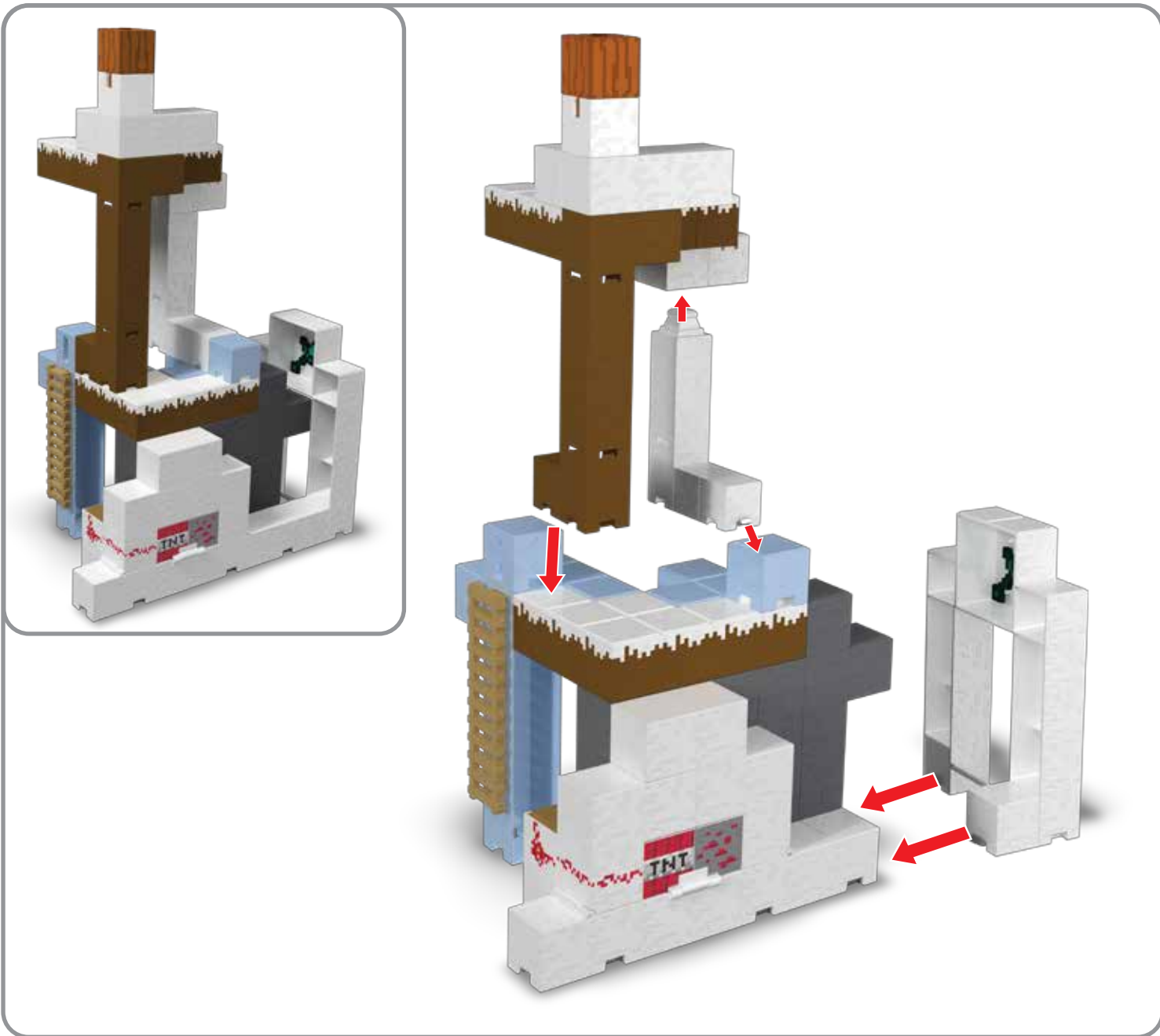

PLAY FEATURES

TRAP DOOR
1. Push hidden button to drop
Zombie Villager through the Trap Door.

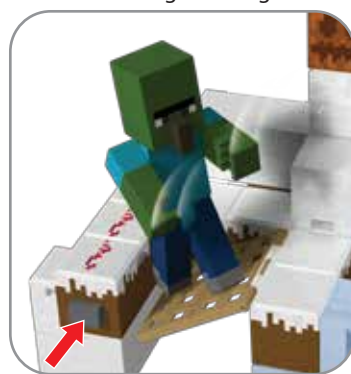

2. Reset Trap Door.

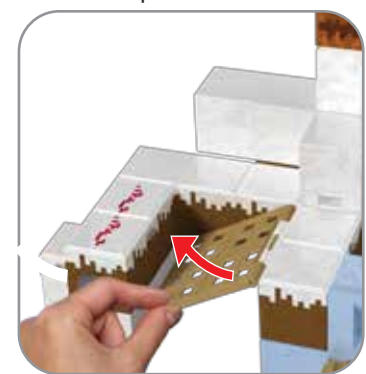

SNOW GOLEM
1. Pull pumpkin to release the Snow Golem.

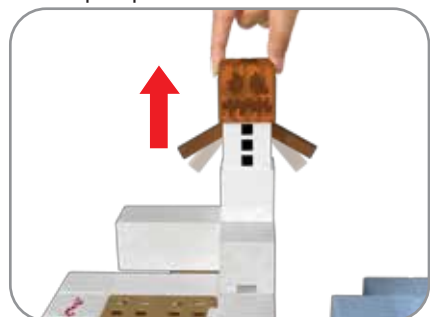

2. Push head down to reset Snow Golem.

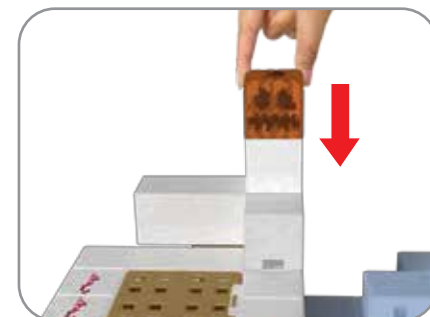

IRON BARS
1. Open the Iron gate and
snap into place.

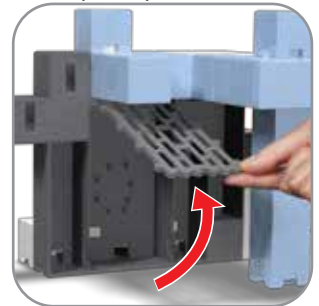

2. Store tools (not included)
behind the Iron Bars.



3. Close the Iron Bars to trap
the Zombie Villager.

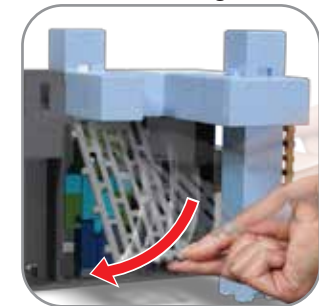

PLAY FEATURES & CONT.3

EXPLODING TNT CRATER

1. Press wooden plate for Exploding TNT Crater.



2. Discover the removable Redstone Dust in the crater hole.

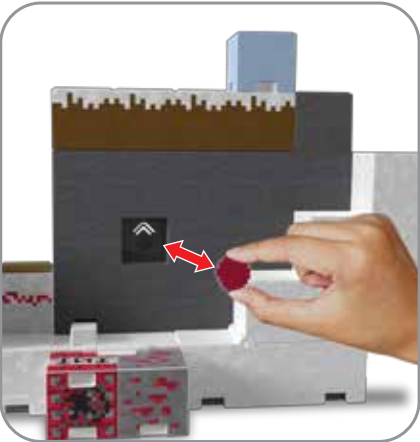

3. Close Crater.

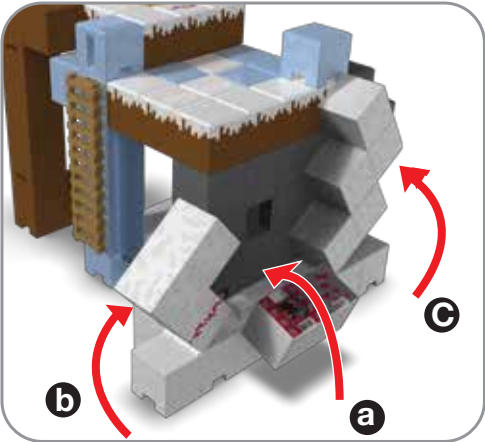

TORCHES

Torches can also be attached to any pieces with this slot.

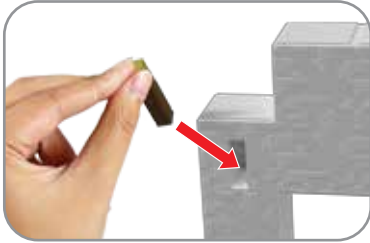
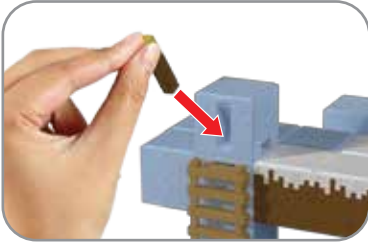

LADDER

The Ladder can be connected to any pieces with these 2 slots.

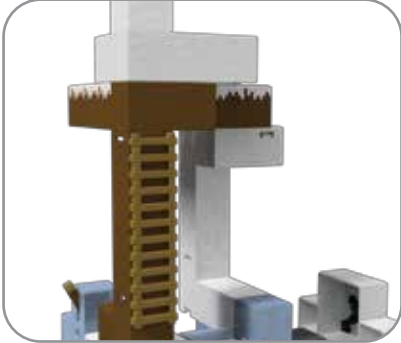
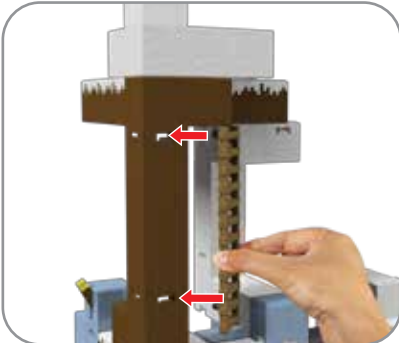

ZOMBIE VILLAGER

Push tab down to activate Zombie Villager.

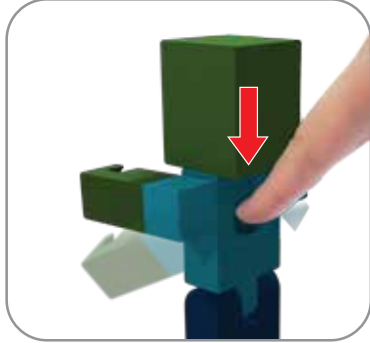

STORAGE CHEST

Apply these stickers to craft Storage Chest.

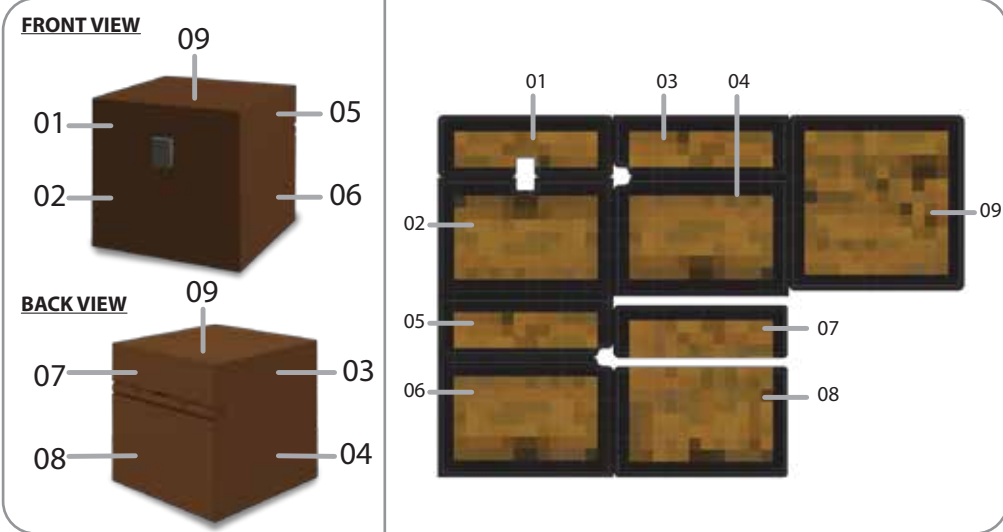

Open Storage Chest and store accessories. (not included).



TRY CRAFTING OTHER COMBINATIONS!

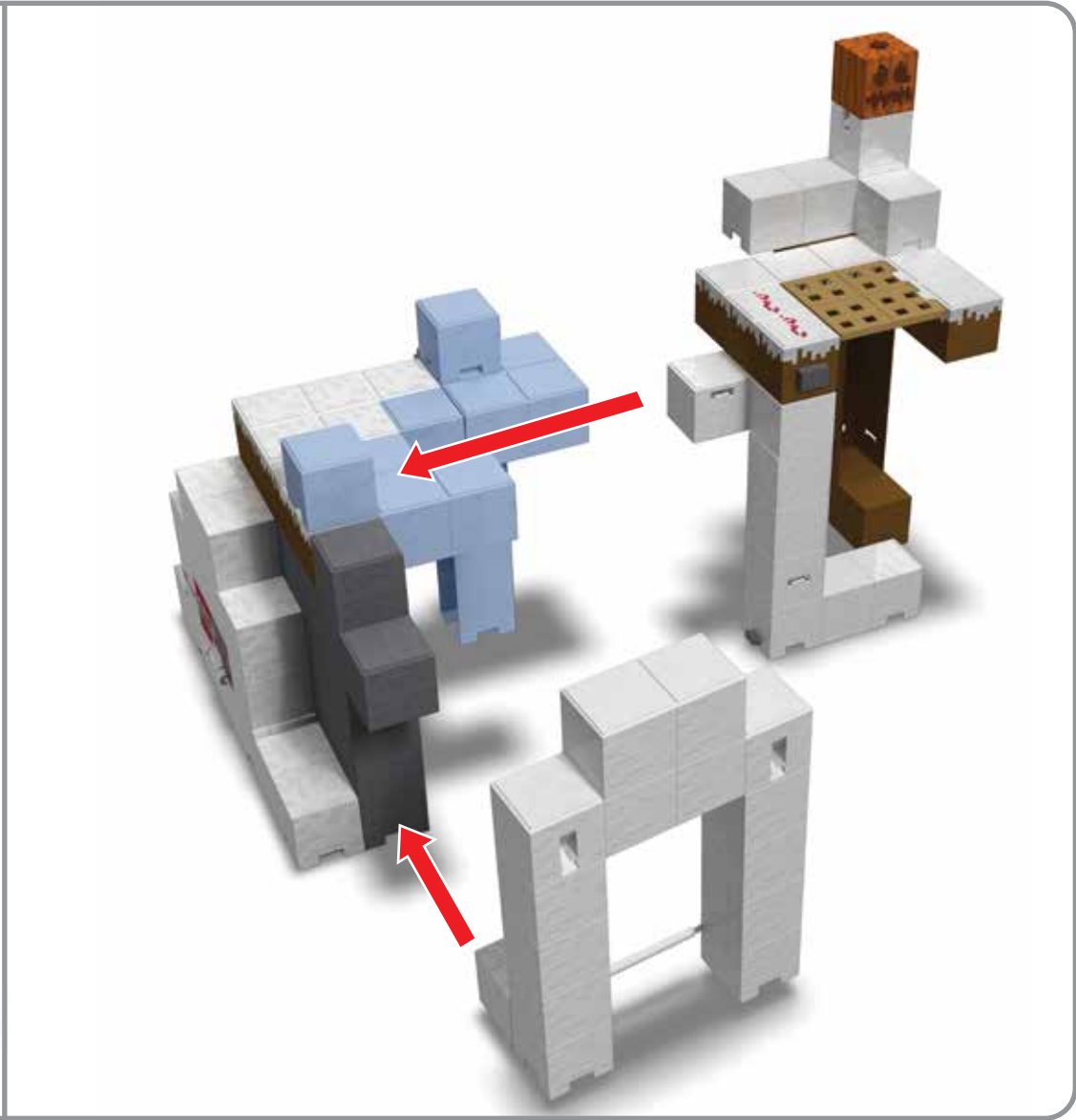
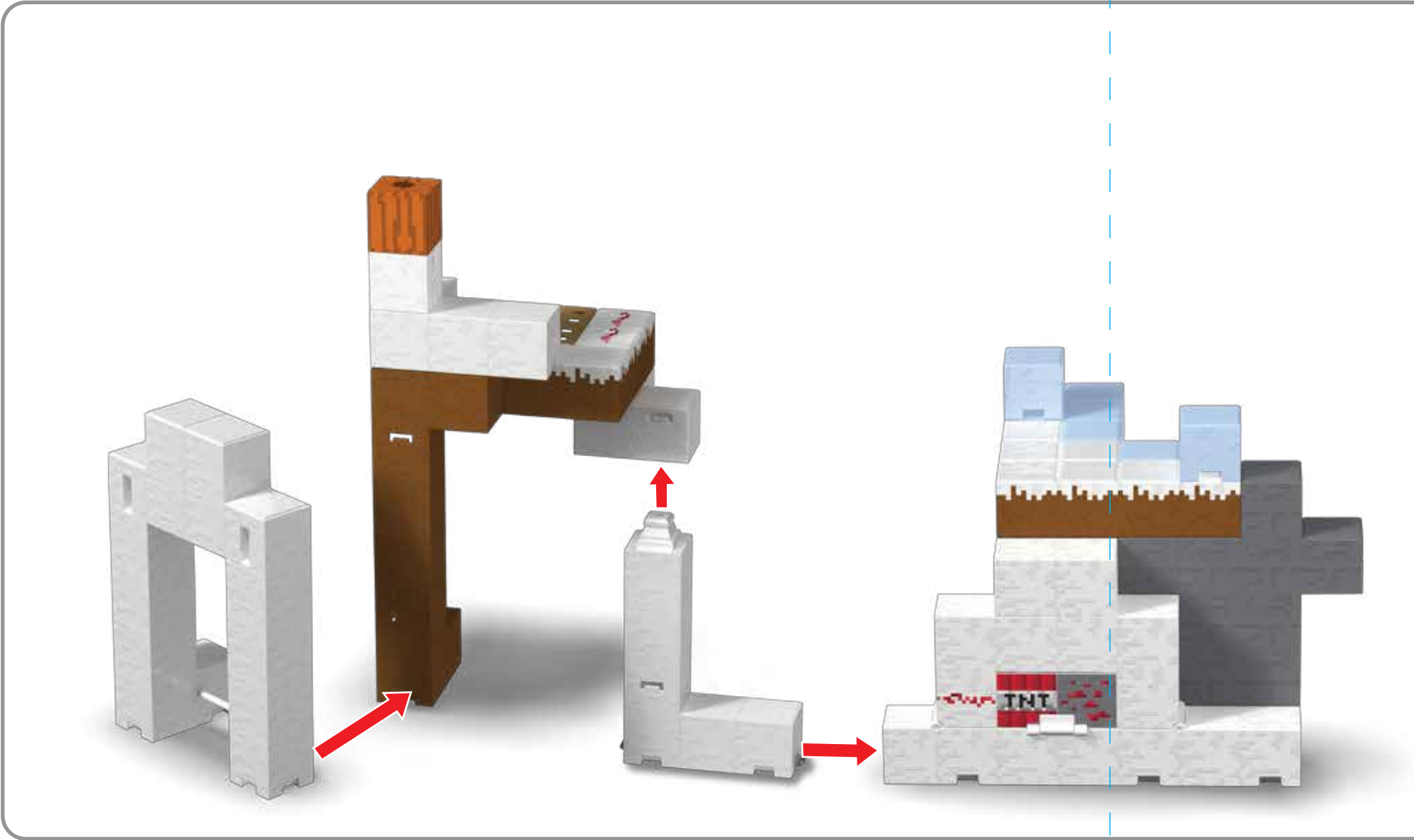

25+ COMBINATIONS TO EXPLORE!

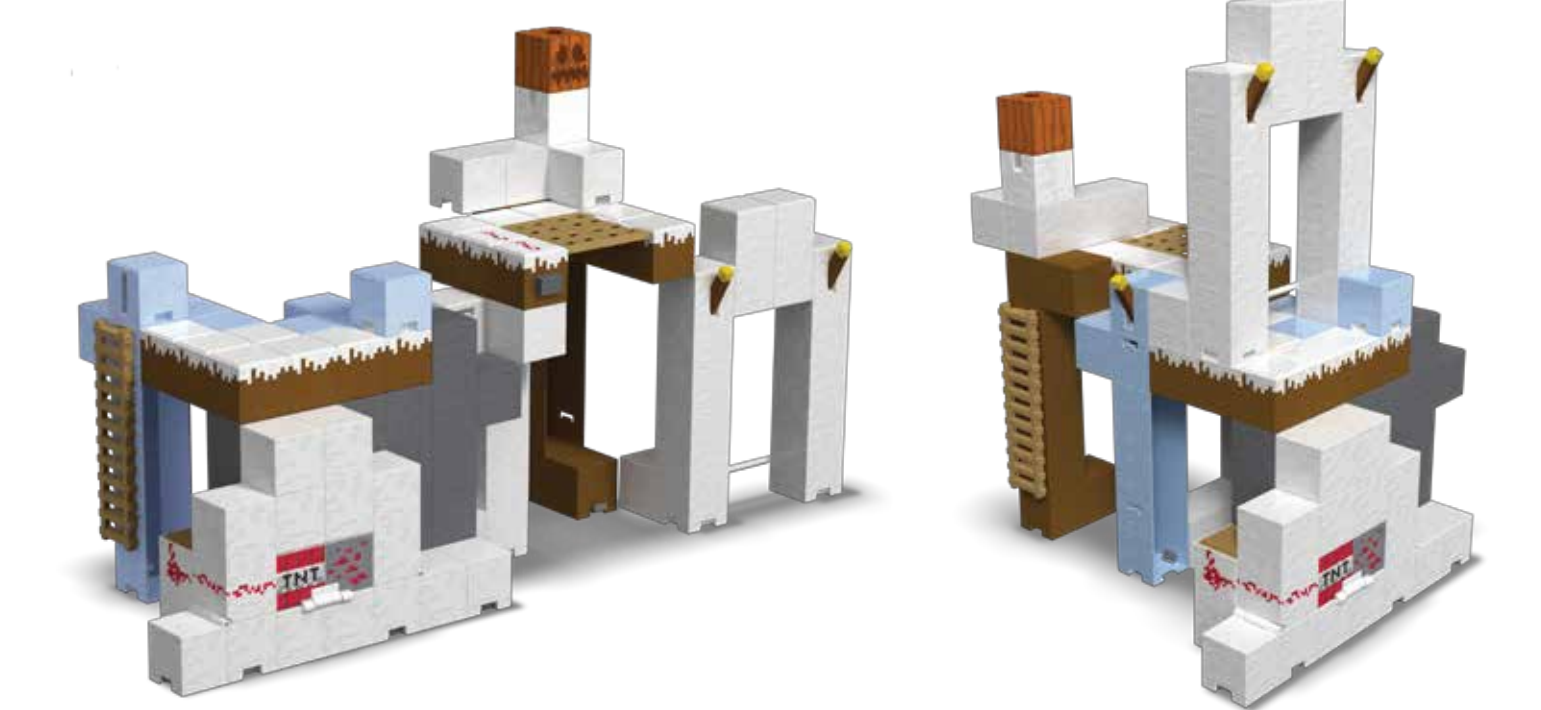

BUILD OUT YOUR MINECRAFT WORLD!

