

4+

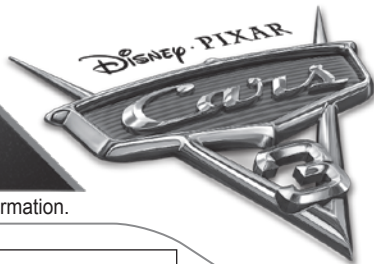

CONTENTS

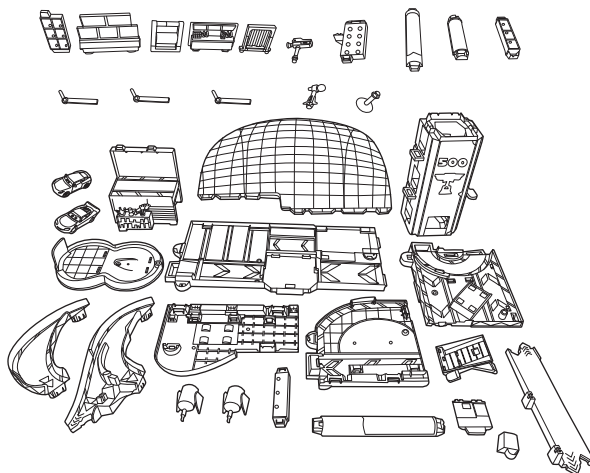

 **WARNING:**
CHOKING HAZARD – Small parts.
Not for children under 3 years.

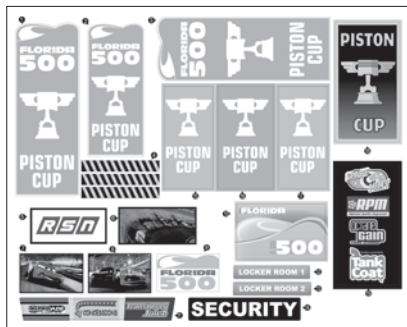

1 APPLY LABELS

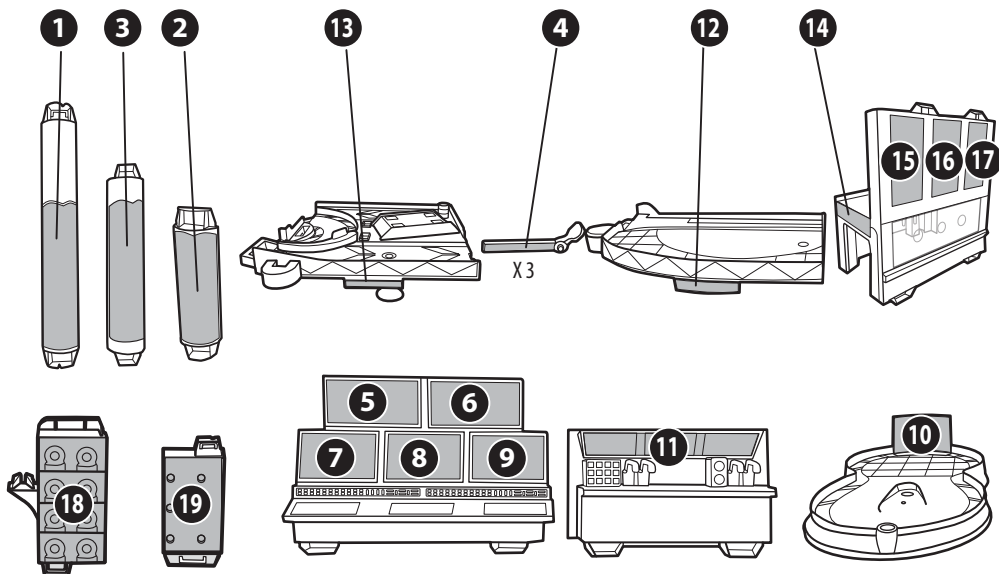

2 ASSEMBLY

①

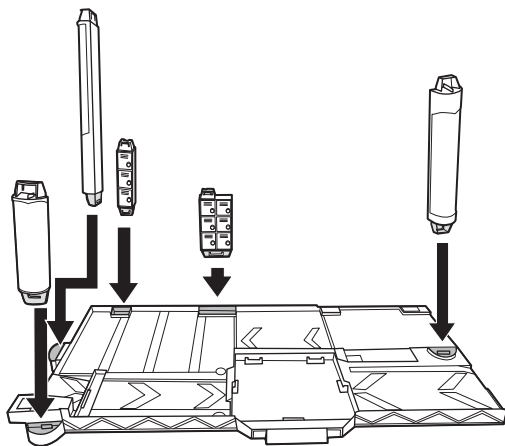

②

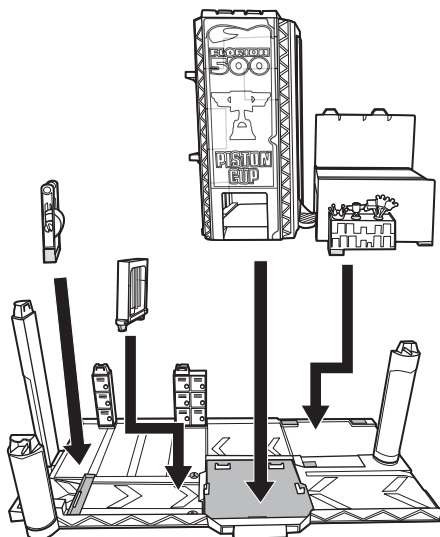

③

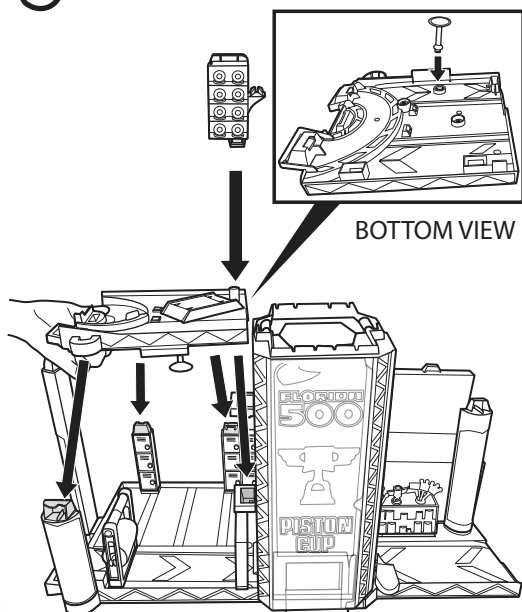

④

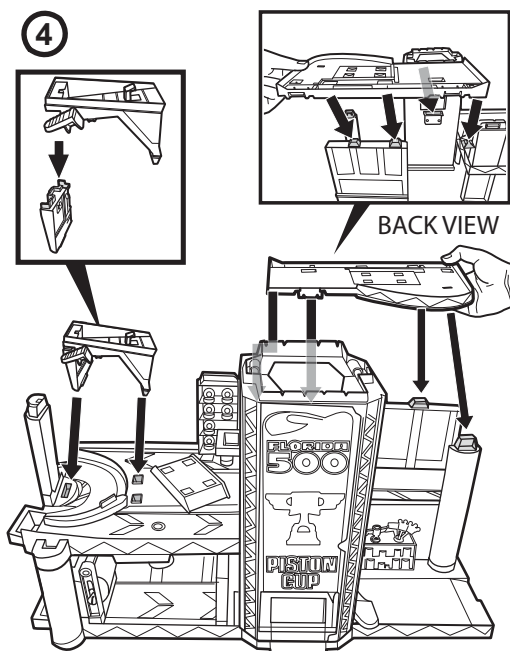

5

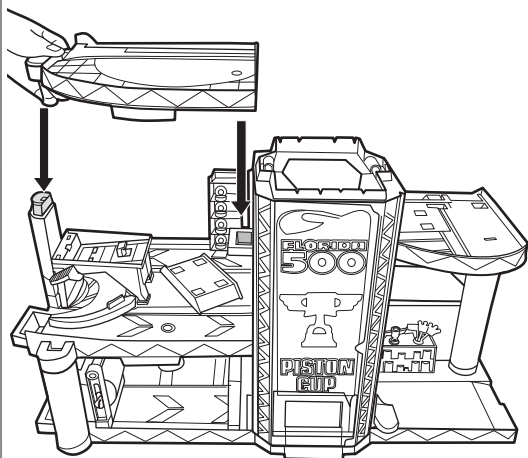

6

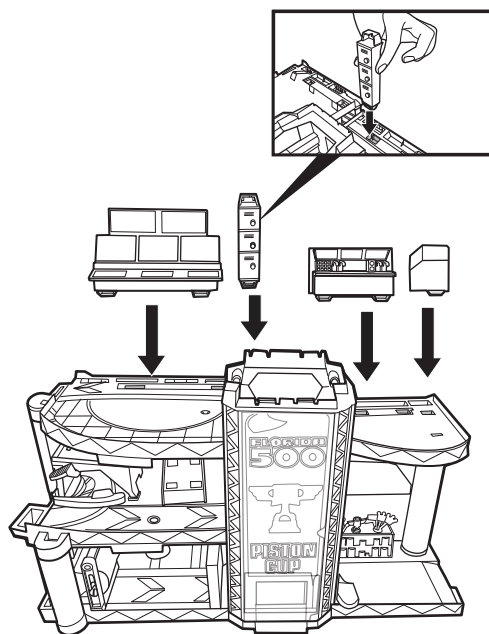

7

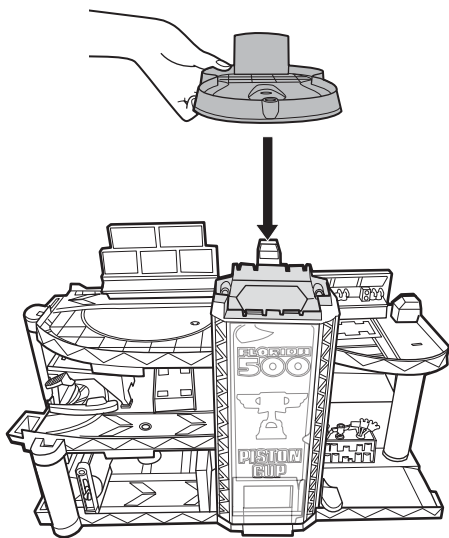

8

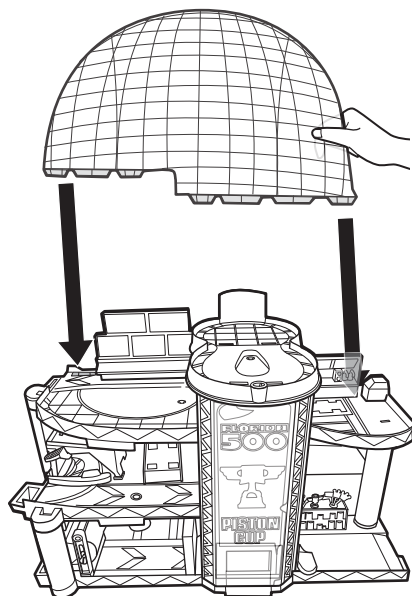

9

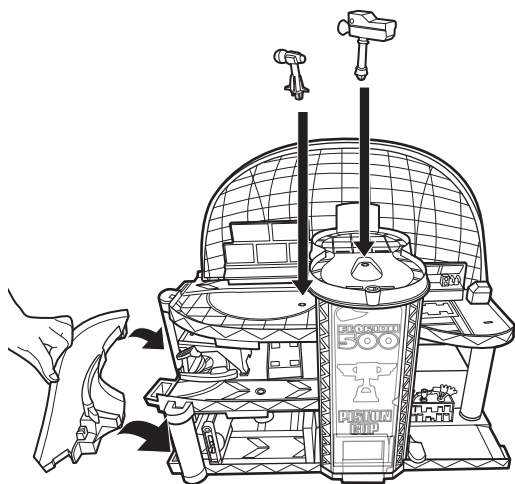

10

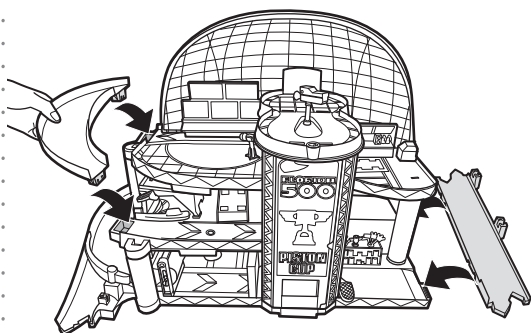

11

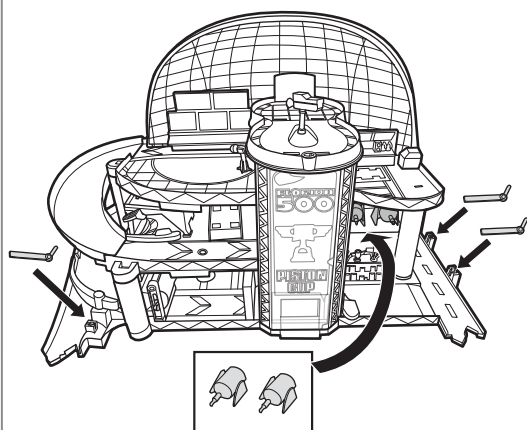

12

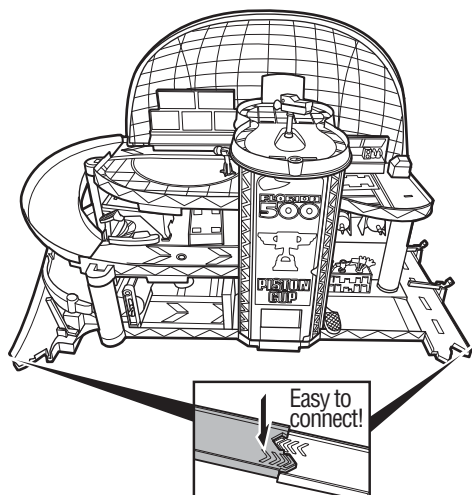

3 TO PLAY

- ① Ride up the elevator to all 3 levels! ② Roll down to the service station.

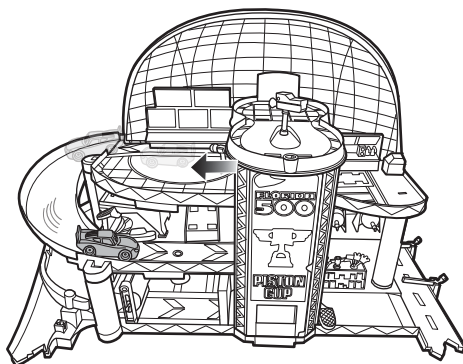
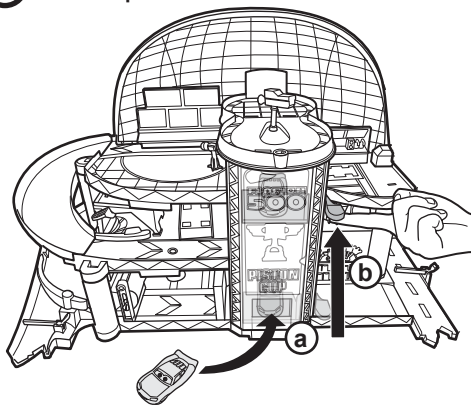

- ③ Tune-up your vehicles.

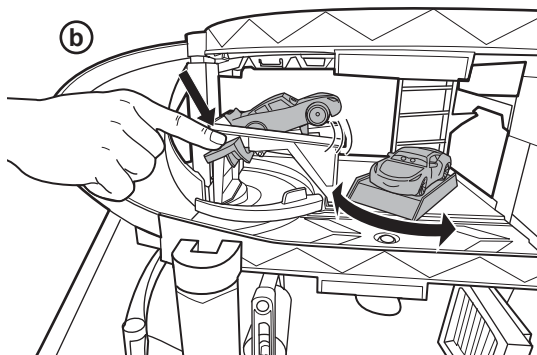
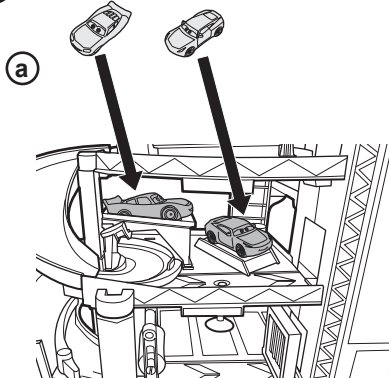

- ④ Change lanes and head down to the car wash!

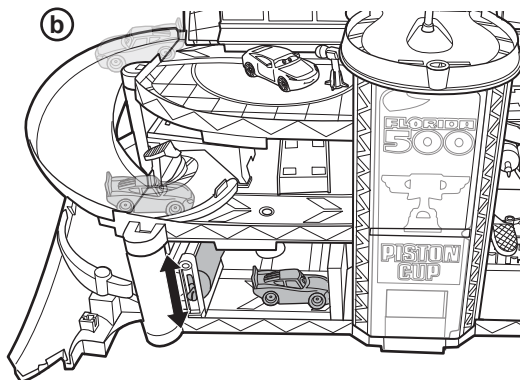
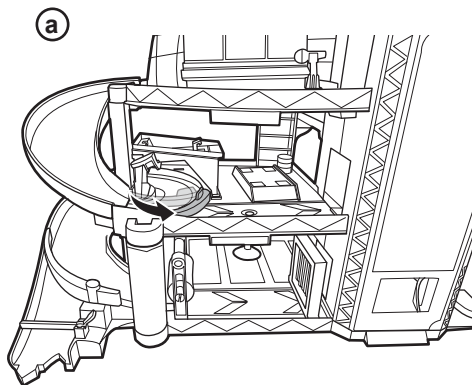

5 Get ready and race down the ramp to the next race!

a

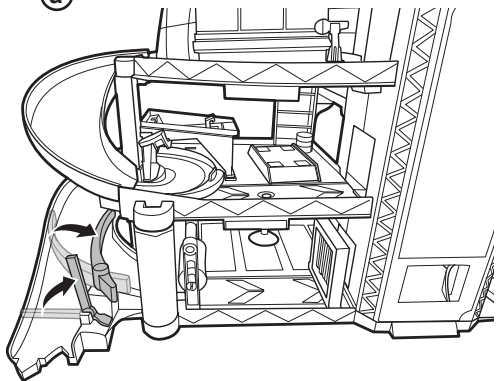

b

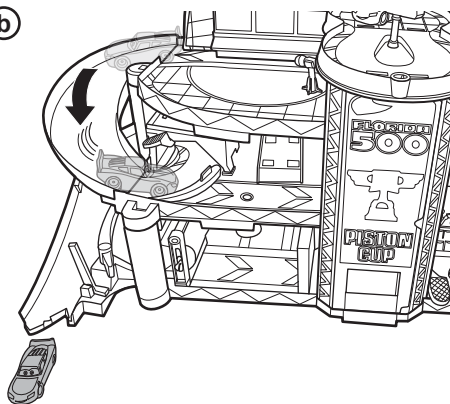

6 Load areas with vehicles.

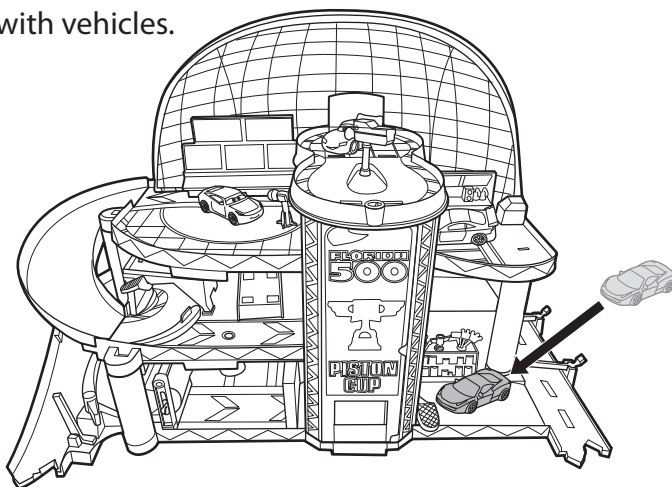

Two vehicles included. Additional vehicles sold separately. Not for use with some Cars vehicles.

©2017 Mattel. All Rights Reserved. ® and ™ designate U.S. trademarks of Mattel, except as noted. Mattel, Inc., 636 Girard Avenue, East Aurora, NY 14052, U.S.A. Consumer Services 1-800-524-8697. Mattel U.K. Ltd., Vanwall Business Park, Maidenhead SL6 4UB. Helpline 01628 500303. Mattel Australia Pty., Ltd., Richmond, Victoria. 3121. Consumer Advisory Service - 1300 135 312. Mattel East Asia Ltd., Room 503-09, North Tower, World Finance Centre, Harbour City, Tsimshatsui, HK, China. Tel.: (852) 3185-6500. Diimport & Diedarkan Oleh: Mattel Southeast Asia Pte. Ltd., No 19-1, Tower 3 Avenue 7, Bangsar South City, No 8, Jalan Kerinchi, 59200 Kuala Lumpur, Malaysia. Tel: 03-78803817, Fax: 03-78803867.