

LIFT & LOAD CARGO SET

INSTRUCTIONS

Keep these instructions for future reference as they contain important information.

What's Included

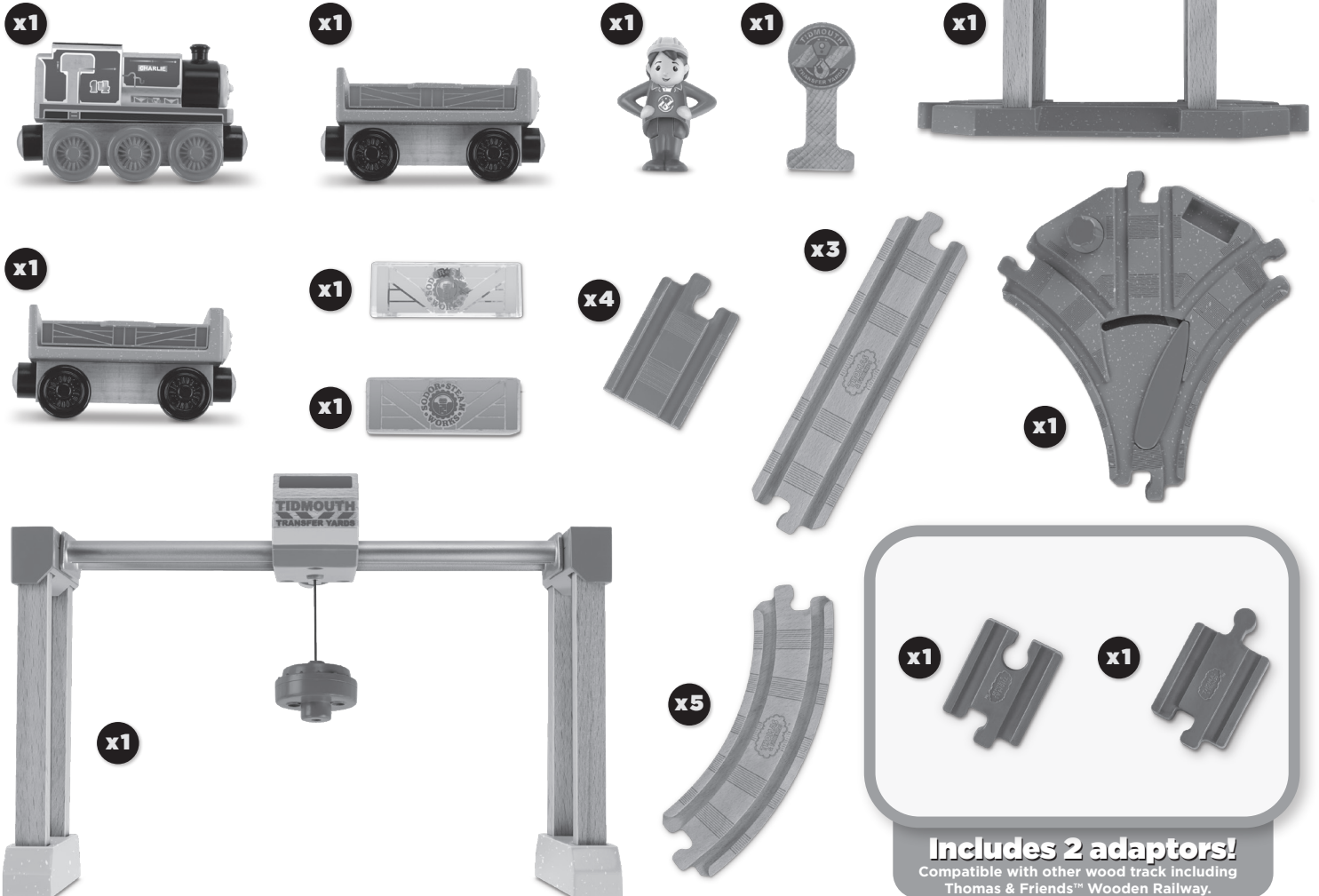

Includes 2 adaptors!
Compatible with other wood track including Thomas & Friends™ Wooden Railway.

Helpful Hint



Both sides of the crane should be assembled in the package.
However, if either side comes apart during play, you can snap them back into place as shown.

How to Play

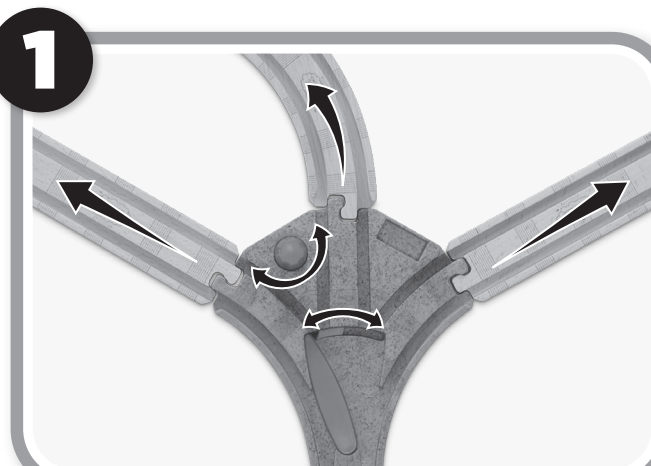

Rotate the knob to choose the direction for your engine.



Attach a Troublesome Truck to Charlie and stop them beneath the shed.

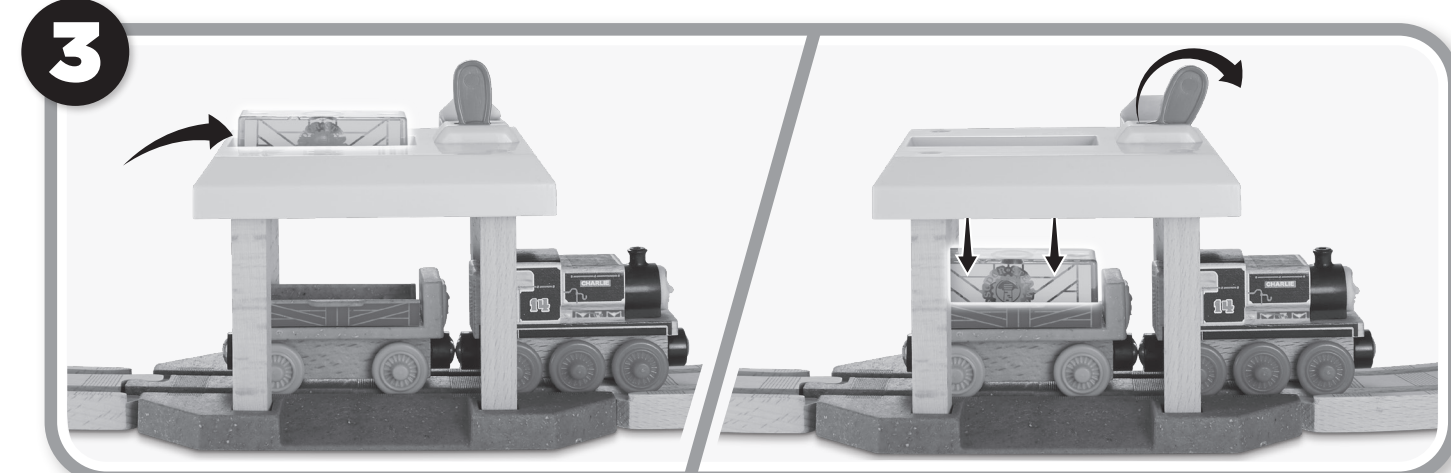

Place the cargo into the groove on the roof, then flip the lever to drop the cargo into the Troublesome Truck.

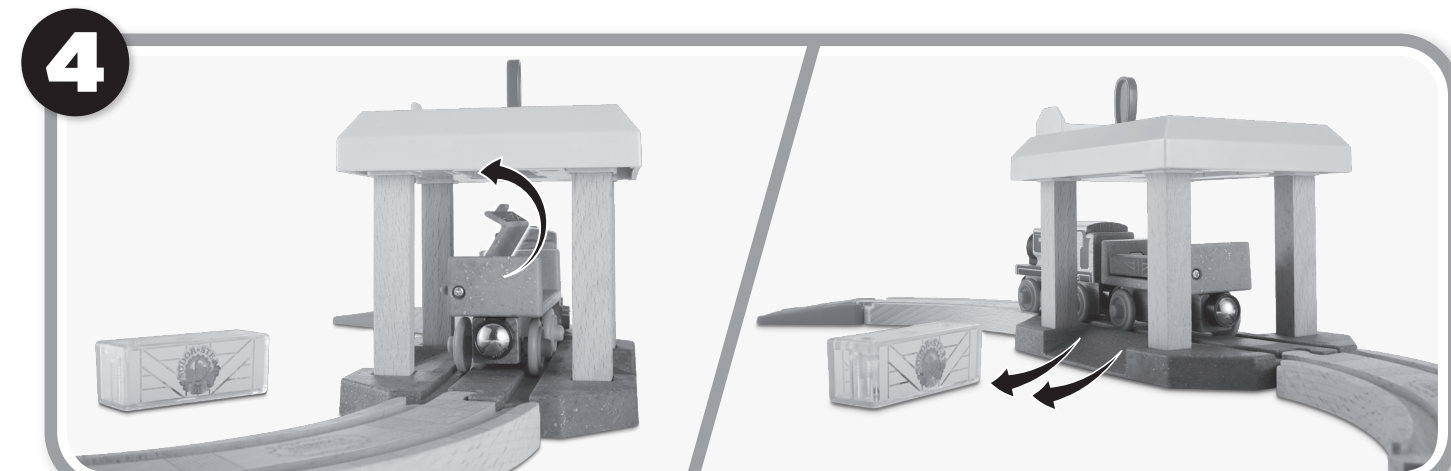

Lift the edge of the flatbed to tip the cargo out of the Troublesome Truck and down the ramp.

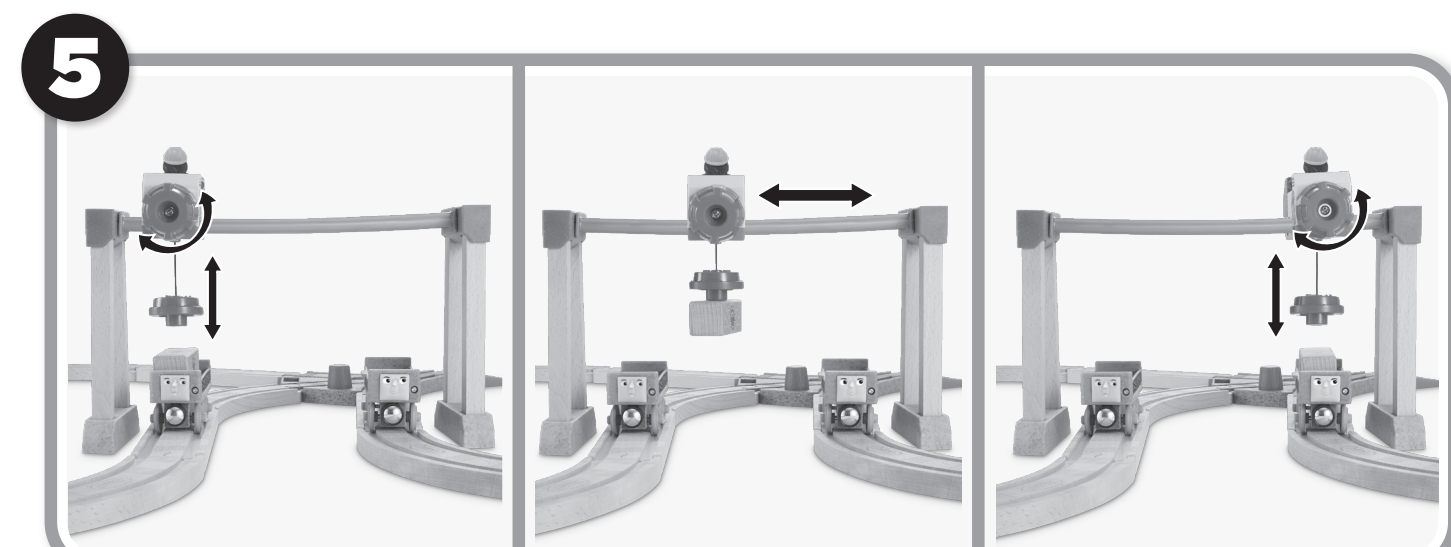

Seat the figure in the crane. Rotate the knob to lift or lower the cargo and slide the crane to shift the cargo to the other side.

Track Layout

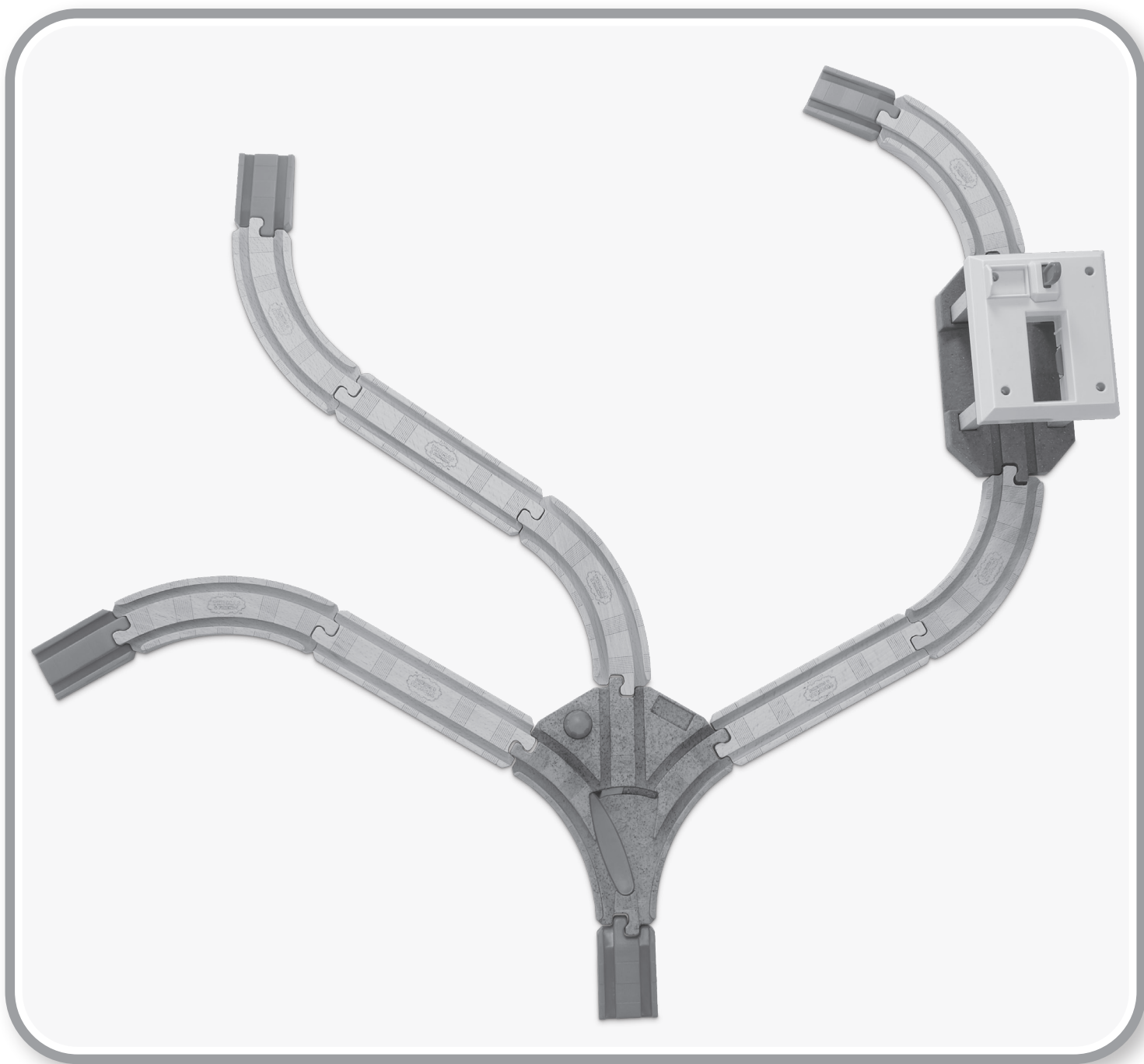

Thomas the Tank Engine & Friends™
CREATED BY BRIT ALLCROFT
Based on the Railway Series by The Reverend W Awdry.
©2017 Gullane (Thomas) Limited. Thomas the Tank Engine & Friends and Thomas & Friends are trademarks of Gullane (Thomas) Limited.
©2017 HIT Entertainment Limited. HIT and the HIT logo are trademarks of HIT Entertainment Limited.

©2017 Mattel. All Rights Reserved.
® and ™ designate U.S. trademarks of Mattel, except as noted.
PRINTED IN CHINA.
Mattel East Asia Ltd., Room 503-09, North Tower,
World Finance Centre, Harbour City, Tsimshatsui, HK, China.
Tel.: (852) 3185-6500.



CONSUMER ASSISTANCE
1-800-432-5437 (US & Canada)
1300 135 312 (Australia)
service.fisher-price.com
Fisher-Price, Inc., 636 Girard Avenue, East Aurora, NY 14052.
Hearing-impaired consumers: 1-800-382-7470.
Outside the United States:
Canada: Mattel Canada Inc., 6155 Freemont Blvd., Mississauga, Ontario L5R 3W2; www.service.mattel.com.
Great Britain: Mattel UK Ltd, Vanwall Business Park, Maidenhead SL6 4UB, Helpline: 01628 500303, www.service.mattel.com/uk
Mattel Europa B.V., Gondel 1, 1186 MJ Amstelveen, Nederland.
Australia: Mattel Australia Pty. Ltd., 658 Church Street, Locked Bag #870, Richmond, Victoria 3121 Australia.
New Zealand: 16-18 William Pickering Drive, Albany 1331, Auckland.
SOUTH AFRICA: Mattel South Africa (PTY) LTD, Office 102 I3, 30 Melrose Boulevard, Johannesburg 2196.

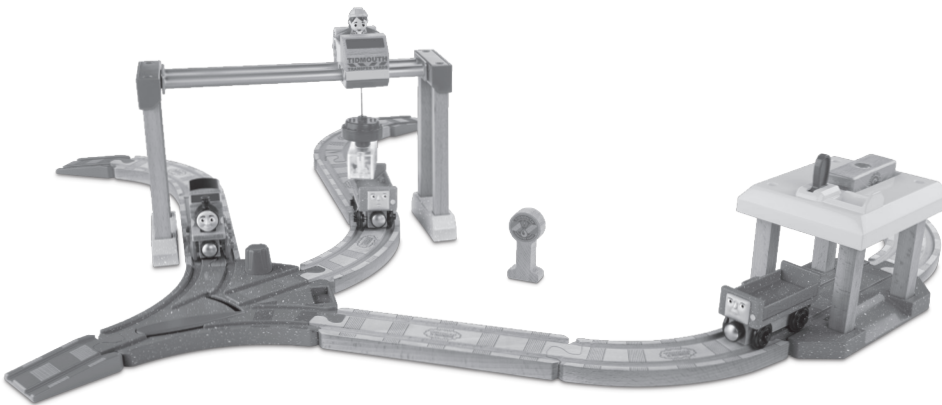

LIFT & LOAD CARGO SET
INSTRUCTIONS

Keep these instructions for future reference as they contain important information.

What's Included

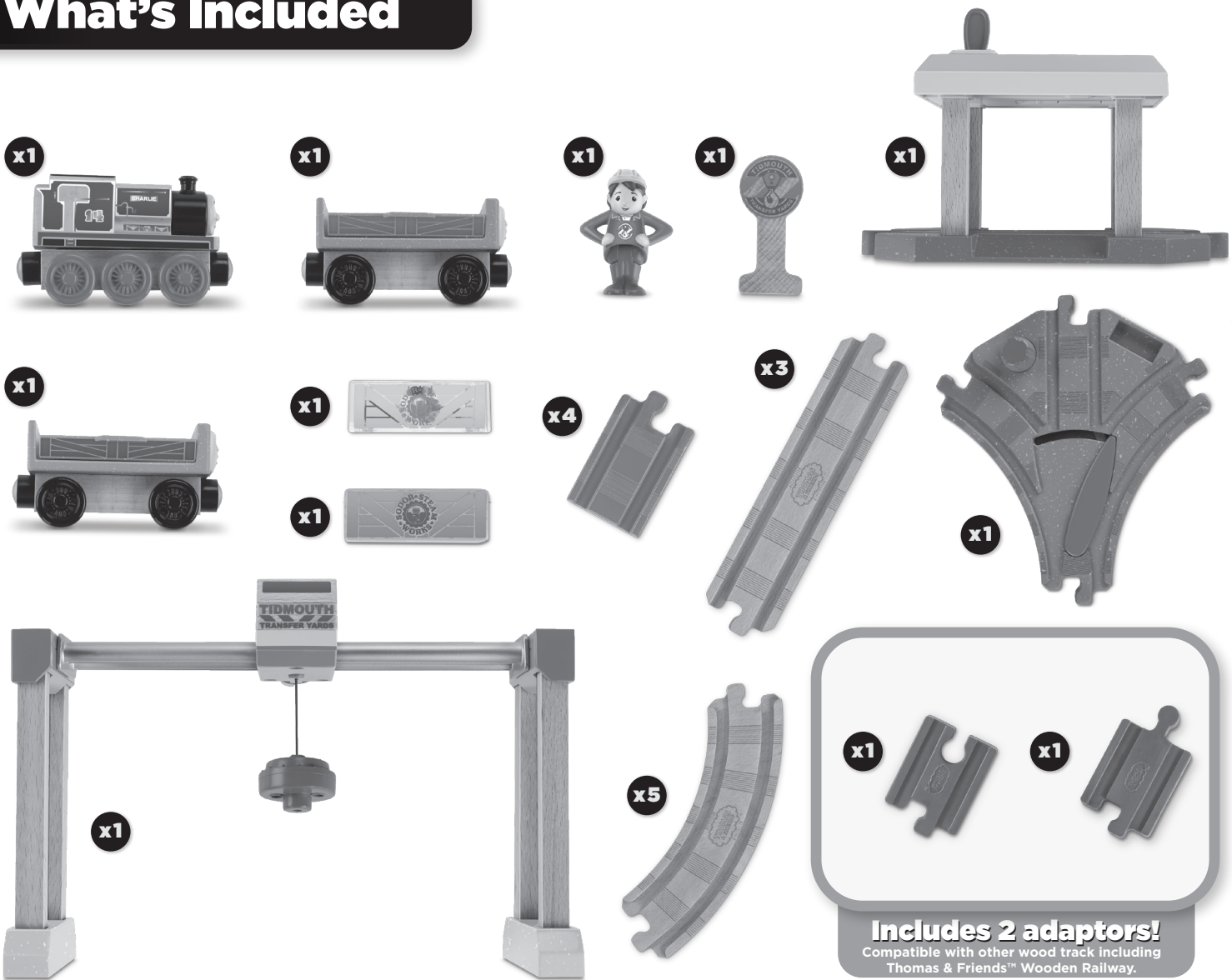

Front

Item No : FHM66-0970-1101572073-DOM_IS
Version : DOM
Size : 16.6" W x 11.7" H (A3)
Paper : 100% Recycled Paper, 70 gsm
Color : Black
Date : 8/11/2017 (Alain Li)

Instruction Sheet Size - Format 2
Sheet Size Open: 16.6" W x 11.7" H (A3)
Sheet Size Folded: 8.3" W x 11.7" H (folds to A4)

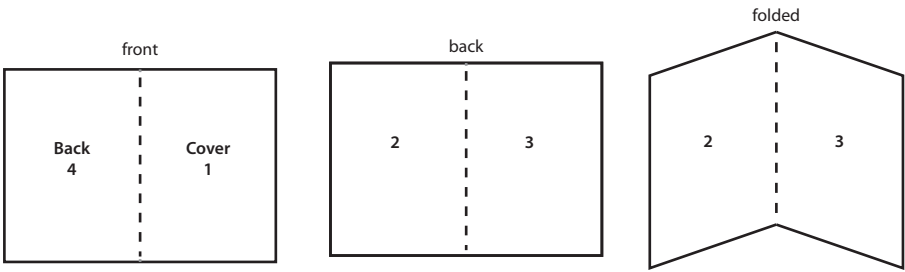

Helpful Hint



Both sides of the crane should be assembled in the package. However, if either side comes apart during play, you can snap them back into place as shown.

How to Play

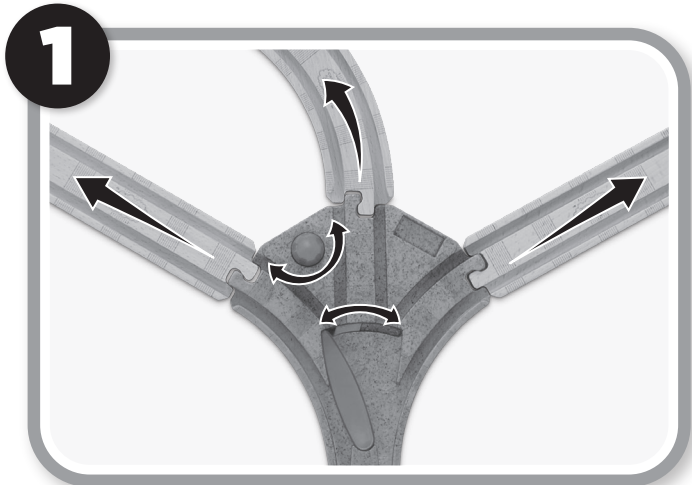

Rotate the knob to choose the direction for your engine.

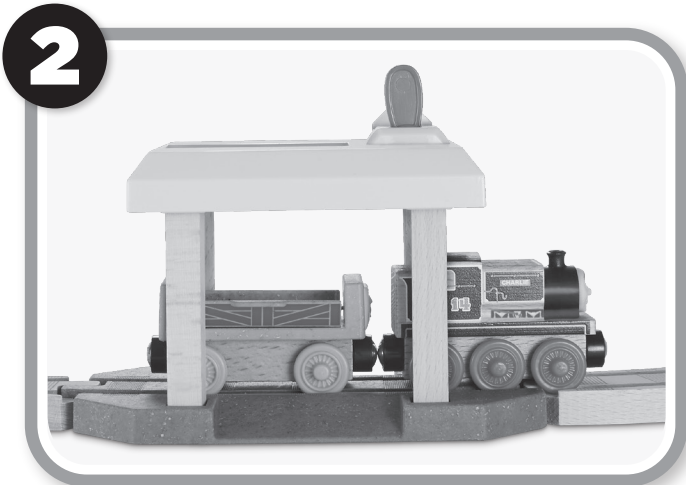

Attach a Troublesome Truck to Charlie and stop them beneath the shed.

Track Layout

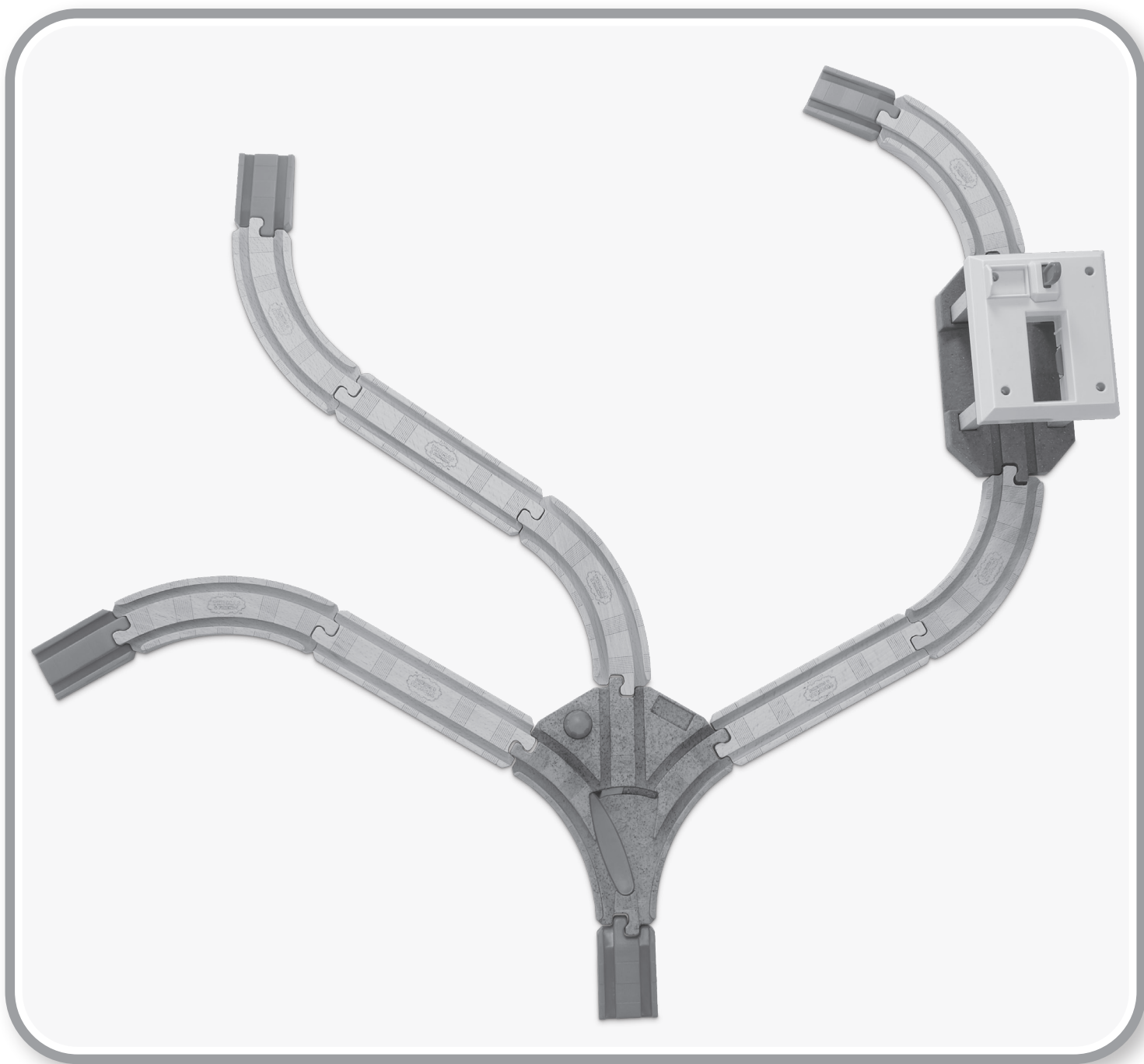

Thomas the Tank Engine & Friends™
CREATED BY BRIT ALLCROFT
Based on the Railway Series by The Reverend W Awdry.
©2017 Gullane (Thomas) Limited. Thomas the Tank Engine & Friends and Thomas & Friends are trademarks of Gullane (Thomas) Limited.
©2017 HIT Entertainment Limited. HIT and the HIT logo are trademarks of HIT Entertainment Limited.

©2017 Mattel. All Rights Reserved.
® and ™ designate U.S. trademarks of Mattel, except as noted.
PRINTED IN CHINA.
Mattel East Asia Ltd., Room 503-09, North Tower,
World Finance Centre, Harbour City, Tsimshatsui, HK, China.
Tel.: (852) 3185-6500.



CONSUMER ASSISTANCE
1-800-432-5437 (US & Canada)
1300 135 312 (Australia)
service.fisher-price.com
Fisher-Price, Inc., 636 Girard Avenue, East Aurora, NY 14052.
Hearing-impaired consumers: 1-800-382-7470.
Outside the United States:
Canada: Mattel Canada Inc., 6155 Freemont Blvd., Mississauga, Ontario L5R 3W2; www.service.mattel.com.
Great Britain: Mattel UK Ltd, Vanwall Business Park, Maidenhead SL6 4UB, Helpline: 01628 500303, www.service.mattel.com/uk
Mattel Europa B.V., Gondel 1, 1186 MJ Amstelveen, Nederland.
Australia: Mattel Australia Pty. Ltd., 658 Church Street, Locked Bag #870, Richmond, Victoria 3121 Australia.
New Zealand: 16-18 William Pickering Drive, Albany 1331, Auckland.
SOUTH AFRICA: Mattel South Africa (PTY) LTD, Office 102 I3, 30 Melrose Boulevard, Johannesburg 2196.

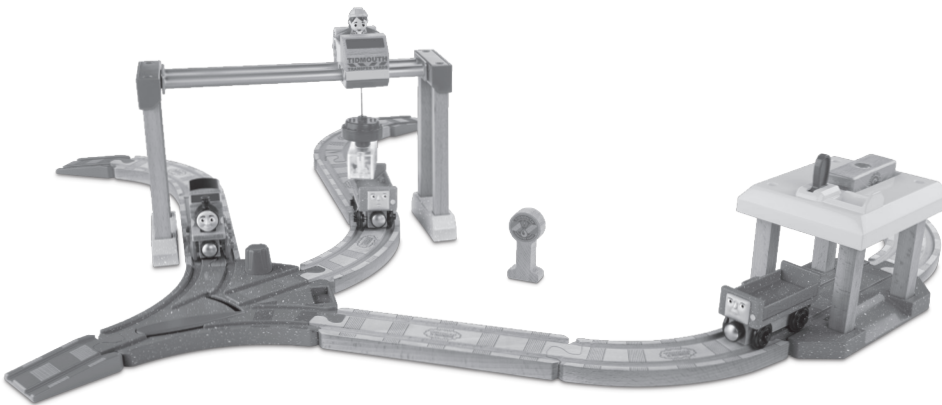

LIFT & LOAD CARGO SET
INSTRUCTIONS

Keep these instructions for future reference as they contain important information.

What's Included

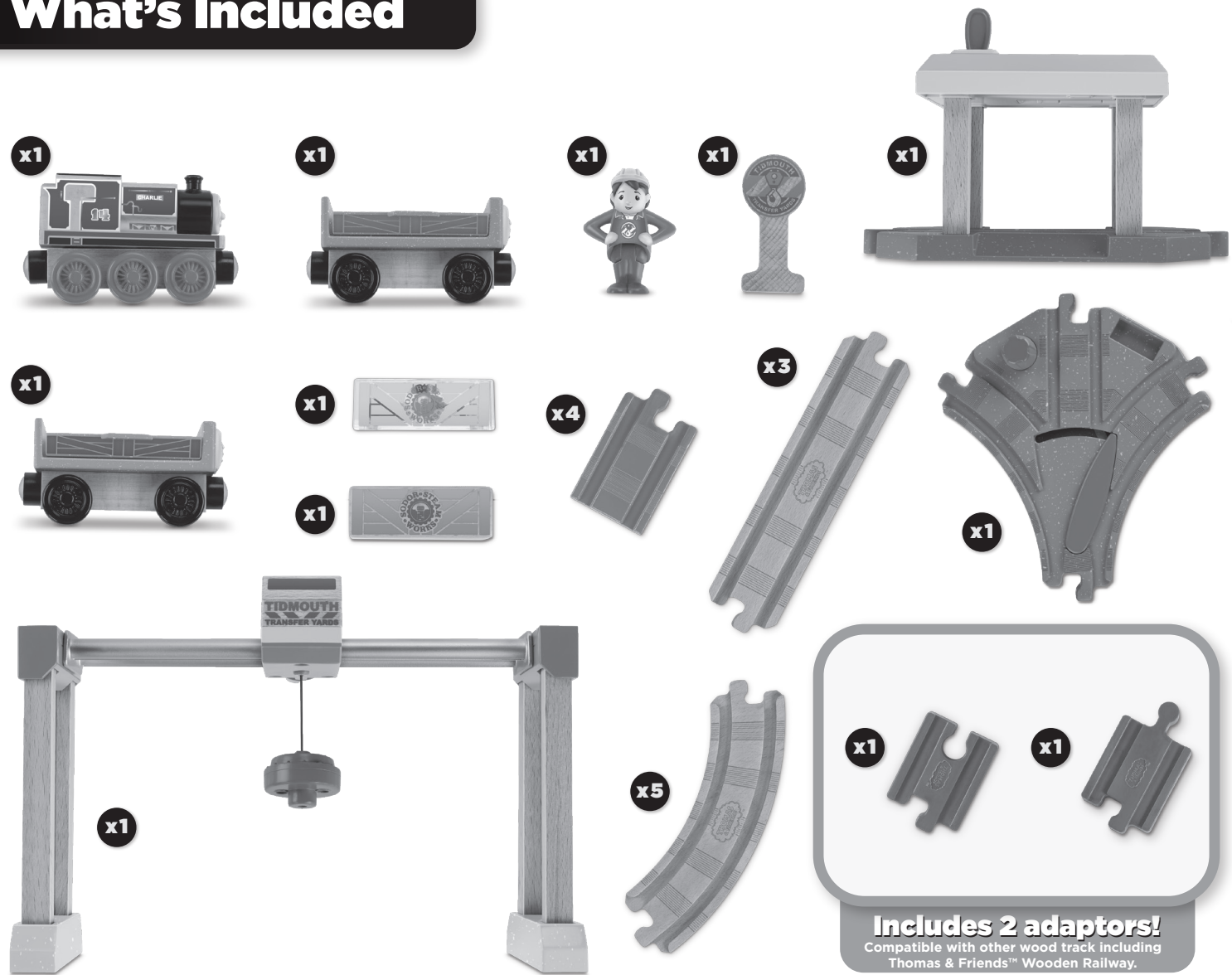

Includes 2 adaptors!
Compatible with other wood track including Thomas & Friends™ Wooden Railway.

Front

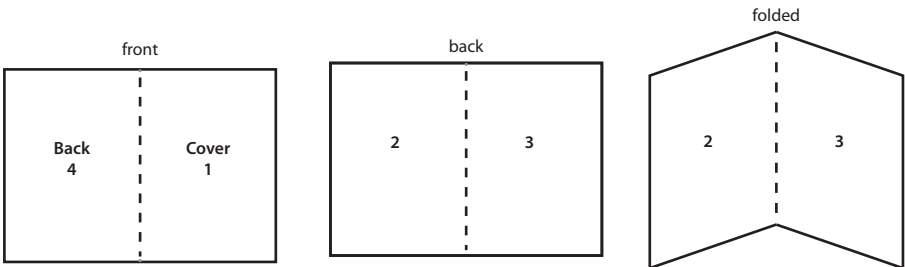

Item No : FHM66-0970-1101572073-DOM_IS
Version : DOM
Size : 16.6" W x 11.7" H (A3)
Paper : 100% Recycled Paper, 70 gsm
Color : Black
Date : 8/11/2017 (Alain Li)

Instruction Sheet Size - Format 2
Sheet Size Open: 16.6" W x 11.7" H (A3)
Sheet Size Folded: 8.3" W x 11.7" H (folds to A4)

3

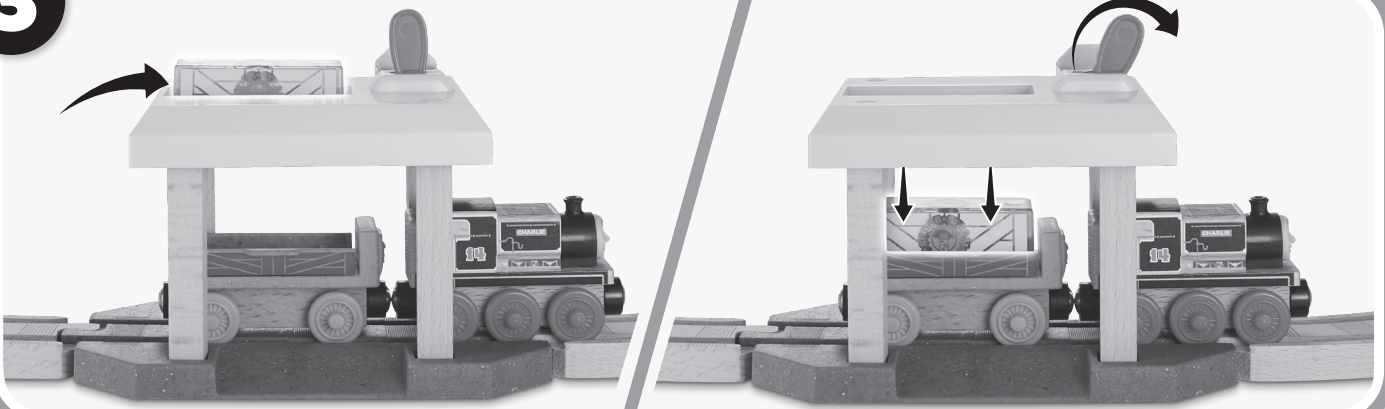

Place the cargo into the groove on the roof, then flip the lever to drop the cargo into the Troublesome Truck.

4

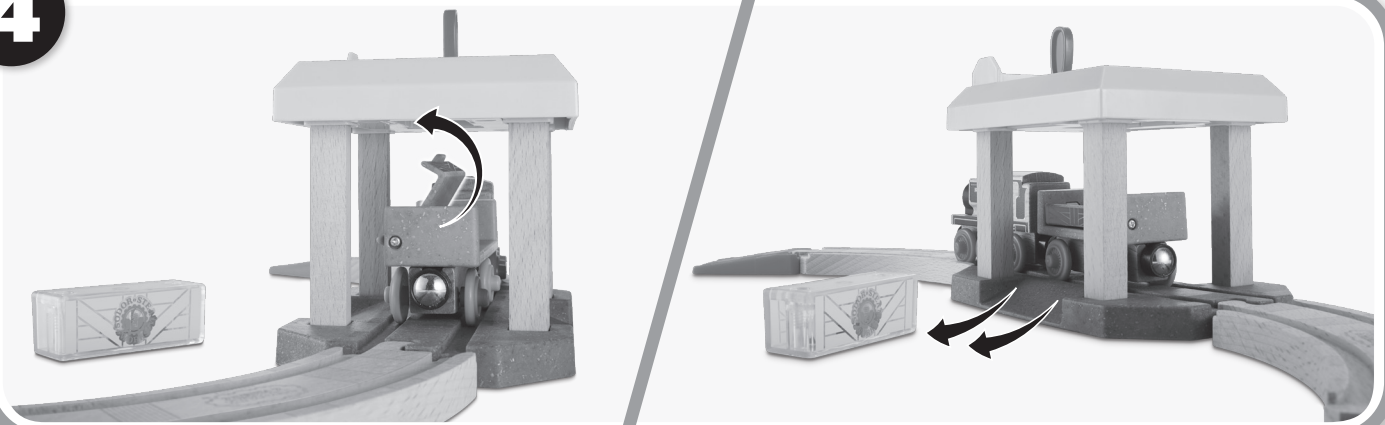

Lift the edge of the flatbed to tip the cargo out of the Troublesome Truck and down the ramp.

5

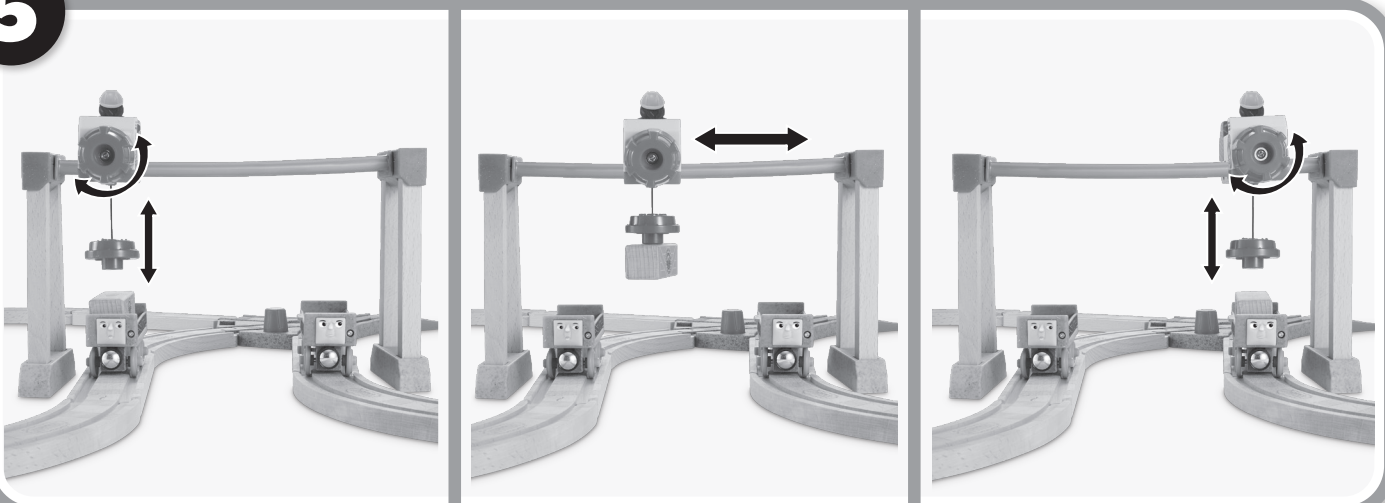

Seat the figure in the crane. Rotate the knob to lift or lower the cargo and slide the crane to shift the cargo to the other side.

Track Layout



Thomas the Tank Engine & Friends™



CREATED BY BRIT ALLCROFT

Based on the Railway Series by The Reverend W Awdry.

©2017 Gullane (Thomas) Limited. Thomas the Tank Engine & Friends and Thomas & Friends are trademarks of Gullane (Thomas) Limited.

©2017 HIT Entertainment Limited. HIT and the HIT logo are trademarks of HIT Entertainment Limited.

©2017 Mattel. All Rights Reserved.

* and ™ designate U.S. trademarks of Mattel, except as noted.

PRINTED IN CHINA.

Mattel East Asia Ltd., Room 503-09, North Tower,
World Finance Centre, Harbour City, Tsimshatsui, HK, China.
Tel.: (852) 3185-6500.



FHM66

FHM66-0970
1101572073-DOM



HIT entertainment

Fisher-Price®

?

CONSUMER ASSISTANCE

1-800-432-5437 (US & Canada)
1300 135 312 (Australia)

service.fisher-price.com

Fisher-Price, Inc., 636 Girard Avenue, East Aurora, NY 14052.
Hearing-impaired consumers: 1-800-382-7470.

Outside the United States:

Canada: Mattel Canada Inc., 6155 Freemont Blvd.,
Mississauga, Ontario L5R 3W2; www.service.mattel.com.
Great Britain: Mattel UK Ltd, Vanwall Business Park,
Maidenhead SL6 4UB. Helpline: 01628 500303.
www.service.mattel.com/uk
Mattel Europa B.V., Gondel 1, 1186 MJ Amstelveen, Nederland.
Australia: Mattel Australia Pty. Ltd., 658 Church Street,
Locked Bag #870, Richmond, Victoria 3121 Australia.
New Zealand: 16-18 William Pickering Drive,
Albany 1331, Auckland.
SOUTH AFRICA: Mattel South Africa (PTY) LTD, Office 102 I3,
30 Melrose Boulevard, Johannesburg 2196.

Helpful Hint



Both sides of the crane should be assembled in the package.
However, if either side comes apart during play, you can snap them back into place as shown.

How to Play

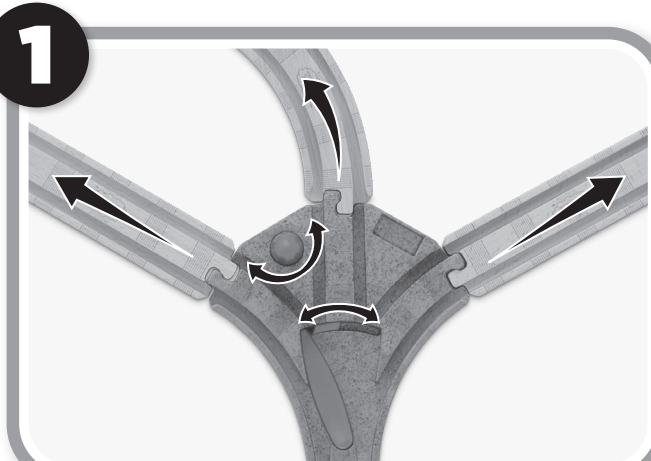

Rotate the knob to choose the direction
for your engine.

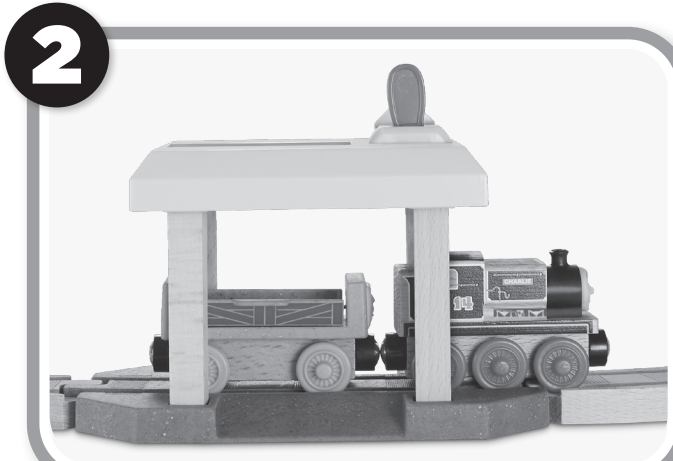

Attach a Troublesome Truck to Charlie and
stop them beneath the shed.

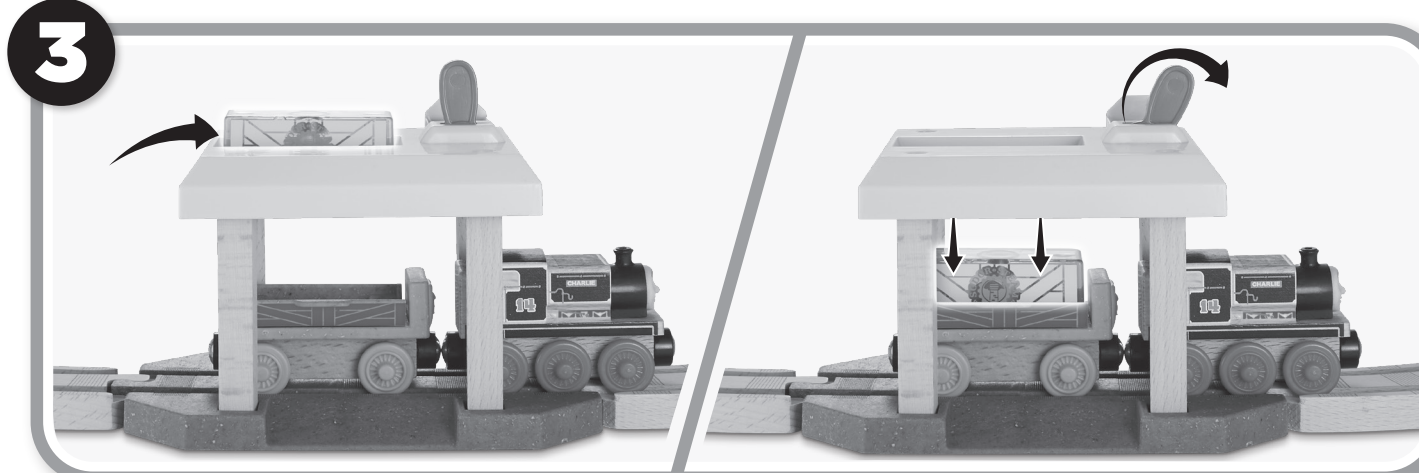

Place the cargo into the groove on the roof, then flip the lever to drop the cargo into the Troublesome Truck.

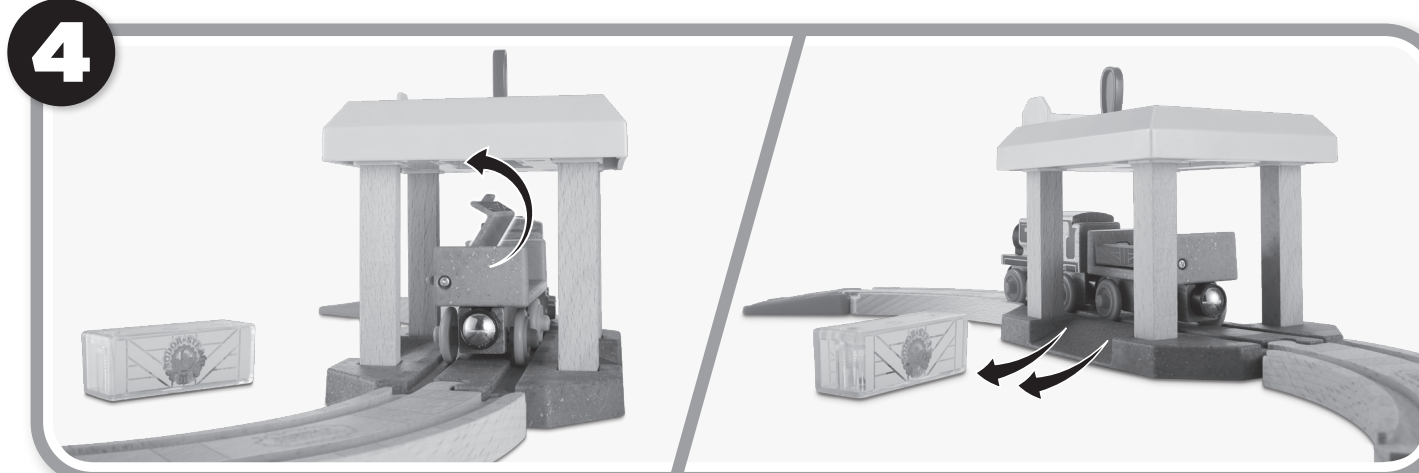

Lift the edge of the flatbed to tip the cargo out of the Troublesome Truck and down the ramp.

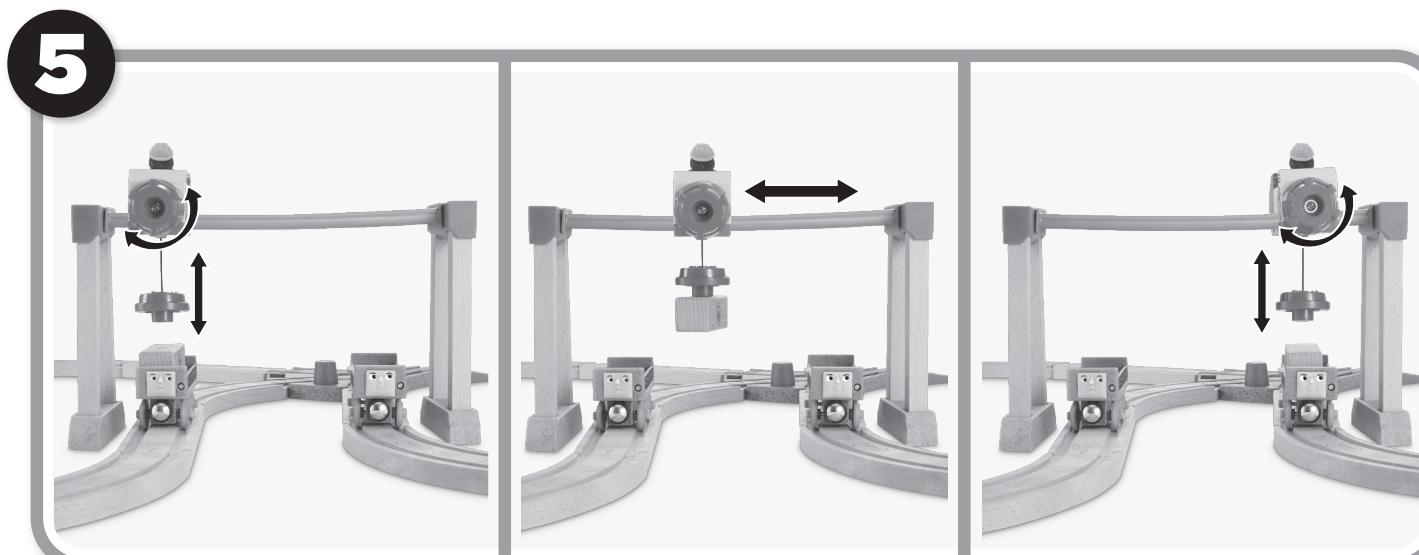

Seat the figure in the crane. Rotate the knob to lift or lower the cargo and slide the crane
to shift the cargo to the other side.

Back

Item No : FHM66-0970-1101572073-DOM_IS
Version : DOM
Size : 16.6" W x 11.7" H (A3)
Paper : 100% Recycled Paper, 70 gsm
Color : Black
Date : 8/11/2017 (Alain Li)

Instruction Sheet Size - Format 2
Sheet Size Open: 16.6" W x 11.7" H (A3)
Sheet Size Folded: 8.3" W x 11.7" H (folds to A4)

