

How To Play

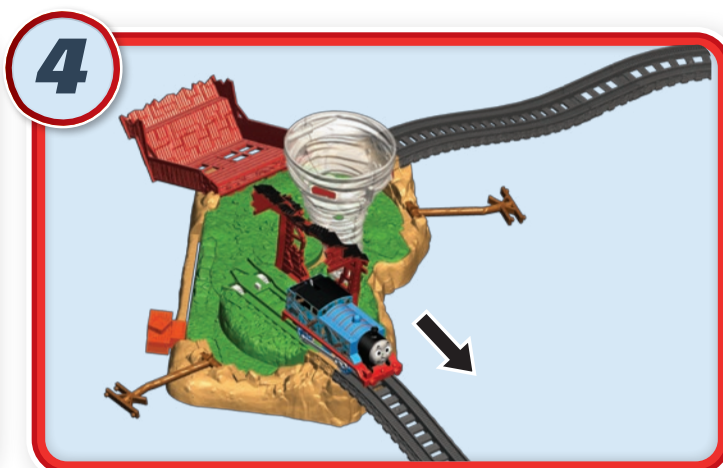

The shed splits in half, the tornado knocks down the utility poles and Thomas spins to the other side.



Thomas continues safely on his way.

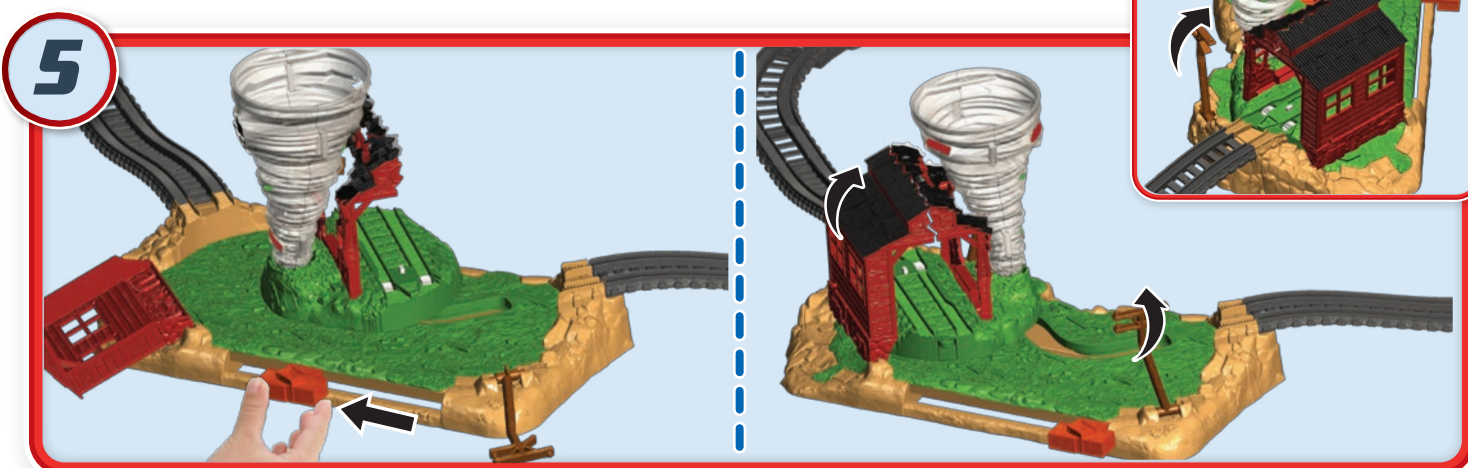

Rush to reset the shed, tornado and utility poles before Thomas makes his way back around!



Protect the environment by not disposing of this product or any batteries with household waste. This symbol indicates that this product shall not be treated as household waste. Check your local authority for recycling advice and facilities.

CAUTION:
To prevent entanglement, keep hair away from wheels.

CONSUMER ASSISTANCE

1-800-432-5437 (US & Canada)
1300 135 312 (Australia)
service.fisher-price.com

Fisher-Price, Inc. 626 Grand Avenue, East Aurora, NY 14052.
Hearing-impaired consumers: 1-800-382-7470.

Outside the United States:

Canada: Mattel Canada Inc., 6155 Freemont Blvd., Mississauga, Ontario L5R 3W2; www.service.mattel.com.
Great Britain: Mattel UK Ltd, Varwell Business Park, Maidenhod SL6 4UG, Heltline: 01628 500303; www.service.mattel.com/uk.
Australia: Mattel Australia Pty. Ltd., G58 Church Street, Locked Bag #870, Richmond, Victoria 3121, Australia.
New Zealand: 16-18 William Pickering Drive, Albany 3231, Auckland.
SOUTH AFRICA: Mattel South Africa (PTY) LTD, Office 102 E3, 30 Melrose Boulevard, Johannesburg 2196.

Thomas the Tank Engine & Friends™
CREATED BY BRITT ALLCROFT

Based on the Railway Series by The Reverend W Awdry.
©2017 Gullane (Thomas) Limited. Thomas the Tank Engine & Friends and Thomas & Friends are trademarks of Gullane (Thomas) Limited.
©2017 HIT Entertainment Limited. HIT and the HIT logo are trademarks of HIT Entertainment Limited.
©2017 Mattel. All Rights Reserved.
™ and ® designate U.S. trademarks of Mattel, except as noted.
PRINTED IN CHINA. Mattel East Asia Ltd., Room 503-09, North Tower, World Finance Centre, Harbour City, Tsimshatsui, HK, China.
Tel.: (852) 3185-6500.

FJK25



FJK25-0970 1101549931-DOM

THOMAS & FRIENDS TRACK MASTER™

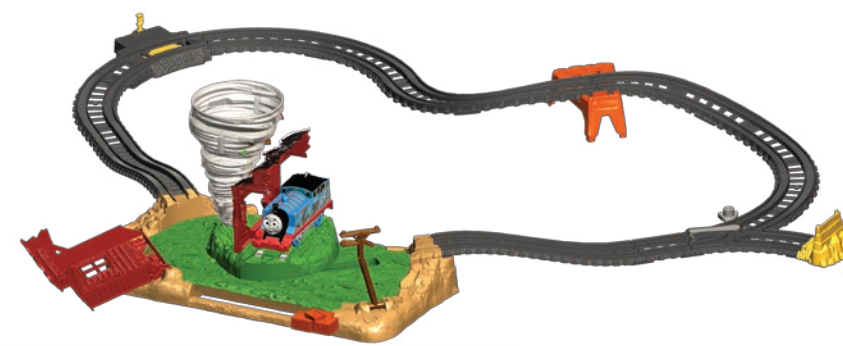

TWISTING TORNADO SET

INSTRUCTIONS

Keep these instructions for future reference as they contain important information.

What's Included

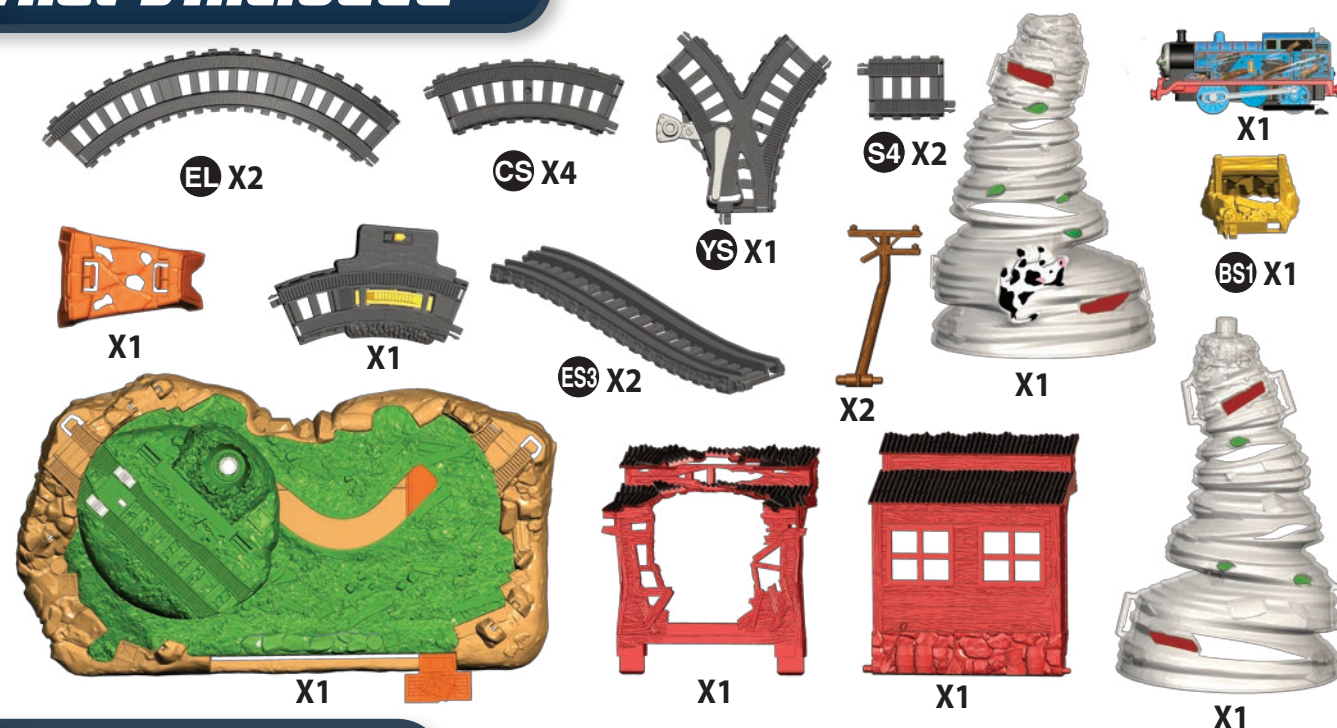

Helpful Hints

Track marking codes are found on the bottom of tracks.

Some track sections (ES3, EL) are intentionally curved, they are not damaged.

Note: Some engines may not work on this track set.

ADULT ASSEMBLY REQUIRED.
No tools needed.

Assembly

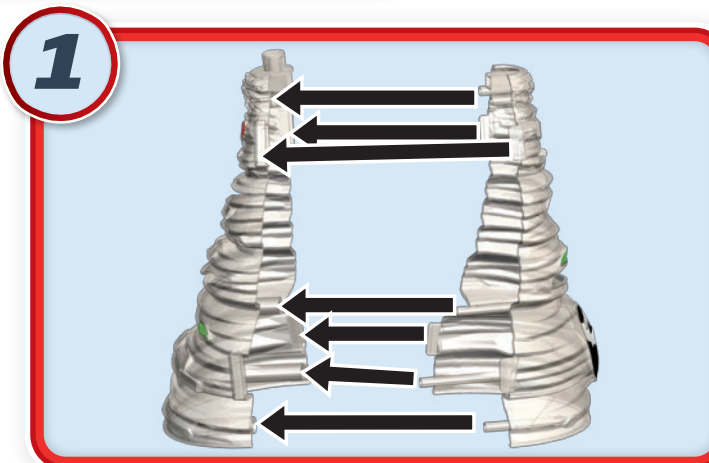

Assembly

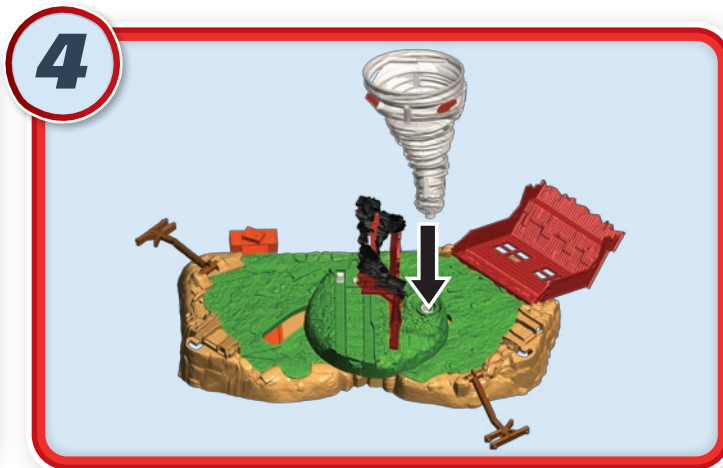
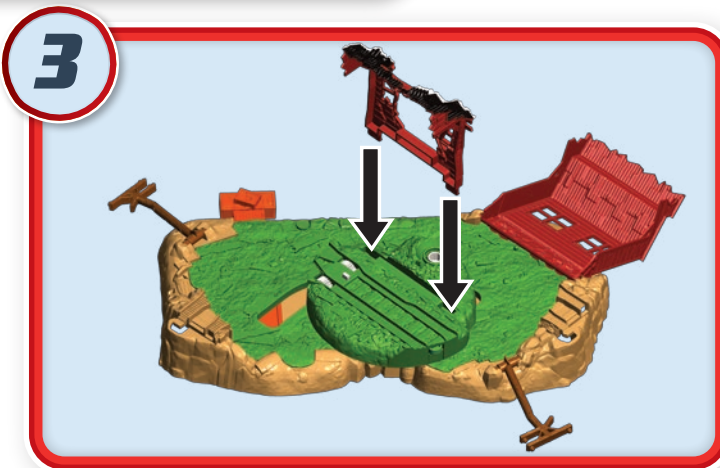

Track Layout

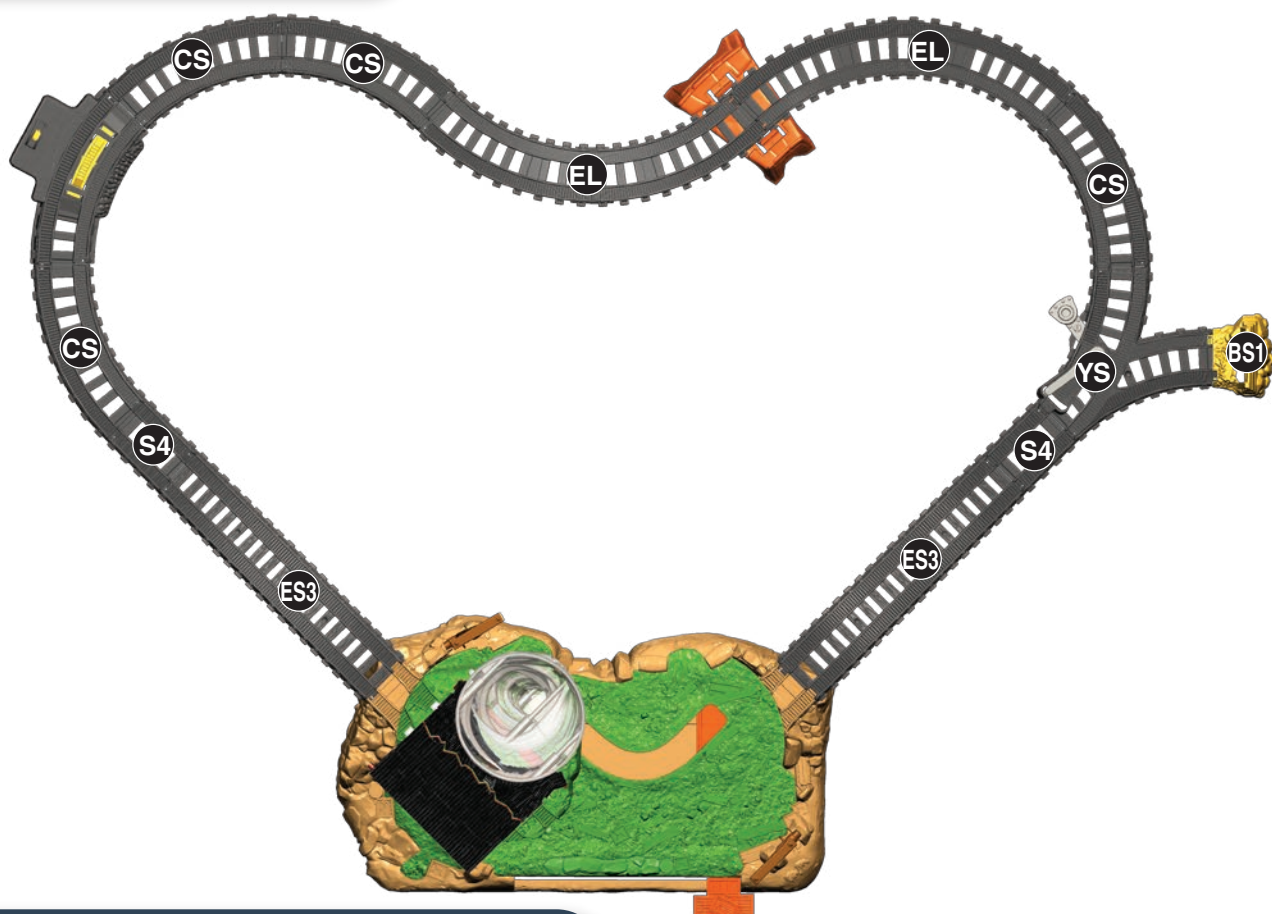

Battery Information

BATTERY INSTALLATION

Access the battery compartment by unscrewing and separating the top half of the engine from the bottom half of the engine. Install the batteries as indicated inside the battery compartment. Re-assemble the two halves of the engine, re-insert the screw and tighten. If the product begins to malfunction, check the battery installation. You may need to reset the electronics by removing the batteries and reinstalling them. If the product continues to malfunction or no longer operates, remove the batteries from the toy and replace them with fresh batteries. Requires 2 AAAA (LR03) batteries. For longer life use only alkaline batteries.

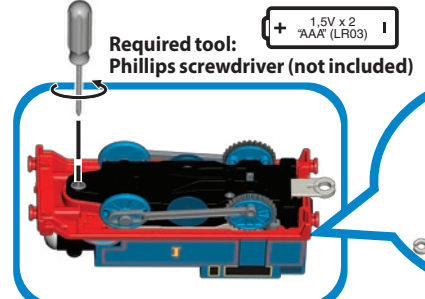

BATTERY SAFETY INFORMATION

In exceptional circumstances batteries may leak fluids that can cause a chemical burn injury or ruin your product. To avoid battery leakage:

- Non-rechargeable batteries are not to be recharged.
- Rechargeable batteries are to be removed from the product before being charged.
- Rechargeable batteries are only to be charged under adult supervision.
- Do not mix alkaline, standard (carbon-zinc), or rechargeable batteries.
- Do not mix old and new batteries.
- Only batteries of the same or equivalent type as recommended are to be used.
- Batteries are to be inserted with the correct polarity.
- Exhausted batteries are to be removed from the product.
- The supply terminals are not to be short-circuited.
- Dispose of batteries safely.
- Do not dispose of this product in a fire. The batteries inside may explode or leak.

Before you play

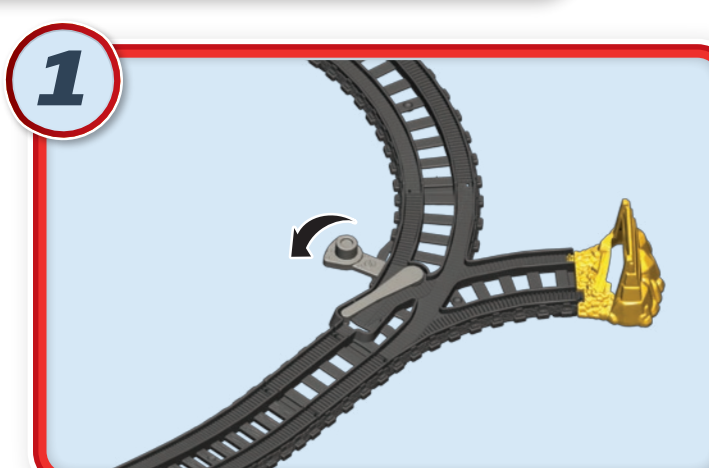

Use the switch track to control your engine's direction.

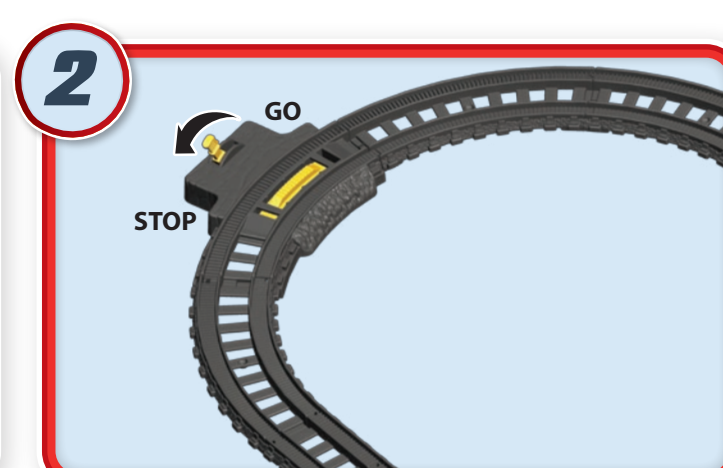

Slide the switch to "Stop".

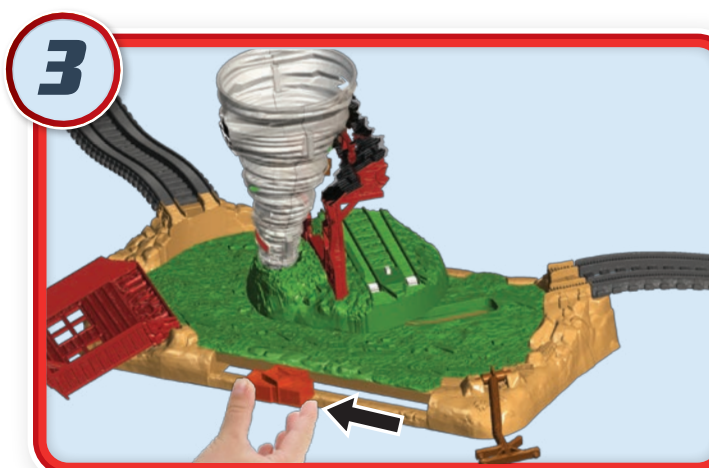

Slide the crates back to set the tornado.

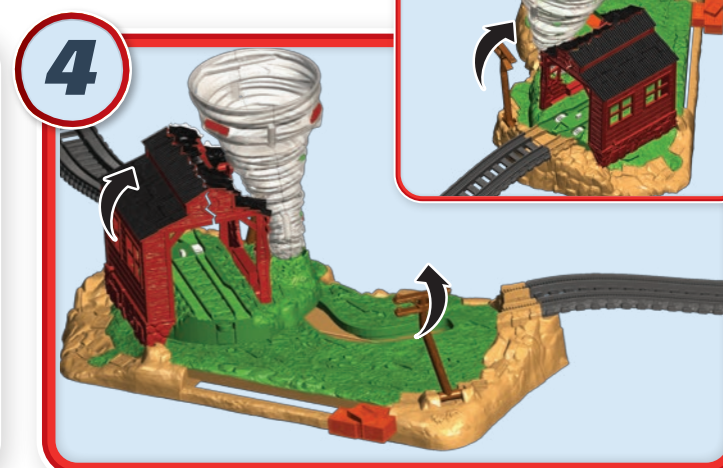

Raise and set the two utility poles and half the shed.

How To Play

The engine should move forward in the direction shown.

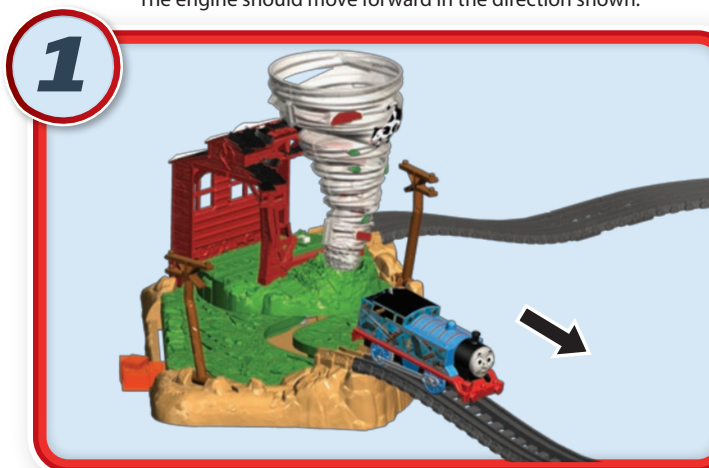

Send Thomas forward.

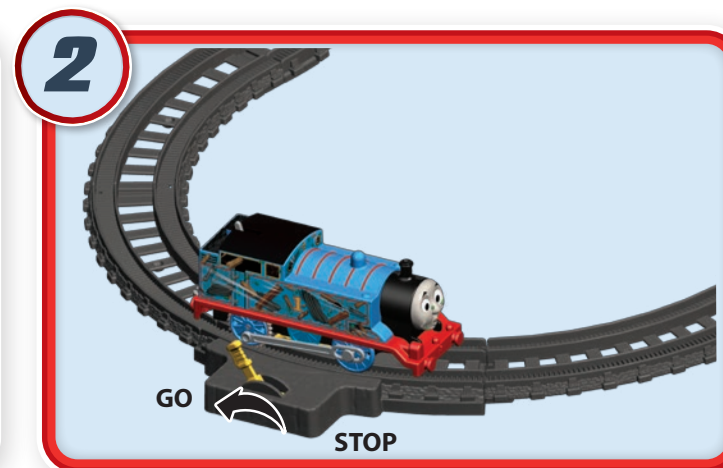

Slide the switch to "Go" to release the engine.

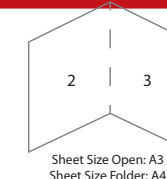

Item No : FJK25-0970
1101549931-DOM
Size : A3
Paper : Woodfree paper 70 gsm
Color : 4C
Date : 7/10/2017 (Emma Wei)