

How To Play

1

Note: If the engine runs continuously for approximately 3 minutes, it will automatically shut off to preserve battery life. To resume play, press the button on the engine.

Once the tail lights are on, the engine is ready to charge and activate glow-in-the-dark track. As the engine passes over this track with its tail lights on, it will leave a glowing trail on the tracks behind it.

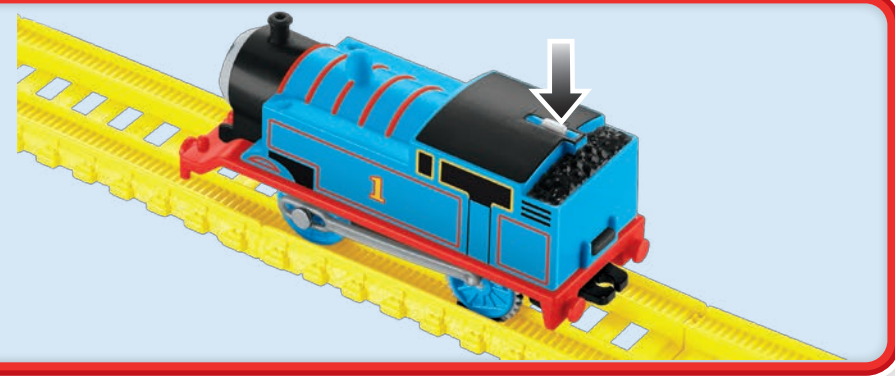

Press the button once to start the engine and watch its tail lights light up. Press the button again to stop the engine and turn off the tail light effect.

2



Press the spout to see water rise up and down.

3



Open the roof of Tidmouth Sheds for engine storage.

4



Engines can hang on the hooks.

Battery Information

BATTERY INSTALLATION

Access the battery compartment by unscrewing and separating the top half of the engine from the bottom half of the engine. Install the batteries as indicated inside the battery compartment. Re-assemble the two halves of the engine, re-insert the screw and tighten. If the product begins to malfunction, check the battery installation. You may need to reset the electronics by removing the batteries and reinstalling them. If the product continues to malfunction or no longer operates, remove the batteries from the toy and replace them with fresh batteries. Requires 2 "AA" (LR03) batteries. For longer life use only alkaline batteries.

1.01 x 2
AA (LR03)

Required tool: Phillips screwdriver (not included)

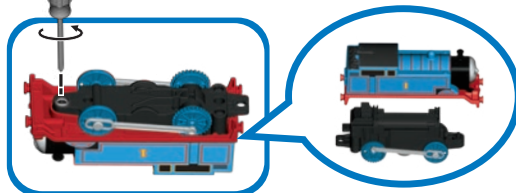

BATTERY SAFETY INFORMATION

In exceptional circumstances batteries may leak fluids that can cause a chemical burn injury or ruin your product. To avoid battery leakage:

- Non-rechargeable batteries are not to be recharged.
- Rechargeable batteries are to be removed from the product before being charged.
- Rechargeable batteries are only to be charged under adult supervision.
- Do not mix alkaline, standard (carbon-zinc), or rechargeable batteries.
- Do not mix old and new batteries.
- Only batteries of the same or equivalent type as recommended are to be used.
- Batteries are to be inserted with the correct polarity.
- Exhausted batteries are to be removed from the product.
- The supply terminals are not to be short-circuited. Dispose of batteries safely.
- Do not dispose of this product in a fire. The batteries inside may explode or leak.

CAUTION:
To prevent entanglement,
keep hair away from wheels.

Protect the environment by not disposing of this product or any batteries with household waste. This symbol indicates that this product shall not be treated as household waste. Check your local authority for recycling advice and facilities.

FJL41

Fisher-Price

CONSUMER ASSISTANCE
1-800-432-5437 (US & Canada)
1-800-335-3132 (Australia)

service.fisher-price.com

Fisher-Price, Inc., 626 Great Avenue, East Aurora, NY 14052.
Hearing-impaired consumers: 1-800-382-7470.

Outside the United States:

Canada: Mattel Canada Inc., 6155 Freemont Blvd.,
Mississauga, Ontario L5R 3W2, www.service.mattel.com.

Great Britain: Mattel UK Ltd, Vauxhall Business Park,
Maidenhead SL6 4UG, Hdkline: 01628 500303,
www.service.mattel.com/uk

Mattel Europe B.V., Gouda 1, 1186 MJ Amstelveen, Nederland.

Australia: Mattel Australia Pty. Ltd., G58 Church Street,
London E9C 8R7D, Richmond, Victoria 3121, Australia,
New Zealand: 16-18 William Pickering Drive,
Aubrey 3232, Auckland.

South Africa: Mattel South Africa (PTY) LTD, Office 102 G3,
30 Midmore Boulevard, Johannesburg 2196.

Thomas the Tank Engine & Friends™

CREATED BY BRIPT ALLCROFT

Based on the Railway Series by The Reverend W Awdry.

©2018 Gullane (Thomas) Limited. Thomas the Tank Engine & Friends and Thomas & Friends are trademarks of Gullane (Thomas) Limited.

©2018 HIT Entertainment Limited. HIT and the HIT logo are trademarks of HIT Entertainment Limited.

©2018 Mattel, ® and ™ designate U.S. trademarks of Mattel, except as noted. PRINTED IN CHINA.

Mattel East Asia Ltd., Room 503-09, North Tower,
World Finance Centre, Harbour City, Tsimshatsui, HK, China.
Tel.: (852) 3185-6500.

FJL41-0970-1101850080-D0M

THOMAS & FRIENDS
TRACK MASTER

HYPER GLOW STATION

INSTRUCTIONS

Keep these instructions for future reference as they contain important information.



What's Included

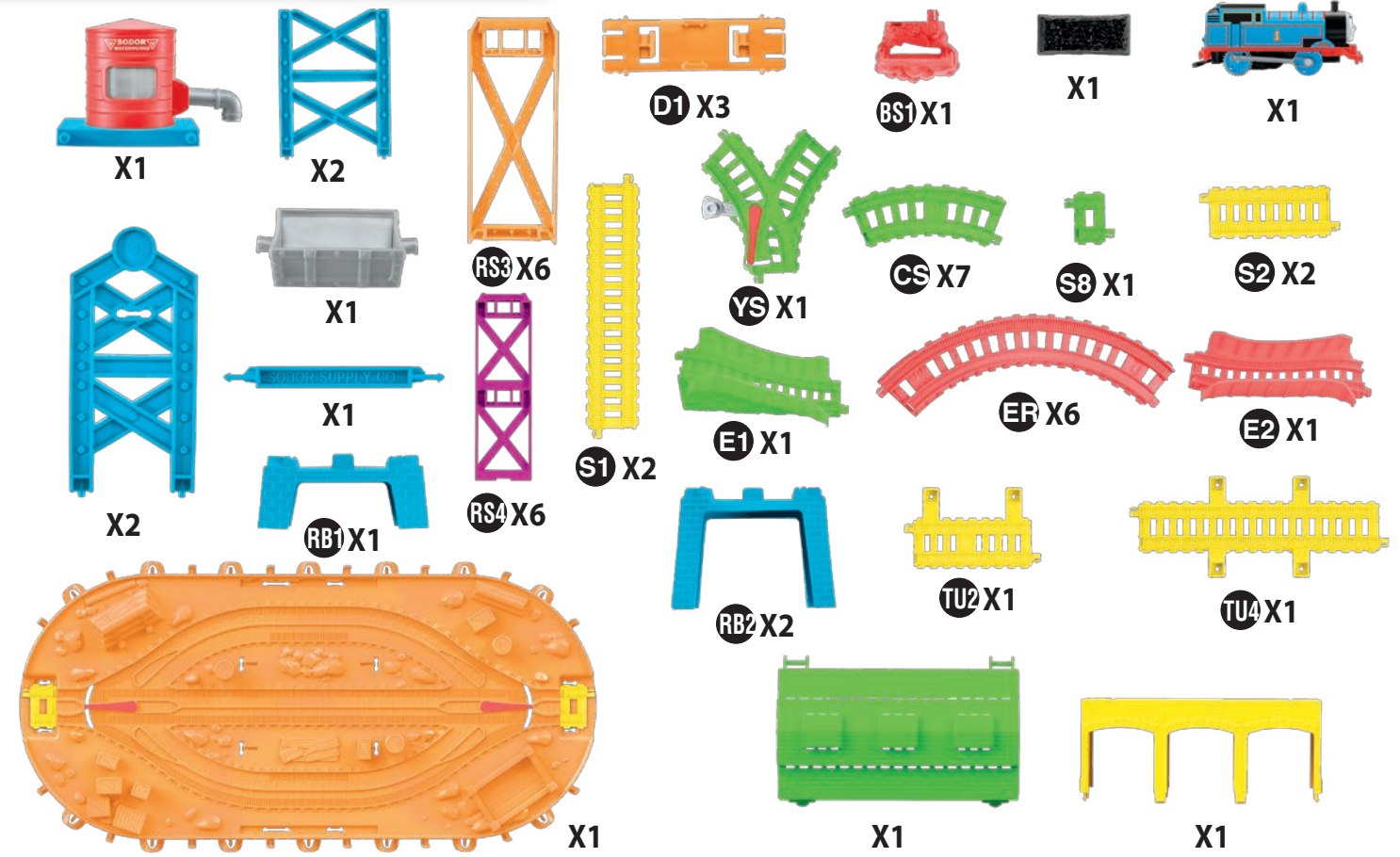

Helpful Hints

Track marking codes are found on the bottom of tracks and riser.

★ ONE-TIME SNAPS: Assembly steps that are marked with a star are "one-time snaps." Once these parts are put together, they cannot be taken apart.

Note: Some engines may not work on this track set.

FCC STATEMENT (UNITED STATES ONLY)

This equipment has been tested and found to comply with the limits for a Class B digital device, pursuant to Part 15 of the FCC rules. These limits are designed to provide reasonable protection against harmful interference in a residential installation. This equipment generates uses and can radiate radio frequency energy and, if not installed and used in accordance with the instructions, may cause harmful interference to radio communications. However, there is no guarantee that interference will not occur in a particular installation. If this equipment does cause harmful interference to radio or television reception, which can be determined by turning the equipment off and on, the user is encouraged to try to correct the interference by one or more of the following measures: • Reorient or relocate the receiving antenna. • Increase the separation between the equipment and receiver. • Consult the dealer or an experienced radio/TV technician for help. NOTE: Changes or modifications not expressly approved by the manufacturer responsible for compliance could void the user's authority to operate the equipment. This device complies with Part 15 of the FCC Rules. Operation is subject to the following two conditions: (1) This device may not cause harmful interference, and (2) this device must accept any interference received, including interference that may cause undesired operation.

CANICES 3 (B)/NMB-3 (B)

Operation is subject to the following two conditions: (1) this device may not cause interference, and (2) this device must accept any interference, including interference that may cause undesired operation of the device.

L'utilisation de ce dispositif est autorisée seulement aux conditions suivantes: (1) il ne doit pas produire de brouillage et (2) il doit pouvoir tolérer tout brouillage radioélectrique reçu, même si ce brouillage est susceptible de compromettre son fonctionnement.

The engine's body also glows in the dark. Expose the engine to light, then watch it glow in the dark. Place product approximately 5 feet (152 cm) away from a light source for 30 seconds. Placing product closer will not intensify the "glow-in-the-dark" feature. Glow-in-the-dark feature will last longer if you do not expose this product to intense heat or direct sunlight for prolonged periods of time.

Adult Assembly Required. No Tools Needed.

Assembly

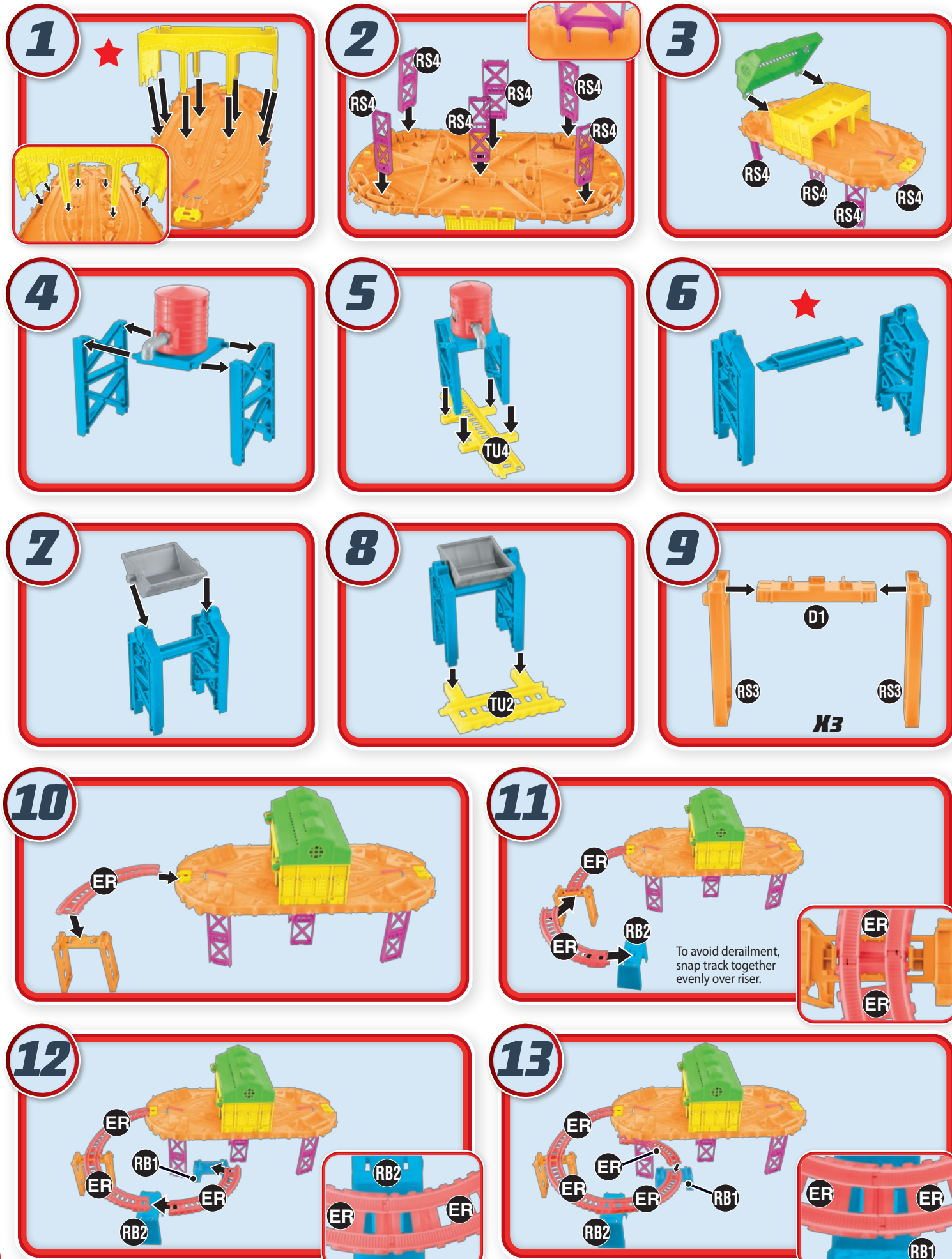

Track Layout

Top View

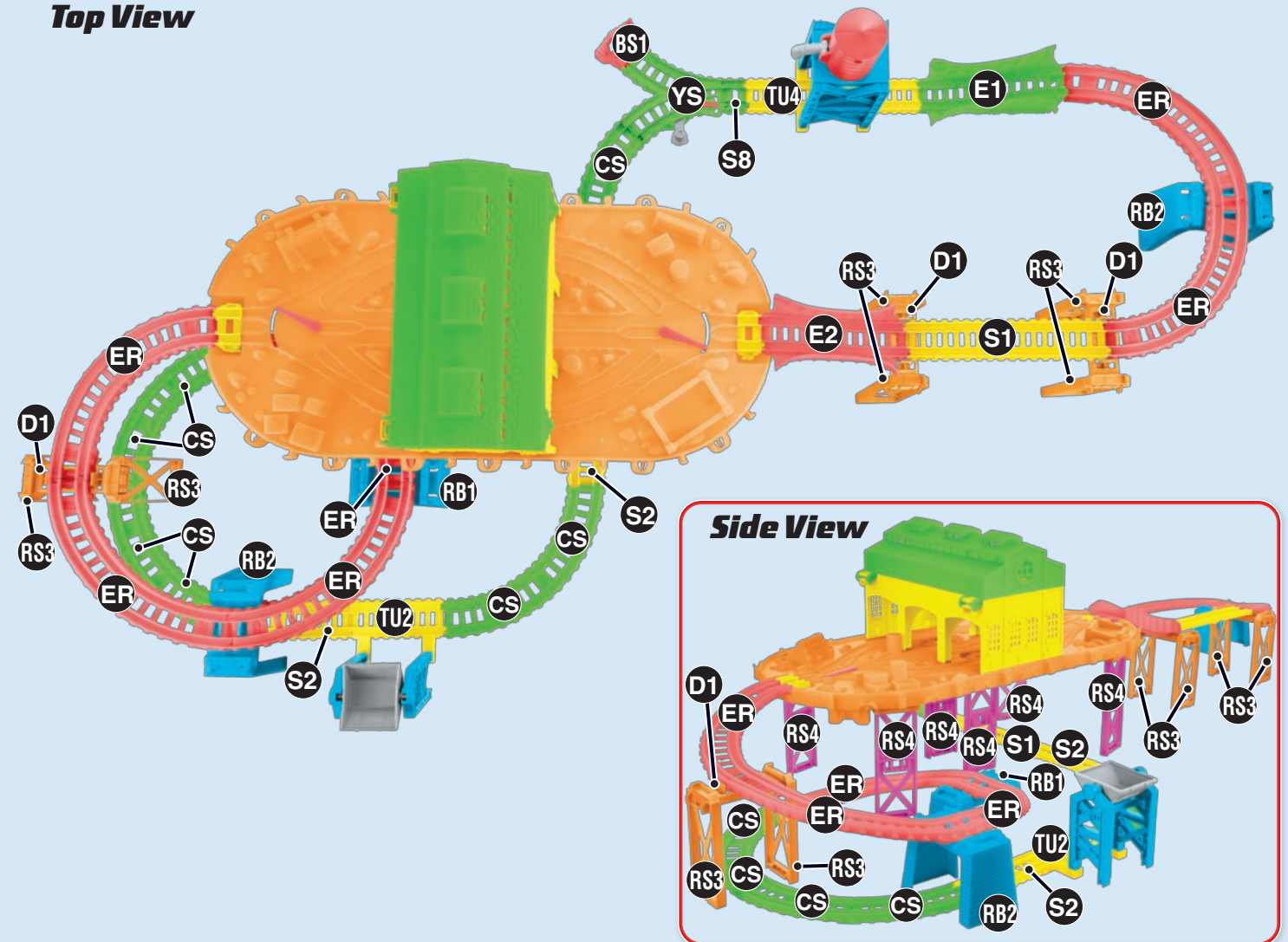

Side View

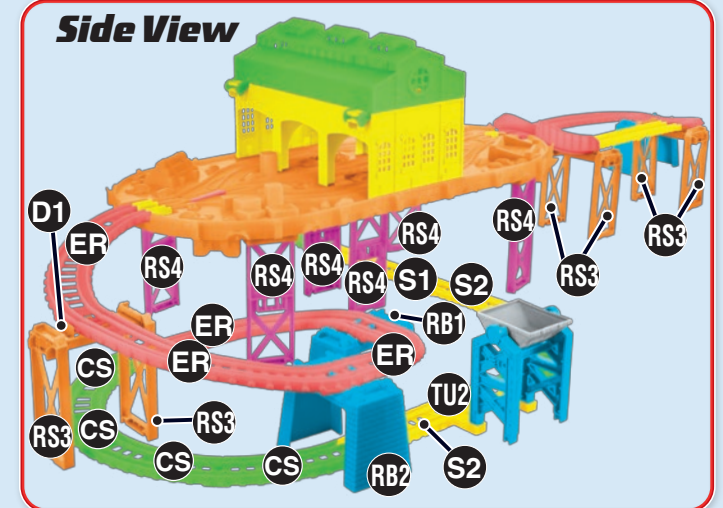

Top View without Tidmouth Sheds

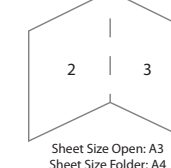
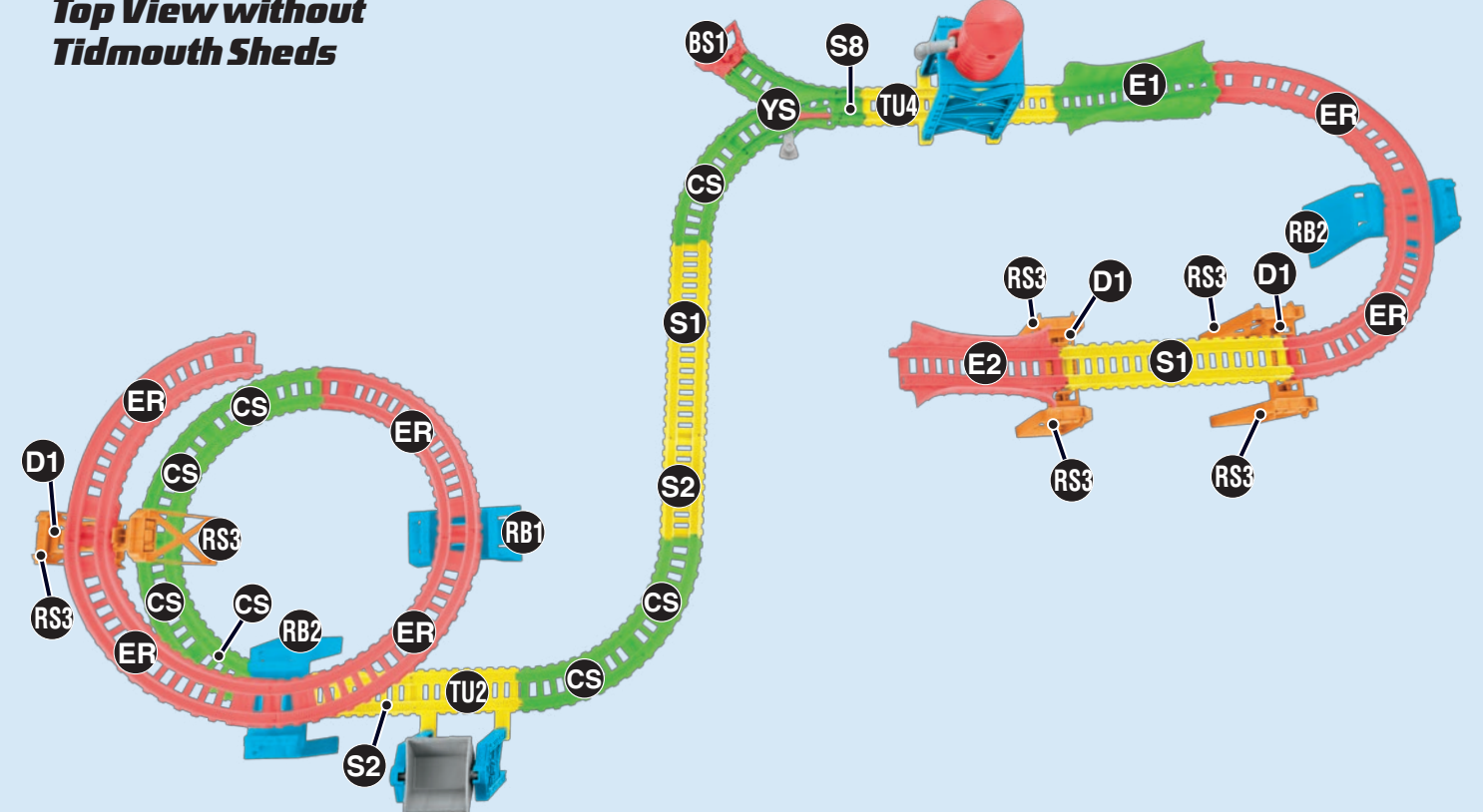

Item No : FJL41-0970
1101850080-D0M
Size : 16.54" x 11.69" (A3)
Paper : Woodfree paper 70 gsm
Color : 4C
Date : 3/2/2018 (Emma Wei)