

SUPER TRACK MACK INSTRUCTIONS

4+



Please keep these instructions for future reference as they contain important information.

CONTENTS

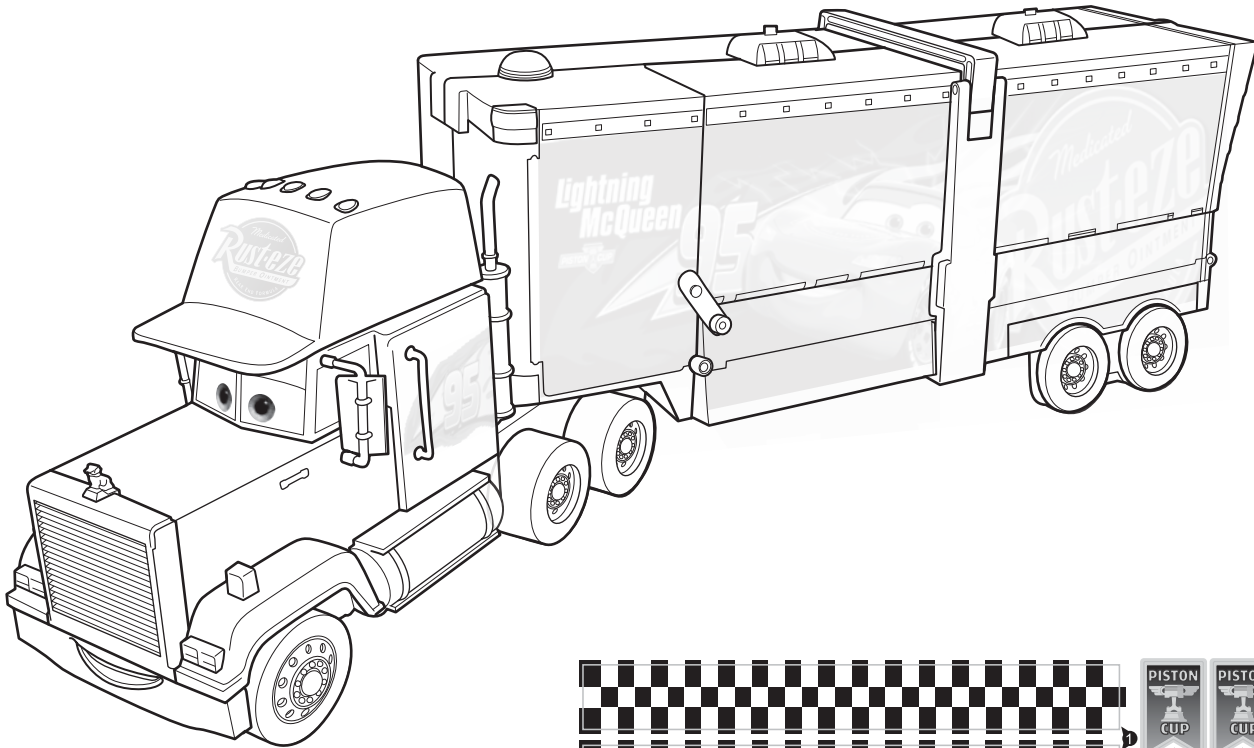

**FULLY ASSEMBLED,
ADULT SET-UP REQUIRED.**

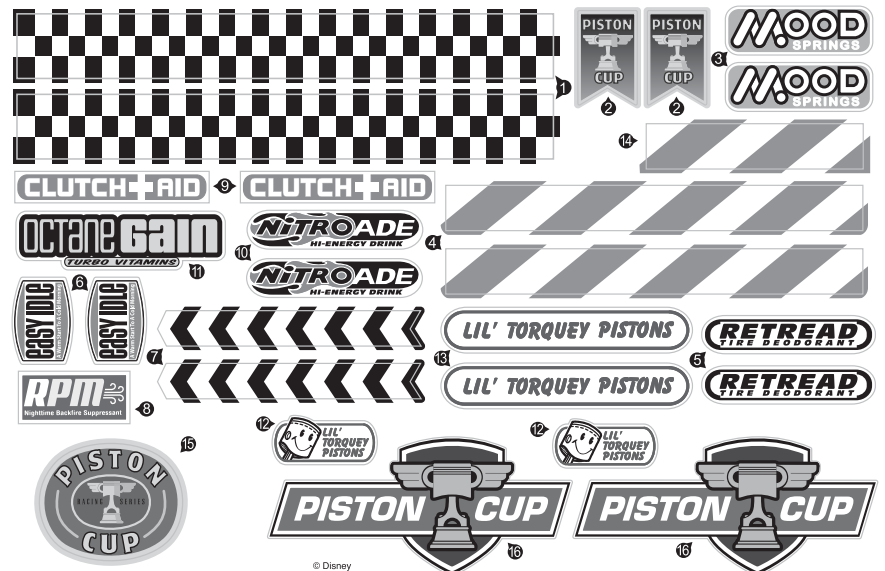

©2018 Mattel. ® and ™ designate U.S. trademarks of Mattel, except as noted.

Mattel, Inc., 636 Girard Avenue, East Aurora, NY 14052, U.S.A. Consumer Services 1-800-524-8697. Mattel U.K. Ltd., Vanwall Business Park, Maidenhead SL6 4UB. Helpline 01628 500303. Mattel Australia Pty., Ltd., Richmond, Victoria. 3121. Consumer Advisory Service - 1300 135 312. Mattel South Africa (PTY) LTD, Office 102 I3, 30 Melrose Boulevard, Johannesburg 2196. Mattel East Asia Ltd., Room 503-09, North Tower, World Finance Centre, Harbour City, Tsimshatsui, HK, China. Tel.: (852) 3185-6500. Diimport & Diedarkan Oleh: Mattel Southeast Asia Pte. Ltd., No 19-1, Tower 3 Avenue 7, Bangsar South City, No 8, Jalan Kerinchi, 59200 Kuala Lumpur, Malaysia. Tel: 03-33419052.



1 BATTERY INSTALLATION

- Includes 3 AA batteries in the cab for demonstration purposes only.
- Requires 4 D size (LR20) alkaline batteries (not included) for the booster.
- Unscrew the battery cover(s) with a Phillips head screwdriver (not included).
- Remove batteries and dispose of them safely.
- For the cab, install 3 new AA (LR6) batteries in the orientation (+/-) shown.
- For the booster, install 4 new D size (LR20) alkaline batteries (not included) in the orientation (+/-) shown.
- Replace batteries in the cab if sounds distort or lights dim.
- Replace batteries in the booster if it can no longer propel vehicles.
- For best performance, use only alkaline batteries.
- Replace battery cover(s) and tighten screw(s).
- When exposed to an electrostatic source, the product may malfunction. To resume normal operation, remove and reinstall the batteries.

Booster

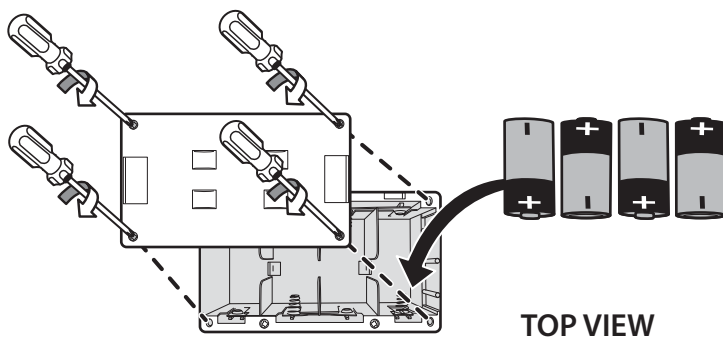

TOP VIEW

Cab

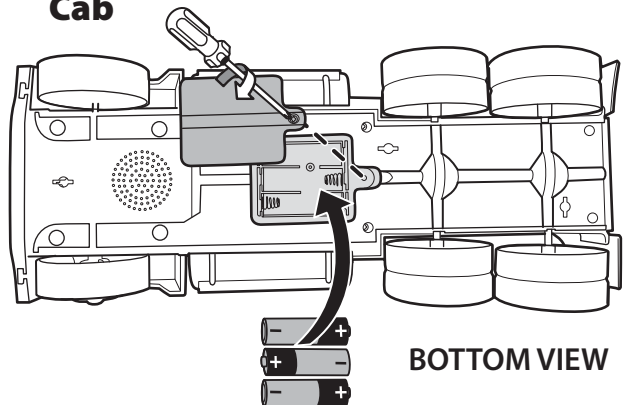

BOTTOM VIEW

NOTE: Booster only functions when attached to playset.

2 SET UP

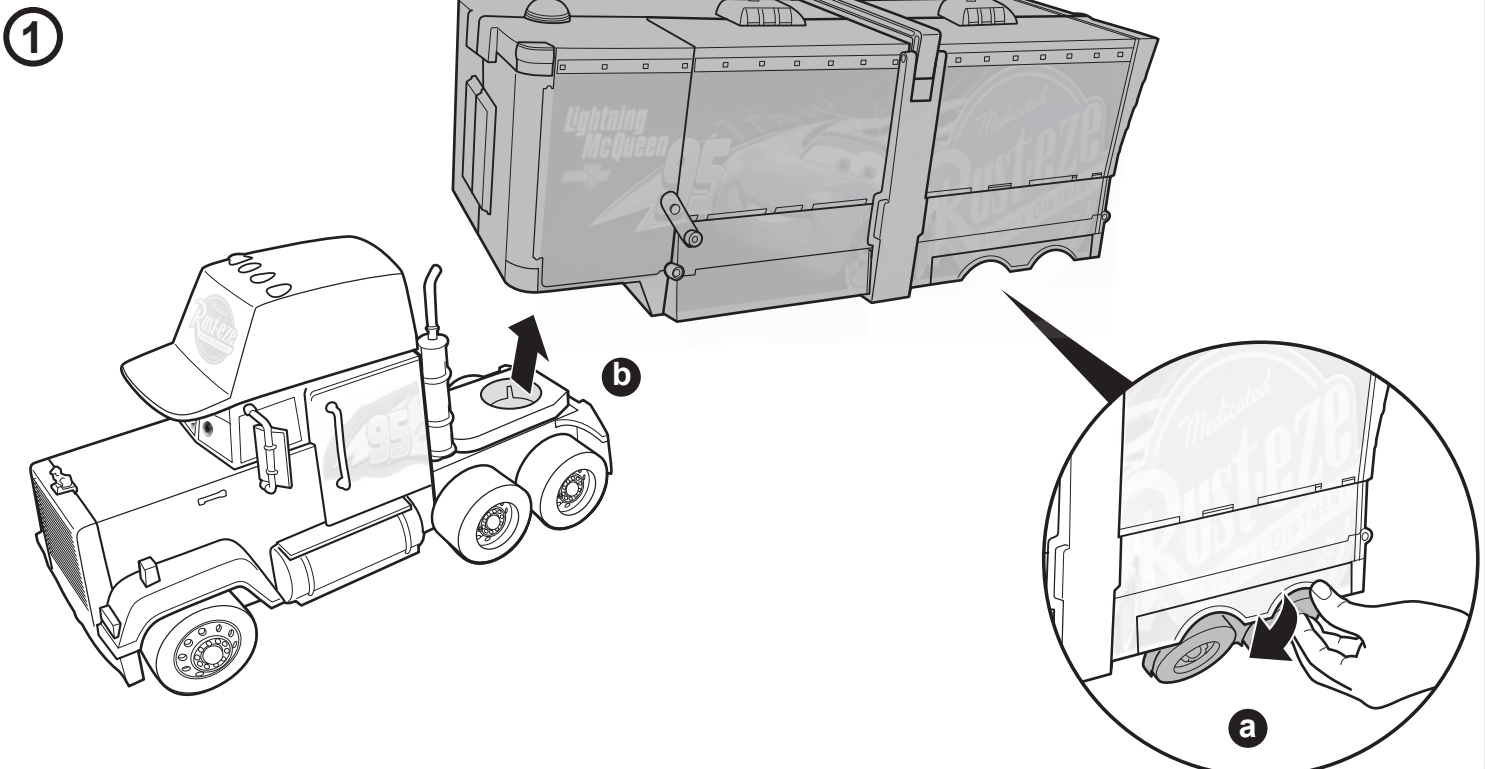

2 SET UP (CONTD.)

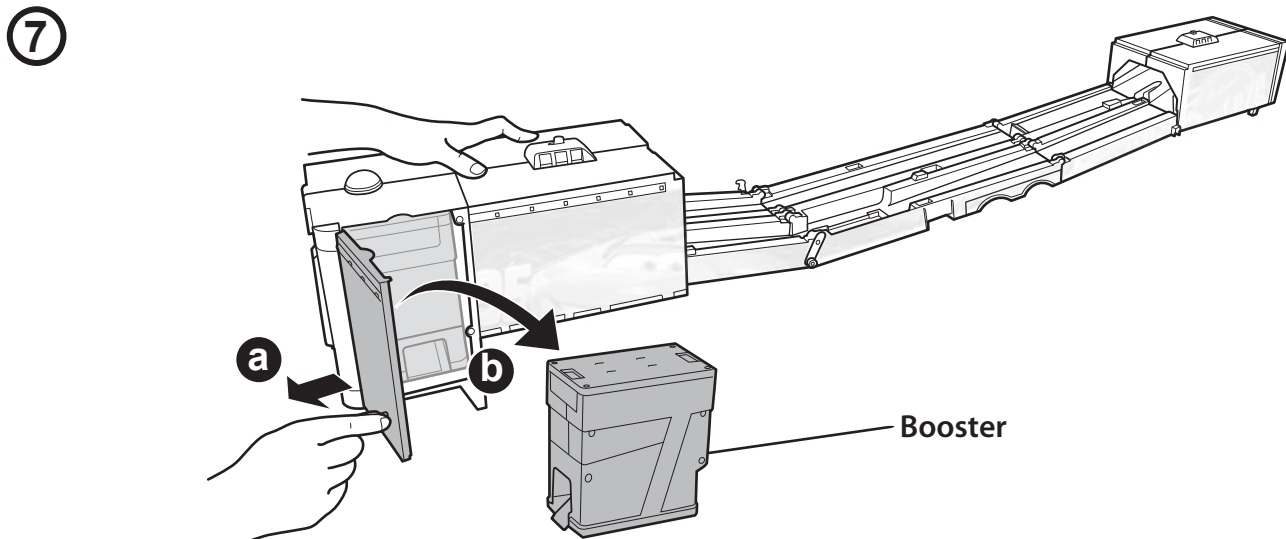
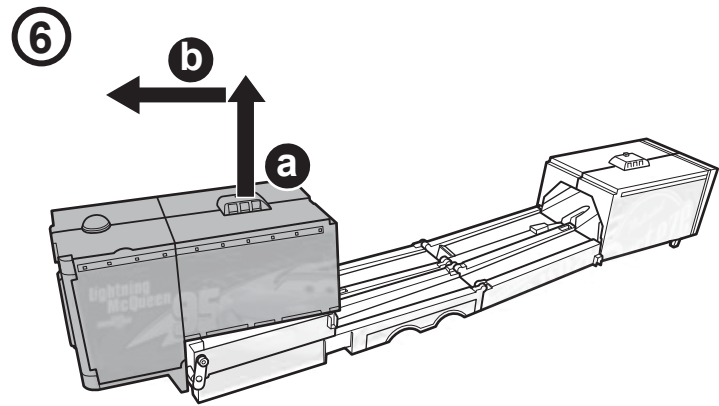
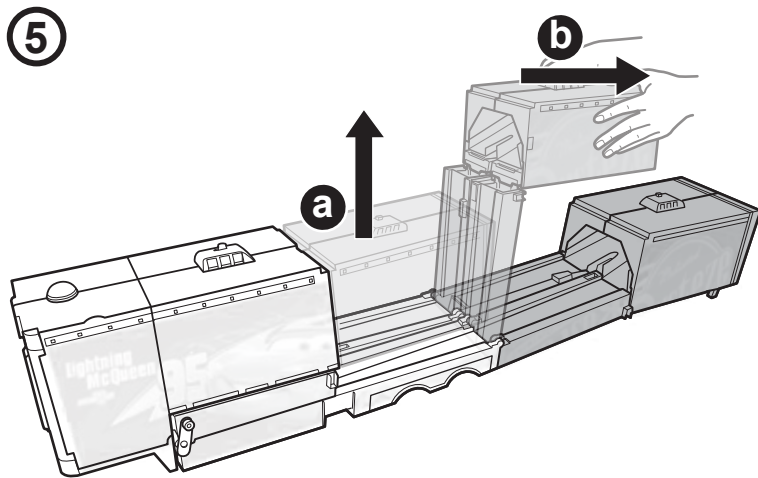
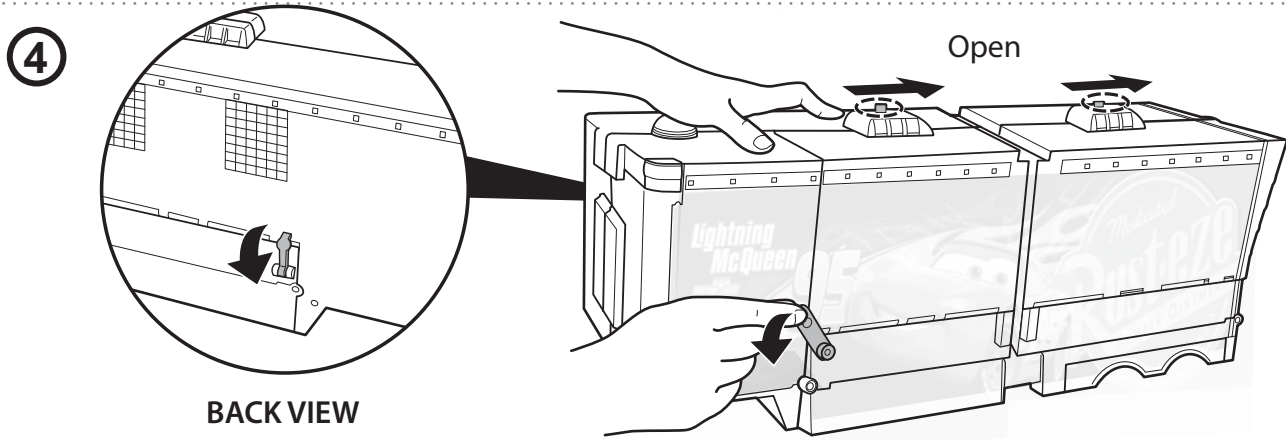
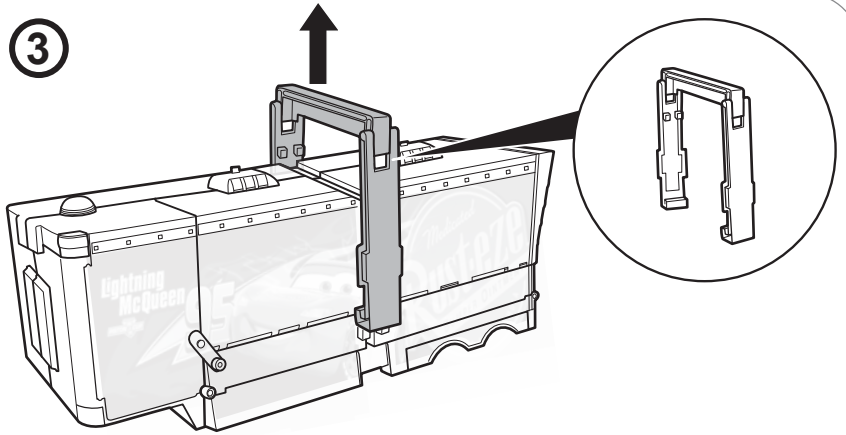
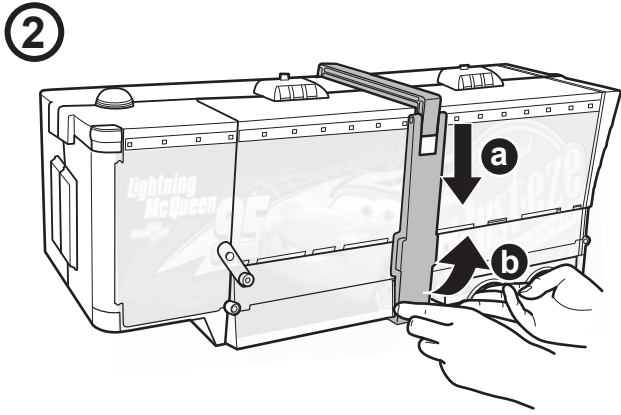

8

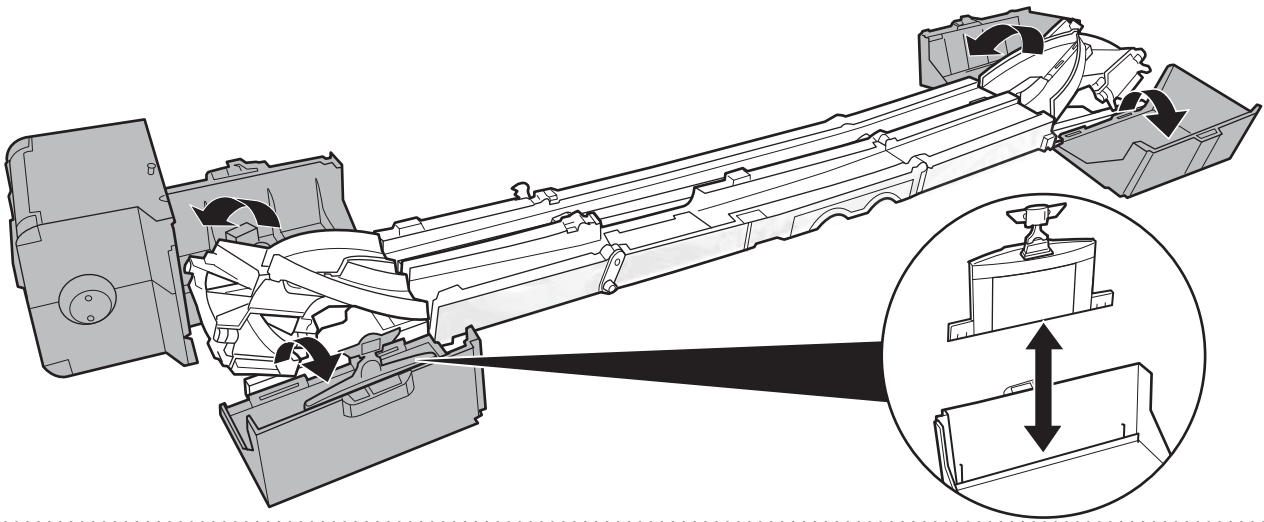

9 Open both sides together with someone else.

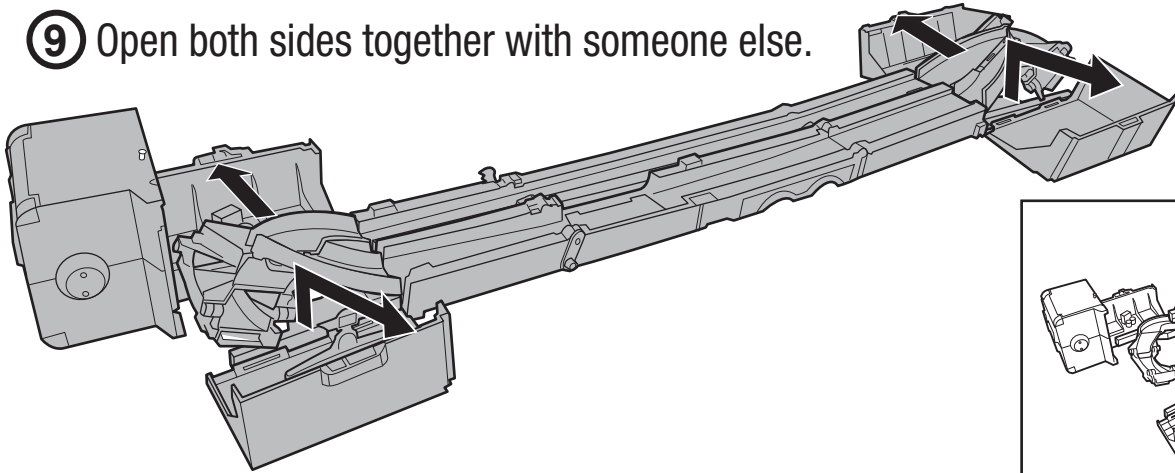

10

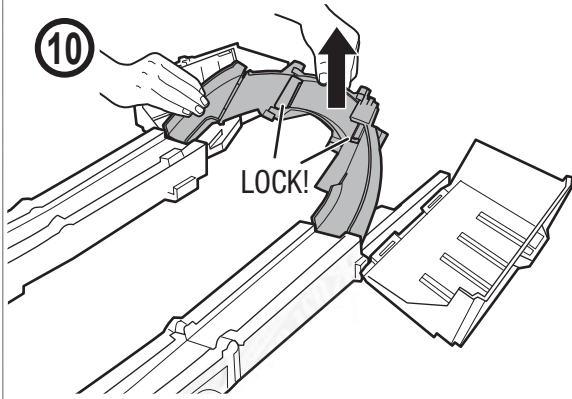

11

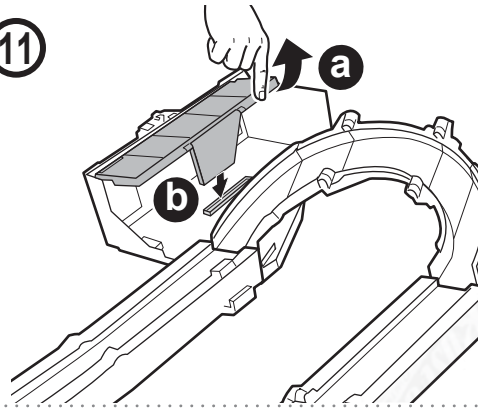

12

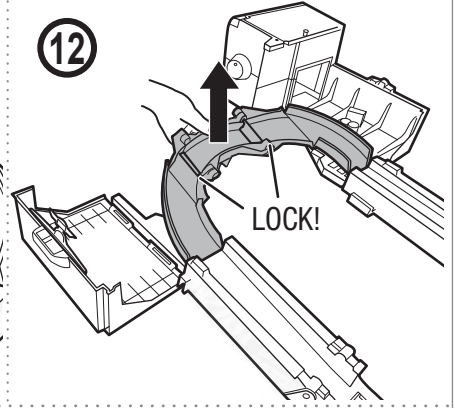

13

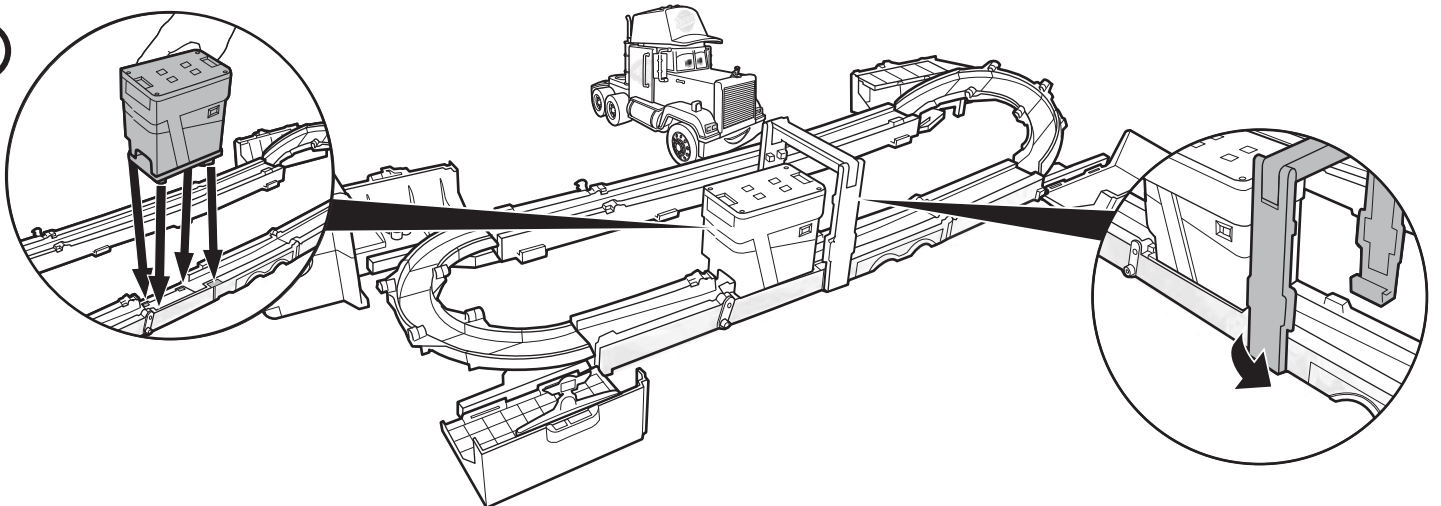

4 TO PLAY

① Press for lights and sounds!

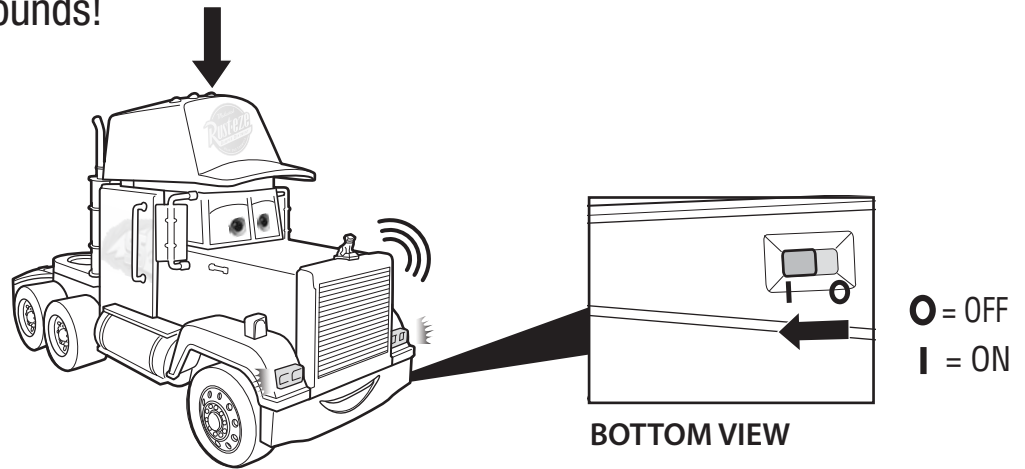

② Load stands with spectators and the crew!

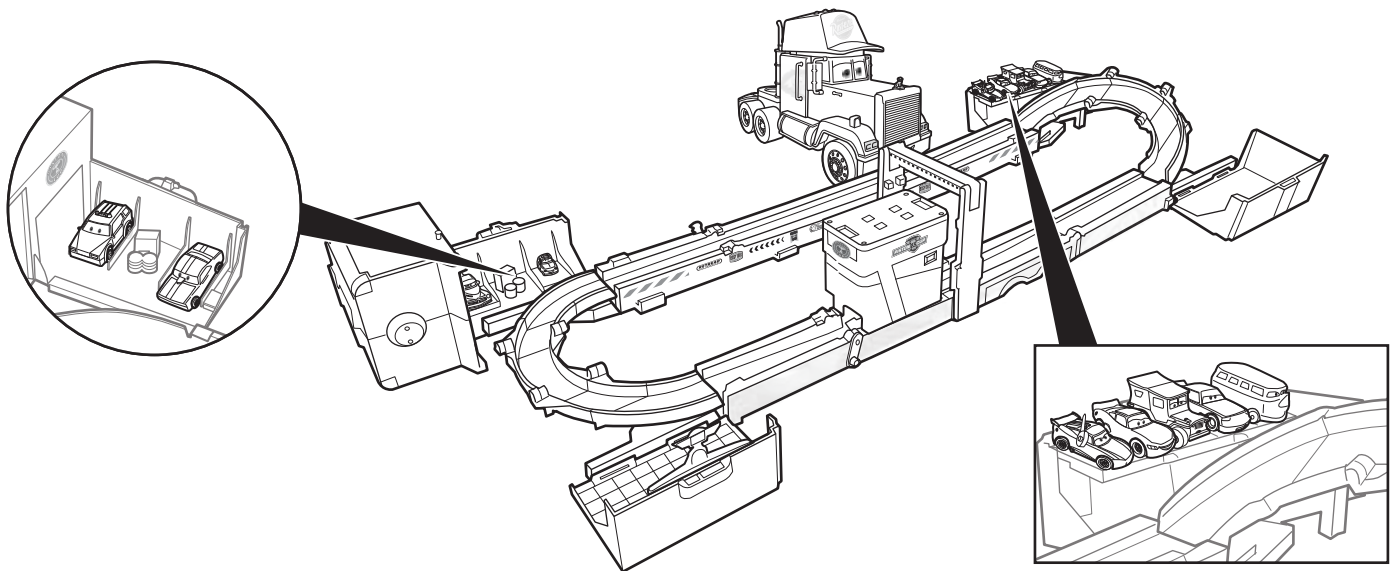

Not for use with some Cars vehicles. Vehicles not included.

③ Switch on the booster.

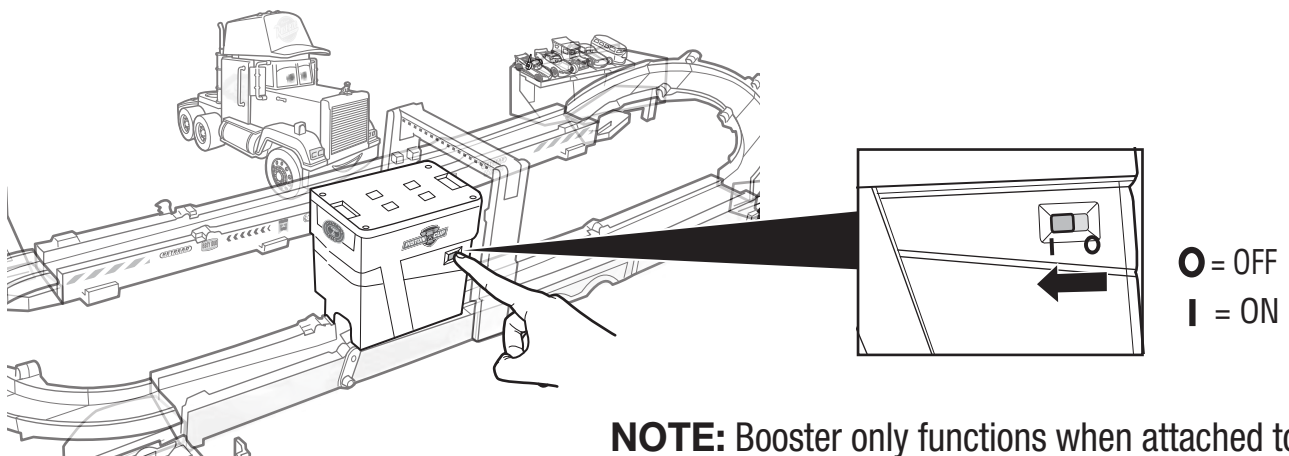

NOTE: Booster only functions when attached to playset.

④ Push vehicle through the booster to launch and race along the track!

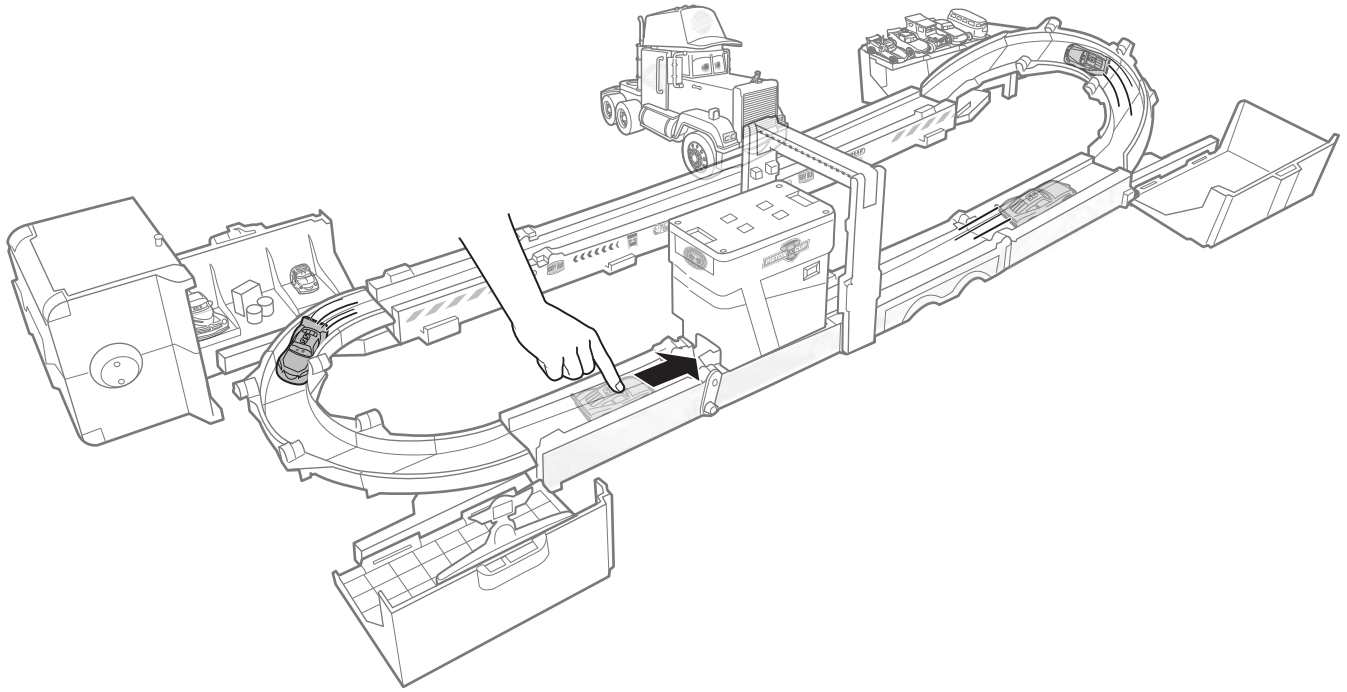

⑤ Add more vehicles to join the race! Load vehicles on stage to claim the trophy!

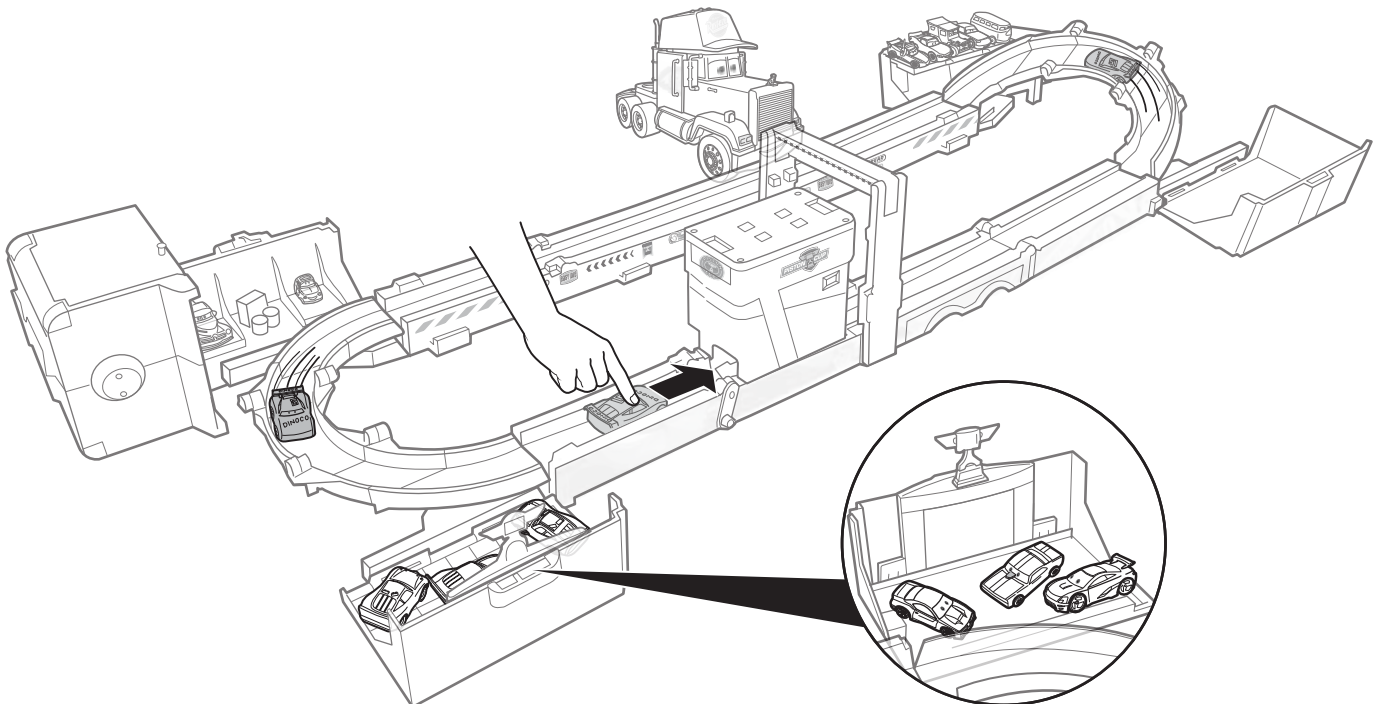

5 STORAGE

Reverse order of instructions in SET UP to convert back into Mack.

1

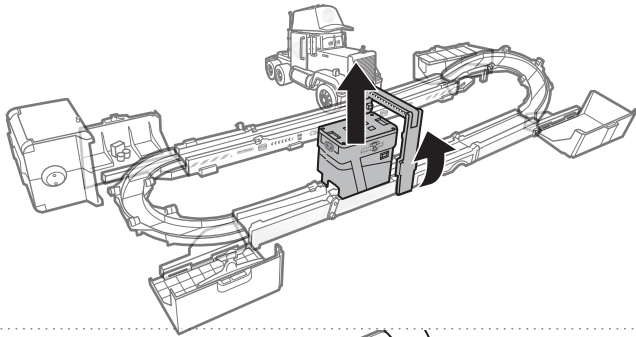

2

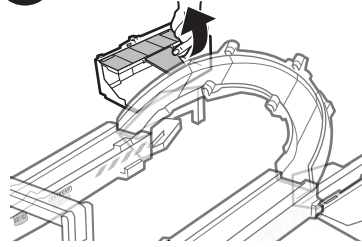

3

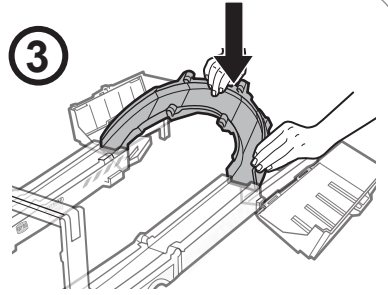

4

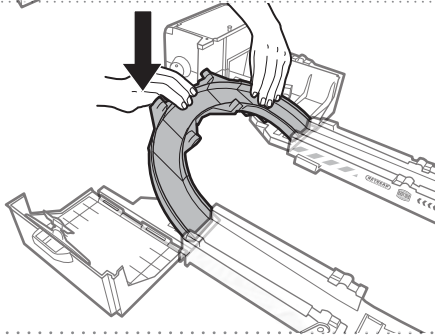

5

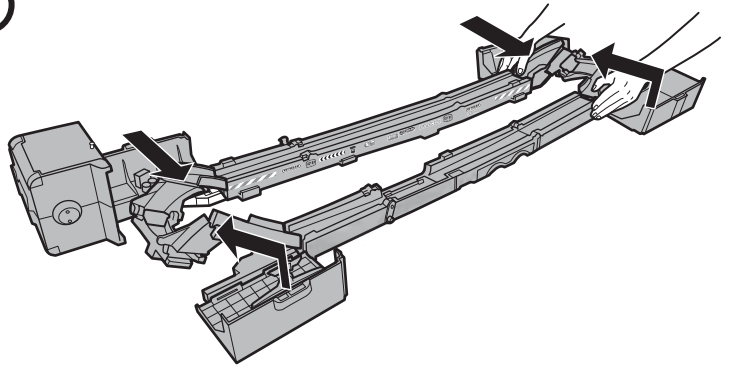

6

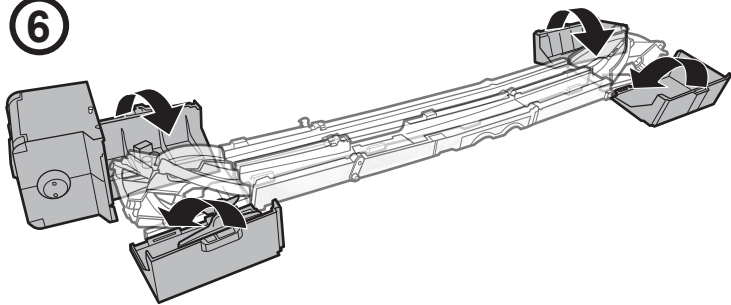

7

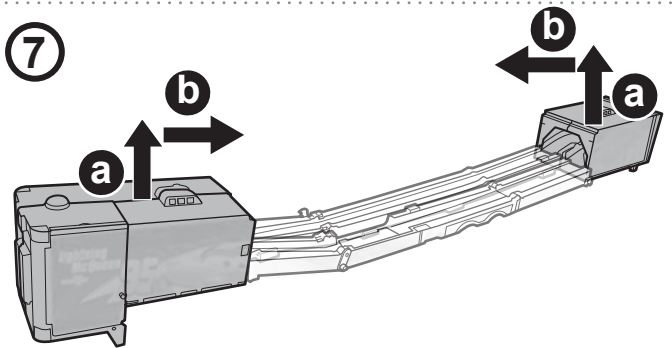

8

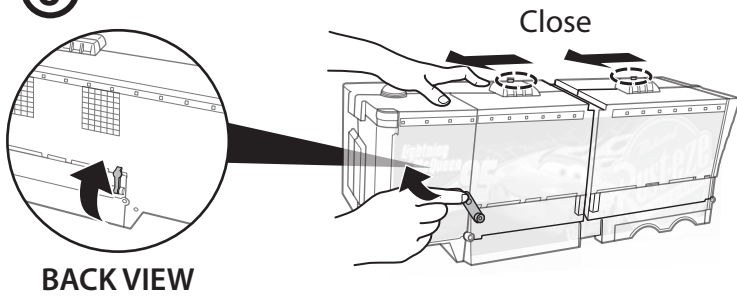

9

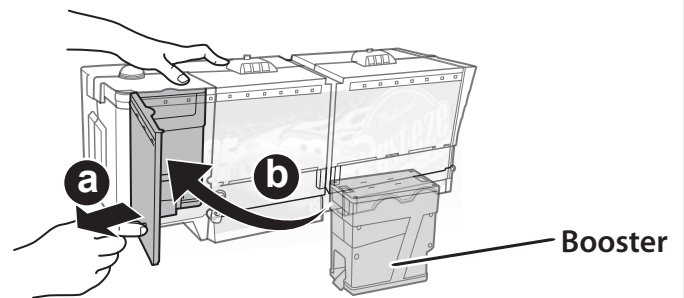

10

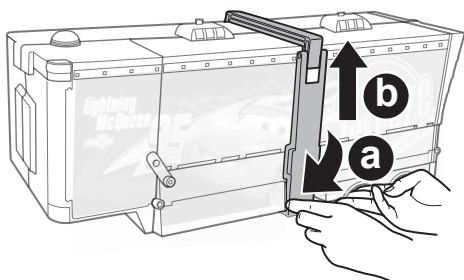

11

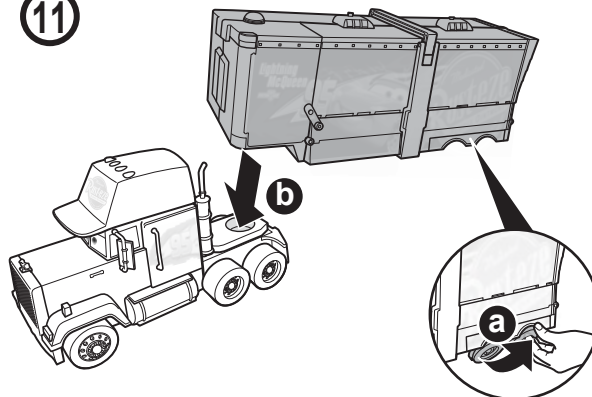

12

