

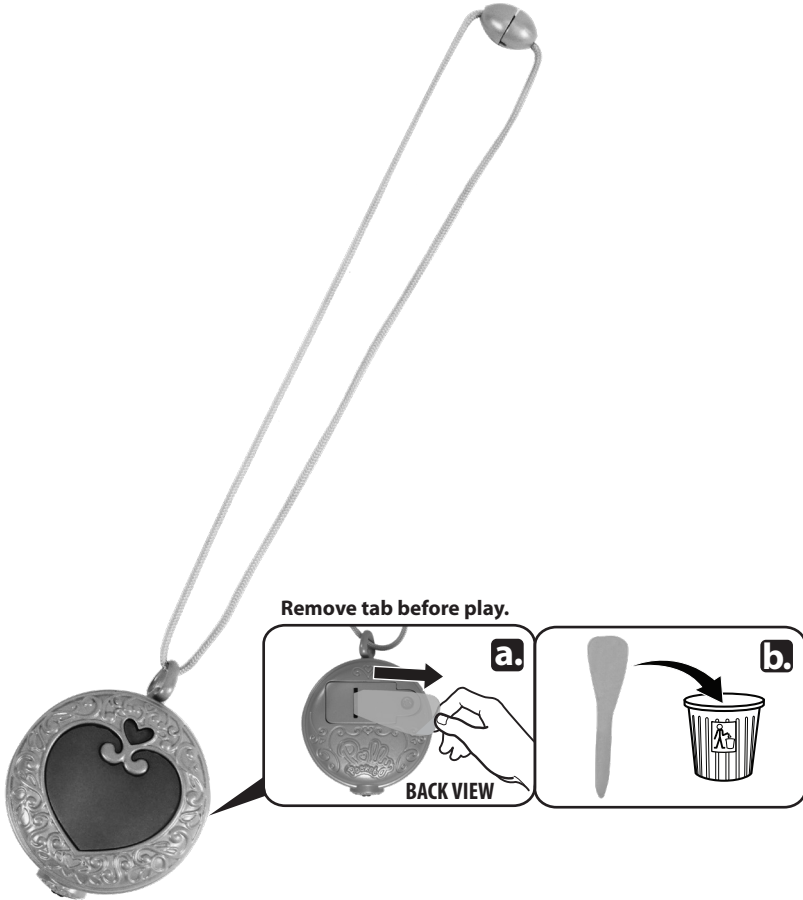

TINY POWER!™ LOCKET INSTRUCTIONS



CONTENTS



Please keep these instructions for future reference
as they contain important information.



1. LET'S PLAY!

A. Put on the locket necklace.

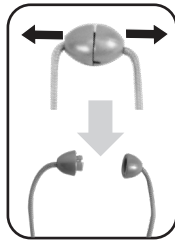

B. Press for lights.



2. BATTERY REPLACEMENT

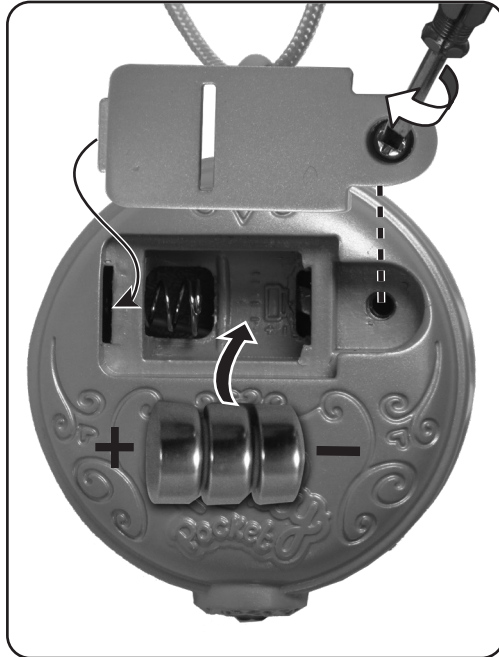

- Includes 3 button cell (AG13, LR44) batteries for demonstration purposes.
- Replace the batteries if lights dim.
- Unscrew the battery cover with a Phillips head screwdriver (not included).
- Remove batteries and dispose of them safely.
- Install 3 new button cell (AG13, LR44) batteries in the orientation (+/-) shown.
- Replace battery cover and tighten screw.
- For best performance, use alkaline batteries.
- When exposed to an electrostatic source, the product may malfunction.
To resume normal operation, remove and re-install the batteries.

NOTE: This product is equipped with an automatic shut-off feature that helps preserve battery life.

**This is a battery-operated product.
1 flyer (00001-2908G16) is required
to be placed inside the packaging.**

**This is a battery-operated product.
1 flyer (00007-1849G7) is required
to be placed inside the packaging.**

Mattel, Inc., 636 Girard Avenue, East Aurora, NY 14052, U.S.A. Consumer Services 1-800-524-8697. Mattel U.K. Ltd., Vanwall Business Park, Maidenhead SL6 4UB. Helpline 01628 500303. Mattel Australia Pty., Ltd., Richmond, Victoria. 3121. Consumer Advisory Service - 1300 135 312. Mattel South Africa (PTY) LTD, Office 102 I3, 30 Melrose Boulevard, Johannesburg 2196. Mattel East Asia Ltd., Room 503-09, North Tower, World Finance Centre, Harbour City, Tsimshatsui, HK, China. Tel.: (852) 3185-6500. Diimport & Diedarkan Oleh: Mattel Southeast Asia Pte. Ltd., No 19-1, Tower 3 Avenue 7, Bangsar South City, No 8, Jalan Kerinchi, 59200 Kuala Lumpur, Malaysia. Tel: 03-33419052.