

IMAGINE WHAT YOU COULD DO WITH THE TRACK BUILDER SYSTEM!

ADVERTISEMENT



EACH SOLD SEPARATELY. SUBJECT TO AVAILABILITY.
COLORS AND DECORATIONS MAY VARY.

FOR MORE EPIC TRACK IDEAS VISIT
WWW.HOTWHEELS.COM/TRACKBUILDER

©2018 Mattel. Mattel, Inc., 636 Girard Avenue, East Aurora, NY 14052. U.S.A. Consumer Services 1-800-524-8697. Mattel U.K. Ltd., Vanwall Business Park, Maidenhead SL6 4UB. Helpline 01628 500303. Mattel Australia Pty., Ltd., Richmond, Victoria. 3121. Consumer Advisory Service - 1300 135 312. Mattel South Africa (PTY) LTD, Office 102 I3, 30 Melrose Boulevard, Johannesburg 2196. Mattel East Asia Ltd., Room 503-09, North Tower, World Finance Centre, Harbour City, Tsimshatsui, HK, China. Tel.: (852) 3185-6500. Diimport & Diedarkan Oleh: Mattel Southeast Asia Pte. Ltd., No 19-1, Tower 3 Avenue 7, Bangsar South City, No 8, Jalan Kerinchi, 59200 Kuala Lumpur, Malaysia. Tel: 03-33419052.



BUILDER'S GUIDE

FOR EXPERT BUILDERS

FTH77-0970
1101933149-D0MG1
service.mattel.com
HOTWHEELS.COM

PLEASE KEEP THESE INSTRUCTIONS
FOR FUTURE REFERENCE AS THEY
CONTAIN IMPORTANT INFORMATION.



RACE CRATE



Hey parents check this out! The Track Builder Race Crate is intended for the expert builder. This set is fun for all ages, but younger kids might need support when building this epic toy. You can curb potential frustration AND it's a great way to get started on enriching your child's cognitive and motor skills!

How To Open Your Box:

1

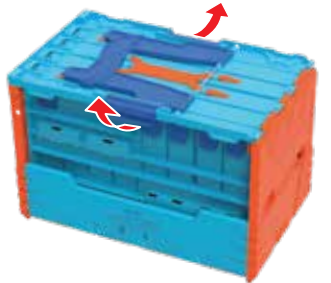

2

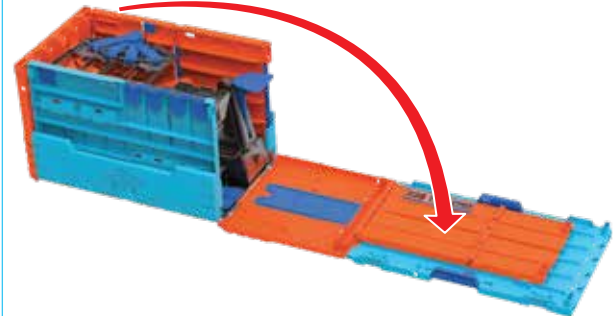

3

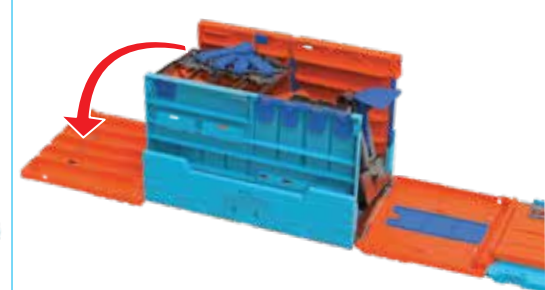

4

TAKE OUT PIECES.



5

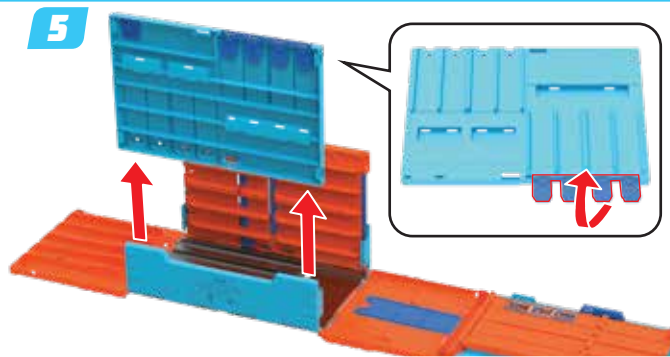

6

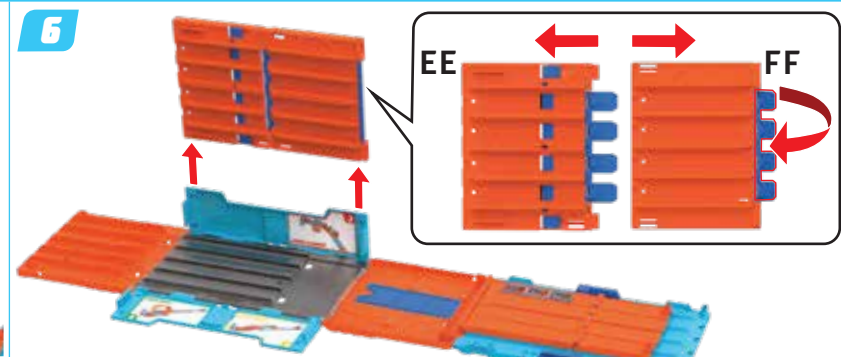

7



8



Get your wheels turning with the unlimited world of Track Builder where YOU are in the driving seat. Create your own outrageous stunts, experiment with speed and keep challenging yourself. The world of Track Builder offers endless possibilities and hours of fun where the formula is: CREATE +EXPERIMENT+ REPEAT. Are you ready to test your limits? Challenge Accepted™!

BUILD THESE FIRST:

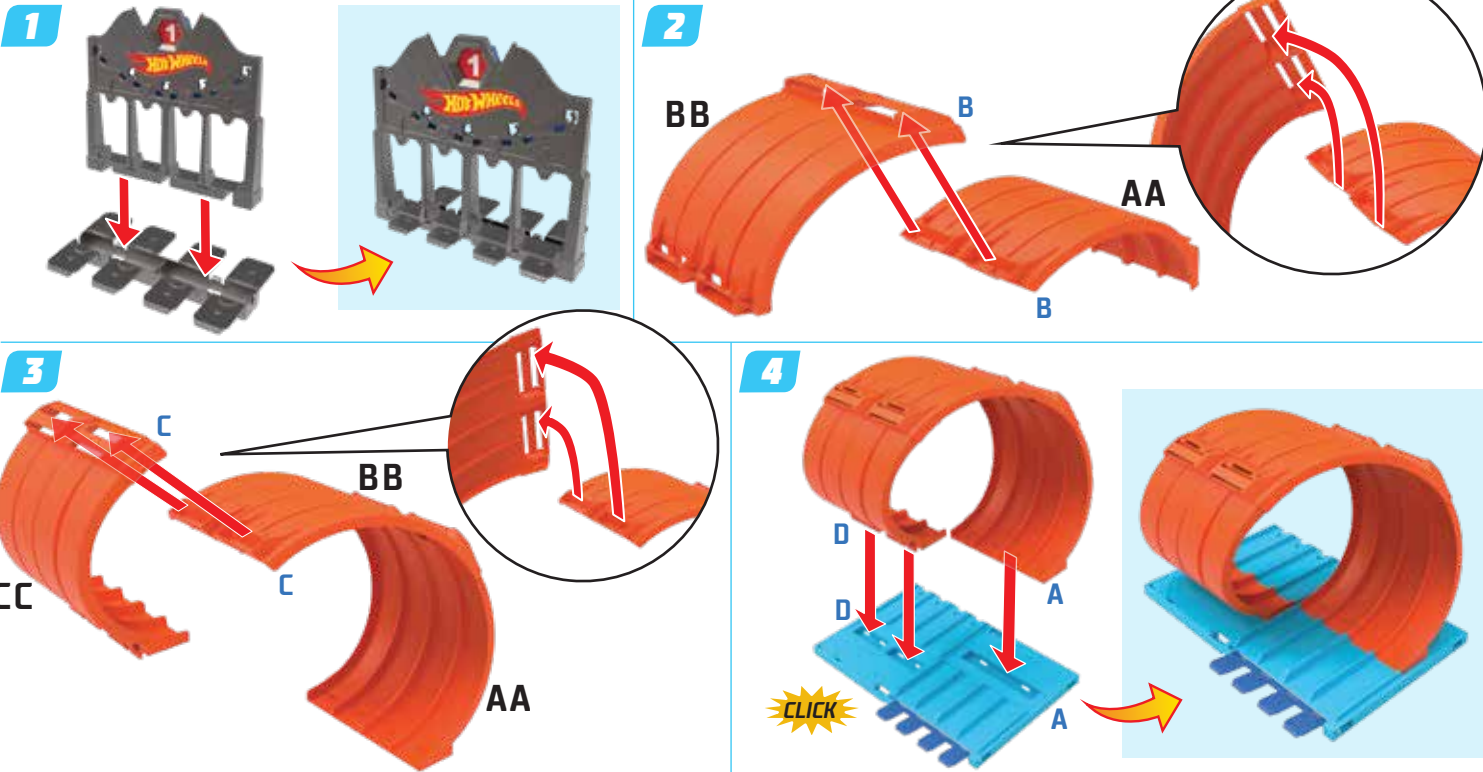

WHICH 4-LANE RACEWAY WILL YOU CHALLENGE FIRST?

BUILD A
DRAG RACE

INSTRUCTIONS ON PAGE 6

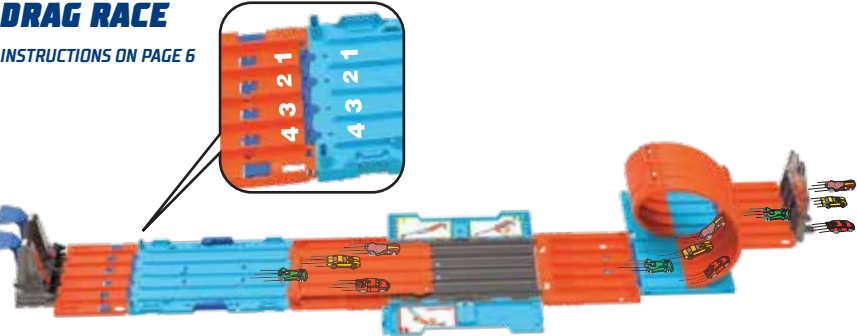

BUILD B
HILL CLIMB

INSTRUCTIONS ON PAGE 9

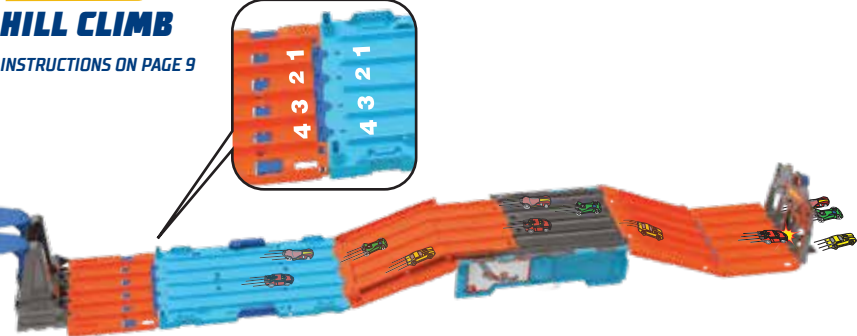

COLORS AND DECORATIONS MAY VARY.
NOT FOR USE WITH SOME HOT WHEELS® VEHICLES.
2 VEHICLES INCLUDED. ADDITIONAL VEHICLES SOLD SEPARATELY.

BUILD C
GRAVITY DROP

INSTRUCTIONS ON PAGE 12

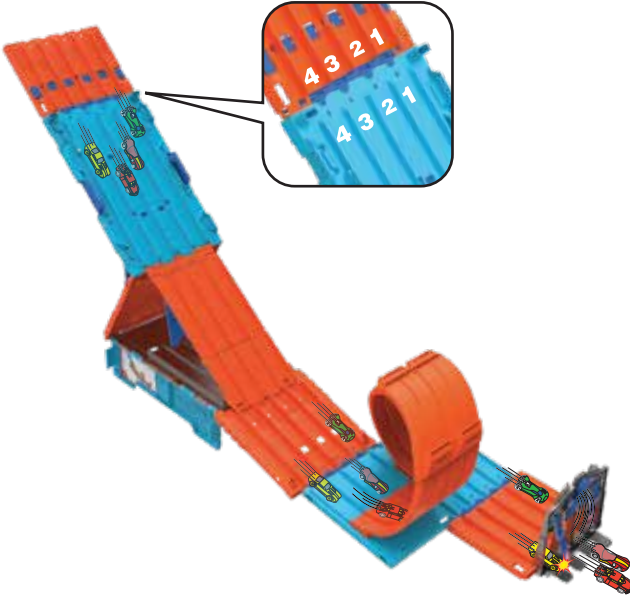

NOTE: FOR BEST PERFORMANCE, PLAY ON LOW PILE CARPET OR HARD SURFACES.

BUILD A: DRAG RACE

HERE'S WHAT YOU NEED:



1

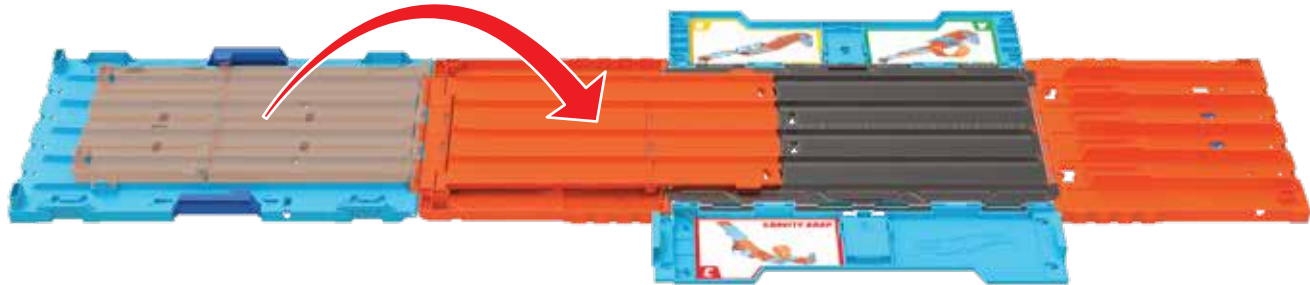

2

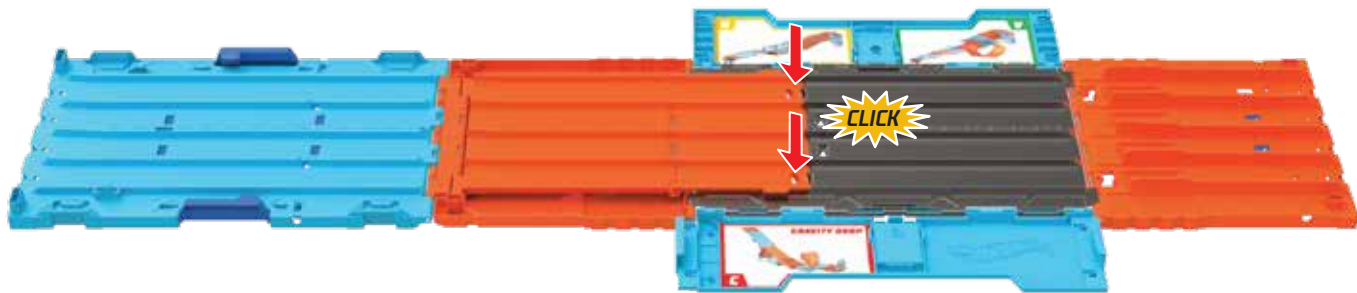

3

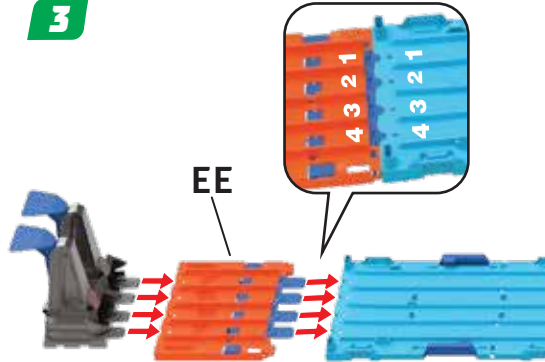

4

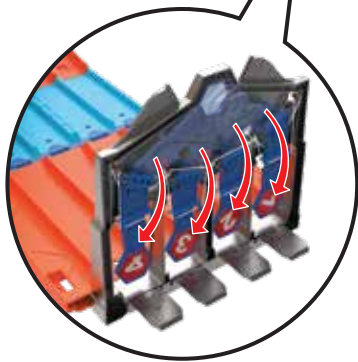
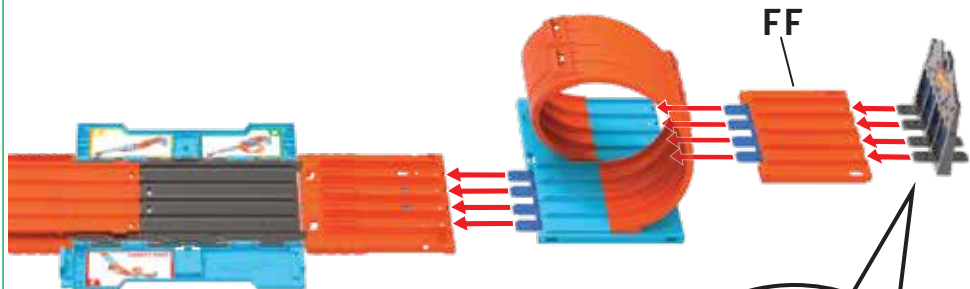

FLIP DOWN FOR EACH RACE.

NOW GRAB YOUR CAR AND GO!

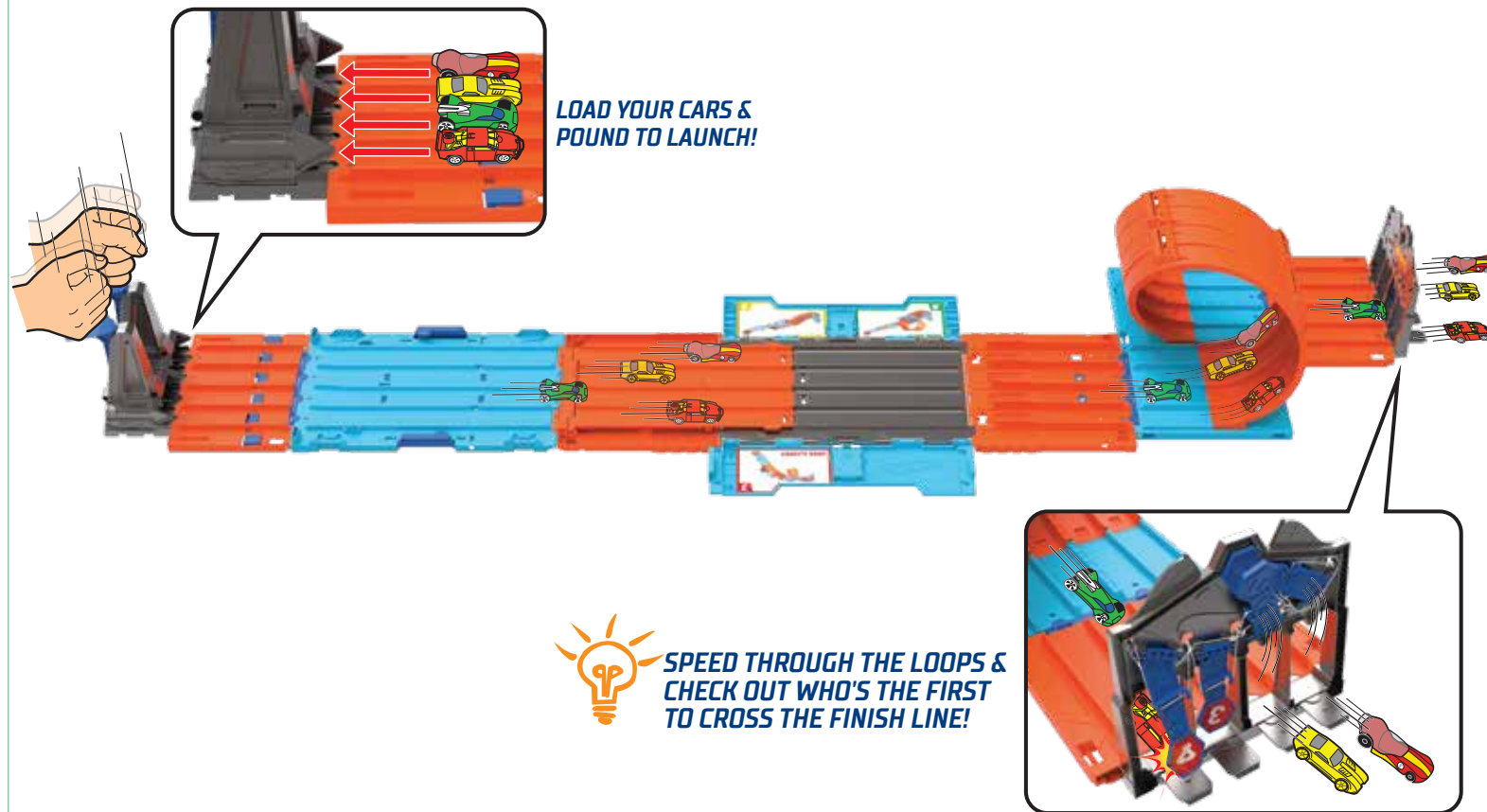

BUILD B: HILL CLIMB

HERE'S WHAT YOU NEED:



1

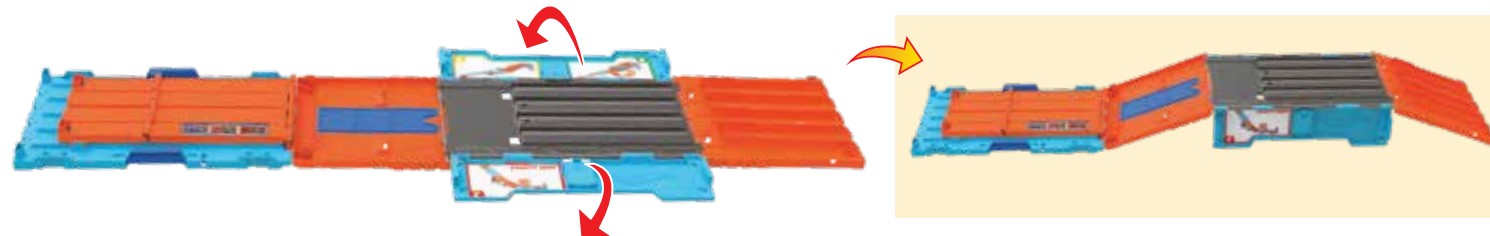

2

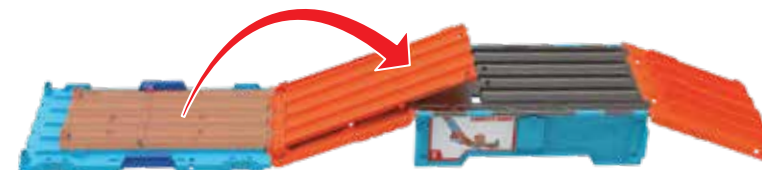

3

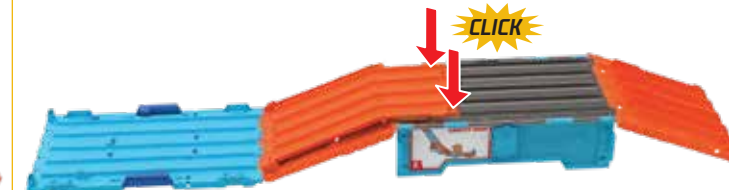

4

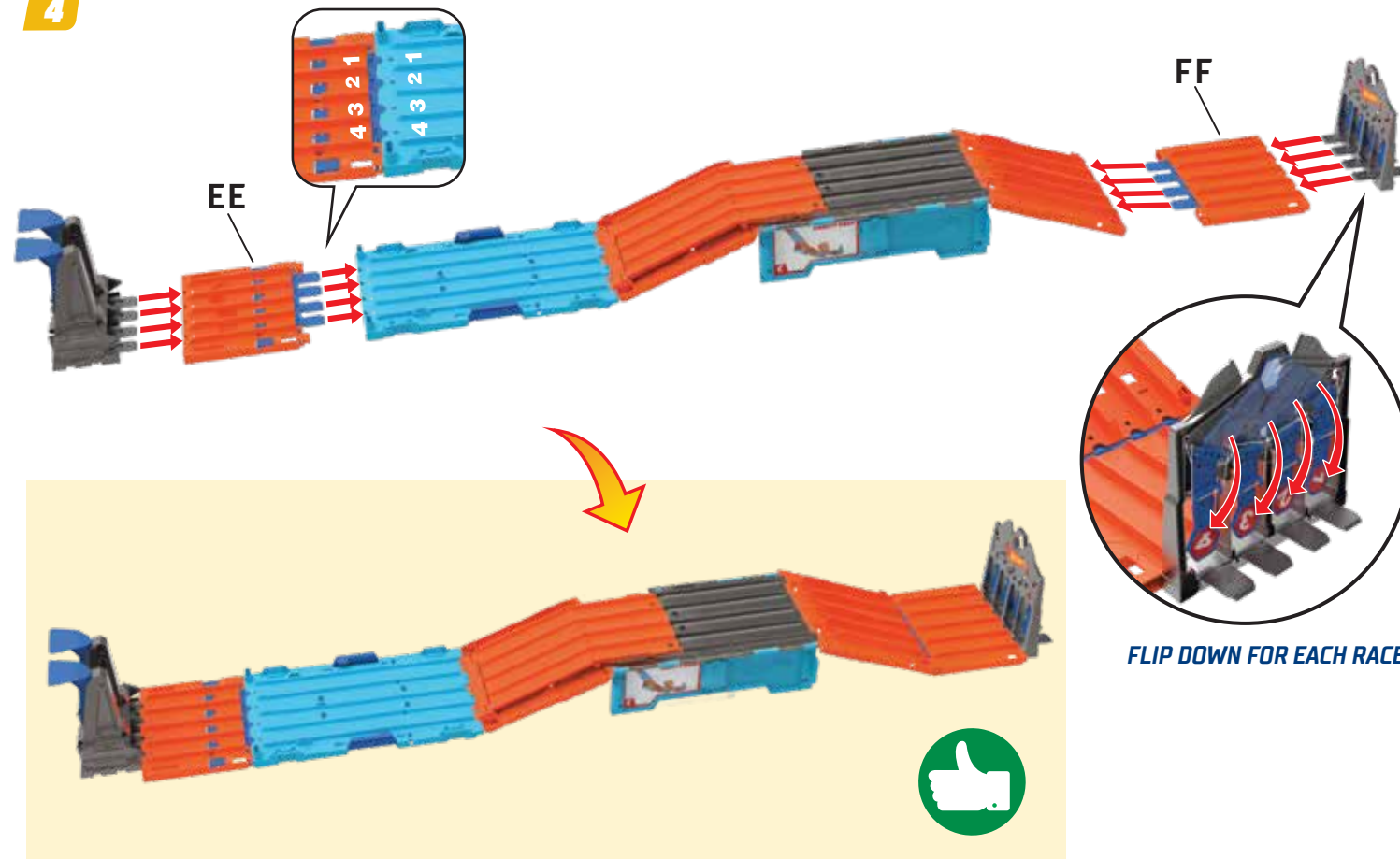

NOW GRAB YOUR CAR AND GO!

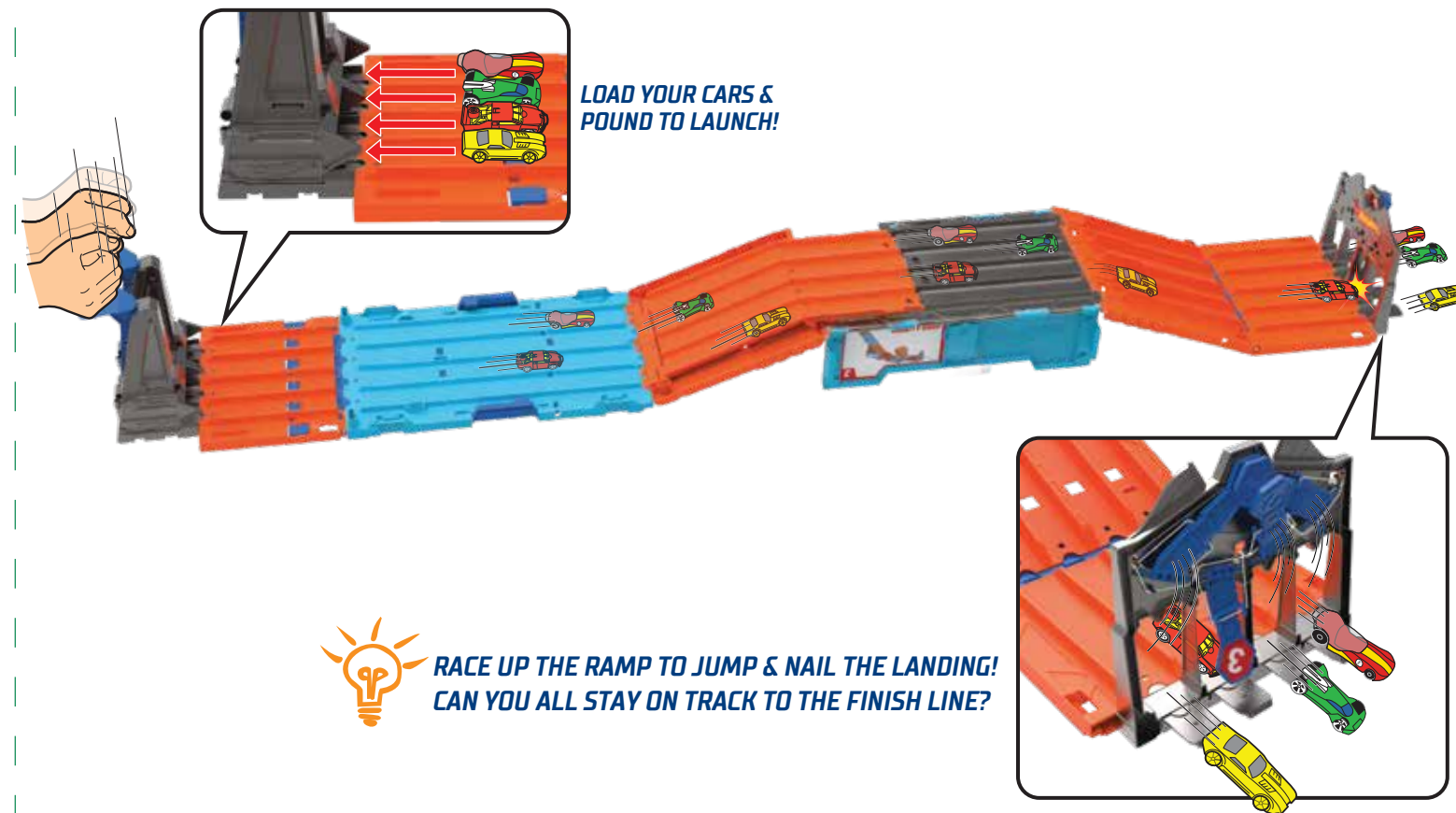

BUILD C: GRAVITY DROP

HERE'S WHAT YOU NEED:

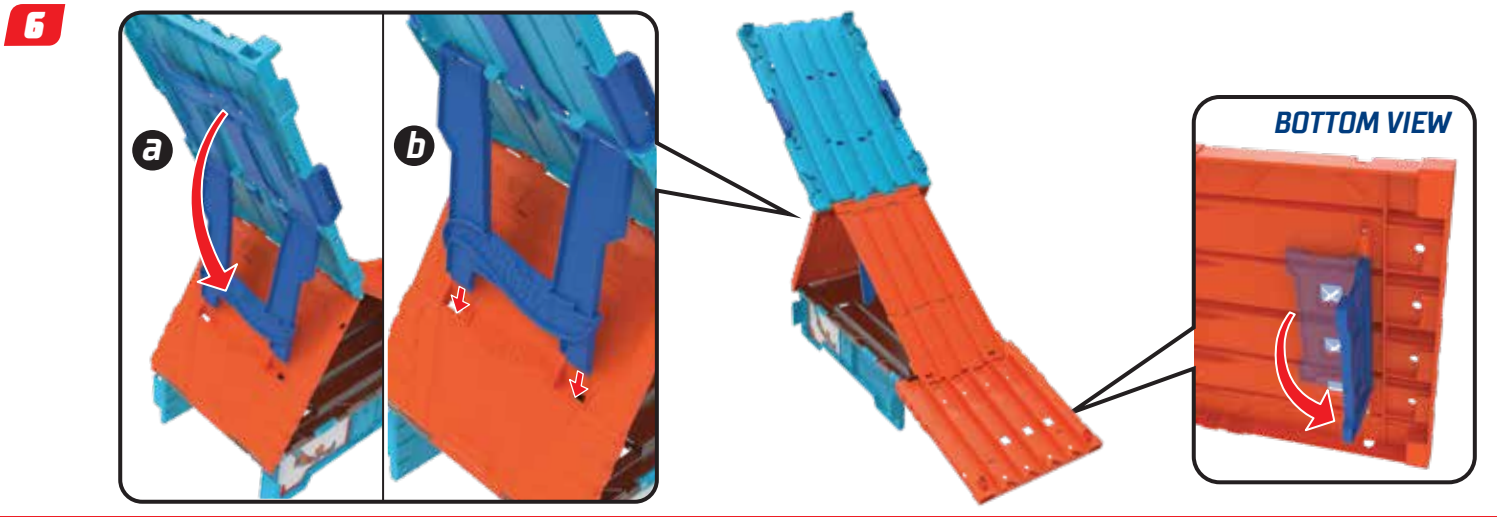
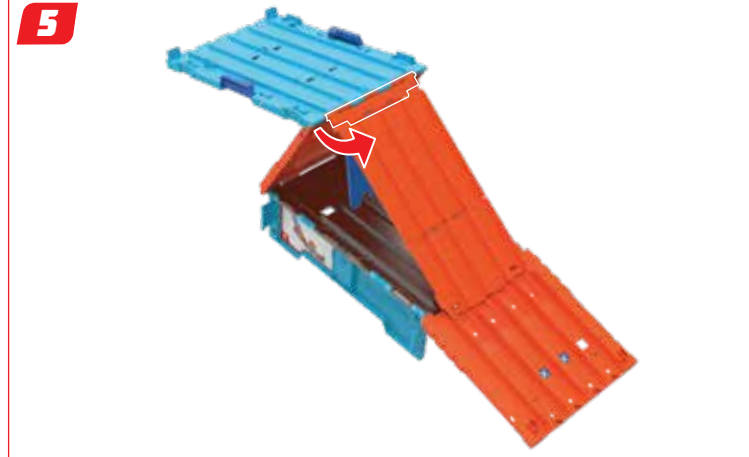
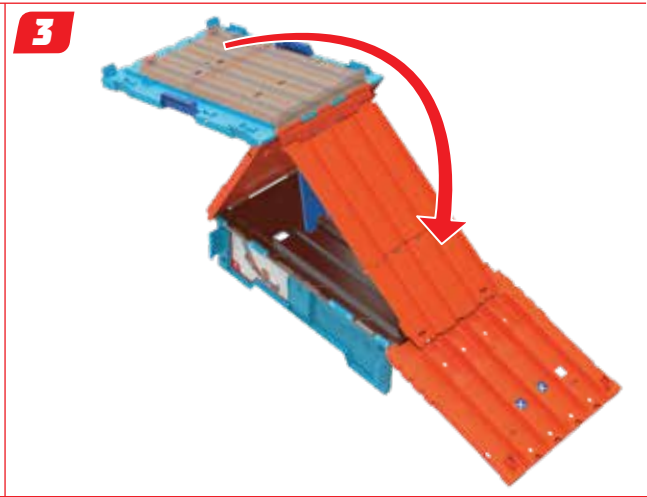
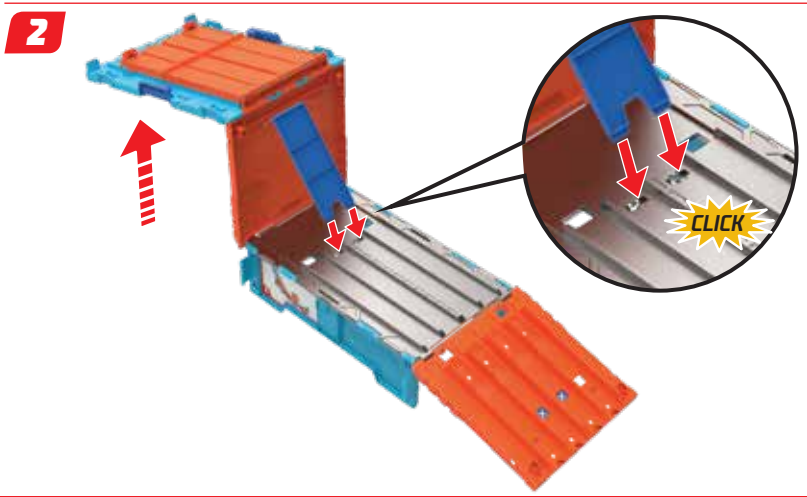
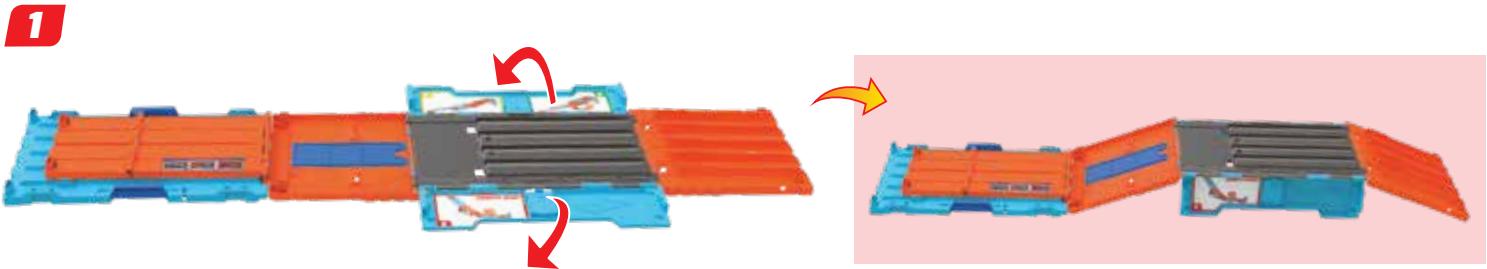

7

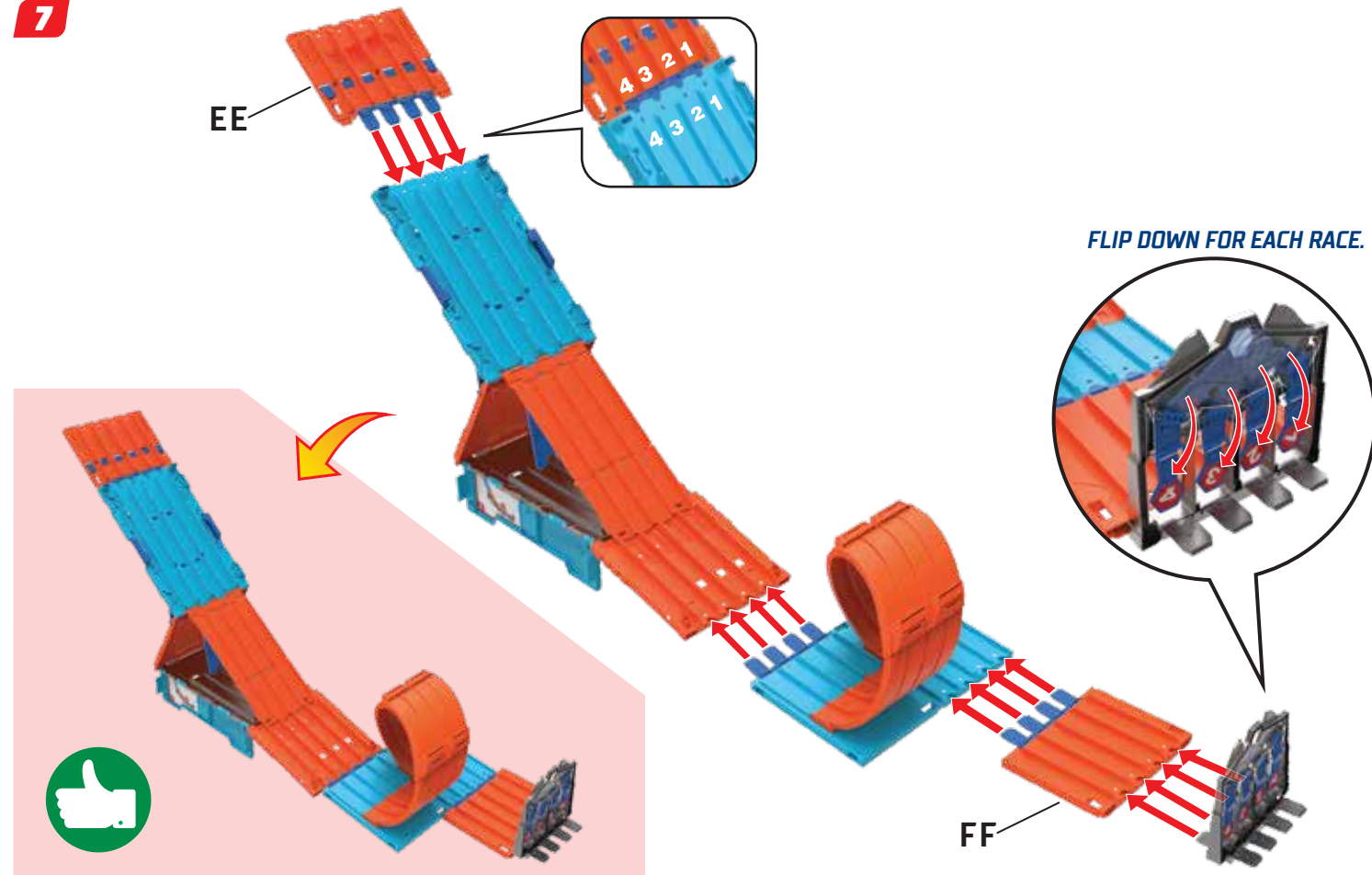

NOW GRAB YOUR CAR AND GO!

LOAD YOUR CARS & LOWER THE GATE FOR A FAIR START!

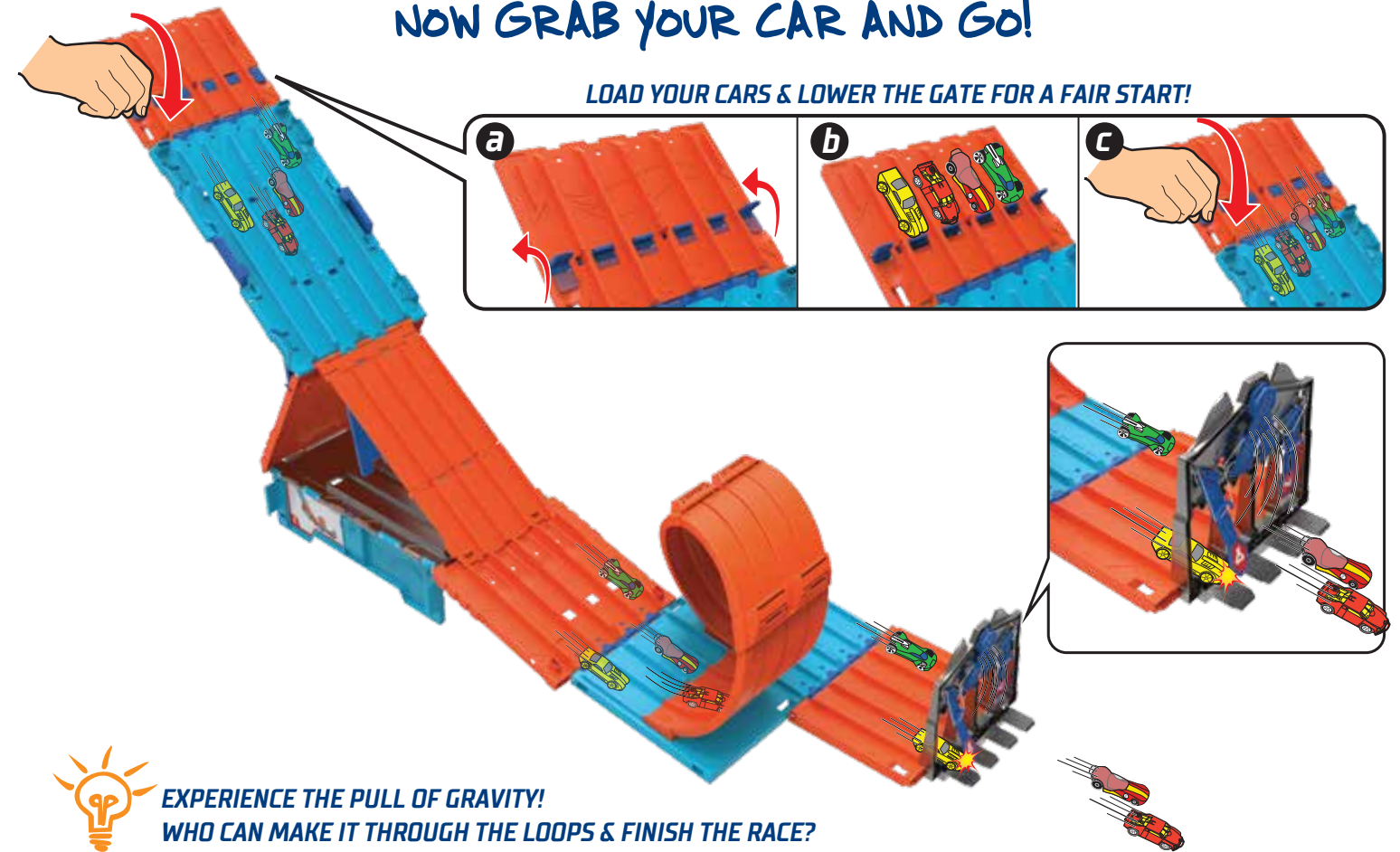

How To Store Your Pieces:

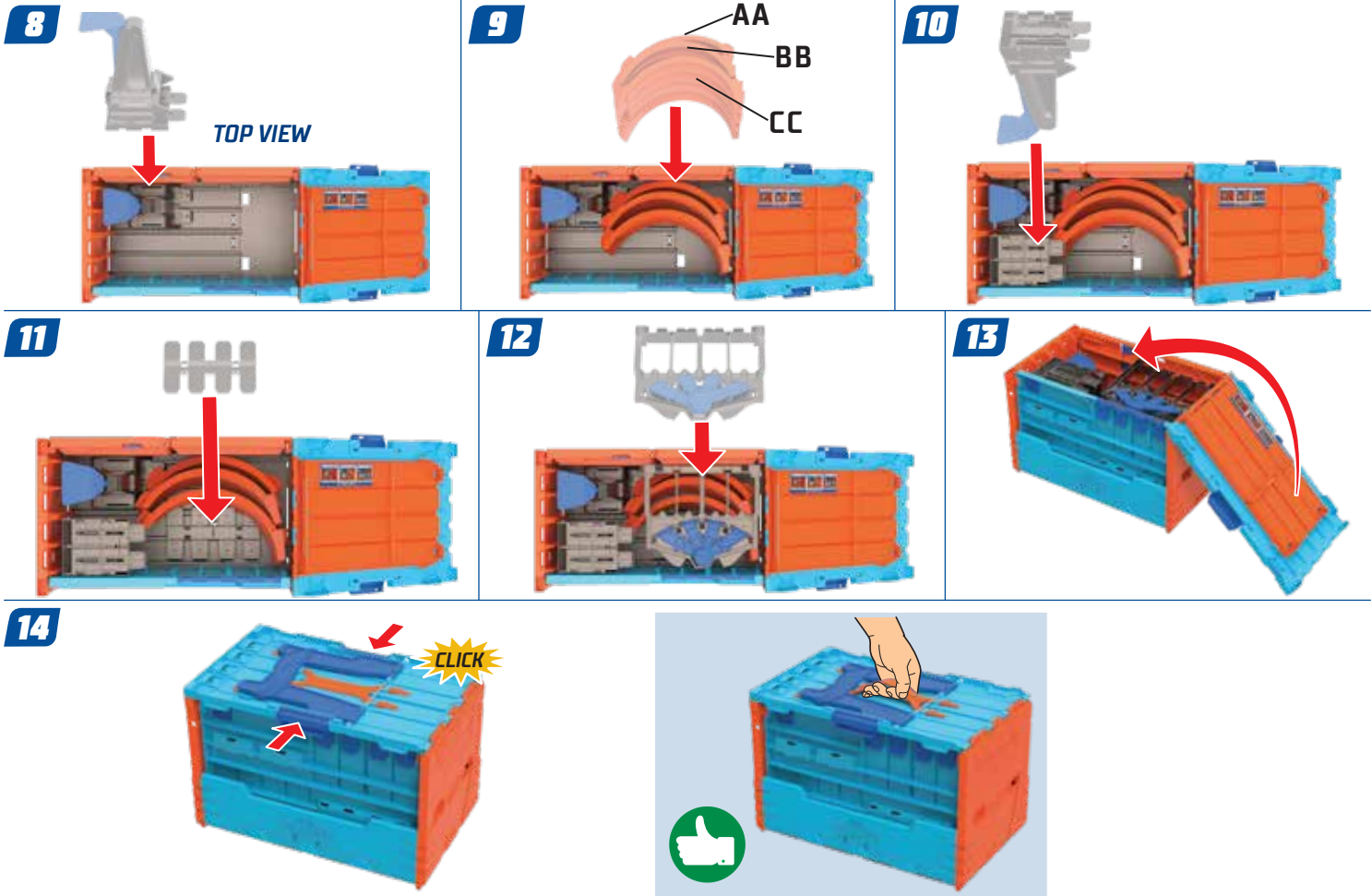
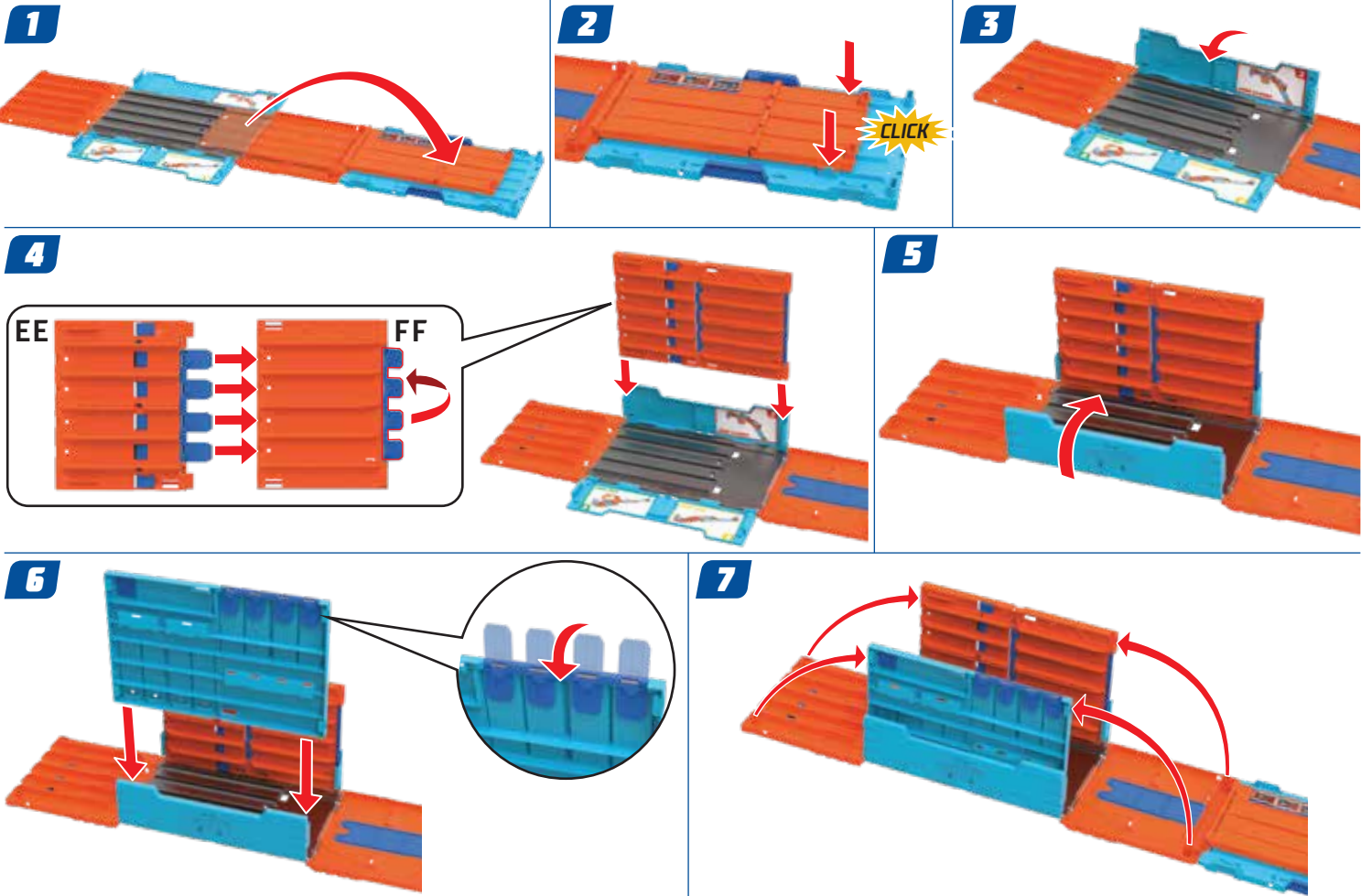

REPLACE RUBBER BAND

FOLLOW THE STEPS IF RUBBER BANDS DETACH.

1

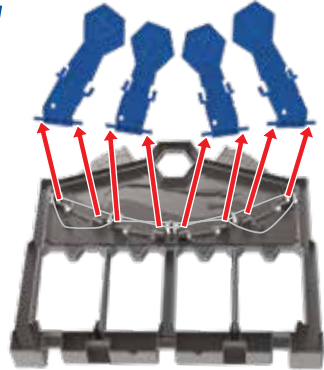

2

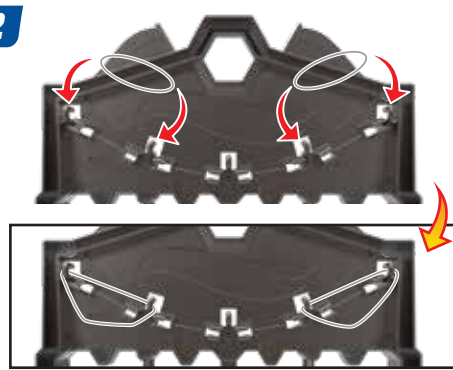

3

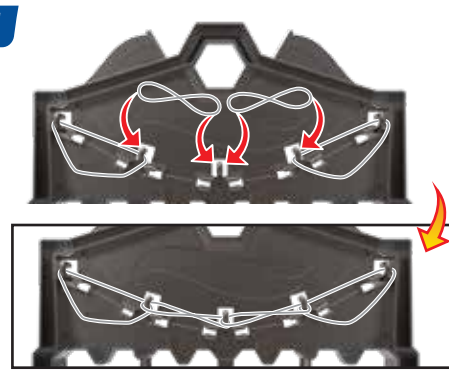

4

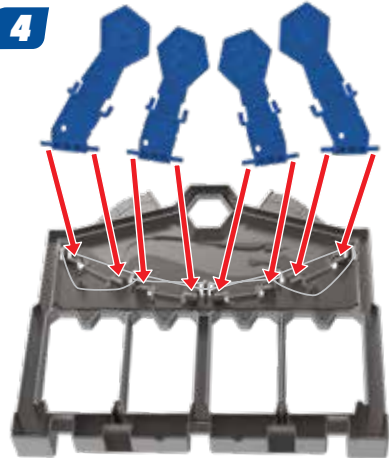

5



PARENTS: FOR EPIC TRACK IDEAS, HOW-TO VIDEOS AND AWESOME ENTERTAINMENT, CHECK OUT THE HOT WHEELS® YOUTUBE CHANNEL!
WWW.YOUTUBE.COM/HOTWHEELS

YouTube

HERE'S WHAT ELSE YOU CAN GET:

ADVERTISEMENT



DLF02
HANG IT!



DLF03
CLAMP IT!



DLF04
SWITCH IT!



DLF05
JUMP IT!



FTV22
LAUNCH IT!



DXM48
TRICK BRICK™



FLK92
BOOST IT!



DMH51
LOOP LAUNCHER



DJ066
LIFT & LAUNCH®



DJ068
2-LANE LAUNCHER



DWW94
RAPID LAUNCHER

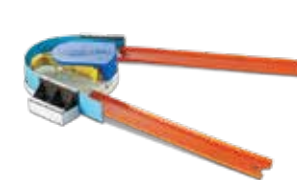

FPG95
CUSTOM TURN KICKER



FLL02
REV 'N LAUNCH CHALLENGE™



FLL01
HAMMER DROP® CHALLENGE



FLK60
ROCKET LAUNCH CHALLENGE



DWW95
STUNT BOX

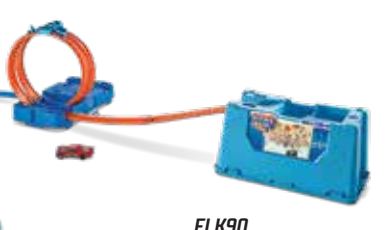

FLK90
MULTI LOOP BOX

EACH SOLD SEPARATELY, SUBJECT TO AVAILABILITY. COLORS AND DECORATIONS MAY VARY.